



Advantium CSB912 Built-In Wall Oven Installation Guide

[Home](#) » [Advantium](#) » Advantium CSB912 Built-In Wall Oven Installation Guide 

Advantium CSB912 Built-In Wall Oven Installation Guide



BEFORE YOU BEGIN

Read these instructions completely and carefully.

IMPORTANT — Save these instructions for local inspector's use.

IMPORTANT — Observe all governing codes and ordinances.

- **Note to Installer** — Be sure to leave these instructions with the Consumer.
- **Note to Consumer** — Keep these instructions with your Owner's Manual for future reference.
- **Skill Level** — Installation of this appliance requires basic mechanical and electrical skills.
- **Completion Time** — 1 Hour.

- Proper installation is the responsibility of the installer. Product failure due to improper installation is not covered under the warranty. See Owner's Manual for warranty information.

IMPORTANT — Use this oven only for its intended purpose. Never use the oven for warming or heating a room. Prolonged use of the oven without proper ventilation can be hazardous.

Caution: For personal safety, remove house fuse or oven circuit breaker before beginning installation to avoid severe or fatal shock injury.

Caution: For personal safety, the mounting surface must be capable of supporting the cabinet load, in addition to the added weight of the oven and drawer, plus additional oven loads.

Contents

1 Design Information

1.1 PRODUCT DIMENSIONS AND CLEARANCES

1.2 TOOLS AND PARTS REQUIRED (NOT SUPPLIED)

1.3 FLUSH MOUNT INSTALLATION

1.4 ADVANCE PLANNING

2 Installation Preparation

2.1 ELECTRICAL REQUIREMENTS

3 GROUNDING INSTRUCTIONS

3.1 Standard Installation Preparation

3.2 Standard Installation Preparation

3.3 Flush Mount Installation Preparation

4 Installation Instructions

4.1 REMOVE THE PACKAGING AND PARTS

4.2 SLIDE OVEN INTO CUTOUT

4.3 INSTALL BOTTOM TRIM

4.4 INSTALL MOUNTING SCREWS

4.5 FINALIZE INSTALLATION

5 Documents / Resources

5.1 References

6 Related Posts

Design Information

PRODUCT DIMENSIONS AND CLEARANCES

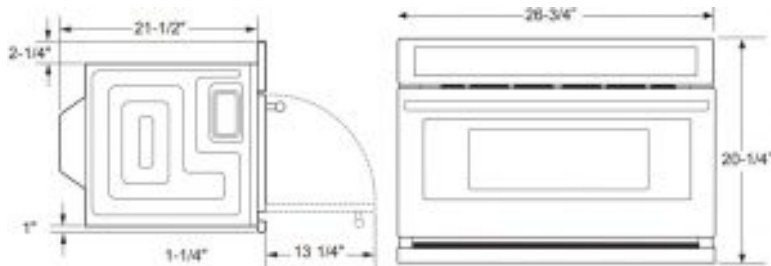

TOOLS AND PARTS REQUIRED (NOT SUPPLIED)

- #2 Phillips screwdriver
- Hand-held drill

- High speed drill bit, 3/32" diameter
- 3/8" slot-head screwdriver
- Level
- Saw
- 3/8" slot-head screwdriver
- Wood screws or other hardware for installing runner or shelf to support oven (if required)
- Safety glasses or goggles

FLUSH MOUNT INSTALLATION

This installation method allows for the unit face to be inline with the cabinet face. **IMPORTANT: HIGH SKILL LEVEL IN CARPENTRY IS REQUIRED.** Non-standard cabinetry may be required. Flush installation of the oven will lead to the exposure of the cabinet face frame edges. Side cleats may be visible and should be a finished surface.

ADVANCE PLANNING

- These ovens may be installed directly into a 27" wide oven cabinet with standard installation.
- Cutout height dimensions are different for installations with an accessory storage drawer. Make sure to use the correct cutout when preparing the opening.
- Allow for clearance to adjacent corners, walls, drawers, etc. The oven must be securely installed in a cabinet that is firmly attached to the house structure. Weight on the oven door could cause the oven to tip and result in injury. Never allow anyone to climb, sit, stand or hang on the oven door

Installation Preparation

ELECTRICAL REQUIREMENTS

Single Advantium Built-In Oven Installation:

This product requires a 120-volt, 60 Hz, 15-amp circuit and draws 1.8 kilowatts. This product must be connected to a supply circuit of the proper voltage and frequency.

- Wire size must conform to the requirements of the National Electrical Code or the prevailing local code for this kilowatt rating.
- The power supply cord and plug should be brought to a separate 15 or 20 ampere branch circuit single grounded receptacle. The outlet box should be located within reach of the 48" power cord.

ELECTRICAL LOCATION

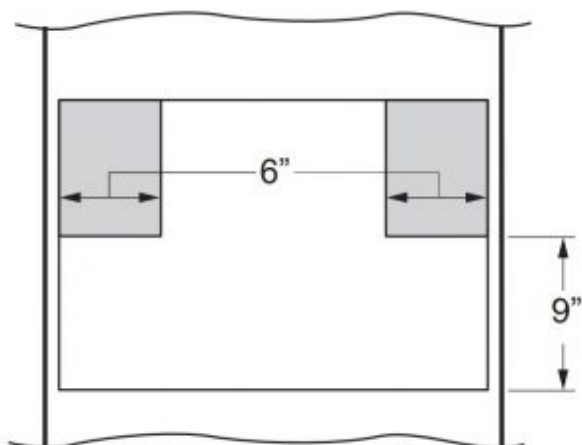

Locate outlet box in the shaded area

Install a recessed electrical outlet in the back wall of the opening within 6 of either side and at least 9 above the cutout floor.

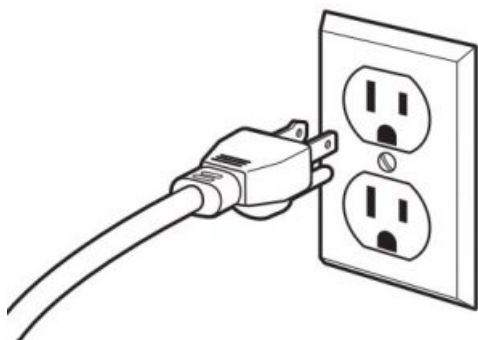

GROUNDING INSTRUCTIONS

WARNING Improper use of the grounding plug can result in a risk of electric shock.

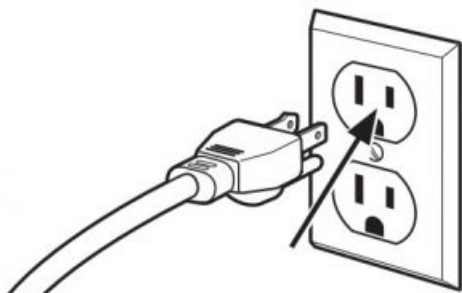

This appliance must be grounded. In the event of an electrical short circuit, grounding reduces the risk of electric shock by providing an escape wire for the electric current.

This appliance is equipped with a power cord having a grounding wire with a grounding plug. The plug must be plugged into an outlet that is properly installed and grounded. Consult a qualified electrician or service technician if the **GROUNDING INSTRUCTIONS** are not completely understood, or if doubt exists as to whether the appliance is properly grounded.

If the outlet is a standard 2-prong wall outlet, it is your personal responsibility and obligation to have it replaced with a properly grounded 3-prong wall outlet.

Do not under any circumstances cut or remove the third (ground) prong from the power cord. Do not use an extension cord. If the power cord is too short, have a qualified electrician or service technician install an outlet near the appliance.

For best operation, plug this appliance into its own electrical outlet to prevent flickering of lights, blowing off use or tripping of circuit breaker.

Standard Installation Preparation

PREPARE THE OPENING

The Advantium Built-In Oven can be installed in combination with other Built-In appliances. Always follow each product's Installation Instructions to complete the installation.

Single Advantium Built-In Oven Installation:

Order a 27" or 30" wide single oven cabinet or cut the opening in a wall to the dimensions shown.

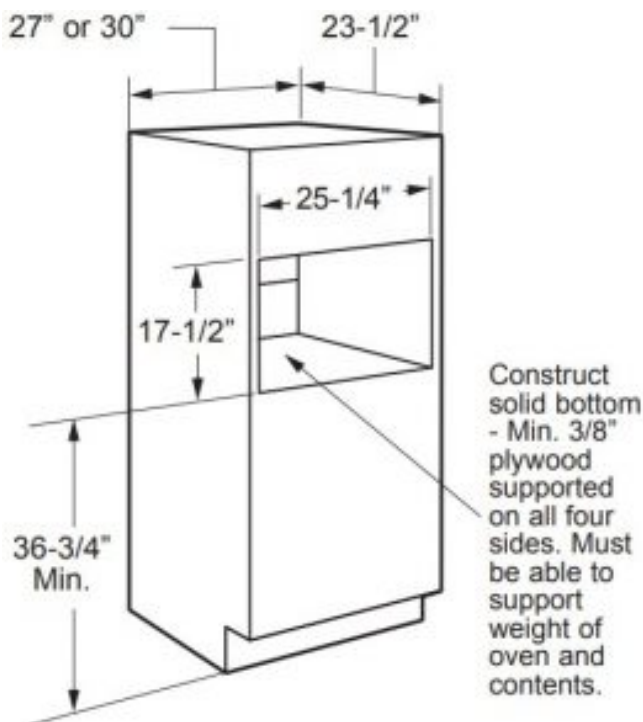

- Allow the following clearances around the cutout on the front surface of the cabinet: 1-7/8" from the top, 7/8" from the side edges and 1-1/8" from the bottom.

Note: these refer to minimum clearances required for installation and do not reflect actual product dimensions.)

- Oven overlaps will conceal cut edges on all sides of the opening. When installed over a single oven or a warming drawer, allow at least 2" between the two openings. This separation will provide clearance for bottom overlap of the Advantium 120 and the other appliance overlaps.
- The support must be level and rigidly mounted, flush with the bottom edge of the cutout.

PREPARE THE OPENING (CONT.)

Installation over a Warming Drawer:

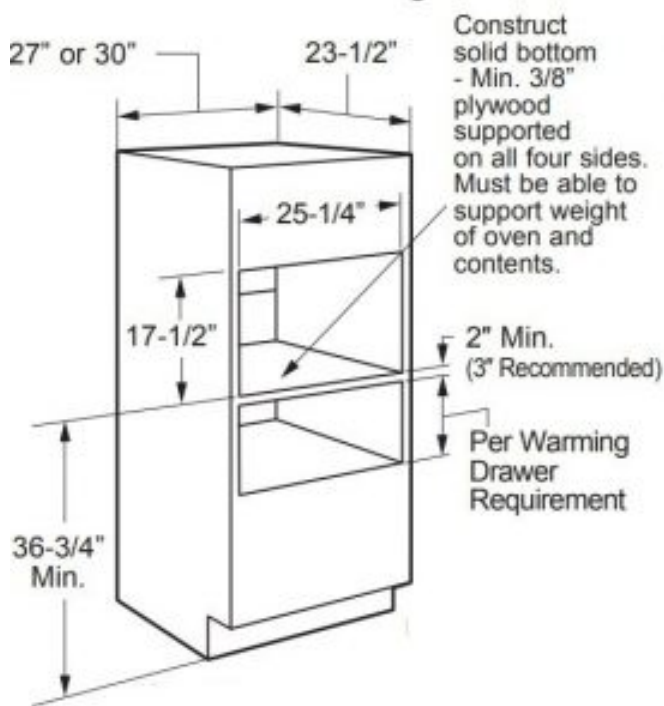

NOTE: Additional clearances between the cutouts may be required. Check to be sure the oven supports above the Warming Drawer location does not obstruct the required interior depth and height. See Warming Drawer installation instructions for details.

Standard Installation Preparation

PREPARE THE OPENING (CONT.)

Installation over a Wall Oven:

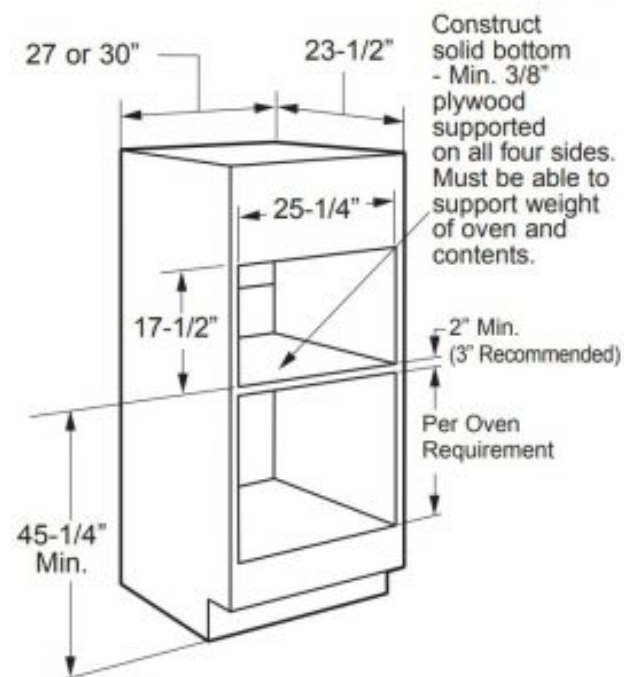

- If you are replacing an electric double oven with the combined installation of an Advantium Built-In Oven and a single oven, use the dimensions shown. The middle rail separating the two openings may need to be larger than the 2" minimum shown.

PREPARE THE OPENING (CONT.)

Installation over a Wall Oven and Warming Drawer:

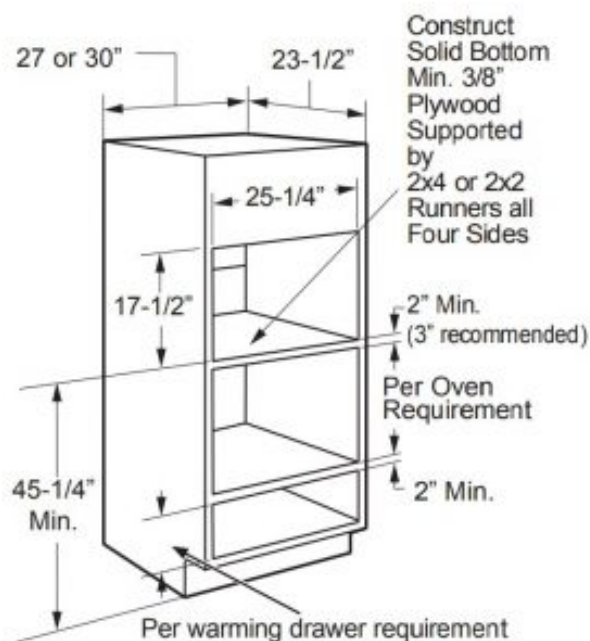

NOTE: Additional clearances between the cutouts may be required. Check to be sure the oven supports above the Warming Drawer location does not obstruct the required interior depth and height. See Warming Drawer installation instructions for details.

CAUTION For personal safety, the mounting surface must be capable of supporting the cabinet load, in addition to the added weight of the oven and drawer, plus additional oven loads

PREPARE THE OPENING (CONT.)

Installation over another Advantium Built-In Oven:

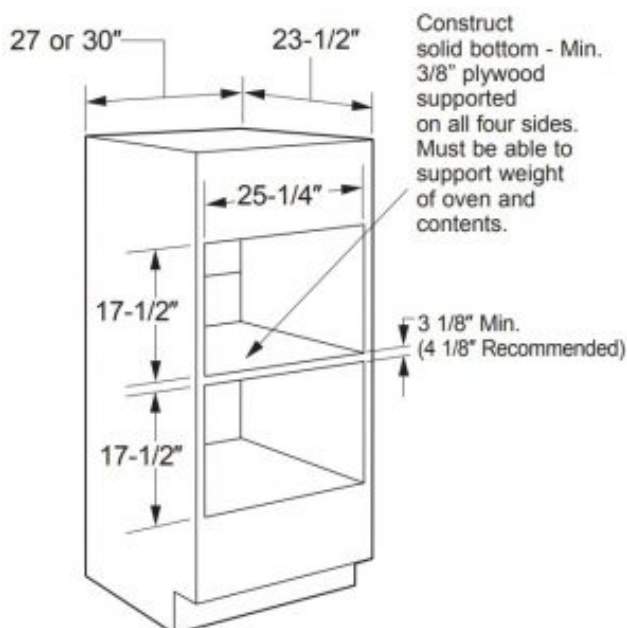

- If you are mounting a Built-In Advantium Oven over another, use the dimensions shown. The middle rail

separating the two openings may need to be larger than the 3-1/8" minimum shown.

PREPARE THE OPENING (CONT.)

Installation under a Microwave Oven and over a Warming Drawer:

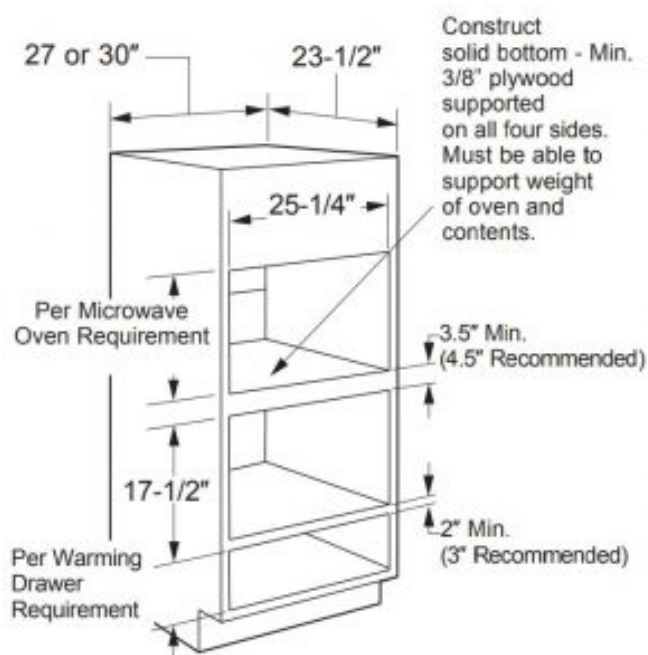

NOTE: Additional clearances between the cutouts may be required. Check to be sure the oven supports above the Warming Drawer location do not obstruct the required interior depth and height. See Warming Drawer installation instructions for details.

CAUTION For personal safety, the mounting surface must be capable of supporting the cabinet load, in addition to the added weight of the oven and drawer, plus additional oven loads.

PREPARE THE OPENING (CONT.)

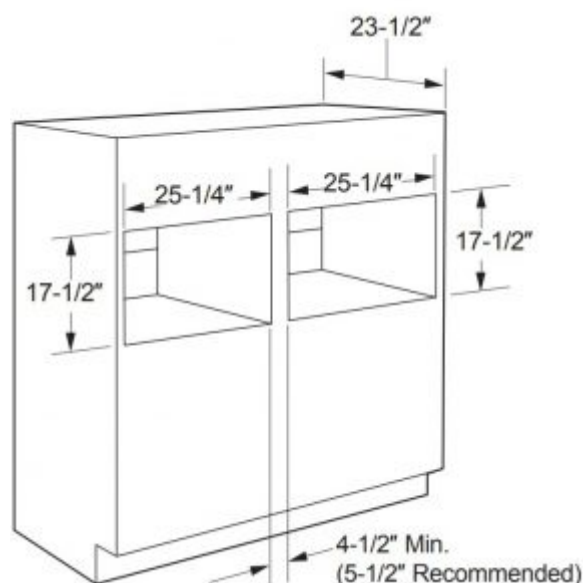

Installation beside another Built-In Oven:

- If you are mounting an Advantium Built-In Oven beside another, use the dimensions shown. The middle rail separating the two openings may need to be larger than the 4-1/2 minimum shown.

PREPARE THE OPENING (CONT.)

Installation under a 30 or 36 Cooktop or Countertop:

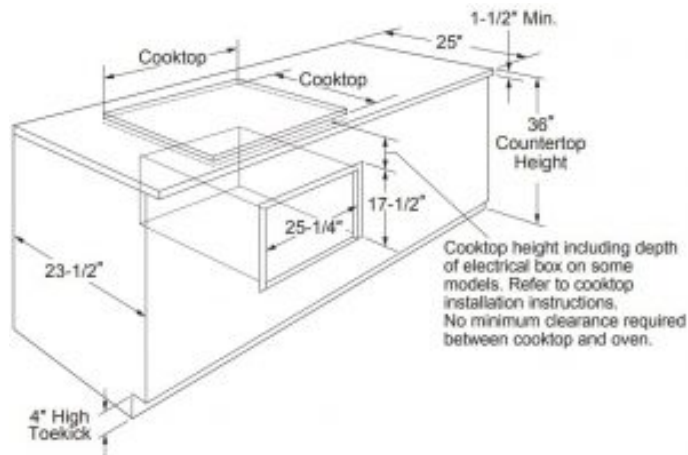

Gas or electric cooktops may be installed over this oven. See cooktop installation instructions for the cutout size. See the label on top of the oven for approved cooktop models. This oven requires a separate, properly grounded 15-Amp, 120-Volt, 60Hz power supply. The cooktop requires a separate power supply. Use a 36 or wider base cabinet.

Flush Mount Installation Preparation

PREPARE THE INTERIOR

Cut and install side cleats:

- Cut side wood cleats to height of cabinet opening and approx. 2-1/2" in depth. Install, on each side, Dim. E from the front face of the cabinet.

Cut and install bottom cleat:

- Cut bottom wood cleat to a height of 1-1/8", a depth of the cabinet minus Dim. E and a width of 25-1/4" to fit between side cleats. Install onto the cabinet floor between the side cleats, push it all the way back against cabinet wall and make sure its front face aligns with the front faces of the side cleats (Dim. E gap from the front cabinet face)

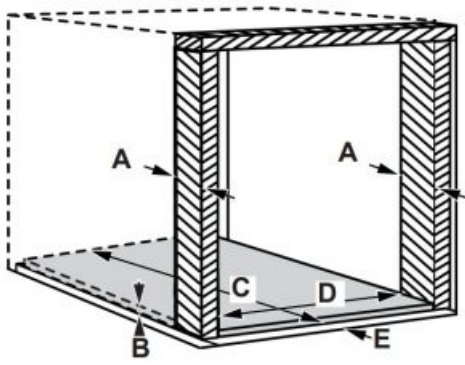

A	Side and top cleats depth	2-1/2" min.
B	Bottom cleat height	1-1/8"
C	Bottom cleat depth	Cabinet depth minus Dim. E"
D	Bottom cleat width	25-1/4"
E	All four cleats inset depth	1 1/4"

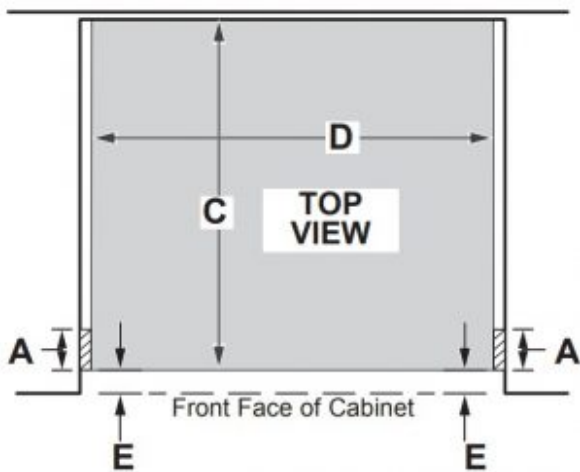

PREPARE THE OPENING

The Advantium Built-In Oven can be installed in combination with other Built-In appliances. Always follow each product's Installation Instructions to complete the installation.

Single Advantium Built-In Oven Installation:

Cut the opening in a cabinet to the dimensions shown.

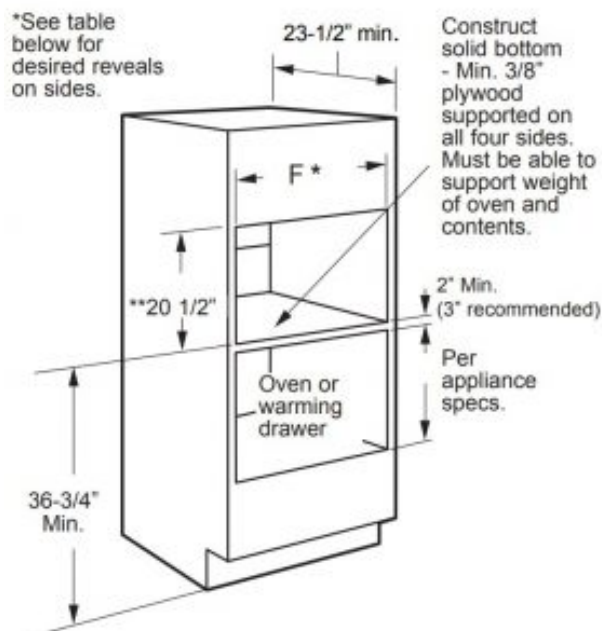

- The support must be level and rigidly mounted, flush with the bottom edge of the cutout.

Approved Flush Installation	Dimension F	
	1/8" Reveal	1/4" Reveal
Single Advantium	27"	27-1/4"
Over Warming Drawer	27"	27-1/4"
Over Oven	27"	27-1/4"
Over Oven and Warming Drawer	27"	27-1/4"
Over Built-in Oven	27"	27-1/4"
Double Advantium (side by side)	See page 10	
Under Cooktop or Countertop	See page 10	

PREPARE THE OPENING

The Advantium Built-In Oven can be installed beside another Advantium Built-In Oven in a side-by-side combination

Double Advantium Built-In Oven Installation:

Cut the opening in a cabinet to the dimensions shown.

- Center divider acts as cleat for side of each respective unit. Only one additional side cleat needed per oven cutout.
- The support must be level and rigidly mounted, flush with the bottom edge of the cutout.

***See table for desired reveals on sides and between unit.**

Dimension	1/8" Reveal	1/4" Reveal
G	53-7/8"	54-1/4"
H	1-5/8"	1-3/4"
I	26-1/8"	26-1/4"

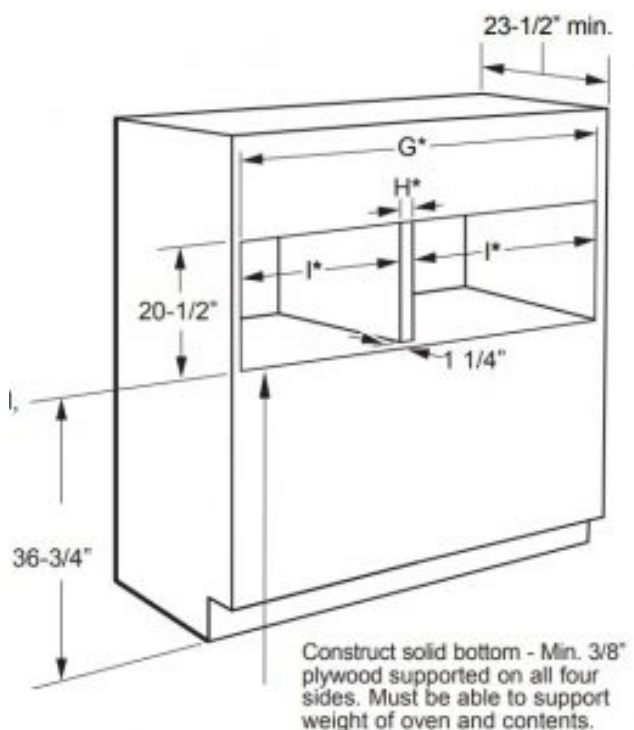

PREPARE THE OPENING

Installation under a 30 or 36 Cooktop or Countertop: Gas or electric cooktops may be installed over this oven. See cooktop installation instructions for the cutout size. See the label on top of the oven for approved cooktop models. This oven requires a separate from the cooktop, properly grounded 15-Amp, 120-Volt, 60Hz power supply. Use a 36" or wider base cabinet.

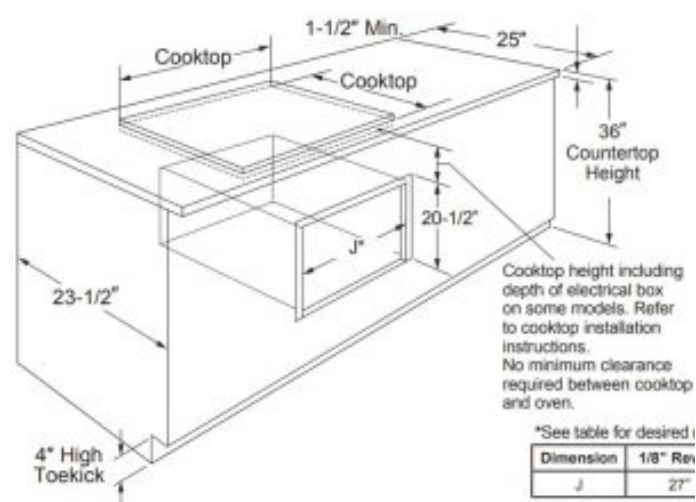

Installation Instructions

REMOVE THE PACKAGING AND PARTS

- Remove all packing material and tape.
- Locate parts package containing mounting screws.
- Remove the oven from the carton. Do not lift unit by handle or conduit. Two people are required to lift this oven.
- Open the door and remove any packaging in oven

IMPORTANT: If installing the Advantium Built-In Oven with an accessory storage drawer, read the storage drawer assembly instructions to assemble the products together before proceeding to Step 2.

- **Owner's Manual**

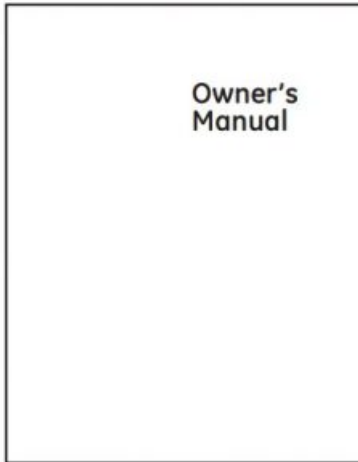

- **Installation Instructions**

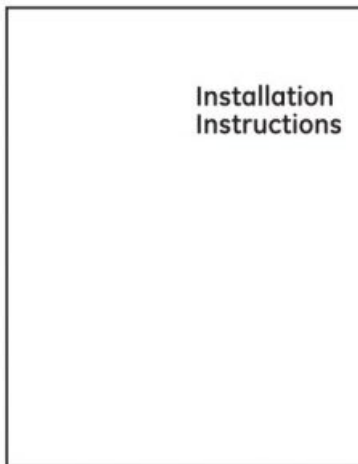

- **Cooking Guide**



- **Glass Tray**



- **Turntable Ring**



- **Metal Trays (2)**



- **Rack**

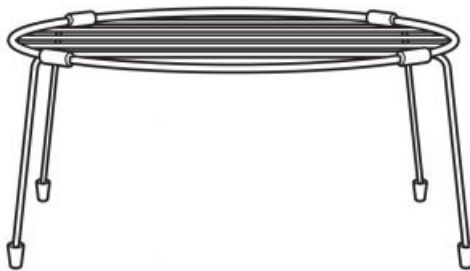

- **5 Color-Matched Screws (4 required, 1 extra)**

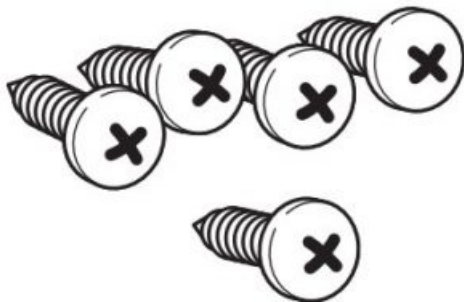

- **6 Brass Screws for the Bottom Trim (3 required, 3 extra)**

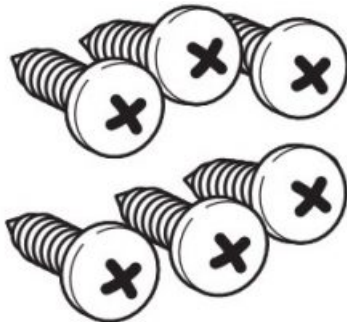

- **Flat-Head Screws (4 extra)**



- **Bottom Trim**

SLIDE OVEN INTO CUTOUT

CAUTION: Two people are required to lift the oven into the opening. lift the oven into the opening. NOT USE THE HANDLE TO LIFT THE OVEN. DAMAGE WILL OCCUR!

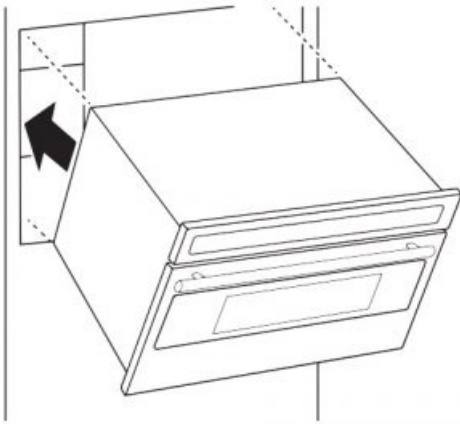

- Lift and hold the oven at the front of the opening. Hold the oven at a 45° angle and plug in the power cord.
- Carefully, slide the oven into the cabinet part way. Leave the oven a few inches forward of the cabinet frame.
- Check to be sure the power cord is not trapped under the oven or along the sides of the oven.

INSTALL BOTTOM TRIM

- Align bottom trim tabs to slots in the bottom of the oven

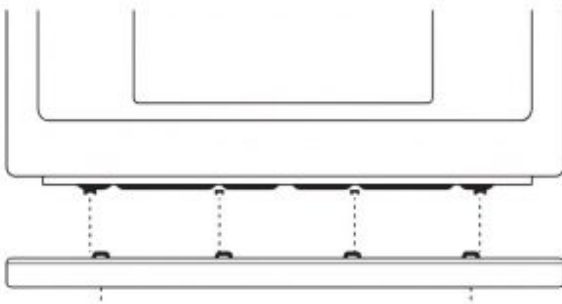

- Secure the bottom trim to the bottom of the oven using 3 brass screws provided

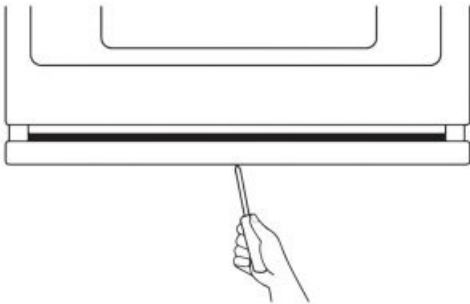

INSTALL MOUNTING SCREWS

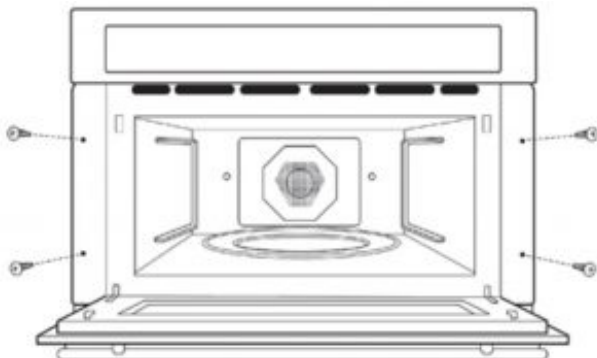

- Slide the oven the remaining way into the opening so that the side flanges and control panel are against the cabinet frame. Make sure that the oven is centered in the opening.
- Open the door, place a turntable tray in the oven and make sure that the tray in the unit is level.
- Drill pilot holes through the side flanges.
- Drive the color-matched screws into the side flanges. It is recommended that the screws be hand tightened.

FINALIZE INSTALLATION

- Turn power on at the source. The interior light should come on when the door is opened.
- Refer to the Owner’s Manual for operating instructions.

Documents / Resources

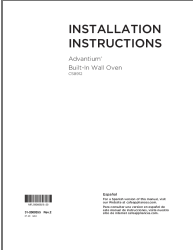
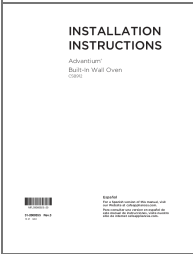
	Advantium CSB912 Built-In Wall Oven [pdf] Installation Guide Built-In Wall Oven, CSB912
	Advantium CSB912 Built-In Wall Oven [pdf] Instruction Manual CSB912, Built-In Wall Oven

References

-  [Cafe Appliances](#)