



ADT Mobile Device 4.0 User Manual

[Home](#) » [ADT](#) » ADT Mobile Device 4.0 User Manual

Contents [[hide](#)]

- [1 ADT Mobile Device 4.0](#)
- [2 Setting up your mobile device](#)
- [3 Call ADT to conduct a live test of your mobile device](#)
- [4 Documents / Resources](#)
 - [4.1 References](#)
- [5 Related Posts](#)



Medical Alert

ADT Mobile Device 4.0



Thank you for choosing this ADT On-The- Go Personal Emergency Response System

ADT is the most trusted name in security, with over 140 years of experience. Live more confidently knowing that your system is ready 24/7/365. At the press of a button, a trained ADT professional can speak to you and get help if needed.

Setting up your mobile device

- Plug the AC adapter end of the power cord into an electrical outlet that is NOT controlled by a light switch.
- Place your mobile device on the cradle charger.
- The yellow light on the front of the cradle charger will illuminate.
- The mobile device will turn on within ten (10) seconds and then it will take about 60 seconds for the mobile device to register with the network.
- The red battery light will start blinking, indicating that the device still needs charging. When the device is fully charged, the red light will turn off. It will take up to three (3) hours for the device to be fully charged.

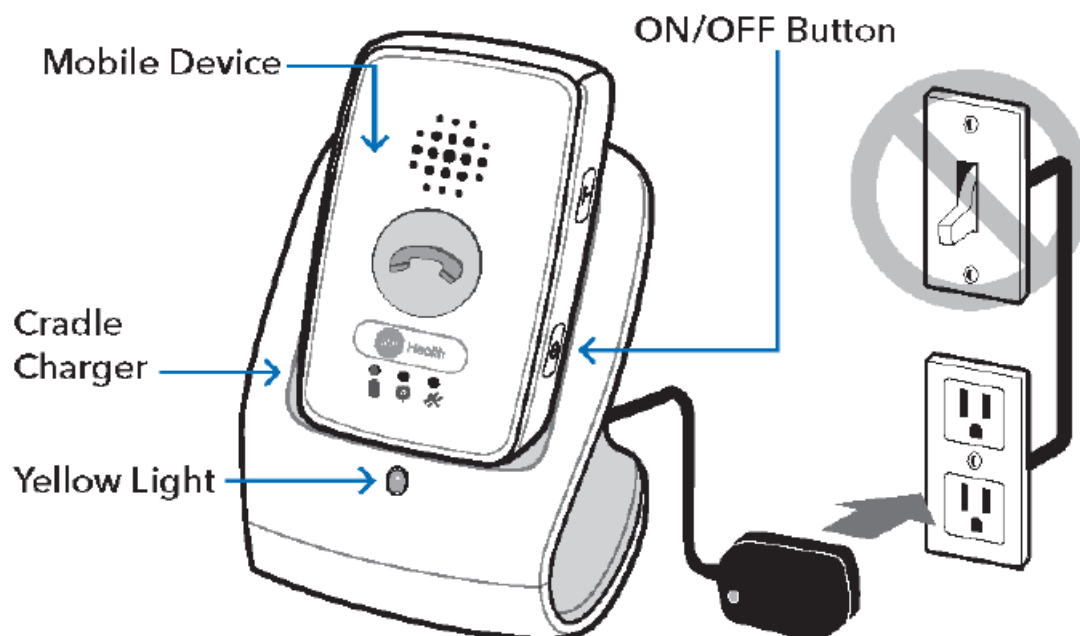

Call ADT to conduct a live test of your mobile device

- Call 800-498-8512
- Please place the unit on the charging cradle for at least three (3) hours prior to calling in to conduct the live test.

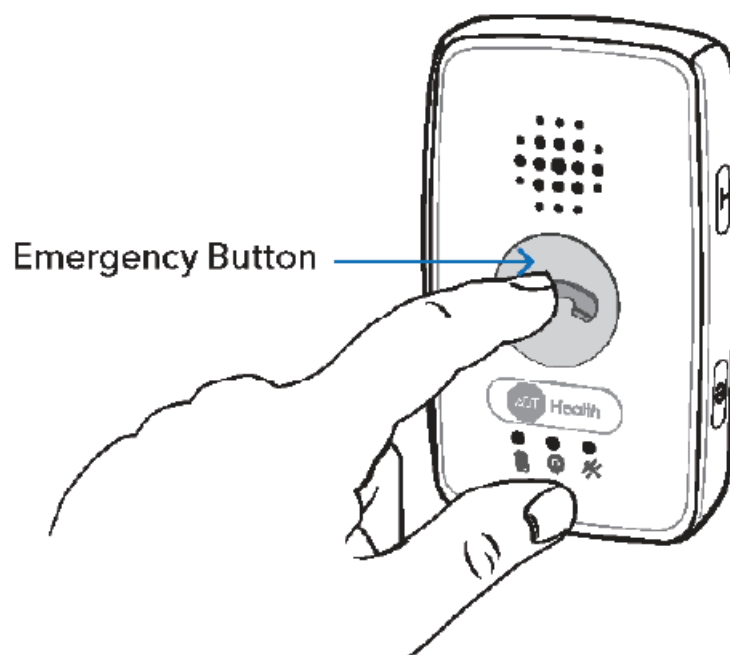

For mobile device light indicator information, please see User Guide.

Manufactured for ADT LLC dba ADT Security Services, Boca Raton FL 33431.

An ADT Medical Alert System is not an intrusion detection or medical device and does not provide medical advice, which should be secured from qualified medical personnel. Fall detection is only available on Medical Alert Plus and Mobile Emergency Response Systems. The System and Services rely on the availability of cellular network coverage to operate properly. These systems are not controlled by ADT. There is always a chance that the System may fail to operate properly. The 911 emergency services line is an alternative to the System and the Services. The Fall Detection pendant does not detect 100% of falls. If able, users should always push their Help Button when they need assistance.

©2020 ADT LLC dba ADT Security Services. All rights reserved. ADT, the ADT logo, 800.ADT.ASAP and the product/service names listed in this document are marks and/or registered marks. Unauthorized use is strictly prohibited. Third-party marks are the property of their respective owners. License information available at www.ADT.com or by calling 800.ADT.ASAP. CA ACO7155, 974443, PPO120288; FL EF0001121; LA F1639, F1640, F1643, F1654, F1655; MA 172C; NC Licensed by the Alarm Systems Licensing Board of the State of North Carolina, 7535P2, 7561P2, 7562P10, 7563P7, 7565P1, 7566P9, 7564P4; NY 12000305615; PA 090797; MS 15019511 L190348-03 07/19



Medical Alert

For assistance, call ADT Medical Alert
800-498-8512

Documents / Resources

	ADT Mobile Device 4.0 [pdf] User Manual
--	---

References

- [ADT® Security Alarm Systems for Home & Business](#)