

Adler AD 3071 Built In Toaster



Adler AD 3071 Built In Toaster User Manual

[Home](#) » [ADLER](#) » Adler AD 3071 Built In Toaster User Manual 

Contents

- 1 Adler AD 3071 Built In Toaster
- 2 Product Information
- 3 Product Usage Instructions
- 4 Cleaning and Maintenance
- 5 FAQ
- 6 Instructions
- 7 DESCRIPTION OF DEVICE
- 8 BEFORE FIRST USE
- 9 USING DEVICE
- 10 TECHNICAL DATA
- 11 Documents / Resources
 - 11.1 References



Adler AD 3071 Built In Toaster



Product Information

Specifications

- **Model:** AD 3071
- **Power Circuit:** Residue Current Device (RCD) recommended with residual current rating not more than 30 mA
- **Heating Function:** Yes
- **Thermostat Indicator Lamp:** Green

Product Usage Instructions

Safety Conditions

It is crucial to follow safety instructions for the proper use of the device:

1. Install an RCD in the power circuit for additional protection.
2. Avoid touching hot surfaces of the appliance during operation.
3. Be cautious when handling hot dishes, grease, or liquids due to high temperatures.
4. Use heat protection like gloves when touching hot surfaces.
5. Allow the device to cool down before storage.
6. Avoid placing flammable materials in the device.

Operating Instructions

7. Carefully open the device by releasing the buckle and holding the handle.
8. Avoid stretching the power cord over open flames or sharp edges.
9. Remove all packaging components before the first use.
10. Avoid covering the device during operation as heating elements take time to cool down.
11. Use insulating washers on sensitive surfaces to high temperatures.

Cleaning and Maintenance

- After use, ensure the device has cooled down before cleaning.
- Use a damp cloth to clean the exterior surfaces and avoid using abrasive cleaners that may damage the device.

FAQ

- **Q:** Can I use external schedulers with this device?
- **A:** No, the device is not designed to work with external schedulers or separate remote control systems.
- **Q:** How should I handle hot surfaces of the appliance?
- **A:** Use heat protection like gloves when handling hot surfaces and avoid touching them directly.

Instructions

SAFETY CONDITIONS IMPORTANT INSTRUCTIONS ON SAFETY OF USE PLEASE READ CAREFULLY AND KEEP FOR FUTURE REFERENCE

The warranty conditions are different if the device is used for commercial purposes.

1. Before using the product please read carefully and always comply with the following instructions. The manufacturer is not responsible for any damages due to any misuse.
2. The product is only to be used indoors. Do not use the product for any purpose that is not compatible with its application.
3. The device should only be connected to a grounded socket 220-240V ~50/60Hz. For safety reasons, it is not appropriate to connect multiple devices to one power outlet.
4. Please be cautious when using around children. Do not let the children to play with the product. Do not let children or people who do not know the device to use it without supervision.
5. **WARNING:** This device may be used by children over 8 years of age and persons with reduced physical, sensory or mental capabilities, or persons without experience or knowledge of the device, only under the supervision of a person responsible for their safety, or if they were instructed on the safe use of the device and are aware of the dangers associated with its operation. Children should not play with the device. Cleaning and maintenance of the device should not be carried out by children unless they are over 8 years of age and these activities are carried out under supervision.
6. After you are finished using the product always remember to gently remove the plug from the power outlet holding the outlet with your hand. Never pull the power cable!!!
7. Never put the power cable, the plug or the whole device into the water. Never expose the product to atmospheric conditions such as direct sunlight or rain, etc.. Never use the product in humid conditions.
8. Periodically check the power cable condition. If the power cable is damaged the product should be turned to a professional service location to be replaced in order to avoid hazardous situations.
9. Never use the product with a damaged power cable or if it was dropped or damaged in any other way or if it does not work properly. Do not try to repair the defective product yourself because it can lead to electric shock. Always turn the damaged device to a professional service location in order to repair it. All the repairs can be done only by authorized service professionals. The repair that was done incorrectly can cause hazardous situations for the user.

10. Never put the product on or close to the hot or warm surfaces or the kitchen appliances like the electric oven or gas burner.
11. Never use the product close to combustibles.
12. Do not let cord hang over edge of a counter or touch hot surfaces.
13. Never leave the product connected to the power source without supervision. Even when use is interrupted for a short time, turn it off from the network, and unplug the power.
14. In order to provide additional protection, it is recommended to install a residue current device (RCD) in the power circuit, with a residual current rating not more than 30 mA. Contact a professional electrician in this matter.
15. Accessible surface temperatures can be high when the appliance is operating. Never touch the hot surfaces of the appliance.



16. Due to the high temperature, you should be careful when removing the prepared dishes, removing hot grease or other hot liquids. Be careful, there can be hot steam present during use of the appliance.
17. This electrical appliance contains a heating function. Surfaces, also different than functional surfaces, can develop high temperatures. The equipment shall be touched only at intended handles and gripping surfaces, and use heat protection like gloves or similar. During or after use, please do not touch the baking tray or the hot area on the shell before the temperature goes down.
18. The device must cool down before you store it.
19. Do not place products made of cardboard, paper, plastic materials or other flammable or meltable objects in the device.
20. The device is not designed to work with external schedulers or a separate remote control system.
21. Do not insert food portions that use whole oven volume, as it may cause fire and destruction of the device. 4
22. The power cord may not be placed above the device and it may not touch or be located near hot surfaces. Do not place the device under a mains socket.
23. Do not move or carry the device during operation. After the operation, it can be moved only if it has enough time for cooling down.
24. Open the device by holding the handle. Before that, release the buckle (4).
25. Before and during use, make sure that the power cord is not stretched over an open flame or other heat source or sharp edges that may damage the insulation of the cable.
26. Before first use, remove all packaging components. Attention! In the case of a casing with metal parts, on these elements, a slightly visible protective foil can be stretched, which should also be removed.
27. NEVER cover the device during operation or when it does not cool down completely, remember that the heating elements of the device take time to cool down completely.
28. SAVE CAREFULLY if you use the device on surfaces sensitive to high temperatures. It is recommended then to use insulating washers
29. The device can not be used with external time switches or other separate remote control systems

DESCRIPTION OF DEVICE

1. lid
2. power indicator lamp (red)
3. thermostat indicator lamp (green)
4. closing clip

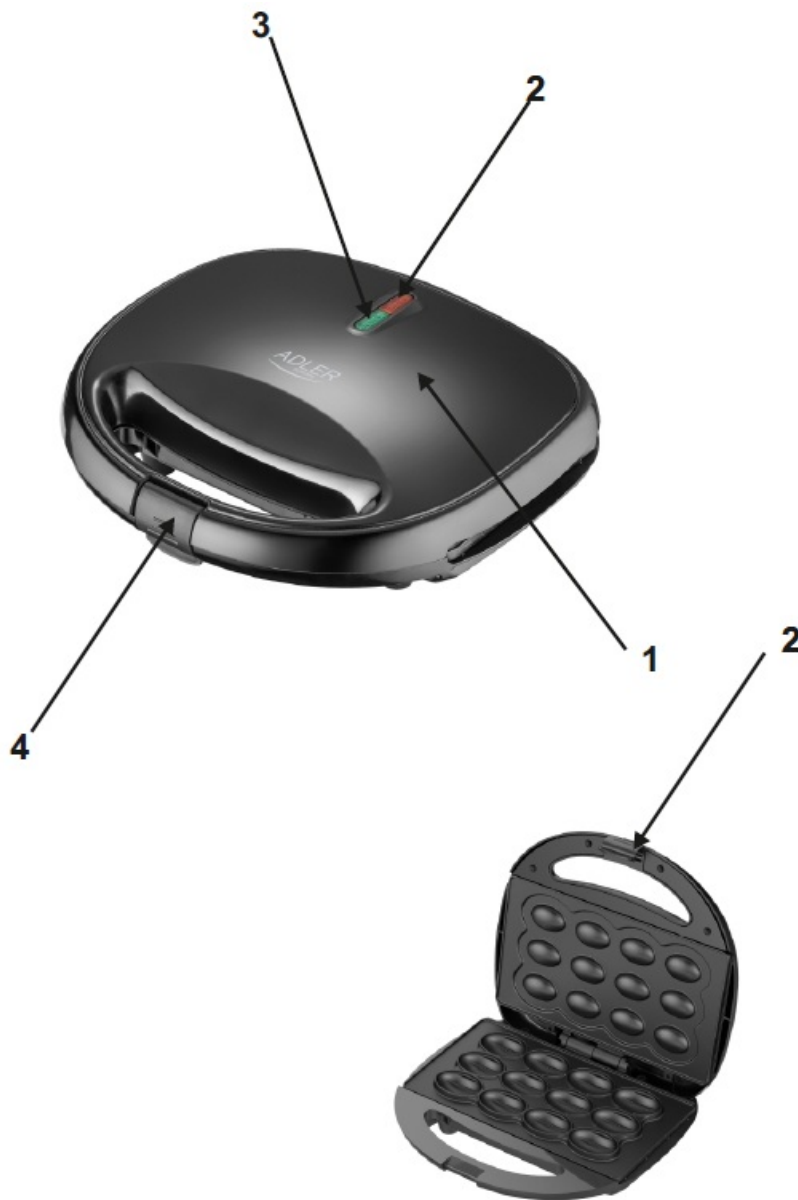

BEFORE FIRST USE

1. Remove all cartons and labels from the housing and from inside (between heating plates).
2. Wipe heating plates first with wet and next with a dry damp cloth.
3. Apply a bit of edible oil or other plant fat to the trays, and close the device to the socket with grounding, and the power and thermostat indicator lamp will light (2/3).
4. Keep the appliance running for a few minutes to get rid of the manufacturing odor. The device could emit some smoke during this time. That's normal.
5. Clean the unit according to the chapter "Cleaning".

USING DEVICE

Prepare needed products

1. Connect the closed device to the socket with grounding – the power and thermostat indicator lamp will light (2/3).

2. Wait about 10 minutes. After this time device should reach the required temperature – the thermostat indicator lamp will be off (3).
3. Fully open the device. Place the previously prepared product on the bottom heating plate
4. Close the device. Snap the closing clip (4). Do not close the lid (1) by force.
5. During operation, the thermostat indicator lamp (3) will be turned on and off, which means that the thermostat keeps the appropriate temperature of the baking trays.
6. Operation time is approximately 2 to 5 minutes and depends on type of used ingredients and taste preference.
CAUTION: During operation from the cover of the device there can be hot steam.
7. Fully open the lid (1) and remove the finished products using only wooden or plastic spatula.
ATTENTION! Do not use metal utensils or sharp kitchen tools because they can damage the special non-stick coating heating plates
8. Before cooking the next batch of products, close the device to the heating plates get hot to the proper temperature. When the thermostat indicator lamp will off (3) indicates readiness for baking.
9. When finished baking, remove the plug from the outlet and allow the unit to cool down.

CLEANING DEVICE

1. Unplug the electric plug after use and wait for it to cool down before starting cleaning.
2. Wipe heating surfaces first with wet and next with dry damp cloth (you can also use a paper towel).
3. Hardest to clean dough rests grease with oil and leave this like that. After a few minutes remove this rests with wood paddle gently.
4. Please do not use any metal nor hard abrasive tool to wipe the interior/exterior of the machine body to avoid scraping the surface of the tray.
5. Do not immerse in water.

TECHNICAL DATA

- **Power supply:** 220-240V ~50/60Hz
- **Power Nom.:** 750W
- **Max power:** 1200W

To protect your environment: please separate carton boxes and plastic PE bags and dispose of them in corresponding waste bins. Used appliances should be delivered to the dedicated collecting points due to hazardous components, which may affect the environment. Electrical appliances must be returned to reduce its reuse and utilization. If the device contains batteries they should be delivered to dedicated points separately.



MODELS



AIR COOLER
AD 7913



FOOT SPA
AD 2177



HAIR CLIPPER
AD 2831



HAIR DRYER
AD 2265



HEATED PAD
AD 7412



CERAMIC FAN HEATER
AD 7731



OIL-FILLER RADIATOR
AD 7811



KITCHEN SCALE
AD 3171



CHOCOLATE FOUNTAIN
AD 4487



HAND BLENDER
AD 4617



LINT REMOVER
AD 9616



VACUUM CLEANER
AD 7044



MEAT MINCER
AD 4811



Blender
AD 4078



ELECTRIC GRILL
AD 6610



ELECTRIC KETTLE
AD 1293

AFTER-SALE SERVICE NOTICE

- If you want to buy spare parts or make any complaints, please contact the seller who issued the receipt directly.

WWW.ADLEREUROPE.EU

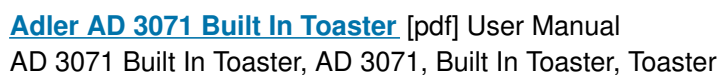

- User Manual

This website is an independent publication and is neither affiliated with nor endorsed by any of the trademark owners. The "Bluetooth®" word mark and logos are registered trademarks owned by Bluetooth SIG, Inc. The "Wi-Fi®" word mark and logos are registered trademarks owned by the Wi-Fi Alliance. Any use of these marks on this website does not imply any affiliation with or endorsement.