

# ADJUST-A-GATE G-3 Rail DD Original Double Drive Gate Full Frame Gate Kits Installation Guide

[Home](#) » [ADJUST-A-GATE](#) » ADJUST-A-GATE G-3 Rail DD Original Double Drive Gate Full Frame Gate Kits Installation Guide 

## Contents

- [1 ADJUST-A-GATE G-3 Rail DD Original Double Drive Gate Full Frame Gate Kits](#)
- [2 Product Information](#)
- [3 Product Usage Instructions](#)
- [4 PARTS](#)
- [5 GETTING READY TO ASSEMBLE YOUR GATE KIT](#)
- [6 BEGIN INSTALLATION](#)
- [7 ATTACHING YOUR BOARDS](#)
- [8 Documents / Resources](#)
  - [8.1 References](#)
- [9 Related Posts](#)



**ADJUST-A-GATE G-3 Rail DD Original Double Drive Gate Full Frame Gate Kits**

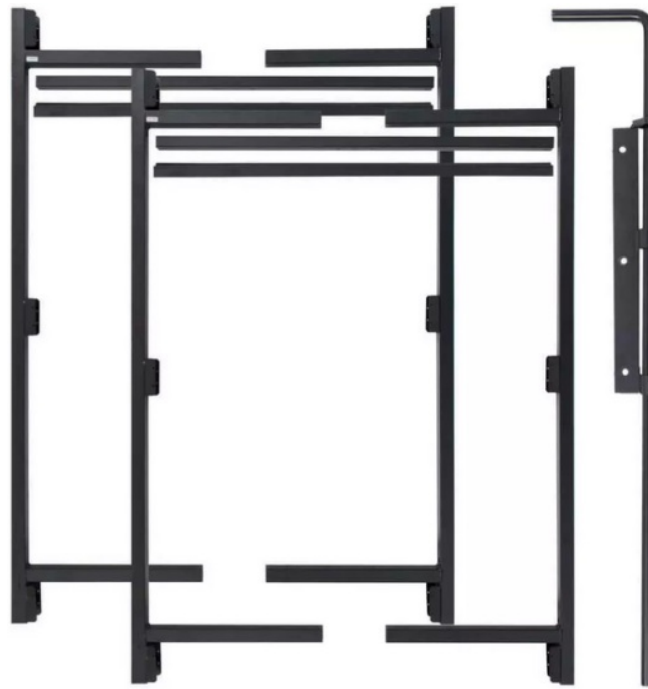

## Product Information

### Specifications:

- Assembly Time: Approximately 45-90 minutes for gate framing
- Skill Level: Easy
- Wood Requirement: 2×4's and wood not included
- Design: Patented design for inward opening gates

## Product Usage Instructions

### Getting Ready to Assemble Your Gate Kit

Familiarize yourself with the gate hardware, frames, and instructions. Ensure the concave side of spreader bars faces down.

### Installation for Inward Opening Gates

If your gate needs to open inward, follow the provided instructions. Adjust the placement of POST HINGES if needed.

### Double Drive Gates Installation

For double drive gates, use two gate kits. Ensure correct alignment of latch catch with striker bar. Space between double gates should be 1 inch.

### Security Precaution

To prevent theft, install HINGE (E) with the pin facing down and the bottom pin facing up to lock the frame into itself.

## Begin Installation

### POST HINGE (E) Installation

1. Locate the center point on your post.

2. Measure up and down 20 units to find the center point for each POST HINGE BRACKET (E).
3. Attach brackets using 2 WOOD SCREWS (J).

### **FRAME HINGES (D) Installation**

1. Loosely attach FRAME HINGES (D) to the HINGE SIDE of the GATE FRAME (A).
2. Slide the BOTTOM FRAME HINGE (D) into position onto the BOTTOM POST HINGE (E) and tighten bolt.

### **FAQ**

- **Q: What should I do if my gate needs to open outward?**

A: For outward opening gates, adjust the placement of POST HINGES accordingly. Additional modifications may be required for outward swinging gates.

- **Q: How do I install a double-drive gate?**

A: Use two gate kits for double-drive gates. Follow the provided instructions for correct alignment and latch installation.

### **IMPORTANT**

Posts, 2×4's and wood are NOT INCLUDED. You must provide the wood to match your fence application.

### **STOP**

DO NOT ASSEMBLE WITHOUT READING AND FULLY UNDERSTANDING THESE INSTRUCTIONS

**CAUTION:** PLEASE WEAR WORK GLOVES, CLOSED-TOE SHOES, AND EYE PROTECTION

### **What to expect for assembly**

Approximately 45-90 minutes for gate framing. Additional time required for customizations, staining, and finishing.  
One or two person installation Skill and experience level: EASY

View or step-by-step installation video.



### **PATENTED DESIGN**

### **PARTS**

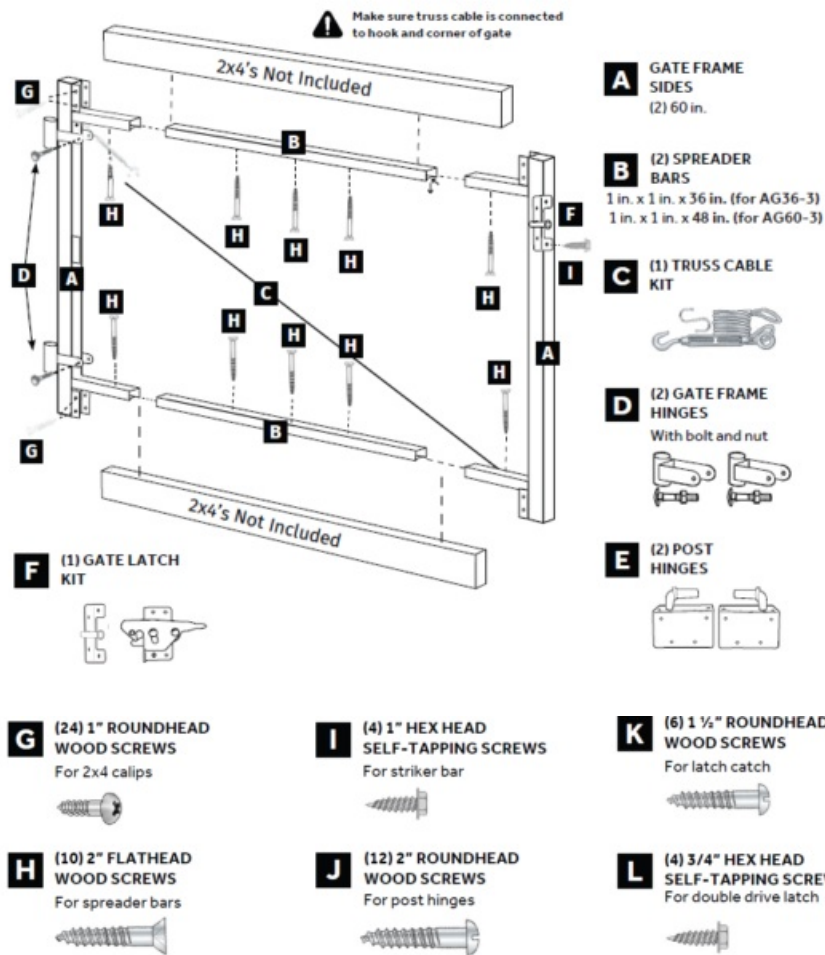

## TOOLS REQUIRED



Adjustable Wrench  
OR 9/16 Wrench



Phillips & Flat  
Screwdriver



Wire  
Cutters



Power Drill with  
5/16 Nut Driver



Hacksaw  
(Gates Under 41')

## GETTING READY TO ASSEMBLE YOUR GATE KIT

Familiarize yourself with the gate hardware/ frames and instructions.

**NOTE:** concave side of spreader bars faces down.

This frame is designed to open INWARD (into your fenced area), if your application calls for an OUTWARD opening you can adjust the placement of the POST HINGES to the opposite side of the post. Additional modifications may be needed for outward swinging gates. For double drive gates openings installations, use two gate kits. The gates will assemble the same way, just reversed. For the latch installation on a double-drive gate, first attach the STRIKER BAR, bring both gates together and line up the LATCH CATCH with the striker bar for correct alignment to gate frame and attach. Suggested space between double gates is 1 inch. For double-drive gates UL301 drop rod kits are highly recommended (sold separately).

As a Security precaution – Installing HINGE (E) with the pin facing down and the bottom pin facing up will help prevent the potential theft by locking the frame into itself. Make sure all 4x4 posts and 2x4 rails are straight (bowing or crooked 4x4 & 2x4's may make the Adjust-A-Gate® out of alignment). If cutting the spreader bars spray all cut ends with a Rust Oleum® type product to prevent rusting.

## BEGIN INSTALLATION

### POST HINGE (E) INSTALLATION

- A) Locate the CENTER POINT top to bottom) on your POST.
- B) Measure up 20" and down 20" to find the CENTER POINT for each POST HINGE BRACKET (E).
- C) Position POST HINGE BRACKETS J-BOLTS point toward the center point and the hinge plates are on the inside, gate swinging side of the post. Attach brackets using 2" WOOD SCREWS (J).



**NOTE:** for best results this Adjust-A-Gate® is designed to open inward but can be modified to open outward by placing the hinges on the opposite side of the post.

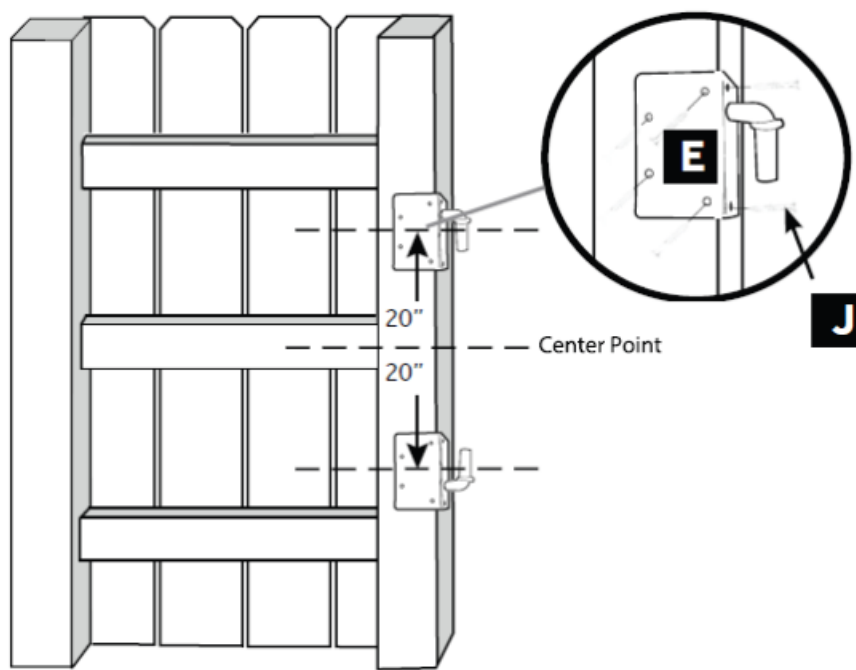

### POST HINGE (E) INSTALLATION

- A) Loosely attach the FRAME HINGES (D) to the HINGE SIDE of the GATE FRAME (A) – remember that the pre-drilled hole for the truss cable is located at top inside of this frame piece. Slide the BOTTOM FRAME HINGE (D) into position onto the BOTTOM POST HINGE (E), tighten bolt. Slide the TOP FRAME HINGE (D) into position onto the TOP POST HINGE (E), tighten bolt.
- B) Insert the SPREADER BARS (B) into slip member on the gate frame as shown.
- C) If your gate opening requires your gate frame to be narrower than standard, you will need to cut (equal amounts of each end of SPREADER BARS (B)) to accomplish the needed size.

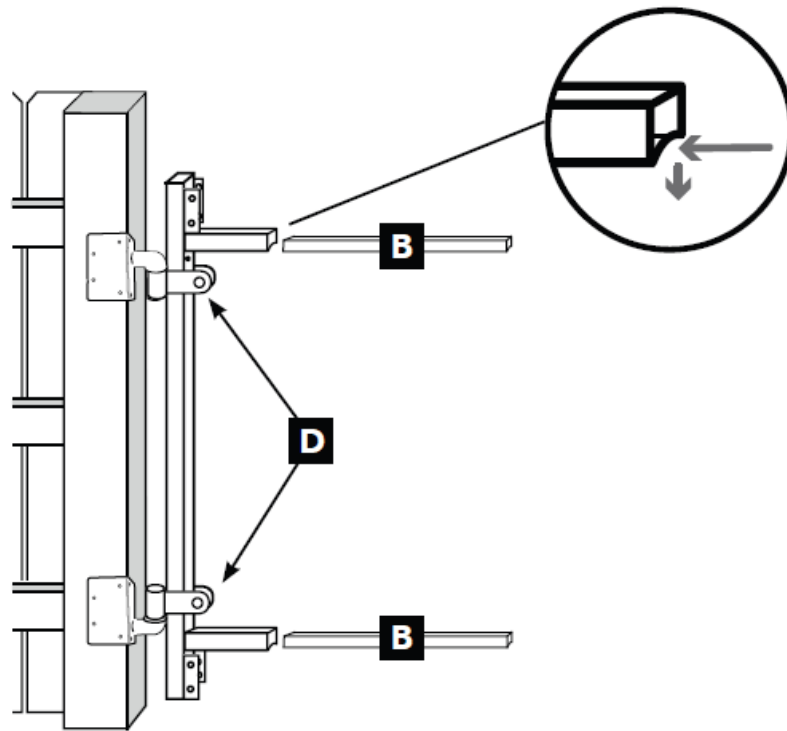

## 2B ) LATCH SIDE OF FRAME (A) INSTALLATION

Carefully add the LATCH SIDE OF THE FRAME (A). Now, carefully (at this point the frame is still loose) extend the gate frame to within 1 inch of the post where the latch will be attached. Now measure the distance between the plates where the 2x4's will attach (top and bottom of frame), cut 2x4's and attach using 1 INCH ROUNDHEAD WOOD SCREWS (G) for the plates, and 2 INCH FLATHEAD WOOD SCREWS (H) for the spreader bars.

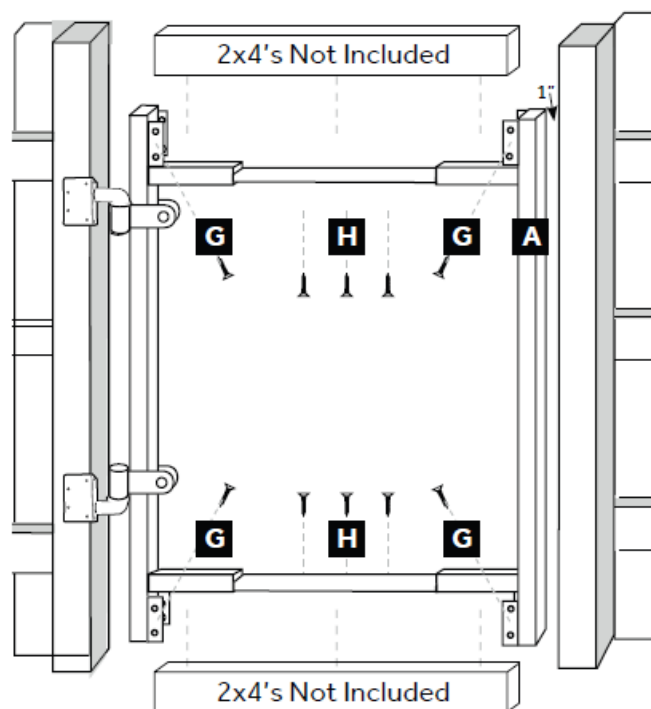

**NOTE:** Depending on the width of your gate, you may not need all of the 2 inch wood screws, it is not necessary to have a screw in every hole. Because it is an adjustable frame, not all the pre-drilled holes on the spreader bars and vertical frame sides will line up.

## TRUSS CABLE AND GATE LATCH INSTALLATION

Be sure to loosen the TURNBUCKLE to its widest opening prior to assembly. Assemble TRUSS CABLE as shown. Slide the "S" HOOK of the TRUSS CABLE KIT (C) into the hole at the lower corner of the latch side of the gate frame. Hook the TURNBUCKLE into the hole at the opposite top corner on the hinge side of the frame. Form a

loop on the loose end of the cable, thread through the CABLE CLAMP, slip that loop onto the “S” HOOK and pull cable tight, secure with clamp, cut off any excess. Attach STRIKER BAR from the GATE LATCH KIT (F) to the inside gate frame at the desired height use the 4 HEX HEAD SELF-TAPPING SCREWS (I). Align the LATCH with the STRIKER BAR and attach to post using 1.5 INCH ROUNDHEAD WOOD SCREWS (K). By adjusting the TURNBUCKLE you can fine tune the gate latch to give a perfect fit.

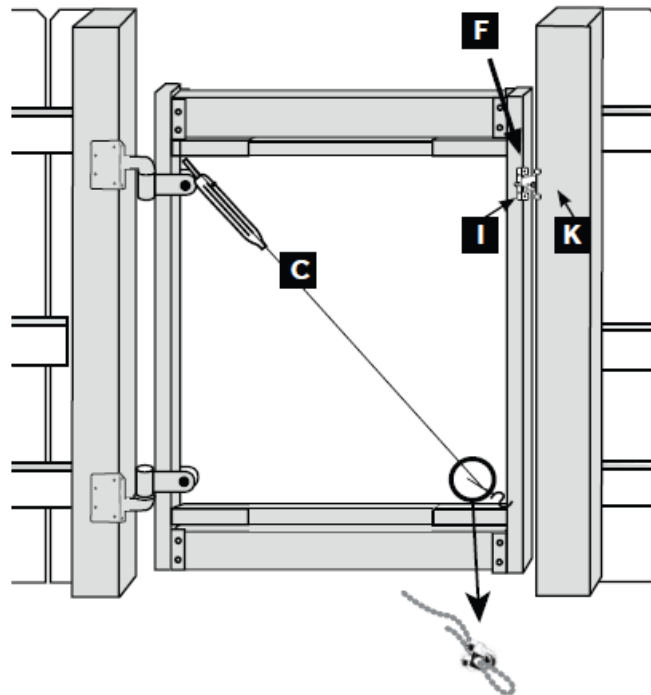

## ATTACHING YOUR BOARDS

**TIP:** To hide the gap on the HINGE SIDE of the gate, you may overlap your fence board to cover this gap.

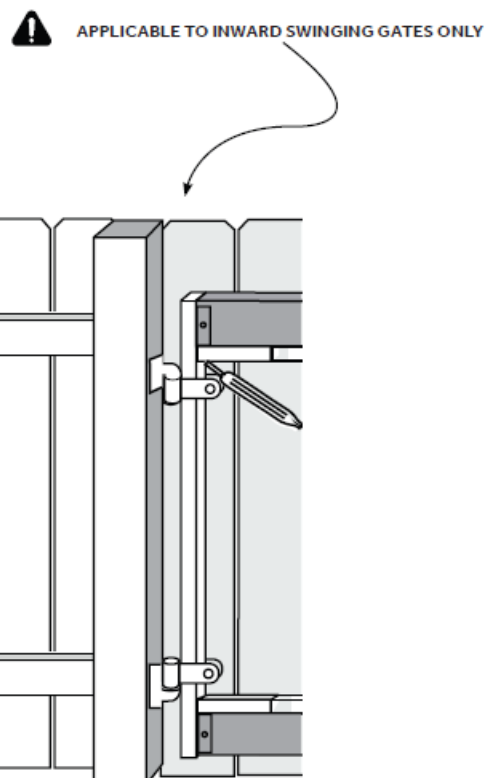

**TIP:** It is recommended that your gate boards be cut 2" shorter than the fence boards to allow the top of your gate to be even with the fence and allow clearance under the gate.

Now you can attach the rest of your boards onto the 2×4's on the gate using nails or screws. By adjusting the turnbuckle on the truss cable you can fine tune the gate.

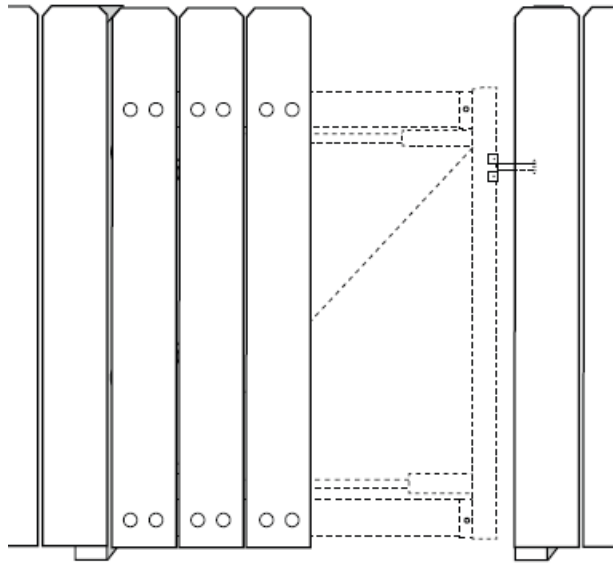

#### FOR LATCH CATCH ASSEMBLY FOR DOUBLE DRIVE GATES

Please view our Adjust-A-Gate Fit Right Drop Rod Kit for Double Drive Gates instructions. These can be found on the package or by visiting [jewettcameronfence.com](http://jewettcameronfence.com) product page.

© Jewett Cameron Co. All Rights Reserved. For the latest product updates and instructions please visit [jewettcameronfence.com](http://jewettcameronfence.com) or contact us.

[800-955-2879](tel:800-955-2879) | [info@jewettcameron.com](mailto:info@jewettcameron.com) | [jewettcameronfence.com](http://jewettcameronfence.com)

#### Documents / Resources

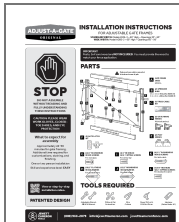

[ADJUST-A-GATE G-3 Rail DD Original Double Drive Gate Full Frame Gate Kits](#) [pdf] Installation Guide

AG-3 Rail DD, AG36\_3, AG60\_3, G-3 Rail DD Original Double Drive Gate Full Frame Gate Kits, G-3 Rail DD, Original Double Drive Gate Full Frame Gate Kits, Double Drive Gate Full Frame Gate Kits, Drive Gate Full Frame Gate Kits, Gate Full Frame Gate Kits, Full Frame Gate Kits, Frame Gate Kits, Gate Kits, Kits

#### References

- [Jewett Cameron Fence | Adjust-a-Gate® | Lifetime Steel Post®](#)
- [User Manual](#)

[Manuals+](#), [Privacy Policy](#)

This website is an independent publication and is neither affiliated with nor endorsed by any of the trademark owners. The "Bluetooth®" word mark and logos are registered trademarks owned by Bluetooth SIG, Inc. The "Wi-Fi®" word mark and logos are registered trademarks owned by the Wi-Fi Alliance. Any use of these marks on this website does not imply any affiliation with or endorsement.