

Addlon SOLAR STRING LIGHT



addlon SOLAR STRING LIGHT USER MANUAL

[Home](#) » [Support](#) » addlon SOLAR STRING LIGHT USER MANUAL 

Contents

- 1 Addlon SOLAR STRING LIGHT
- 2 SAFETY INSTRUCTION
- 3 Installation Steps
- 4 Attention to solar panels
- 5 PRODUCT PARAMETERS
- 6 COMMON TROUBLESHOOTING
- 7 CUSTOMER SERVICE
- 8 CONTACT US
- 9 FAQs
- 10 Video-addlon SOLAR STRING LIGHT
- 11 References
- 12 Related Posts

Addlon

Addlon SOLAR STRING LIGHT



SAFETY INSTRUCTION

ATTENTION

1. Please turn on the switch and cover the solar panel to check whether all the bulbs are on normally. If not, please contact us.
2. Please keep the solar panel away from the bulbs or other light sources, otherwise the bulbs will not automatically light up or flicker at night.
3. Before using for the first time, please use USB to charge for 8 hours or place in direct sunlight to charge for 1 day.
4. If using the remote control, the dust-to-down function of the solar lamp will be disabled. Keep snow and debris clear of the solar panel, for the battery to recharge efficiently.

VIDEO



Need a more detailed guide?

Please visit the QR code for Installation Video If the QR code is broken, please contact us for the video.

Installation Steps

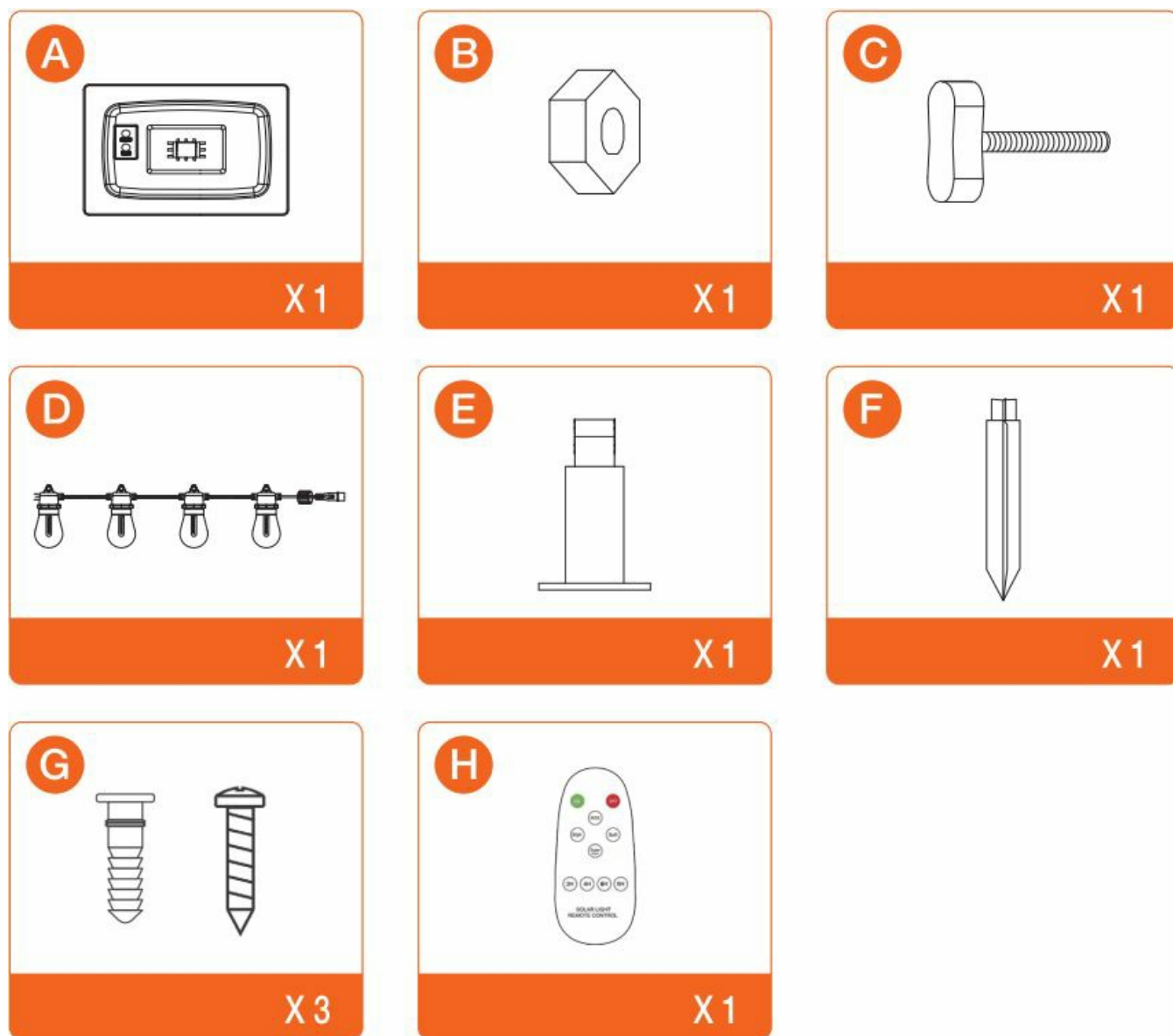

Before beginning installation of the product, make sure all parts are present. If any part is missing or damaged. do not attempt to install the product, The estimated Installation time' is 10 minutes. No Tools Required For Installation.

1. please plug the base E into the fastener back Of the solar panel A.

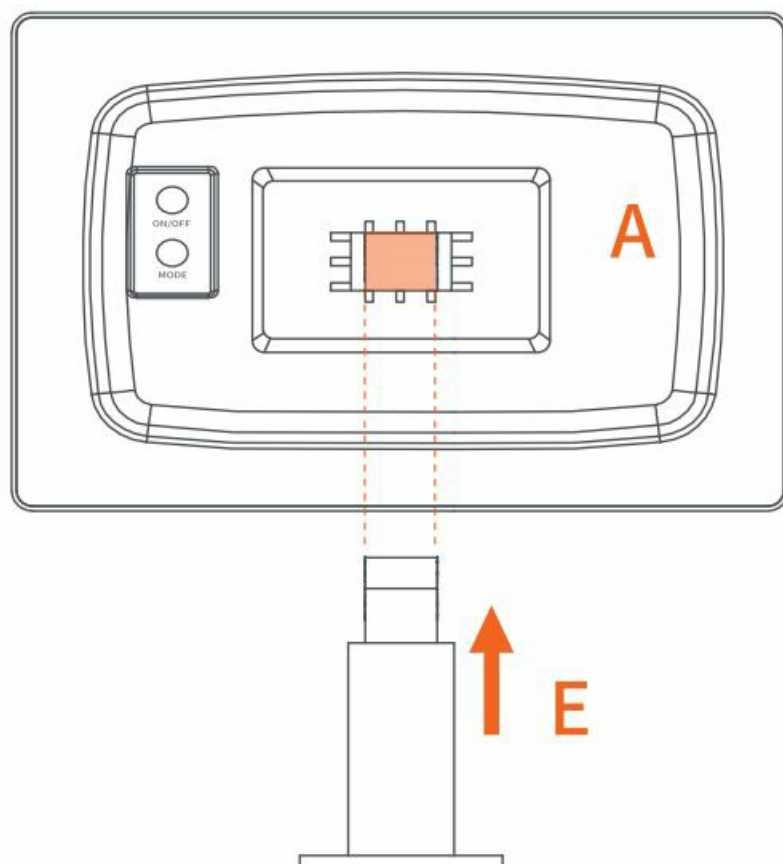

2. Place the nut B in the groove on one side of the fastener.

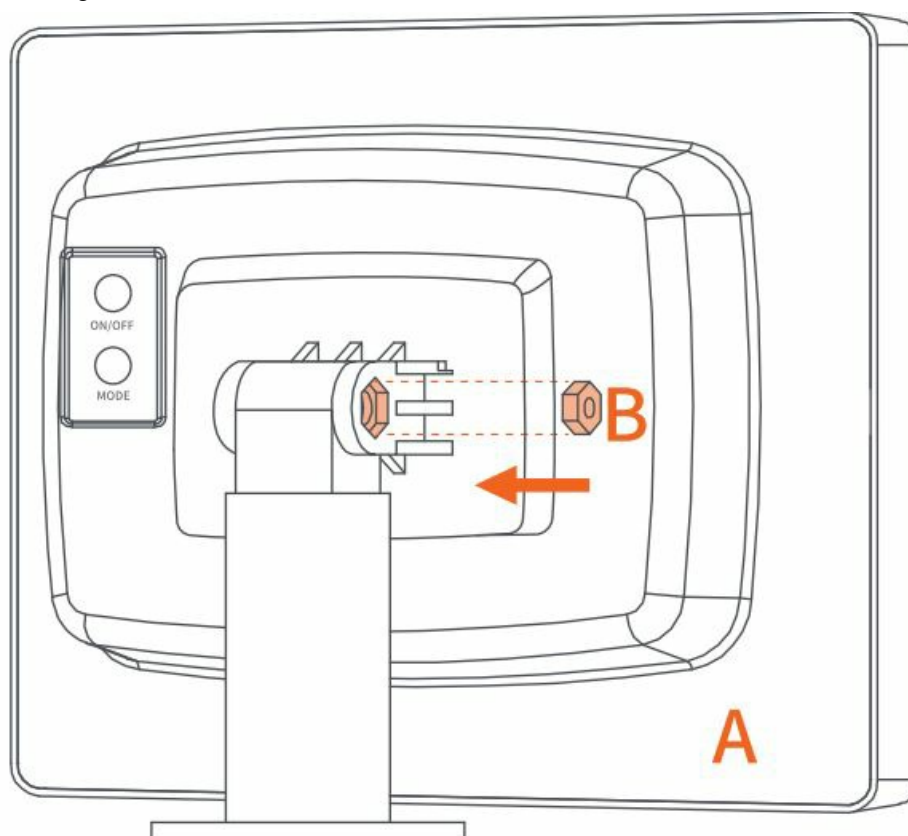

3. Insert studs on the other side C and tighten.

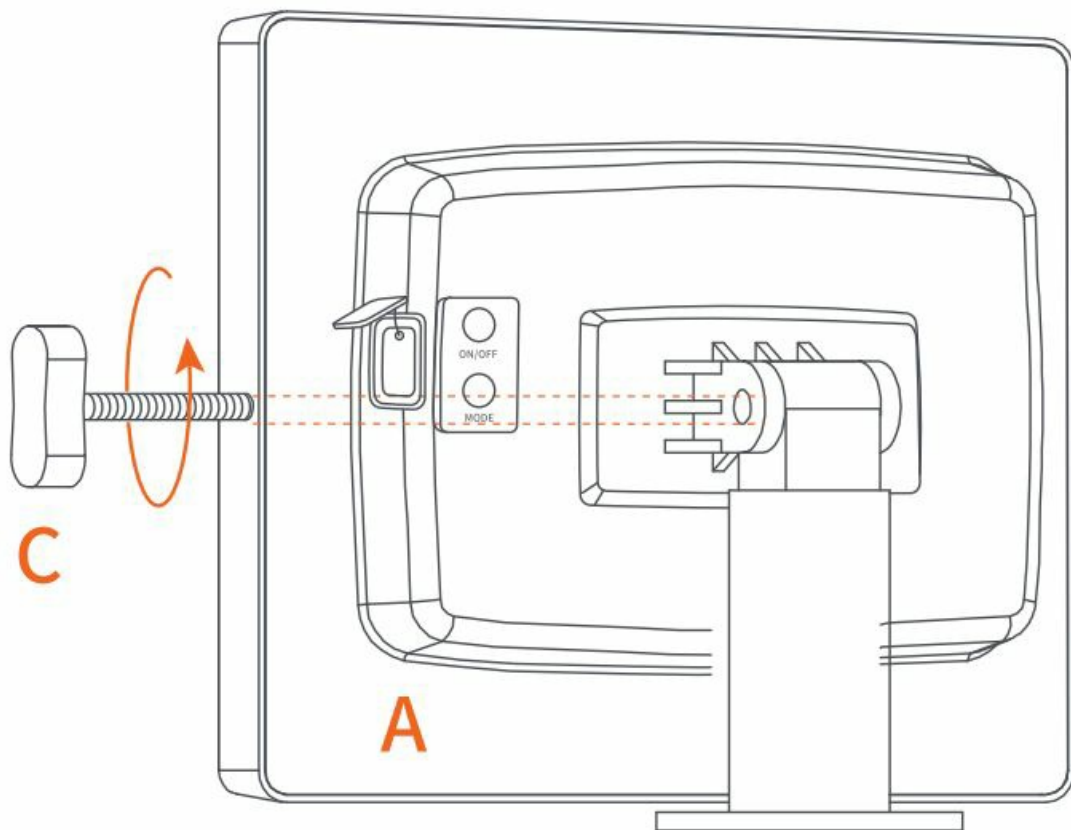

4. Connect the string light D With the solar panel A.

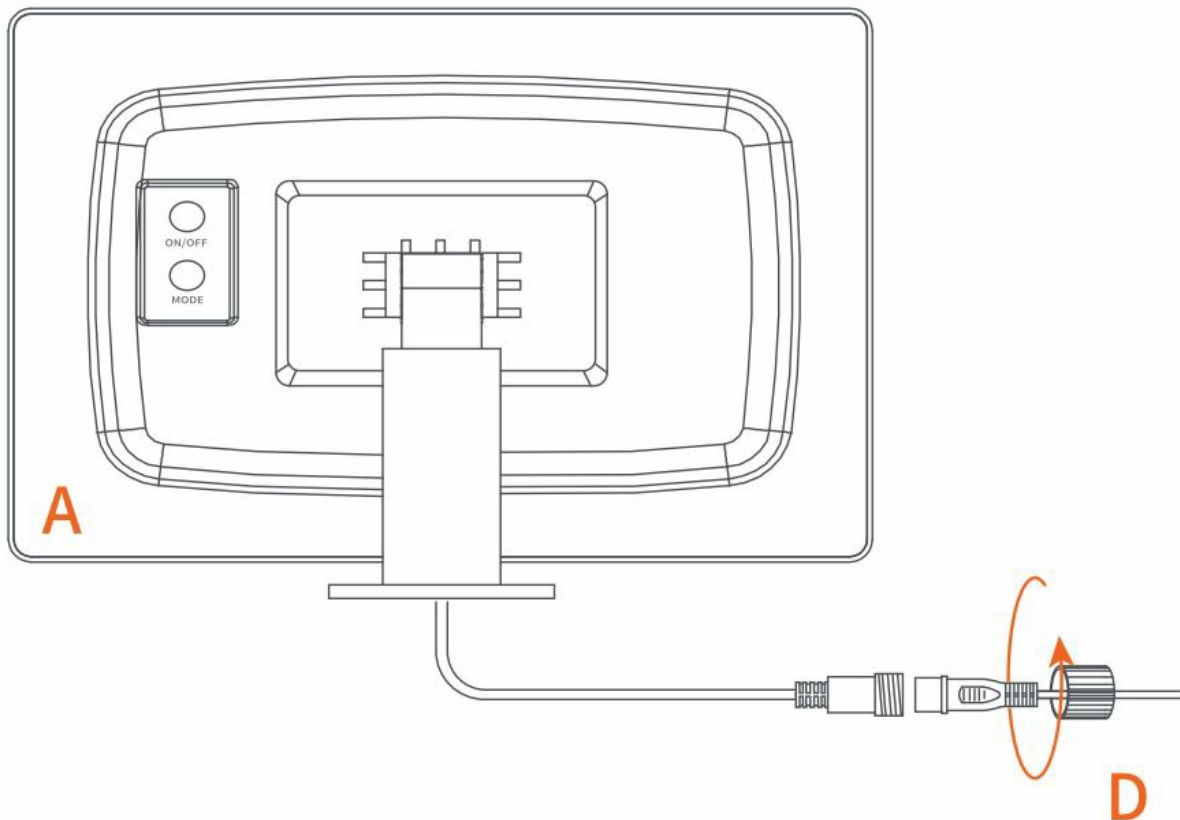

5. Press the button as shown in the figure, and then cover the solar panel to test whether the string light can normally lit.

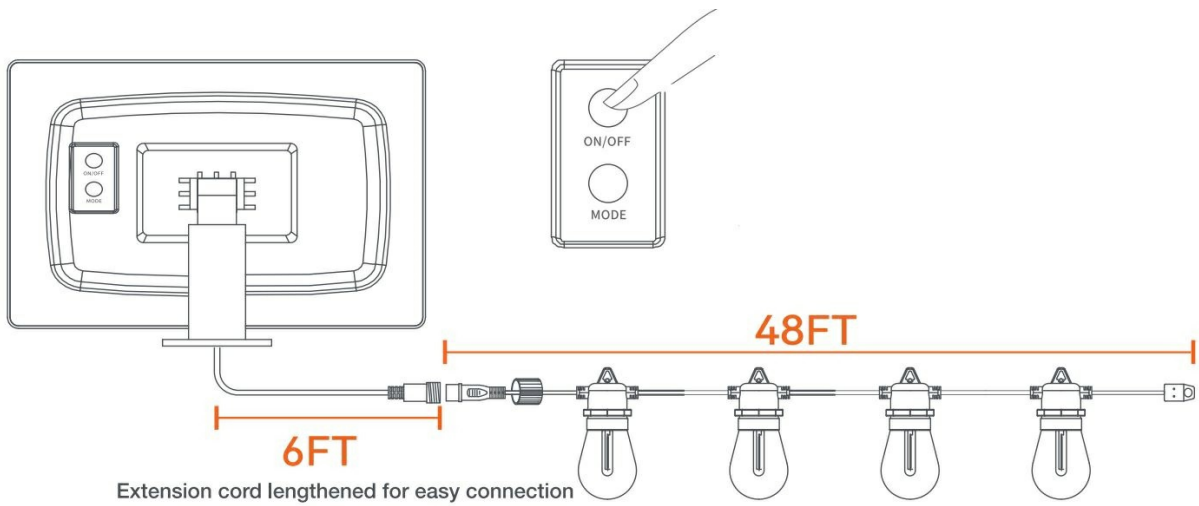

6.

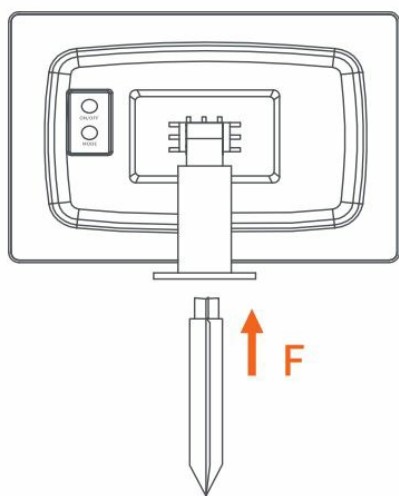

OR

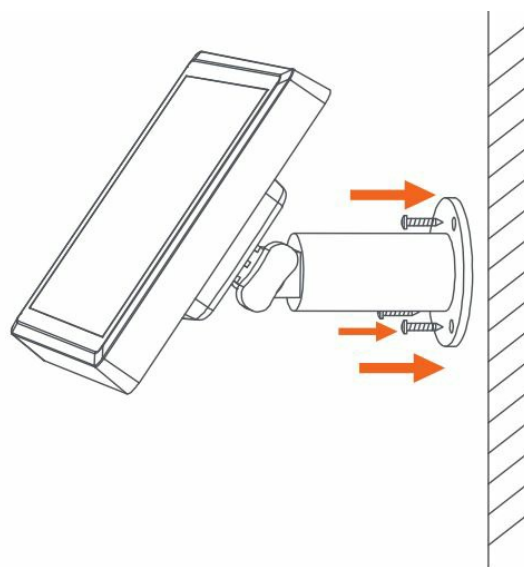

7.

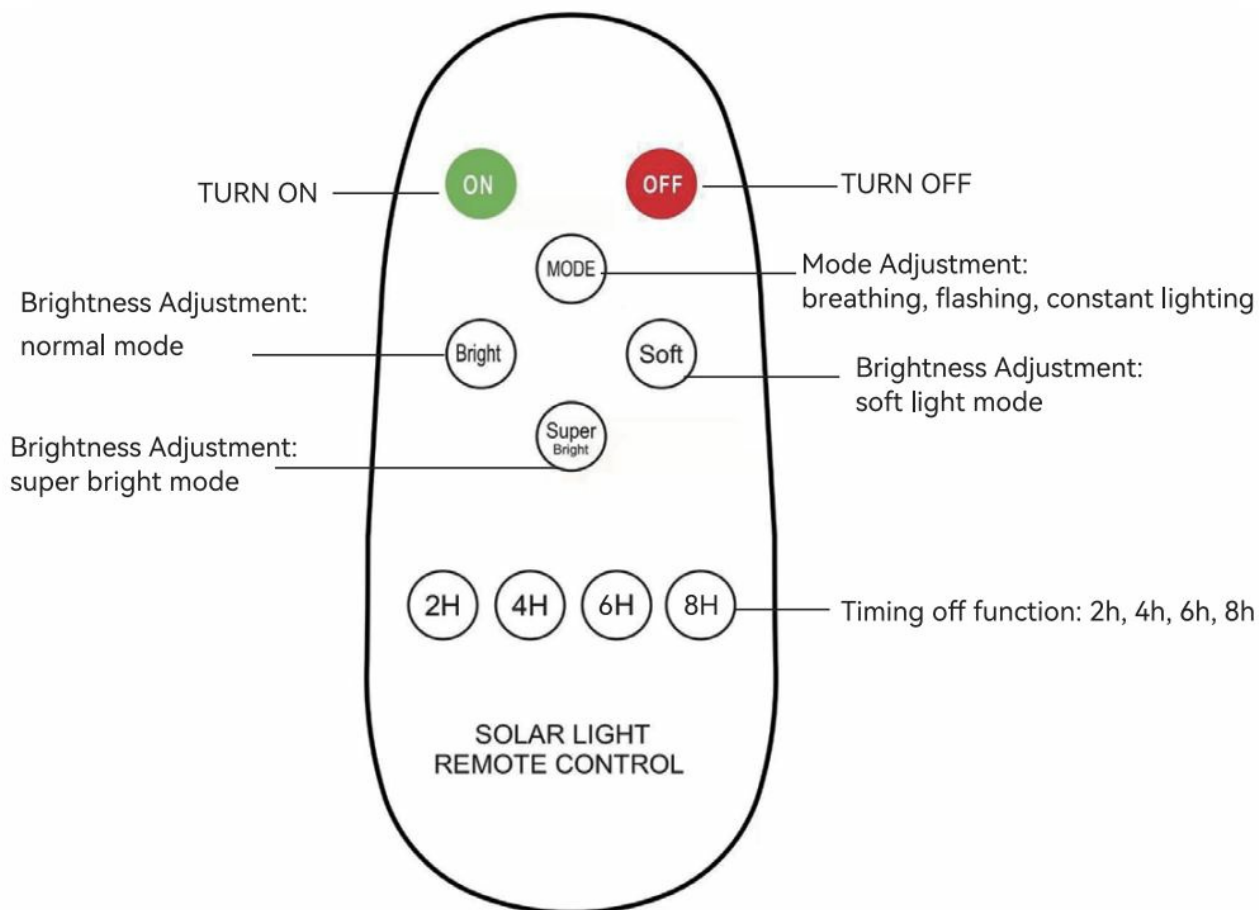
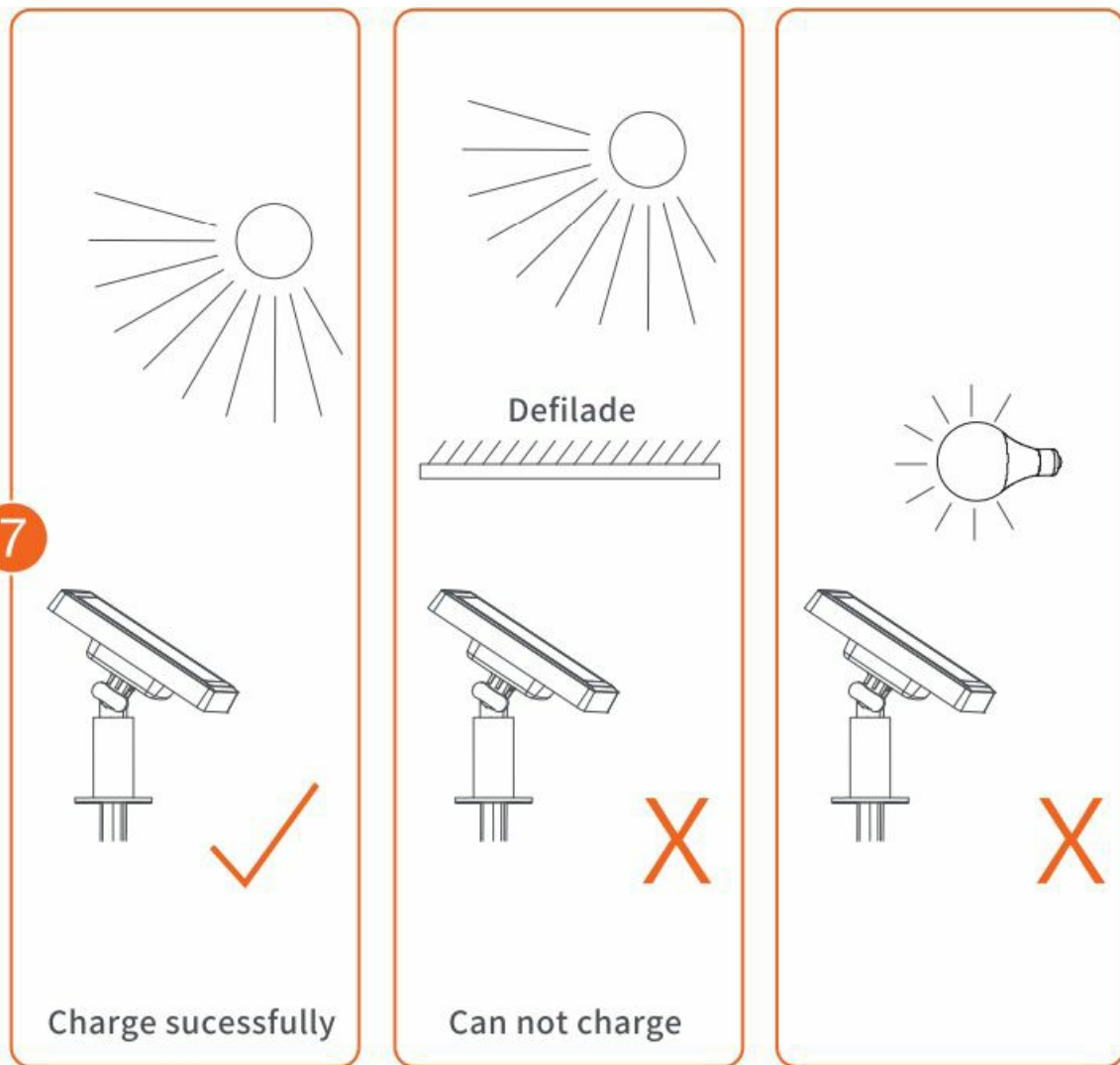

Attention to solar panels

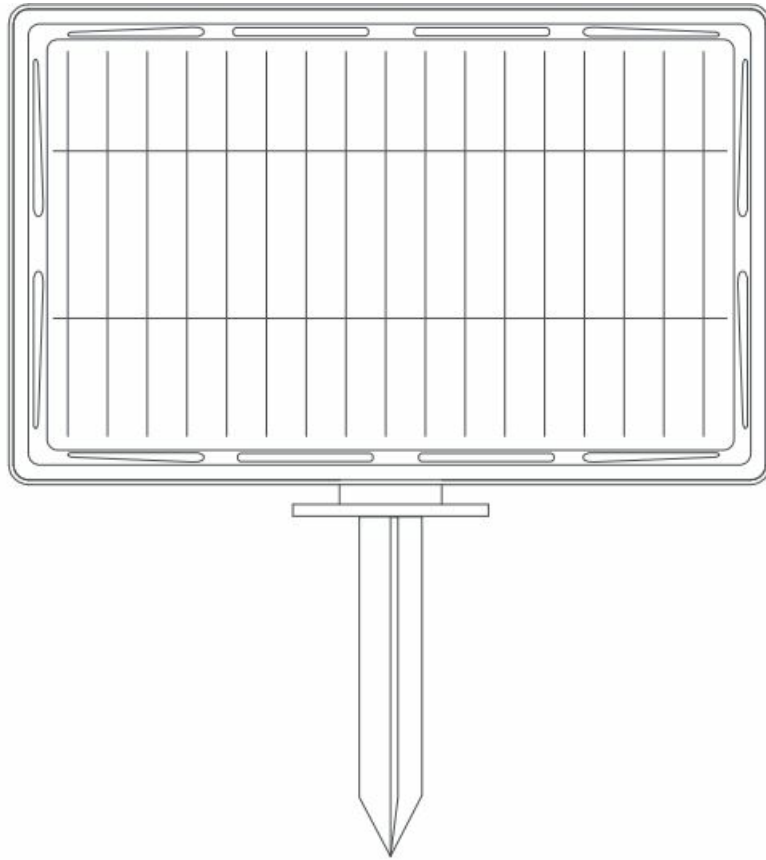

1. Please turn on the switch and cover the solar panel to check whether all the bulbs are on normally.
2. Please keep the solar panel away from the bulbs or other light sources, otherwise .
3. Before using for the first time, please use USB to charge for 8 hours or place in direct sunlight to charge for 1 day.
4. If using the remote control, the dust-to-down function of the solar lamp will be disabled.

PRODUCT PARAMETERS

Product Information

- **Material:** Metal + Plastic
- **Package Contents:** String Light / Bulb / Instruction Manual / Solar panels

Specifications

- **Voltage:** 5.5V
- **Lamp Hdder:** E12

Product Life

- **AverageLife(hours):** 8000h
- **Warranty:** 1 year

COMMON TROUBLESHOOTING

Probleme and Countermeaguree

Problem	Probable Cause	Solution
Not bright	The battery was empty due to long cloudy days	Please charge it in full sunlight or USB
Short lighting time	Power switch was off	Turn on the switch
Flickering	The connection cable was not in contact	Please tighten the plug
Other problems	The solar panel was shaded	Remove the cover
	The solar panel was too close to the light	Stay away from light
		Please contact us

CUSTOMER SERVICE

- **30-Day Return Policy**

If you're not completely satisfied with your purchase, simply return the merchandise via Amazon Orders. Unused merchandise can be refunded or exchanged within 30 days from the original purchase date.

- **1-Year Warranty**

We guarantee your product is free from defects in product material and workmanship for one (1) year starting from the date of purchase during normal use Of household conditions. If your appliance fails to operate properly within our warranty period, we will arrange a new replacement free of charge and cover all the shipping costs.

- **Quick Response within 12 Hours**

If you are still unable to resolve the issue you are experiencing, please contact us immediately at our support email. It doesn't matter if the product has been installed, our customer support team will respond within 12 hours and assist you quickly and efficiently The most efficient way to confirm your problem to us is to attach a video illustrating your product issue.

CONTACT US

1. Log into your [Amazon.com](https://www.amazon.com) account, click "Returns&Orders" on the top-right corner.

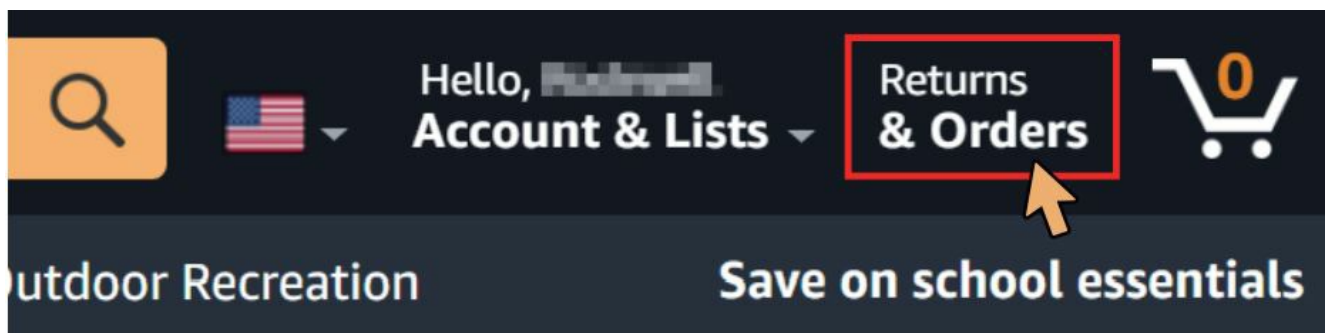

2. Find your order in the list and click "View order details".

ORDER # 111-1111111-1111111

[View order details](#)

[View invoice](#)

[Track package](#)

3. Click the “store name” following the Sold by, below the product title.

Delivered yesterday

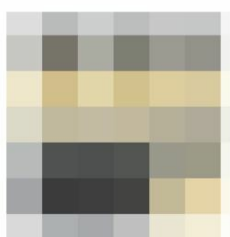

Sold by:

Serial Numbers:

AZ: [redacted]

Return eligible through Sep 8, 2021

\$49.99

4. Click the yellow button “Ask a question”, on the top-right corner, to contact the seller.

[Livestreams](#)

[Outdoor Recreation](#)

[Save on school essentials](#)

Have a question for [redacted]

[Ask a question](#)

Should you experience any issues while operating any of our products, you can directly reach out to our Customer Support via Amazon Orders. Or you can send your inquiry to our Official Customer Support at:

- **Call us:** Monday – Friday from 9:00AM – 5:00PM (PT)
- **Contact via Email:** support@addlonlighting.com

Should you experience any issues while operating any of our products, you can directly reach out to our Customer

Support via Amazon Orders or you can send your inquiry to Our Official Customer Support at:

support@addlonlighting.com

S +1 (626)328-6250

Monday – Friday from 9:00 AM- 5:00PM (PT)

MADE IN CHINA

FAQs

What are the charging options for the Addlon Solar String Lights?

The Addlon Solar String Lights can be charged using solar energy or via USB, providing flexibility in various lighting conditions.

How long are the Addlon Solar String Lights?

The Addlon Solar String Lights are 54 feet long, which includes a 6-foot lead cable for easy setup and connection.

What are the different lighting modes available with the Addlon Solar String Lights?

The Addlon Solar String Lights feature three light modes: Breathing, Flashing, and Constant, which can be controlled via the included remote.

How easy is the installation process for the addlon SOLAR STRING LIGHT?

The installation of the addlon SOLAR STRING LIGHT is reported to be straightforward, requiring only the placement of the solar panel in a sunny location and hanging or draping the string lights as desired.

Does the addlon SOLAR STRING LIGHT have any automatic features?

The addlon SOLAR STRING LIGHT features an automatic on/off function that turns the lights on at dusk and off at dawn, providing convenient hands-free operation.

How energy-efficient are the Addlon Solar String Lights?

The Addlon Solar String Lights are highly energy-efficient due to their LED bulbs and solar charging capability, which minimizes environmental impact while saving on energy costs.

How do the timer settings work on the Addlon Solar String Lights?

The remote control for the Addlon Solar String Lights includes options to set a timer for 2, 4, 6, or 8 hours of operation, allowing for automatic shut-off based on your preferences.

How long is the warranty for the addlon SOLAR STRING LIGHT?

The addlon SOLAR STRING LIGHT comes with a 2-year manufacturer's warranty, covering any defects in materials or workmanship.

How long is the string and how many lights does it include?

The Addlon Solar String Lights feature a 54-foot string with 16 LED bulbs, ideal for extensive coverage in outdoor settings.

What is the color temperature of the Addlon Solar String Lights?

The Addlon Solar String Lights emit a warm white light at 2700 Kelvin, creating a cozy and inviting atmosphere.

How does the remote control work with Addlon Solar String Lights?

The remote control can adjust light settings from a distance, including turning the lights on/off, changing brightness levels, and setting the timer.

What is the dimension of Addlon Solar String Lights?

The Addlon Solar String Lights have a total length of 54 feet, which includes a 6-foot lead cable. This length provides ample coverage for various outdoor setups. The packaging dimensions for the product are 9.79 x 7.45 x 6.39 inches, which gives you an idea about the size of the box in which they come.

Video-addlon SOLAR STRING LIGHT

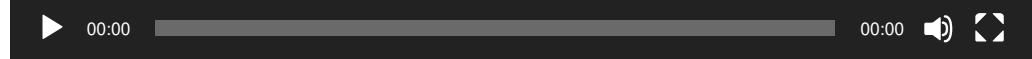

[Download this Manual mp-content/uploads/2024/04/addlon-SOLAR-STRING-LIGHT.mp4](#)

[addlon SOLAR STRING LIGHT USER MANUAL](#)

References

- [User Manual](#)

[Manuals+](#), [Privacy Policy](#)

This website is an independent publication and is neither affiliated with nor endorsed by any of the trademark owners. The "Bluetooth®" word mark and logos are registered trademarks owned by Bluetooth SIG, Inc. The "Wi-Fi®" word mark and logos are registered trademarks owned by the Wi-Fi Alliance. Any use of these marks on this website does not imply any affiliation with or endorsement.