



ADATA TurboHDD USB II HM800 External Hard Drive User Guide

[Home](#) » [ADATA](#) » ADATA TurboHDD USB II HM800 External Hard Drive User Guide 

Contents

- [1 ADATA TurboHDD USB II HM800 External Hard Drive](#)
- [2 Product Information](#)
- [3 Product Introduction](#)
- [4 Revision History](#)
- [5 Copyright](#)
- [6 DISCLAIMER](#)
- [7 User Notice](#)
- [8 System Requirements](#)
- [9 Install software](#)
- [10 Input the Serial Number](#)
- [11 Start the software](#)
- [12 Software problem](#)
- [13 Turbo](#)
- [14 References](#)
- [15 Documents / Resources](#)
 - [15.1 References](#)
- [16 Related Posts](#)



ADATA TurboHDD USB II HM800 External Hard Drive



Product Information

- **Version:**
 - 1.03.00 Dec. 19, 2022 Proprietary and Confidential
- **Specifications**
 - **Brand:** TurboHDD
 - **Model:** USB II
 - **Version:** 1.03.00
 - **Date:** Dec. 19, 2022

Product Introduction

All information, materials, and content available in this document are protected by copyrights and other intellectual property rights of ADATA Technology Co., Ltd., and all rights are strictly reserved. Any portion of this document shall not be reproduced, copied, or translated to any other forms without permission from ADATA Technology Co., Ltd.

- **Disclaimer**
 - FNet Co., Ltd. reserves the right to change products, information, and specifications without notice.
 - FNet Co., Ltd. is not liable for any consequential, incidental, or indirect damages (including damages for indirect personal injury, loss of business profits, business interruption, loss of business information, and the like) arising out of the use or inability to use this product.
- **User Notice**

- The serial number sticker is a license certificate, please keep it carefully. If you lost this sticker that means the software warranty was terminated.
- Please kindly use this software product properly by the user guide.
- If this product is defective, please contact us.
- FNet Co., Ltd. is not liable for any consequential, incidental, or indirect damage (including damages for indirect personal injury, loss of business profits, business interruption, loss of business information, and the like) arising out of the use or inability to use this product.

• FAQ

- **Q:** What should I do if I lose the serial number sticker?
- **A:** The serial number sticker is a license certificate, and losing it will terminate the software warranty. Please keep it carefully to ensure the warranty remains valid.
- **Q:** How should I use this software product?
- **A:** Please refer to the user guide provided to properly use this software product.
- **Q:** What should I do if the product is defective?
- **A:** If you encounter any defects with the product, please contact us for assistance.
- **Q:** Is FNet Co., Ltd. responsible for any damages resulting from the use of this product?
- **A:** FNet Co., Ltd. is not liable for any consequential, incidental, or indirect damages (including damages for indirect personal injury, loss of business profits, business interruption, loss of business information, and the like) arising out of the use or inability to use this product.

Revision History

Revision	Date	Description	Editor
1.0	2022/12/17	Initial release	Tim Tseng

Copyright

- The user is responsible for all results. FNet Co., Ltd owns this product and its related information and we grant you no right to this product. FNet Co., Ltd. also owns all unauthorized rights in this User Guide.
- All rights reserved. No part of this product may be copied without the written permission or authorization of FNet Co., Ltd, which prohibits the sale, rental, exchange, lending, exhibition, revision, destruction, etc. of the product, as these actions could infringe on FNet's rights.
- FNet also prohibits anyone from re-compiling, reverse engineering the software, or decoding our product. Covering or removing the copyright and trademark description is not allowed.
- FNet Co., Ltd. owns the product copyright and patent. This product and its manual possess copyrights & patents for multiple countries. The trademark of FNet is registered by FNet Co., Ltd.
- Adobe is a trademark and Adobe Acrobat is a registered trademark of Adobe Systems Incorporated. Microsoft and Windows are trademarks of Microsoft Corporation.
- All other company and product names may be trademarks of the respective companies with which they are associated.

DISCLAIMER

- FNet Co., Ltd. RESERVES THE RIGHT TO CHANGE PRODUCTS, INFORMATION AND SPECIFICATIONS WITHOUT NOTICE.
- FNet Co., Ltd. is not liable for any consequential, incidental or indirect damages (including damages for indirect personal injury, loss of business profits, business interruption, loss of business information and the like) arising out of the use or inability to use this product.

User Notice

1. The serial number sticker is a license certificate, please keep it carefully. If you lost this sticker that means the software warranty was terminated.
2. Please kindly use this software product properly by the user guide.
3. If this product is defective, please contact us.
4. FNet Co., Ltd. is not liable for any consequential, incidental or indirect damage (including damages for indirect personal injury, loss of business profits, business interruption, loss of business information and the like) arising out of the use or inability to use this product.

System Requirements

- **Operating System** Windows 7 (32/64bit) Windows 8 & 8.1 (32/64bit) Windows 10 (32/64bit) Windows 11 (64bit)
- Disk Capacity Minimum 15MB available for installation
- Supported Partition Types MBR GPT
- Supported Languages English, Chinese (Traditional), Chinese (Simplified), Japanese
- USB Interface USB 2.0 3.0 3.1

Some limitations exist depending on the type of storage and model.

Install software

Caution: The software installation must login by administrator mode.

1. Plug in the USB storage to your computer.
2. Run the Setup of TurboHDD USB II.
3. Read and confirm the agreement before installing.
4. If you like to change the path of the software installation, please click “Options” and change the installation path. It’s recommended to use the default path.
5. Confirm and check the license agreement after reading and then click “Install”



Input the Serial Number

- After installing the software for the first time, start the software and you will see the serial number input screen.
- Please find the attached serial number sticker and enter the complete serial number, press [Activation], and you can start using the software after registering through the Internet.

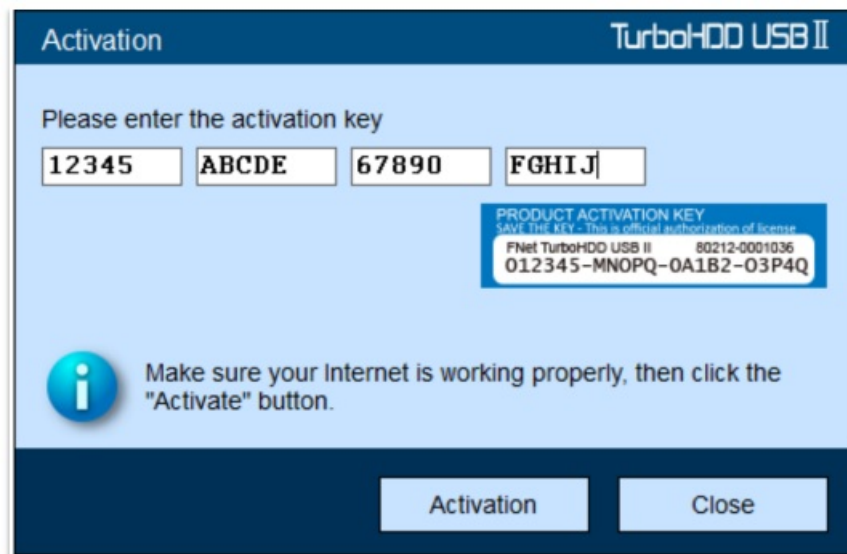

Start the software

1. Execute the TurboHDD USB program, and the screen will display the relevant information of the USB hard disk and the current status of the USB hard disk.
2. The default value of the program is to set the USB hard disk to the accelerated state (the green ON is displayed in the lower right corner).



Software problem

- If there are compatibility problems or any unknown problems with this software, please click the [Options] icon in the upper right corner of the screen, and then click the [Information] button.

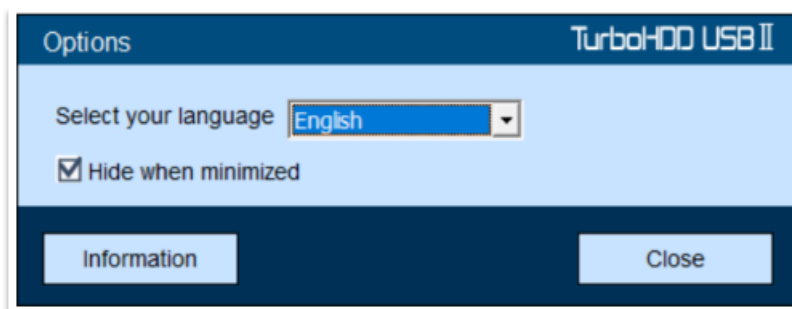



- Save the generated software and hardware information as a txt file and send it to us, and we will solve the problem as soon as possible



```

TurboHDD USB II_Info.TXT - 記事本
檔案(F) 編輯(E) 格式(O) 檢視(V) 說明
TurboHDD USB II Ver 1.03.00
ExeName : [C:\Program Files (x86)\AdataTurboHddUsb2\TurboH
Drivers Info :
RAM CACHE Version=[5.02]
OS Info :
OSVERSIONINFO :
dwPlatformId = [2]
Version = [10.0.19045]
OS = [Windows 10 (x64)]
IsServer = [false]
IsWinPE = [false]
Admin Mode = [false]
Physical Memory : [51538]/[65446]
Screen Size = [2560] x [1440]
Work Area = (0, 0) - (2560- 1400)
User Information :
Dns Hostname = [DESKTOP-SEOKNP2]
Net BIOS = [DESKTOP-SEOKNP2]
User Name = [lipso]
SID = [S-1-5-21-1371043440-1252295878-147020086-1001]
WorkGroup = [WORKGROUP]
第 1 列, 第 1 行 100% Windows (CRLF) UTF-16 LE

```

Turbo

Illustration	Description
	<p>“Turbo” is for speeding up the transfer efficiency. “Normal” is for operating the transfer rate as a common hard disk.</p>
	<ol style="list-style-type: none"> When FNet TurboHDD USB is booted, the USB state and relation of information are displayed. The default is set the state of “Turbo”.

	<p>3. Click the icon of the hard disk that can switch the state between “Turbo” and “Normal”.</p>
	<p>4. If you select “Normal”, the transfer efficiency will be work as a common rate.</p> <p>5. If you click the icon of the hard disk again. Its default will be “Turbo” again.</p>

References

1. USB <https://zh.wikipedia.org/w/index.php?title=USB&variant=zh-tw&oldformat=true>.

All information, materials, and content available in this document are protected by copyrights and other intellectual property rights of ADATA Technology Co., Ltd., all rights are strictly reserved. Any portion of this document shall not be reproduced, copied, or translated to any other forms without permission from ADATA Technology Co., Ltd.

Proprietary and Confidential

All information, materials and content available in this document are protected by copyrights and other intellectual property rights of ADATA Technology Co., Ltd., all rights are strictly reserved. Any portion of this document shall not be reproduced, copied, or translated to any other forms without permission from ADATA Technology Co., Ltd.

- **Version:** 1.03.00
- **Dec.** 19, 2022



TurboHDD USB II
User Guide

Model: AH800
Rev. 1.0 (2011)

Copyright © 2011 ADATA Technology Co., Ltd.
All rights reserved. No part of this publication may be reproduced, stored in a retrieval system, or transmitted, in any form or by any means, electronic, mechanical, photocopying, recording, or by any information storage and retrieval system, without prior written permission from ADATA Technology Co., Ltd.

[ADATA TurboHDD USB II HM800 External Hard Drive](#) [pdf] User Guide

TurboHDD USB II HM800 External Hard Drive, TurboHDD USB II HM800, External Hard Drive, Hard Drive, Drive

References

- [USB -](#)
- [User Manual](#)