

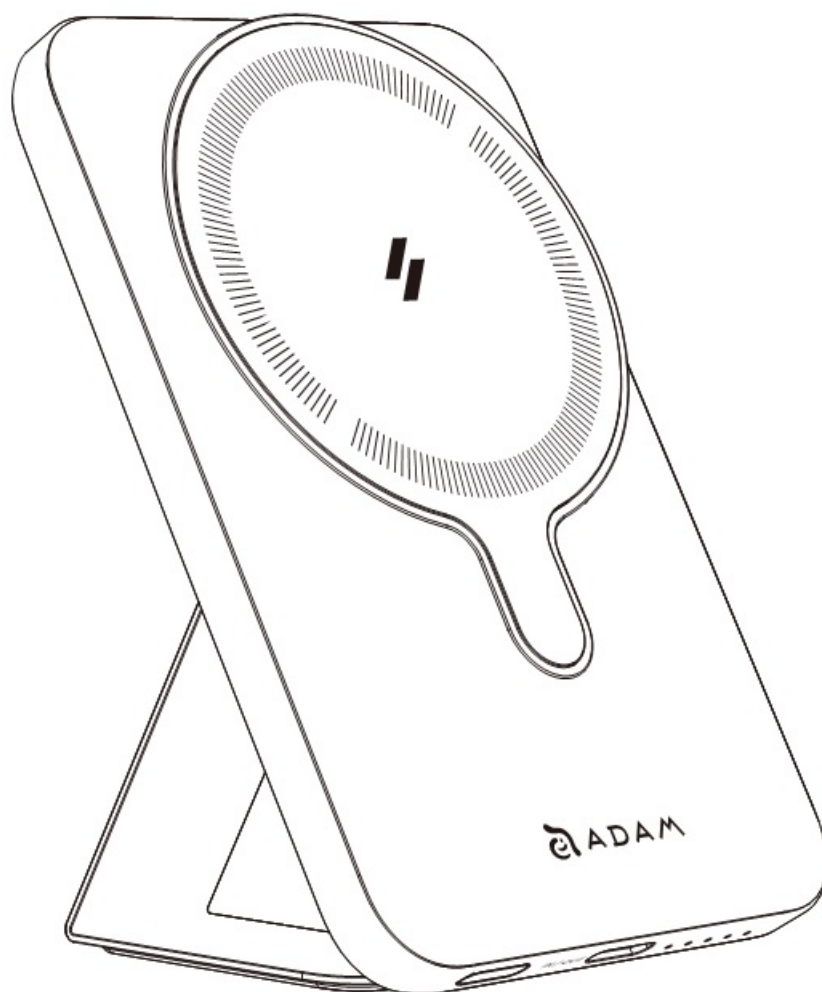

ADAM elements GRAVITY CS10 Magnetic Power Bank with Foldable Stand User Manual

[Home](#) » [ADAM elements](#) » ADAM elements GRAVITY CS10 Magnetic Power Bank with Foldable Stand User Manual 

*ADAM elements GRAVITY CS10 Magnetic Power Bank with Foldable Stand
User Manual*



GRAVITY CS5

Magnetic Power Bank with Foldable Stand

ENGLISH

User Manual

(READ MANUAL BEFORE PRODUCT USE)

Specification

GRAVITY CS5

Magnetic Power Bank with Foldable Stand

Battery Capacity: 5000mAh / 3.85V / 19.25Wh

Input:

USB-C | 5V = 3A / 9V = 2A

Output:

- Wireless: 5V/5W, 7.5V/7.5W, 9V/10W, 12V/15W (iPhone 7.5W)
 - USB-C: 5V = 3A / 9V = 1.2A / 12V = 1.2A
- Wireless + USB-C: 5V = 1.5A + 5W

Operating Temperature: 10°C - 35°C

Size: 67.2 x 15 x 105 mm

Weight: 149 g

Warranty: 1 year

Product Introduction

1. Power Button
2. USB-C (Input/Output)
3. Light Indicator
4. Magnetic Wireless Charger
5. Foldable Stand

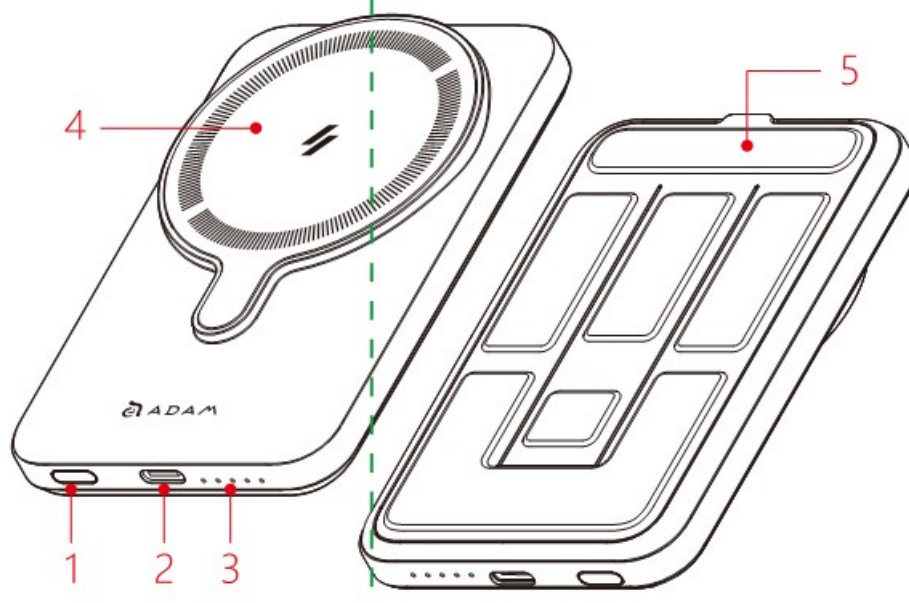

Magnetic Foldable Stand

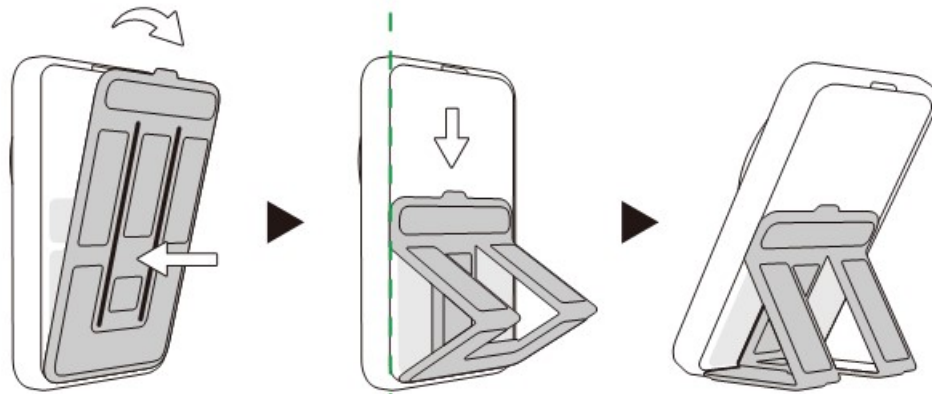

Instruction

Light Indicator

The white light indicates the current battery level, and the green light shows wireless charging activated or FOD.

(1) Battery Level

● ● ● ○ ○	0% - 25%
● ● ○ ○ ○	25% - 50%
● ○ ○ ○ ○	50% - 75%
○ ○ ○ ○ ○	75% - 100%

(2) Wireless Charging

○ ○ ○ ○ ●	Activated
○ ○ ○ ○ ●	FOD

- **Power On**

Press power button once.

*It will shutdown if no action is taken after 40 seconds.

- **Power Off**

Press power button twice.

- **Wireless Charging**

Instantly charge upon contact and activate wireless charging output.

- **FOD (Foreign Object Detection)**

The green light flashes rapidly.

*Wireless charger will shutdown if no action is taken after 20 seconds.

Charging Mode



Charge 1 device with magnetic attachment.

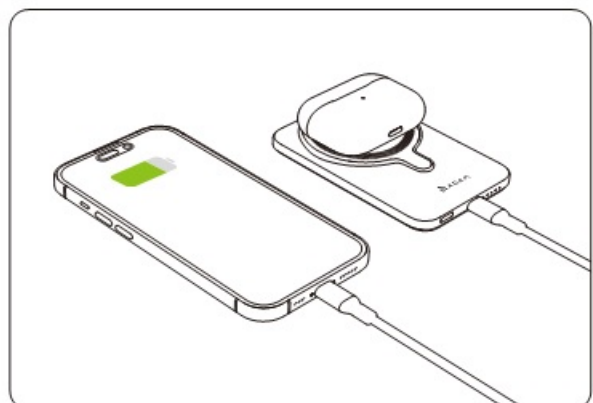

Charge 2 devices simultaneously.

Protective Function



Multiple Circuit Protection



Over-Voltage Protection



Over-Heat Protection



Over-Current Protection



Short-Circuit Protection



Flame Retardant Protection

Attention



Do not disassemble, puncture, drop, bend or modify



Do not shake while charging



Unplug the device when fully charged



Do not expose to liquids



Keep away from children



Avoid extreme temperatures



1 year warranty



For the fastest and safest charge, use an ADAM cable, your device's original cable or a certified cable (such as MFi)



The information in this user manual may be changed without prior notice, please scan the QR code for the latest version.

FCC Statement :

This device complies with Part 15 of the FCC Rules. Operation is subject to the following two conditions:
(1) This device may not cause harmful interference, and (2) this device must accept any interference received, including interference that may cause undesired operation.

Warning: Changes or modifications not expressly approved by the party responsible for compliance could void the user's authority to operate the equipment.



Note: This equipment has been tested and found to comply with the limits for a Class B digital device, pursuant to Part 15 of the FCC Rules. These limits are designed to provide reasonable protection against harmful interference in a residential installation.

This equipment generates, uses, and can radiate radio frequency energy and, if not installed and used in accordance with the instructions, may cause harmful interference to radio communications. However, there is no guarantee that interference will not occur in a particular installation. If this equipment does cause harmful interference to radio or television reception, which can be determined by turning the equipment off and on, the user is encouraged to try to correct the interference by one or more of the following measures:

- (1) Reorient or relocate the receiving antenna.
- (2) Increase the separation between the equipment and receiver.
- (3) Connect the equipment into an outlet on a circuit different from that to which the receiver is connected.
- (4) Consult the dealer or an experienced radio / TV technician for help.

FCC RF Radiation Exposure Statement:

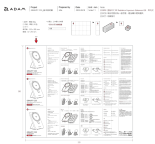
The device has been evaluated to meet general RF exposure requirement. The device can be used in portable exposure condition without restriction.

	<p>ADAM elements GRAVITY CS10 Magnetic Power Bank with Foldable Stand [pdf] User Manual</p> <p>2ABY9GRAVITY-CS10, 2ABY9GRAVITYCS10, GRAVITY CS10, GRAVITY CS10 Magnetic Power Bank with Foldable Stand, Magnetic Power Bank with Foldable Stand, Power Bank with Foldable Stand, Foldable Stand</p>
	<p>ADAM elements GRAVITY CS10 Magnetic Power Bank with Foldable Stand [pdf] User Manual</p> <p>2ABY9GRAVITY-CS10, 2ABY9GRAVITYCS10, GRAVITY CS10, GRAVITY CS10 Magnetic Power Bank with Foldable Stand, Magnetic Power Bank with Foldable Stand, Power Bank with Foldable Stand, Foldable Stand</p>