

ADAM AUDIO

**S SERIES Range of
Studio Monitors**



ADAM AUDIO S SERIES Range of Studio Monitors User Guide

[Home](#) » [ADAM AUDIO](#) » ADAM AUDIO S SERIES Range of Studio Monitors User Guide 

Contents

- [1 ADAM AUDIO S SERIES Range of Studio Monitors](#)
- [2 Product Specifications](#)
- [3 Product Usage Instructions](#)
- [4 Frequently Asked Questions](#)
- [5 Documents / Resources](#)
 - [5.1 References](#)
- [6 Related Posts](#)



ADAM AUDIO S SERIES Range of Studio Monitors



Product Specifications

- **Model:** S SERIES (S2V, S3H, S3V, S5H, S5V)
- **Color:** Black
- **Power Requirements:** AC mains power cord
- **Recommended Usage:** Indoor
- **Manufacturer:** Not specified

Product Usage Instructions

Safety Instructions

Please read the following safety instructions before setting up your system. Keep the instructions for further reference. Please heed the warnings and follow the instructions. It is crucial to follow the safety instructions provided with the product to ensure safe operation and prevent any hazards.

Some key safety guidelines include:

- Do not open the product to avoid the risk of electrical shock.
- Ensure the product is placed on a solid surface or stand to prevent accidents.
- Use only manufacturer-specified accessories like stands or brackets for setup.
- Avoid exposure to extreme temperatures and never operate in explosive atmospheres.

Caution

Risk of electrical shock Do not open Risque de shock électrique Ne pas ouvrir

CAUTION: TO REDUCE THE RISK OF FIRE OR ELECTRIC SHOCK, DO NOT REMOVE BACK COVER OR ANY OTHER PART. NO USER-SERVICABLE PARTS INSIDE. DO NOT EXPOSE THIS EQUIPMENT TO RAIN OR MOISTURE. REFER SERVICING TO QUALIFIED PERSONNEL.

Explanation of Graphical Symbols

The lightning flash with arrowhead symbol, within an equilateral triangle, is intended to alert the user to the presence of uninsulated “dangerous voltage” within the product’s enclosure that may be of sufficient magnitude to constitute a risk of electric shock to persons. The exclamation point within an equilateral triangle is intended to alert the user to the presence of important operating and maintenance (servicing) instructions in the literature accompanying the appliance.

- **Caution:** To reduce the risk of electric shock, do not open the loudspeaker. There are no user-serviceable parts inside. Refer servicing to qualified service personnel.
- This product, as well as all attached extension cords, must be terminated with an earth ground three-conductor AC mains power cord like the one supplied with the product. To prevent shock hazard, all three components must always be used.
- Never replace any fuse with a value or type other than those specified. Never bypass any fuse.
- Ensure that the specified voltage matches the voltage of the power supply you use. If this is not the case do not connect the loudspeakers to a power source! Please contact your local dealer or national distributor.
- Always switch off your entire system before connecting or disconnecting any cables, or when cleaning any components.
- To completely disconnect from AC mains, unplug the power supply from the power socket. The monitor should be installed near the mains connection and it should be easy to access the socket and disconnect the device if

necessary.

- Protect the power cord from being walked on or pinched particularly at plugs, sockets, and the point where it exits from the apparatus.
- Unplug this apparatus during lightning storms or when unused for long periods of time. Always keep electrical equipment out of the reach of children.
- Do not expose this product to rain or moisture, never wet the inside with any liquid and never pour or spill liquids directly onto this unit. Please do not put any objects filled with liquids [e.g. vases, etc.] onto the speaker.
- Use only with stands, tripods or brackets specified by the manufacturer, or sold with the apparatus. When moving the loudspeakers on a trolley, avoid injuries; take care and do not over-balance the trolley.
- The speakers must be positioned on a solid surface or a stand.
- Always use fully checked cables. Defective cables can harm your speakers. They are a common source for any kind of noise, hum, crackling etc.
- Never use flammable or combustible chemicals for cleaning audio components.
- Install in accordance with the manufacturer's instructions.
- Never expose this product to extremely high or low temperatures.
- Never operate this product in an explosive atmosphere.
- High SPLs may damage your hearing! Please do not get close to the loudspeakers when using them at high volumes.
- Please be aware that sensitivity is sensitive to distance from the speaker.
- A Ensure free airflow behind the speakers to maintain sufficient cooling by keeping a distance of at least 100 mm [4"] to the wall.
- No naked flame sources, such as lit candles, should be placed on the speaker.
- Do not use this apparatus near water.
- A Use a dry cloth for cleaning.
- A Do not install near any heat sources such as radiators, hot air vents, stoves, or other equipment [including amplifiers) that produces heat.
- A Do not disconnect the earth wire in an earthed plug. An earthed plug has live and neutral prongs, plus a third prong for grounding purposes which is included for your safety. If the provided plug does not fit into your socket, consult an electrician to have your socket replaced.
- Only use attachments/accessories specified by the manufacturer.
- A SzY, 53H and S3V only: When using the wall or ceiling mount option, only mount this product onto dry and non-conducting wood/ plaster panel walls. To prevent injury, this loudspeaker must be securely attached to the wall in accordance with the installation instructions of each separate mounting accessory.
- A Refer all servicing to qualified service personnel. Servicing is required when the apparatus has been damaged in any way, for example if the power-supply cord or plug is damaged, liquid has been spilled or objects have fallen into the apparatus, or if the apparatus has been exposed to rain or moisture, does not operate normally, or has been dropped.
- Only suitable for safe use in areas below 2000 meters above sea level.
- Only for safe use in non-tropical climate conditions. The ventilation should not be impeded by covering the ventilation openings with items, such as newspapers, table-cloths, curtains, etc.

MANUAL

This is the S Series Quick Start Guide, which is designed purely to get you up and running with your new ADAM Audio monitors as quickly as possible. For the full users' manual, visit: www.adam-audio.com/s-series/manual

Setup and Installation

Before setting up the speakers, ensure that the power supply voltage matches the required voltage. Follow these steps for setup:

1. Connect the AC mains power cord to an earth ground three-conductor power source.
2. Place the speakers on a stable surface or stand to prevent any imbalance.
3. Use fully checked cables to connect the speakers to your audio source.
4. Position the speakers at an appropriate distance from magnetically sensitive items to avoid interference.

CONNECTIONS

Despite all the power and flexibility the S Series monitors have to offer, setting them up is very straightforward. The only choice you have to make is whether to drive them digitally or with a traditional analog signal. This selection is made via the rear-panel OLED display and its adjacent dual-function push-button/rotary encoder, which allow access to the S Series DSP settings. In addition to a standard IEC mains connector, the simple S Series rear panel features traditional AES XLR analog inputs and AES3 digital Input and Thru connectors (the latter are for multi-channel arrays where multiple speakers are being driven using the same signal). There's also a USB jack to facilitate internal software upgrades and the use of computer-based remote setting software, and a blank panel covering an Options slot that will hold two RJ45 connectors for future expansion options.

NOTE: Always use AES/EBU-compatible, shielded twisted-pair cables for digital audio connections.

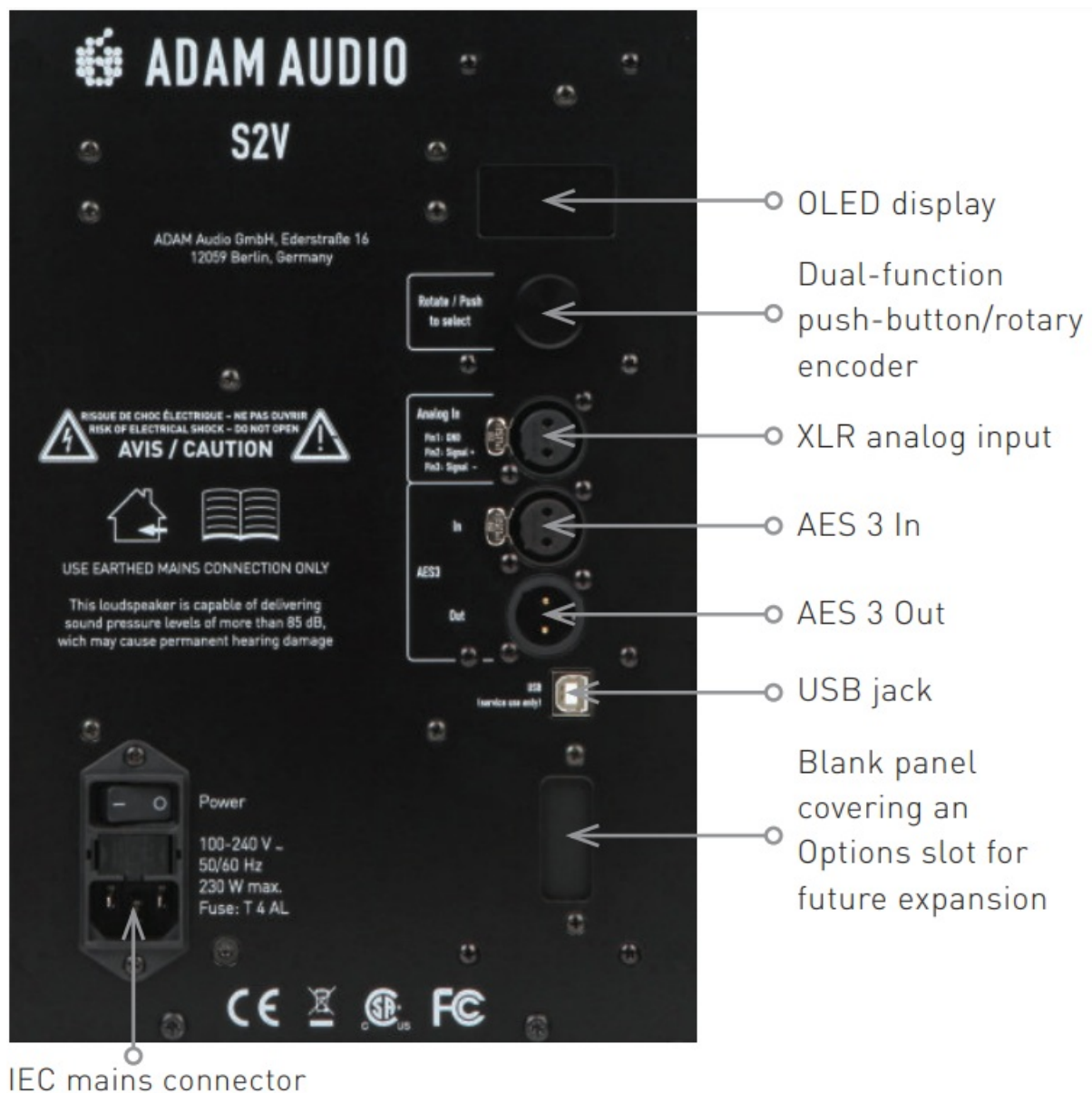

GETTING STARTED

Before using your new speakers, you should let them settle at the ambient temperature of your listening environment by leaving them in position for an hour or so after unpacking them. We recommend that the S Series speakers are driven on a solid, stable surface for best results. Please also be aware that before optimum performance can be attained, it always takes some hours of continuous usage to 'break in' factory-fresh reference monitors. With the speakers connected to your audio source but turned off, and with the audio input to the monitors turned all the way down, the amplifiers should be connected to AC mains power via the supplied standard IEC cable. The switched-mode power amplifiers in the S Series loudspeakers can handle mains electricity from anywhere in the world, with a voltage and frequency range of 100-240 volts AC, 50/60 Hz, so you can plug the monitors in without having to worry about mains transformers or overheating. Then simply turn on the loudspeakers, start your playback audio, and gradually increase the output level of your audio source. You should now start to hear sound through your S Series speakers.

LOUDSPEAKER PLACEMENT

Assuming your room has been acoustically treated to a reasonable degree to remove the worst effects of unwanted reflections and room modes, much of loudspeaker placement is common sense, but there are a few basic points that should be followed:

- Ensure that all your speakers are level with one another in the vertical plane [except subwoofers, for which placement is much less critical, and that the tweeters are roughly level with your ears. If a speaker needs to be placed higher or lower due to spatial constraints, it should be angled accordingly, but tilts of 15 degrees or more should be avoided (see diagram)]. Angles that result in reflections from your mixing console or other significant studio furniture should also be avoided.
- Make sure that nothing partially or totally obscures your monitors. You should have a clear line of sight to them; this will also guarantee that nothing comes between them and your ears.

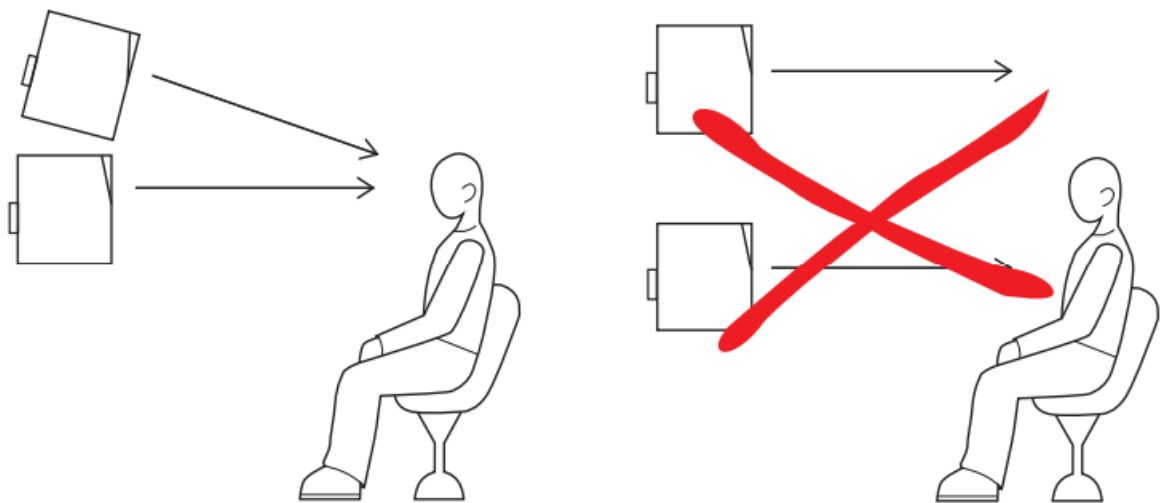

- Place each of your monitors at least 400 mm [16 inches) from the nearest wall to minimize back reflections, which can adversely affect your chances of accurately monitoring low-frequency information. If at all possible, avoid placing loudspeakers near room corners for the same reason: with two reflective surfaces in close proximity, the chances of unwanted reflections affecting your low-frequency audio are even greater.
- For stereo audio production, your ears should be placed as near as possible to one corner of an equilateral triangle, with the two speakers at the other corners [see below].

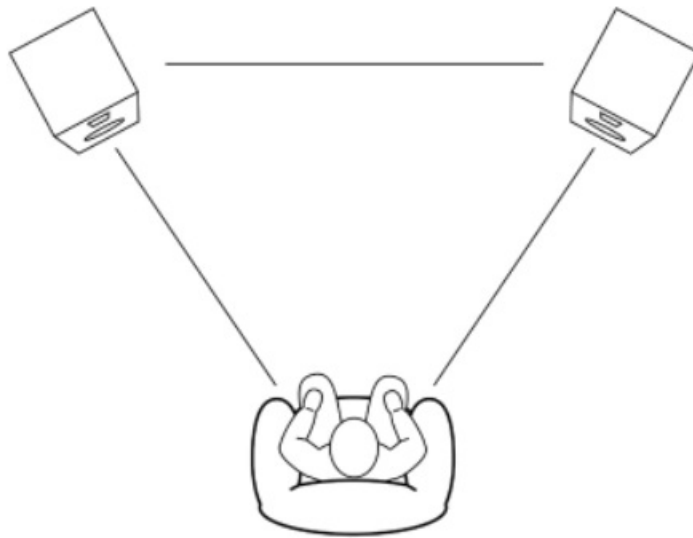

- → Precise idealized placements of speakers for surround audio production depend on the number of channels [and therefore speakers] you are using, and whether your audio is being produced for musical or film use. The International Telecommunication Union recommendations on ideal loudspeaker placement for a variety of audio formats and applications can be found in detail at their web site, www.itu.int. However, as general guidance and in common with stereo placement, a symmetrical listening position is recommended, with all speakers all situated at least 400 mm [16 inches] from the nearest wall to minimize back reflections, and b) pointing as much as possible toward the listener's ears.

S SERIES DSP FUNCTIONS

All models of the S Series come with the PURE factory EQ setting, which allows you to start working right away. To learn more about tailoring your speakers to your individual room's acoustics with the onboard DSP, please go to www.adam-audio.com/s-series/manual, where you will find a full explanation of how to use the DSP module.

How to drive the S Series digitally via its AES3 connections [daisy-chaining]

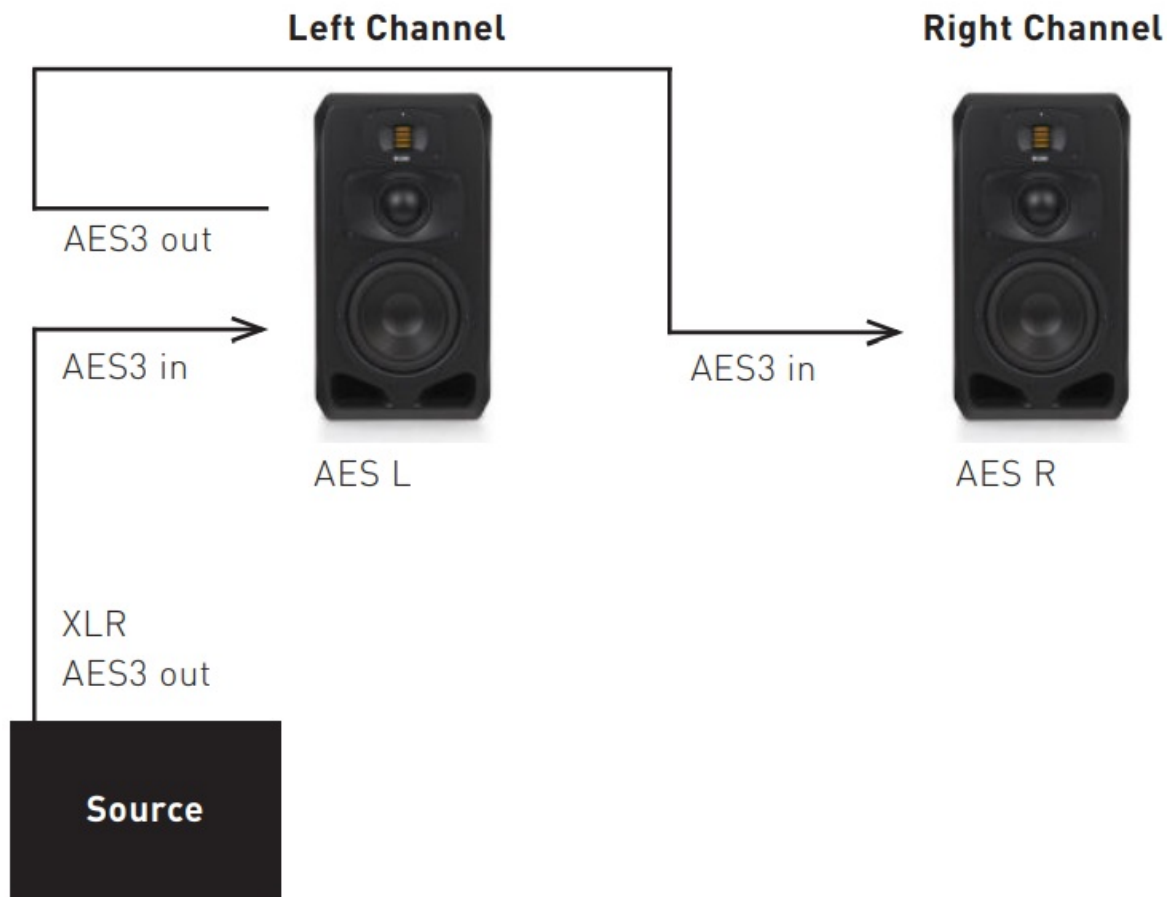

Operation and Maintenance

To operate the speakers safely and maintain their performance, keep these points in mind:

- Switch off the system before connecting or disconnecting any cables.
- Keep the power cord away from potential hazards like being walked on or pinched.
- Avoid using flammable chemicals for cleaning to prevent damage to the components.
- Avoid getting close to the speakers at high volumes to prevent hearing damage.

ADAM AUDIO GMBH

BERLIN, GERMANY

T +49 30-863 00 97-0

F +49 30-863 00 97-7

INFO@ADAM-AUDIO.COM

WWW.ADAM-AUDIO.COM

SUPPORT

If you have any problems that cannot be solved by reading this Quick Start Guide or the full manual, please contact your local dealer or ADAM Audio Support via: support@adam-audio.de
Our team will be happy to help.

Frequently Asked Questions

Q: Can I use any power cord with the speakers?

A: No, it is recommended to use an earth ground three-conductor AC mains power cord supplied with the product for safety reasons.

Q: How far should magnetically sensitive items be kept from the speakers?

A: It is advised to keep magnetically sensitive items at least 0.5 meters away from the speakers to avoid interference due to the emitted magnetic field.

Documents / Resources

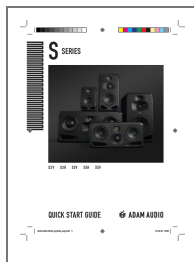

[ADAM AUDIO S SERIES Range of Studio Monitors](#) [pdf] User Guide

S2V, S3H, S3V, S5H, S5V, S SERIES Range of Studio Monitors, S SERIES, Range of Studio Monitors, Studio Monitors, Monitors

References

- [C AUDIO - Das Magazin für HiFi, Surround, High End, Musik - connect](#)
- [ADAM Audio - High Precision Studio Monitors from Berlin, Germany](#)
- [User Manual](#)

[Manuals+](#), [Privacy Policy](#)

This website is an independent publication and is neither affiliated with nor endorsed by any of the trademark owners. The "Bluetooth®" word mark and logos are registered trademarks owned by Bluetooth SIG, Inc. The "Wi-Fi®" word mark and logos are registered trademarks owned by the Wi-Fi Alliance. Any use of these marks on this website does not imply any affiliation with or endorsement.