

 **ADAM AUDIO**
D3V Desktop
Monitor System



ADAM AUDIO D3V Desktop Monitor System Installation Guide

[Home](#) » [ADAM AUDIO](#) » ADAM AUDIO D3V Desktop Monitor System Installation Guide 

Contents

- [1 ADAM AUDIO D3V Desktop Monitor System](#)
- [2 Specifications](#)
- [3 Frequently Asked Questions](#)
- [4 What's included](#)
- [5 Power Connection](#)
- [6 Balanced Analog Audio Connection](#)
- [7 Unbalanced Analog Audio Connections](#)
- [8 Balanced Digital Audio Connection](#)
- [9 Headphone Connection](#)
- [10 Use of Rotary Front Knob & LED States](#)
- [11 Desktop Stand Connection & Stick-On Pads](#)
- [12 Microphone Stand Connection](#)
- [13 EQ Section](#)
- [14 Documents / Resources](#)
 - [14.1 References](#)



ADAM AUDIO D3V Desktop Monitor System



Specifications

- Power Connection: USB-C
- Analog Audio Connections: Balanced TRS, Unbalanced TS
- Digital Audio Connection: Balanced XLR, TRS, TS
- Headphone Connection: 3.5mm TRS

Frequently Asked Questions

Q: How do I know if the product is powered on?

A: The LED state will be solid green for power on and analog input active, and solid cyan for power on with digital input active.

Q: What does a flashing red LED indicate?

A: A flashing red LED indicates limiter activity; ensure audio levels are within limits.

What's included

(TRS)

Use a TRS cable to connect the product for balanced analog audio transmission. Ensure proper alignment of Tip, Ring, and Sleeve connectors.

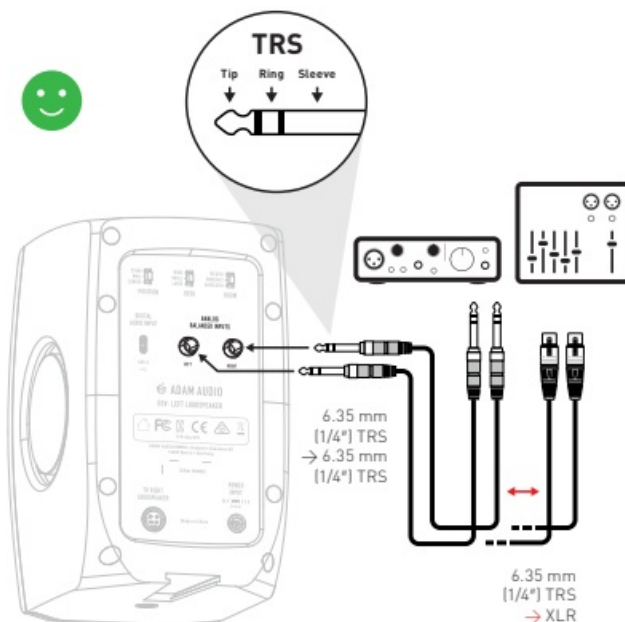

Unbalanced Analog Audio Connections

(TS)

For unbalanced analog audio connections, use a TS cable with Tip and Sleeve connectors for Left (L) and Right (R) channels.

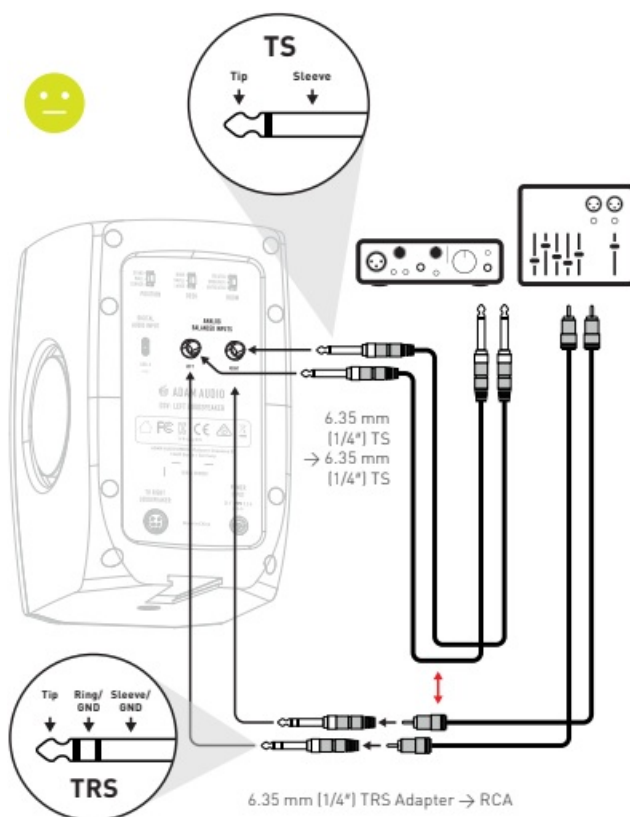

Balanced Digital Audio Connection

Connect using XLR or TRS cables for balanced digital audio transmission.

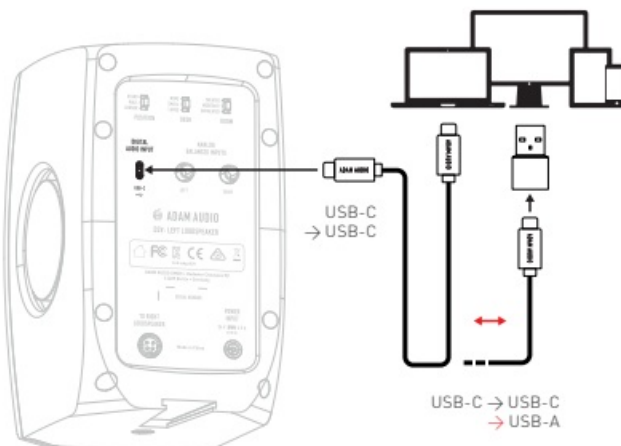

Headphone Connection

Connect headphones using a 3.5mm TRS connector for audio output.

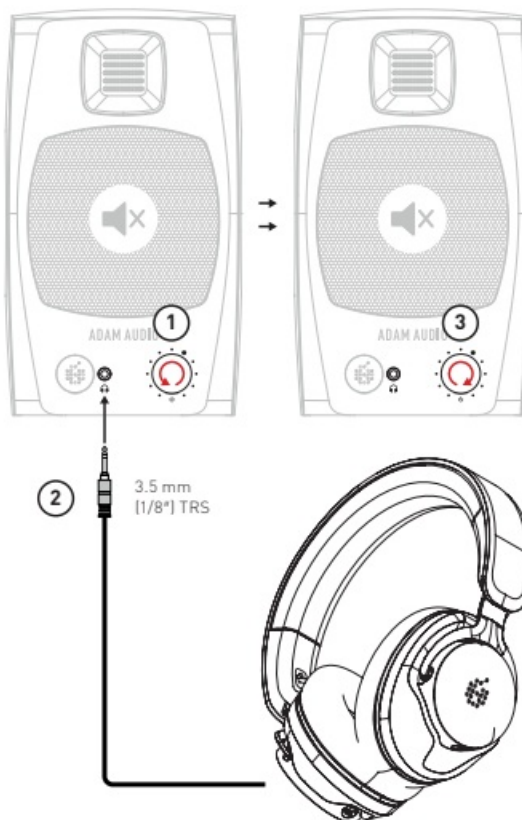

Use of Rotary Front Knob & LED States

Refer to the provided table for actions associated with pressing the front knob and interpreting LED states for various functions.

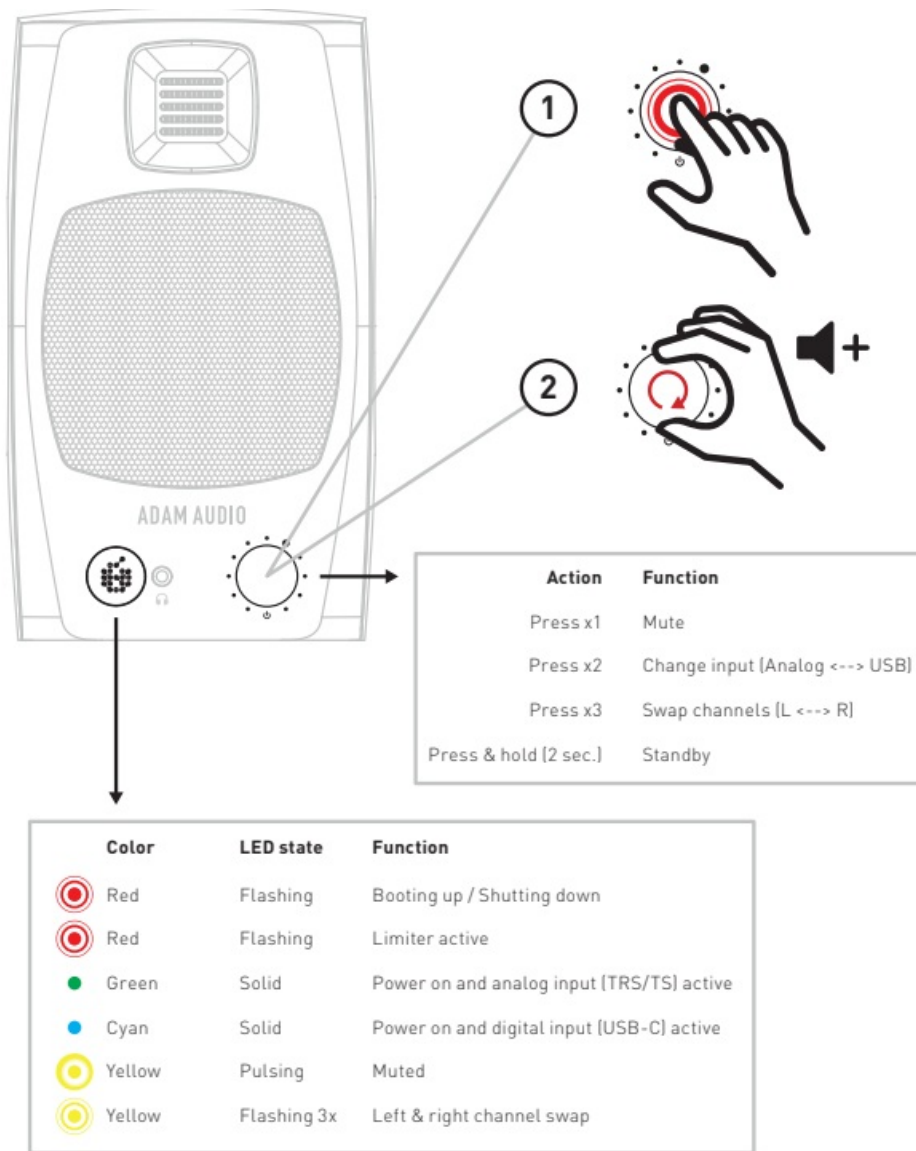

Desktop Stand Connection & Stick-On Pads

Attach the product to the desktop stand using provided connectors or use stick-on pads for stability.

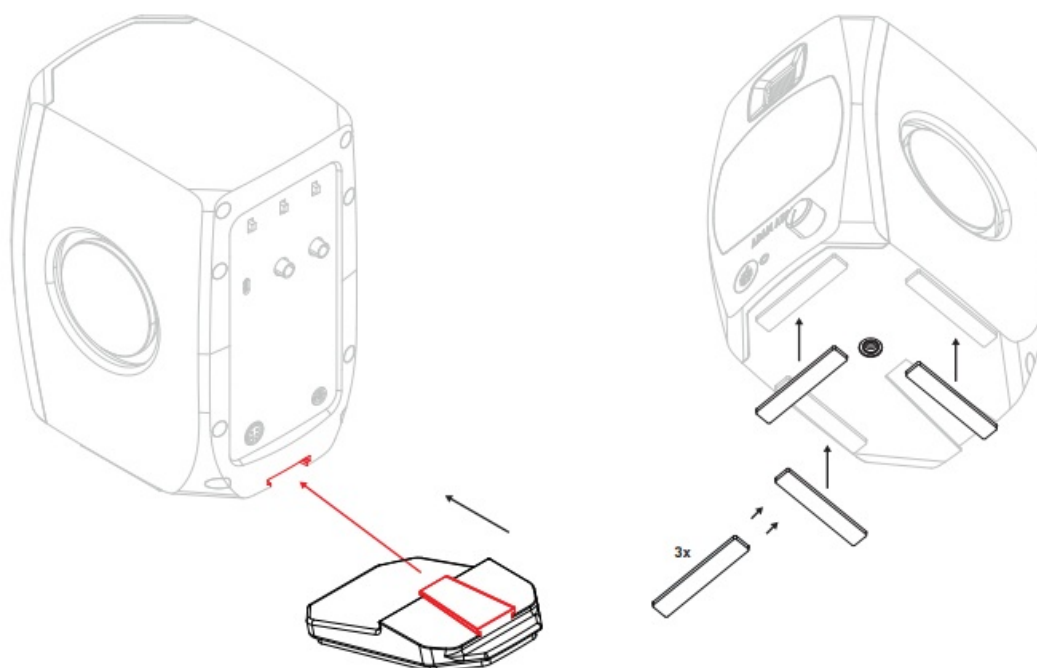

Microphone Stand Connection

For mounting on a microphone stand, follow the instructions provided in the manual for secure placement.

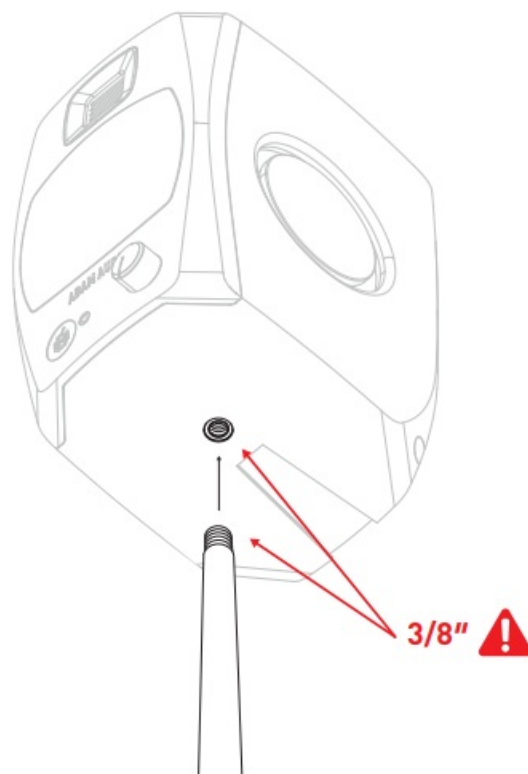

EQ Section

Adjust EQ settings as desired using the designated controls for Channels A, B, and C.

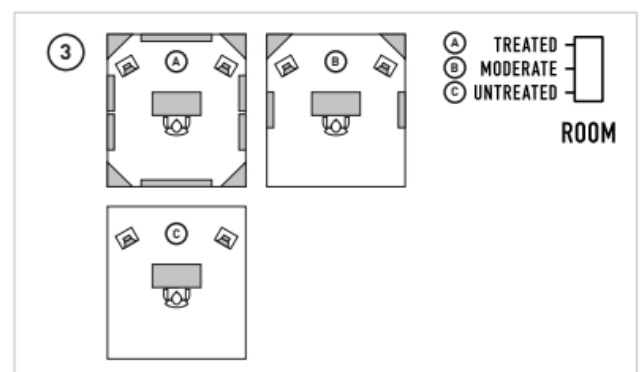
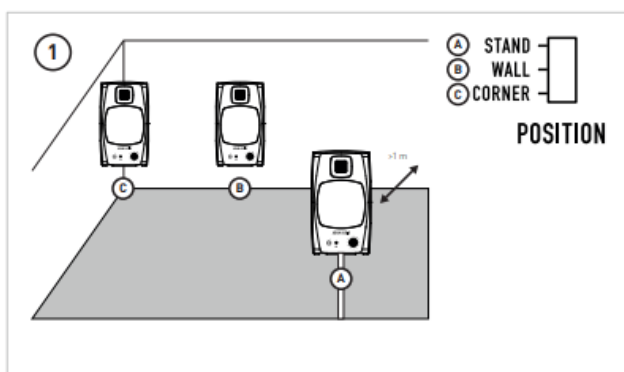
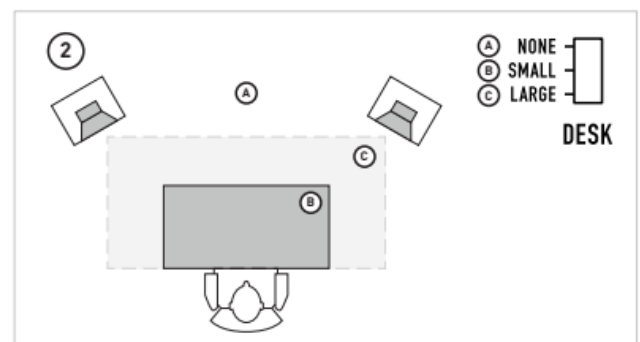
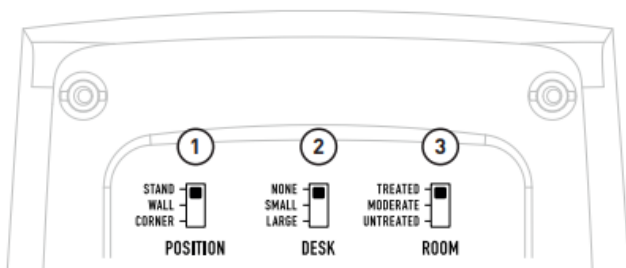

For the complete user manual, visit: www.adam-audio.com/d3v/manual



Documents / Resources

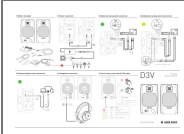

[ADAM AUDIO D3V Desktop Monitor System](#) [pdf] Installation Guide
D3V Desktop Monitor System, D3V, Desktop Monitor System, Monitor System, System

References

- [User Manual](#)

[Manuals+](#), [Privacy Policy](#)

This website is an independent publication and is neither affiliated with nor endorsed by any of the trademark owners. The "Bluetooth®" word mark and logos are registered trademarks owned by Bluetooth SIG, Inc. The "Wi-Fi®" word mark and logos are registered trademarks owned by the Wi-Fi Alliance. Any use of these marks on this website does not imply any affiliation with or endorsement.