



## ADA INSTRUMENTS COSMO MINI 40 Laser Distance Meter Instruction Manual

[Home](#) » [ADA INSTRUMENTS](#) » ADA INSTRUMENTS COSMO MINI 40 Laser Distance Meter Instruction Manual 

ADA INSTRUMENTS COSMO MINI 40 Laser Distance Meter Instruction Manual



Congratulations on the purchase of laser distance meter ADA COSMO MINI 40!

## Permitted use

-  Measuring distances
- Computing functions, e.g. areas, volumes, Pythagorean calculation, addition and subtraction.

**The safety regulations and instructions along with the operating manual should be read carefully before initial operation. The person responsible for the instrument must ensure that equipment is used in accordance with the instructions. This person is also accountable for the deployment of personnel and for their training and for the safety of the equipment when in use**

### Contents

- 1 SAFETY INSTRUCTION
- 2 Laser classification
  - 2.1 START UP
  - 2.2 Inserting / Replacing Batteries
- 3 MENU FUNCTIONS
  - 3.1 Single distance measurement
- 4 FUNCTIONS
  - 4.1 Indirect measurement
- 5 MESSAGE CODES
- 6 TECHNICAL DATA
- 7 MEASURING CONDITIONS
- 8 WARRANTY
  - 8.1 EXCEPTIONS FROM RESPONSIBILITY
  - 8.2 WARRANTY CARD
- 9 WARRANTY DOESN'T EXTEND TO FOLLOWING CASES:
- 10 Documents / Resources
  - 10.1 References
- 11 Related Posts

## SAFETY INSTRUCTION

### Prohibited use

Please follow up instructions given in operating manual.

Do not use instrument in explosive environment (filling station, gas equipment, chemical production and so on).

Do not remove warning labels or safety instructions.

Do not open instrument housing, do not change it's construction or modification.

Do not stare at beam. Laser beam can lead to eye injury (even from greater distances).

Do not aim laser beam at persons or animals.

Opening of the equipment by using tools (screwdrivers, etc.), as far as not specifically permitted for certain cases.

Inadequate safety precautions at the surveying site (e.g. when measuring on the roads, construction sites and so on).

Use the instrument in the places where it could be dangerous: on the air transport, near manufacturers, production facilities, in the places where the work of laser distance meter can lead to the harmful effects on people or animals.

### Laser classification

The instrument is a laser class 2 laser product with power < 1 mW and wavelength 635 nm. Laser is safety in

ordinary conditions of usage.

## START UP

### Keypad

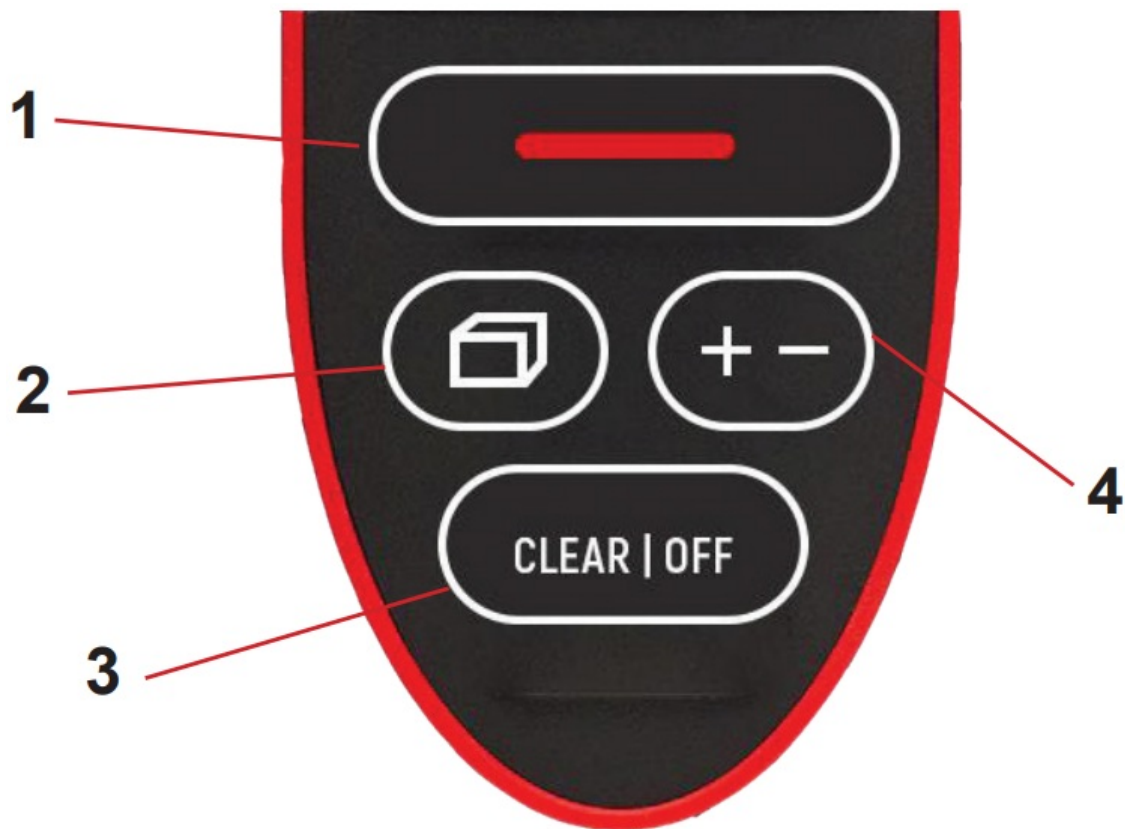

1. ON / Measure/ Continuous measurement
2. Area / Volume / Pythagorean measure
3. Clear / OFF
4. Addition/subtraction

### Display

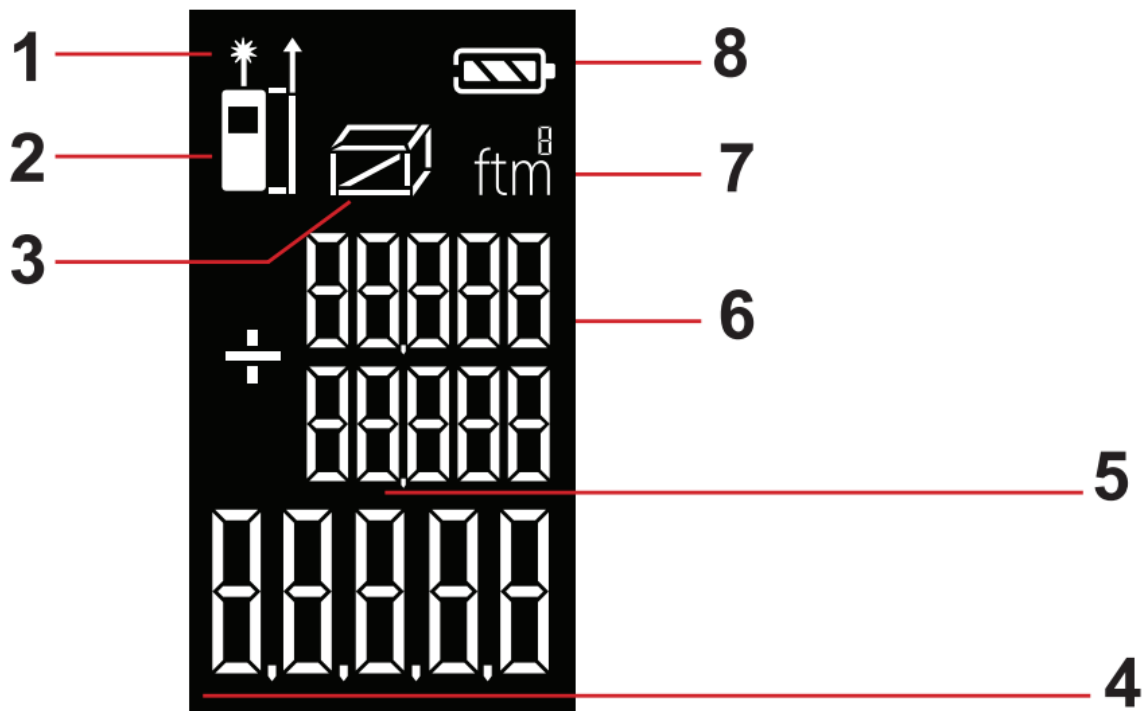

1. Laser ON
2. Reference (front/rear)
3. Area / volume/ Pythagorean
4. Main line 1
5. Line 2
6. Line 3
7. Units
8. Battery level

#### Inserting / Replacing Batteries

Remove the battery cover, insert the battery correctly. Pay attention to correct polarity. Close the battery compartment.

Replace the battery when symbol constantly blinks in the display.

Batteries should be removed in case of danger of corrosion, if the device will not be used for a long time.

#### MENU FUNCTIONS

##### Switch on and off

Press the button (1) to switch on the instrument and laser.

Press and hold key for about 2 seconds to start continuous measuring.

The device also switches off automatically after 3 minutes of inactivity i.e. no key is pressed within that interval.

To switch off the instrument press and hold button (3) for about 2 sec.

##### Clear-Key

Cancel the last action. Press button (3)

##### Reference setting

Default reference setting is from the rear of the device. Press and hold button (2) for more than 2 sec to set the reference: the front or the rear. You will see the reference symbol on the display..

### **Selecting Units (ft/m)**

Instrument is switched ON. Press and hold button (1) for 8 sec. Selected unit will be shown on the display (ft/m). When you switch ON the instrument again DO NOT press and hold button (1) for 8 sec if you don't want to change the units of measurement.

## **MEASUREMENTS**

### **Single distance measurement**

Press button (1) to activate the laser. When in continuous laser mode, press this button to trigger the distance measurement directly. The instrument will give acoustical signal. The result is displayed immediately.

### **Continuous Measurement**

Press and hold the button (1) for about 2 seconds to start continuous measuring.

### **Addition/Substraction**

Press button (4) to add the next measurement result to the previous result. (+) is displayed. Press button (4) once again to subtract the next result from the previous. (-) is displayed. Follow these steps for every measurement. Main result is always displayed in the line 1. The previous result is displayed in the line 2.

## **FUNCTIONS**

### **Area**

Press the button (2) once. The symbol "area" is displayed. Press button (1) to take the first measurement (for example, length). Measured value is displayed in the second line. Press button (1) to take the second measurement (for example, width). Measured value is displayed in the second line. The result of measured area is displayed in the first line.

### **Volume**

For volume measurements, press button (2) twice until the indicator for volume measurement appears on the display. Press button (1) to take the first measurement (for example, length). Measured value is displayed in the second line. Press button (1) to take the second measurement (for example, width). Measured value is displayed in the second line. Press button (1) to take the third measurement (for example, height). Measured value is displayed in the second line. The volume value will be displayed in the first line.

### **Indirect measurement**

Pythagorean measurement is used in the condition that the objective needing to be measured is covered or has no effective reflecting surface and can't be measured directly.

Make sure you adhere to the prescribed sequence of measurement:

All target points must be in a horizontal or vertical plane.

The best results are achieved when the instrument is rotated about a fixed point (e.g. with the positioning bracket fully folded out and the instrument placed on a wall).

Be sure that the first measurement and distance are measured at right angles.

### **Indirect measurement – determining a distance using 2 auxiliary measurements**

This function is used when height and distance can't be measured directly.

Press button (2) 3 times. The symbol "triangle" is displayed. The distance to be measured is blinking in the symbol triangle. Press button (1) to take distance measuring (hypotenuse of triangle). The result is displayed in the second line. This measurement can be taken in the indirect measurement function. Press and hold button (1) for 2

sec. After second pressure of the button (1) value is fixed.

The second distance to be measured is blinking in the symbol triangle. Press button (1) to take distance measuring. There is a right angle between laser beam and the length you need to measure. The result of the measurement is displayed in the second line. The result of the function is displayed in the first line.

## MESSAGE CODES

All message codes are displayed with either “Info”. Following mistakes can be corrected.

INFO	CAUSE	REMEDY
204	Data overflow	Repeat procedure
205	Measurement range transfinite	Use the meter in distance allowed
252	Temperature too high	Let device cool down
253	Temperature too low	Warm device up
255	Receiver signal is too weak	Measure target point with stronger reflector
256	Received signal too strong	Measure target point with weaker reflector
206	Pythagorean measurement violation	Re-measure and ensure the hypotenuse is greater than right angle edge
258	Initialization error	Switch on – off the instrument

## TECHNICAL DATA

Range, without target, m	0.05 to 40
Accuracy, mm	±2*
Smallest unit displayed	1 mm
Laser class	2
Laser type	635 nm, <1 mW
IP rating	IP 54
Automatic switch off	3 minutes of inactivity
Battery life, 2 x AAA	> 5000 measurements
Dimensions, mm	108x38x29
Weight	120 g
Temperature range: Storage Operating	-25° to +70° -10° to +50°

In favourable conditions (good target surface properties, room temperature).

Maximum deviation occurs under unfavorable conditions such as bright sunlight or when measuring to poorly reflecting or very rough surfaces.

## MEASURING CONDITIONS

### Measuring range

The range is limited to 40 m. At night, at dusk and when the target is shadowed the measuring range without target plate is increased. Use a target plate to increase the measurement range during daylight or if the target has a bad reflection.

### Measuring Surfaces

Measuring errors can occur when measuring toward colorless liquids (e.g. water) or dust free glass, Styrofoam or similar semi-permeable surfaces. Aiming at high gloss surfaces deflects the laser beam and measurement errors can occur. Against non-reflective and dark surfaces the measuring time can be increased.

## **Precautions**

Please, handle the instrument with care. Avoid vibrations, hits, water, effect of heat. During transportation put the instrument into the soft bag.

**Note: the instrument should be dry!**

## **Care and cleaning**

Do not immerse the instrument in water. Wipe off dirt with a damp, soft cloth. Do not use aggressive cleaning agents or solutions.

## **Specific reasons for erroneous measuring results**

- Measurements through glass or plastic windows;
- Dirty laser emitting window;
- After instrument has been dropped or hit. Please check the accuracy;
- Large fluctuation of temperature: if instrument will be used in cold areas after it has been stored in warm areas (or the other way round) please wait some minutes before carrying out measurements;
- Against non-reflective and dark surfaces, colorless surfaces and so on.

## **Electromagnetic acceptability (EMC)**

It cannot be completely excluded that this instrument will disturb other instruments (e.g. navigation systems); will be disturbed by other instruments (e.g. intensive electromagnetic radiation nearby industrial facilities or radio transmitters).

## **Laser classification**

ADA COSMO MINI 40 projects visible laser beam from the front part of the instrument. The instrument is a laser class 2 laser product according to DIN IEC 6082 5-1:2007. It is allowed to use unit following further safety precautions (see operating manual)

## **WARRANTY**

This product is warranted by the manufacturer to the original purchaser to be free from defects in material and workmanship under normal use for a period of two (2) years from the date of purchase.

During the warranty period, and upon proof of purchase, the product will be repaired or replaced (with the same or similar model at manufactures option), without charge for either parts or labour. In case of a defect please contact the dealer where you originally purchased this product.

The warranty will not apply to this product if it has been misused, abused or altered. Without limiting the foregoing, leakage of the battery, bending or dropping the unit are presumed to be defects resulting from misuse or abuse.

## **EXCEPTIONS FROM RESPONSIBILITY**

The user of this product is expected to follow the instructions given in operators' manual. Although all instruments left our warehouse in perfect condition and adjustment the user is expected to carry out periodic checks of the product's accuracy and general performance.

The manufacturer, or its representatives, assumes no responsibility of results of a faulty or intentional usage or misuse including any direct, indirect, consequential damage, and loss of profits.

The manufacturer, or its representatives, assumes no responsibility for consequential damage, and loss of profits by any disaster (earthquake, storm, flood ...), fire, accident, or an act of a third party and/or a usage in other than usual conditions.



The manufacturer, or its representatives, assumes no responsibility for any damage, and loss of profits due to a change of data, loss of data and interruption of business etc., caused by using the product or an unusable product.

The manufacturer, or its representatives, assumes no responsibility for any damage, and loss of profits caused by usage other than explained in the users' manual.

The manufacturer, or its representatives, assumes no responsibility for damage caused by wrong movement or action due to connecting with other products.

## **WARRANTY CARD**

**Name and model of the product:**

**Serial number:**

**Date of sale:**

**Name of commercial organization:**

**Stamp of commercial organization**

Warranty period for the instrument exploration is 24 months after the date of original retail purchase.

During this warranty period the owner of the product has the right for free repair of his instrument in case of manufacturing defects.

Warranty is valid only with original warranty card, fully and clear filled (stamp or mark of the seller is obligatory).

Technical examination of instruments for fault identification which is under the warranty, is made only in the authorized service center.

In no event shall manufacturer be liable before the client for direct or consequential damages, loss of profit or any other damage which occur in the result of the instrument outage.

The product is received in the state of operability, without any visible damages, in full completeness. It is tested in my presence. I have no complaints to the product quality. I am familiar with the conditions of warranty service and I agree.

**Purchaser signature:**

**Before operating you should read service instruction!**

If you have any questions about the warranty service and technical support contact seller of this product

## **WARRANTY DOESN'T EXTEND TO FOLLOWING CASES:**

1. If the standard or serial product number will be changed, erased, removed or will be unreadable.
2. Periodic maintenance, repair or changing parts as a result of their normal runout.
3. All adaptations and modifications with the purpose of improvement and expansion of normal sphere of product application, mentioned in the service instruction, without tentative written agreement of the expert provider.
4. Service by anyone other than an authorized service center.
5. Damage to products or parts caused by misuse, including, without limitation, misapplication or negligence of the terms of service instruction.
6. Power supply units, chargers, accessories, wearing parts.
7. Products, damaged from mishandling, faulty adjustment, maintenance with low-quality and non-standard materials, presence of any liquids and foreign objects inside the product.
8. Acts of God and/or actions of third persons.
9. In case of unwarranted repair till the end of warranty period because of damages during the operation of the

product, it's transportation and storing, warranty doesn't resume.

Documents / Resources

	<a href="#">ADA INSTRUMENTS COSMO MINI 40 Laser Distance Meter</a> [pdf] Instruction Manual COSMO MINI 40 Laser Distance Meter, COSMO MINI 40, Laser Distance Meter, Distance Meter, Meter
---	---

References

-  [ADA Instruments](#)