



## Acuity Brands D Series Area LED Luminaires With Motion Sensors Instructions

[Home](#) » [Acuity Brands](#) » Acuity Brands D Series Area LED Luminaires With Motion Sensors Instructions 

### Acuity Brands D Series Area LED Luminaires With Motion Sensors Instructions



## Contents

- 1 LED Important Safety Instructions
- 2 LED Important Safety Instructions
- 3 INTRODUCTION
- 4 INSTALLATION
- 5 Luminaire Installation.
- 6 MAINTENANCE
- 7 AO and PR7/PR7E options
- 8 LIMITED WARRANTY AND LIMITATION OF LIABILITY
- 9 FIELD ADJUSTABLE OUTPUT MODULE
- 10 Documents / Resources
  - 10.1 References

## LED Important Safety Instructions

READ AND FOLLOW ALL SAFETY INSTRUCTIONS!

SAVE THESE INSTRUCTIONS AND DELIVER TO OWNER AFTER INSTALLATION

- To reduce the risk of death, personal injury or property damage from fire, electric shock, falling parts, cuts/abrasions, and other hazards please read all warnings and instructions included with and on the fixture box and all fixture labels.
- Before installing, servicing, or performing routine maintenance upon this equipment, follow these general precautions.
- Installation and service of luminaires should be performed by a qualified licensed electrician.
- Maintenance of the luminaires should be performed by person(s) familiar with the luminaires' construction and operation and any hazards involved. Regular fixture maintenance programs are recommended.
- It will occasionally be necessary to clean the outside of the refractor/lens. Frequency of cleaning will depend on ambient dirt level and minimum light output which is acceptable to user. Refractor/lens should be washed in a solution of warm water and any mild, non-abrasive household detergent, rinsed with clean water and wiped dry. Should optical assembly become dirty on the inside, wipe refractor/lens and clean in above manner, replacing damaged gaskets as necessary.
- **DO NOT INSTALL DAMAGED PRODUCT!** This luminaire has been properly packed so that no parts should have been damaged during transit. Inspect to confirm. Any part damaged or broken during or after assembly should be replaced.
- Recycle: For information on how to recycle LED electronic products, please visit [www.epa.gov](http://www.epa.gov).
- These instructions do not purport to cover all details or variations in equipment nor to provide every possible contingency to meet in connection with installation, operation, or maintenance. Should further information be desired or should particular problems arise which are not covered sufficiently for the purchaser's or owner's purposes, this matter should be referred to Acuity Brands Lighting, Inc.



### WARNING: RISK OF ELECTRIC

- Disconnect or turn off power before installation or servicing.
- Verify that supply voltage is correct by comparing it with the luminaire label information.

- Make all electrical and grounded connections in accordance with the National Electrical Code (NEC) and any applicable local code requirements.
- All wiring connections should be capped with UL approved recognized wire connectors.



**WARNING: RISK OF BURN**

- Allow lamp/fixture to cool before handling. Do not touch enclosure or light source.
- Do not exceed maximum wattage marked on luminaire label.
- Follow all manufacturer's warnings, recommendations and restrictions  
**for:** driver type, burning position, mounting locations/methods, replacement and recycling.



**CAUTION: RISK OF INJURY**

- Wear gloves and safety glasses at all times when removing luminaire from carton, installing, servicing or performing maintenance.
- Avoid direct eye exposure to the light source while it is on.



**CAUTION: RISK OF FIRE**

- Keep combustible and other materials that can burn, away from lamp/lens.
- Do not operate in close proximity to persons, combustible materials or substances affected by heat or drying.

Always read the fixtures complete installation instructions prior to installation for any additional fixture specific warnings.

Please see product specific installation instructions for additional warnings or any applicable FCC or other regulatory statements.

Failure to follow any of these instructions could void product warranties.

For a complete listing of product Terms and Conditions, please visit [www.acuitybrands.com](http://www.acuitybrands.com).

## **LED Important Safety Instructions**



**CAUTION: RISK OF PRODUCT DAMAGE**

- Never connect components under load.
- Do not mount or support these fixtures in a manner that can cut the outer jacket or damage wire insulation.
- Controls for dimming, auto-sensing, or remote control of a luminaire that are not factory-wired to the luminaire must be checked for compatibility with the luminaire prior to installation. LED fixtures must be powered directly off a switched circuit.
- Unless individual product specifications deem otherwise: Do not restrict fixture ventilation. Allow for some

volume of airspace around fixture. Avoid covering LED fixtures with insulation, foam, or other material that will prevent convection or conduction cooling.

- Unless individual product specifications deem otherwise: Do not exceed fixtures maximum ambient temperature.
- Only use fixture in its intended location.
- LED products are Polarity Sensitive. Ensure proper Polarity before installation.
- Electrostatic Discharge (ESD): ESD can damage LED fixtures. Personal grounding equipment must be worn during all installation or servicing of the unit.
- Do not touch individual electrical components as this can cause ESD, shorten lamp life, or alter performance.
- Some components inside the fixture may not be serviceable. In the unlikely event your unit may require service, stop using the unit immediately and contact an ABL representative for assistance.
- Always read the fixtures complete installation instructions prior to installation for any additional fixture specific warnings.
- Always ensure that the electrical distribution system is up to NEC (and any applicable local code) requirements.
- Verify that power distribution system has proper grounding. Lack of proper earth ground can lead to fixture failure and may void warranty

Always read the fixtures complete installation instructions prior to installation for any additional fixture specific warnings.

Please see product specific installation instructions for additional warnings or any applicable FCC or other regulatory statements

Failure to follow any of these instructions could void product warranties.

For a complete listing of product Terms and Conditions, please visit [www.acuitybrands.com](http://www.acuitybrands.com).

Aculux®	Distech Controls™	Healthcare Lighting	Juno ®	nLight®
AEL®	DTL®	Holophane®	Lithonia Lighting	Peerless®
aLight	eldoLED®	Hydrel®	Luminaire LED	Reloc®
aLight	Euerka	Indy	Luminis®	Sensor Switch®
Cyclone	Gotham®	IOTA®	Mark Architectural Li ghting™	Sunoptics ®

Acuity Brands Lighting, Inc. assumes no responsibility for claims arising out of improper or careless installation or handling of its products.

**AFTER INSTALLATION DELIVER THIS MANUAL TO OWNER**

**AUCL3**

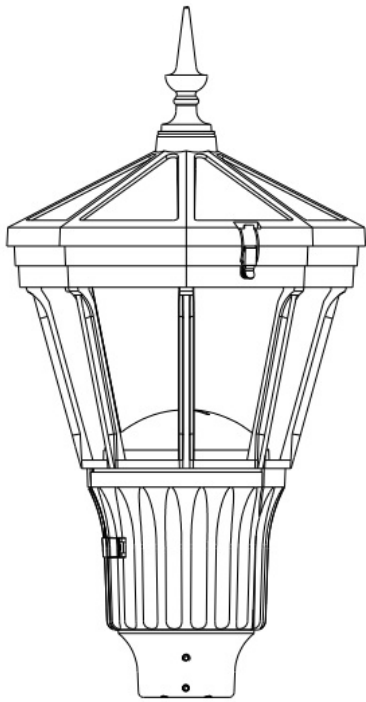

**AUCL3**

PUCL3

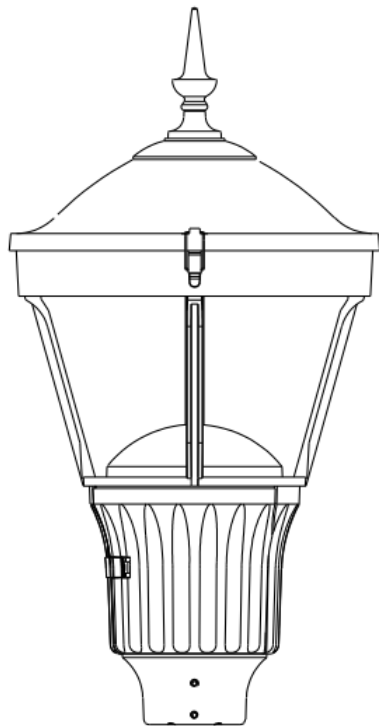

**PUCL3**

WFCL3

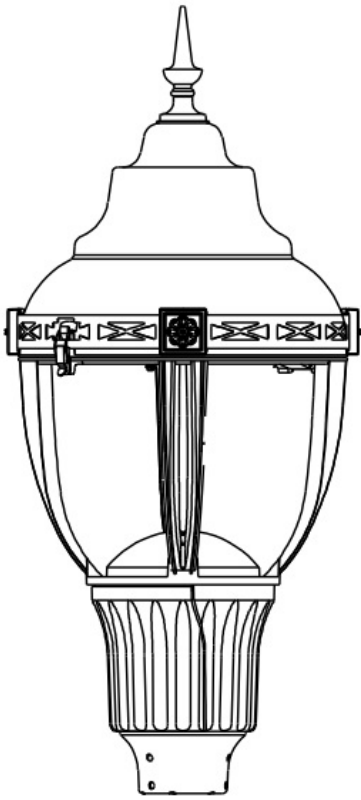

## WFCL3

### IMPORTANT SAFETY INSTRUCTIONS

**WARNING** – READ THESE INSTRUCTIONS CAREFULLY BEFORE ATTEMPTING TO INSTALL OR MAINTAIN THIS FIXTURE. WORK MUST BE DONE BY QUALIFIED PERSONNEL.

**WARNING** – BE CERTAIN THAT ALL ELECTRICAL POWER IS DISCONNECTED FROM THE FIXTURE BEFORE INSTALLING OR MAINTAINING THE FIXTURE.

**FAILURE TO FOLLOW THESE WARNINGS MAY RESULT IN DEATH, INJURY OR SIGNIFICANT PROPERTY DAMAGE**

### INTRODUCTION

#### **Product Description.**

This post top luminaire is designed with LED's which do not require replacement.

The luminaire includes a plug-in electrical module that contains the photocontrol receptacle when specified. These modules are common to all luminaire styles in this series.

This device complies with Part 15 of the FCC Rules. Operation is subject to the following two conditions: (1) this device may not cause harmful interference, and (2) this device must accept any interference received, including interference that may cause undesired operation

### Alternate Information Sources

Holophane  
Field Service Department P.O. Box 3004  
Newark, OH 43058-3004 (866) 759-1577

INSTALLATION

Tools and Material Required.

Table 1. Installation Tools and Materials

DESCRIPTION	USE
Flat-end Screwdriver 3/16" Allen Wrench Torque Wrench	Installation of electrical module 3/8" set screws in pole fitter. Set screws.

Luminaire Installation.

This luminaire is designed to be installed on a bracket or a pole top with a 3" tenon fitter. A latched door on the side of the housing allows access to the driver module and electrical connections. The electrical driver module may remain in place while installing this fitter. If specifically ordered, the luminaire comes with leads pre-wired to terminal block. Make electrical connections per local code. Proceed to section 2.2.4, then section 2.2.7

If pre-wired leads were not ordered, insert the electrical supply wiring into the luminaire's electrical chamber through the hole in the pole fitter. Set the luminaire on its mounting (bracket, tenon, pole top), being careful not to pinch the supply wires. Orient and level the luminaire before tightening all six set screws. Alternate tightening of the screws will assist in leveling and insuring proper attachment. Tighten the set screws to 10 to 12 ft-lbs. of torque. **See Figure 1**

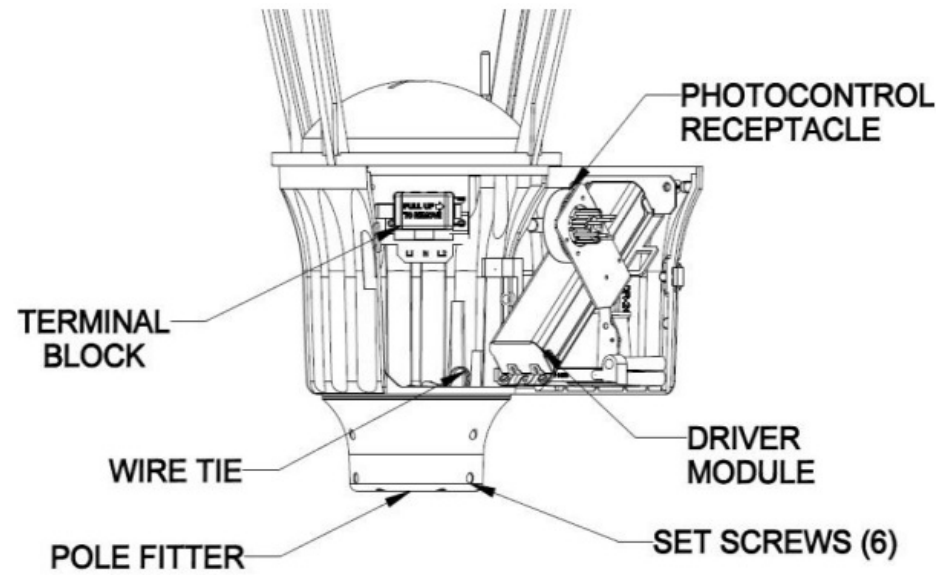

STANDARD LUMINAIRE ORIENTATION NOTES

For all luminaires not including rSBOR units, orient the street side of the luminaire per the below **Figure 2**.

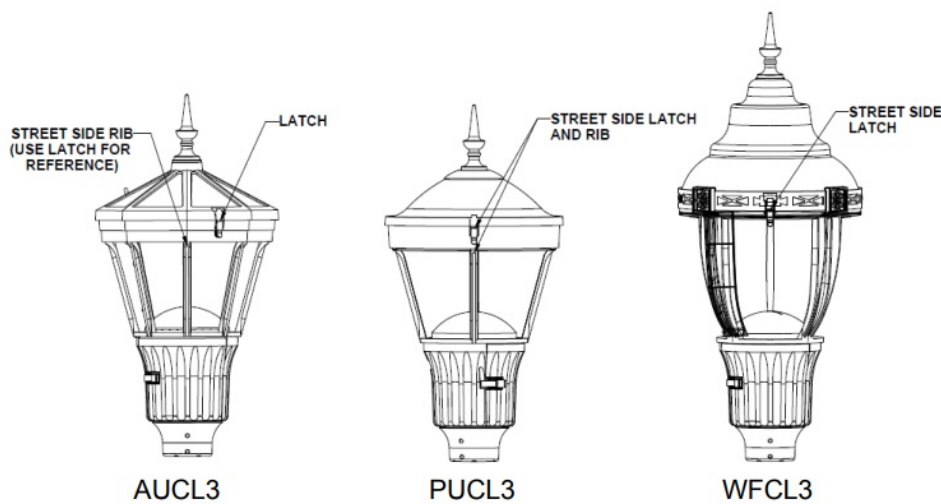

### rSBOR LUMINAIRE OPTIC ORIENTATION NOTES

Luminaires with rSBOR units have a “Street Side” label on the dome cover that indicates the proper orientation of the fixture. Orient this label towards the street. **See Figure 3.**

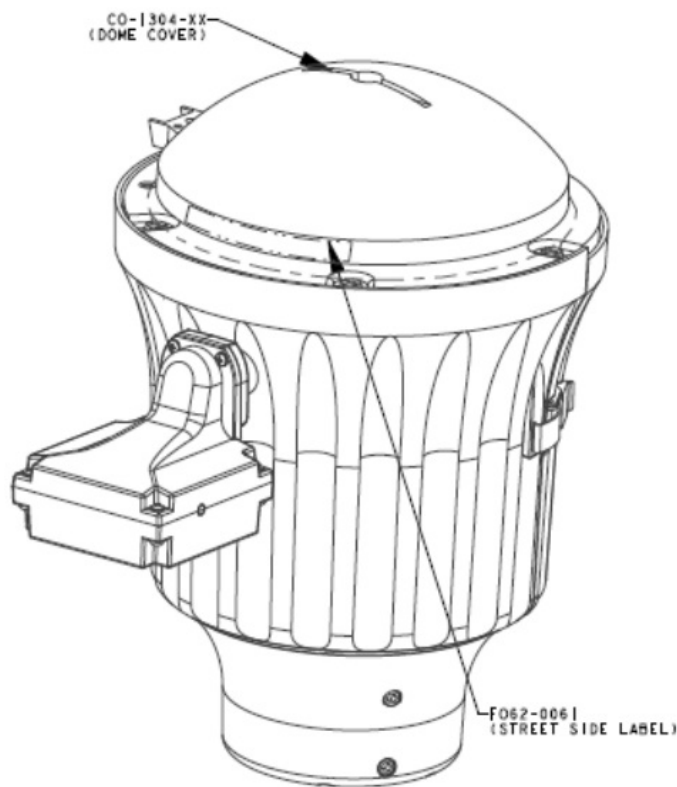

Pass the supply conductors through the wire tie provided, leave enough length for connections. See Figure 1. Connect the electrical supply wires to the terminal block in the back of the electrical chamber. The terminals are marked “L1” (Line 1), “G” (Ground), and “L2” (Line 2). If one of the supply lines is electrically neutral, it should be connected to terminal “L2”. Recommended torque for terminal block screws is 35 in-lbs.

Units with a dimmable driver have 0-10V leads, gray and violet, coming off of the driver. If the unit is to be connected to dimming control gear (not included), trim, strip, and connect these leads according to the dimming control gear manufacturer’s instructions. The violet lead is positive, and the gray (or pink) lead is negative. If the unit is not to be connected to dimming control gear, leave the leads individually capped.

Units supplied with a photo control option require a shorting plug or a twist lock photo control to be installed. Install the device by twisting it clockwise. See Figure 1.

### CAUTION

A PHOTO CONTROL THAT MEETS THE REQUIREMENTS OF ANSI C136.10 AND WITH A CLEAR WINDOW



ON THE SIDE THAT EXPOSES THE PHOTOCELL MUST BE USED

Return internal wiring to original locations and tighten wire tie around supply wires.  
Close the electrical compartment, engage and secure the latch.  
Energize the unit and check for proper operation.

### **Installation of DIN Photocontrol on DINBRA Fixtures**

#### **CAUTION**

WHEN INSTALLED INTERNALLY, DIN PHOTOCONTROLS SHALL ONLY BE INSTALLED IN FIXTURES THAT HAVE BEEN ORDERED WITH THE “DINBRA” OPTION.

To install a Dark to Light® DIN photocontrol (ordered separately) on a fixture ordered with the “DINBRA” option, open the housing door by unlatching and swinging the door open.

Remove the protective plastic cap over the free end of the antenna cable inside the fixture.

Follow the steps shown in the installation video linked below to install and commission the DIN.

<https://youtu.be/IDhz1saajhl>

### **MAINTENANCE**

#### **Cleaning**

Make sure the unit is de-energized.

Wipe off exterior dirt and debris using a soft, clean cloth.

#### **CAUTION**

DO NOT USE ABRASIVE CLEANSERS ON OPTICAL SURFACES. THEIR USE MAY RESULT IN THE LOSS OF OPTICAL EFFICIENCY.

#### **Electrical Component Replacement**

Make sure the unit is de-energized. Open housing door by unlatching and swinging open.

To replace photocontrol, if provided as part of the fixture, twist counterclockwise and remove. Replace with equivalent photocontrol. See Figure 1. If no other components are to be replaced go to Section 3.2.6.

**To replace driver**, disconnect input and output via quick disconnects and remove (2) mounting screws. Replace with Holophane approved driver. **See Figure 4.**

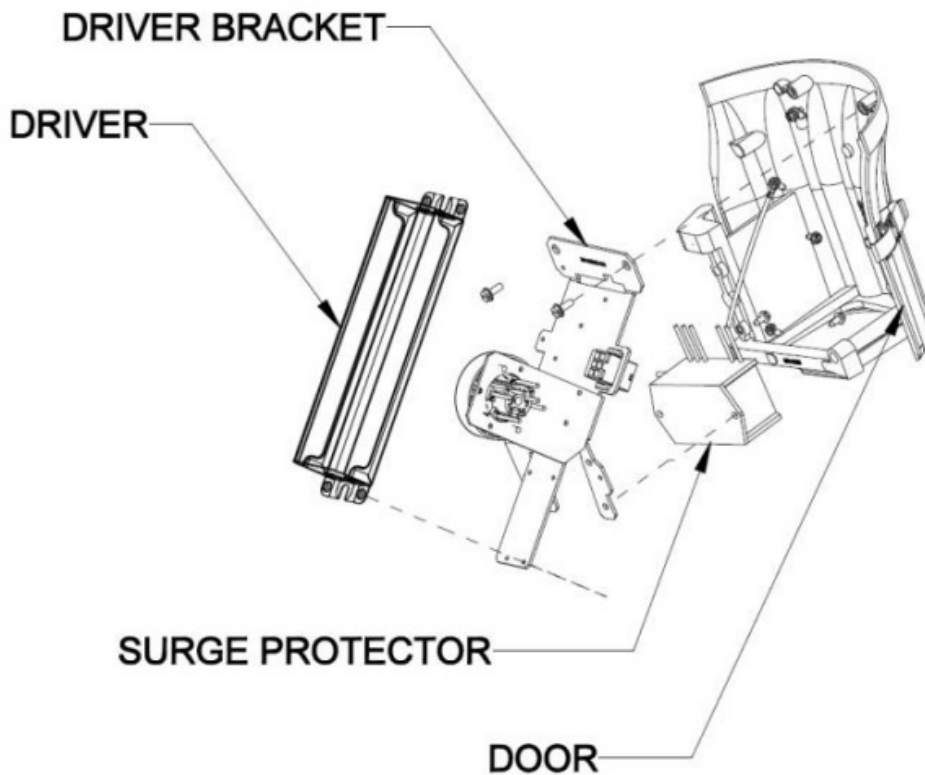

If no other components are to be replaced go to Section 3.2.6.

To remove surge protector, disconnect quick disconnect plug coming from terminal and quick disconnect going to optical compartment. Remove (2) screws connecting driver bracket to door; retain screws for re-installation. Disconnect surge protector via quick disconnect.

Remove (2) screws; retain screws for re-installation. Remove surge protector and replace it with Holophane approved device. Replace (2) screws and connect quick disconnect. See Figure 4.

Replace driver bracket and screws. Reconnect quick disconnect plug from terminal block and quick disconnect plug going to optical compartment. If no other components are to be replaced go to Section 3.2.8

3.2.7 To remove driver module, disconnect quick disconnect plug coming from terminal and quick disconnect going to optical compartment. Remove (2) screws connecting driver bracket to door, retain screws for re-installation. Reinstall new driver module in door. Reconnect quick disconnect plugs from terminal block and quick disconnect plug going to optical compartment. **See Figure 4.**

Bundle and secure the wiring in a manner similar to the way it was originally secured to avoid pinching of wires when re-installing the module into the housing.

Close the housing by carefully swinging the door shut while ensuring no leads are pinched. Engage and secure the latch.

Energize the unit and check for proper operation.

## AO and PR7/PR7E options

When PR7 or PR7E options are ordered with AO, driver dimming leads are wired to the AO module. The 7-pin receptacle dimming leads (Pins 4 & 5) are routed to the driver tray but are capped off enabling a transfer of driver dimming wires from the AO module to the 7-pin receptacle. These leads must be disconnected from the AO

module and reconnected to the PR7 receptacle (Pins 4 and 5) for an adaptive control to function when installed in the PR7/PR7E receptacle.

**LIMITED WARRANTY AND LIMITATION OF LIABILITY**

The Holophane limited warranty and limitation of liability is published in the “Terms and Conditions” section of the current Holophane buyer’s guide and is available from your local Holophane sales representative.

**FIELD ADJUSTABLE OUTPUT MODULE**

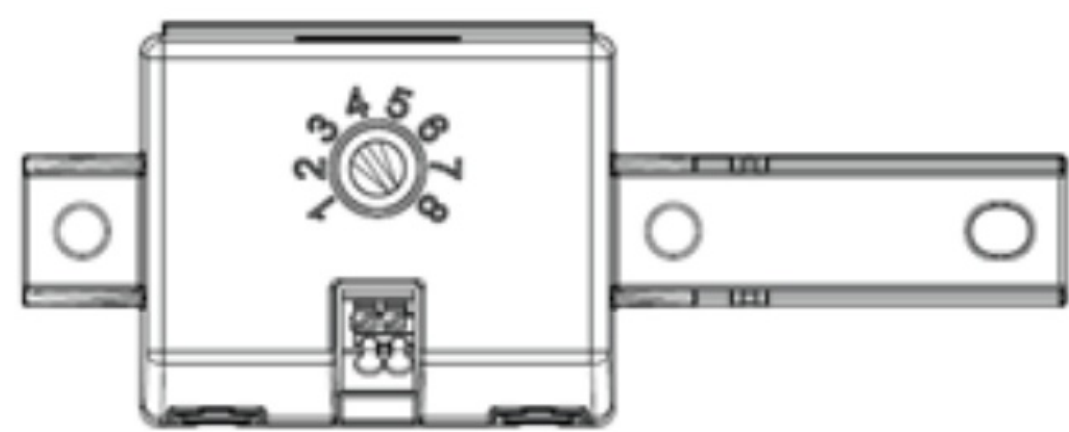

The Field Adjustable Output (AO) module is an onboard device that adjusts the light output and input wattage to meet site specific requirements, allowing a single fixture configuration to be flexibly applied in many different applications. The AO option is available on the AUCL3, PUCL3 and WFCL3 series. The following data tables are for all voltage options.

Performance Package	FAO Position	% Lumen Output	% Wattage
P30-P100	8	100%	100%
	7	95%	94%
	6	83%	81%
	5	72%	69%
	4	59%	56%
	3	46%	44%
	2	33%	32%
	1	19%	20%

Performance Package	FAO Position	% Lumen Output	% Wattage
P30-P100	8	100%	100%
	7	94%	94%
	6	82%	82%
	5	70%	70%
	4	57%	57%
	3	45%	45%
	2	32%	32%
	1	19%	25%



**Acuity Lighting Group, Inc.**

3825 Columbus Rd. S.W. Granville, OH 43023

IM-303 rev H 8/7//23 ©2020 Acuity Lighting Group Inc.

ALL RIGHTS RESERVED. Visit our web site at [www.holophane.com](http://www.holophane.com)

Printed in USA



## Documents / Resources

	<p><a href="#">Acuity Brands D Series Area LED Luminaires With Motion Sensors</a> [pdf] Instructions D Series Area LED Luminaires With Motion Sensors, D Series, Area LED Luminaires With Motion Sensors, Luminaires With Motion Sensors, Motion Sensors</p>
--	--

## References

- [Acuity Brands | Lighting, Controls, and Building Management Solutions](#)
- [Acuity Brands | Lighting, Controls, and Building Management Solutions](#)
- [U.S. Environmental Protection Agency | US EPA](#)
- [U.S. Environmental Protection Agency | US EPA](#)
- [Holophane | Lighting solutions for commercial, industrial, emergency and outdoor applications.](#)
- [Holophane | Lighting solutions for commercial, industrial, emergency and outdoor applications.](#)
- [User Manual](#)

## **Manuals+. Privacy Policy**

This website is an independent publication and is neither affiliated with nor endorsed by any of the trademark owners. The "Bluetooth®" word mark and logos are registered trademarks owned by Bluetooth SIG, Inc. The "Wi-Fi®" word mark and logos are registered trademarks owned by the Wi-Fi Alliance. Any use of these marks on this website does not imply any affiliation with or endorsement.