



ACT Connectivity AC8302 Dual Monitor Arm Instruction Manual

[Home](#) » [ACT Connectivity](#) » ACT Connectivity AC8302 Dual Monitor Arm Instruction Manual 

Contents

- [1 ACT Connectivity AC8302 Dual Monitor Arm](#)
- [2 Documents / Resources](#)
 - [2.1 References](#)
- [3 Related Posts](#)



ACT Connectivity AC8302 Dual Monitor Arm



Product Information

The product is a Monitor Desk Mount designed to hold 2 monitors. Its model number is AC8302. The product is manufactured by ACT, located at Koolhovenstraat 1E, 3772 MT Barneveld, The Netherlands. It comes with a 5-year warranty provided by PAP.

The product is made in China.

Product Usage Instructions

1. Before starting the installation and assembly process, make sure to read the entire instruction manual.
2. Ensure that you have all the necessary components and tools required for the installation.
3. Follow the step-by-step instructions provided in the manual for proper installation and assembly of the Monitor Desk Mount.
4. When assembling the mount, use the specified techniques such as pulling, repositioning, putting, and turning as indicated by the corresponding letters (a, b, c, d) mentioned in the manual.
5. For any safety information regarding the product, please visit www.act-connectivity.com/safety.
6. If you need any service, manuals, firmware updates, or additional information about the product, please visit www.act-connectivity.com.

Read the entire instruction before you start the installation and assembly.

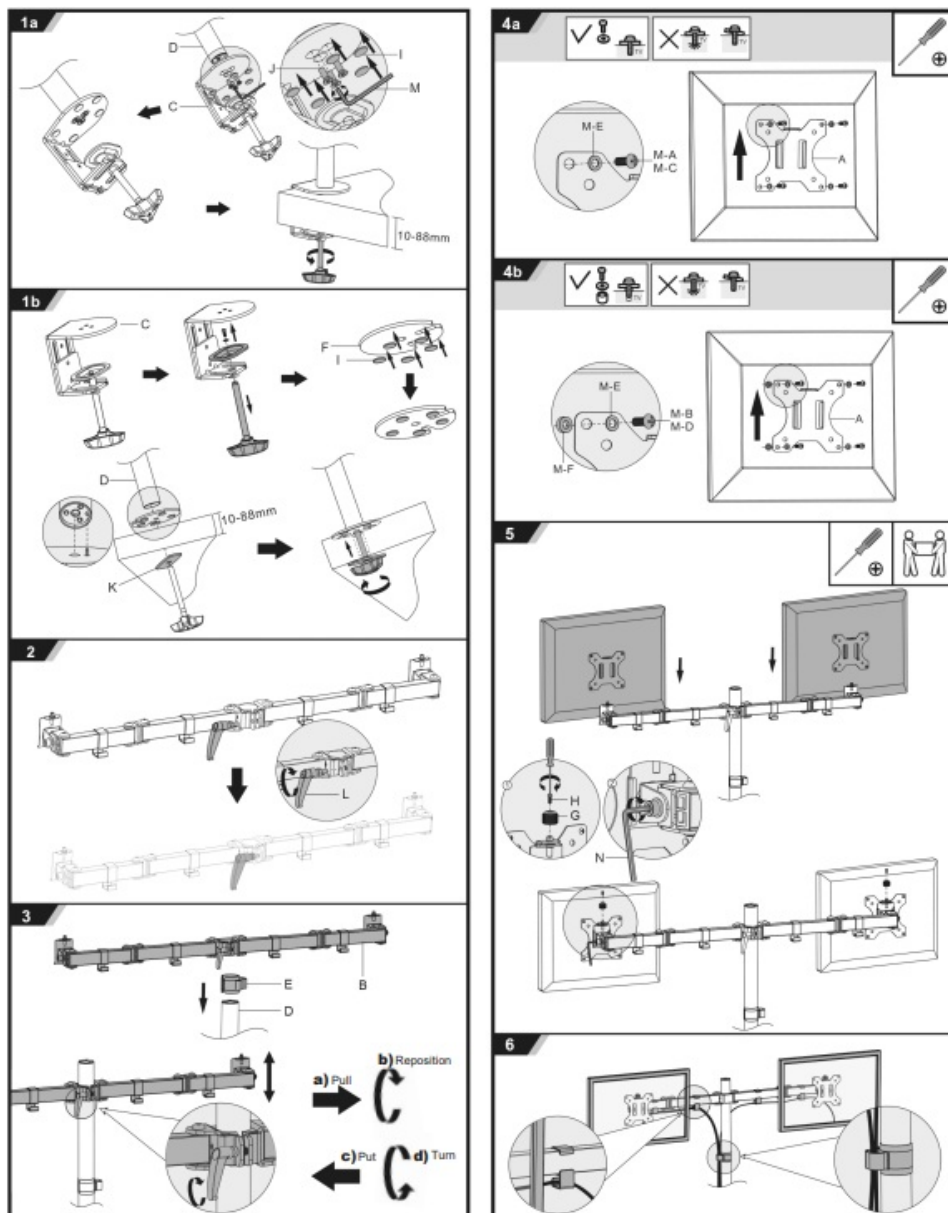

CAUTION: Use with products heavier than the rated weights indicated may result in instability causing possible injury.

- Mounts must be attached as specified in assembly instructions.
- Improper installation may result in damage or serious personal injury.
- Make sure that the supporting surface will safely support the combined weight of the equipment and all attached hardware and components
- Use the mounting screws provided and DO NOT OVER-TIGHTEN mounting screws.
- This product contains small items that could be a choking hazard if swallowed. Keep these items away from children
- This product is intended for indoor use only. Using this product outdoors could lead to product failure and injury.
- **IMPORTANT:** Ensure that you have received all parts according to the component checklist prior to the installation.
- **MAINTENANCE:** Check that the bracket is secure and safe to use at regular intervals (at least every three months).

You can find safety information at www.act-connectivity.com/safety

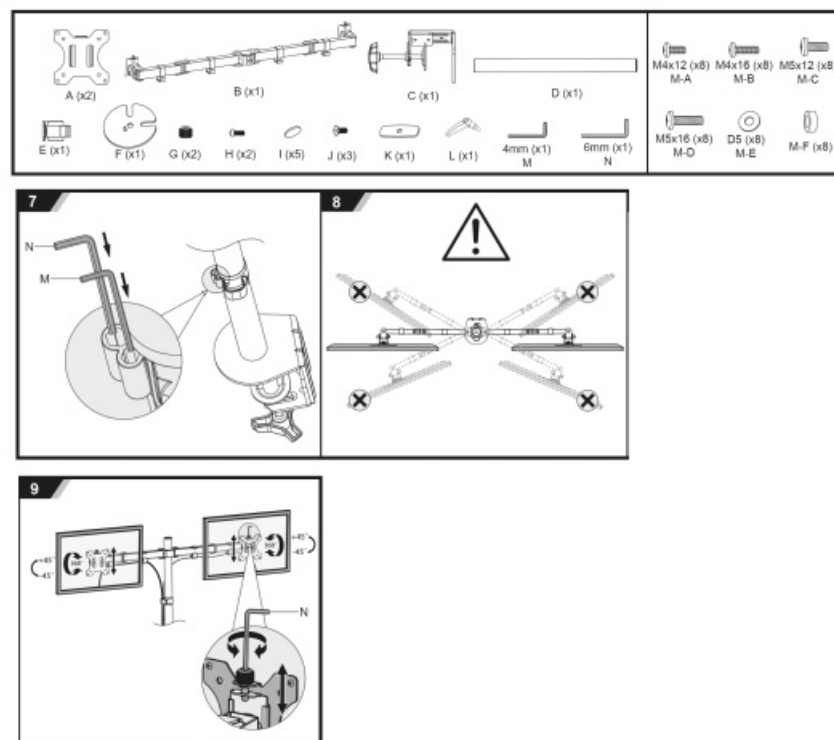

Documents / Resources

	<p>ACT Connectivity AC8302 Dual Monitor Arm [pdf] Instruction Manual AC8302, AC8302 Dual Monitor Arm, Dual Monitor Arm, Monitor Arm, Arm</p>
--	--

References

- [Safety instructions | ACT](#)
- [Online Review & Business Listing Management | Connectivity](#)
- [Home | ACT](#)

- [A Safety instructions | ACT](#)

Manuals+