



Installation Guide

Contents [[hide](#)]

- [1 93799 Mudguard Set](#)
- [2 GENERAL READ AND KEEP THE MANUAL](#)
- [3 SAFETY INSTRUCTIONS FOR ACCESSORIES](#)
- [4 OPERATION](#)
- [5 MAINTENANCE](#)
- [6 CLEANING AND CARE](#)
- [7 OTHER INFORMATION](#)
- [8 Documents / Resources](#)
 - [8.1 References](#)

93799 Mudguard Set

This exploded view diagram illustrates the components of a bicycle seat assembly, numbered 1 through 25. The parts are distributed as follows:

- Top Row:**
 - Part 1 (x1): A long, curved seat rail.
 - Part 2 (x1): A small bracket with two pins.
 - Part 3 (x1): A black plastic cap with a hole.
 - Part 4 (x3): A small circular washer.
- Second Row:**
 - Part 5 (x1): A long, curved seat rail.
 - Part 6 (x1): A metal bracket with a pin.
 - Part 10 (x1): A long, curved seat rail.
- Third Row:**
 - Part 11 (x2): Two circular washers.
 - Part 12 (x2): Two small circular washers.
 - Part 13 (x2): Two black plastic caps.
 - Part 14 (x2): Two black plastic caps.
 - Part 15 (x6): Six small circular washers.
 - Part 16 (x4): Four black plastic caps.
- Fourth Row:**
 - Part 19 (x1): A long, curved seat rail.
 - Part 21 (x1): A black plastic cap with a hole.
 - Part 22 (x1): A metal bracket with a pin.
 - Part 23 (x1): A small circular washer.
- Fifth Row:**
 - Part 24 (x1): A black plastic cap with a hole.
 - Part 25 (x3): Three small circular washers.
 - Part 17 (x2): Two metal brackets with pins.
 - Part 18 (x2): Two black plastic caps.

Exploded view diagram of a bicycle fender assembly. The parts are numbered 1 through 20:

- 1 x 1**: Curved fender main body.
- 2 x 1**: Long, thin fender stay.
- 3 x 1**: Small bracket with two mounting tabs.
- 4 x 2**: Bolt with a washer.
- 5 x 3**: Washer.
- 6 x 1**: Small bracket with a single mounting tab.
- 7 x 1**: Bolt with a washer.
- 8 x 1**: Small bracket with a single mounting tab.
- 9 x 1**: Long, thin fender stay.
- 10 x 4**: Bolt with a washer.
- 11 x 4**: Bolt with a washer.
- 12 x 4**: Bolt with a washer.
- 13 x 4**: Bolt with a washer.
- 14 x 1**: Small bracket with a single mounting tab.
- 15 x 1**: Bolt with a washer.
- 16 x 1**: Bolt with a washer.
- 17 x 1**: Curved fender main body.
- 18 x 1**: Long, thin fender stay.
- 19 x 1**: Small bracket with a single mounting tab.
- 20 x 1**: Bolt with a washer.

#93799
Mudguard Set
Editor Hybrid 60 28"
BB-Mount 2.0

#93998
Mudguard Set
Nuroad/Nulane 60 28"
BB-Mount 2.0

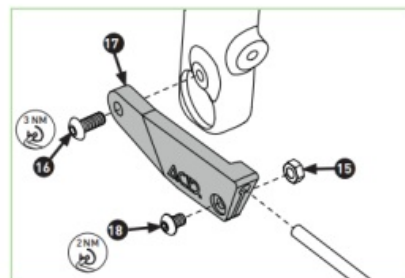
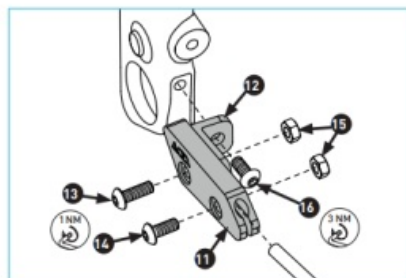
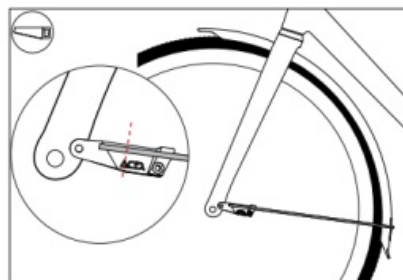
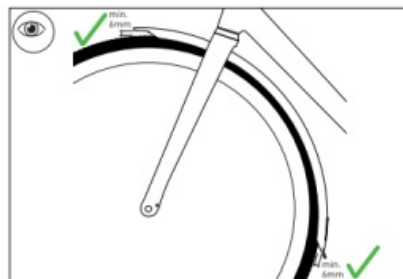
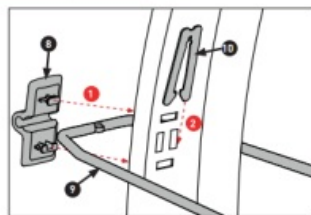
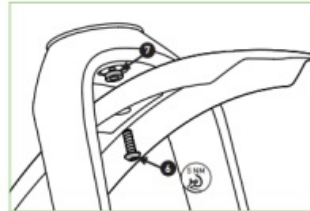
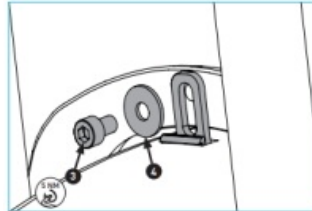
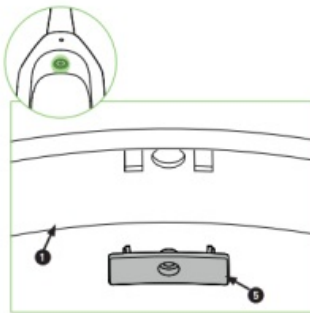
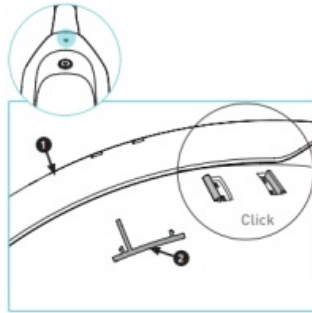

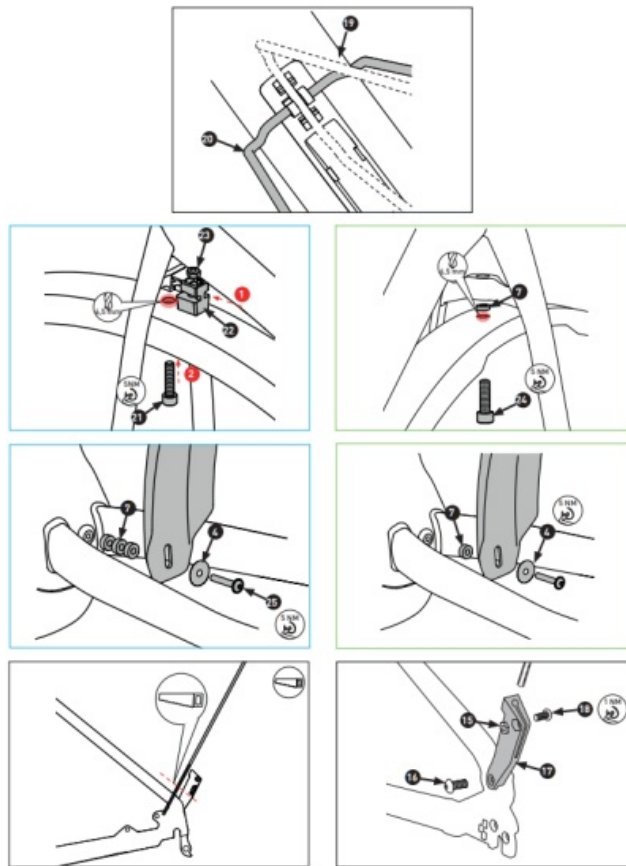

GENERAL READ AND KEEP THE MANUAL



This and other accompanying instructions contain important information on the assembly, initial operation, and maintenance of the product.

Read all enclosed instructions carefully before assembling or using the product, especially the general safety instructions. Non-observance of this manual may result in serious injury or damage to the product itself and your vehicle.

Keep the enclosed instructions close to hand for further use.

If you pass on the product or the vehicle equipped with the product to a third party, always include all accompanying instructions.

The enclosed instructions are subject to European legislation. If the product or vehicle is delivered outside Europe, the manufacturer/importer may have to provide additional instructions.

EXPLANATION OF SYMBOLS

The following symbols and signal words are used in the enclosed instructions, on the product or on the packaging.

WARNING!







A medium risk of hazard which may result in death or serious injury if not avoided.

CAUTION!

A low risk of hazard which may result in moderate or minor injury if not avoided

NOTICE!

Warning of possible damage to property.

	Useful additional information for assembly or operation.
	Read and observe the enclosed instructions.
	Reference to further documentation – See instructions (Doc. – Number)
	Use a torque wrench. Use the torque values indicated in the symbol.
	Drill a hole at the marked position. Use the drill diameter indicated in the symbol.
	Observe indication sound.
	Trim with suitable tool.

SAFETY INSTRUCTIONS FOR ACCESSORIES

WARNING!

NORMAL USAGE

Use the product only as described in the manual. Any other use is considered as improper and may result in an accident, serious injury or damage to the bicycle.

The manufacturer or dealer accepts no liability for damage caused by improper or incorrect use.

- » Follow the bicycle manufacturer's instructions before attaching and using the product.
- » The range of use of the bicycle always changes to use category 2 (asphalt road, bike paths, forest roads and dirt roads) when using this product.

» Use only parts and accessories intended for the product. Components from other manufacturers may affect optimal function.

Assembly

We at CUBE strongly recommend that you have this product assembled by your dealer. Improper assembly or assembly sequence can lead to serious falls.

- » Before assembly, check the scope of delivery of the product for completeness.
- » If the scope of delivery for the product is not complete or if you notice any damage, sharp edges or burrs on the product, components or bicycle, do not use it.
- » Have the product and the vehicle checked by your dealer.
- » If you are uncertain or do not have the necessary knowledge, have your specialist dealer install the product.
- » Make sure your bicycle is suitable for the retrofitting of a luggage rack.
- » Do not make any structural changes to the product.
- » If you intend to combine this product with bicycle of other manufacturers, be sure to check their specifications and check dimensional accuracy and compatibility according to the instructions in the enclosed manuals and the owner's manual of your bicycle.
- » Screw connections must be tightened correctly with a torque wrench and with correct torque values. If you are not experienced in using a torque wrench or do not have a suitable torque wrench, have loose screw connections checked by your dealer.
- » Note special torques for components made of aluminum or carbon fiber reinforced polymer. Please also read and follow the operating instructions of your bicycle.

OPERATION

Please note that accessories can have a significant influence on the characteristics of the bicycle.

- » The additional weight may change the driving properties of your vehicle, in particular the steering and braking behaviour. Adapt your driving style to the changed driving properties.
- » Observe the instructions on the packaging,
- » to approved vehicles.
- » to approved wheel sizes.
- » to the maximum load capacity of the luggage carrier.

- » Observe the specifications regarding the maximum permissible total weight of the bicycle.
- » It is only safe to transport luggage if it is transported firmly secured to the product.
- » When loading the product,
 - » ensure that the luggage is evenly distributed on both sides of the product and, if necessary, place it as far down as possible in the panniers to achieve a low centre of gravity of the luggage.
 - » ensure that the accessories and fastening elements used, such as tensioning straps or similar, are securely attached and cannot get into moving parts.
 - » ensure that no lighting components (headlamps, tail lamp, reflectors) are covered.
- » Never install a child's seat on the product.
- » Never install a trailer on the product.

MAINTENANCE

Prevent malfunctions due to excessive wear, material fatigue or loose screw connections:

- » Check all attached components for tight fit and functionality before each use.
- » Do not use the product, accessories used, fastening elements, such as tensioning straps or similar, and your vehicle if you discover excessive wear or loose screw connections.
- » Do not use the vehicle if you notice cracks, deformation or color changes.
- » Have the bicycle inspected immediately by your dealer if you notice excessive wear, loose screw connections, deformation, cracks or color changes.

CLEANING AND CARE

NOTICE!

RISK OF DAMAGE!

Improper handling of cleaning agents can cause damage to the product.

- » Do not use aggressive cleaning agents, brushes with metal or nylon bristles or sharp or metallic cleaning objects such as knives, hard spatulas and the like. These can damage the surfaces and the product.

Clean the product regularly with water (add a mild detergent if necessary) and a soft cloth.

STORAGE

All parts must be completely dry before storage.

- » Always store the product in a dry place.
- » Protect the product from direct sunlight.

DISPOSAL



Dispose of the packaging according to its type. Add cardboard and cartons to your waste paper collection, and films and plastic parts to your recyclables collection.

Dispose of the product in accordance with the laws and regulations valid in your country.

LIABILITY FOR MATERIAL DEFECTS

If there are any defects, please contact the dealer from whom you purchased the product.

In order to ensure that your complaint is processed smoothly, it is necessary for you to present proof of purchase and proof of inspection.

Please keep them in a safe place.

To ensure a long service life and durability of your product or your vehicle, you may only use it in accordance with its intended purpose. It is essential that you observe the information in the operating instructions of your bicycle.

OTHER INFORMATION

 Please visit us occasionally on our website at www.CUBE.eu. There you will find news, information and the latest versions of our manuals as well as the addresses of our specialist dealers.

Pending System GmbH & Co. KG

Ludwig-Hüttner-Str. 5-7

D-95679 Waldershof

+49 (0)9231 97 007 80

www.cube.eu

Documents / Resources

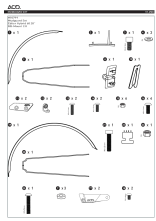

[ACID 93799 Mudguard Set \[pdf\]](#) Installation Guide

93799, 93998, 93799 Mudguard Set, 93799, Mudguard Set, Set

References

- [🔌 HOME | CUBE Bikes](#)
- [🔌 HOME | CUBE Bikes](#)
- [User Manual](#)

🔑 93799, 93799 Mudguard Set, 93998, Acid, Mudguard Set,

📁 ACID Set

—Previous Post

[ACID Towing System Instruction Manual](#)

Next Post—

[ACID Pure C100, Rigid Pure C120 Folding Lock Rigid Instruction Manual](#)

Leave a comment

Your email address will not be published. Required fields are marked *

Comment *

Name

Email

Website

☐ Save my name, email, and website in this browser for the next time I comment.

Post Comment

[Manuals+](#), [Privacy Policy](#) | [@manuals.plus](#) | [YouTube](#)

This website is an independent publication and is neither affiliated with nor endorsed by any of the trademark owners. The "Bluetooth®" word mark and logos are registered trademarks owned by Bluetooth SIG, Inc. The "Wi-Fi®" word mark and logos are registered trademarks owned by the Wi-Fi Alliance. Any use of these marks on this website does not imply any affiliation with or endorsement.