



## acer X2SCC Smart Cycling Computer User Manual

[Home](#) » [Acer](#) » acer X2SCC Smart Cycling Computer User Manual 



acer X2SCC Smart Cycling Computer



## Contents



- 1 [BUTTON FUNCTIONALITY](#)
- 2 [PAIR PHONE](#)
- 3 [INSTALL THE STANDARD MOUNT](#)
- 4 [PAIR SENSORS](#)
- 5 [GO FOR A RIDE](#)
- 6 [CONTACT US](#)
- 7 [WARNING](#)
- 8 [Documents / Resources](#)
- 9 [Related Posts](#)

## BUTTON FUNCTIONALITY

1. POWER/MENU 
2. BACK/LAP 
3. ENTER/START 
4. SCROLL UP 
5. SCROLL DOWN 



## PAIR PHONE

- Download **IGPSPORT** APP (Ensure Bluetooth is on).
- Press  to get to the menu.
- Select **Pair Phone**, then press .

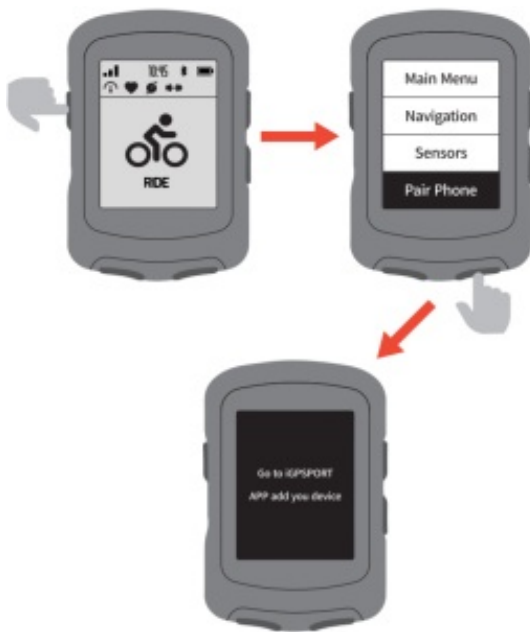
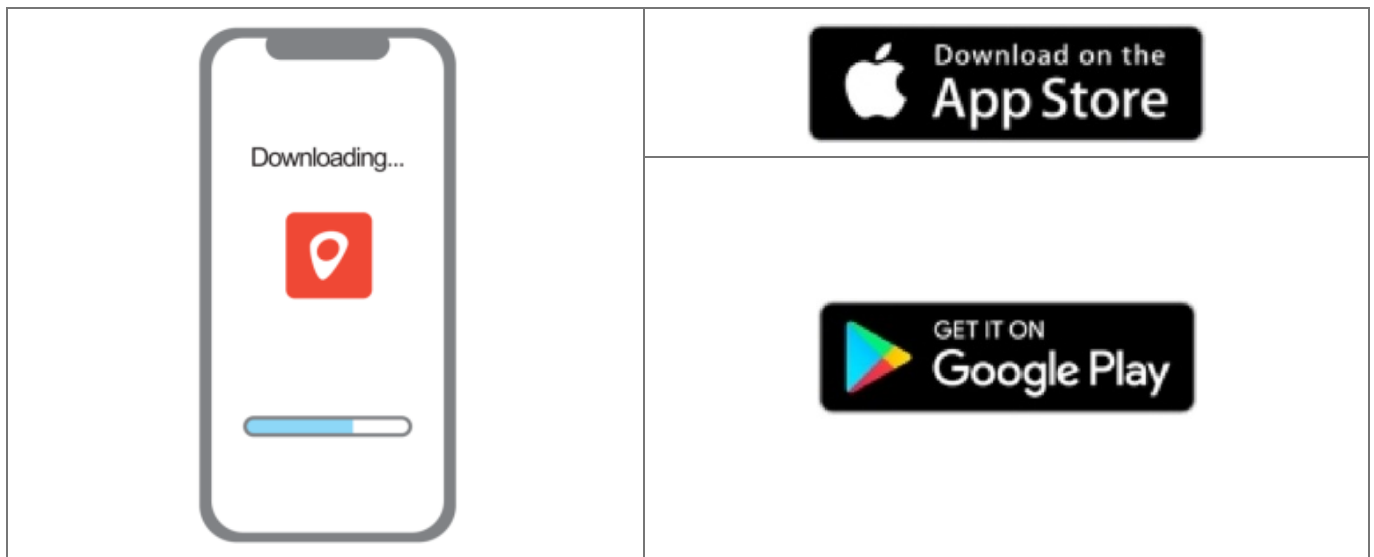

## INSTALL THE STANDARD MOUNT

- Use the included zip ties to attach to bike stem.



## PAIR SENSORS

- Press  to get to the menu.

- Select **Sensors**.
- Activate the sensor and hold near iGS520.
- Select the sensor and press ►|| to save.



## GO FOR A RIDE

- Go outside, and wait while the device locates satellites.
- Press ►|| to go to ride page.
- Press ►|| to start / stop an activity.
- Press  to get to the menu and select Save to save ride



- Go 10 WMY.~psportcanfurde<ailed insiuction III<nJaJ.

## CONTACT US

 [www.igpsport.com](http://www.igpsport.com)



Wuhan Qiwu Technology Co., Ltd



Hongshan District, Wuhan City, Hubei Province, China.



(86)27-87835568



[info@igpsport.com](mailto:info@igpsport.com) | [service@igpsport.com](mailto:service@igpsport.com)

## WARNING

This device complies with part 15 of the FCC Rules. Operation is subject to the condition that this device does not cause harmful interference (1) this device may not cause harmful interference, and (2) this device must accept any interference received, including interference that may cause undesired operation.

Any changes or modifications not expressly approved by the party responsible for compliance could void the user's authority to operate the equipment. NOTE: This equipment has been tested and found to comply with the limits for a Class B digital device, pursuant to Part 15 of the FCC Rules. These limits are designed to provide reasonable protection against harmful interference in a residential installation. This equipment generates, uses and can radiate radio frequency energy and, if not installed and used in accordance with the instructions, may cause harmful interference to radio communications. However, there is no guarantee that interference will not occur in a particular installation. If this equipment does cause harmful interference to radio or television reception, which can be determined by turning the equipment off and on, the user is encouraged to try to correct the interference by one or more of the following measures:

- Reorient or relocate the receiving antenna.
- Increase the separation between the equipment and receiver.
- Connect the equipment into an outlet on a circuit different from that to which the receiver is connected.
- Consult the dealer or an experienced radio/TV technician for help.

To maintain compliance with FCC's RF Exposure guidelines, This equipment should be installed and operated with minimum distance between 20cm the radiator your body: Use only the supplied antenna. FCC ID:

## SPECIFICATIONS:

**Operating Temperature: -10°~50°C**

## Documents / Resources



[acer X2SCC Smart Cycling Computer](#) [pdf] User Manual

X2SCC, HLZX2SCC, X2SCC Smart Cycling Computer, X2SCC, Smart Cycling Computer