



# ACCURITE Set & Forget Alarm Clock Instruction Manual

[Home](#) » [ACCURITE](#) » ACCURITE Set & Forget Alarm Clock Instruction Manual 

## Contents

- 1 ACCURITE
- 2 Set & Forget Alarm Clock Instruction Manual
  - 2.1 Unpacking Instructions
- 3 Package Contents
  - 3.1 IMPORTANT
- 4 Features & Benefits
- 5 SETUP
  - 5.1 Clock Setup
  - 5.2 Install or Replace Batteries
- 6 Set & Forget® Clock
- 7 Set the Time & Date
  - 7.1 Set the AUTO DAYLIGHT SAVING TIME (DST):
- 8 OPERATION
  - 8.1 Using the Alarm Clock Set the Alarm Time
  - 8.2 Alarm Clock ON or OFF function
  - 8.3 Alarm Clock SNOOZE function
- 9 Replace Set & Forget® Battery
- 10 Specifications
- 11 FCC Information
- 12 Customer Support
- 13 Limited One Year Warranty
  - 13.1 [www.AcuRite.com](http://www.AcuRite.com)
- 14 Documents / Resources
  - 14.1 References
- 15 Related Posts

**ACCURITE**

**Set & Forget Alarm Clock  
Instruction Manual**

Model: 19956 / 19958



**Questions? Contact Customer Support at**  
(877) 221-1252 or visit [www.AcuRite.com](http://www.AcuRite.com)

**SAVE THIS MANUAL FOR FUTURE REFERENCE.**

Congratulations on your new AcuRite product. To ensure the best possible product performance, please read this manual in its entirety and retain it for future reference.

**Unpacking Instructions**

Remove the protective film that is applied to the LCD screen prior to using this product. Locate the tab and peel off to remove.

**Package Contents**

1. Alarm clock
2. Instruction Manual

**IMPORTANT**

PRODUCT MUST BE REGISTERED TO RECEIVE WARRANTY SERVICE

**PRODUCT REGISTRATION**

Register online to receive 1 year warranty protection  
[www.AcuRite.com](http://www.AcuRite.com)

**Features & Benefits**



1. ALARM ON/OFF Switch
2. TIME SET Button
3. MONTH/HOUR Button
4. SNOOZE/LIGHT Button
5. YEAR/DAY/MINUTE Button
6. ALARM SET Button
7. AUTO DST- ON/OFF Switch
8. Time Zone Dial
9. Main Battery Compartment
10. Backup Battery Compartment
11. Battery Compartment Cover

## SETUP

### Clock Setup



## Install or Replace Batteries

1. Remove battery compartment cover.
2. Insert 2 x AAA alkaline batteries into the battery compartment, as shown. Follow the polarity (+/-) diagram in the battery compartment.
3. Replace the battery cover.

## Set & Forget® Clock

Set & Forget® clock and calendar are pre-programmed to the correct time and date, and update automatically for Daylight Savings Time. All you need to do is select your time zone using the “TIME ZONE” dial.

### Set the Time & Date

Choose the correct time zone (HAST AKST PST MST CST EST AST) using the “TIME ZONE” dial on the bottom of the clock in the battery compartment.

Choose Daylight Savings Time ON or OFF using the DST switch on the top of the clock. If you live in an area that observes Daylight Savings Time, DST should be set to ON, even if it is not currently Daylight Savings Time.

Press and release the “TIME SET” button to enter the SET MODE. Once in the SET MODE the preference you are currently in will blink on the clock.

To save your adjustments, press and release the “TIME SET” button to adjust the next preference. The preference order is as follows:

**CALENDAR DATE**

**CALENDAR YEAR**

**TIME** (Please note PM Indicator light)

You will not automatically exit SET MODE until “TIME SET” is pressed after adjusting the time. Enter SET MODE any time by pressing and releasing “TIME SET”.

**PLEASE DISPOSE OF OLD OR DEFECTIVE BATTERIES IN AN ENVIRONMENTALLY SAFE WAY AND IN ACCORDANCE WITH YOUR LOCAL LAWS AND REGULATIONS.**

**BATTERY SAFETY:** Clean the battery contacts and also those of the device prior to battery installation. Remove batteries from equipment which is not to be used for an extended period of time. Follow the polarity (+/-) diagram in the battery compartment. Promptly remove dead batteries from the device. Dispose of used batteries properly. Only batteries of the same or equivalent type as recommended are to be used. DO NOT incinerate used batteries. DO NOT dispose of batteries in fire, as batteries may explode or leak. DO NOT mix old and new batteries or types of batteries (alkaline/standard). DO NOT use rechargeable batteries. DO NOT recharge non-rechargeable batteries. DO NOT short-circuit the supply terminals.

### Set the AUTO DAYLIGHT SAVING TIME (DST):

The following chart illustrates the differences between the auto DST settings and when each setting automatically changes the time during the year.

| NEW DST  | ON  | OFF            |
|--|---|----------------|
| <b>2007 and beyond:</b><br>2:00 am 2nd Sunday in March<br>2:00 am 1st Sunday in November | <b>2006:</b><br>2:00 am 1st Sunday in April<br>2:00 am last Sunday in October | No DST changes |

**AUTO DST NOTE:** Portions of Indiana and Arizona do not observe daylight savings time. If you live in an area that does not observe daylight saving time, slide the "AUTO DST" switch to the "OFF" position.

## OPERATION

### Using the Alarm Clock Set the Alarm Time

To set alarm time, press and hold the "ALARM SET" button to enter ALARM SET MODE. The "AL" indicator will appear on the display.

To adjust the alarm time, press and release the "MONTH/HOUR" to adjust hours or "YEAR/DAY/MINUTE" button to adjust the minutes (press and HOLD to fast adjust).

To save your adjustments, release the "ALARM SET" button.

You will automatically exit ALARM SET MODE when the ALARM SET button is released. Enter ALARM SET MODE by pressing and holding the "ALARM SET" button.

### Alarm Clock ON or OFF function

To Turn Alarm on: Slide the "ALARM ON/OFF" switch to ON and the ALARM ON icon appears on the screen.  
To Turn Alarm off: Slide the "ALARM ON/OFF" button to OFF and the ALARM ON icon disappears from the screen.

### Alarm Clock SNOOZE function

When the alarm is sounding, activate the 8 minute SNOOZE function by pressing the SNOOZE button at the top of the alarm clock. SNOOZE function can be activated up to 10 times, then alarm is deactivated.

### Replace Set & Forget® Battery

Set & Forget® technology is powered by 2 pre-installed coin-cell batteries that store the time and date settings. The battery has a shelf life of several years. To replace the Set & Forget® battery:

DO NOT change the backup battery and the main battery at the same time.

This will cause the clock to be without any power and the internal calendar memory will no longer function properly.

1. Locate the coin cell battery compartment door on the back of the display unit. Unscrew and remove the compartment cover.
2. Insert 2 x L1142 coin cell battery into the battery compartment, as shown. Install battery with “+” positive terminal facing OUT.
3. Screw in the battery cover.

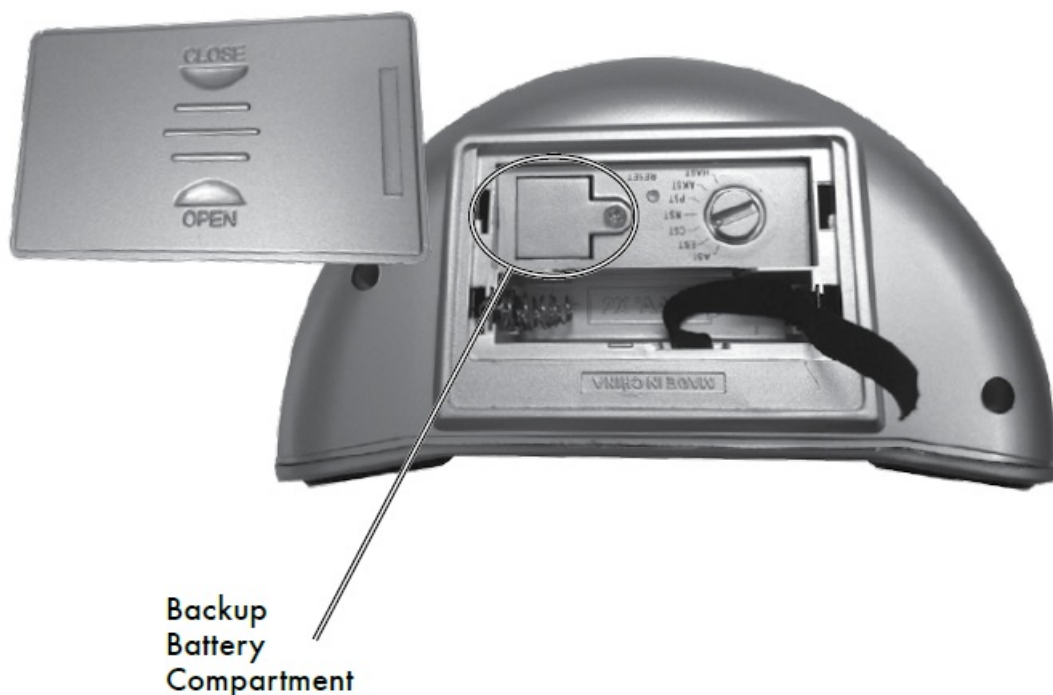

**WARNING:** THIS PRODUCT CONTAINS A BUTTON-CELL BATTERY. IF SWALLOWED, IT~ COULD CAUSE SEVERE INJURY OR DEATH IN JUST 2 HOURS. SEEK MEDICAL ATTENTION IMMEDIATELY IF INGESTED.

## Specifications

**POWER:** 2 x AAA batteries

## FCC Information

This device complies with part 15 of FCC rules. Operation is subject to the following two conditions:

1. This device may NOT cause harmful interference, and
2. This device must accept any interference received, including interference that may cause undesired operation.

**WARNING:** Changes or modifications to this unit not expressly approved by the party responsible for compliance could void the user's authority to operate the equipment.

**NOTE:** This equipment has been tested and found to comply with the limits for a Class B digital device, pursuant to Part 15 of the FCC rules. These limits are designed to provide reasonable protection against harmful interference in a residential installation.

This equipment generates, uses and can radiate radio frequency energy and, if not installed and used in accordance with the instructions, may cause harmful interference to radio communications. However, There is no guarantee that interference will not occur in a particular installation. If this equipment does cause harmful interference to radio or television reception, which can be determined by turning the equipment off and on, the user is encouraged to try to correct the interference by one or more of the following measures:

- Reorient or relocate the receiving antenna.
- Increase the separation between the equipment and the receiver.
- Connect the equipment into an outlet on a circuit different from that to which the receiver is connected.
- Consult the dealer or an experienced radio/TV technician for help.

**NOTE:** The manufacturer is not responsible for any radio or TV interference caused by unauthorized modifications to this equipment.

Such modifications could void the user authority to operate the equipment.  
This device complies with Industry Canada licence-exempt RSS standard(s).  
Operation is subject to the following two conditions:

1. This device may not cause interference, and
2. This device must accept any interference received, including interference that may cause undesired operation of the device.

## **Customer Support**

AcuRite customer support is committed to providing you with best-inclass service. For assistance, please have the model number of this product available and contact us in any of the following ways:

**Phone: (877) 221-1252**

**Email: [info@chaney-inst.com](mailto:info@chaney-inst.com)**

## **Limited One Year Warranty**

At AcuRite, we proudly uphold our commitment to quality technology. Chaney Instrument Co. warrants that all products it manufactures to be of good material and workmanship, and to be free of defects when properly installed and operated for a period of one year from the date of purchase.

We recommend that you visit us at [www.AcuRite.com](http://www.AcuRite.com) for the fastest way to register your product. However, product registration does not eliminate the need to retain your original proof of purchase in order to obtain warranty benefits.

Chaney Instrument Co. warrants that all products it manufactures to be of good material and workmanship, and to be free of defects when properly installed and operated for a period of one year from the date of purchase. Remedy for breach of this warranty is limited to repair or replacement of the defective item(s). Any product which, under normal use and service, is proven to breach the warranty contained herein within ONE YEAR from date of sale will, upon examination by Chaney, and at its sole option, be repaired or replaced by Chaney. Transportation costs and charges for returned goods shall be paid for by the purchaser. Chaney hereby disclaims all responsibility for such transportation costs and charges. This warranty will not be breached, and Chaney will give no credit for products it manufactures which have received normal wear and tear, been damaged (including by acts of nature), tampered, abused, improperly installed, damaged in shipping, or repaired or altered by others.

than authorized representatives of Chaney.

The above-described warranty is expressly in lieu of all other warranties, express or implied, and all other warranties are hereby expressly disclaimed, including without limitation the implied warranty of merchantability and the implied warranty of fitness for a particular purpose. Chaney expressly disclaims all liability for special, consequential or incidental damages, whether arising in tort or by contract from any breach of this warranty. Some states do not allow the exclusion or limitation of incidental or consequential damages, so the above limitation or exclusion may not apply to you. Chaney further disclaims all liability from personal injury relating to its products to the extent permitted by law. By acceptance of any of Chaney's products, the purchaser assumes all liability for the consequences arising from their use or misuse. No person, firm or corporation is authorized to assume for Chaney any other liability in connection with the sale of its products. Furthermore, no person, firm or corporation is authorized to modify or waive the terms of this paragraph, and the preceding paragraph, unless done in writing and signed by a duly authorized agent of Chaney. This warranty gives you specific legal rights, and you may also have other rights which vary from state to state.

For in-warranty claims: Chaney Instrument Co.  
965 Wells St., Lake Geneva, WI 53147

# ACURITE®



Weather  
Stations



Temperature  
& Humidity



Weather  
Alert Radio



Kitchen  
Thermometers  
& Timers



Clocks

It's more than accurate, it's **AcuRite**

AcuRite offers an extensive assortment of precision instruments, designed to provide you with information you can depend on to Plan your day with confidence™

[www.AcuRite.com](http://www.AcuRite.com)

## Documents / Resources

|   |  |
|---|--|
|  | <p><a href="#">ACCURITE Set &amp; Forget Alarm Clock</a> [pdf] Instruction Manual<br/>Set Forget Alarm Clock, 19956, 19958</p> |
|---|--|

## References



- [/ Home -](#)
- [▶ AcuRite Weather Monitoring | #1 Weather Station Brand in North America](#)
- [▶ Patented Technology | AcuRite](#)

Manuals+.