



## ACCULENZ BD4 Battery Powered Security Camera User Guide

[Home](#) » [AccuLenz](#) » ACCULENZ BD4 Battery Powered Security Camera User Guide 

### **ACCULENZ** Battery-powered Security Camera Quick Setup Guide



**BD4**  
**v1.0**  
**305503000938**

## Contents

- 1 Safety Instructions of Battery Usage
- 2 What's in the Box
- 3 Camera Introduction
- 4 Different states of the LED indicator
- 5 Install the Camera
- 6 Mount the Camera
- 7 Solar panel installation
- 8 Storage Media
- 9 Safety Tips
- 10 Product Performance
- 11 Troubleshooting
- 12 Documents / Resources
  - 12.1 References

## Safety Instructions of Battery Usage

The camera is not designed for running 24/7 at full capacity or around the-clock live streaming. It is designed to record motion events and to live view remotely only when you need it.

- The battery is built-in, so do not remove it from the camera.
- Charge the rechargeable battery with a standard and high-quality DC 5V battery charger or Acumens solar panel. Do not charge the battery with solar panels from any other brands.
- Charge the battery when the temperature is between 0°C and 45°C and always use the battery when the temperature is between -20°C and 60°C.
- Keep the USB charging port dry, clean and free of any debris and cover the USB charging port with the rubber plug when the battery is fully charged.
- Do not charge, use or store the battery near any ignition sources such as fire or heaters.
- Do not use the battery if it gives off an odor, generates heat, becomes discolored or deformed, or appears abnormal in any ways. If the battery is being used or charged, remove the battery from the device.
- Do the charger immediately, and stop using it.
- Always follow the local waste and recycle laws when you get rid of the used battery.
- Please fully charge the battery before first use.
- Please use the included standard USB Type-C charging cable to charge to avoid charging failure.

### Add Device: Connection via the Acculenz App

Before You Get Started

Scan the QR code below to download and install the Acumens AP from APP Store (for iOS) or Google Play (for Android).



Acculenz



Acculenz APP

To ensure a smoother video experience on your smart phone, it is recommended that your smart phone meet the following specifications:

- iOS: version 11 or higher.
- Android: 5.0 or higher, using a device with a Graphics Processing Unit (GPU).

**Note:** For the best experience, please update the APP to the latest version!

#### **Wifi connection**

1. Open the Acumens APP and please sign up for a Acumens account, or sign in if you have one already.



2. Turn on the power switch to power on the **camera**.



**Warnings:** Close cover tightly after use, to avoid water leakage causing the camera failure

3. Mobile phone connection to the network.

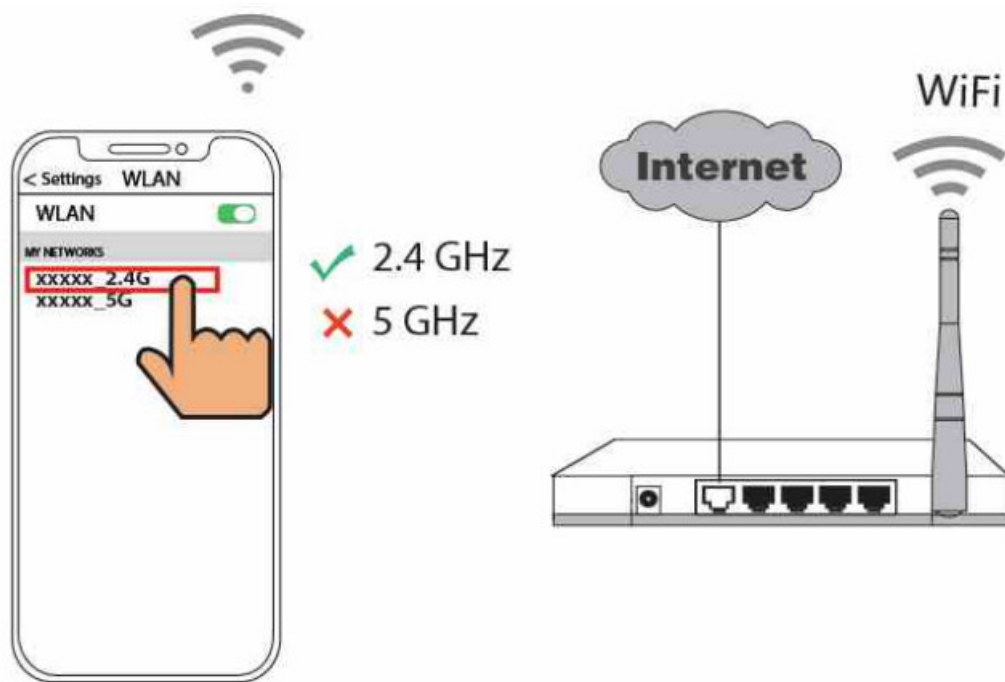

4. Follow the steps below:

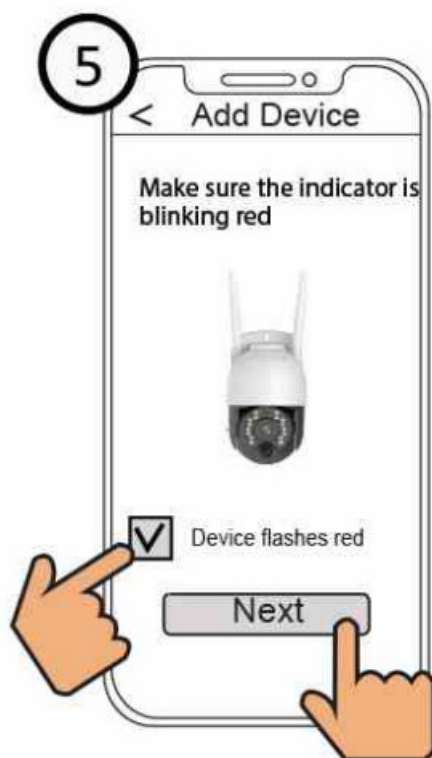
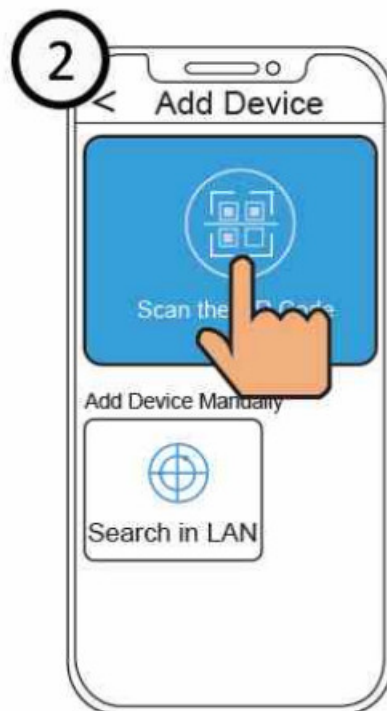
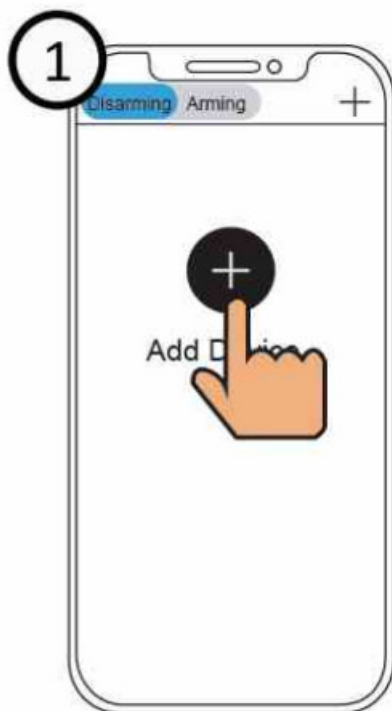

**Important:**

Please keep the camera and the QR code at the same level, and keep it for 5~10s without moving, until you hear a voice promptly say "WiFi connecting".

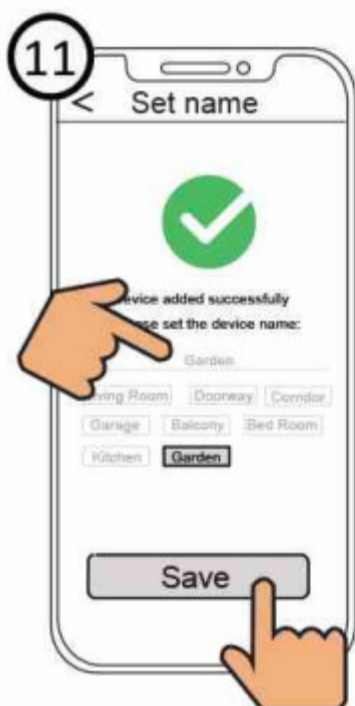
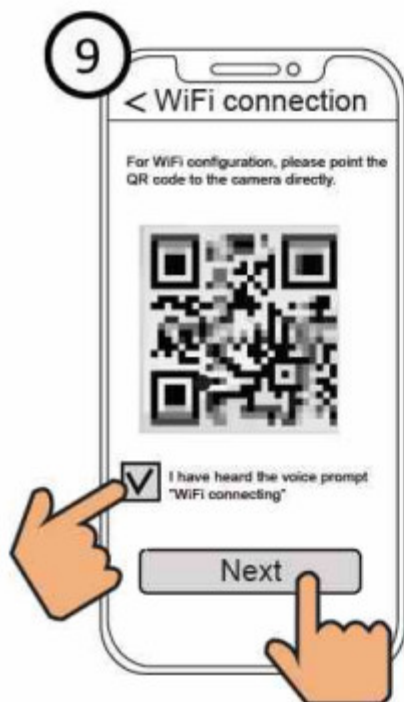

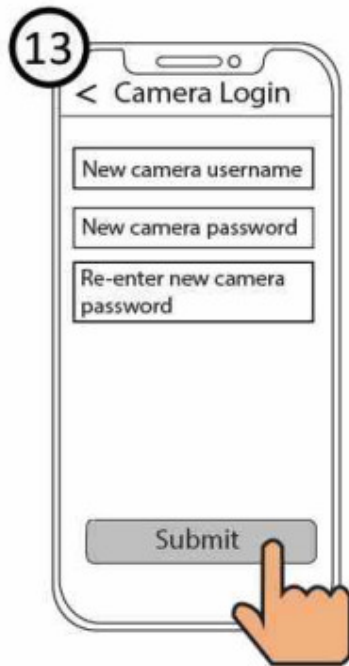

**Note:** If the process of adding a camera fails please reset your camera and try adding again with the above method.

## What's in the Box



Camera x1



Solar Panel x1



USB Type-C Cable x1

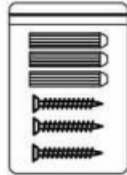

Screw kit x1  
(For camera)



Drill Hole Position Template x1



User Manual x1



Solar Panel Bracket x1

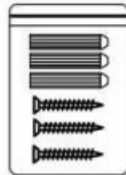

Screw kit x1  
(For Solar Panel )



Waterproof silicone cork  
for camera charging port x1

## Camera Introduction

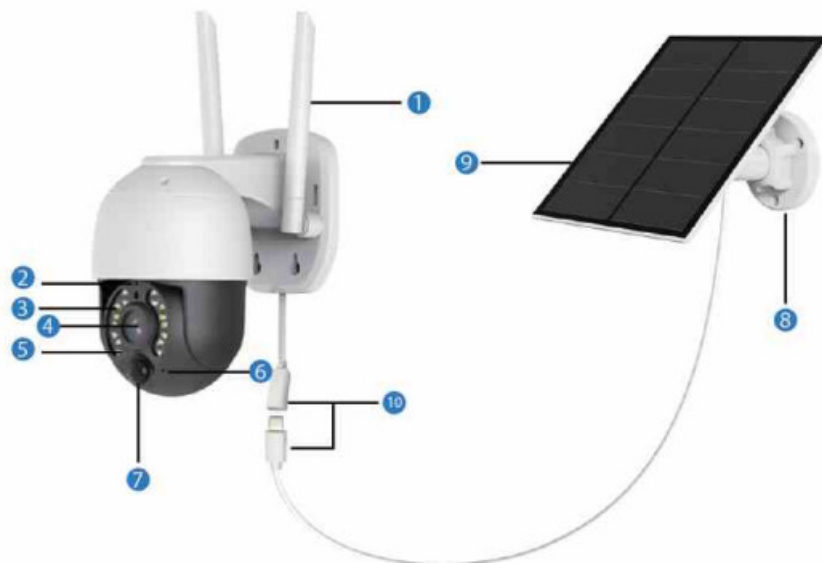

1. Antenna
2. Led indicator
3. Spotlight
4. Lens
5. Infrared LEDs



6. Microphone
7. Passive Infrared Sensor
8. Solar Panel Bracket
9. Solar Panel
10. USB Type Port



11. TF card slot
12. Power ON/OFF
13. Reset button
14. Speaker

### Different states of the LED indicator

LED indicator	Description
The red light flashes slowly	Ready for Wi-Fi configuration
The blue light flashes quickly	Connecting to router
The blue light flashes slowly	Connecting to server
The blue light is always on	Connected to the server
The blue light flashes three times quickly and one slowly	Charging in sleeping status
Blue & red lights are always on	Battery fully charged
Blue & red lights flash quickly	Firmware upgrading
All indicator off	Camera turned off or in standby status

### Install the Camera

- Install the camera 2.2-2.5 meters (7-10 ft) above the ground. This height maximizes the detection range of the PIR motion sensor.
- For better motion detection performance, please install the camera angularly. Camera installation with tilt angle of 10° downward is suggested.

### NOTE:

1. If a moving object approaches the PIR sensor vertically, the camera may fail to detect motion. The angle of the camera is related to the detection distance.
2. The Pan& Tilt angle will affect the PIR detection range;

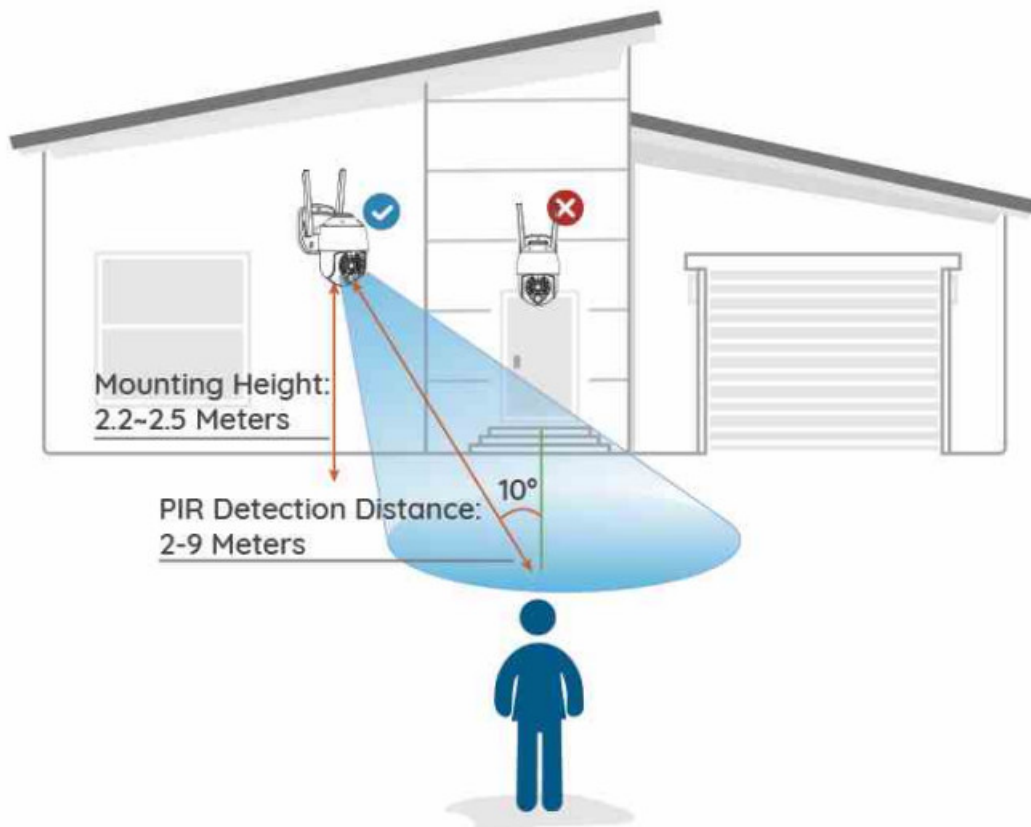

## Mount the Camera

It's recommend to fully charge the battery before mounting the camera outdoors.

### Option At

Charge the battery with power adapter (not included in the box, please find a 5V/1A power adapter for camera)

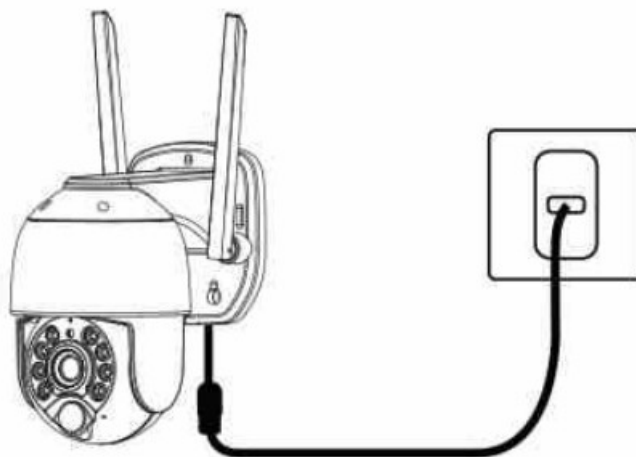

Please use the included standard USB Type-C charging cable to charge to avoid charging failure.

### Option8:

Charge the battery with the Acumens Solar Panel.

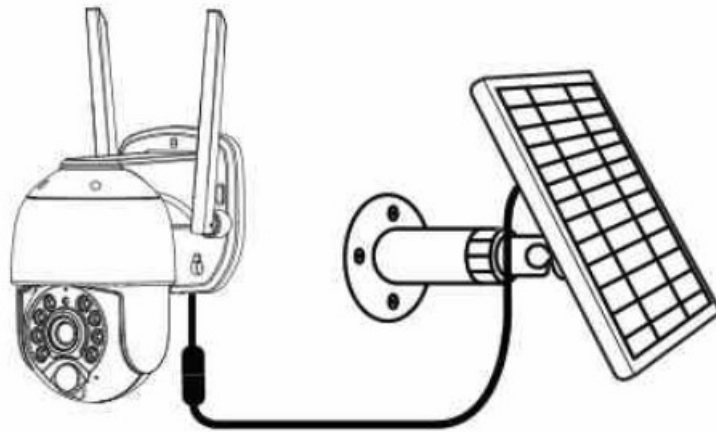

1. Use the drill hole position template to mark the screw holes in the area, and then use the drilling tool to punch holes on the wall. Screw the expansion untint the holes on the wall.

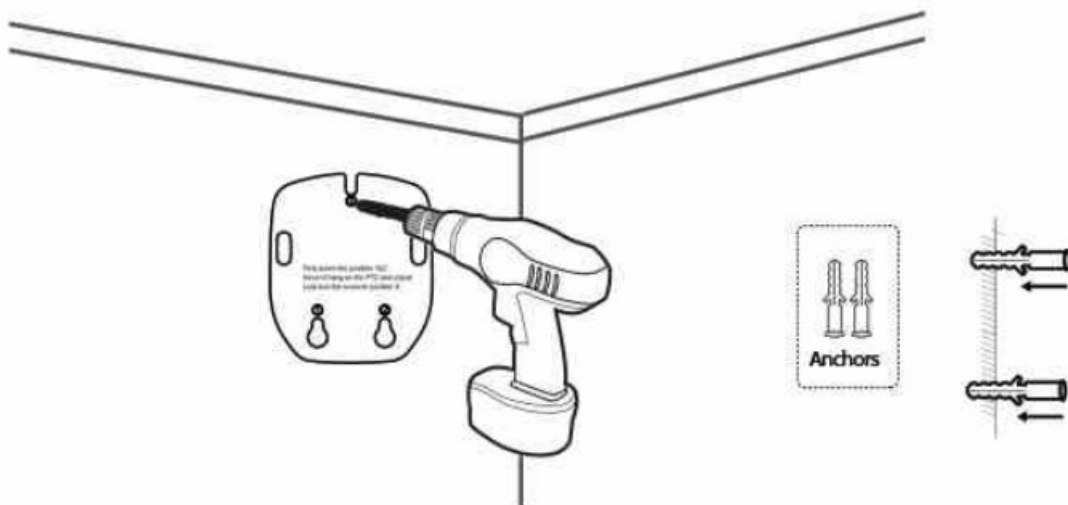

2. Mount the bracket with the screws provided in the package.

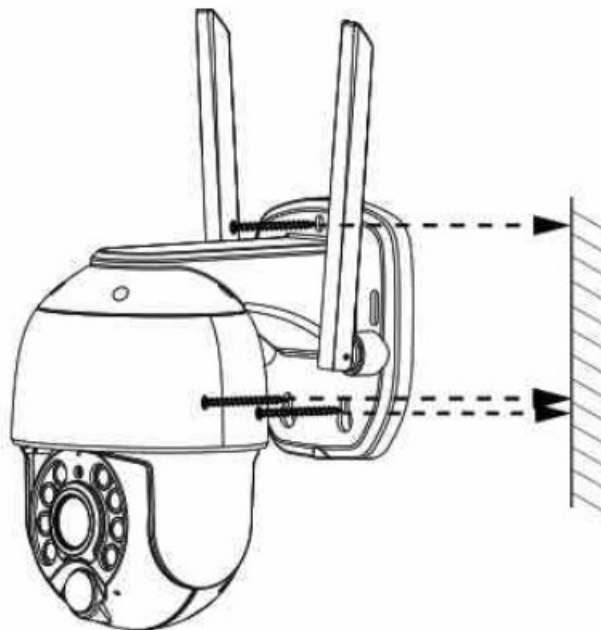

## Solar panel installation

1. Please select a position with the most sunlight throughout the year for your solar panel. The Acumens solar panel only needs a few hours of direct sunlight to sufficiently power your camera daily. The amount of energy

that the solar panel can produce is affected by weather conditions, seasonal changes, geographic locations, etc.



2. Mount the bracket with the mounting template and the screws provided in the package.

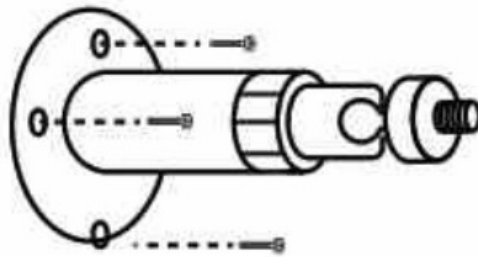

3. Slot the solar panel into the bracket and make sure it's secure.

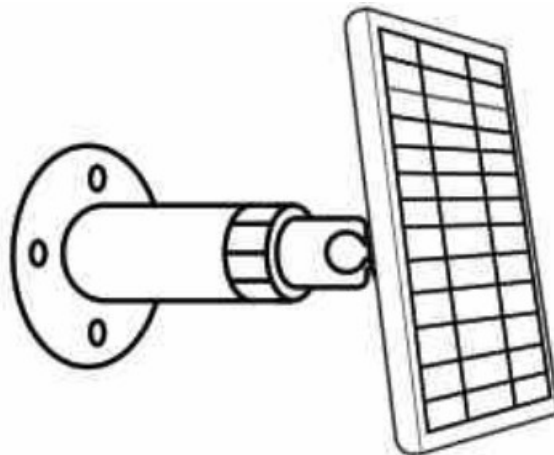

4. Loosen the adjusting control on the bracket and adjust the angle of the solar panel to make it receive direct sunlight, and then retighten the adjusting control to secure your setting.

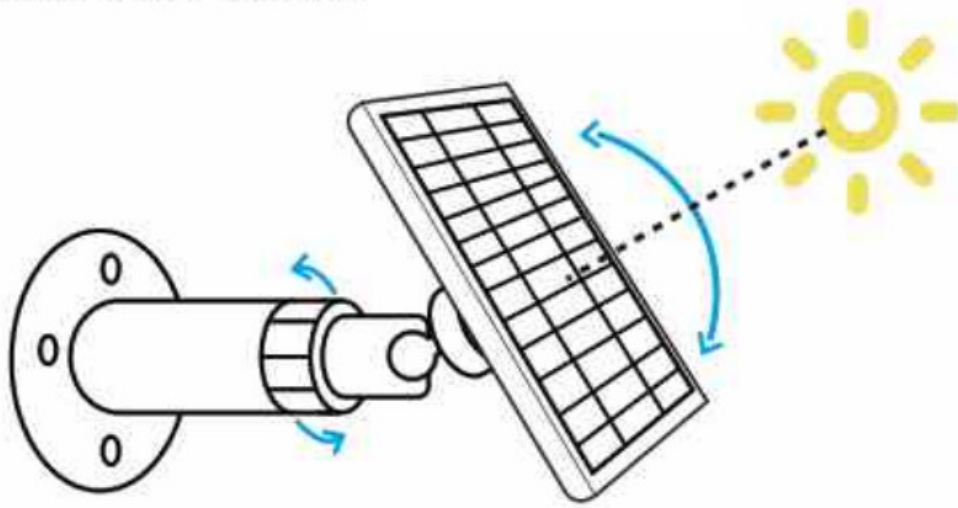

5. Connect the solar panel to the Acumens Battery camera with the USB Type-C cable.

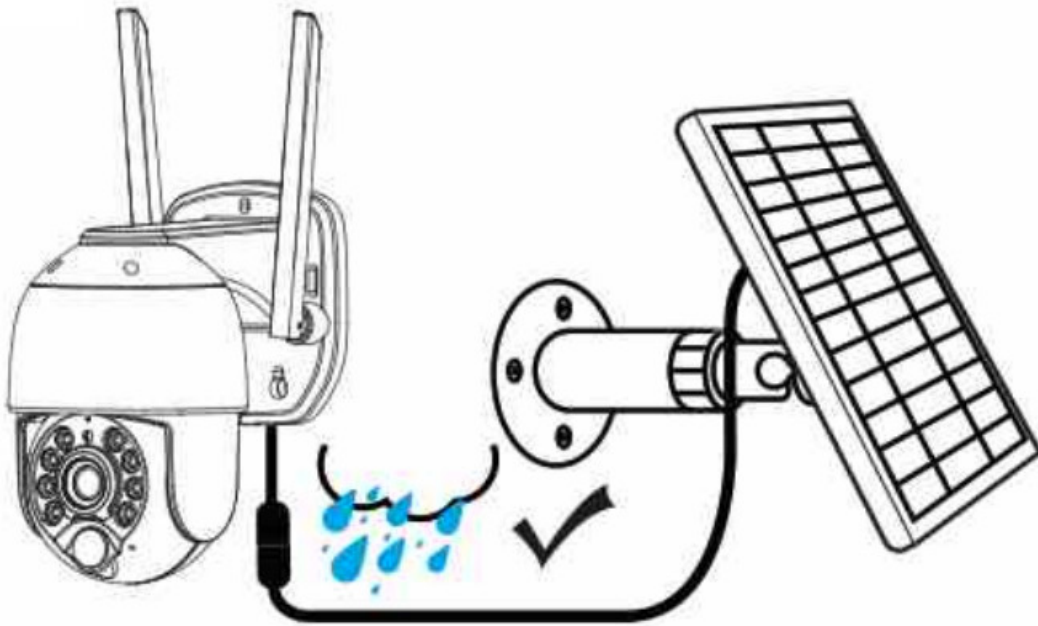

#### Important Notes:

1. Make sure that there is NO blocking on the solar panel. The energy harvesting efficiency drops drastically even when a small portion of the solar panel is blocked.
2. Please don't install the solar panel completely horizontally. Otherwise: your solar panel might accumulate dust and other debris easily. It is advised to install the solar panel angularly to make it receive direct sunlight.
3. Wipe the solar panel regularly to remove the dust or debris.
4. Connect the TYPE-C port on the solar panel or Charge the battery with a power adapter to the tail cable on the camera. You have to hear a "click" to be waterproof.



5. Please use the included standard Us8 Type-C charging cable to charge to avoid charging failure.

### **Important Notice**

#### **Camera Username & Password**

The camera username & password are used to access and manage your camera. Having a strong password can significantly improve the security of your camera.

If you have forgotten either of them, please press the “Reset” button.



Press the ‘Reset’ button and hold it for more than 3-5 seconds

### **Storage Media**

Your camera supports cloud and Micro SD card (only supports FAT32 format) storage formats.







cloud Storage



Micro SD card  
(only supports FAT32 )

### **Safety Tips**

	
Prohibit use at high temperature	Prohibit use at low temperature
	
Do not burn	Keep away from children
	
Do not puncture and crush hearing aid	No unauthorized disassembly
	
Use the correct supplied type-cable	Use the supplied screwdriver

## Product Performance

WLAN frequency range	2412MHz – 2472MHz
Maximum transmission power	< 16dBm
Wireless Standard	IEEE802.11b/g/n (2.4GHz)
Power Supply	DC5V1.0A5W

## Troubleshooting

### • Camera is Not Powering On

If your camera is not turning on, please apply the following solutions

1. Make sure the power switch is turned on.
2. Charge the battery with a DC 5V/1A power adapter. When the red and blue lights are on at the same time, the battery is fully charged.
3. Use the 5V/1A DC power adapter to charge the battery. The blue light indicates that the battery is charging, while the light is not on, the current battery voltage may be too low to support the blue indicator light and it needs to be charged for a while before the blue light turns on. When the red and blue lights turn on simultaneously, the battery is fully charged.
4. If these won't work, please contact Acumens support [support@acculenz.com](mailto:support@acculenz.com).

### • Failed to Scan QR Code on the Phone

If you cannot scan the QR code on your phone, please try the following solutions:

1. Wipe the camera lens with a dry paper/towel tissue.
2. Vary the distance between your camera and the mobile phone so that the camera can focus better.
3. Try to scan the QR code under sufficient lighting,

### • Failed to Connect to WiFi During Initial Setup Process

If the camera falls to connect to WiFi, please try the following solutions:

1. Ensure that you have entered the correct WiFi password.
2. Put the camera closer to your router to ensure a strong WiFi signal.
3. Change the encryption method of the Wifi network to WPA2-PSK/WPA-PSK (safer encryption) on your router interface.
4. Change your WiFi SSID or password and make sure that SSID is within 31 characters and password i within 64 characters.
5. Set your password using only the characters available on the keyboard.
6. If these won't work, please contact Acumens support: [support@acculenz.com](mailto:support@acculenz.com).

# ACCULENZ



Name: Ouled Ltd

Address: 39-41 High Street, New Malden,  
Surrey, England, KT3 4BY

E-mail: [oule.ukrep@outlook.com](mailto:oule.ukrep@outlook.com)



Company:

Qing UG (haftungsbeschränkt)

Address: Undines. 7, 12203 Berlin Germany

Tell:004917662179550

E-mail: [pmdheinrich@gmail.com](mailto:pmdheinrich@gmail.com)

**Shenzhen Accu Lenz Technology Co., Ltd.**

Room 2806-559, Foreign Trade Group Building, No. 239

Zhong Xing Road, Lihou District, Shenzhen, China

Support E-mail: [support@acculenz.com](mailto:support@acculenz.com)

US&CA toll-free: +1833 587 5008

UK: +44 1388434593

Germany: +49 6931090129

Website: [www.acculenz.com](http://www.acculenz.com)



## Documents / Resources

	
---	--



Safety Instructions of Battery Usage

The camera is not designed for exposure to fire at all capacity or around the risk of fire, meaning it is designed to avoid fire and heat and is for use only in normal conditions.

- The battery is built-in, and is not removable from the camera.
- Charge the rechargeable battery with a standard and high-quality DC 5V power charger or Acculens charger. Do not charge the battery with other power sources or other chargers.
- Charge the battery when the temperature is between 0°C and 40°C, and do not use the battery when the temperature is between -20°C and 60°C.
- When the LED charging port is dry, clean and free of any debris and is fully charged.
- Do not charge, use or store the battery near any flammable materials.
- Do not use the battery if it gives off an odor, gets too hot, becomes discolored or deformed, or appears abnormal in any way. If the battery is being used or stored, remove the battery from the device.
- Do not get electrolyte into your eyes.
- Always follow the local waste and recycle laws when you get rid of the used battery.
- Please fully charge the battery before first use.
- Please use the included standard USB Type-C charging cable to charge to avoid charging failure.

42 English

Add Device: Connection via the Acculens App

Before You Get Started

Scan the QR code below to download and install the Acculens APP from APP Store (iOS) or Google Play (Android).



To ensure a successful video experience on your smart phone, it is recommended that your phone meet the following specifications:

- iOS version 11 or higher.
- Android 5.0 or higher, using a device with a Graphics Processing Unit (GPU).

Note: For the best experience, please update the APP to the latest version.

12 English

■ WIFI connection

1. Open the Acculens APP and please sign up for an Acculens Account, or sign in if you have one already.



2. Turn on the power switch to power on the camera.



42 English

3. Mobile phone connection to the network.



4. Follow the steps below:



72 English

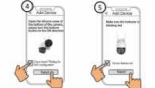

82 English

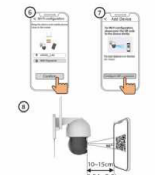

Important: Please keep the camera lens and the QR code at the same level and keep it for 3-5s without moving, until you hear a voice prompt saying "WiFi connecting".

102 English



112 English



112 English



112 English

What's in the Box



## ACCULENZ BD4 Battery Powered Security Camera [pdf] User Guide

# BD4 Battery Powered Security Camera, BD4, Battery Powered Security Camera, Powered Security Camera, Security Camera, Camera, Camera, Camera BD4



1/2 English

### Camera Introduction



1/2 English

LED indicator	Description
The red light flashes slowly	Ready for Wi-Fi configuration
The red light flashes quickly	Connecting to Wi-Fi
The blue light flashes slowly	Connecting to the camera
The blue light is always on	Connected to the camera
The blue light flashes twice	Charge plug charging status
Red and light on at the same time	Charge plug charging
Red and light on quickly	Recharge plug charging
Red and light on quickly	Recharge plug charging
Red and light on quickly	Recharge plug charging

### Install the Camera

1. Install the camera 2.2-2.5 meters (7'-8'6") above the ground. This height maximizes the detection range of the IR night vision camera.
2. The camera should be installed in a place that is not exposed to direct sunlight or rain.
3. The camera should be installed in a place that is not exposed to direct sunlight or rain.

1/2 English



### Mount the Camera

1. It is recommended to fully charge the battery before installing the camera.
2. Charge the battery with the included adapter (not included).
3. Please use the included standard USB Type-C charging cable to charge the camera battery.

1/2 English

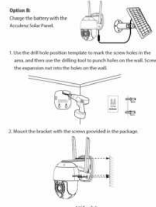

### Solar panel installation

1. Please select a position with the most sunlight throughout the year to install the panel. The camera will automatically detect the best position for the solar panel.
2. Please don't install the solar panel completely horizontally. Otherwise, the solar panel will produce less power, affecting the camera's performance.

1/2 English

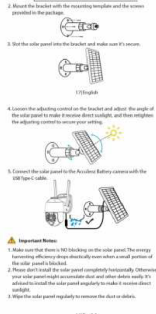

1. Connect the TYPE-C port on the solar panel to the camera's battery with a power adapter to the solar panel or the camera's battery to have a USB to be waterproof.
2. Please use the included standard USB Type-C charging cable to charge the camera battery.

1/2 English

### Important Notice

1. Camera Orientation & Powering On
2. The camera requires a minimum 24-hour power-on time to ensure the camera's performance.
3. Please use the included standard USB Type-C charging cable to charge the camera battery.

1/2 English



1. Please use the power switch to turn on the camera.
2. Charge the battery with the included adapter (not included).
3. Please use the included standard USB Type-C charging cable to charge the camera battery.

1/2 English

Product Performance	
Wi-Fi Frequency range	2.4GHz - 5.8GHz
Maximum transmission power	< 100mW
Wireless Standard	IEEE802.11b/g/n (40MHz)
Power Supply	DC 5V 1A 5W

### Troubleshooting

1. Camera is Not Working
2. Please check the camera's power switch.
3. Please check the camera's battery level.
4. Please check the camera's Wi-Fi connection.

1/2 English

