



ACCU-CHEK 03453498 Insertion Device Instruction Manual

[Home](#) » [ACCU-CHEK](#) » ACCU-CHEK 03453498 Insertion Device Instruction Manual 

ACCU-CHEK® Solo

Front side
INSERTION DEVICE
INSTRUCTIONS FOR USE

Contents

- [1 03453498 Insertion Device](#)
- [2 Package Contents](#)
- [3 Component Overview](#)
- [4 Storage Conditions](#)
- [5 Attaching the Infusion Assembly](#)
- [6 Disposal](#)
- [7 Documents / Resources](#)
 - [7.1 References](#)
- [8 Related Posts](#)

03453498 Insertion Device

Instructions for use

Accu-Chek Solo insertion device

Intended Use

The Accu-Chek Solo insertion device is used to attach the infusion assembly (pump holder and cannula) to the body and insert the cannula into the subcutaneous tissue.

Package Contents

1 insertion device

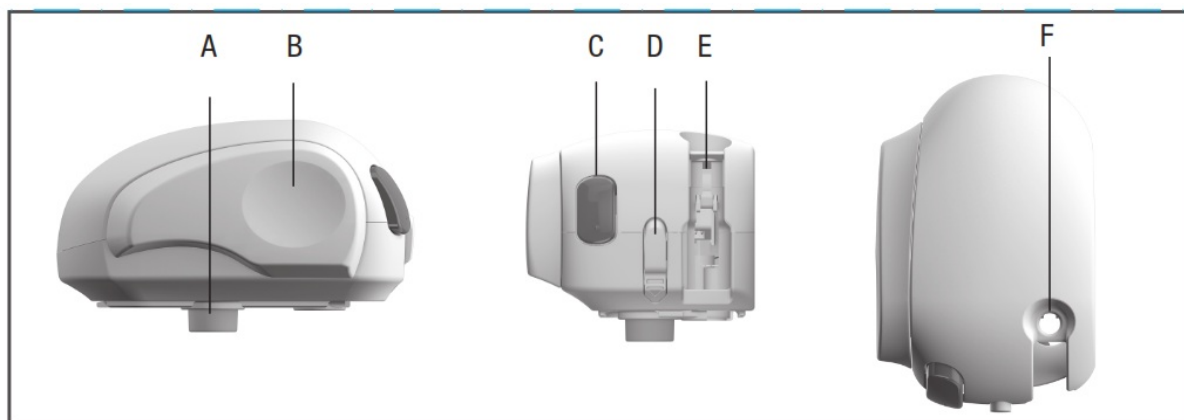

Component Overview

A Release lock

The release lock (A) prevents the insertion device from being triggered unintentionally.

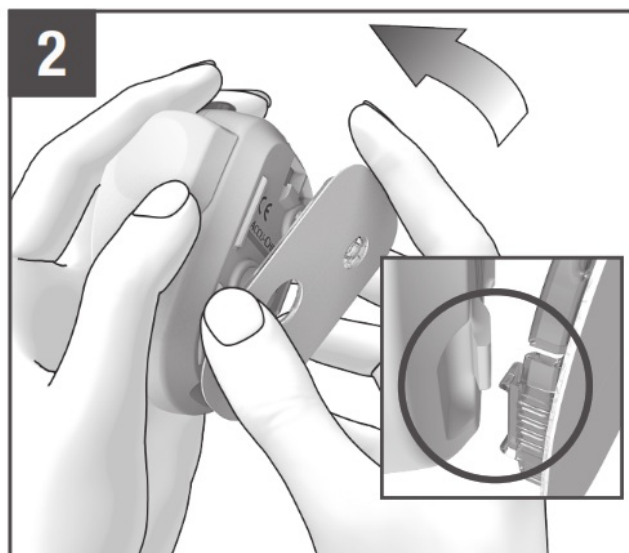
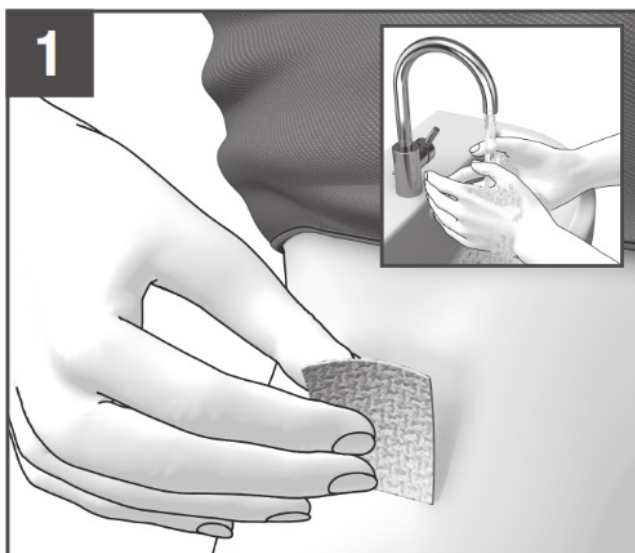

B Priming handle

C Release button (blue)

D Detach button (white)

E Cannula assembly slot

Do not touch the cannula or the introducer needle of the cannula assembly before insertion.

F Positioning aid

This product contains pointed and sharp-edged parts that may cause injury. Keep pointed and sharp-edged parts away from small children and vulnerable persons.

Storage Conditions

See outer packaging. You can find the symbol explanations in the User's Manual of the Accu-Chek Solo micropump system. Do not store the insertion device when it is primed. This weakens the spring tension, which may lead to incorrect insertion of the cannula and insufficient delivery of insulin.

Before You Get Started

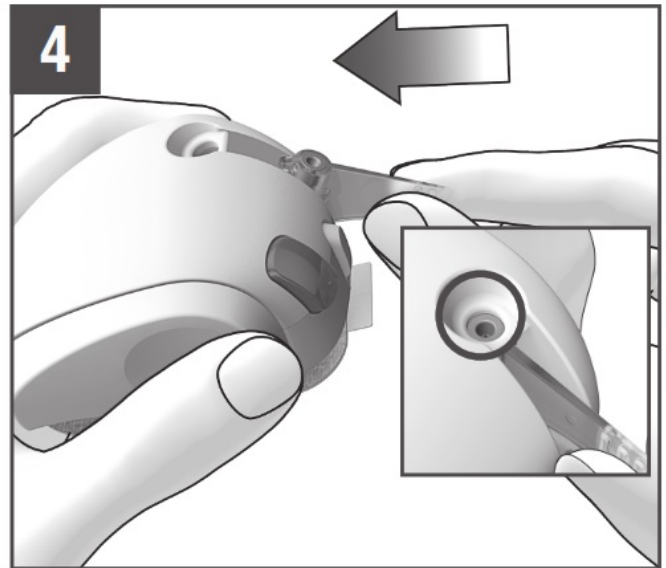
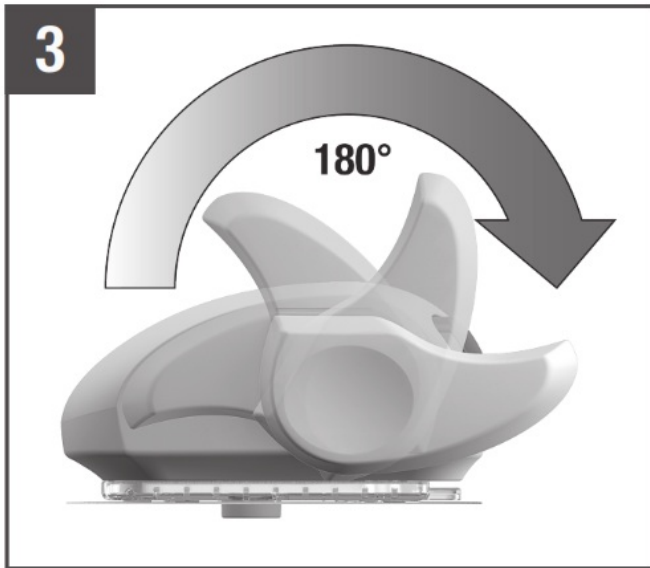

Read these instructions for use and the instructions in the User's Manual of the Accu-Chek Solo micropump system. Take particular note of all warnings, information, and notes required for the safe and proper use of the micropump system.

This product is meant to be used by 1 person only and may be reused. You may use the insertion device for 4 years. Before attaching the infusion assembly, choose a suitable infusion site. Consult your healthcare professional for advice.

Sites with sufficient subcutaneous fatty tissue are the most suitable, for example, the abdominal region.

Attaching the Infusion Assembly

To attach the infusion assembly, you need an Accu-Chek Solo insertion device, an Accu-Chek Solo cannula assembly & pump holder, wipes, and disinfectant.

To replace a component of the micropump system, always use the Replace menu on the diabetes manager.

To view an animated video of the handling steps, tap Help on the diabetes manager.

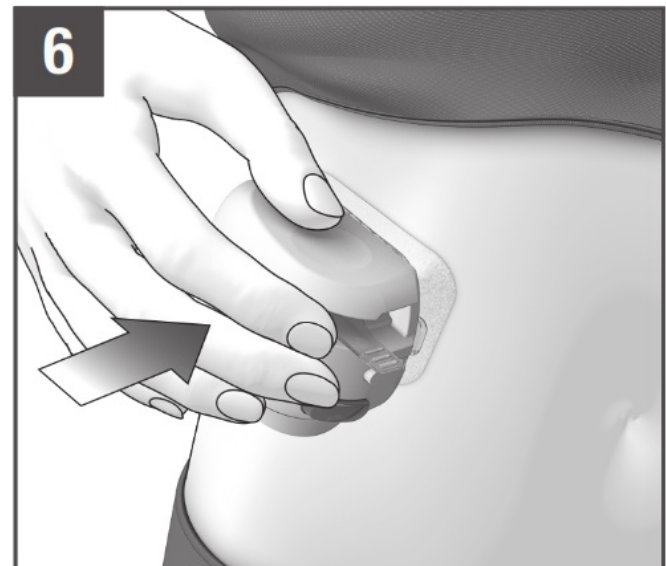
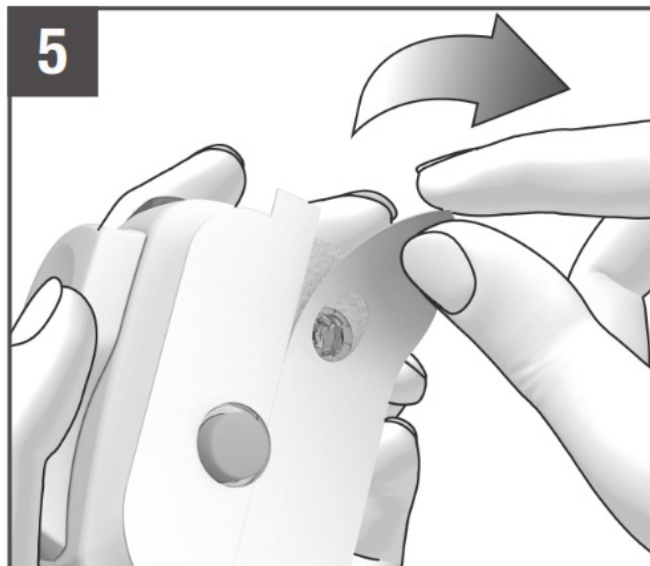

WARNING

Risk of hyperglycemia (high blood glucose level)

If you trigger the insertion device without inserting a cannula assembly, you reduce the useful lifetime of the insertion device. This may lead to incorrect insertion of the cannula and insufficient delivery of insulin.

Do not use the insertion device without inserting a cannula assembly.

1. Wash your hands and dry them thoroughly. Disinfect the infusion site on your body according to the instructions

given by your healthcare professional. Make sure that the infusion site is dry and free from residues.

2. Attach the hook on the pump holder to the underside of the insertion device. Press the pump holder onto the underside of the insertion device until it locks into place. Check whether the pump holder is correctly locked into place.

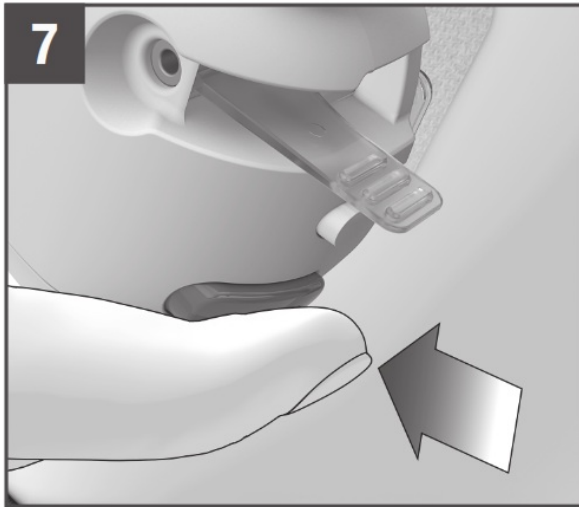

3. Prime the insertion device by rotating the priming handle (B) clockwise in the direction of the arrow, as far as it will go. When the insertion device is fully primed, you will hear a click.
4. Insert the cannula assembly into the cannula assembly slot (E). Push the cannula assembly into the slot until you hear it click into place. Use the positioning aid (F) to check whether the cannula assembly is in the correct position.
5. Remove both parts of the protective film from the adhesive pad.
6. Holding the skin taut, press the insertion device firmly against the selected site on your body.
7. Press the blue release button (C) to insert the cannula under the skin.
8. Smooth over the adhesive pad around the infusion assembly so that the infusion assembly is in good contact with the skin.

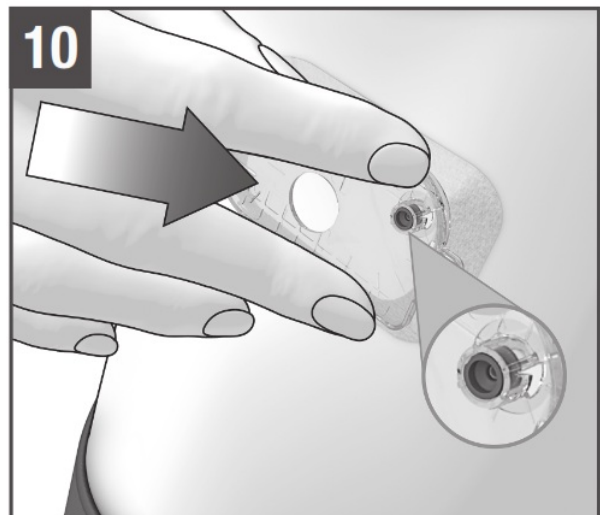
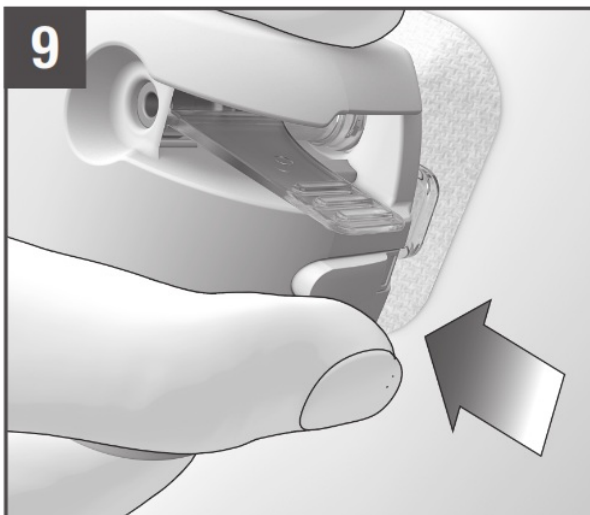

9. Press the white detach button (D) and detach the insertion device from the infusion assembly. If possible, keep the adhesive pad in position with the other hand.
10. Press the infusion assembly and the edges of the adhesive pad against the skin so that the adhesive pad is smooth on the skin. Check whether the grey cannula head in the cannula opening is visible and flush with the opening. If this is not the case, repeat steps 1 to 10 using a new pump holder and a new cannula assembly.

Check the infusion site regularly. If the infusion site appears inflamed or has become contaminated, immediately replace the infusion assembly and choose another infusion site.

Cleaning and Disinfecting

For more details, see chapter Care and Maintenance in the User's Manual of the micropump system.

Disposal

WARNING

Risk of infection

Used components carry a risk of infection.

Dispose of the cannula assembly safely, in such a way that the introducer needle does not cause injury to anyone. Dispose of used products according to local regulations. For more information about correct disposal, contact your local council or authority.

Distributed in the United Kingdom by:

Roche Diabetes Care Limited Charles Avenue, Burgess Hill West Sussex, RH15 9RY, United Kingdom
Accu-Chek Pump Careline1) :

UK Freephone number: 0800 731 22 91

ROI Freephone number: 1 800 88 23 51 1) calls may be recorded for training purposes Some mobile operators may charge for calls to these numbers.

burgesshill.insulinpumps@roche.com

www.accu-chek.co.uk, www.accu-chek.ie

Australia

Roche Diabetes Care Australia Pty. Limited

Insulin Pump Support: 1800 633 457

australia.insulinpumps@roche.com

www.accu-chek.com.au

PDF siliobim – Mai 20, 2021

Approved according to SHR SOP 04.07.08 Att. A Vers.4.9

Kat. 03

The Signature will not be printed!

GO/ siliobim – Mai 20, 2021 LAY

Pro/ LAB scheikej – May 25, 2021

LA RI bracin – Mai 25, 2021



ACCU-CHEK and ACCU-CHEK SOLO are trademarks of Roche.

© 2021 Roche Diabetes Care



Roche Diabetes Care GmbH

Sandhofer Strasse 116

68305 Mannheim, Germany

www.accu-chek.com

Last update: 2021-03

Documents / Resources



[ACCU-CHEK 03453498 Insertion Device](#) [pdf] Instruction Manual
03453498 Insertion Device, 03453498, Insertion Device, Device

References

- [!\[\]\(849840539e55921a3851a4ff96d7400d_img.jpg\) Willkommen bei Accu-Chek](#)
- [!\[\]\(c176e0b06f6c5dd85a4598b214d1ebba_img.jpg\) Accu-Chek® |](#)
- [!\[\]\(66a18e26647fc145bd9198dd182dd107_img.jpg\) Willkommen bei Accu-Chek | Switzerland](#)
- [!\[\]\(572bcf30fdd4de64673b94584b7c6eca_img.jpg\) Bienvenido a Accu-Chek | Chile](#)
- [!\[\]\(ba6dc7fecffbf82e7fd414c1c97a1ece_img.jpg\) Accu-Chek UK | Diabetes Care Management: Devices, Apps & Tools](#)
- [!\[\]\(7b0c59a8d567ae8f4c94e1b0dfc0504e_img.jpg\) Accu-Chek Diabetes Care Products Home | Accu-Chek](#)
- [!\[\]\(6e7b00b003bc1efbd5a833fe586c1576_img.jpg\) Bienvenido a Accu-Chek | Accu-Chek](#)
- [!\[\]\(f2e2aef7ad678fd5527dfd3a24e78b6d_img.jpg\) Welcome to Accu-Chek® | Accu-Chek](#)
- [!\[\]\(0bdc169ad27675acfc0a2460ebf11020_img.jpg\) Czech Republic](#)
- [!\[\]\(ff1db8033de97c9b5192b575e06c8897_img.jpg\) Accu-Chek | Diabetes Management und Blutzuckerselbstkontrolle](#)
- [!\[\]\(8e22f16edd611aa34ab98b6176f90abf_img.jpg\) Velkommen til Min Accu-Chek | Danmark](#)
- [!\[\]\(8d7540c68f056d32e1f5c277c946b92b_img.jpg\) Bienvenido a Accu-Chek | Spain](#)
- [!\[\]\(3bb45e9059d5a505b3fa2f4e5c39e3da_img.jpg\) Tervetuloa Accu-Chek Clubiin](#)
- [!\[\]\(bcbb2ca52bf0ba47932372eb96197d41_img.jpg\) Bienvenue sur Accu-Chek | France](#)
- [!\[\]\(86bfe340afcacac49a3dd00ab134ada7_img.jpg\) Accu-Chek UK | Diabetes Care Management: Devices, Apps & Tools](#)
- [!\[\]\(9b99400845b7213efae8696f53f668bd_img.jpg\) Benvenuti a Accu-Chek | Italy](#)
- [!\[\]\(246a070aa530e685bd4358f7a4e50d22_img.jpg\) Welkom bij Accu-Chek | Nederland](#)
- [!\[\]\(7dc89558730445a73c5b7315038c9f70_img.jpg\) Velkommen til Accu-Chek® | Accu-Chek](#)
- [!\[\]\(9714e508639a0d75d3a727c47613d2a5_img.jpg\) Polska |](#)
- [!\[\]\(33b0086d79a773326190bf875bef408b_img.jpg\) Bem-vindo à Accu-Chek | Portugal](#)
- [!\[\]\(0e3402112c6e2ed1af3ce3861c917098_img.jpg\) Welcome to Accu-Chek | Accu-Chek Sweden](#)