



AC INFINITY Cloudray Circulation Fan System User Manual

[Home](#) » [AC Infinity](#) » AC INFINITY Cloudray Circulation Fan System User Manual 

Contents

- 1 AC INFINITY Cloudray Circulation Fan System
- 2 WELCOME
- 3 PRODUCT WARNING
- 4 RECOMMENDED USAGE
 - 4.1 KEY FEATURES
 - 4.2 PRODUCT CONTENTS
- 5 INSTALLATION
 - 5.1 POWERING AND SETUP
 - 5.2 CLEANING
- 6 CONNECTING TO CONTROLLERS
 - 6.1 PROGRAMMING
- 7 CLOUDRAY FAQ
 - 7.1 AC INFINITY PRODUCTS
- 8 WARRANTY
- 9 Documents / Resources
 - 9.1 References
- 10 Related Posts

AC INFINITY

AC INFINITY Cloudray Circulation Fan System



WELCOME

Thank you for choosing AC Infinity. We are committed to product quality and friendly customer service. If you have any questions or suggestions, please don't hesitate to contact us. Visit www.acinfinity.com and click contact for our contact information.

MANUAL CODE CC2209X1

PRODUCT

- CLOUDRAY A6
- CLOUDRAY S6
- CLOUDRAY T6
- CLOUDRAY A9
- CLOUDRAY S9
- CLOUDRAY T9

MODEL

- AC-CCA6
- AC-CCS6
- AC-CCT6
- AC-CCA9
- AC-CCS9
- AC-CCT9

UPC-A

- 819137022416

- 819137022423
- 819137022447
- 819137022454
- 819137022461
- 819137022478

PRODUCT WARNING

TO REDUCE THE RISK OF FIRE, ELECTRIC SHOCK, OR INJURY TO PERSONS, OBSERVE THE FOLLOWING:

1. Ensure your power source conforms to the electrical requirements of this product.
2. Check your local code restrictions for additional safety measures that may be needed for a proper code compliant installation.
3. Read all instructions before installing and using this product.
4. If you are unfamiliar or have doubts about performing this product's installation, seek the services of a qualified, trained, and licensed professional. Inappropriate installation will void this product's warranty.
5. Do not attempt to hardwire this product. Performing any retrofitting actions may result in personal injury and/or electrical damage, and will void this product's warranty.
6. This product must not be used in potentially hazardous locations such as flammable, explosive, chemical-laden or wet atmospheres.
7. Do not cover power cords with rugs or other fabric materials.
8. This product has rotating parts. Safety precautions should be exercised during the installation, operation, and maintenance of this product.
9. Do not insert or allow fingers or foreign objects to enter through the fan grille as it may cause electric shock, fire, or damage to this product. Do not block or tamper with this product in any manner while it is in operation.
10. Do not depend on the on/off programming as the sole means of shutting power from this product. Unplug the power cord before installing, servicing, or moving this product.
11. Do not operate this product while its cord is damaged, or if it malfunctions, has been dropped, or is damaged in any manner.

RECOMMENDED USAGE

REDUCING CORD TENSION

Please make sure to provide enough slack for the power cord and the extension cord. The fan should be able to oscillate freely without tugging on its cords.

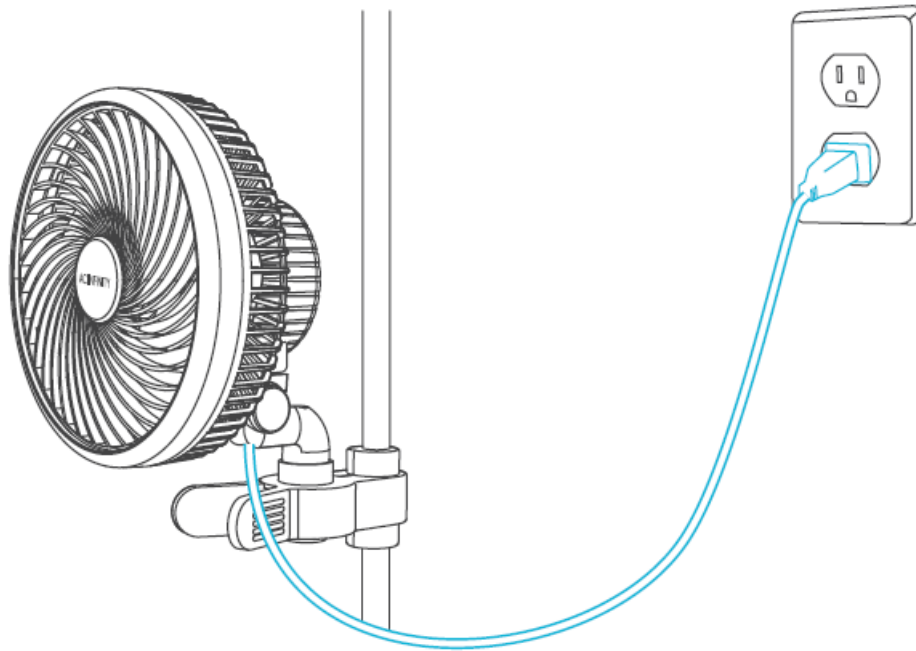

MAXIMIZING LIFESPAN

This fan utilizes the latest in step motor technology that allows it to operate 24 hours a day.

However, to maximize its lifespan, we do not recommend having it oscillate nonstop for more than 18 hours a day.

This will preserve the motor by passively keeping it cool to prevent it from wearing down.

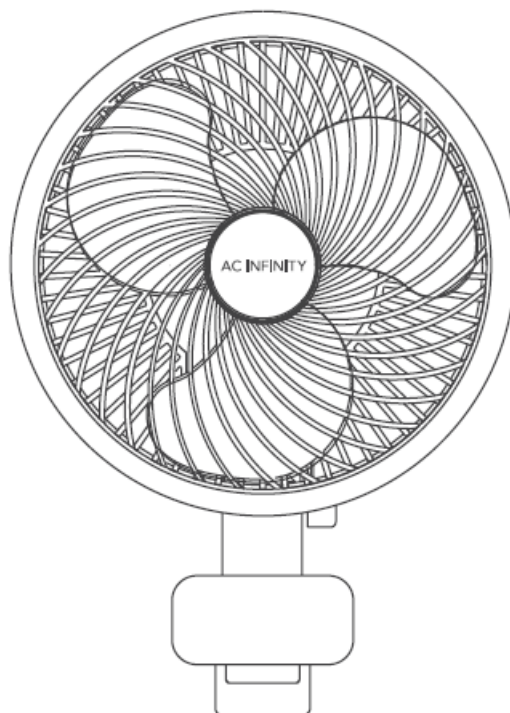

KEY FEATURES

EC MOTOR

Next generation motor runs quieter, is more energy efficient, and has a longer lifespan than AC motors.

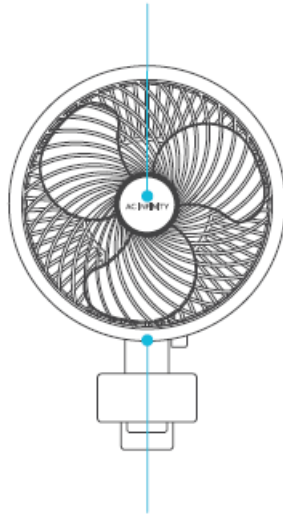

IP44 PROTECTION

The clip fan is sealed to Ingress Protection 44 standards, rated with high resistance to liquids and dust.

PWM CONTROL

Digitally controlled to enable a range of 10 fan speeds and 10 oscillation angles* in any grow setting.

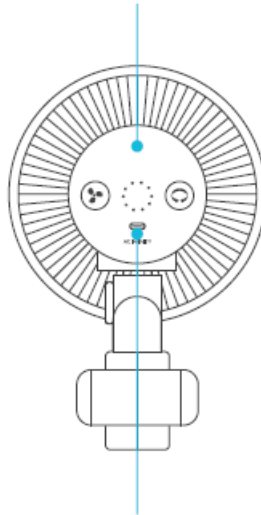

UIS™ COMPATIBLE

Connects with UIS controllers for temperature, humidity, timer, cycle, and schedule programming.

COMPACT BASE

Shallower motor base allows for closer mounting to poles to maximize amount of grow space.

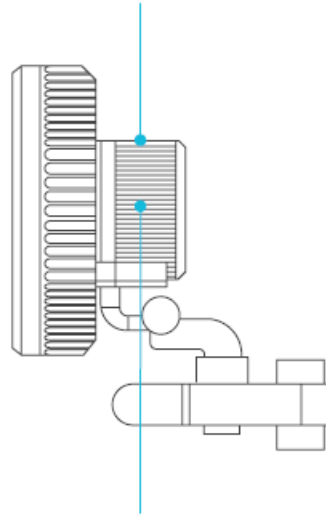

DUAL BALL BEARINGS

The motor contains ball bearings with an estimated 67,000 hour lifespan. Enables the fan to be mounted in any orientation.

PRODUCT CONTENTS

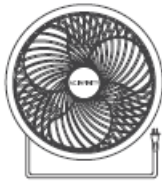

CIRCULATION FAN
(x1)

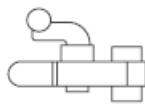

GRIP CLIP
(x1)



ADAPTER DONGLE
(x1)

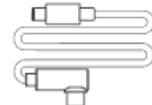

EXTENSION CORD
(x1)



CABLE TIE
(x4)



CABLE MOUNT
(x1)

INSTALLATION

STEP 1

Twist to remove the bigger knob piece from the grip clip.
Pull the smaller button piece from the vice grip.

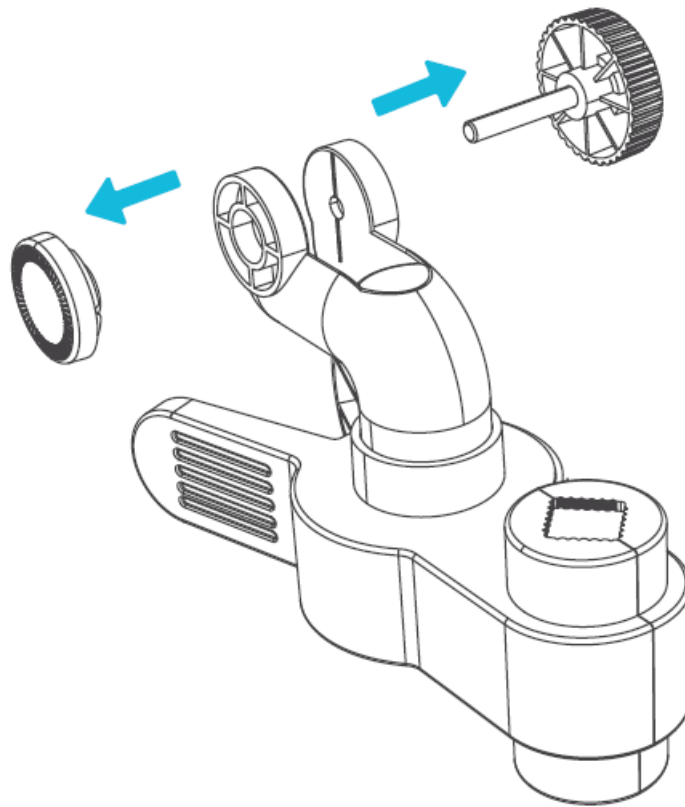

STEP 2

Slide the grip clip into the swivel.

You may need to pull its clamps apart for it to fit over the swivel. This tightness ensures your fan will not tilt downwards on its own.

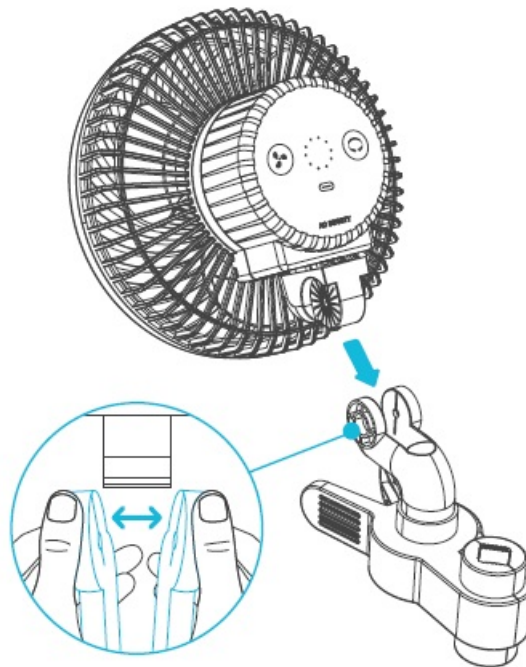

STEP 3

Replace the knob and button on either side of the mounting point as desired.

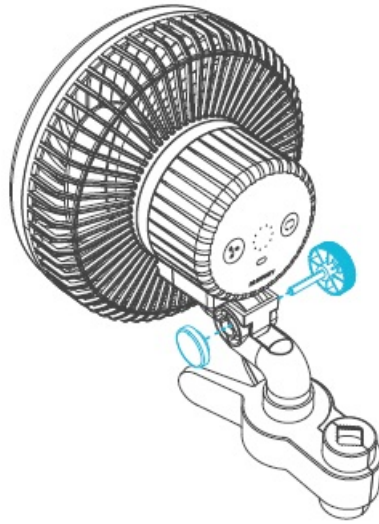

STEP 4

Clamp your clip fan onto a pole or post.

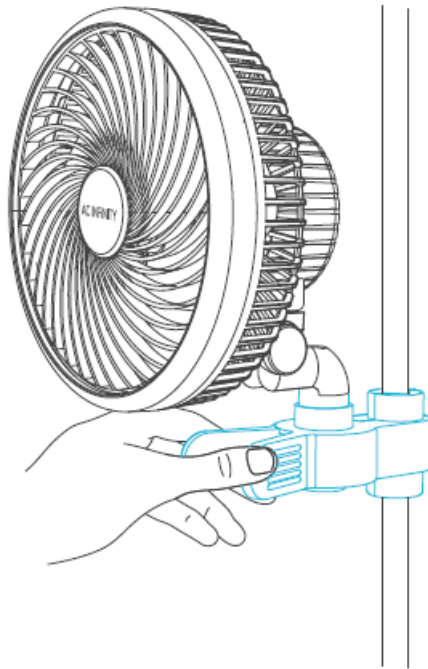

POWERING AND SETUP

STEP 1

Plug your clip fan's power cord into an AC power outlet to power it.

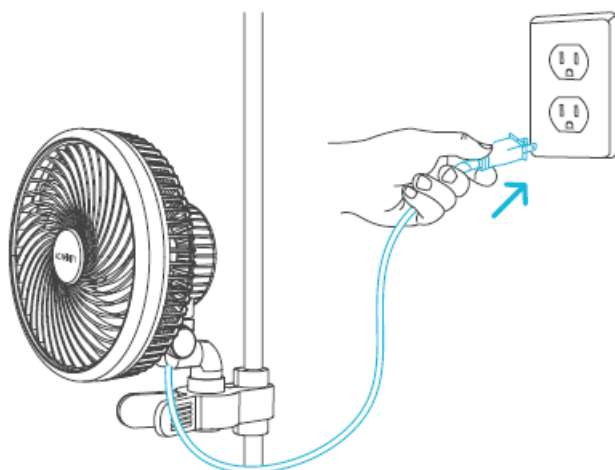

STEP 2

You may cable manage the cords using the included cable ties or cable mounting set. Adhere the tie mount onto a clean surface. Loop the wire tie into the mount and around the cables.

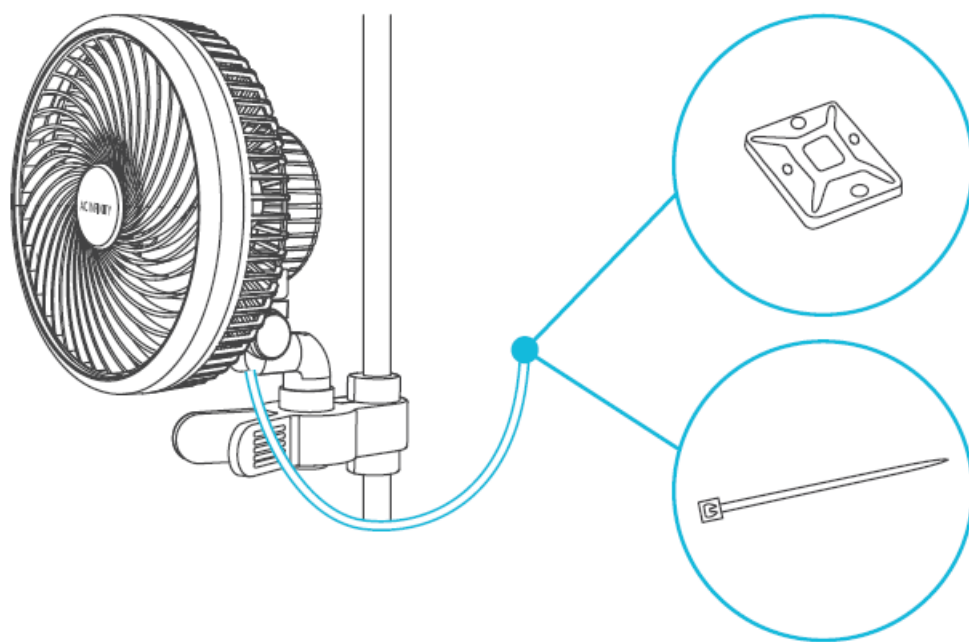

CLEANING

STEP 1

Unplug your clip fan.

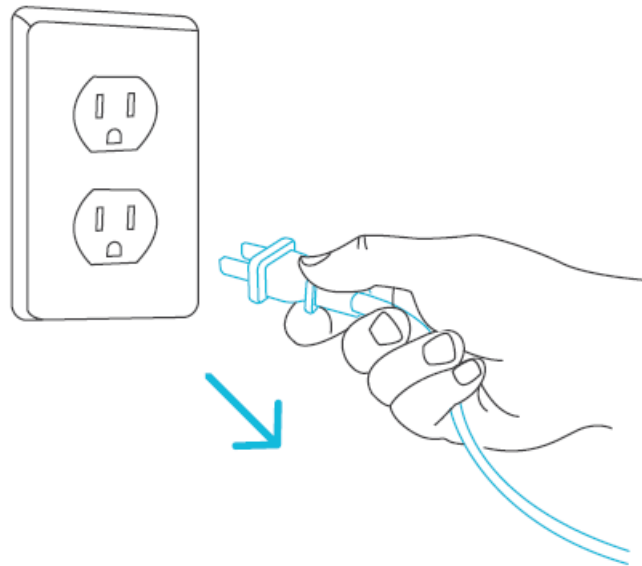

STEP 2

Remove the front grille by twisting the grille counter-clockwise and pulling it off.

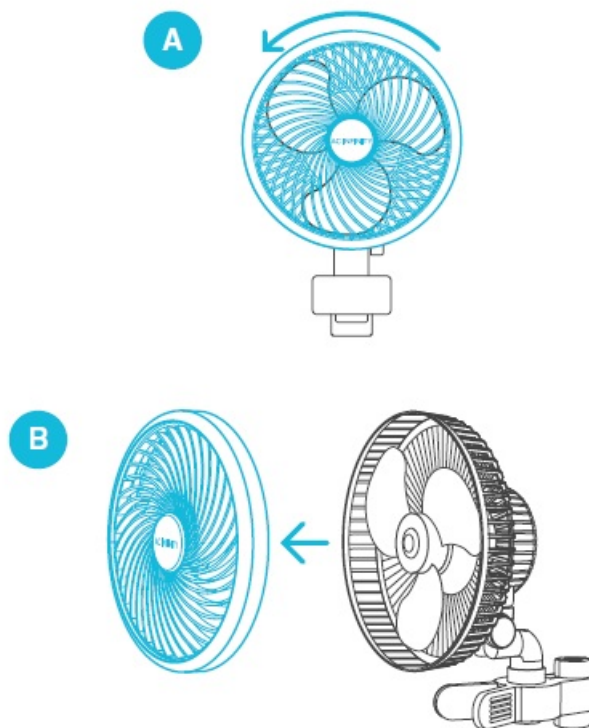

Removing the front grille to clean the fan blades will not void your warranty.

STEP 3

Wipe off any dust and debris from the grille and fan blades using a damp cloth. Set aside to dry as needed.

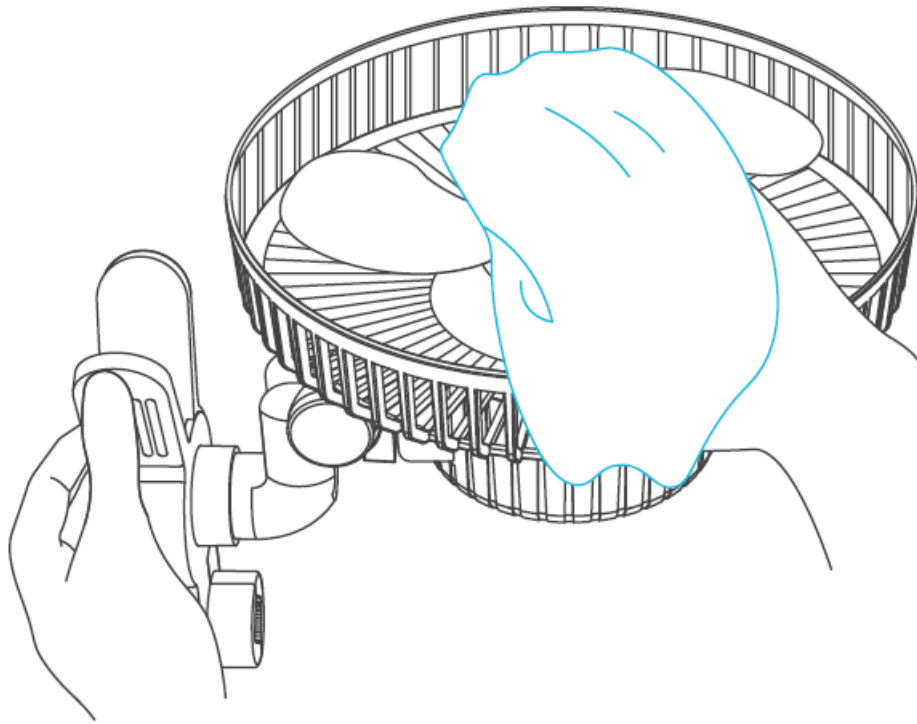

STEP 4

Realign the grille over your clip fan and twist clockwise to lock it in place.

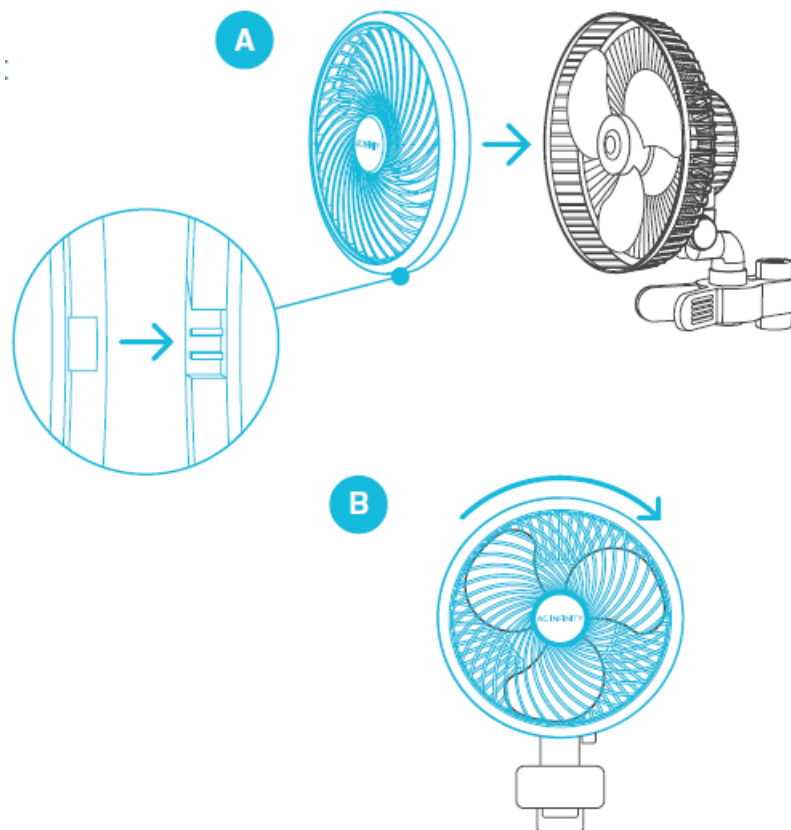

UISTM PLATFORM

The UISTM platform enables you to connect a single central controller with several grow devices simultaneously. By creating this fully integrated system, you can power and program all your devices together or separately for optimized grow tent management.

Your grow system can be regulated using your controller hub or remotely on the AC Infinity app (paired with compatible controllers), where you will have access to automation programming and climate data.

You can also connect your favorite grow light and outlet device to integrate them into the UIS platform using our

RJ11/12 adapter and control plug module.

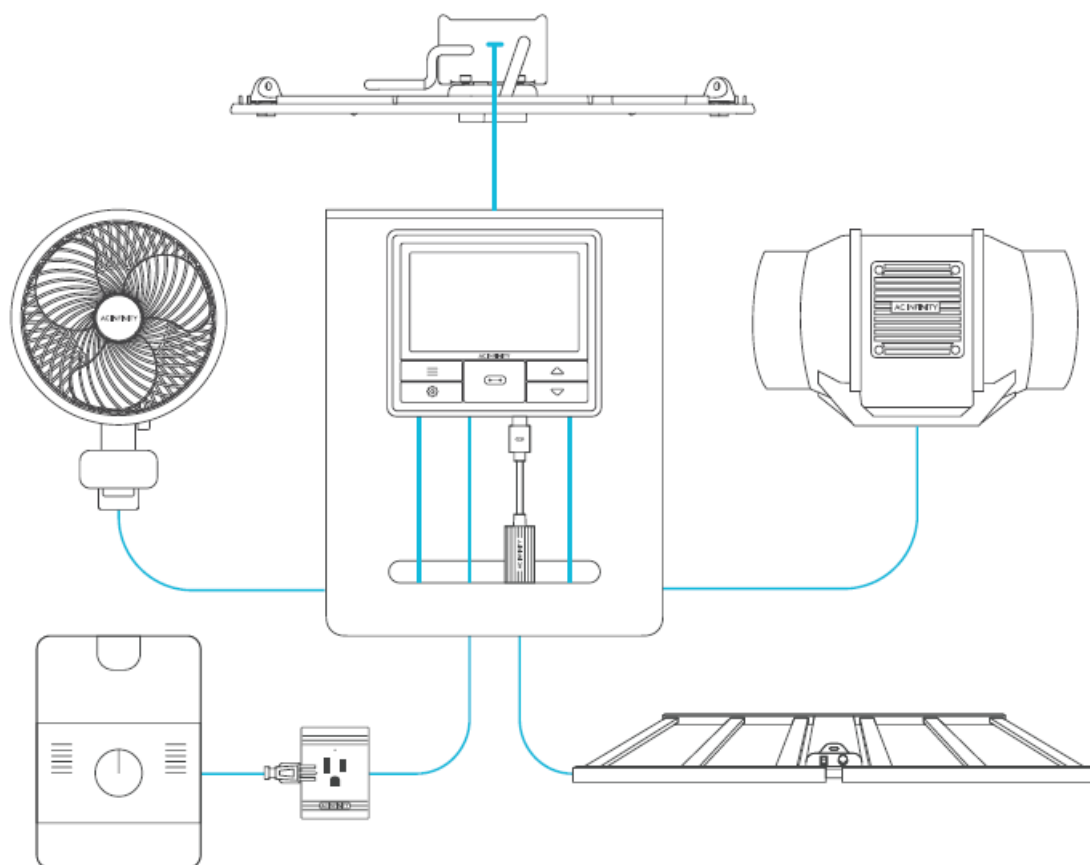

Central controllers, mounting plates, and grow devices will be sold separately and may still be in development at the time of your purchase of this product.

CONNECTING TO CONTROLLERS

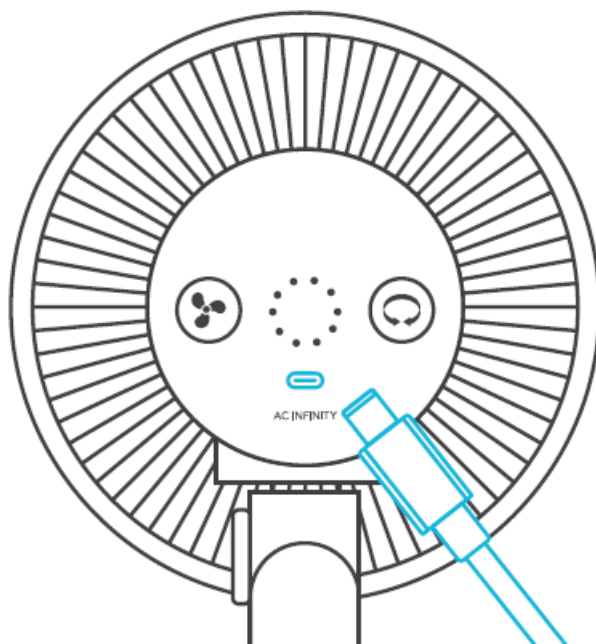

The CLOUDRAY circulation fan can connect with select smart controllers as part of an integrated system using the included UIS cable. Please see below for limitations.

UISTM CONNECTORS

To connect to the latest gen controllers such as CONTROLLER 69 PRO (sold separately), use the included UIS extension cord to directly connect the CLOUDRAY fan's UIS port to the controller's UIS port.

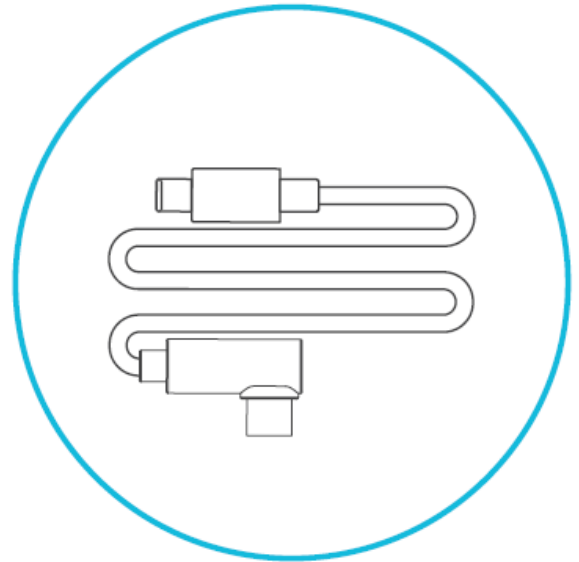
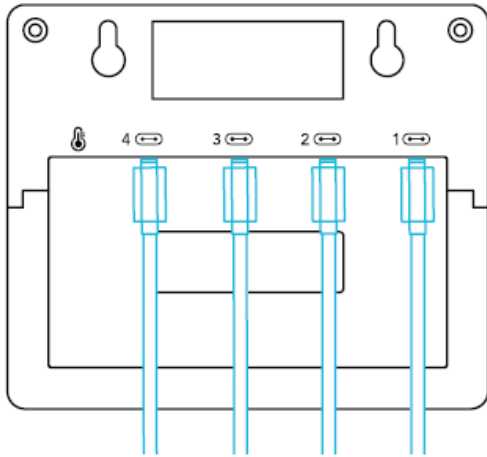

MOLEX CONNECTORS

To connect to previous gen controllers such T-Series controller (UNC529) or CONTROLLER 67 (sold separately), use the included adapter dongle to convert the controller's molex connector to a UIS connector. Then use the included UIS extension cord to connect that to the CLOUDRAY fan's UIS port.

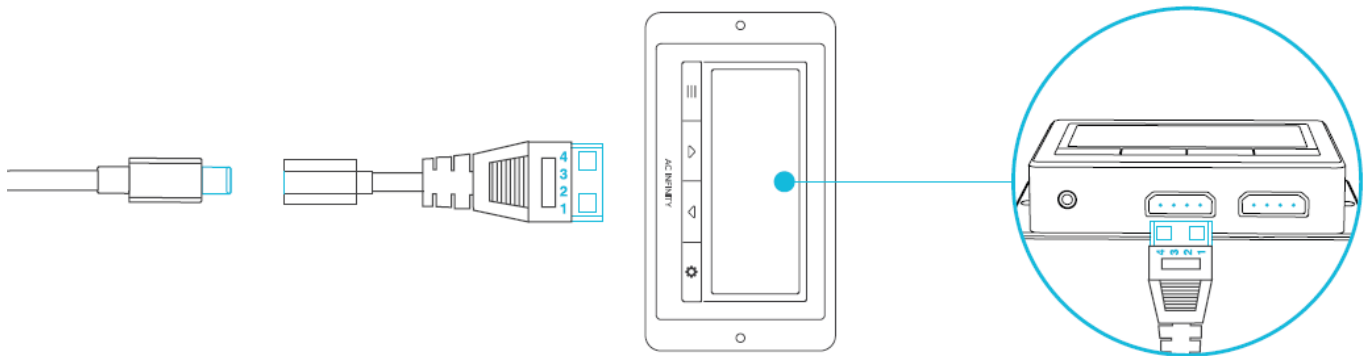

Shown: CONTROLLER 67

PROGRAMMING

S-SERIES

FAN SPEED ADJUSTING

Your clip fan features a single button that cycles through the fan speed from 0-10, indicated by the ring of LED lights.

Press the speed button to increase the fan speed level by one.

Pressing the button past speed 10 will cycle the fan speed back to 0.

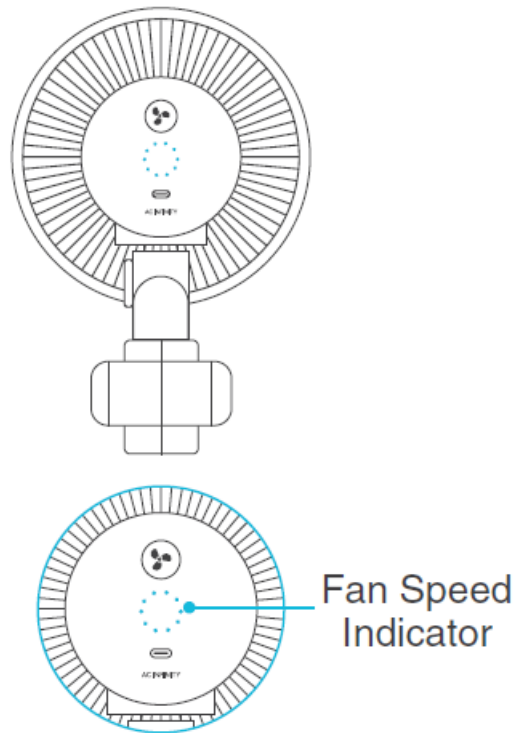

POWERING ON/OFF

Hold the speed button for 4 seconds to turn the fan OFF. Pressing it again from OFF will turn the fan ON at its last speed setting.

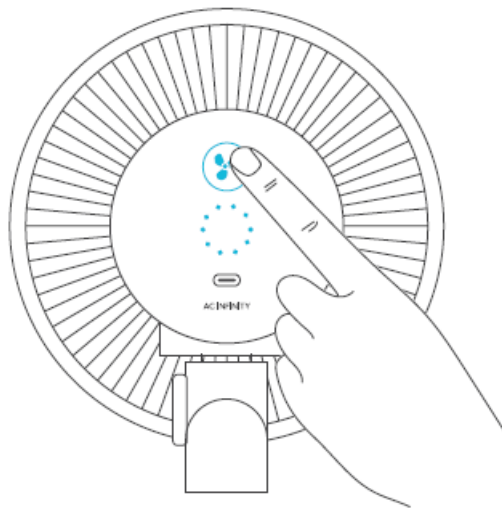

OSCILLATION

In addition to the standard features, S-Series models can oscillate to provide airflow at a wide angle. The oscillation function is manually activated using the oscillation button and cannot be controlled using external UIS programming.

If set to off, your clip fan will not oscillate regardless of any external programs.

If set to on, oscillation will automatically start if the external program activates your clip fan to turn ON. Oscillation will then automatically stop if the external program deactivates your clip fan to turn OFF.

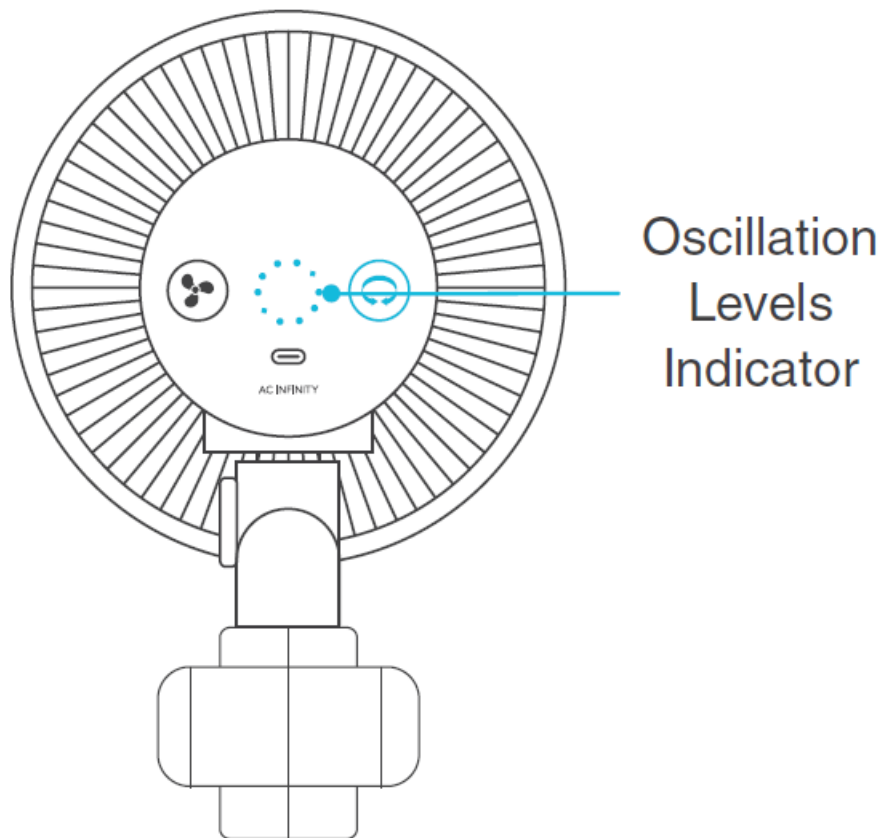

ADJUSTING OSCILLATION RANGE

The oscillation button cycles through the oscillation levels from 0-10 with a maximum 90° angle range, indicated by the ring of LED lights. This will ensure your clip fan will not come in contact with your grow tent while enabling you to adjust the focus of the circulation.

Press the oscillation button to increase how wide the fan will oscillate by one level.

Pressing the button past level 10 will cycle the oscillation back to 0.

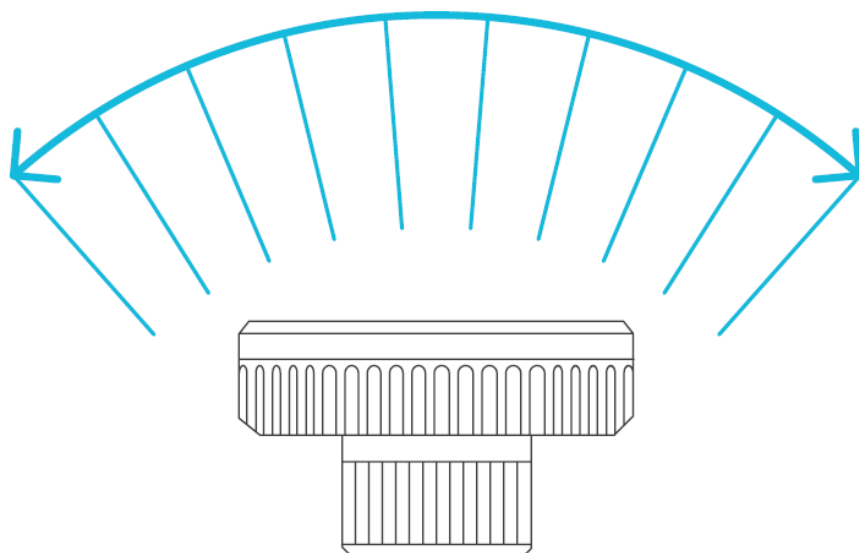

CLOUDRAY FAQ

Q: Can I mount this clip fan upside down?

A: Yes. The CLOUDRAY can be mounted right-side up or upside down.

Q: Will I be able to hardwire this clip fan to my own controller or thermostat?

A: We do not recommend hardwiring or splicing our fan's power wires. Such modifications may compromise electrical safety and will void this product's warranty.

Q: Do I need to use a power converter if I'm outside the US?

A: This product's voltage range is 100-240V AC. You may need a simple travel adapter to plug it into a foreign socket, or a power converter if your country uses a different voltage.

Q: What is the CFM of my clip fan?

A: Please refer to your CLOUDRAY model's product listing for its CFM specification.

Q: Will the clamp be able to hold onto my grow tent?

A: The heavy-duty clamp is capable of gripping onto the poles of any thickness in any grow tent.

Q: Will I be able to connect additional units to this clip fan?

A: The CLOUDRAY does not support daisy-chaining or interconnectivity between additional clip fans. However, multiple fans can be connected to a UIS™ controller to receive smart programming.

Q: How long can I keep this clip fan running?

A: The CLOUDRAY features the latest innovations in step motor technology, allowing it to run continuously for 24 hours a day.

AC INFINITY PRODUCTS

Inline Duct Fans

The CLOUDLINE series is a line of duct fans designed to quietly ventilate AV rooms and closets, as well as various DIY air circulation and exhaust projects. Features a thermal controller with intelligent programming that will automatically adjust duct fan speeds in response to changing temperatures.

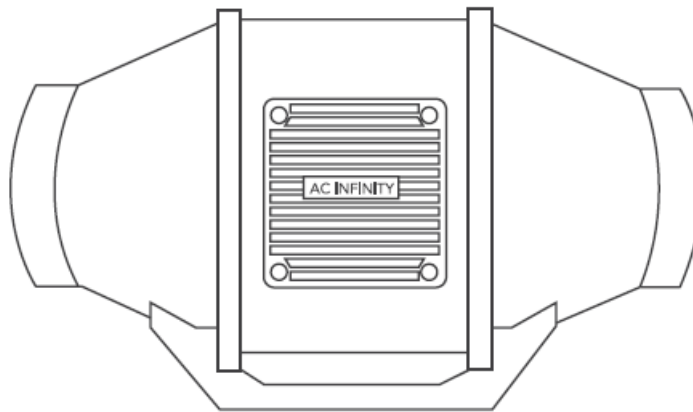

Carbon Filters

The duct carbon filter is designed to eliminate odors and chemicals for grow tents and hydroponic spaces. It utilizes premium grade Australian charcoal that features greater absorption power and a longer lifespan. Enables maximum airflow pass through as part of an intake or an exhaust system.

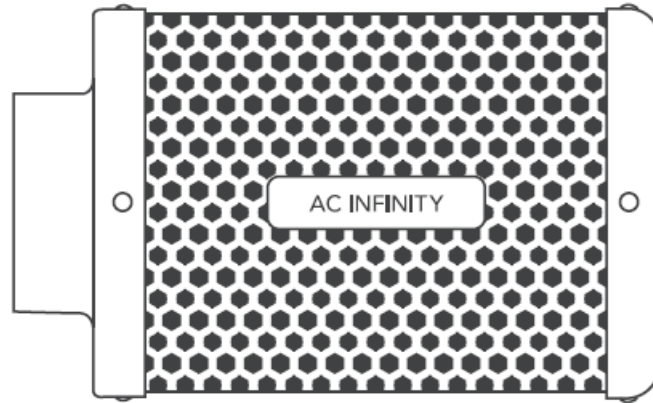

Grow Lights

An indoor LED grow lamp designed to simulate outdoor daytime lighting to improve and accelerate your plant's photosynthesis. Using the latest Samsung LM301H diodes, this LED grow system efficiently produces full-spectrum lighting usable during all stages of the grow cycle.

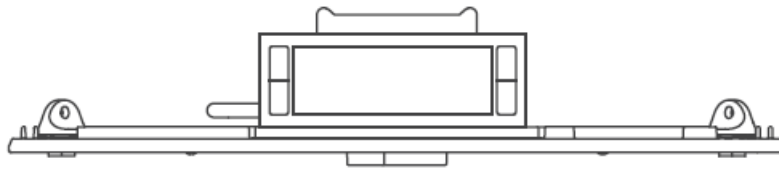

Discover the latest innovations in environmental controls at [acinfinity.com](https://www.acinfinity.com)

WARRANTY

This warranty program is our commitment to you, the product sold by AC Infinity will be free from defects in manufacturing for a period of two years from the date of purchase. If a product is found to have a defect in material or workmanship, we will take the appropriate actions defined in this warranty to resolve any issues.

The warranty program applies to any order, purchase, receipt, or use of any products sold by AC Infinity or our authorized dealerships. The program covers products that have become defective, malfunctioned, or expressively if the product becomes unusable. The warranty program goes into effect on the date of purchase. The program will expire two years from the date of purchase. If your product becomes defective during that period, AC Infinity will replace your product with a new one or issue you a full refund.

The warranty program does not cover abuse or misuse. This includes physical damage, submersion of the product in water, incorrect installation such as wrong voltage input, and misuse for any reason other than intended purposes. AC Infinity is not responsible for consequential loss or incidental damages of any nature caused by the product. We will not warrant damage from normal wear such as scratches and dings.

Contact our dealers department at dealers@acinfinity.com or (626) 838-4656 for more information about our dealers and distributors program. Contact our customer service department at support@acinfinity.com or 626-923-6399 for product and warranty assistance. Our business hours are Monday through Friday, 9:00 am to 5:00 pm PST.

If you have any issues with this product, contact us and we'll happily resolve your problem or issue a full refund!

COPYRIGHT © 2022 AC INFINITY INC. ALL RIGHTS RESERVED

No part of the materials including graphics or logos available in this booklet may be copied, photocopied, reproduced, translated or reduced to any electronic medium or machine readable form, in whole or in part, without

specific permission from AC Infinity Inc.

www.acinfinity.com

Documents / Resources

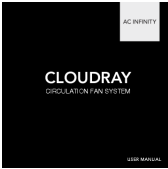
	<p>AC INFINITY Cloudray Circulation Fan System [pdf] User Manual</p> <p>Cloudray Circulation Fan System, Circulation Fan System, Cloudray Circulation Fan, Circulation Fan, Cloudray, Fan</p>
	<p>AC INFINITY Cloudray Circulation Fan System [pdf] User Manual</p> <p>Cloudray Circulation Fan System, Cloudray, Cloudray Fan System, Circulation Fan System, Circulation Fan, Fan System, Fan</p>

References

- [AC Infinity](#)
- [AC Infinity](#)