

ABUS 6950M XPlus Frame Lock



ABUS 6950M XPlus Frame Lock Instruction Manual

[Home](#) » [ABUS](#) » ABUS 6950M XPlus Frame Lock Instruction Manual 

Contents

- [1 ABUS 6950M XPlus Frame Lock](#)
- [2 Product Information](#)
- [3 What In The Box](#)
- [4 Installation Instructions](#)
- [5 Operating Utilisation](#)
- [6 Warranty](#)
- [7 CONTACTS](#)
- [8 Documents / Resources](#)
 - [8.1 References](#)



ABUS 6950M XPlus Frame Lock



Product Information

Specifications

- **Brand:** ABUS
- **Model:** 6950AM
- **Intended Users:** Adults only
- **Minimum Distance Requirement:** 6 mm between lock and moving parts of the bike

FAQ

- **Q:** Can I mount the lock on any type of bike frame?
 - **A:** No, avoid mounting the lock on carbon frames, front frames, or obviously defective struts. Ensure a suitable frame for mounting.
- **Q:** How should I clean the lock?
 - **A:** Avoid using high-pressure cleaners or aggressive cleaning agents. Clean the lock by ensuring it is free from dirt and foreign material before each use.

Thank you for choosing this ABUS product!

Please read this guide carefully before installation and use. Keep these instructions and provide all users with instruction on how to use it. Failure to observe these instructions can lead to injury! For use by adults only! Keep packaging material away from children: Danger of suffocation!

The product may only be used for its intended purpose. Any modification to the product is prohibited.

Only mount the lock on suitable frames and in positions where it does not interfere with riding. Do not mount the lock on carbon frames, the front frame or obviously defective struts.

There must be a distance of at least 6 mm between the fitted lock and the moving parts of the bike.

Make sure that there is no dirt or foreign material on the lock each time before use. Check the lock regularly to ensure that it is mounted securely. The lock must be closed when the bike is transported on a car.

Attention: Risk of injury:

- Danger of crush injuries when opening the lock!
- If you use an additional chain, always remove this before starting your journey.

Do not use a high-pressure cleaner or aggressive cleaning agents to clean the lock.

What In The Box

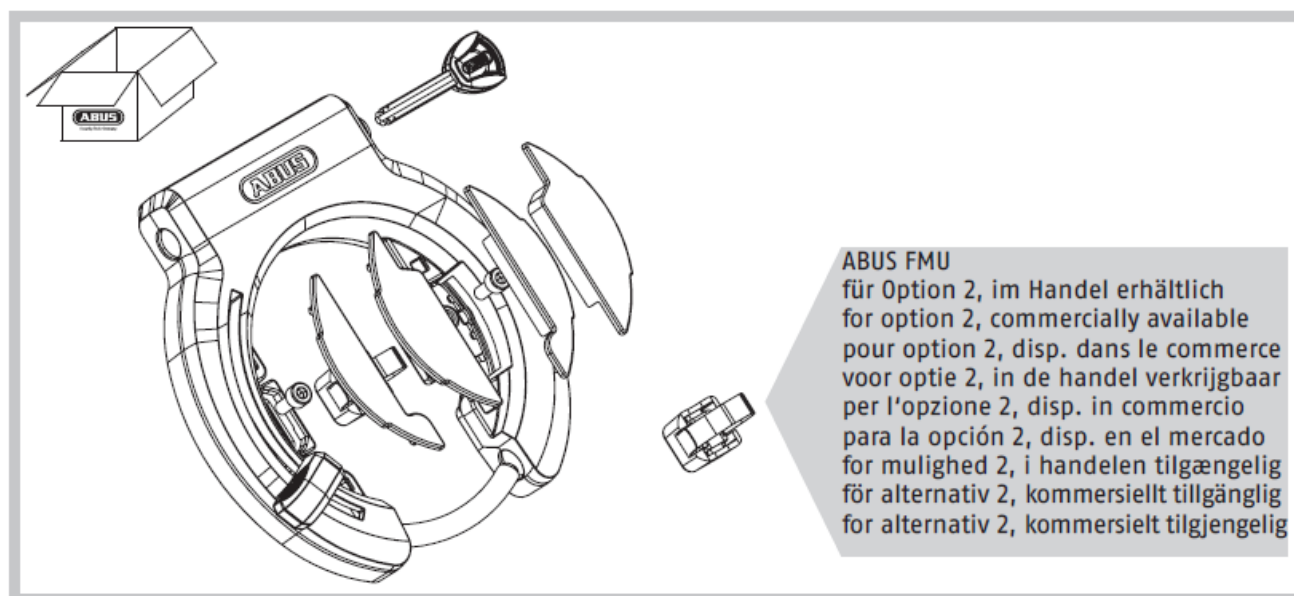

Info

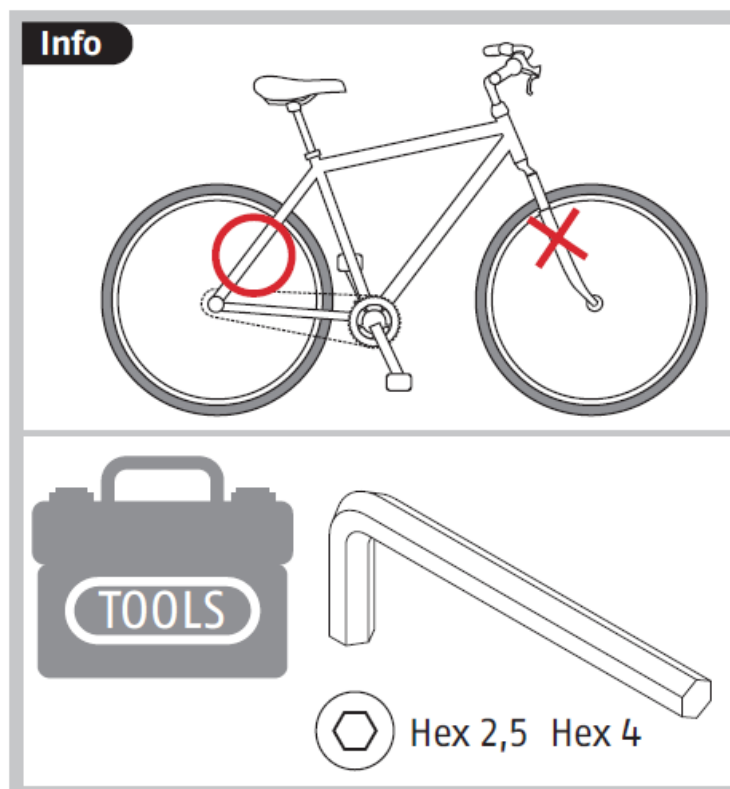

Warning

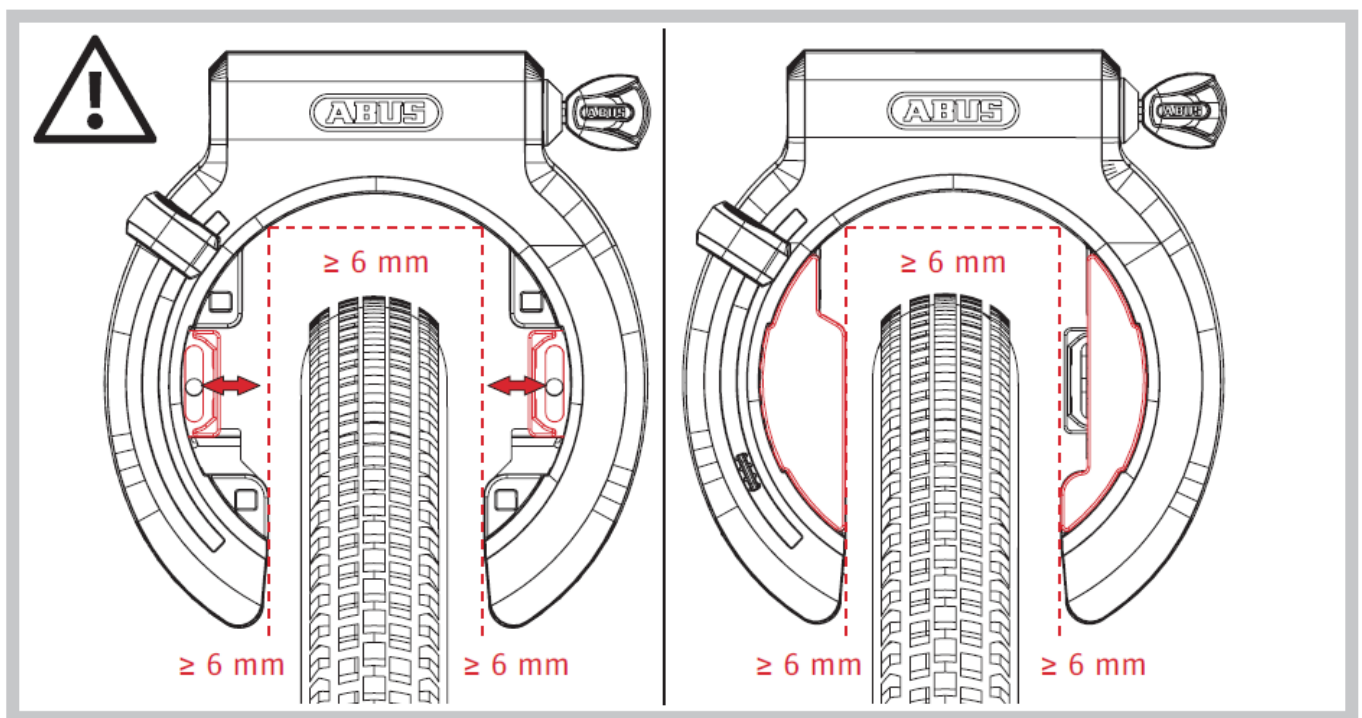

Installation Instructions

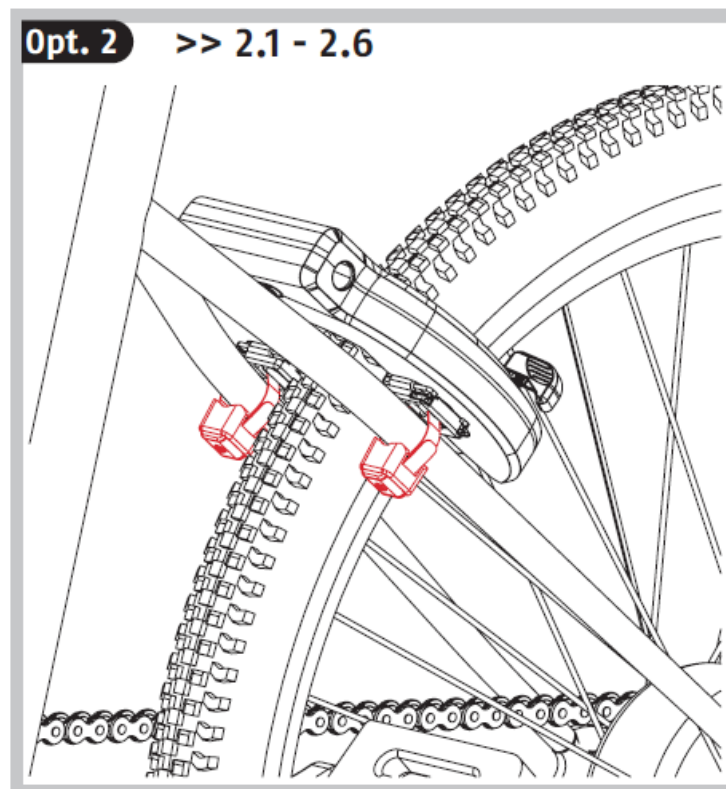
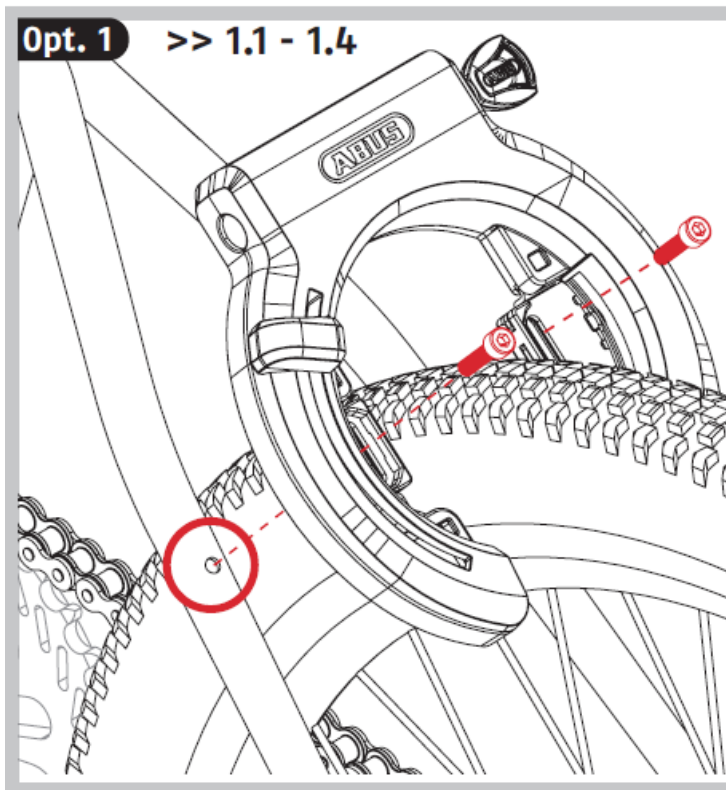

Option 1

1.1

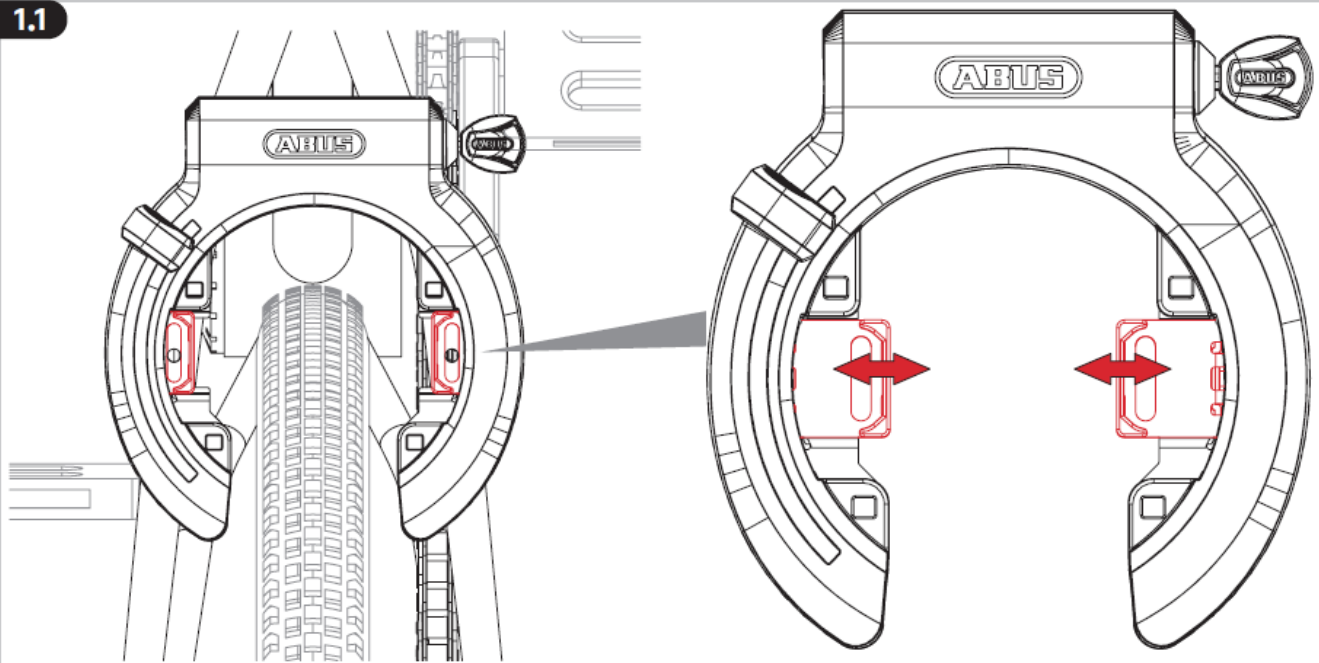

1.2

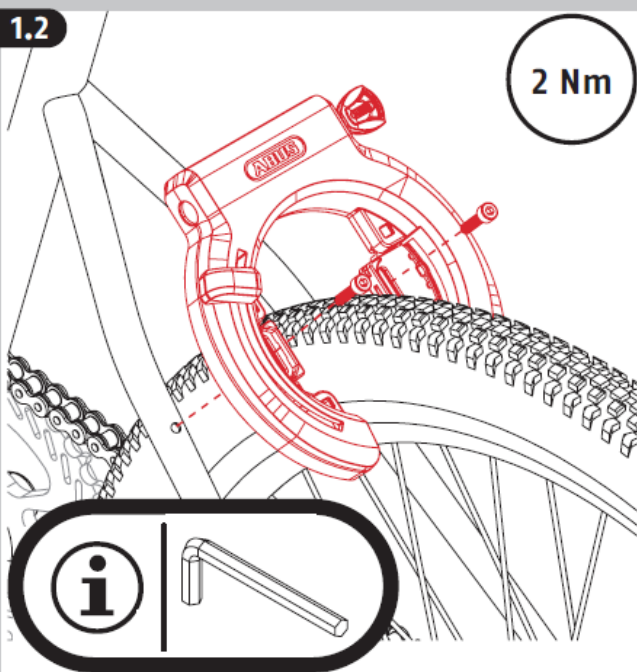

1.3

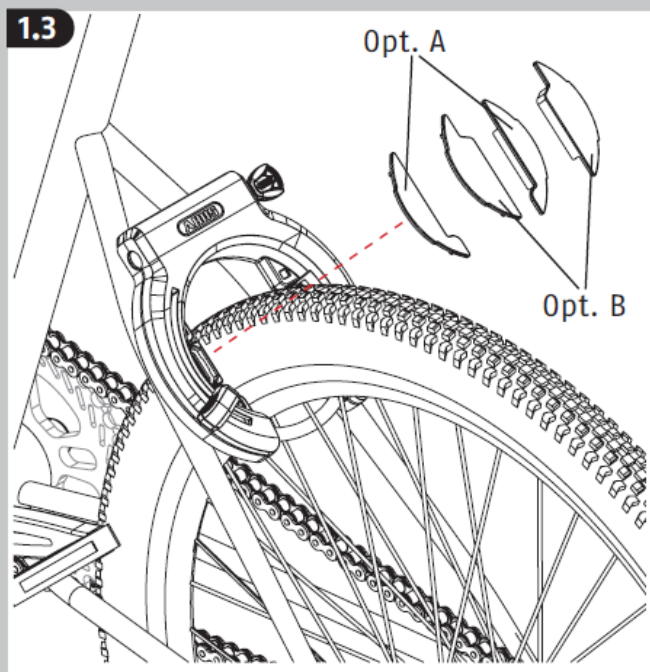

1.4

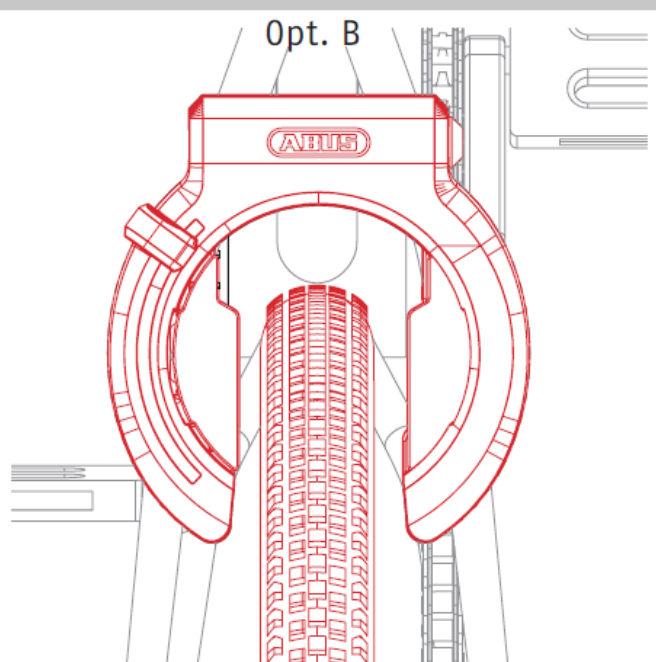
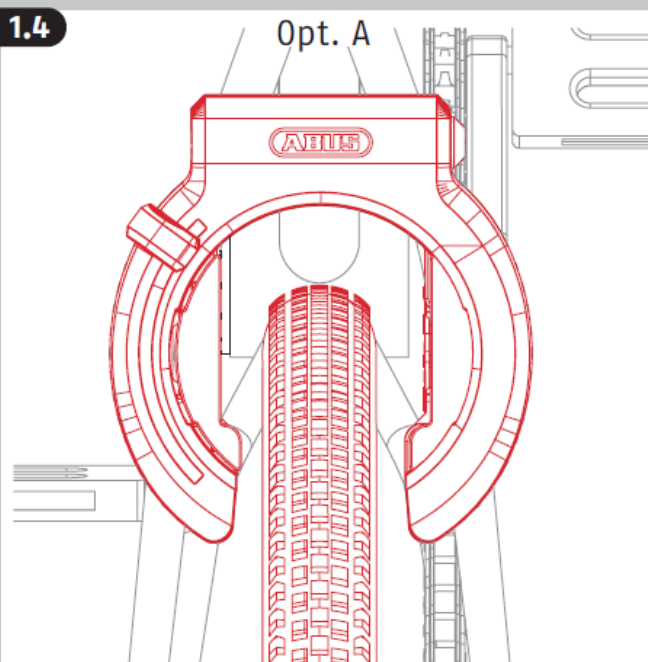

Option 2

2.1

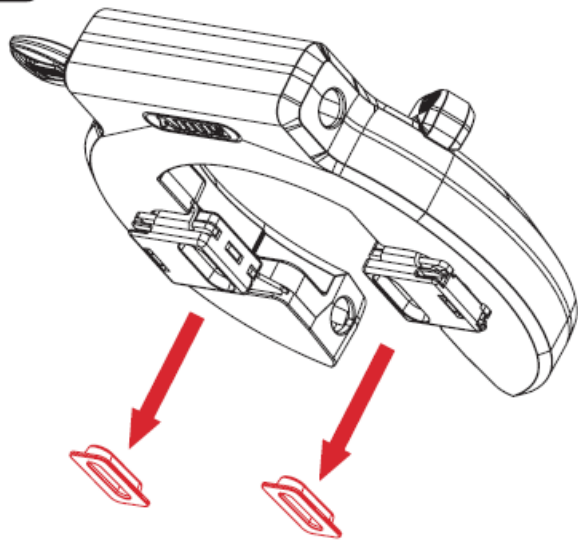

2.2

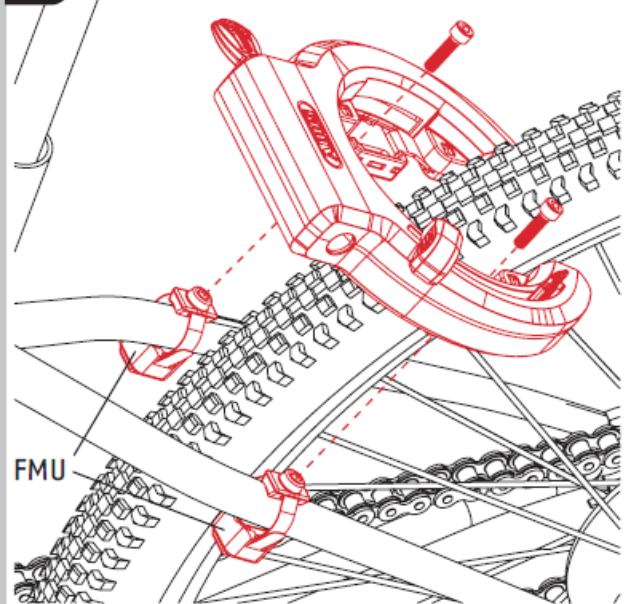

2.3

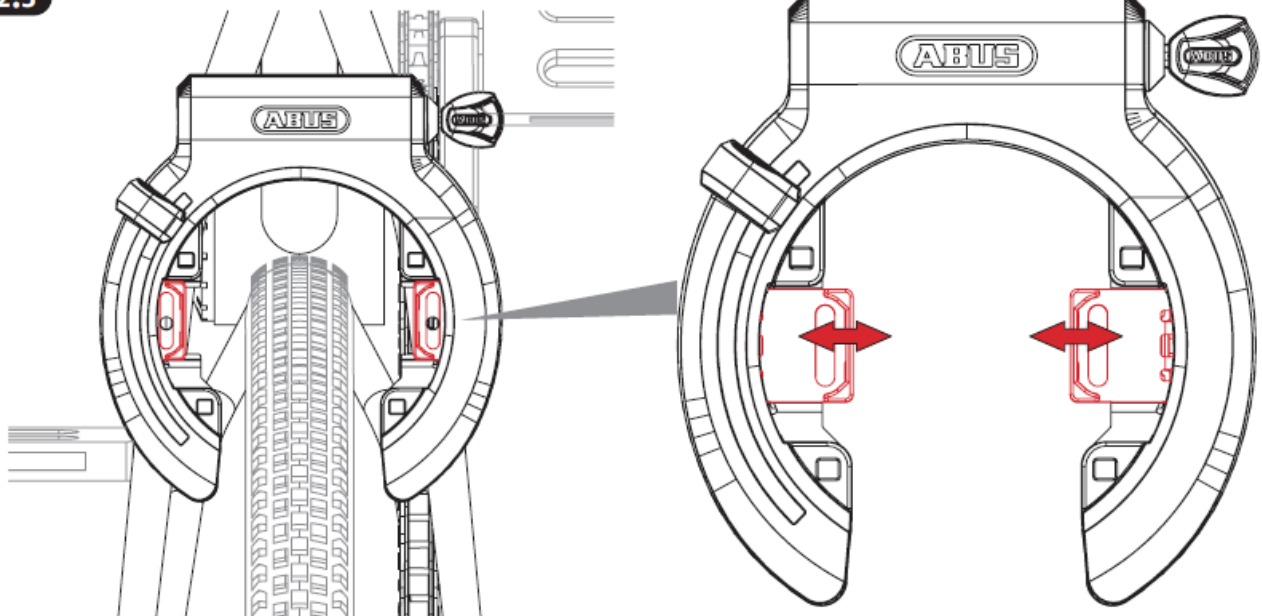

2.4

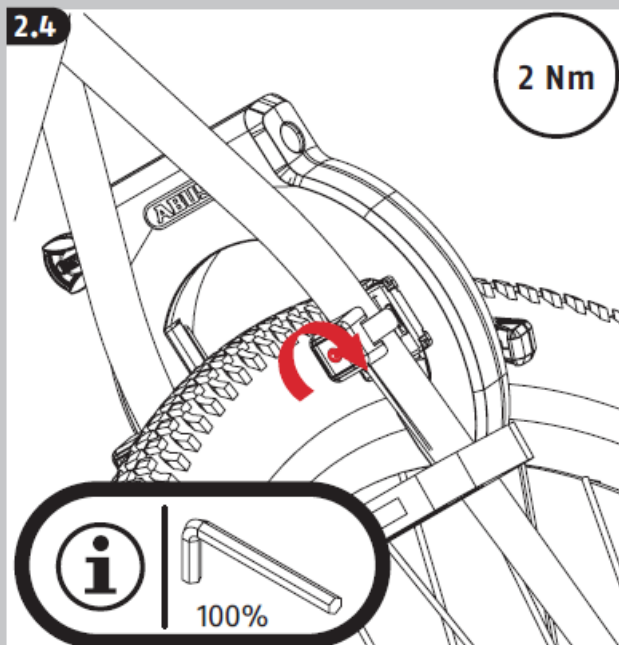

2.5

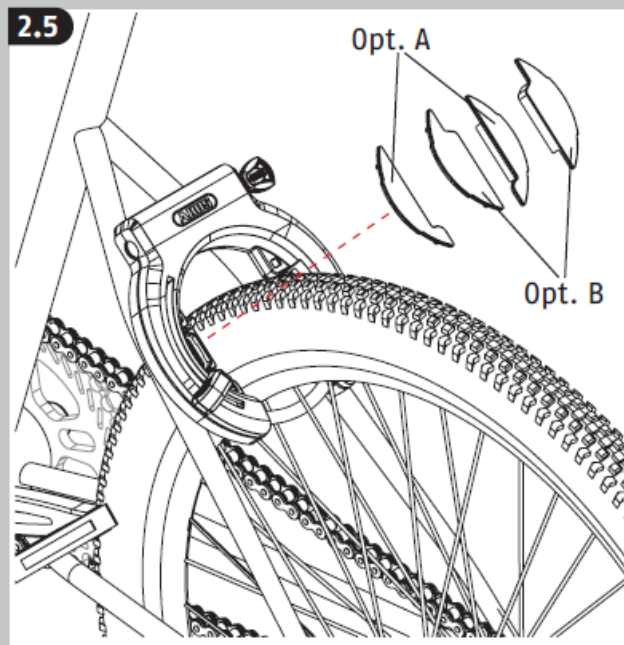

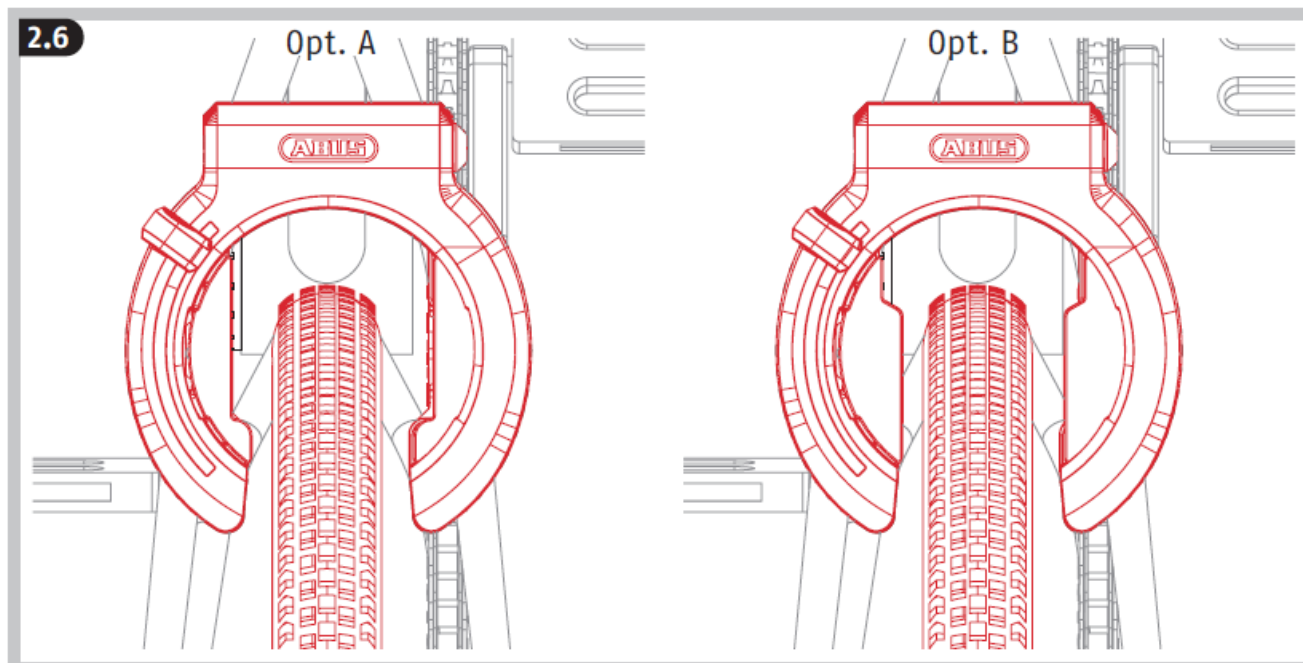

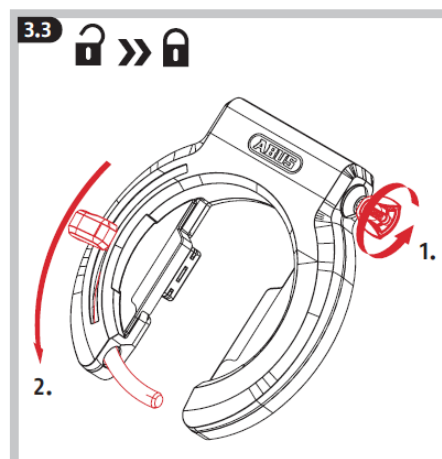
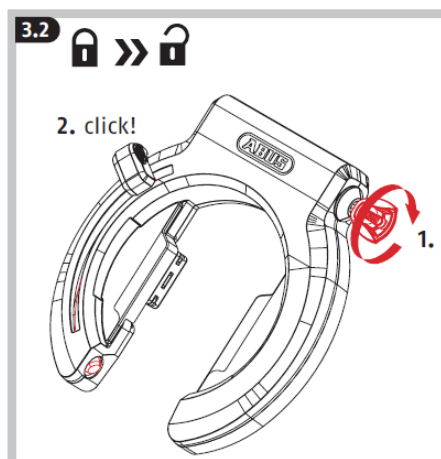
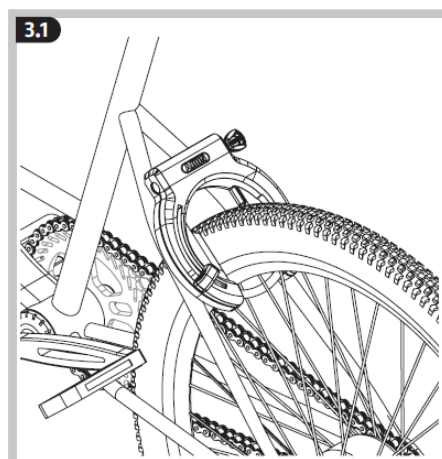

Operating Utilisation

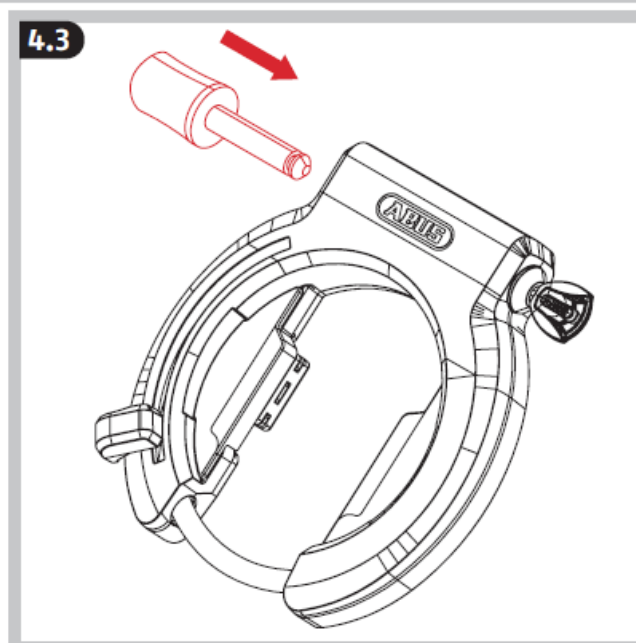
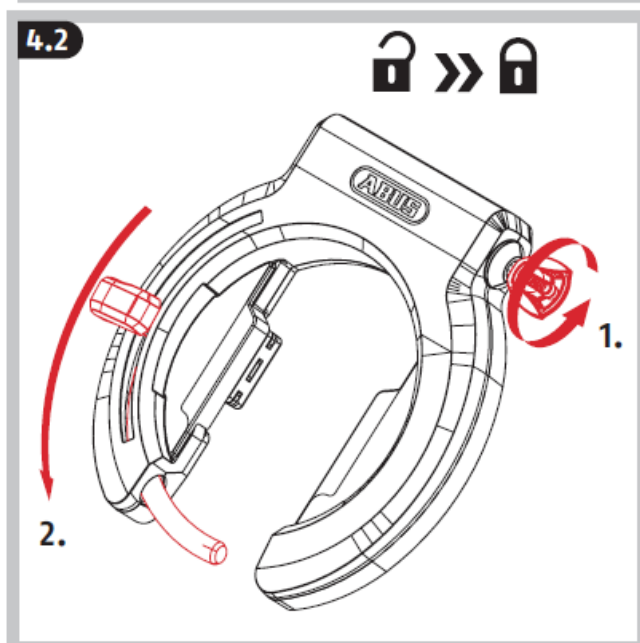
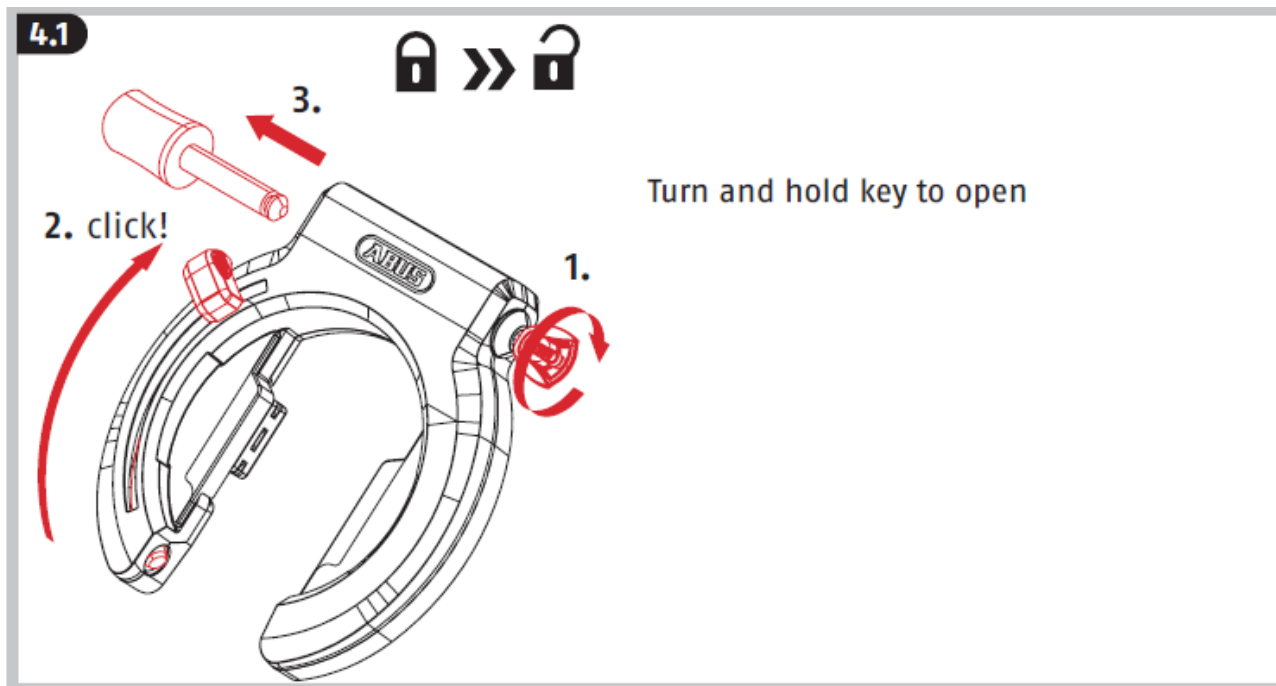

Option: Operating with chain



Icon explanation

-  Warning!
-  Further fitting / using details.

Disposal: At the end of its service life, dispose of the product in accordance with the applicable legal requirements. Please contact the local authority responsible for disposal if you have any queries. Dispose of the packaging according to type. Separate the cardboard, foil and plastic elements for recycling.

Warranty

ABUS products are designed, manufactured and tested in accordance with applicable regulations with great care. The warranty exclusively covers faults that are caused by material or manufacturing defects. If a material or manufacturing defect can be proven, the product will be repaired or replaced at the discretion of the warrantor. In such cases, the warranty ends with the termination of the original warranty period. Any further claims are

expressly excluded.

ABUS assumes no liability for defects or damage that has been caused by external influences (e.g. transport, external forces), improper use, normal wear and tear or non-compliance with this operating and installation instructions document. If a warranty claim is asserted, the product must be returned with the original receipt with date of purchase and a brief written description of the fault.

Subject to technical alterations. No liability for mistakes and printing errors.

© ABUS 2024

CONTACTS

ABUS August Bremicker Söhne KG

- D 58292 Wetter | Germany.
- **Tel.:** +49 (0) 23 35 63 40
- www.abus.com
- info@abus.de

UK-Importer: ABUS (UK) Ltd.

- Unit 30, Portishead Bus. Park
- Old Mill Road, Portishead BS20 7BX, BRISTOL, UK
- **Tel.:** +44 117 204 70 00
- www.abus.com
- info@abus-uk.com

SCAN





[ABUS 6950M XPlus Frame Lock](#) [pdf] Instruction Manual 6950M, 6950M XPlus Frame Lock, XPlus Frame Lock, Frame Lock, Lock

References

- [🇬🇧 UK.COM](#)
- [🇦🇹 ABUS - Security technology since 1924](#)
- [User Manual](#)

[Manuals+.](#) [Privacy Policy](#)

This website is an independent publication and is neither affiliated with nor endorsed by any of the trademark owners. The "Bluetooth®" word mark and logos are registered trademarks owned by Bluetooth SIG, Inc. The "Wi-Fi®" word mark and logos are registered trademarks owned by the Wi-Fi Alliance. Any use of these marks on this website does not imply any affiliation with or endorsement.