



Absen C110 Multi-screen Display User Manual

[Home](#) » [Absen](#) » Absen C110 Multi-screen Display User Manual 

Absen C110 Multi-screen Display User Manual



Contents

- [1 Safety Information](#)
- [2 Product introduction](#)
 - [2.1 Product features](#)
 - [2.2 Product specification](#)
 - [2.3 Screen Dimension Figure \(mm\)](#)
 - [2.4 Standard packaging](#)
- [3 Product Installation](#)
 - [3.1 Installation guide](#)
 - [3.2 Installation method of moving](#)
 - [3.3 Installation method of wall-mounted](#)
- [4 Documents / Resources](#)
- [5 Related Posts](#)

Safety Information

Warning: Please read the safety measures listed in this section carefully before installing powering on operating or doing maintenance on this product.

The following marks on the product and in this manual indicate important safety measures.



WARNING!
Safety risk! Might
cause equipment
damage or safety risk.



WARNING!
Please read the
manual before
operating.



WARNING!
Dangerous voltage!
Might cause
equipment damage
or electric shock.



WARNING!
Hot surface!
Do not touch.



WARNING!
Flammable!



WARNING!
Possible damage
to eyes.



WARNING: Be sure to understand and follow all safety guidelines, safety instructions, warnings and precautions listed in this manual.

This product is for professional use only!

This product may result in serious injury or death due to fire hazard, electric shock, and crushing hazard.



Please read this manual carefully before installing, powering up, operating and maintenance of this product. Follow safety instructions in this manual and on the product. If you have any questions, please seek help from Absen.



Beware of Electric Shock!



- To prevent electric shock the device must be properly grounded during installation, Do not ignore using the grounding plug, or else there is a risk of electric shock.
- During a lightning storm, please disconnect the device's power supply, or provide other suitable lightning protection. If the equipment is not in use for a long time, please unplug the power cord.
- When performing any installation or maintenance work (e.g. removing the fuses, etc.,) make sure to turn off the master switch.
- Disconnect AC power when the product is not in use, or before disassembling, or installing the product.
- The AC power used in this product must comply with local building and electric codes, and should be equipped with overload and ground fault protection.
- The main power switch should be installed at a location near the product and should be clearly visible and easily reached. This way in case of any failure the power can be promptly disconnected.
- Before using this product check all electrical distribution equipment, cables and all connected devices, and make sure all meet current requirements.
- Use appropriate power cords. Please select the appropriate power cord according to the required power and current capacity, and ensure the power cord is not damaged, aged or wet. If any overheating occurs, replace power cord immediately.
- For any other questions, please consult a professional.



Beware of Fire!

- Use a circuit breaker or fuse protection to avoid fire caused by power supply cables overloading.
- Maintain good ventilation around the display screen, controller, power supply and other devices, and keep a minimum 0.1 meter gap with other objects.
- Do not stick or hang anything on the screen.
- Do not modify the product, do not add or remove parts.
- Do not use the product in case ambient temperature is over 55 °C.

Beware of Injury!

-  **Warning:** Wear a helmet to avoid injury.
- Ensure any structures used to support, fix and connect the equipment can withstand at least 10 times the weight of all the equipment.
- When stacking products, please hold products firmly to prevent tipping or falling.
-  Ensure all components and steel frames are securely installed.
- When installing, repairing, or moving the product, ensure the working area is free of obstacles, and ensure the working platform is securely and stably fixed.
-  In the absence of proper eye protection, please do not look directly at the lit screen from within a 1 meter distance.
- Do not use any optical devices that have converging functions to look at the screen to avoid burning the eyes



Product Disposal

- Any component that has a recycling bin label can be recycled.
- For more information on collecting, reusing and recycling, please contact the local or regional waste management unit.
- Please contact us directly for detailed environmental performance information.



WARNING: Beware of suspended loads.



LED lamps used in the module are sensitive and can be damaged by ESD (electrostatic discharge). To prevent damage to LED lamps, do not touch when the device is running or switched off.



WARNING: The manufacturer shall not bear any responsibility for any incorrect, inappropriate, irresponsible or unsafe system installation.

Warning: Changes or modifications to this unit not expressly approved by the party responsible for compliance could void the user's authority to operate the equipment.

NOTE: This equipment has been tested and found to comply with the limits for a Class A digital device, pursuant to part 15 of the FCC Rules. These limits are designed to provide reasonable protection against harmful interference when the equipment is operated in a commercial environment. This equipment generates, uses, and can radiate radio frequency energy and, if not installed and used in accordance with the instruction manual, may cause harmful interference to radio communications. Operation of this equipment in a residential area is likely to cause harmful interference in which case the user will be required to correct the interference at his own expense.

Product introduction

Absenicon3.0 series standard conference screen is an LED intelligent conference terminal product developed by Absen, which integrates document display, high definition display and video conference application, and can meet the multi-scene requirements of enterprise highend conference rooms, lecture halls, lecture room, exhibitions and so on. Absenicon3.0 series conference screen solutions will create a bright, open, efficient and intelligent conference environment, enhance audience's attention, strengthen speech influence and improve conference efficiency.

Absenicon3.0 series conference screens bring a brand-new large-screen visual experience for the conference room, which can share the speaker's intelligent terminal content to the conference screen at any time, without complicated cable connection, and easily realize wireless projection of multi-platform terminals of Windows, Mac OS, iOS and Android. At the same time, according to different conference application scenarios, four scene modes are provided, so that document presentation, video playback and remote conference can match the best display effect. The fast wireless display of up to four screens and switching function can meet various meeting scenarios, and is widely used in commercial meeting scenarios of government, enterprise, design, medical care, education and other industries.



Product features

1. The front of the screen adopts an integrated minimalist design, and the ultra-high percentage of display area for 94%. The front of the screen has no redundant design except for the switch button and the commonly used USB*2 interface. The giant screen interacts, breaking the space boundary, and immersing the experience
2. The back design of the screen is derived from lightning, blurring the concept of singlecabinet splicing, improving the integrated minimalist design, adding textures to improve heat dissipation performance, every detail is a display of art, shocking the eyes;
3. Minimalist hidden cable design, complete the connection of the screen and various external devices with one cable, bid farewell to the messy power signal wiring;
4. Adjustable brightness range 0~350nit by software, optional low blue light mode for eye protection, bring comfortable experience;
5. Ultra-high contrast ratio of 5000:1, 110% NTSC large color space, showing colorful colors, and the smallest visible details are in front of you;
6. 160° ultra-wide display viewing angle, everyone is the protagonist;
7. 28.5mm ultra-thin thickness, 5mm ultra-narrow frame;
8. Built-in audio, dividable frequency processing treble and bass, ultra-wide audio range, shocking sound effects;
9. Built-in Android 8.0 system, 4G+16G running storage memory, support optional Windows10, superb experience of intelligent system;
10. Support multiple device such as computer, mobile phone, PAD wireless display, support four screens simultaneously display, adjustable screen layout;
11. Support scan code to wireless display, no need to set up WIFI connection and other complicated steps to realize one-click wireless display;
12. Support one-key wireless display, access to the transmitter without driver installation, one-key projection;
13. Unlimited internet, wireless display does not affect work, Browsing web information at any time;

14. Provide 4 scene modes, whether it is document presentation, video playback, remote meeting, can match the best display effect, so that every moment can enjoy comfort, builtin a variety of VIP welcome templates, quickly and efficiently improve the welcome atmosphere;
15. Support remote control, can adjust brightness, switch signal source, adjust color temperature and other operations, one hand can control various functions;
16. All kinds of interfaces are available, and peripheral devices can access
17. A variety of installation methods to meet your installation needs, 2 people 2 hours rapid installation, All modules support full front maintenance

Product specification

		Absenicon3.0 C110
Display Parameters	Product size (Inch)	110
	Display area mm	2440*1372
	Screen size mm	2450×1487×28.5
	Pixel Per Panel Dots)	1920×1080
	Brightness nit	350nit
	Contrast Ratio	4000:1
	colour space NTSC	110%
Power Parameters	power supply	AC 100-240V
	average power consumption(w)	400

	Maximum power consumption(w)	1200
System Parameters	Android system	Android8.0
	System configuration	1.7G 64-bit quad-core processor, Mail T820 GPU
	System memory	DDR4-4GB
	Storage capacity	16GB eMMC5.1
	control interface	MiniUSB*1 RJ45*1
	I/O interface	HDMI2.0 IN*3 USB2.0*1 USB3.0*3 Audio OUT*1 SPDIF OUT*1 RJ45*1 Automatic sharing of network and control
OPS	Optional	Support
Environmental Parameters	Operating Temperature °C	-10°C 40°C
	Operating Humidity RH	10 80%RH
	Storage Temperature °C	-40°C 60°C
	Storage Humidity RH	10% 85%

Screen Dimension Figure (mm)

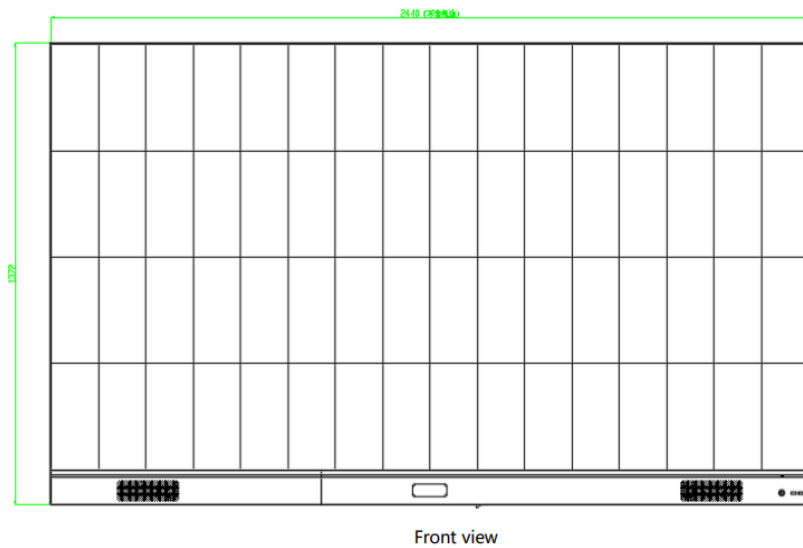

Standard packaging

The product packaging of the all-in-one machine is mainly composed of three parts: box/module packaging (1*4 modular packaging) , installation structure packaging (movable bracket or wall hanging + edging).

The cabinet packaging is unified to 2010*870*500mm

Three 1*4 cabinets + free packaging into honeycomb box, overall size: 2010*870*500mm

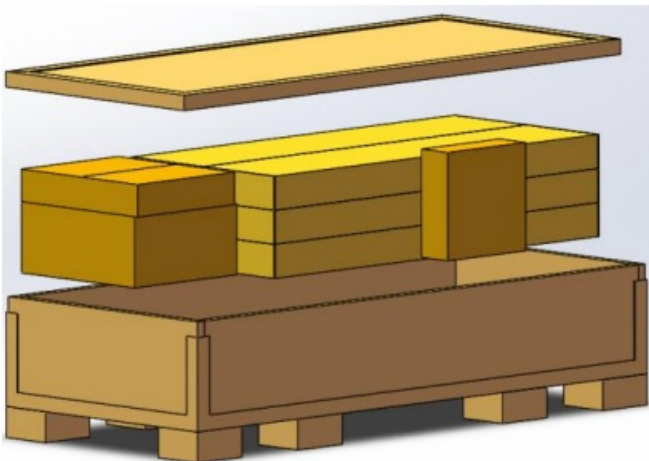

one 1*4 cabinet and four 4*1*4 module packages and edge into the honeycomb box, dimensions: 2010*870*500mm

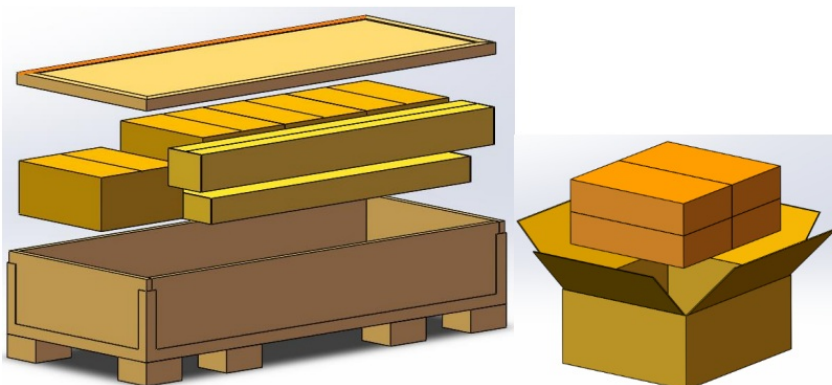

Installation structure packaging figure (take the movable bracket as an example)

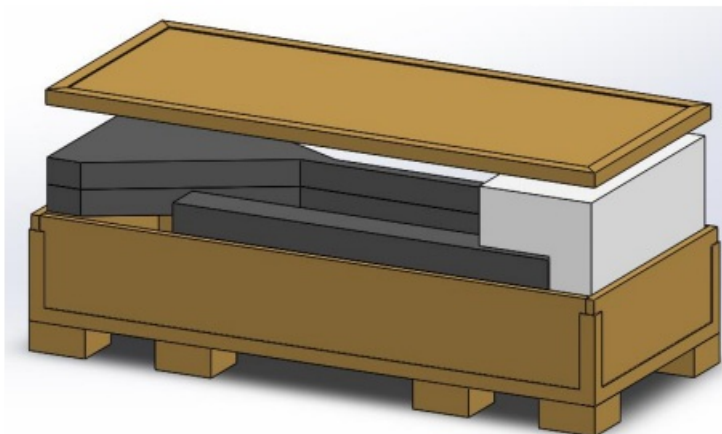

Product Installation

This product can realize wall-mounted installation and movable bracket installation.'

Installation guide

This product is calibrated by the whole machine. In order to ensure the best display effect, it is recommended to install it according to the identification sequence number of our company.

Diagram of installation number (front view)

1-1-1	1-1-2	1-1-3	1-1-4	1-1-2-1	1-1-2-2	1-1-2-3	1-1-2-4	1-1-3-1	1-1-3-2	1-1-3-3	1-1-3-4	1-1-4-1	1-1-4-2	1-1-4-3	1-1-4-4
1-1-1	1-1-2	1-1-3	1-1-4	1-1-2-1	1-1-2-2	1-1-2-3	1-1-2-4	1-1-3-1	1-1-3-2	1-1-3-3	1-1-3-4	1-1-4-1	1-1-4-2	1-1-4-3	1-1-4-4
1-2-1	1-2-2	1-2-3	1-2-4	1-2-1	1-2-2	1-2-3	1-2-4	1-2-1	1-2-2	1-2-3	1-2-4	1-2-1	1-2-2	1-2-3	1-2-4
1-2-1	1-2-2	1-2-3	1-2-4	1-2-1	1-2-2	1-2-3	1-2-4	1-2-1	1-2-2	1-2-3	1-2-4	1-2-1	1-2-2	1-2-3	1-2-4
1-3-1	1-3-2	1-3-3	1-3-4	1-3-1	1-3-2	1-3-3	1-3-4	1-3-1	1-3-2	1-3-3	1-3-4	1-3-1	1-3-2	1-3-3	1-3-4
1-3-1	1-3-2	1-3-3	1-3-4	1-3-1	1-3-2	1-3-3	1-3-4	1-3-1	1-3-2	1-3-3	1-3-4	1-3-1	1-3-2	1-3-3	1-3-4
1-4-1	1-4-2	1-4-3	1-4-4	1-4-1	1-4-2	1-4-3	1-4-4	1-4-1	1-4-2	1-4-3	1-4-4	1-4-1	1-4-2	1-4-3	1-4-4
1-4-1	1-4-2	1-4-3	1-4-4	1-4-1	1-4-2	1-4-3	1-4-4	1-4-1	1-4-2	1-4-3	1-4-4	1-4-1	1-4-2	1-4-3	1-4-4

Number description:

The first digit is the screen number, the second digit is the cabinet number, from top to bottom, the top is the first row; The third place is the cabinet column number:

For example, 1-1-2 is the first row and the second column at the top of the first screen.

Installation method of moving

Install frame

Take out the frame from the packing box, including the cross beam and vertical beam. Place it on the ground with the front facing upwards (the side with the silk-printed logo on the beam is the front); Assemble the four sides of the frame, including two beams, two vertical beams and 8 M8 screws.

The side of the beam with screw holes is facing up

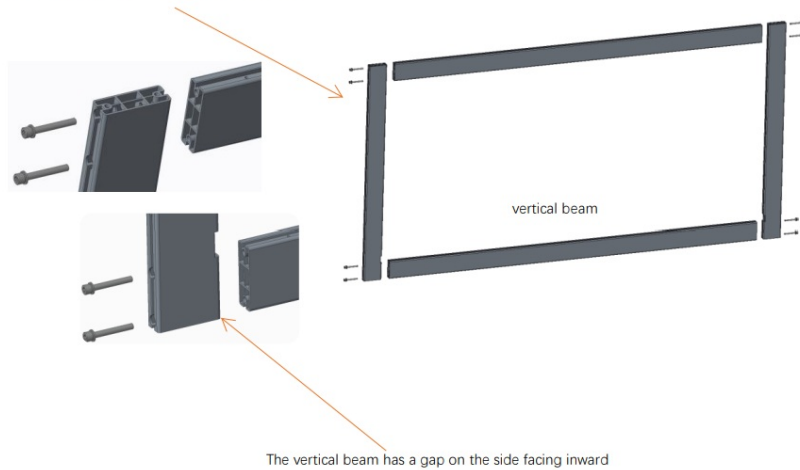

Install support legs

1. Confirm the the front and back of the support leg and height of the bottom of the screen from the ground.

Note: There are 3 heights to choose for the height of the bottom of the screen surface from the ground: 800mm, 880mm and 960mm, corresponding to different installation holes of the vertical beam.

The default position of the bottom of the screen is 800mm from the ground, the height of the screen is 2177mm, the highest position is 960mm, and the height of the screen is 2337mm.

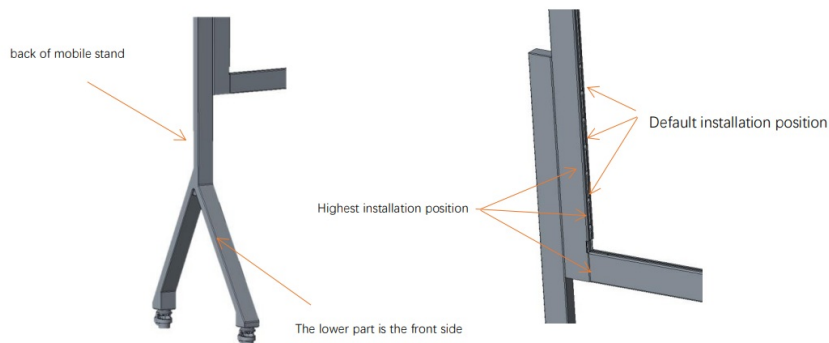

2. The front of the frame is in the same direction as the front of the support leg, and a total of 6 M8 screws on both

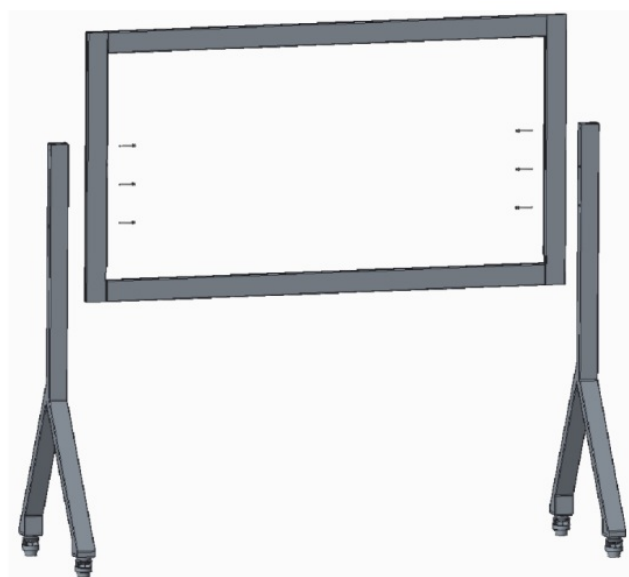

sides are installed.

Install cabinet

Hang the middle row of cabinet first, and hook connecting plate on the back of the cabinet into the notch of the

cross beam of the frame. Move the cabinet to the center and align the marking line on the beam;

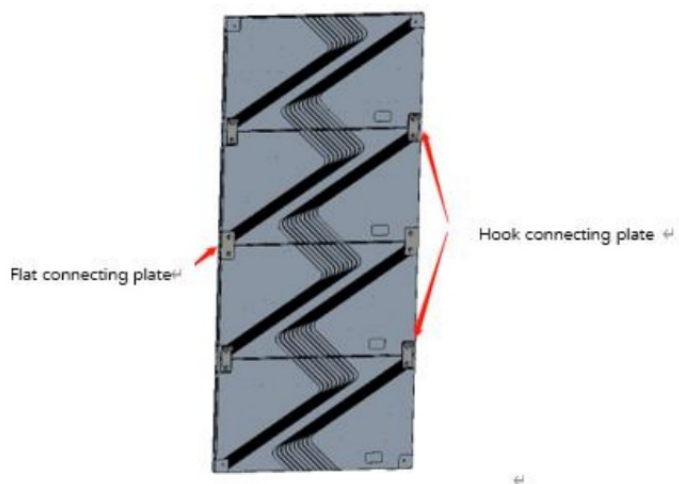

1. Install 4 M4 safety screws after the cabinet is installed;

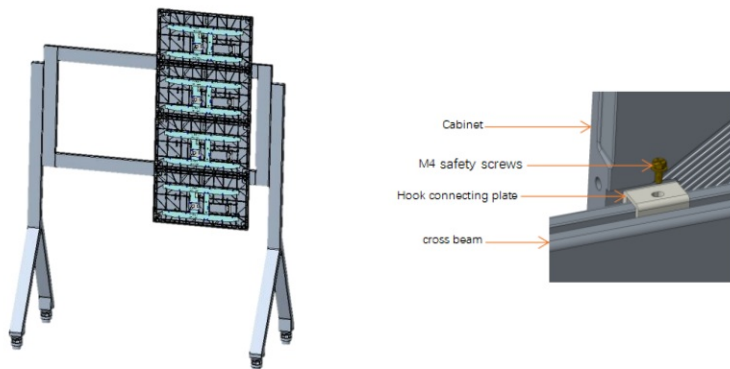

Note: The internal structure is subject to the actual product.

2. Hang the cabinets on the left and right sides in turn, and lock the left and right connecting bolts on the cabinet.
The four-corner hook connecting plate of the screen are flat connecting plate.

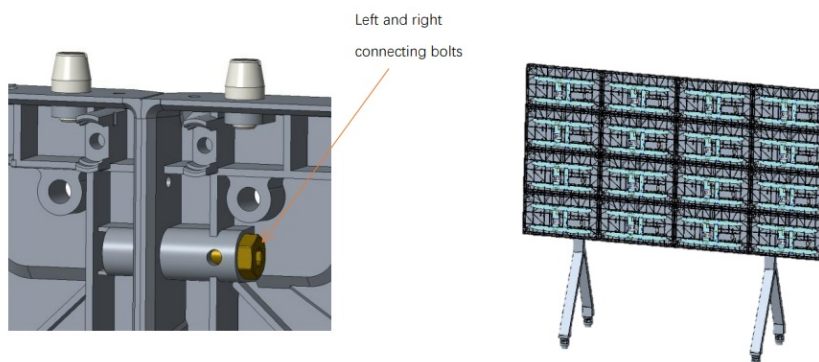

Note: The internal structure is subject to the actual product.

Install edging

1. Install the edging under the screen, and tighten the fixing screws of the left and right connecting plates of the bottom edging (16 M3 flat head screws);

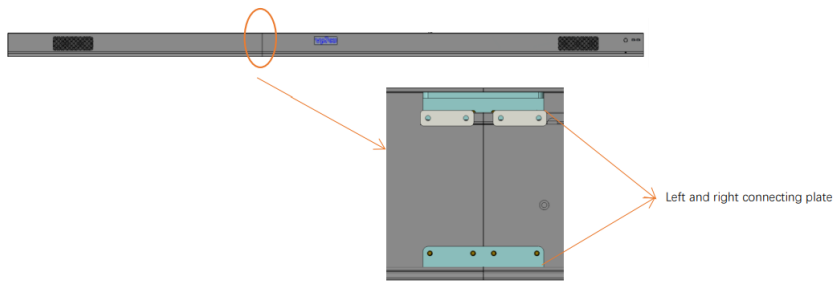

2. Fix the lower edging to the bottom row of cabinets, tighten 6 M6 screws, and connect the power and signal wires of the lower edging and the bottom cabinet;

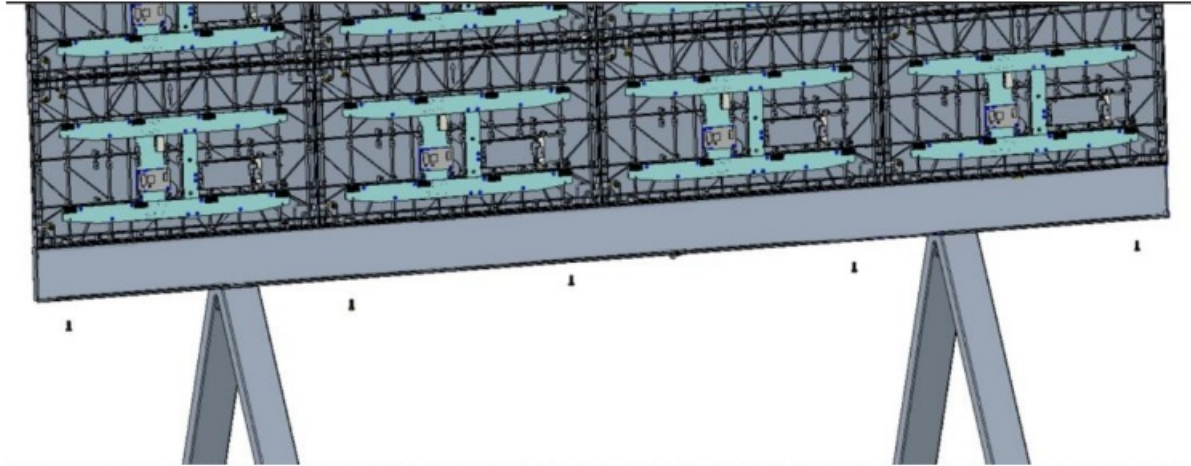

Note: The internal structure is subject to the actual product.

3. Install the left, right and top edging using M3 flat head screws;

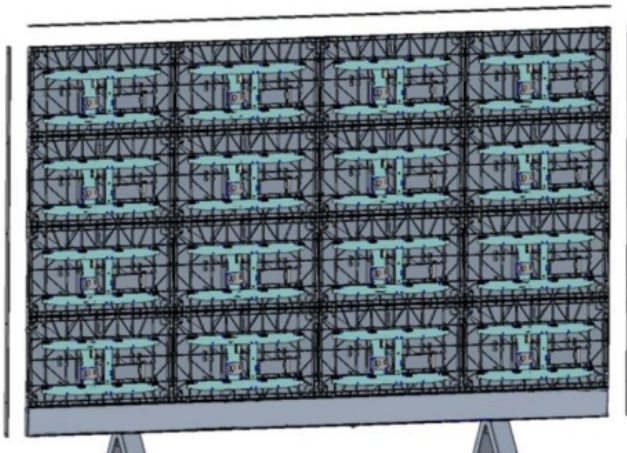

Note: The internal structure is subject to the actual product.

Install module

Install the modules in order of number.

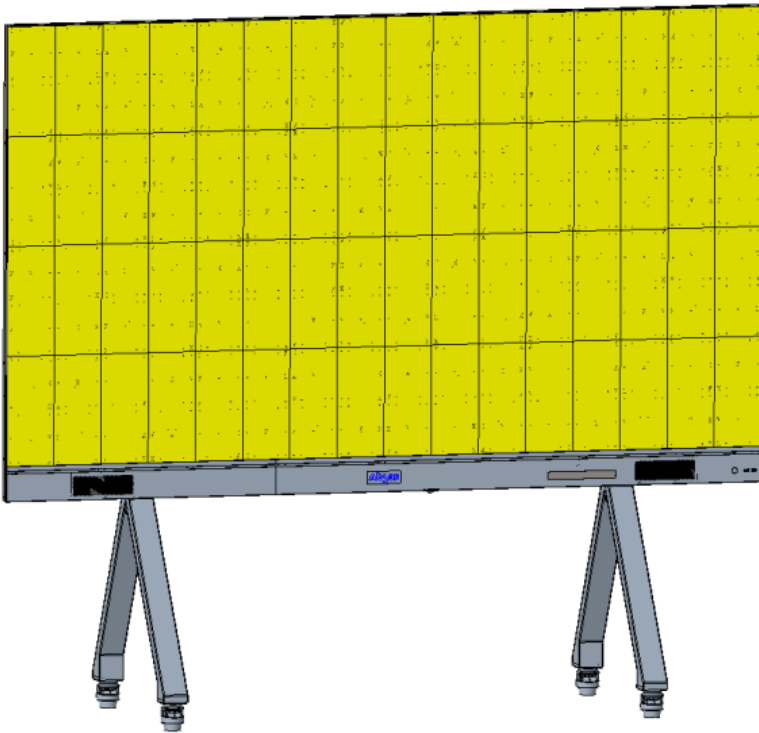

Installation method of wall-mounted

Assemble frame

Take out the frame from the packing box, including the cross beam and vertical beam. Place it on the ground with the front facing upwards (the side with the silk-printed logo on the beam is the front);
Assemble the four sides of the frame, including two beams, two vertical beams and 8 M8 screws.

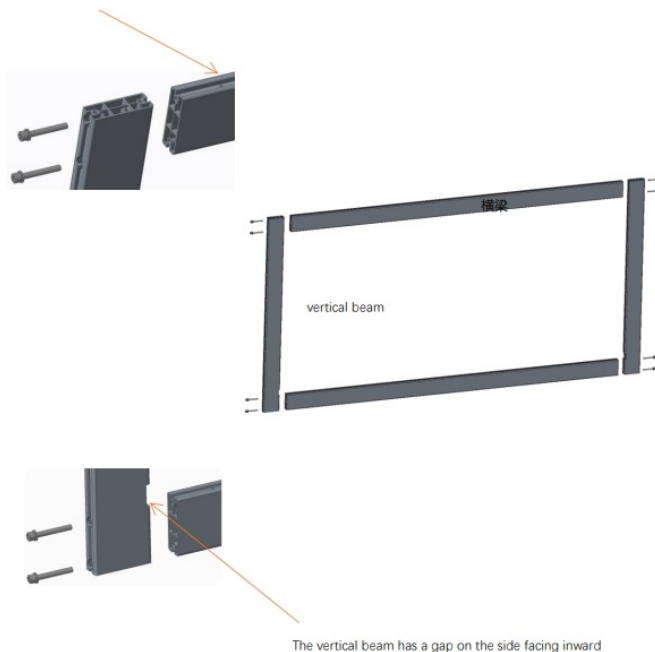

Install frame fixed connecting plate

1. Install the frame fixed connecting plate;

Frame fixed connecting plate Each is fixed with 3 M8 expansion screws

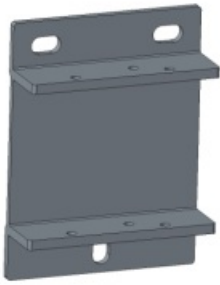

After the connecting plate is installed, install the back frame, and fix it with 2 M6*16 screws at each position (the screws are topped into the groove on the beam, clamped up and down,)

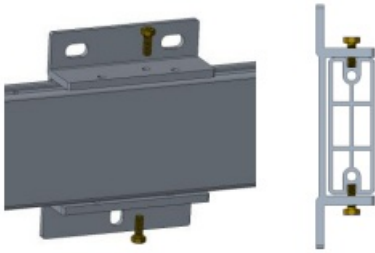

2. After confirming the installation position of the connecting plate on the back frame and the position of the screen body, drill holes on the wall to install the fixed connecting plate (only 4 connecting plates on the four sides can be installed when the wall bearing capacity is good);

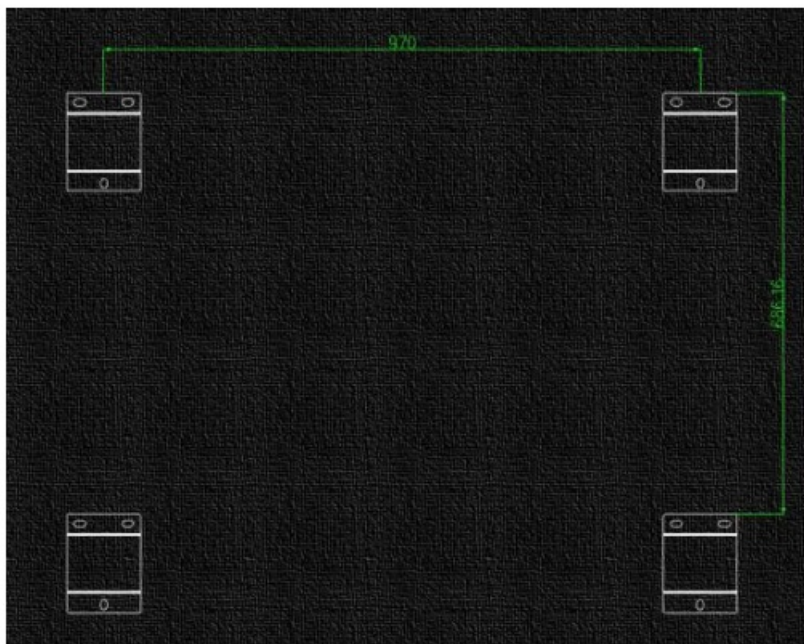

Fixed the frame

After the frame fixed connecting plate is installed, install the frame, fix it with 2 M6*16 screws at each position, and clamp it up and down.

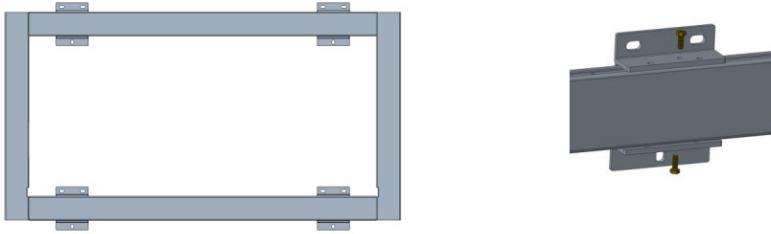

Install cabinet

1. Hang the middle row of cabinet first, and hook connecting plate on the back of the cabinet into the notch of the cross beam of the frame. Move the cabinet to the center and align the marking line on the beam;

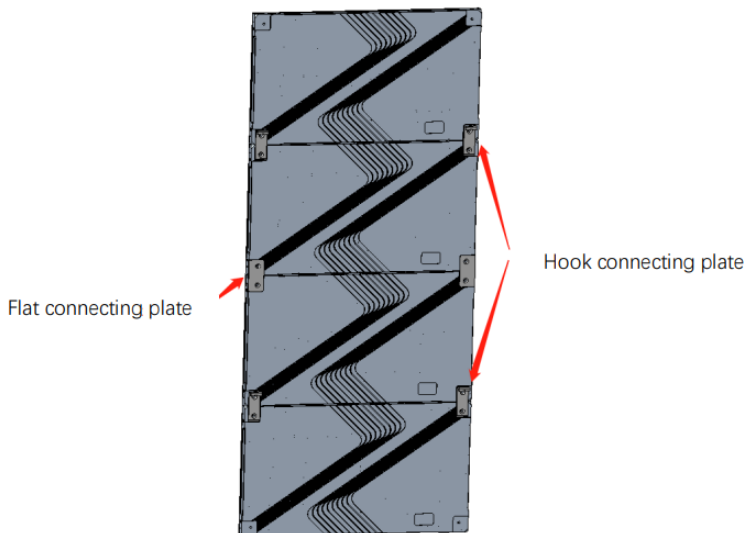

2. Install 4 M4 safety screws after the cabinet is installed

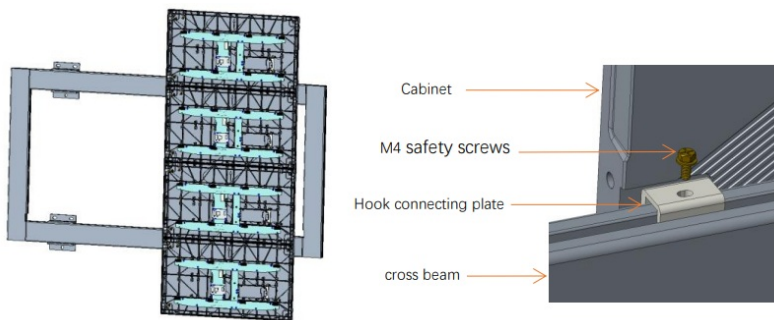

Note: The internal structure is subject to the actual product.

3. Hang the cabinets on the left and right sides in turn, and lock the left and right connecting bolts on the cabinet. The four-corner hook connecting plate of the screen are flat connecting plate

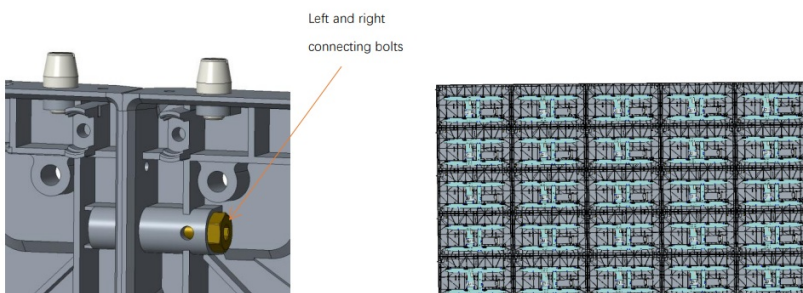

Note: The internal structure is subject to the actual product.

Install edging

1. Install the edging under the screen, and tighten the fixing screws of the left and right connecting plates of the bottom edging (16 M3 flat head screws);

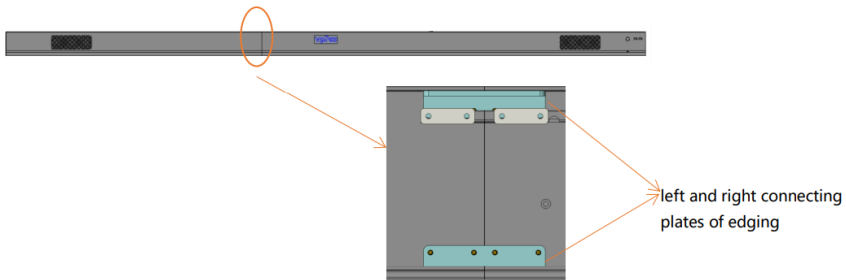

2. Fix the lower edging to the bottom row of cabinets, tighten 6 M6 screws, and connect the power and signal wires of the lower edging and the bottom cabinet;

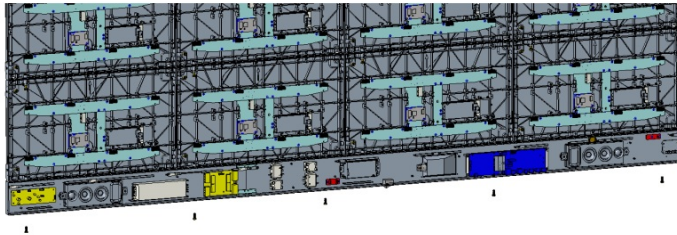

Note: The internal structure is subject to the actual product.

3. Install the left, right and top edging using M3 flat head screws;

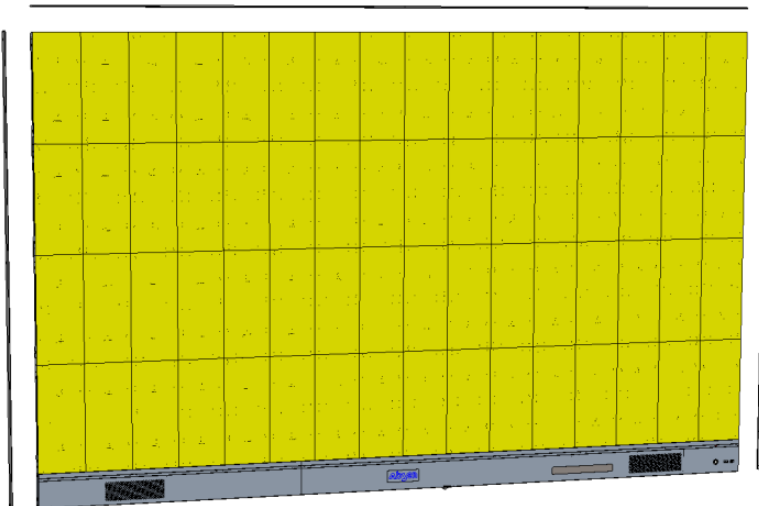

Note: The internal structure is subject to the actual product.

Install module

Install the modules in order of number.



Please refer to Absenicon3.0 C138 user manual for system operation instructions and maintenance instructions

Documents / Resources

<p>Absenicon3.0 Series C110 User Manual</p> 	<p>Absen C110 Multi-screen Display [pdf] User Manual C110 Multi-screen Display, Multi-screen Display, screen Display</p>
------------------------------------------------------------------------------------------------------------------------------------	----------------------------------------------------------------------------------------------------------------------------------------------