

ABOUTSTEK Stek Table 13 and 5kg Side Table Made of Travertine

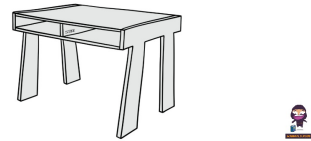

ABOUTSTEK Stek Table 13 and 5kg Side Table Made of Travertine Installation Guide

[Home](#) » [ABOUTSTEK](#) » ABOUTSTEK Stek Table 13 and 5kg Side Table Made of Travertine Installation Guide 

Contents

- [1 ABOUTSTEK Stek Table 13 and 5kg Side Table Made of Travertine](#)
- [2 Parts List](#)
- [3 Assembly Instructions](#)
- [4 Final Product](#)
- [5 Specifications](#)
- [6 FAQ](#)
- [7 Documents / Resources](#)
 - [7.1 References](#)
- [8 Related Posts](#)

ABOUTSTEK

ABOUTSTEK Stek Table 13 and 5kg Side Table Made of Travertine

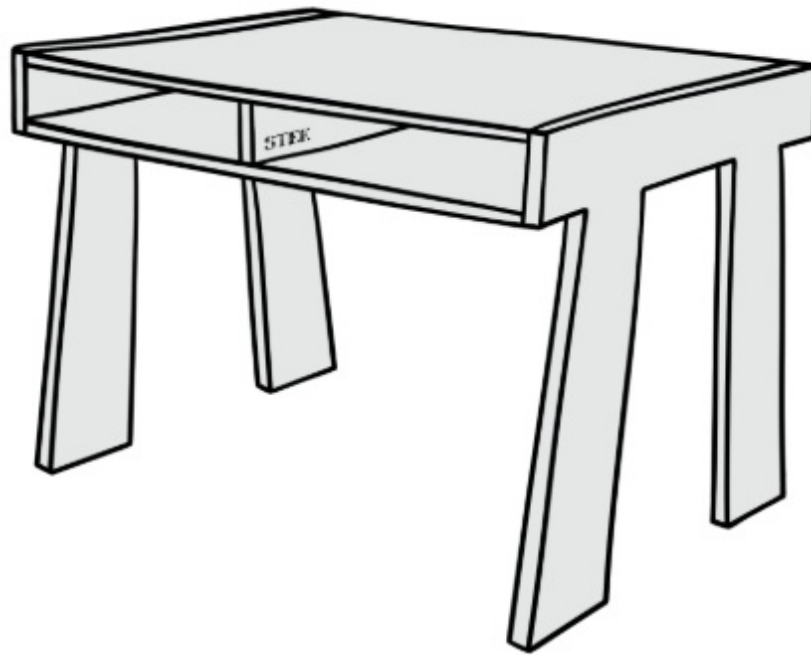

Parts List

Part	Quantity
A	1x
B	6x
C	1x
D	1x
E	1x
F	1x
G	1x
H	1x

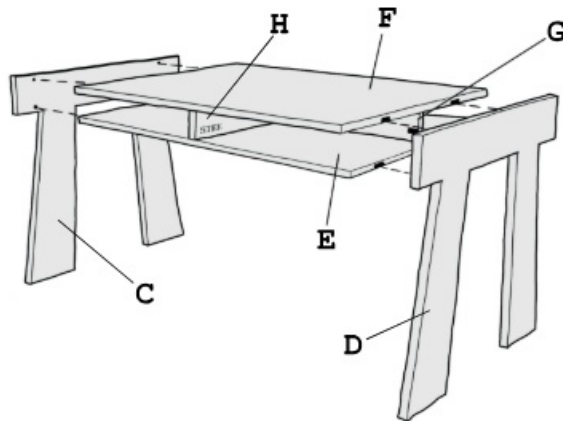
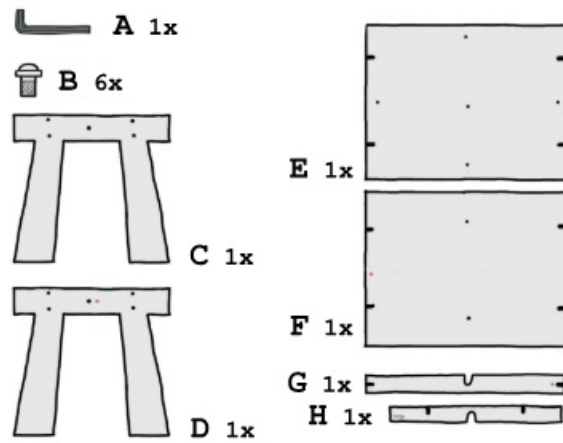

Assembly Instructions

• Step 1

Attach part H to part F using 2 screws (B).

Diagram: Shows part H being attached to part F with 2 screws.

• Step 2

Attach part D to the assembly from step 1.

Diagram: Shows part D being attached to the assembly.

• Step 3

Attach part C to the assembly.

Diagram: Shows part C being attached to the assembly.

• Step 4

Secure the assembly with 4 screws (B).

Diagram: Shows 4 screws being used to secure the assembly.

• Step 5

Attach part G to the assembly.

Diagram: Shows part G being attached to the assembly.

• Step 6

Secure part G with 2 screws (B).

Diagram: Shows 2 screws being used to secure part G.

• Step 7

Attach part E to the assembly.

Diagram: Shows part E being attached to the assembly.

- **Step 8**

Secure part E with 4 screws (B).

Diagram: Shows 4 screws being used to secure part E.

- **Step 9**

Ensure all screws are tightened and the table is stable.

Diagram: Shows the final check of the table stability.

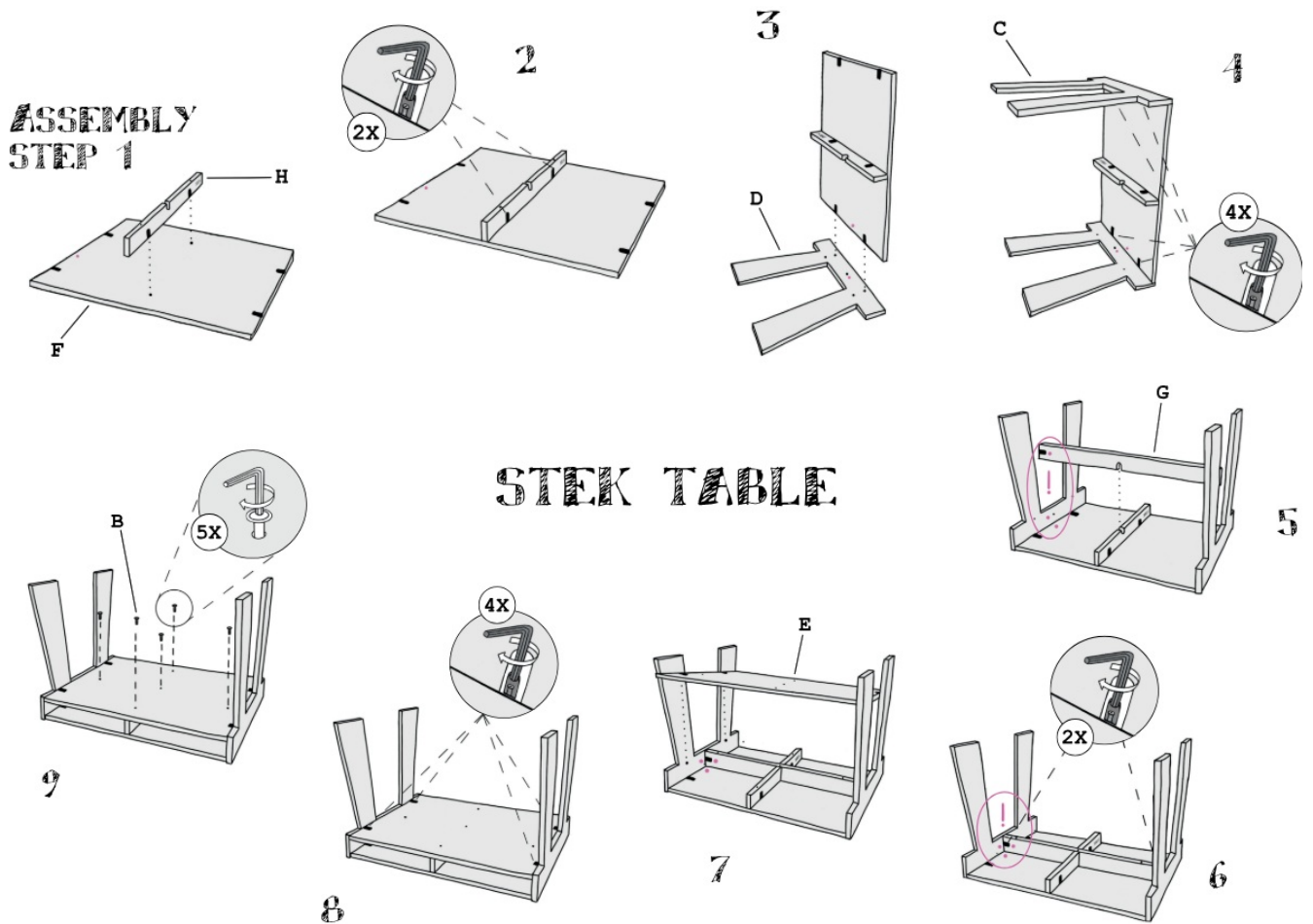

Final Product

Diagram: Shows the completed STEK table.

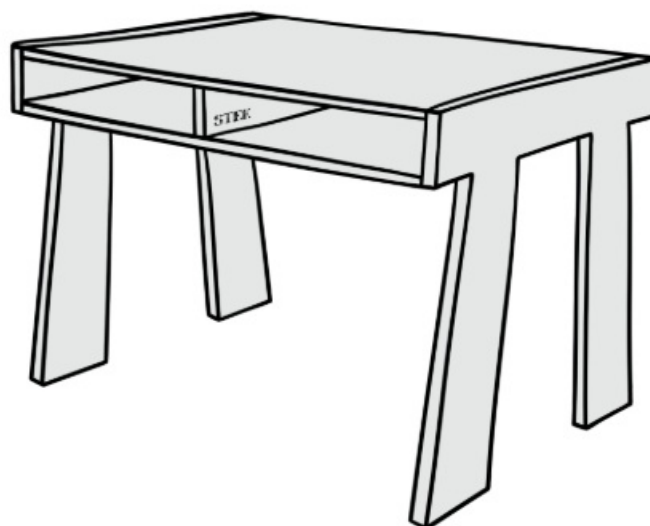

Specifications

Specification	Details
Material	Wood
Dimensions	Height: 75cm, Width: 120cm, Depth: 60cm
Weight	20kg

FAQ

Q: What tools do I need for assembly?

A: You will need a screwdriver for the screws provided.

Q: How long does it take to assemble the table?

A: The assembly process takes approximately 30 minutes.

Q: Can one person assemble the table alone?

A: Yes, the table can be assembled by one person, but having an extra pair of hands can be helpful.

Q: Where can I find more information about STEK products?

A: Visit www.aboutstek.nl for more information.

Enjoy!

Congratulations on assembling your STEK table! We hope you enjoy using it.

Documents / Resources

	ABOUTSTEK Stek Table 13 and 5kg Side Table Made of Travertine [pdf] Installation Guide Stek Table 13 and 5kg Side Table Made of Travertine, Stek Table, 13 and 5kg Side Table Made of Travertine, Side Table Made of Travertine, Table Made of Travertine, Travertine
---	---

References

- [about STEK – aboutstek](#)
- [User Manual](#)

[Manuals+](#), [Privacy Policy](#)

This website is an independent publication and is neither affiliated with nor endorsed by any of the trademark owners. The "Bluetooth®" word mark and logos are registered trademarks owned by Bluetooth SIG, Inc. The "Wi-Fi®" word mark and logos are registered trademarks owned by the Wi-Fi Alliance. Any use of these marks on this website does not imply any affiliation with or endorsement.