



ABKO TOS250 Multi Device Wireless Keyboard User Guide

[Home](#) » [ABKO](#) » ABKO TOS250 Multi Device Wireless Keyboard User Guide 



TOS250 Multi-Device Wireless Keyboard User Guide

Contents

- [1 ABKO TOS250](#)
- [2 Package Content](#)
- [3 LED Indicator](#)
- [4 Backlight Instructions](#)
- [5 Multimedia Keys](#)
- [6 FN Combination Functions](#)
- [7 Connecting iPad / iPhone](#)
- [8 Connecting Mac](#)
- [9 Connecting Samsung / Huawei Tablet](#)
- [10 Warning](#)
- [11 Troubleshooting](#)
- [12 Federal Communications Commission \(FCC\) Statement](#)
- [13 WARRANTY](#)
- [14 What ABKO will not cover](#)
- [15 Documents / Resources](#)
- [16 Related Posts](#)

ABKO TOS250

- Working Range: 10M
- Battery Capacity: 1000mAh
- Working Current (Without Backlight): 1.5mA

- Working Hours (Without Backlight): 667hours
- Working Current With The Brightest Backlight: 200mA
- Working Time With The Brightest Backlight: 5hours
- Charging Time: 2hours
- Standby Time: 2,100hours
- Backlight Sleep Mode: After 2minutes of Not in Use
- Keyboard Sleep Mode: After 30minutes of Not in Use
- FCC ID : 2AWXK-TOS250

Package Content

ABKO TOS250 x 1/ Type-C Charging Cable x 1 / Silicone Pad x 1/ User Manual x 1



* If part of the screen is covered by the mounting slot, use a silicone pad.

LED Indicator

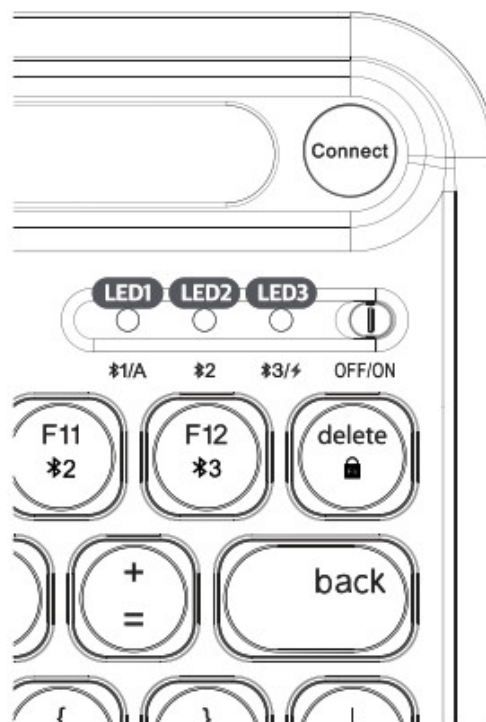

LED1



Indicator

LED2



Indicator

LED3



Indicator



Indicator / Charging, Battery Warning

Battery Warning Sign

LED3 will flash in red slowly and the keyboard backlight will be turned off.

Charging Sign LED3 will light up in red and turn off when charging is completed.

Backlight Instructions

1. Press FN +  to adjust the brightness. It will operate in the following sequence. (Turn on backlight > Level 1 > Level 2 > Level 3 brightness > Turn off backlight)
2. Press FN +  to change the color of the backlight. (Total 7 colors: Blue, Yellow, Purple, Cyan, White, Red, Green)
3. The backlight will automatically turn off when the battery is at 30% and below. Charge the product and wait for 10 minutes for the backlight to be turned on.

Multimedia Keys

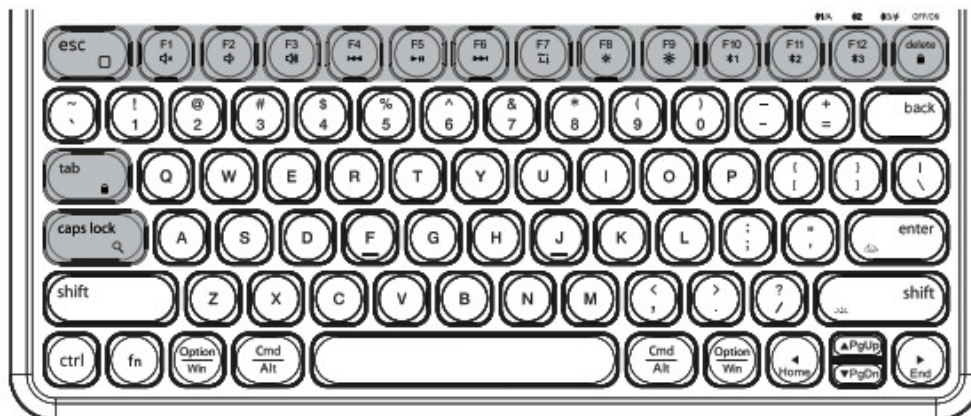

Key	Window	MAC OS	Android, IOS
ESC	Homepage	N/A	Go to Home
F1	Mute	Mute	Mute
F2	Reduce Volume	Reduce Volume	Reduce Volume
F3	Increase Volume	Increase Volume	Increase Volume
F4	Previous Track	Previous Track	Previous Track
F5	Ploy / Pause	Play / Pause	Ploy / Pause
F6	Next Track	Next Track	Next Track
F7	Screen Capture	Screen Capture Wain:* auk in some votscovJ	Screen Capture
F8	Decrease Brightness	Decrease Brightness	Decrease Brightness
F9	Increase Brightness	Increase Brightness	Increase Brightness
F10	Wireless Device 1	Wireless Device 1	Wireless Device 1
AI	Wireless Device 2	Wireless Device 2	Wireless Device 2
F12	Wireless Device 3	Wireless Device 3	Wireless Device 3
DEL	FN +  = 'Function Lock		

Function Lock: The multimedia functions only work when F1-F12 keys are pressed together with the FN key. When activated, F1-F12 keys will work normally.

FN Combination Functions

FN +  = Lock Screen (May not work in some Mac OS versions)

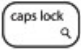
FN +  = Search (May not work in some Mac OS versions)

Connecting iPad / iPhone

1. Switch on the keyboard.
2. Press FN + F10 button and the first indicator will light up in blue for 1 sec.
3. Press CONNECT button for 3 secs then the first indicator will flash in blue at rapid speed and be ready to be paired.
4. Turn on the Wireless Function.

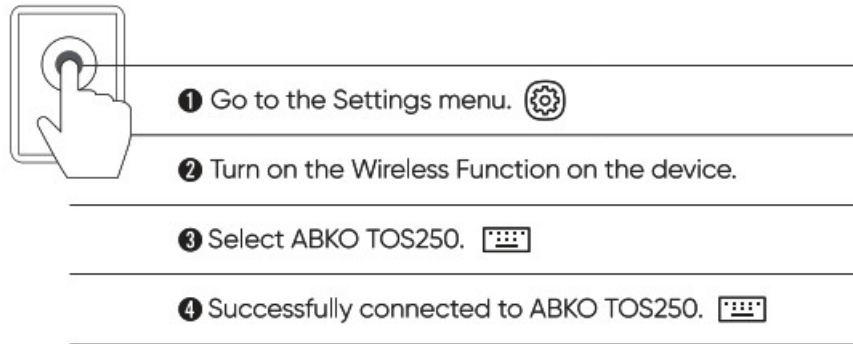

Connecting Mac

1. Switch on the keyboard.
2. Press FN + F10 button and the first indicator will light up in blue for 1 sec.
3. Press CONNECT button for 3 secs then the first indicator will flash in blue at rapid speed and be ready to be paired.
4. Turn on the Wireless Function.

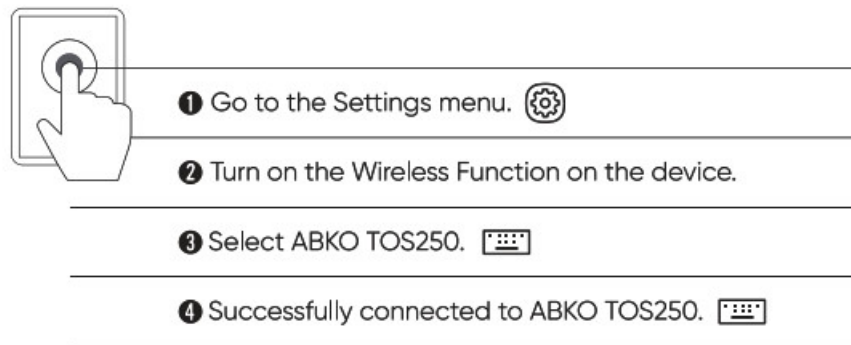

5. It will be connected within seconds.
6. This keyboard supports automatic reconnection. When you turn on the keyboard, It automatically connects to the last device you connected. (Check if the Wireless Function of the device to be connected is turned on)

Connecting Windows PC & Tablet

1. Switch on the keyboard.
2. Press FN + F10 button and the first indicator will light up in blue for 1 sec.
3. Press CONNECT button for 3 secs then the first indicator will flash in blue at rapid speed and be ready to be paired.
4. Turn on the Wireless Function.



- ➊ Go to the START menu.
- ➋ Go to the Setting menu.
- ➌ Go to Devices.
- ➍ Turn on the Wireless Function.
- ➎ Add a device.
- ➏ Select ABKO TOS250.
- ➐ Successfully connected to ABKO TOS250.

5. This keyboard will automatically connect to the PC when it is turned on within the connection range.

Connecting Samsung / Huawei Tablet

1. Switch on the keyboard.
2. Press FN + F10 button and the first indicator will light up in blue for 1 sec.
3. Press CONNECT button for 3 secs then the first indicator will flash in blue in rapid speed and be ready to be paired.
4. Turn on the Wireless Function.



- ➊ Go to the Settings menu.
- ➋ Turn on the Wireless Function on the device.
- ➌ Select ABKO TOS250.
- ➍ Successfully connected to ABKO TOS250.

Switching / Changing Channels

1. Press FN + F11 buttons and the second indicator will light up in blue for 1 sec, press FN+F12 buttons and third indicator will light up in blue for 1 sec.
2. Press CONNECT button and the indicator you have chosen will flash in blue in rapid speed.
3. Set two channels by following the instructions above.
4. Switch the channels by pressing FN+F10 or F11 or F12.



+

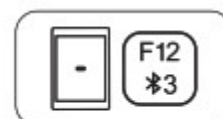

Warning

1. Do not impact the product.
2. Do not get close to strong magnetic fields or forces.
3. Do not use the product in a humid environment.
4. Wipe the product with a dry cloth and turn off the power when not in use.

Troubleshooting

1. Check whether the product is fully charged.
2. Check whether the product is within the connection area. (10M)
3. Check if the Wireless Function of the device to be connected is turned on.
4. Check if the pairing is successful from the device.
5. There may be problems when multiple keyboards are connected to one device.

Federal Communications Commission (FCC) Statement

NOTE: This equipment has been tested and found to comply with the limits for a Class B digital device, pursuant to part 15 of the FCC Rules. These limits are designed to provide reasonable protection against harmful interference in a residential installation. This equipment generates uses and can radiate radio frequency energy and, if not installed and used in accordance with the instructions, may cause harmful interference to radio communications. However, there is no guarantee that interference will not occur in a particular installation. If this equipment does cause harmful interference to radio or television reception, which can be determined by turning the equipment off and on, the user is encouraged to try to correct the interference by one or more of the following measures:

- Reorient or relocate the receiving antenna.
- Increase the separation between the equipment and receiver.
- Connect the equipment into an outlet on a circuit different from that to which the receiver is connected.
- Consult the dealer or an experienced radio/TV technician for help.

Changes or modifications not expressly approved by the party responsible for compliance could void the user's authority to operate the equipment. This device complies with Part 15 of the FCC Rules. Operation is subject to the following two conditions:

- (1) this device may not cause harmful interference, and
- (2) this device must accept any interference received, including interference that may cause undesired operation.

WARRANTY

All warranty service is provided by our factory service center or an authorized customer care technician. If you have any inquiries, please visit our website or email us. Please check the below information. To schedule your service, please have your serial number and your model number available for service.

- Website: abkoglobal.com
- E-mail: cs_support@abko.co.kr

For the period of	ABKO will replace
1 year from the date of the original purchase (* 6 months for motors)	ABKO will replace free of charge the part that proves defective in material and manufacturing workmanship, under normal installation, use, and service.

What ABKO will not cover

- Failure of the product if it is abused, misused, modified, or used for other than the intended purpose or used commercially
- Damage to the product caused by accident, fire, floods, any natural disasters, or acts of God.
- Damage to finish, such as surface rust, tarnish, or small blemishes not reported within 48 hours of delivery
- Incidental or consequential damage caused by improper use or not following the manual.
- Damage caused after delivery
- Product not accessible to provide required service.
- Service to repair or replace lights bulbs, except for LED lamps.

This limited warranty is extended to the original purchaser and any succeeding owner for products purchased for home use in the world. If the product is located in an area where service by an ABKO is not available, you may be responsible for a trip charge or you may be required to bring the product to an authorized ABKO service location for service. Some regions/countries do not allow the exclusion or limitation of incidental or consequential damages. This limited warranty gives you specific legal rights, and you may also have other rights which vary from country to country. To know what your legal rights are, consult your local/region or country consumer affairs office or your Attorney General.

EXCLUSION OF IMPLIED WARRANTIES

Your sole and exclusive remedy is product repair as provided in this Limited Warranty. Any implied warranties, including the implied warranties of merchantability or fitness for a particular purpose, are limited to one year or the shortest period allowed by law.



Documents / Resources

	<p>ABKO TOS250 Multi Device Wireless Keyboard [pdf] User Guide TOS250, 2AWXK-TOS250, 2AWXKTOS250, TOS250, Multi Device Wireless Keyboard</p>
---	--