

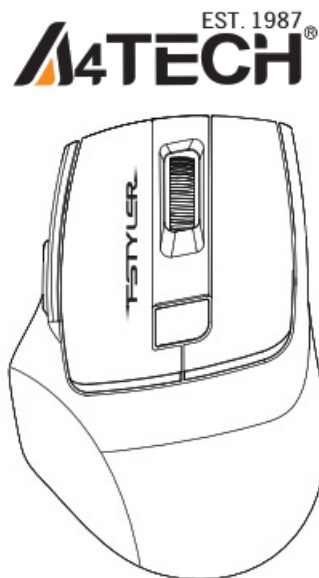

A4TECH FB35C FASTLER Dual Mode Rechargeable Silent Click Wireless Mouse User Guide

[Home](#) » [A4TECH](#) » A4TECH FB35C FASTLER Dual Mode Rechargeable Silent Click Wireless Mouse User Guide



FB35C / FB35CS



Contents

- 1 WHAT'S IN THE BOX
- 2 KNOW YOUR PRODUCT
- 3 INDICATOR
- 4 CHARGING & INDICATOR
- 5 LOW BATTERY INDICATOR
- 6 Q & A
- 7 WARNING STATEMENT
- 8 Documents / Resources
 - 8.1 References
- 9 Related Posts

WHAT'S IN THE BOX

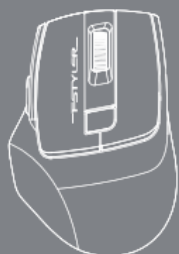

Mouse



Nano USB Receiver



Charging Cable (Type-C)



User Manual

KNOW YOUR PRODUCT

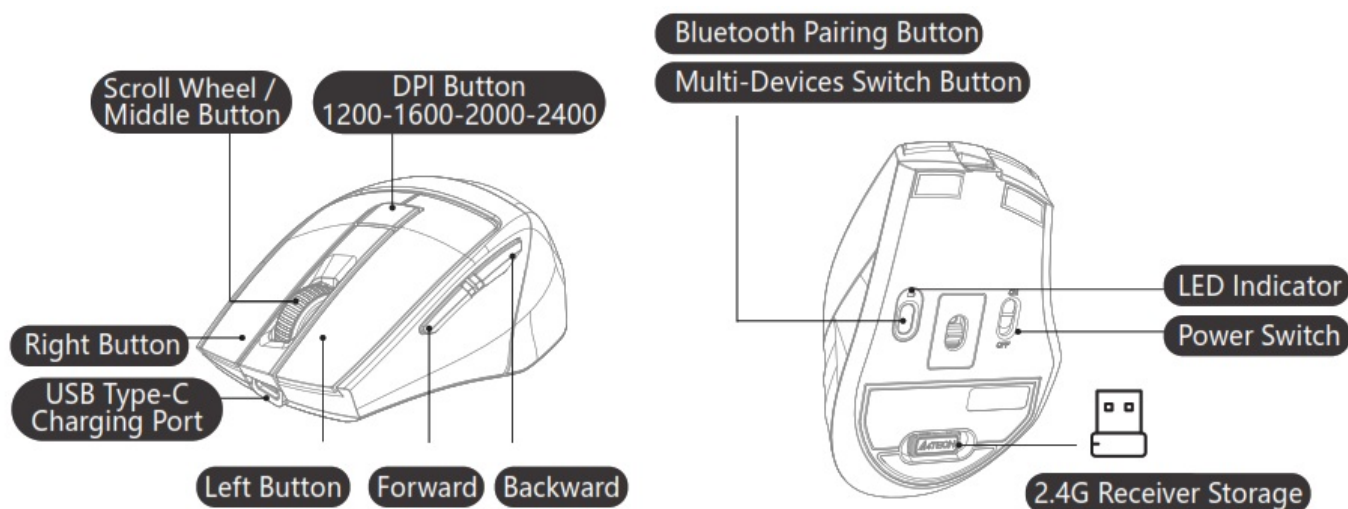

CONNECTING 2.4G DEVICE



1

Plug the receiver into the computer's USB port.



2

Turn the mouse power switch to on.



3

Indicator:

Red and blue light will flash (10S). The light will be off after connected.

CONNECTING BLUETOOTH DEVICE 1 (For Mobile Phone/Tablet/Laptop)



Blue Light



BLUETOOTH DEVICE

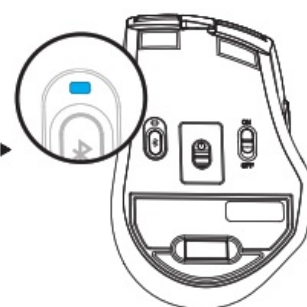
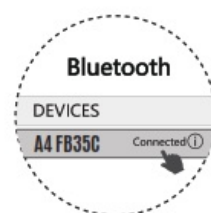

1. Short-press the Bluetooth button and choose Device 1 (Indicator shows blue light for 5 S).

2. Long-press the Bluetooth button for 3S and blue light flashes slowly when pairing.

3. Turn on the Bluetooth and locate the BT 4 FB35C

CONNECTING BLUETOOTH DEVICE 2 (For Mobile Phone/Tablet/Laptop)



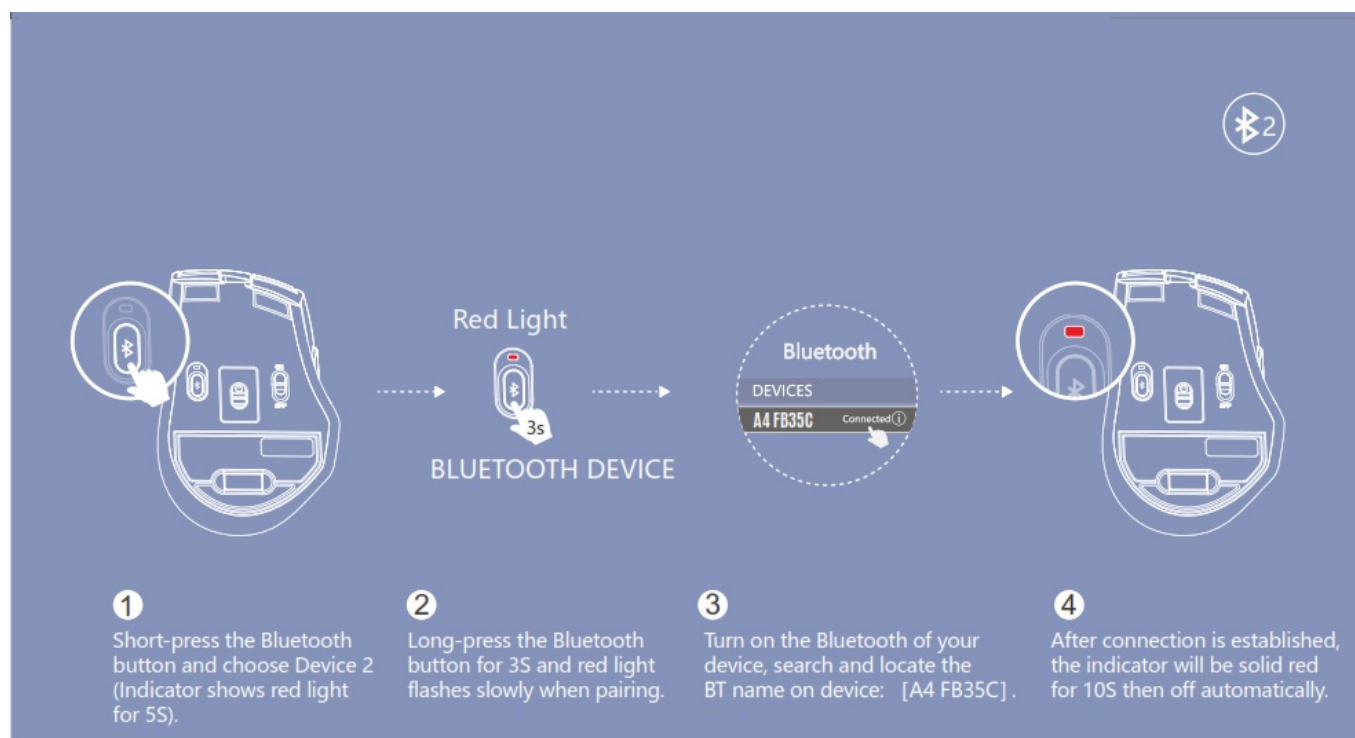

INDICATOR

MOUSE	2.4G DEVICE	BLUETOOTH DEVICE 1	BL

Indicator	Red and Blue Light	Blue Light	Red Light
@SvAtch Device: Short-Press 15	Flashes Quickly 105	Solid Light SS	Solid Light SS
OPair Device: Long-Press For 35	No Need to Pair	Pairing: Flashes Slowly Connected: Solid Light 105	Pairing: Flashes Slowly Connected: Solid Light 105

The above indicator status is before Bluetooth is paired. After the Bluetooth connection succeeds, the light will turn off after 10S.

CHARGING & INDICATOR

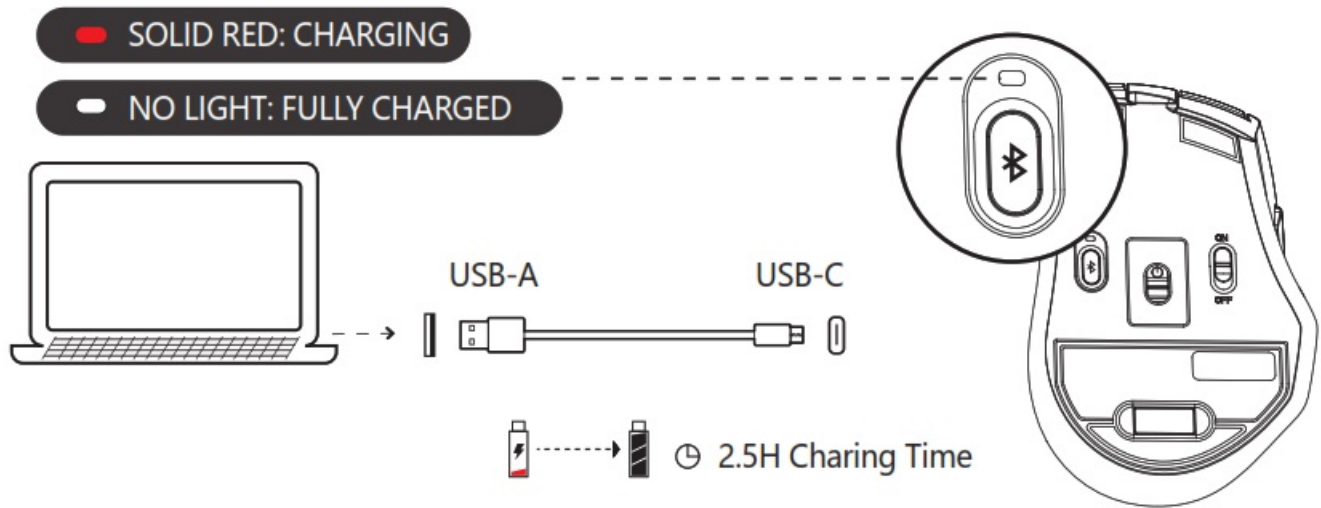

LOW BATTERY INDICATOR

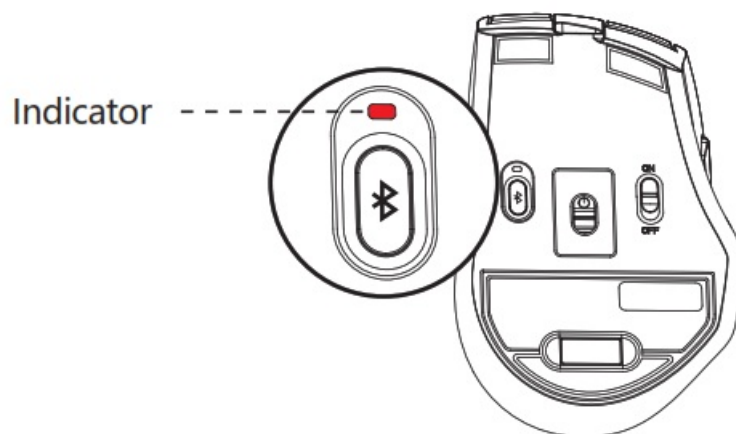

The flashing Red light indicates when the battery is below 25%.

Q & A





Question	How many total devices can be connected at a time?
Answer	Interchange and connect up to 3 devices at the same time. 2 Devices with Bluetooth +1 Device with 2.4G Hz.
Question	Does the mouse remember connected devices after power off?
Answer	The mouse will automatically remember and connect the last device. You may switch the devices as you choose to.
Question	How do I know what device is currently connected to?
Answer	When the power is turned on, the indicator light will be displayed for 10S.
Question	How to switch connected Bluetooth devices?
Answer	Repeat the procedure of connecting Bluetooth devices.



WARNING STATEMENT

The following actions may/will cause damages to the product.

1. To disassemble, bump, crush, or throw into the fire, you may cause irrefutable damage in event of the lithium battery leakage.
2. Do not expose to strong sunlight.
3. Please obey all local laws when discarding the batteries, if possible please recycle them. Do not dispose of it as household garbage, it may cause a fire or an explosion.
4. Please try to avoid charging in an environment below 0°C.
5. Do not remove or replace the battery.

	
 www.a4tech.com	 http://www.a4tech.com

Documents / Resources

	A4TECH FB35C FASTLER Dual Mode Rechargeable Silent Click Wireless Mouse [pdf] User Guide FB35C, FB35CS, FASTLER Rechargeable Wireless Mouse
-------------------------------------------------------------------------------------	-------------------------------------------------------------------------------------------------------------------------------------------------------------------

References

-  [A4TECH Official Website](#)