



## A4TECH FB10CS Dual Mode Rechargeable Bluetooth Wireless Mouse User Guide

[Home](#) » [A4TECH](#) » A4TECH FB10CS Dual Mode Rechargeable Bluetooth Wireless Mouse User Guide 



QUICK START GUIDE  
FB10C / FB10CS



## Contents

- 1 WHAT'S IN THE BOX
- 2 KNOW YOUR PRODUCT
- 3 CONNECTING 2.4G DEVICE
- 4 INDICATOR
- 5 CHARGING & INDICATOR
- 6 LOW BATTERY INDICATOR
- 7 Q & A
- 8 WARNING STATEMENT
- 9 Documents / Resources
  - 9.1 References
- 10 Related Posts

## WHAT'S IN THE BOX

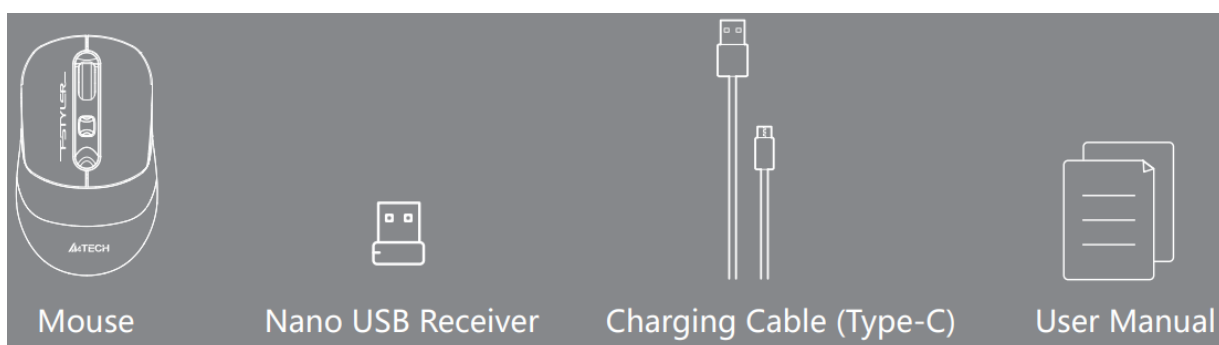

## KNOW YOUR PRODUCT

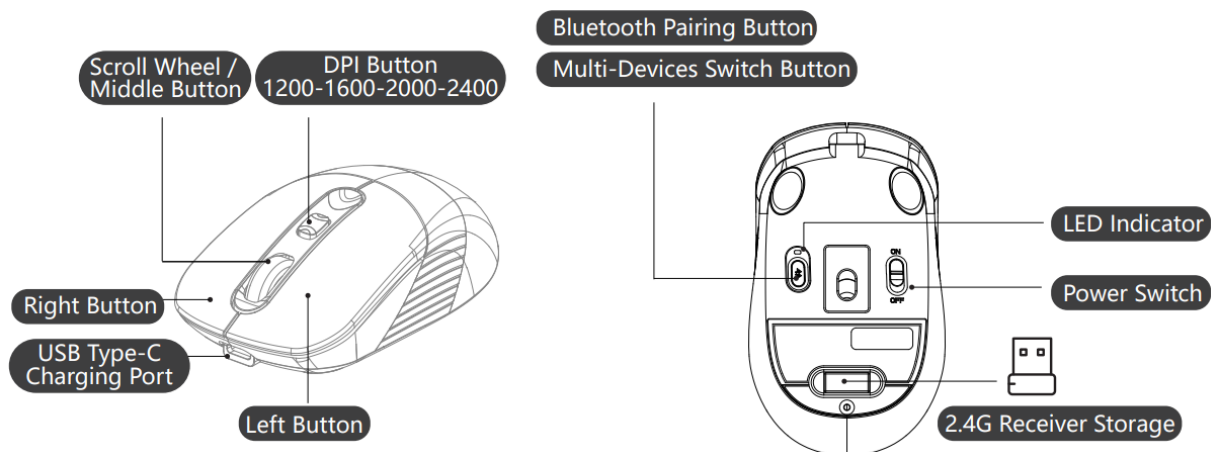

## CONNECTING 2.4G DEVICE

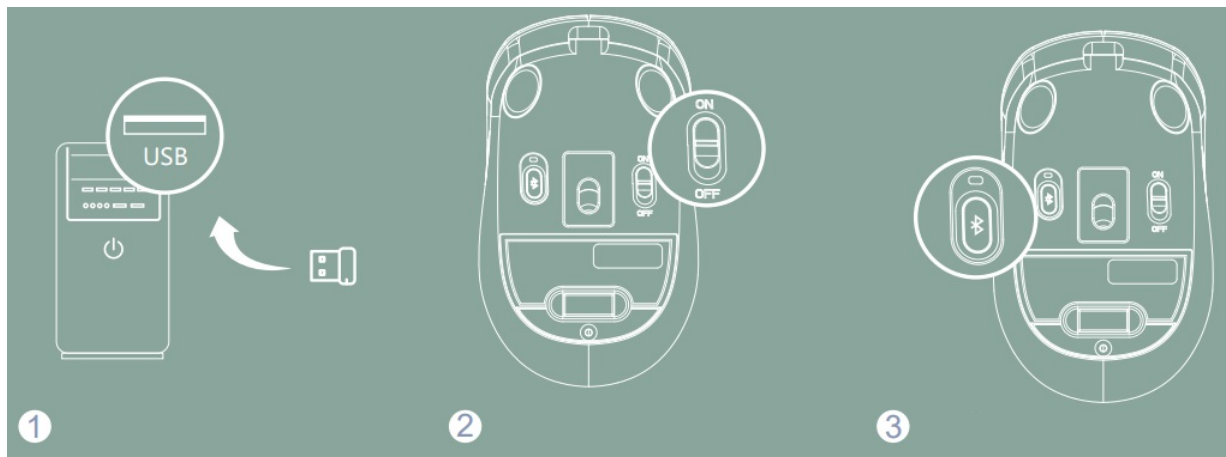

1. Plug the receiver into the computer's USB port.
  2. Turn the mouse power switch on.
  3. Indicator
- The red and blue light will flash (10S). The light will be off after connecting.

### CONNECTING BLUETOOTH DEVICE 1

(For Mobile Phone/Tablet/Laptop)

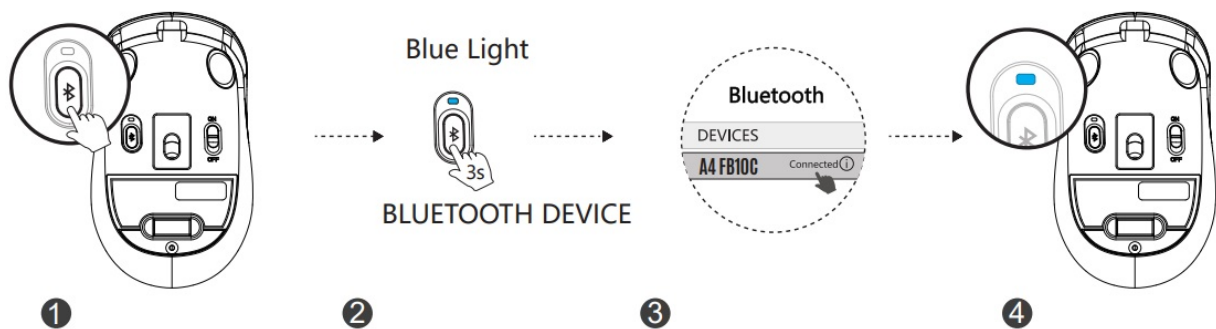

1. Short-press the Bluetooth button and choose Device 1 (Indicator shows blue light for 5S).
2. Long-press the Bluetooth button for 3S and blue light flashes slowly when pairing.
3. Turn on the Bluetooth of your device, search and locate the BT name on the device: A4 FB10C .
4. After the connection is established, the indicator will be solid blue for 10S then off automatically.

### CONNECTING BLUETOOTH 2

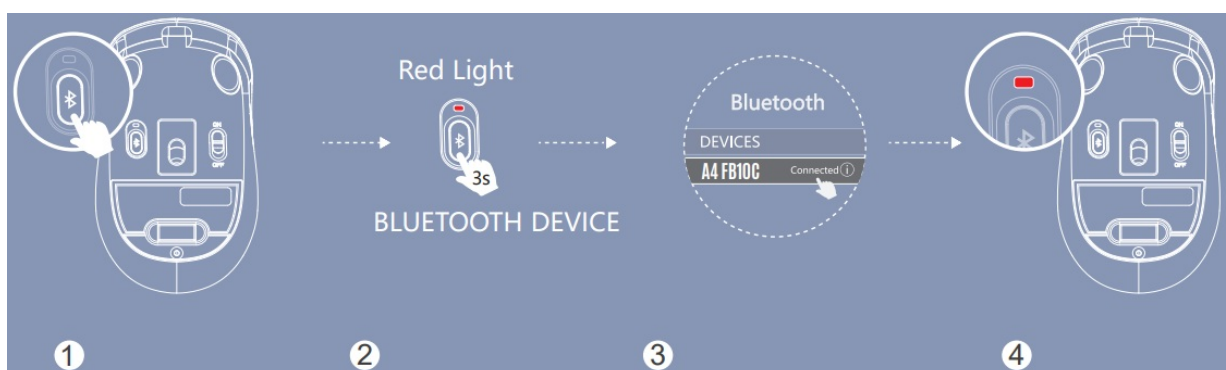

(For Mobile Phone/Tablet/Laptop)





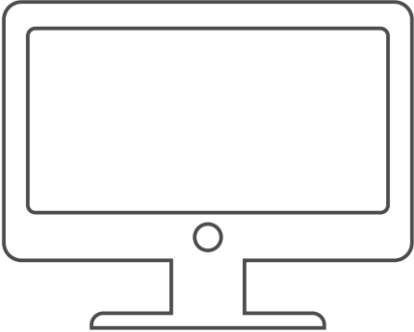

1. Short-press the Bluetooth button and choose Device 2 (Indicator shows red light for 5S).

2. Long-press the Bluetooth button for 3S and the red light flashes slowly when pairing.
3. Turn on the Bluetooth of your device, search and locate the BT name on the device: A4 FB10C .
4. After the connection is established, the indicator will be solid red for 10S then off automatically.

### INDICATOR

		
MOUSE	2.4G DEVICE	BLUETOOTH DEVICE 1

 Indicator	 Red and Blue Light	 B
 Switch Device Short-Press 1S	Flashes Quickly 10S	Solid Light 5S
 Pair Device Long-Press For 3S	No Need to Pair	Pairing Flashes Slow Connected Solid Lig

The above indicator status is before Bluetooth is paired. After the Bluetooth connection succeeds, the light will turn off after 10S.

### CHARGING & INDICATOR

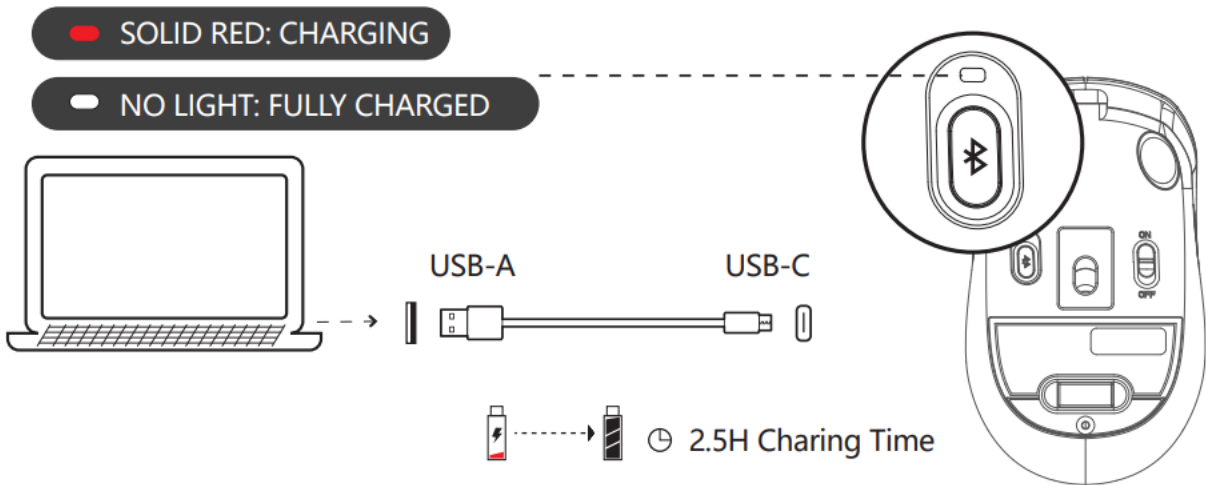

### LOW BATTERY INDICATOR

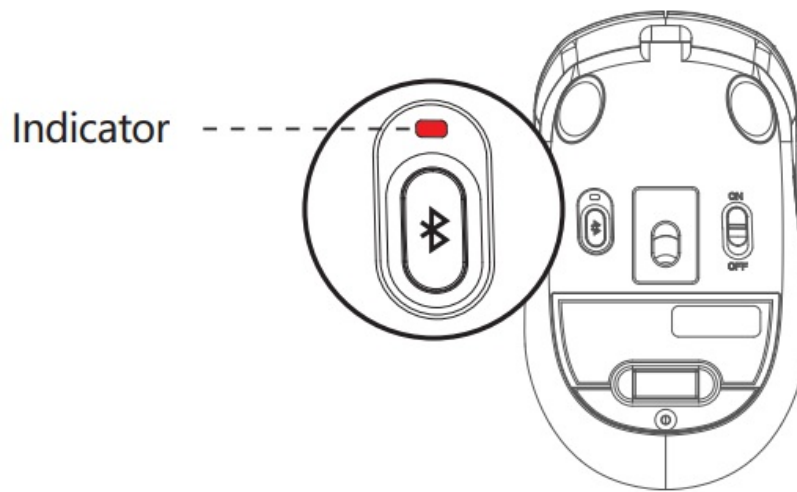

The flashing Red light indicates when the battery is below 25%.

## Q & A

**Question: How many total devices can be connected at a time?**

**Answer:** Interchange and connect up to 3 devices at the same time. 2 Devices with Bluetooth +1 Device with 2.4G Hz.

**Question: Does the mouse remember connected devices after power off?**

**Answer:** The mouse will automatically remember and connect the last device. You may switch the devices as you choose to.

**Question: How do I know what device is currently connected to?**

**Answer:** When the power is turned on, the indicator light will be displayed for 10S.

**Question: How to switch connected Bluetooth devices?**

**Answer:** Repeat the procedure of connecting Bluetooth devices.

## WARNING STATEMENT

The following actions may/will cause damages to the product.

1. To disassemble, bump, crush, or throw into the fire, you may cause irrefutable damage in event of the lithium battery leakage.
2. Do not expose to strong sunlight.
3. Please obey all local laws when discarding the batteries, if possible please recycle them.  
Do not dispose of it as household garbage, it may cause a fire or an explosion.
4. Please try to avoid charging in an environment below 0°C.
5. Do not remove or replace the battery.



<http://www.a4tech.com>

## Documents / Resources



[A4TECH FB10CS Dual Mode Rechargeable Bluetooth Wireless Mouse](#) [pdf] User Guide  
FB10CS, FB10C, Rechargeable Bluetooth Wireless Mouse

## References

- [A4 A4TECH Official Website](#)