



# A D AD-8127 Multi Functional Compact Printer for Balances or Scales Instruction Manual

[Home](#) » [A D](#) » A D AD-8127 Multi Functional Compact Printer for Balances or Scales Instruction Manual 

## Contents

- [1 A D AD-8127 Multi-Functional Compact Printer for Balances or Scales](#)
- [2 Installing the printer and printer suppo](#)
- [3 Packing Content](#)
- [4 Documents / Resources](#)
- [5 Related Posts](#)



**A D AD-8127 Multi-Functional Compact Printer for Balances or Scales**



The printer support is used to install the AD-8127 to GX-L/GF-L series and GP series balances made by A&D Company, Limited.

- **Applicable products:** GX-L/GF-L series, GP series

## **Installing the printer and printer suppo**

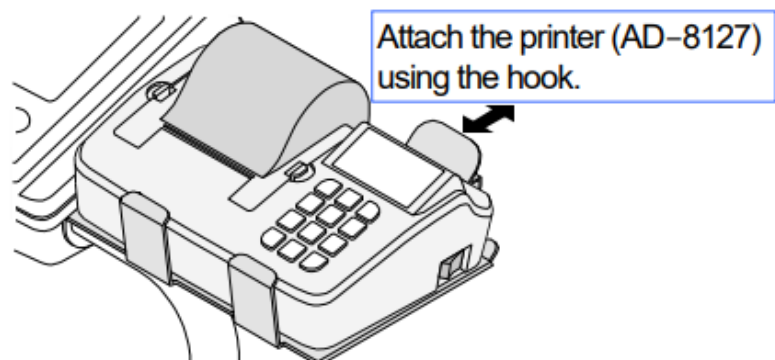
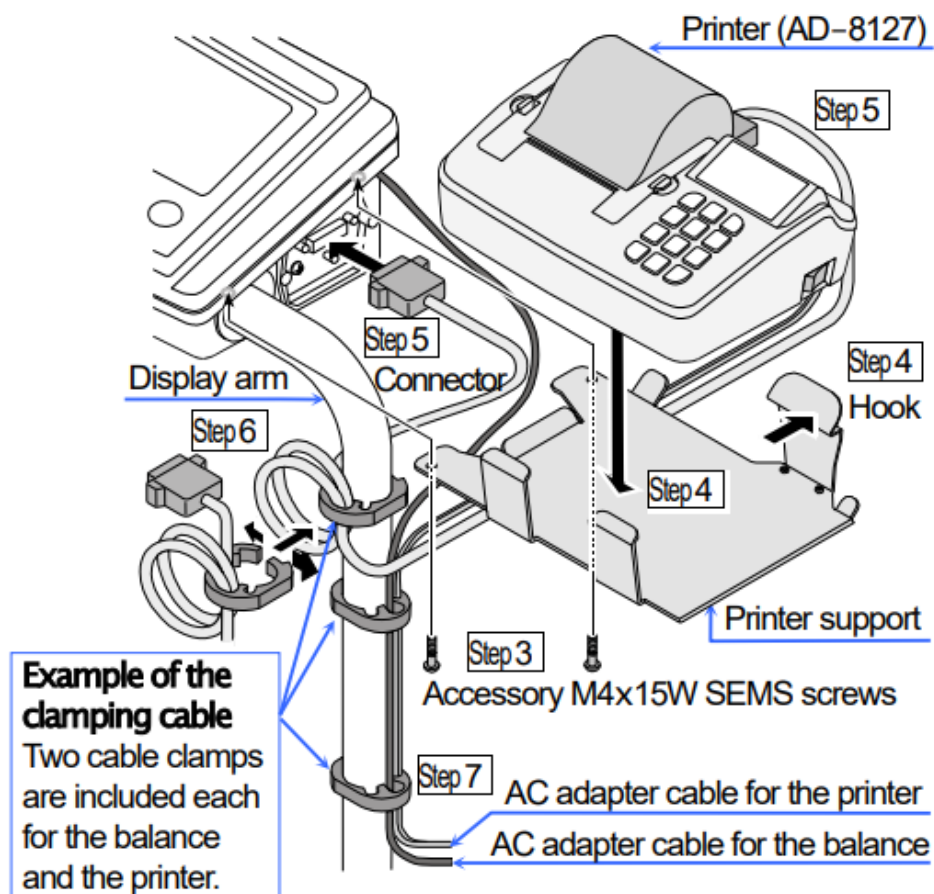
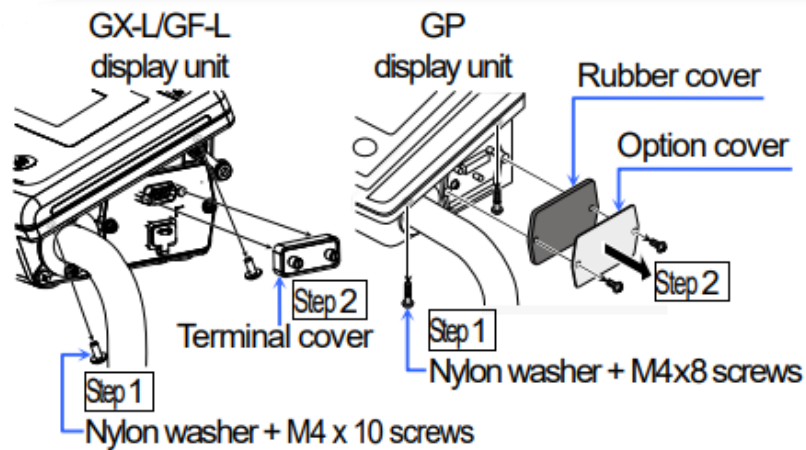

- Step 1** Remove two screws on the right side of the display case.
- Step 2** GX-L/GF-L series Remove the terminal cover for the RS-232C interface (D-Sub 9 pin). GP series Remove the option cover and the rubber cover.

3. **Step 3** Install the printer support besides the display unit using screws (M4x15W SEMS screws).
4. **Step 4** Place the printer (AD-8127) on the printer support while holding open the hook.
5. **Step5** GX-L/GF-L series Connect the RS-232C cable (AX-KO2741-100). Connect its RS-232C connector to the display unit and to the printer. GP series Connect the RS-232C cable (AX-KO2116-090). Connect its 25-pin connector to the display unit and its 9-pin connector to the printer.
6. **Step 6** Adjust the length of the remaining cable. Bundle up cables using cable clamps beside the display arm.
7. **Step7** AttachAC adaptor cables to the balance and printer, and bundle them using cable clamps.

### Caution

If the RS-232C interface terminal cover is removed from GX-L/GF-Lseries, or if the options cover and rubber cover are removed from GPseries, the balance and printer will not be waterproof and dustproof.

## Packing Content

Component parts	Quantity
GP-16 Printer support for the AD-8127	1
Cable clamp	2
M4 x 15W SEMS screws	2
Instruction manual (This document)	1

## Documents / Resources

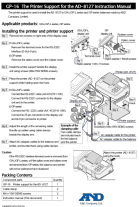
	<p><a href="#">A D AD-8127 Multi Functional Compact Printer for Balances or Scales</a> [pdf] Instruction Manual</p> <p>AD-8127, Multi Functional Compact Printer for Balances or Scales, AD-8127 Multi Functional Compact Printer for Balances or Scales, AD-8127 Multi Functional Compact Printer, Multi Functional Compact Printer, Compact Printer, Printer</p>
---	--