



XR MI4 Pinpointer User Manual

[Home](#) » [XR](#) » XR MI4 Pinpointer User Manual 



MI-4, MI-6 USER MANUAL

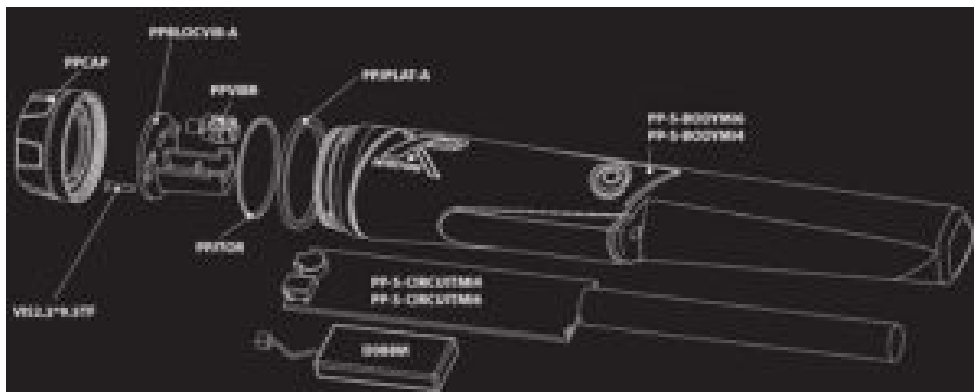

Contents

- [1 MI-4/MI-6 Basic features:](#)
- [2 MI-6 + DEUSE features:](#)
- [3 Pairing the MI-6 with the DEUS](#)
- [:](#)
- [4 Declaration of conformity EU](#)
- [5 Documents / Resources](#)
- [6 Related Posts](#)

MI-4/MI-6 Basic features:

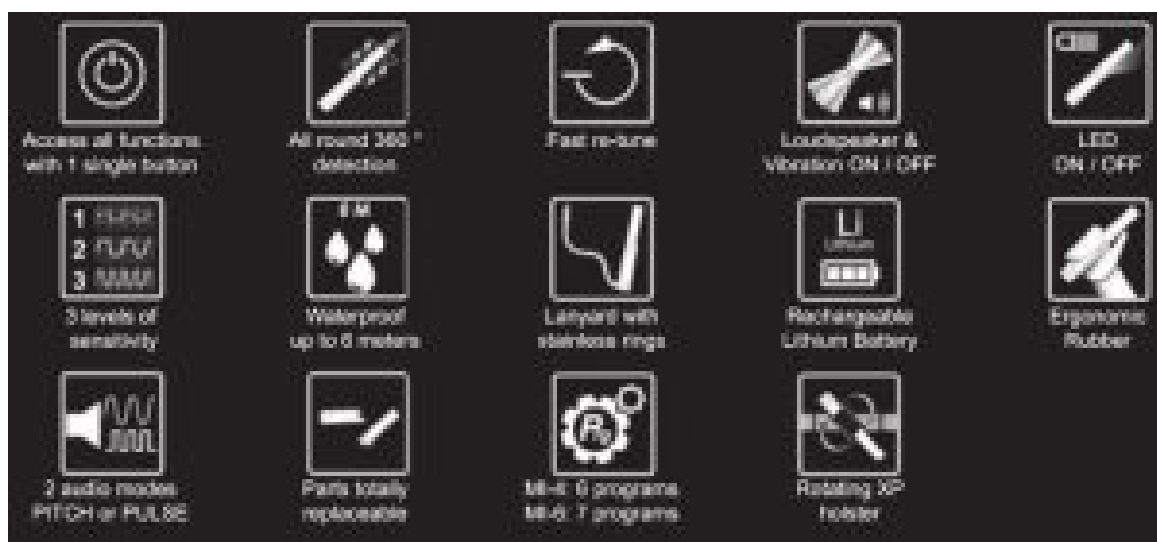

MI-6 + DEUSE features:

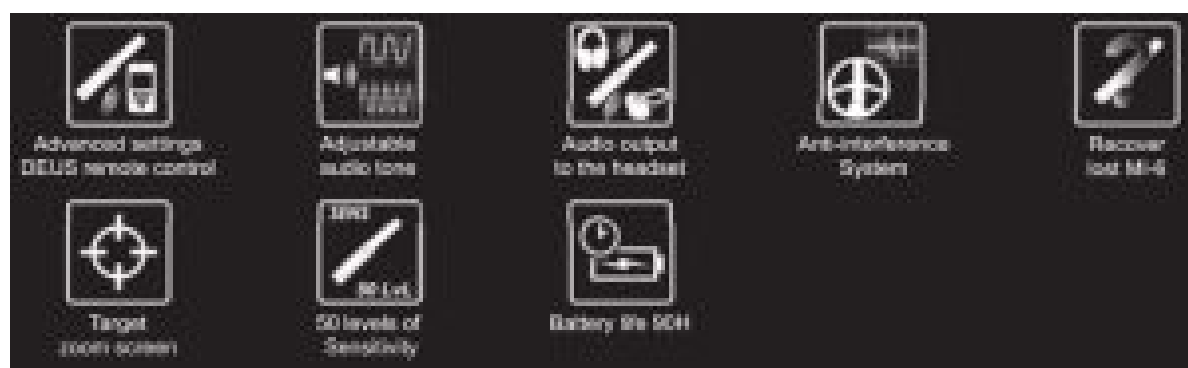

Introduction: Congratulations on the purchase of your new MI-4 / MI-6 Pinpointer, made in France by XP Metal Detectors. Note: The MI-4 and MI-6 can operate alone with its 6 user programs. 3 levels of sensitivity and selectable audio modes. Furthermore, the MI-6 offers an additional advantage of being able to connect via radio link to the DEUS by selecting program Ni. For more information please refer to the Deus V4 manual available from our web site www.xpmetaldetectors.com

Switch on: Press the button while remaining away from any metal source until the end of the melody, now the Pinpointer is calibrated and ready to detect.

Switch off: Press the button for a minimum of 0.5s and then release. – Once off, the LED flashes briefly every 4 seconds.

Note: Auto-switch off is activated after 5 min without any keypress.

Retune: When operating, you can re-calibrate the Pinpointer by briefly pressing the button while away from any metallic source. On mineralized ground and saltwater, it is advised to re-calibrate while in contact with the ground. To obtain a precise target location, re-calibrate near to the object, the detection zone will now be reduced.

Programs: When the Pinpointer is switched on for the first time, it will start in program N°2. When it is switched on again, it will start on the last program used. To change a program: With the Pinpointer on, press the button for 5 seconds, a short melody will indicate that you have entered the program selection mode, press again for the desired program number. (e.g : press 6 times for program 6). After 2 seconds a melody indicates the MI-6 has returned to search mode.

Programs	1	2	1	4	5	6	7 (DEUS – MI-6)
Vibrate	ON	ON	ON	ON	ON	ON	OFF
Buzzer	ON	ON	ON	OFF	OFF	OFF	OFF
Sensitivity	LOW	MEDIUM	HIGH	LOW	MEDIUM	HIGH	ADJUSTABLE VIA DEUS



Prog 7 is intended for use with the DEUS only. It will not generate any sound or vibration. It is necessary to pair the MI-6 with your DEUS



For precise target location a lower sensitivity level is recommended prog 1 or 2. – Prog 3 uses a higher sensitivity level and is intended for cache searching in walls, furniture, or in mineralized soils.

Pairing the MI-6 with the DEUS :

1. From the remote control menu select: OPTION > PINPOINTER > PAIRING. (To pair the MI.6 to the WS4 or WS5 wireless headphones, please refer to the Deus a user's manual.)
2. Switch on while holding down the MI-6 button for 8 seconds, this will enable pairing.
3. The MI-6 automatically selects program 7 and works with the DEUS. If you want to use the MI-6 without the DEUS radio link connection, select programs 1 to 6 on the MI-6 button menu.

MI-6 specifications and advantages when paired with the DEUS: Audio signal transmitted to the DEUS (XP patent) / An-ti-interference system (XP patent): The DEUS is automatically switched OFF when the MI-6 is in use and then wakes up when the MI-6 is turned OFF – When the Pinpointer is switched ON a dedicated Deus menu is activated allowing further adjustments: / 50 levels of sensitivity / Sound mode selection – Pitch or Pulse / Audio Tone adjustment. Other Deus features include a Target zoom screen / MI- 6 on-screen Battery level display / Long battery life of up to 90 hours / Remote recovery mode (even when the lost MI-6 is switched OFF)

Advanced Mode MI-4 / MI-6: Switch on while keeping the button depressed for 3 seconds until you hear the melody, release the button and:

Press once

Audio PITCH or PULSE

Audio PITCH: The sound varies in tone and intensity. it offers a more precise target location.

Audio PULSE: Higher sound. for noisy environments. Tar-get location is not as precise as PITCH mode. PULSE has the same performance as PITCH mode.

Press twice

LED ON or OFF

Increase the battery life by deactivating the LED on all programs. When the LED is switched off, the start-up flashes will remain.

Press 3 times

VIBRATION ON or OFF

The first 3 programs have vibration on: You can increase the battery life by 50% by deactivating the vibration for programs 1, 2 and 3, so that only the audio remains.

Battery: Unscrew the cap, connect the supplied cable to the Pinpointer. Use a power supply with a USB output (eg DEUS, PC, smartphones ...).

Charge time ± 3 hours – During charging the LED will flash 3 times – End of charging the LED 4 sec ON, 4 sec OFF (cycle) Every time the MI-4 and the MI-6 are switched on they will indicate the battery level by a series of LED flashes.



Battery life: To obtain the longest battery life (90 hours) use the MI-6 with the DEUS (prog 7) and the LED / OFF in the advanced menu.

	VIBRATE	AUDIO	AUDIO + VIBRATE	LED + VIBRATE	LED + AUDIO + VIBRATE	PROGRAMMI-6)
Battery life	30h	30h	20h	11h	10h	90h

Note: Do not leave your Pinpointer fully discharged for several months. With correct care, your battery will last more than 5 years.

Technical features:

– Radio Freq: 2.4 GHz I P: 0.56mW – Detecting frequency : 12 kHz – Sensitivity: 3 levels + Retune – Led / Vibration / Audio: ON 1 OFF – Search for lost pinpointer (MI-6) -Audio mode: PULSE or PITCH – Holster I Lanyard I Charging Cable – Waterproof: 6 meters – L: 24 cm , D: 3.8cm , Weight: 170 gr – Lithium Polymer Battery – T ° of use: – 5°C to +40°C – T ° permitted while charging: 0°C to +35°C – Patents: Pending

2 year limited warranty, parts and labour:

The warranty does not cover it. Damage caused by accidental breakage, fall, or shock / The manipulation of the electronic circuit by an unauthorized person / Circuitry corrosion due to negligence, such as bad maintenance and – or replacement of used seals... I Reduced battery life / Breaking of the lanyard cable and clips / Wear of the Holster, the case, and its rubber grip. In the event of a breakdown contact your dealer. If the device is returned, it must be accompanied by the original invoice and an explanatory note. In the event that the product has been replaced, the warranty will continue to apply as if it were the original.

Precaution (Battery & Charger)

- Recharge only with a SELV power source, limited power source.
- Permissible ambient temperature while charging 0°C to + 35 °C. Recommended storage temperature: 25 ° C
- The batteries are protected against overloads and deep discharges. Do not intervene or short-circuit the batteries, this will destroy the protection circuits or cause smoke and fire.
- Do not leave batteries charged unnecessarily and as a precaution unplug the power after a charge cycle.
- If you notice a perforation, odor or something abnormal drop it into a specific collection point. Do not attempt to recharge the battery, as this may result in overheating or fire.
- Do not throw the lithium battery into the garbage, put it in a suitable collection point.
- Do not place the batteries near heat sources and do not throw them into a fire.
- Do not pierce the battery casing or attempt to solder the battery. MADE IN FRANCE
- There is a risk of explosion or fire if the battery is replaced by an incorrect battery.
- Only use LiPo batteries from XP (ref: D068). FCC ID : XFJA01 IC: 8392A – A01
- The recommended temperature range is -5°C to +40°C. MODEL: M 161
- If you notice abnormal overheating, disconnect the power supply and do not attempt to recharge. U.S. Patent No. D796,971
- Do not carry a faulty or doubtful battery by air.

Declaration of conformity EU

This declaration is established under the responsibility of the manufacturer. XPLOER SARL – 8 rue du Développement – F-31320 CASTANET-TOLOSAN . We, XPLOER, certify that this detector complies with the essential requirements of the European Directives: RED 2014/53/EU, SECURITY 2014/35/EU, EMC 2014/30/EU, which aims to approximate the laws of the Member States concerning the use of radio spectrum, electrical radio compatibility, and electrical safety. The conformity assessment of the device was carried out in accordance with the essential requirements of this Directive and the harmonized standards:

SECURITY (Article 3.1.a): EN60950-1: 2001 +A11, EN50368: 2003 and EN50371: 2002 • EMC (art 3.1.b): EN3014893: V1.4.1, EN61326-1: 1997 +A1 +A2 + A3, EN55011: 2007 • RADIO SPECTRUM (Art 3.2): EN300440-1: V1.3.1, EN300440-2: V1.1.2 • OTHER: EN300331.1: V1.5.1 on September 10, 2009 • A copy of the certificate may be provided upon request from: XPLOER SARL – 8 rue du Développement – F-31320 CASTANET-TOLOSAN



THIS DEVICE COMPLIES WITH PART 15 OF THE FCC RULES. OPERATION IS SUBJECT TO THE FOLLOWING TWO CONDITIONS: (1) THIS DEVICE MAY NOT CAUSE HARMFUL INTERFERENCE. (2) THIS DEVICE MUST ACCEPT ANY INTERFERENCE RECEIVED, INCLUDING INTERFERENCE THAT MAY CAUSE UNDESIRABLE OPERATION. XPLOER IS NOT RESPONSIBLE FOR ANY CHANGES OR MODIFICATIONS NOT EXPRESSLY APPROVED BY THE PARTY RESPONSIBLE FOR COMPLIANCE. SUCH MODIFICATIONS COULD VOID THE USER'S AUTHORITY TO

OPERATE THE EQUIPMENT.



This device complies with Industry Canada licence-exempt RSS standard(s). Operation is subject to the following two conditions: (1) This device may not cause interference, and (2) This device must accept any interference, including interference that may cause undesired operation of the device.



This symbol on the product or its packaging means that this product should not be disposed of with your household waste. You must bring it to a collection point provided for the recycling of electrical and electronic waste. This selective sorting and associated recycling make it possible to preserve natural resources and to avoid potential risks to human health and the environment, which could result from inappropriate disposal due to the presence of dangerous substances in the equipment Electrical and electronic. For more information on where to store your

electrical waste, please contact the store where you purchased this product or return it to your supplier.

Xplorer reserves the right to change the specification or specifications of its detectors without prior notice. This document contains information that is protected by copyright, trademark, and copyright laws. No part of this document may be reproduced, logos or trademarks.

©2018 Xplorer is sarl.

MADE IN FRANCE

FCC ID : XFJA01 IC: 8392A – A01

MODEL : MI61

U.S. Patent No. 0796.971

www.xpmetaldetectors.com

Documents / Resources



[XR MI4 Pinpointer](#) [pdf] User Manual
MI4, Pinpointer