



RF Elite Receiver User Guide

[Home](#) » [RF](#) » RF Elite Receiver User Guide 

Contents

- [1 RF Elite Receiver](#)
- [2 PART NO](#)
- [3 Changing Mode of Operation – EXAMPLE](#)
- [4 Safety Information](#)
- [5 Battery Precautions](#)
- [6 Electrical Safety](#)
- [7 Setting Timed Outputs—EXAMPLE](#)
- [8 Wiring Example](#)
- [9 Documents / Resources](#)
 - [9.1 References](#)
- [10 Related Posts](#)



RF Elite Receiver



Hereby, RF Solutions Limited declares that the radio equipment type defined within this document is in compliance with Directive 2014/53/EU. The full text of the EU declaration of conformity is available at the following internet address: www.rfsolutions.co.uk

PART NO

ELITEFOB-8S4
TRAPELITE-8S4
TAURUSELITE-8S4
SCORPIONELITE-8S4
ELITE-8R4

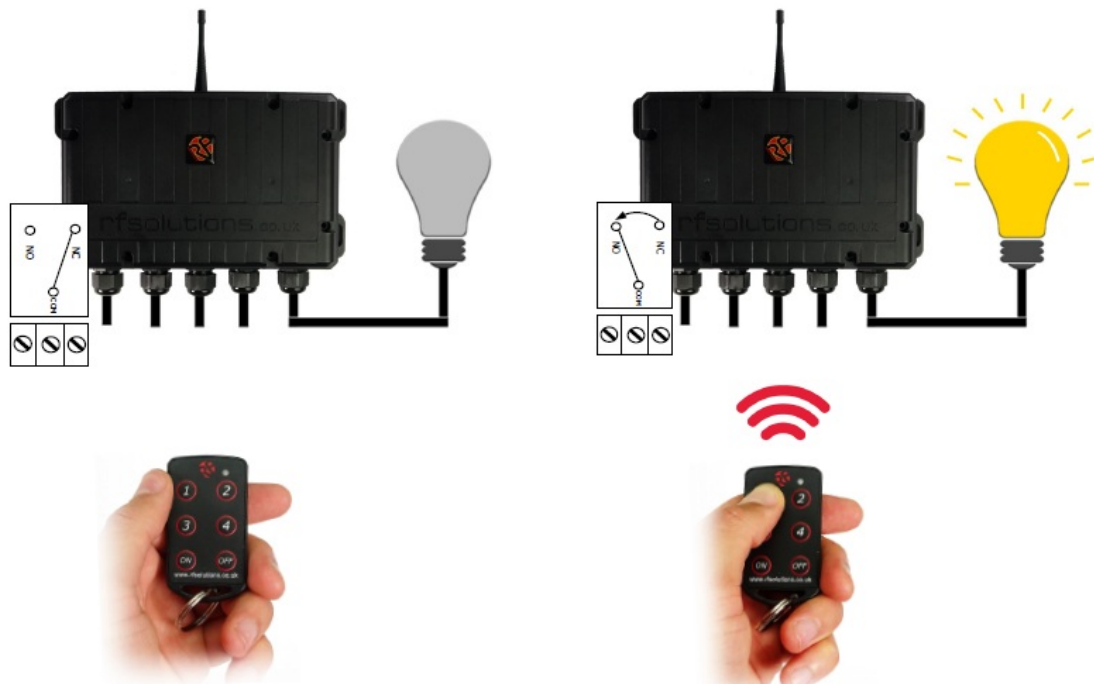

Changing Mode of Operation – EXAMPLE

Modification du mode de fonctionnement – EXEMPLE

Bedrijfsmodus wijzigen – VOORBEELD

Betriebsmodus ändern – BEISPIEL

Cambio de modo de funcionamiento – EJEMPLO

Modifica della modalità di funzionamento – ESEMPIO



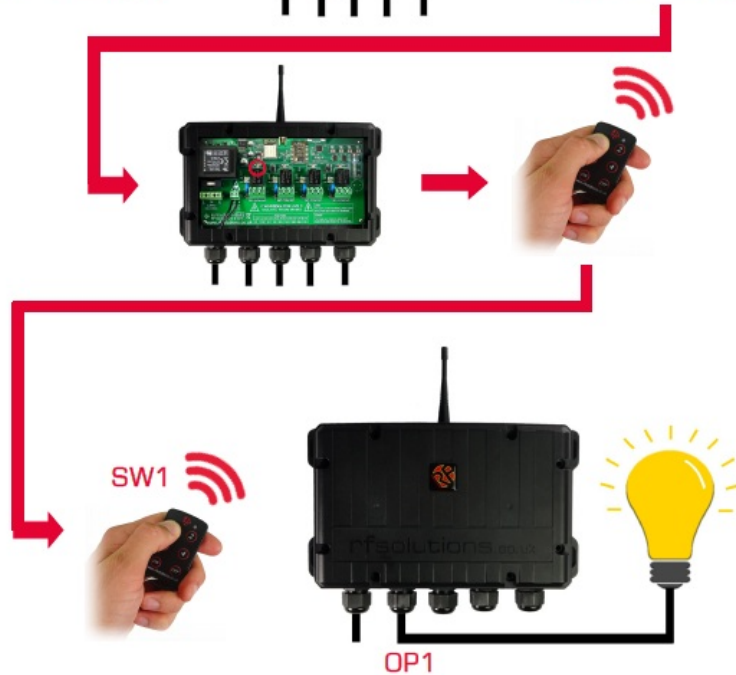
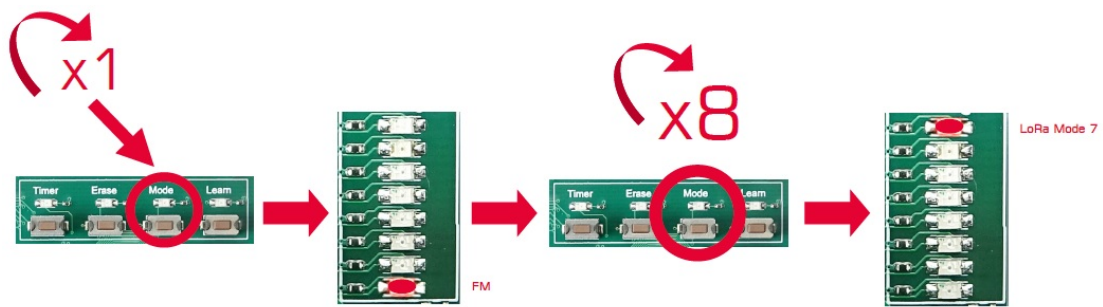

Safety Information

Carefully read the following safety information before proceeding with installation, operation, or maintenance of RF Solutions product. Failure to follow these warnings could result in death or serious injury

- This radio system must not be used in areas where there is a risk of explosion.
- Only qualified personnel should be permitted to access the transmitter and operate the equipment.
- Always follow operating information as well as all applicable safety procedures and requirements.
- You must satisfy the age requirements in your country for operating the equipment.
- Store in a safe place.
- Keep a clear view of the work area at all time before using, check it is safe to do so.

Before maintenance intervention on any remote-controlled equipment

- Do not open the receiver enclosure unless you are qualified.
- Disconnect all electrical power from the equipment.
- Check the enclosure and cable for damage regularly, do not use if there is evidence of damage.

Battery Precautions

- Risk of explosion if battery is replaced with a battery of an incorrect type.
- Do not short-circuit, disassemble, deform or heat batteries.
- Never attempt to charge a visibly damaged or frozen battery.
- Do not use or charge the battery if it appears to be leaking, deformed or damaged in any way.
- Immediately discontinue use of the battery if, while using, charging, or storing the battery, the battery emits an unusual smell, feels hot, changes color, changes shape, or appears abnormal in any other way.

Electrical Safety

ISOLATE the mains electricity supply before removing the cover and observe any relevant safety information.

- Maintenance to the product that involves removal of the cover should only be carried out by a competent person or qualified electrician.
- Ensure adequate protection on the Load circuit
- Refer to Product Datasheet for MAX operating Load.
- Product must be installed in accordance with the local country electrical regulations.
- A current limiting supply must be used in accordance with the datasheet

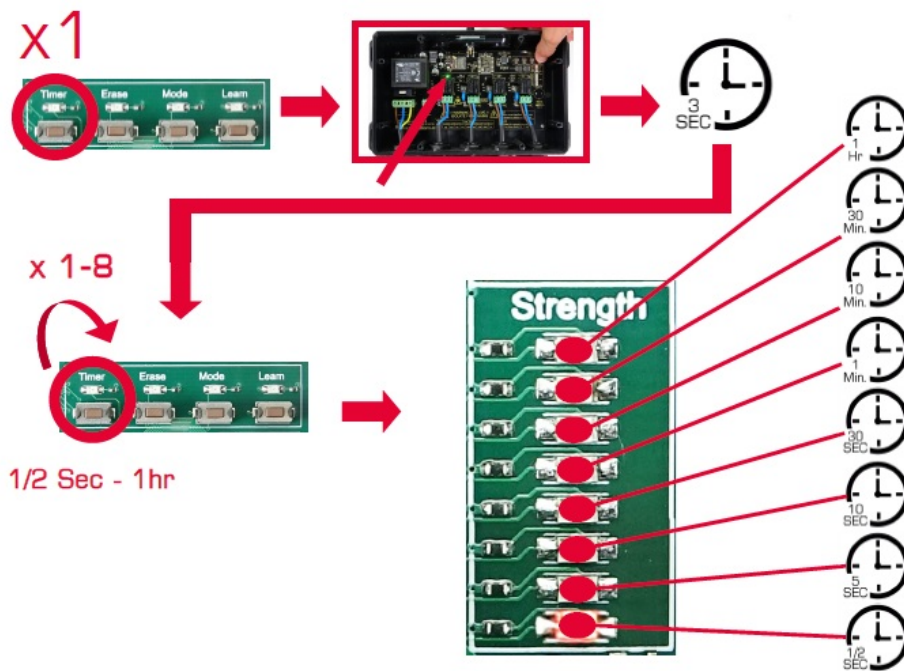

Erase ALL Pairings



Setting Timed Outputs—EXAMPLE



Setting Momentary / Latching

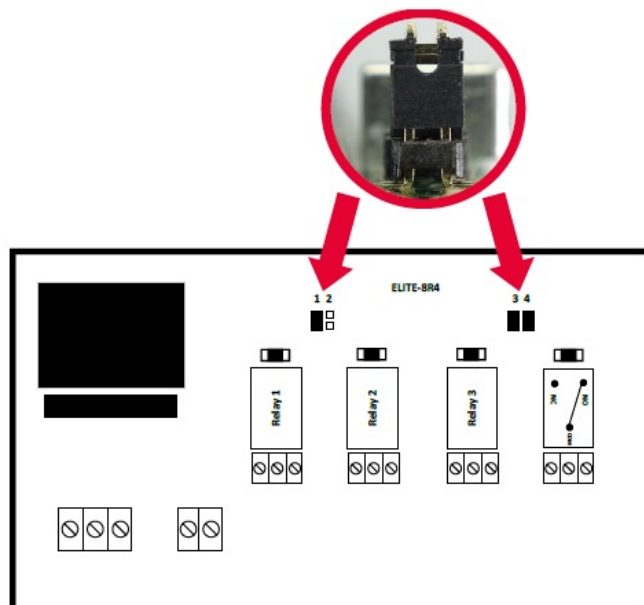

MOMENTARY



LATCHING



Wiring Example

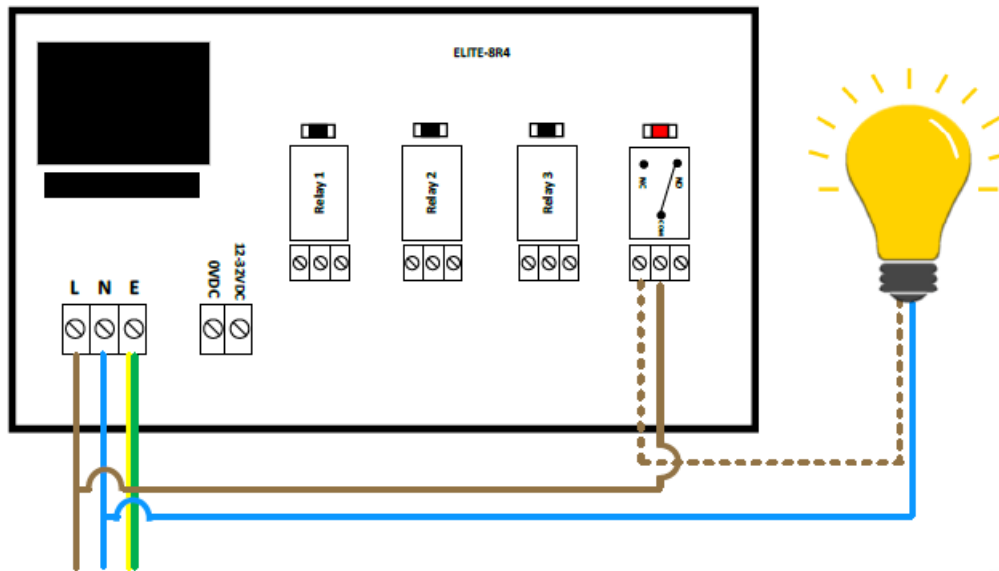

RF Solutions Ltd. Recycling Notice

Meets the following EC Directives:

DO NOT Discard with normal waste, please recycle.

ROHS Directive 2011/65/EU and amendment 2015/863/EU

Specifies certain limits for hazardous substances.

WEEE Directive 2012/19/EU

Waste Batteries and Accumulators

Directive 2006/66/EC

Where batteries are fitted, before recycling the product, the batteries must be removed and disposed of at a licensed collection point. RF Solutions battery producer number: BPRNO0060.

Disclaimer:

Whilst the information in this document is believed to be correct at the time of issue, RF Solutions Ltd does not accept any liability whatsoever for its accuracy, adequacy or completeness. No express or implied warranty or representation is given relating to the information contained in this document. RF Solutions Ltd reserves the right to make changes and improvements to the product(s) described herein without notice. Buyers and other users should determine for themselves the suitability of any such information or products for their own particular requirements or specification(s). RF Solutions Ltd shall not be liable for any loss or damage caused as a result of user's own determination of how to deploy or use RF Solutions Ltd's products. Use of RF Solutions Ltd products or components in life support and/or safety applications is not authorised except with express written approval. No licences are created, implicitly or otherwise, under any of RF Solutions Ltd's intellectual property rights. Liability for loss or damage resulting or caused by reliance on the information contained herein or from the use of the product (including liability resulting from negligence or where RF Solutions Ltd was aware of the possibility of such loss or damage arising) is excluded. This will not operate to limit or restrict RF Solutions Ltd's liability for death or personal injury resulting from its negligence.

www.rtsolutions.co.uk

Documents / Resources



RF Elite Receiver [pdf] User Guide

ELITEFOB-8S4, TRAPELITE-8S4, TAURUSELITE-8S4, SCORPIONELITE-8S4, ELITE-8R4, Elite Receiver, Receiver, Elite

References

-  [RF Solutions | Remote control systems, RF Modules, Antennas](#)
-  [rtsintercom.com/](#)

Manuals+.