



## **NX-8100F HD Drone with Foldable Design and 100M Range User Manual**

[Home](#) » [NX](#) » NX-8100F HD Drone with Foldable Design and 100M Range User Manual



**ENGINEERED  
FOR THE NEXT GENERATION™  
HD DRONE WITH FOLDABLE DESIGN & 100M RANGE  
USER MANUAL**



## Contents [ [hide](#) ]

### 1 WELCOME

#### 1.1 BEFORE YOU GET UP IN THE AIR

#### 1.2 GENERAL SAFETY

### 2 PRODUCT CONTENTS

#### 2.1 PRODUCT OVERVIEW

#### 2.2 CONTROLLER OVERVIEW

### 3 BATTERY SAFETY

### 4 SETTING UP YOUR NX-8100F

#### 4.1 INSTALLING THE BATTERY

#### 4.2 INSTALLING A MICRO SD CARD

#### 4.3 REMOVING A MICRO SD CARD

#### 4.4 REPLACING ROTOR BLADES

#### 4.5 INSTALLING ROTOR GUARDS

#### 4.6 REMOTE CONTROL

#### 4.7 FLIGHT SAFETY

#### 4.8 SYNCING YOUR NX DRONE

#### 4.9 FACTORY RESET FUNCTION

### 5 FLYING YOUR NX DRONE

#### 5.1 BASIC FLIGHT

#### 5.2 TRIM FUNCTION

#### 5.3 SPEED MODE

### 6 CAMERA / VIDEO FEATURES

#### 6.1 VIEWING PHOTOS AND VIDEOS

#### 6.2 CAMERA MODE

#### 6.3 VIDEO MODE

### 7 360° FLIP

### 8 HEADLESS MODE

### 9 ONE-KEY REVERSE

#### 9.1 EMERGENCY / STOP

### 10 DRONE MAINTENANCE

### 11 REPLACEMENT PARTS

### 12 WARRANTY TERMS & CONDITIONS

### 13 INDEMNITY

### 14 WARRANTY AND WARRANTY DISCLAIMER

### 15 LIMITATIONS OF NX LIABILITY

### 16 Documents / Resources

### 17 Related Posts

## WELCOME

Thank You for purchasing an NX Drone, get ready to have the time of your life! We're sure your NX Drone will bring you a world of great experience in the air. Please take the time to read the following Safety Warnings and operating instructions carefully.

### BEFORE YOU GET UP IN THE AIR

Before you familiarise yourself with the NX Drone, we ask that you read pages 5-6 before you start charging your drone's battery.

### GENERAL SAFETY

Please familiarise yourself with your local legislation regarding drone usage before you begin using your NX Drone. Included in the package contents of your NX Drone are the Australian CASA guidelines, please read them

carefully and understand this information as operating a drone outside of these guidelines may result in legal issues. NX takes no responsibility for the operation of this product outside of what is legally permissible in your area.

- Do not fly your NX Drone any closer than 30 meters from people, animals or buildings. Check to make sure you are no closer than 5.5 kilometers from any airfields or airports. For more information on CASA's Australian legislation visit: <http://www.casa.gov.au/>
- You must not fly your drone higher than 120 meters (400 ft) above the ground.
- You must only fly during the day and keep your drone within visual line of sight.
- For information outside Australia please visit the website of your local aviation authority.
- Do not attempt to modify the NX Drone or any of its components in any way, doing so will void your warranty and may affect the operation of the drone.
- Do not use the NX Drone in any conditions that could affect, damage or impair your view of the NX Drone.
- Do not use the NX Drone in any conditions that could leave it wet, dusty or sandy. These elements will damage the components of your NX Drone.
- Please do not attempt to touch the NX Drone when the Remote Control is powered on, or if the rotor blades are turning.
- When flying your NX Drone, please keep in mind the privacy of others.

## PRODUCT CONTENTS

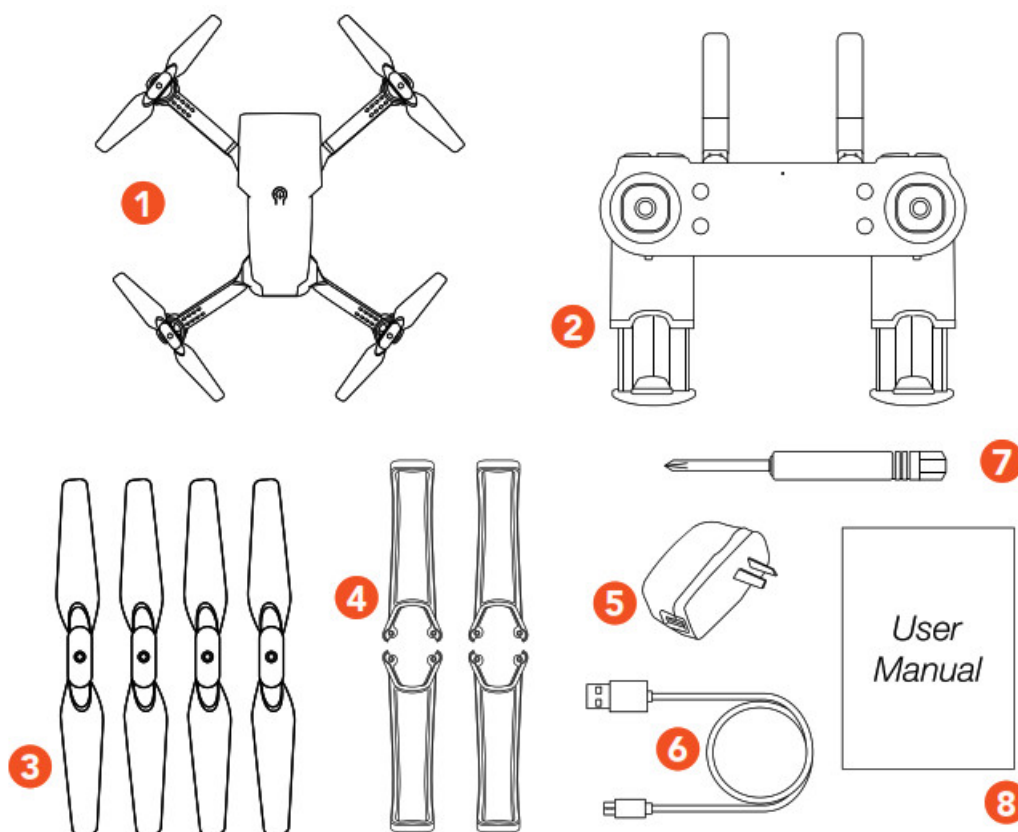

1. NX Drone 2. Remote Control 3. Rotor Blades x 4 4. Rotor Guards x 4	5. USB AC Wall Charger 6. USB Charging Cable 7. Screw Driver 8. User Manual
--	--

## PRODUCT OVERVIEW

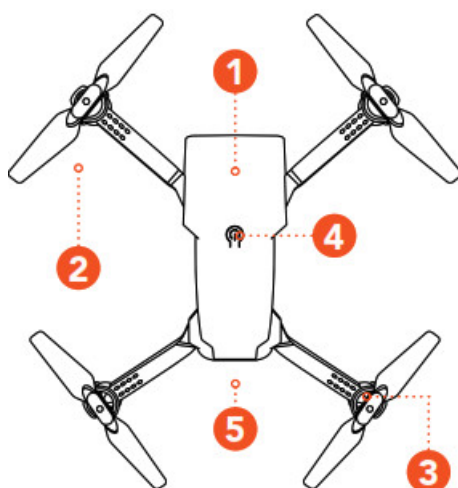

- |  |  |
|--|--|
| 1. Camera<br>2. Rotor Blades<br>3. Motor | 4. Power Button<br>5. Battery Release Button |
|--|--|



## CONTROLLER OVERVIEW

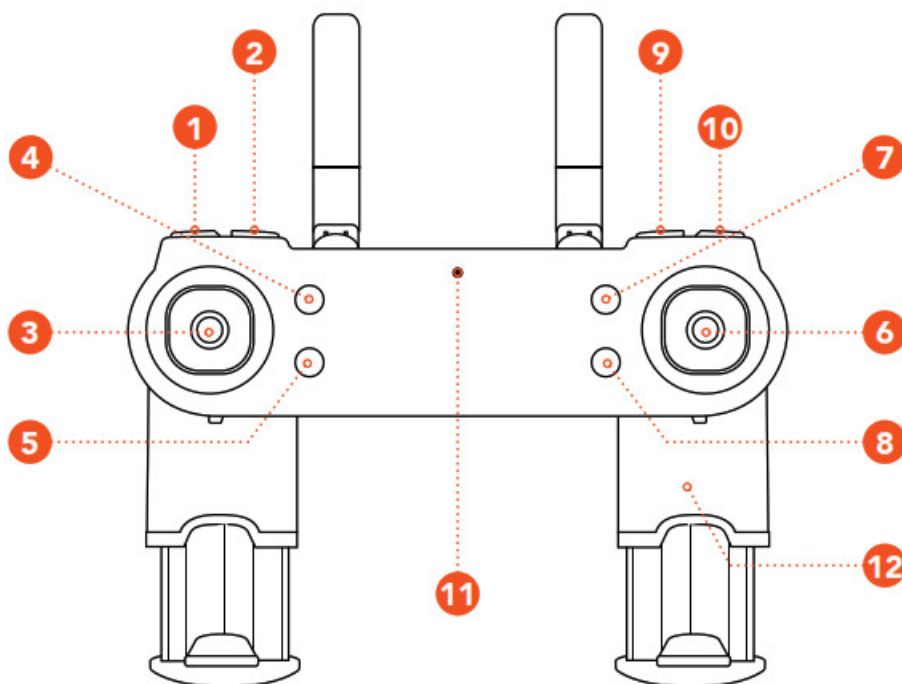

- |  |  |
|--|--|
| 1. Speed<br>2. Reverse<br>3. Left Control Stick (Pulse /<br>Descend, Yaw Left / Right)<br>4. One Key Take Off / Landing<br>5. Emergency Stop<br>6. Right Control Stick (Forward<br>/ Backward, Left / Right) | 7. Photo<br>8. Video<br>9. Headless Mode<br>10. 360 Flip<br>11. LED Power ON<br>12. ON / OFF |
|--|--|

## **IMPORTANT INFORMATION – PLEASE READ BEFORE USE**

### **BATTERY SAFETY**

When handled incorrectly, Lithium polymer batteries can be dangerous and can potentially harm and do damage to persons or property. NX does not accept any liability for damage to persons or property if the battery is not correctly charged, stored or protected.

- Always unwind all cables before charging.
- Do not overcharge the battery. Once the charging process is completed, remove the battery from the charger as soon as possible.
- Only use the included or replacement NX chargers and batteries.
- You must charge the Lithium polymer battery in a safe area away from flammable materials.
- The battery is only to be charged under adult supervision, do not leave charging batteries unattended. You should always remain in constant observation to monitor the charging process and react immediately to any potential problems that may occur.
- Do not charge the battery in temperatures hotter than 40°C or colder than 0°C.
- Do not cover the batteries when charging. Do not leave batteries in direct sunlight.
- After each flight & or crash, please check battery for any damage or swelling.
- If the battery is damaged, leaking, making noise, punctured or malformed in any way DO NOT attempt to use it. Please dispose of the battery immediately and safely in the correct manner.
- Do not bend, puncture, crush or scratch the drone's battery. Do not store batteries in your pockets, on your person or in extreme temperatures.
- After flying/discharging the battery you must allow it to cool to ambient/room temperature before recharging.
- If at any time during the charge or discharge process the battery begins to balloon or swell, discontinue charging or discharging immediately. Quickly and safely disconnect the battery, then place it in a safe, open area away from flammable materials to observe it for at least 15 minutes. Continuing to charge or discharge a battery that has begun to balloon or swell can result in a fire. A battery that has ballooned or swollen even a small amount must be removed from service completely.
- Never plug in a battery and leave it to charge unattended overnight.
- Non-compliance with the above warnings may result in the failure of the battery.

**PLEASE NOTE: YOUR NX DRONE COMES WITH A CERTIFIED NX USB AC CHARGING ADAPTER FOR 240v CHARGING OF YOUR DRONE BATTERY. USE OF A NON-NX CERTIFIED USB AC CHARGING ADAPTER WILL VOID YOUR WARRANTY AND MAY DAMAGE BOTH YOUR BATTERY AND DRONE.**

Connect the drone battery to the charging cable. The light will glow red indicating charging is in process. The LED on the USB charging cable will turn off once charging is complete. To keep the battery life as long as possible, avoid removing the battery from the charging cable before charging is complete. If you have just finished flying your NX Drone, please allow the battery to cool down for at least 30 minutes before recharging. When the NX Drone battery has finished charging it is advised that the battery is removed from the charger as soon as possible. Overcharging will damage the battery and affect the flight time. The NX Drone battery can take up to 50 minutes to fully charge. If the battery has been on charge for any longer than 2 hours and the indicator on the charging cable is not showing that the battery is charged, please remove the battery from the charger.

### **SETTING UP YOUR NX-8100F**

#### **INSTALLING THE BATTERY**

For detailed instructions on how to install the battery please follow the steps below.

1. Ensure that the battery is fully charged.
2. Insert the battery into the rear of the drone in the correct orientation (the tab on the battery should be facing down).
3. Slide the battery all the way in until it securely slots into place.

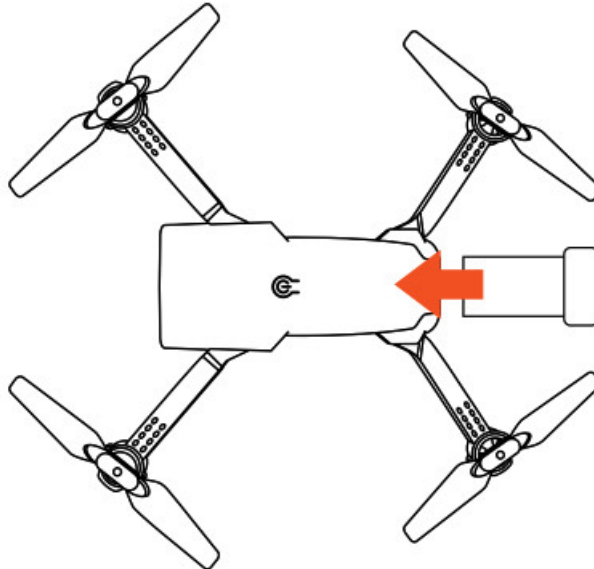

**NOTE:**

- Do not force the battery, if the battery does not fit into position, please check that you have installed the battery in the correct orientation.

**INSTALLING A MICRO SD CARD**

If you want to record your flights using the NX Drone's built-in camera it is required that you install a Micro SD Card (not included). It is recommended that you use a class 10 Micro SD Card, up to 32 GB. To install a Micro SD Card, please follow the instructions below.

1. With the NX Drone positioned upside down, insert your Micro SD Card into the slot near the copper contacts ensuring that the text on the Micro SD card is facing upwards.
2. Press the Micro SD card in until a click is heard and the Micro SD Card locks in position.

**REMOVING A MICRO SD CARD**

To remove your Micro SD Card, follow the instructions below.

1. Press the Micro SD Card in until a click is heard and the card releases.
2. The card will now release and the Micro SD Card will now be removable.

**REPLACING ROTOR BLADES**

If your rotor blades become damaged or the NX Drone drone is no longer flying straight, the rotor blades may need to be replaced. To replace the NX Drone's rotor blades please follow the directions below. There are two

types of rotor blades included with the NX Drone, A blades (clockwise rotation) and B blades (counter-clockwise rotation). The blades are marked on top showing either A or B. The arms of the drone are also marked A and B showing what blades each motor is compatible with.

It is important that the rotor blades are installed on the designated motors or else the drone may not fly and you could potentially burn out the drone's motors.

To remove and replace the rotor blades, please follow the instructions below.

1. Remove the black cap from the top of the rotor blade that you want to replace by using a small flat head screwdriver (not included). This will reveal the securing screw.
2. Remove the rotor blades securing screw by unscrewing counterclockwise with a screwdriver (included).
3. Once the screw has been removed gently pull the rotor blade upward to remove the rotor blade from the motor stem.
4. Get your replacement blade and ensure to identify and match the correct blade with the motor (A rotor blade to A motor, B rotor blade to B motor).
5. Place the new rotor blade over the motor stem and press it to ensure it is locked.
6. Replace and tighten the screw.
7. Replace the black cap by pressing it back into position.

## NOTE

- It is important that the correct rotor blades are installed on the correct motors. If they are installed incorrectly the drone will not fly and you could potentially burn out the drone's motors.
- When replacing multiple rotor blades please replace the blades one at a time to avoid any confusion in reattaching the rotor blades.

## INSTALLING ROTOR GUARDS

Replacing the rotor guards is an option. Installing the rotor guards will protect your rotor blades and motors against bumps and light crashes.

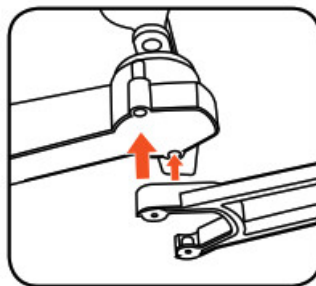

1. To install the rotor guards please insert the rotor guards' pegs into the designated holes near the motors on the NX Drone's arms.

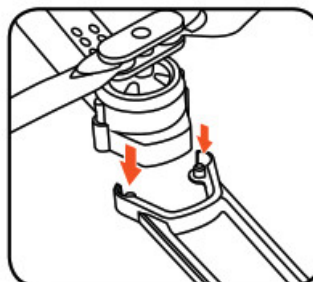

2. To remove the rotor guard, please press the middle part of the rotor guard first, then take the rotor guard out.



## REMOTE CONTROL

1. Extend the arms of the remote controller.
2. Remove the battery cover on the rear of the remote control by sliding it downward.
3. Insert 2 x AAA batteries (AAA batteries not included) making sure that they are in the orientation specified.

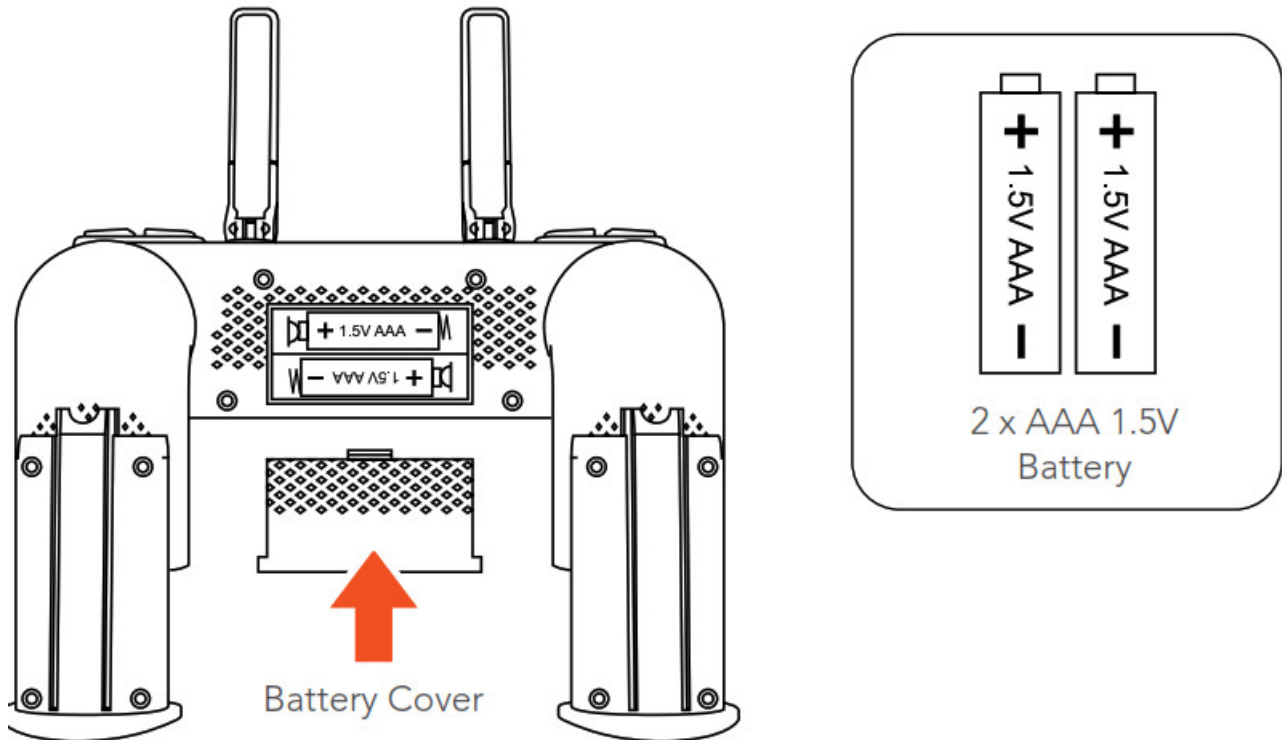

### NOTE:

- The right arm of the controller is Power ON / OFF.
- By extending the arm lower the controller, will Power On make a beep sound and the Power Indicator will turn ON.
- Closing the right controller arm will turn off the controller.

## FLIGHT SAFETY

Before flying your NX Drone make sure that you are in a safe setting. CASA restrictions regarding flying drones require the drone to be no closer than 5.5kms from any airport or airfield while flying. Drones should also not be flown over populated areas or any closer than 30 meters from vehicles, people or animals.

It is also required that you check your surroundings before taking off making sure there are no obstacles or dangers in the area including overhead power lines and large bodies of water. If there are hazards present in your intended area of flight, please consider an alternative location.

## SYNCING YOUR NX DRONE

1. Press the ON/OFF button on the top of the drone to turn the drone on, the LED light of the drone will blink a blue color (front) and a red color (rear).
2. Extend the arms of the controller downwards, the controller will make a beeping sound and the LED indicator will Power On the controller.
3. Move the left control stick to the upside for 1 second and then move the left thumbstick to the downside for 1 second, the control will beep and the LED light of the drone will stop blinking. LED will change to solid blue in

front and solid red in the rear.

4. Please ensure that the drone is kept on a flat surface. Press the left and right control sticks outward and downward (left stick 7 o'clock and right stick 5 o'clock positions) for 3 seconds. The Drone blades will start rotating and the drone is ready to fly.

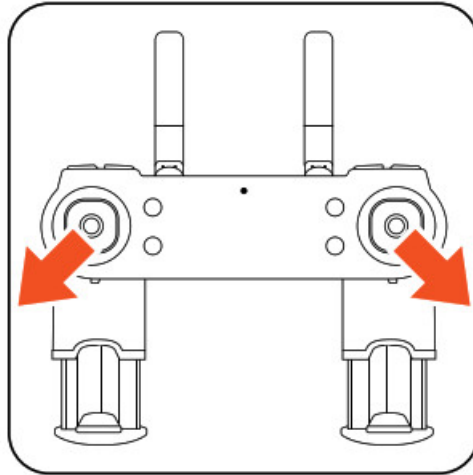

**NOTE:**

- Please pair the controller frequency within 5m of the drone to avoid interference with other signals

**FACTORY RESET FUNCTION**

To restore factory default settings, follow the steps below.

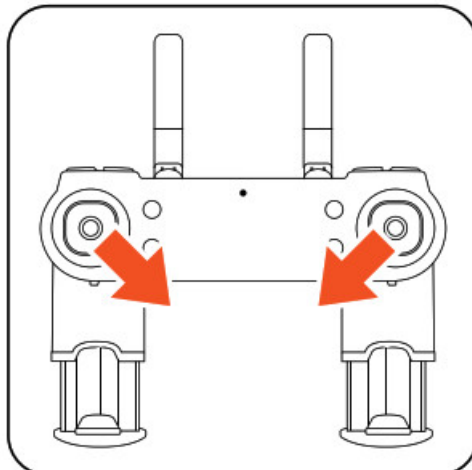
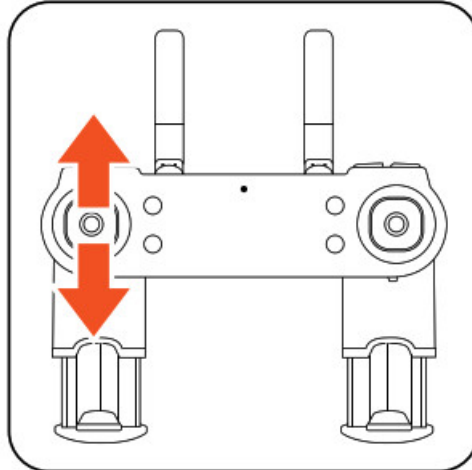

1. Press the Power ON/OFF to switch to turn on the drone.
2. Turn the controller on by moving the right arm of the controller downwards.
3. Sync the drone by following the Syncing Process as mentioned in the previous section.
4. Place the drone on a flat surface, and hold the left and right control sticks inward & downward (left stick 5 o'clock and right stick 7 o'clock positions) for 3 seconds. The indicator on the drone will change from constant light to quick flashing lights. When the LED light of the drone remains solid again, this means that the drone has been reset successfully.

## FLYING YOUR NX DRONE

### BASIC FLIGHT

#### UP AND DOWN

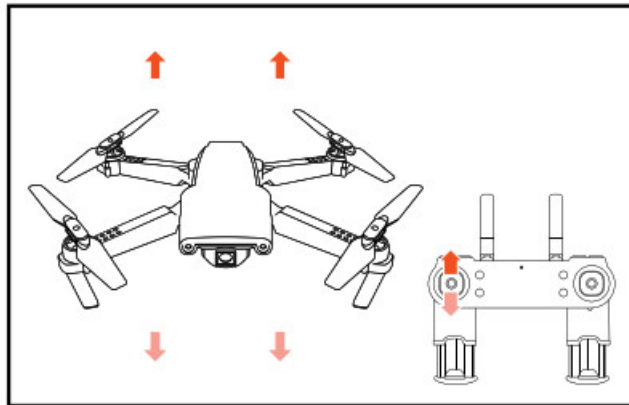

Push the left control stick up to gain altitude and down to descend

#### FORWARD AND BACKWARDS

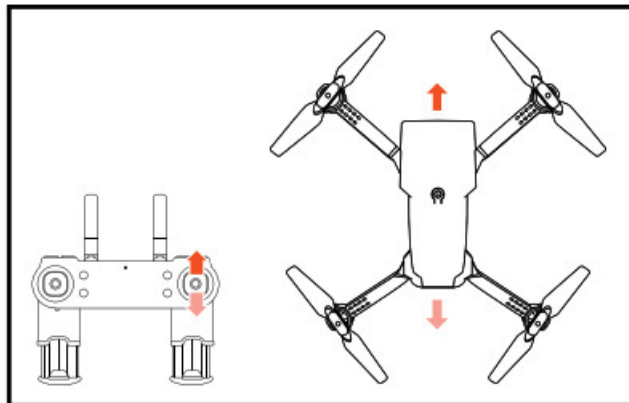

Push the right control stick up and down to fly forward and backward.

#### ROTATION

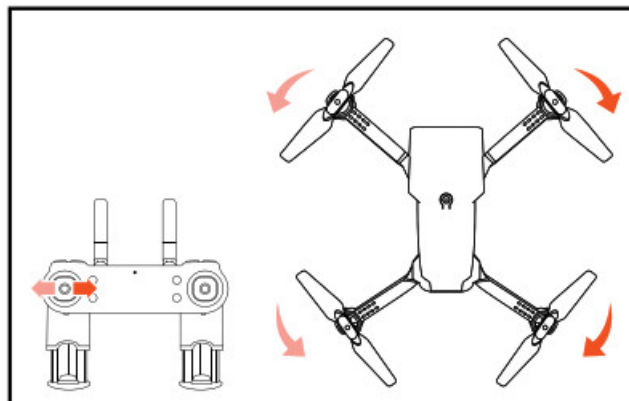

Push the left control stick left and right to pivot left/right.

#### LEFT/RIGHT FLIGHT

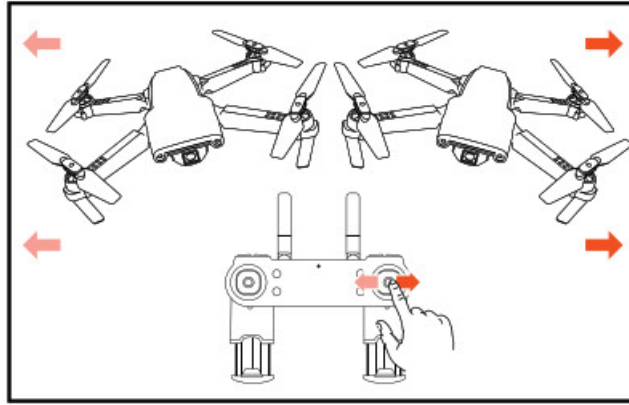

Push the right control stick left and right, to fly left/right.

## TRIM FUNCTION

Trimming is used to balance out your drone if it is drifting when flying. To adjust the trimming please follow the steps below. You can only use this trim function when the drone is airborne.

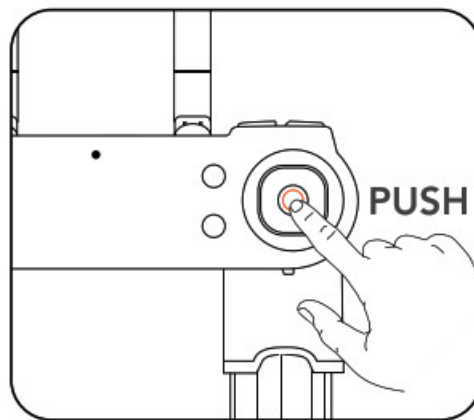

1. Make sure that the Remote Control and NX Drone are switched on and correctly paired.
2. With the right control stick centered, push down on it, once you hear the stick button click, release it. (This needs to be done each time you want to adjust trim in flight).
3. You can now adjust your trim using your left/right and up/down on your right controller stick. PLEASE REFER TO IMAGES 1-3 on Page 12.
4. To stop trimming, press down on the right control stick again.

## TRIM FORWARD/BACKWARD

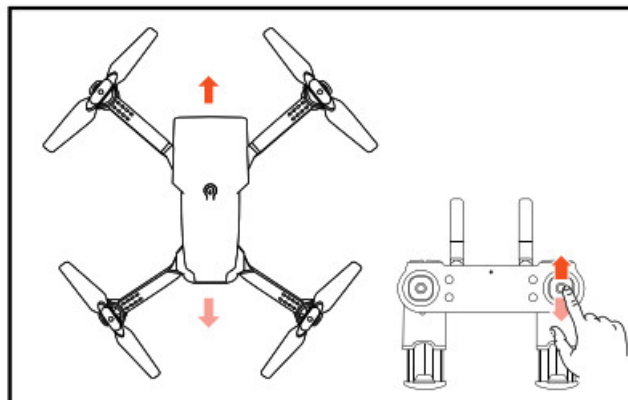

When the drone is hovering and starts to drift to the side, push the right stick to the left/right until the drone is stable.

If the drone keeps rotating to the left, press the left direction stick to the right until it's stable. If the drone keeps

rotating to the right, press the left direction stick to the left until it's stable.

When the drone is hovering in place, and starts to drift forward, press the right control stick backward until it's stable. If it drifts backward, press the right control stick forward until it's stable.

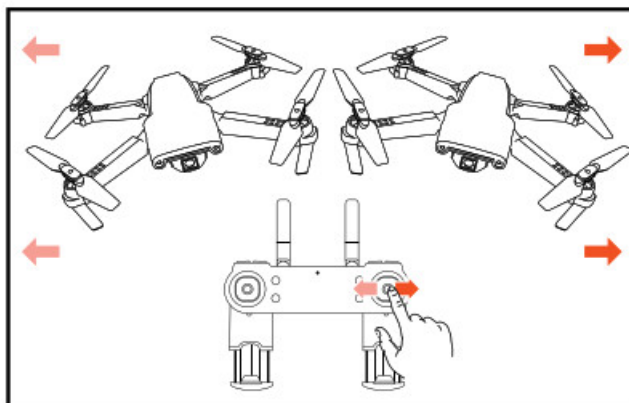

### LEFT/RIGHT TRIM

If the drone keeps rotating to the left, press the left direction stick to the right until it's stable. If the drone keeps rotating to the right, press the left direction stick to the left until it's stable.

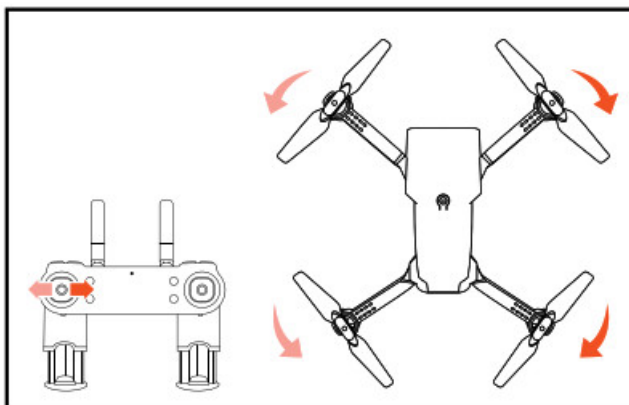

### SPEED MODE

The NX Drone has 3-speed modes. To cycle through the Speed Modes, use the speed button on the top left of the controller.

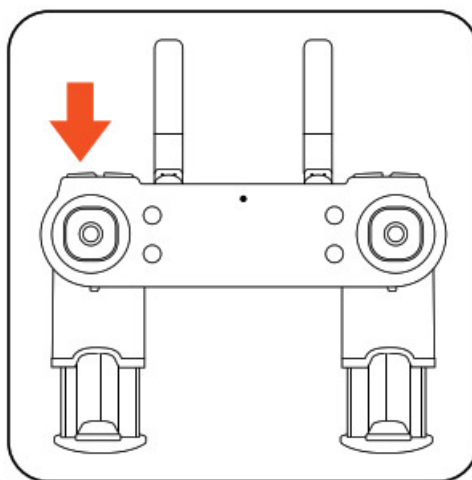

- Each mode will be identifiable by a series of beeps.
- Low-Speed Mode (Default): One beep
- Medium Speed Mode: Two beeps
- High-Speed Mode: Three beeps.

**NOTE:**

- For beginners, it is suggested to operate the drone at Low Speed.

**CAMERA / VIDEO FEATURES****VIEWING PHOTOS AND VIDEOS**

To view the recorded footage and videos you will need to connect the Micro SD card to your computer via either a USB Micro SD card reader or via an SD card converter if your computer has an SD card reader. (Not provided)

**CAMERA MODE**

1. With the drone turned on and paired, press the Photo button.
2. The remote control will beep once and the LED lights of drone will blink once to indicate that a photo was taken.

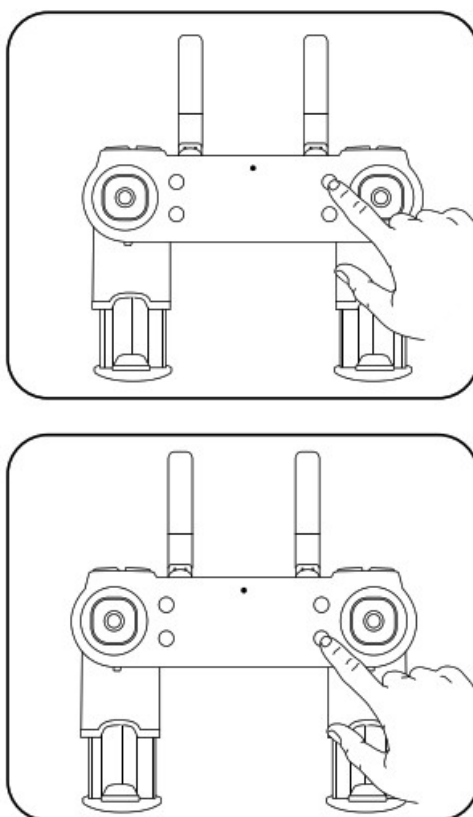
**VIDEO MODE**

1. With the drone turned on and paired, press the Video button.
2. The remote control will beep once and the LED lights on the drone will blink continuously to indicate that a video is being recorded.
3. Press the video button again to stop recording and the LED lights on the drone will stop blinking.

**NOTE:**

1. If there is no SD card or the SD card is full, the camera LEDs will blink green.

**360° FLIP**

Fly the drone to a height of more than 3 meters, push the right controller stick in the direction you want to flip your drone, then press the 360-degree flip button on the top right of your controller to flip your drone.

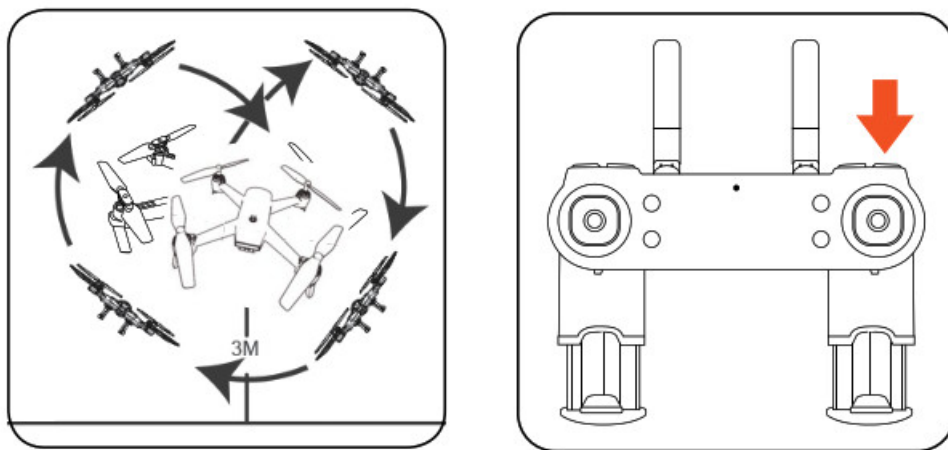

#### NOTE:

- 360 degree flips work better when the battery is fully charged.

#### HEADLESS MODE

1. Press the headless mode button on the controller (shown in the diagram to the right). The remote control will start beeping once indicating that headless mode has been enabled. To stop headless mode, press the headless mode button again; the controller will beep again.
2. When the headless mode is enabled, the drone will move in the direction that the remote controller stick is pressed, regardless of its orientation. This makes it easy to bring the drone home when it is far away from you.
3. When using headless mode, the camera of the drone must point in the direction of flight; the back of the drone should be facing the pilot. See below.

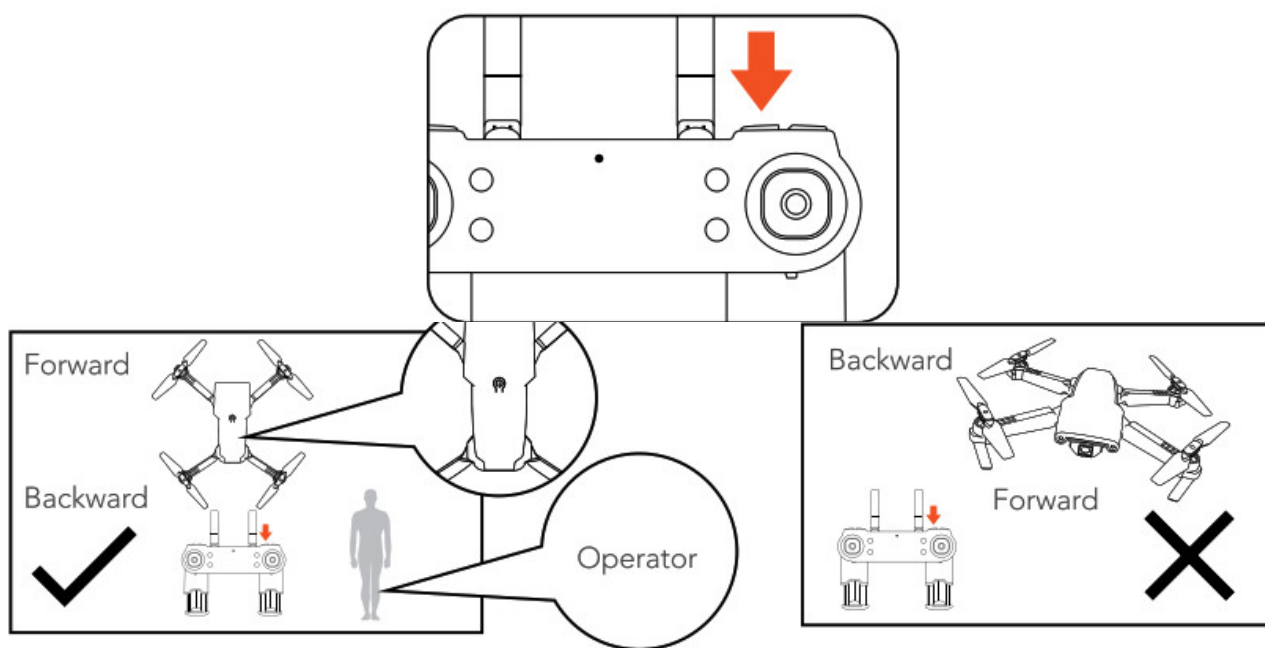

The correct take off position.

The incorrect take off position.

#### ONE-KEY REVERSE

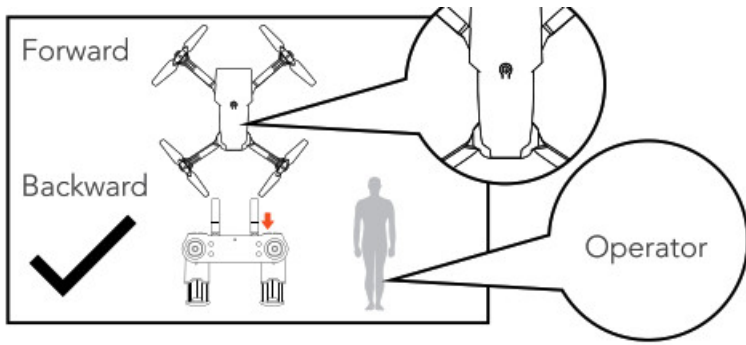

The correct take off position.

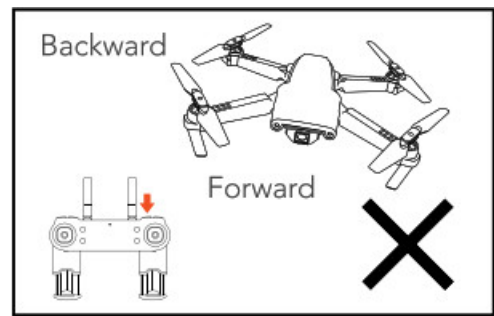

The incorrect take off position.

1. While the drone is in flight, press the reverse button on the remote control, the controller will beep once and the drone will fly in reverse.
2. Press the reverse button again to cancel or push the right control stick in any direction to stop this function.

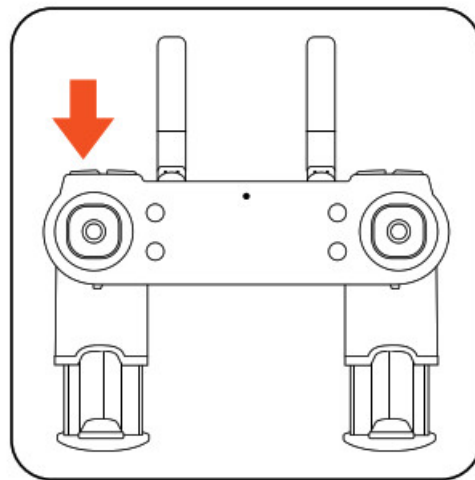

#### NOTE:

It is highly recommended that you push the reverse button only when you are aware that it is safe to reverse.

#### EMERGENCY / STOP

1. While the drone is airborne and emergency is activated, the rotor blades will lock and the drone will fall to the ground.

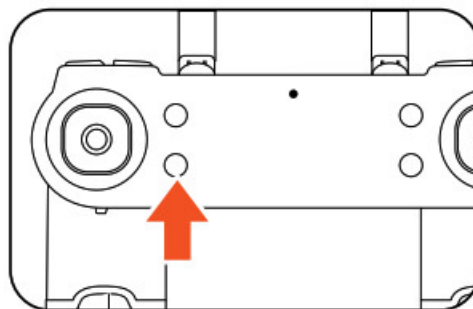

#### NOTE:

- It is highly recommended that you do not push this button unless it is an emergency.

#### DRONE MAINTENANCE



Avoid exposing your NX Drone and its accessories to dust, sand and moisture as these can damage the NX Drone. If the NX Drone is exposed to dust or sand, use a soft brush to remove any visible particles.

## REPLACEMENT PARTS

We understand that it's not always easy learning how to fly a drone, and sometimes a close call can turn into a crash landing. For all spare part inquiries please contact our customer service team on +61 03 8331 4800 or visit our website [www.nx-tech.com.au](http://www.nx-tech.com.au).

## WARRANTY TERMS & CONDITIONS

Our goods come with guarantees that cannot be excluded under the Australian and New Zealand Consumer Law. You are entitled to a replacement or refund for a major failure and for compensation for any other reasonably foreseeable loss or damage. You are also entitled to have the goods repaired or replaced if the goods fail to be of acceptable quality and the failure does not amount to a major failure.

This warranty is provided in addition to your rights under the Australian & New Zealand Consumer Law. NX warrants that this product is free from defects in material and workmanship for a period of 12 months from the date of purchase or for the period stated on the packaging. This warranty is only valid where you have used the product in accordance with any recommendations or instructions provided by NX.

This warranty excludes defects resulting from alterations of the product, accident, misuse, abuse or neglect. In order to claim the warranty, you must return the product to the retailer from which it was purchased or if that retailer is part of a national network, a store within that chain, along with satisfactory proof of purchase. The retailer will then return the goods to NX. NX will repair, replace or refurbish the product at its discretion. The retailer will contact you when the product is ready for collection. All costs involved in claiming this warranty, including the cost of the retailer sending the product to NX, will be borne by you.

NX Address: 115-119 Link Road, Melbourne Airport Australia Ph: +61 03 8331 4800 Email: [info@nx-tech.com.au](mailto:info@nx-tech.com.au)

## INDEMNITY

YOU AGREE TO DEFEND, INDEMNIFY AND HOLD HARMLESS NX AND ITS SUBSIDIARIES AND AFFILIATES FROM AND AGAINST ANY AND ALL CLAIMS, PROCEEDINGS, INJURIES, LIABILITIES, LOSSES, COSTS, AND EXPENSES (INCLUDING REASONABLE LEGAL FEES), INCLUDING BUT NOT LIMITED TO, CLAIMS ALLEGING NEGLIGENCE, INVASION OF PRIVACY, COPYRIGHT INFRINGEMENT AND/OR TRADEMARK INFRINGEMENT AGAINST NX AND ITS SUBSIDIARIES AND AFFILIATES OR THE NX SERVICES, RELATING TO OR ARISING OUT OF YOUR BREACH OF ANY PROVISION OF THESE TERMS, YOUR MISUSE OF THE NX OR NX SERVICES, OR YOUR UNAUTHORIZED MODIFICATION OR ALTERATION OF PRODUCTS OR SOFTWARE.

## WARRANTY AND WARRANTY DISCLAIMER

NX HAS A LIMITED WARRANTY ON WHEREBY NX WARRANTS TO AND ONLY TO YOU THAT NX DRONES WILL BE FREE FROM DEFECTS IN MATERIALS AND WORKMANSHIP FOR ONE (1) YEAR FROM THE DATE OF YOUR PURCHASE OF THE NX DRONE (UNLESS A LONGER WARRANTY PERIOD IS REQUIRED BY LAW).

THE SPECIFICS OF THIS NX LIMITED WARRANTY ARE AT [WWW.NX-TECH.COM.AU/WARRANTY](http://WWW.NX-TECH.COM.AU/WARRANTY) TO THE EXTENT POSSIBLE UNDER GOVERNING LAW, OTHER THAN THE ABOVE PRODUCT WARRANTY FOR THE NX DRONES, YOU UNDERSTAND AND AGREE THAT THE NX SERVICES ARE PROVIDED ON AN "AS IS" AND "AS AVAILABLE" BASIS. NX MAKES NO WARRANTY THAT THE NX SERVICES WILL MEET YOUR REQUIREMENTS OR THAT USE OF THE NX SERVICES WILL BE UNINTERRUPTED, TIMELY, SECURE OR ERROR-FREE NOR DOES NX MAKE ANY WARRANTY AS TO THE ACCURACY OR RELIABILITY OF ANY INFORMATION OBTAINED THROUGH THE NX SERVICES (INCLUDING THIRD PARTY CONTENT), THAT ANY DEFECTS IN THE NX SERVICES WILL BE CORRECTED OR THAT THE NX PRODUCTS OR NX SERVICES WILL BE COMPATIBLE WITH ANY OTHER SPECIFIC HARDWARE OR SERVICE. FURTHER, NX DOES NOT

WARRANT THAT THE NX SERVICES OR THE NX SERVERS THAT PROVIDE YOU WITH DATA AND CONTENT ARE FREE OF VIRUSES OR OTHER HARMFUL COMPONENTS. NX ALSO ASSUMES NO RESPONSIBILITY FOR AND SHALL NOT BE LIABLE FOR ANY DAMAGES CAUSED BY VIRUSES THAT MAY INFECT YOUR NX DRONES, COMPUTER SOFTWARE, OR OTHER HARDWARE. IF YOU WANT INSURANCE TO PROTECT AGAINST ANY RISK OF LOSS OF YOUR DRONE OR DAMAGE TO YOUR PROPERTY AS A RESULT OF USING YOUR DRONE, YOU WILL PURCHASE IT. IN THE EVENT OF ANY LOSS, DAMAGE OR INJURY, YOU WILL NOT LOOK TO NX TO COMPENSATE YOU OR ANYONE ELSE. YOU RELEASE AND WAIVE FOR YOURSELF AND YOUR INSURER ALL SUBROGATION AND OTHER RIGHTS TO RECOVER AGAINST NX ARISING AS A RESULT OF THE PAYMENT OF ANY CLAIM FOR LOSS, DAMAGE OR INJURY. NX'S EQUIPMENT AND SERVICES DO NOT CAUSE AND CANNOT ELIMINATE OCCURRENCES OF CERTAIN EVENTS, INCLUDING, BUT NOT LIMITED TO, ACCIDENTS OR PROPERTY DAMAGE. NX MAKES NO GUARANTEE OR WARRANTY, INCLUDING ANY IMPLIED WARRANTY OF MERCHANTABILITY OR FITNESS FOR A PARTICULAR PURPOSE, THAT THE NX EQUIPMENT AND SERVICES PROVIDED WILL DETECT OR AVERT SUCH INCIDENTS OR THEIR CONSEQUENCES. NX DOES NOT UNDERTAKE ANY RISK THAT YOU OR YOUR PROPERTY, OR THE PERSON OR PROPERTY OF OTHERS, MAY BE SUBJECT TO INJURY OR LOSS IF SUCH AN EVENT OCCURS. THE ALLOCATION OF SUCH RISK REMAINS WITH YOU, NOT NX. OTHER THAN THE ABOVE PRODUCT WARRANTY FOR THE NX DRONES, NX AND ITS SUPPLIERS DISCLAIM ALL WARRANTIES OF ANY KIND, WHETHER EXPRESS, IMPLIED, OR STATUTORY, REGARDING THE NX EQUIPMENT AND ANY ASSOCIATED APP/SERVICE. INCLUDING ANY IMPLIED WARRANTY OF TITLE, MERCHANTABILITY, FITNESS FOR A PARTICULAR PURPOSE, OR NON-INFRINGEMENT OF THIRD-PARTY RIGHTS. BECAUSE SOME JURISDICTIONS DO NOT PERMIT THE EXCLUSION OF IMPLIED WARRANTIES, THE LAST SENTENCE OF THIS SECTION MAY NOT APPLY TO YOU. NX HEREBY FURTHER EXPRESSLY DISCLAIMS ALL LIABILITY FOR ANY CLAIMS FOR SERVICE FAILURES THAT ARE DUE TO NORMAL PRODUCT WEAR, PRODUCT MISUSE, ABUSE, PRODUCT MODIFICATION, IMPROPER PRODUCT SELECTION OR YOUR NON-COMPLIANCE WITH ANY AND ALL APPLICABLE FEDERAL, STATE OR LOCAL LAWS. THIS WARRANTY AND WARRANTY DISCLAIMER GIVE YOU SPECIFIC LEGAL RIGHTS, AND YOU MAY HAVE OTHER RIGHTS THAT VARY BY STATE, PROVINCE, OR COUNTRY. OTHER THAN AS PERMITTED BY LAW, NX DOES NOT EXCLUDE, LIMIT OR SUSPEND OTHER RIGHTS YOU HAVE, INCLUDING THOSE THAT MAY ARISE FROM THE NONCONFORMITY OF A SALES CONTRACT. FOR A FULL UNDERSTANDING OF YOUR RIGHTS YOU SHOULD CONSULT THE LAWS OF YOUR STATE, PROVINCE, OR COUNTRY. FOR OUR AUSTRALIAN CUSTOMERS: PLEASE NOTE THAT THIS WARRANTY IS IN ADDITION TO ANY STATUTORY RIGHTS IN AUSTRALIA IN RELATION TO YOUR GOODS WHICH, PURSUANT TO THE AUSTRALIAN CONSUMER LAW, CANNOT BE EXCLUDED.

## **LIMITATIONS OF NX LIABILITY**

UNDER NO CIRCUMSTANCES WILL NX BE LIABLE IN ANY WAY FOR ANY CONTENT, INCLUDING, BUT NOT LIMITED TO, THE LOSS OF CONTENT, ANY ERRORS OR OMISSIONS IN ANY CONTENT, OR ANY LOSS OR DAMAGE OF ANY KIND INCURRED IN CONNECTION WITH USE OF OR EXPOSURE TO ANY CONTENT POSTED, EMAILED, ACCESSED, TRANSMITTED, OR OTHERWISE MADE AVAILABLE VIA THE NX APP. NX LIABILITY FOR DAMAGES, ESPECIALLY FOR BREACH OF DUTY OR OBLIGATION, DELAY IN PERFORMANCE, NON-PERFORMANCE, OR MAL PERFORMANCE SHALL BE PRECLUDED, EXCEPT WHEN THESE ARE DUE TO NEGLIGENT BREACHES OF ANY SIGNIFICANT CONTRACTUAL DUTY OR OBLIGATION ON THE PART OF NX. ANY LIABILITY FOR NEGLIGENCE IS LIMITED TO DIRECT LOSSES USUALLY AND TYPICALLY FORESEEABLE IN SUCH CASE. SHOULD THE CLAIM FOR DAMAGES BE BASED ON A WILFUL OR GROSSLY NEGLIGENT BREACH OF CONTRACTUAL DUTY OR OBLIGATION ON THE PART OF NX, THE PRECLUSION AND LIMITATION OF LIABILITY MENTIONED IN THE PRECEDING SENTENCES WILL NOT APPLY. THE PRECEDING PRECLUSION AND LIMITATION OF LIABILITY WILL ALSO NOT APPLY TO CLAIMS FOR DAMAGES ARISING OUT OF LOSS OF LIFE, BODILY INJURY OR HEALTH IMPACTS FOR WHICH NX MAY BE LIABLE, OR FOR NON- CONTRACTUAL LIABILITY. SOME STATES AND COUNTRIES DO NOT ALLOW THE EXCLUSION OR LIMITATION OF INCIDENTAL OR CONSEQUENTIAL DAMAGES, SO THE ABOVE LIMITATION OR EXCLUSION MAY NOT APPLY TO YOU. ADDITIONALLY, THIS PROVISION IS NOT INTENDED TO LIMIT NX'S LIABILITY IN THE EVENT OF NX'S WILLFUL OR INTENTIONAL MISCONDUCT.

## **NOTES**



ENGINEERED FOR THE NEXT GENERATION™

[www.nx-tech.com.au](http://www.nx-tech.com.au) | [www.nx-tech.co.nz](http://www.nx-tech.co.nz)

© NX v1.0 2020

All Images, Information and Content are Copyright © 2020 Directed Electronics Australia Pty Ltd. All Rights Reserved.



## Documents / Resources

The image shows the cover of the user manual for the NX-8100F HD Drone. It features a black drone with orange propellers and a black remote control. The text on the cover includes 'NX', 'HD DRONE WITH FOLDABLE DESIGN & 100M RANGE', and 'USER MANUAL'.	<p><a href="#">NX NX-8100F HD Drone with Foldable Design and 100M Range</a> [pdf] User Manual NX-8100F, HD Drone with Foldable Design and 100M Range</p>
--	--