



hp MP250 Mobile Projector User Guide

[Home](#) » [HP](#) » hp MP250 Mobile Projector User Guide 



Mobile Projector MP250/MP250 PRO Quick Start Guide

Congratulations and we thank you for choosing HP MP250 / MP250 PRO as your definitive mobile projector. MP250 / MP250 PRO features a suite of native apps for entertainment and productivity. With Wi-Fi connectivity, screen mirroring, and Bluetooth-out speaker functionality, it is versatile, yet compact and lightweight. MP250/MP250 PRO is your perfect companion to enjoy content wherever life takes you.

Contents

- [1 Package Contents:](#)
- [2 Device Overview](#)
- [3 USAGE TIPS:](#)
- [4 Technical Support:](#)
- [5 Documents / Resources](#)
- [6 Related Posts](#)

Package Contents:

HP MP250 / MP250 PRO* 1 <Accessories>

- Power Adapter * 1 Power Cord *1
- Remote Control * 1

- AAA Battery * 2 (For Remote Control)
- Quick Start Guide * 1
- Warranty Card *1
- Product Notices *1

Device Overview

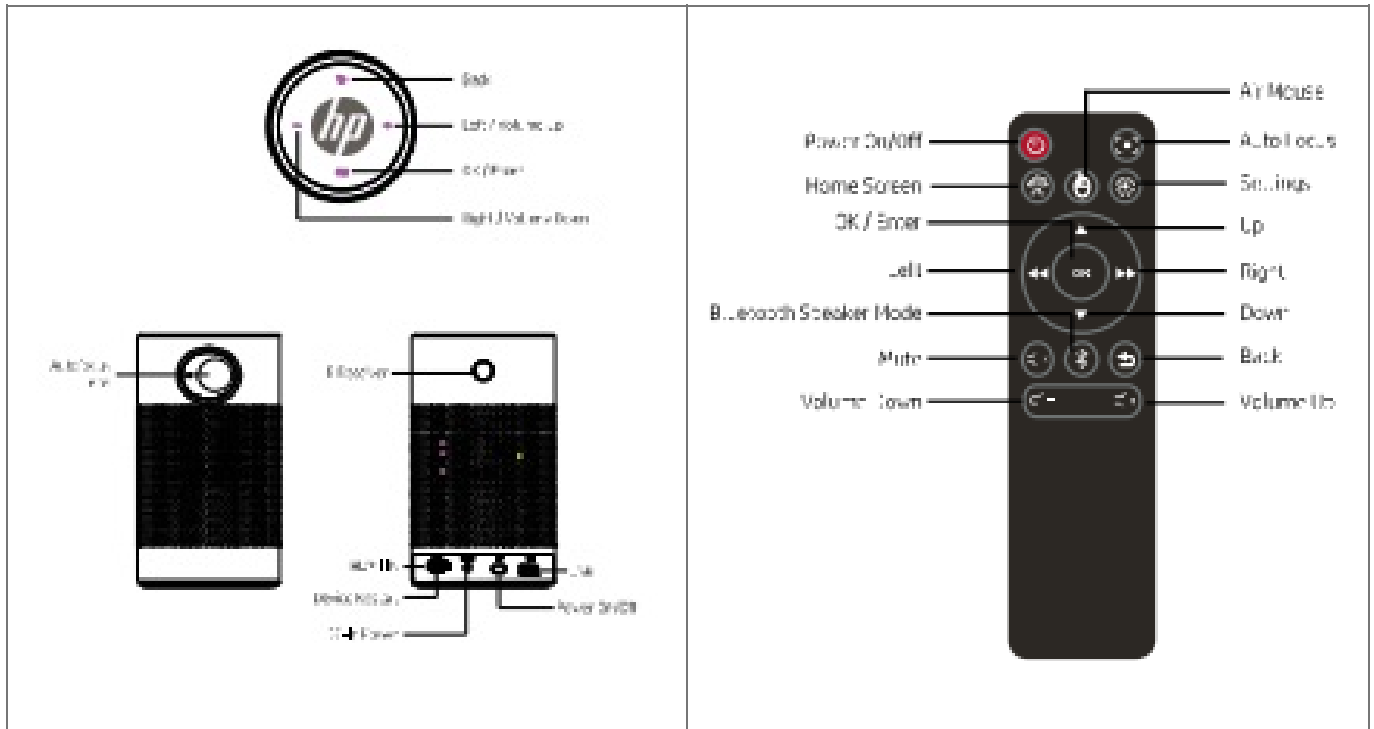

POWER ON/OFF: Press to power on, long Press 10~3 seconds to power off

SETTINGS: To access device settings

AUTOFOCUS: To proactively initiate autofocus of the projected screen

MUTE: To enable or disable speaker audio

KEYS (LEFT / RIGHT): To control focus points [left and right directions. Within multimedia playback, to increase playback speed or rewind speed

OK / ENTER: To confirm or proceed into a menu item

HOME SCREEN: To revert to the home screen

BACK: To return to the previous menu

BLUETOOTH SPEAKER MODE: To enter Bluetooth speaker (audio-out.t) mode

VOLUME UP & DOWN: To adjust audio volume

NAVIGATION KEYS (UP / DOWN): To navigate menu items

USAGE TIPS:

1. Power On / Off
 - a. Power On Press and hold the power button for 3 seconds on the device.
 - b. Power Off Press and hold the power button for 3 seconds on the device or remote control.
 - c. Force shut down: In the event, the device does not respond to the above steps, press and hold the power button for 10 seconds to force shut down.
2. When using the I4P250 / MP250 PRO for the first time, please set up and connect to a stable and working Wi-Fi network.
3. Upon successful Wi-Fi network setup, you will be able to access content on the Internet via the embedded apps. You may also wirelessly screen mirror content to the big

screen from your iOS / Android devices. Note: Please ensure your iOS / Android device is connected to the same Wi-Fi network used by MP250 / MP250 PRO.

4. There are multiple ways you can play content on MP250 / MP250 PRO
 - a. You can use a compatible HDMI cable to connect your smart devices to MP250 / f4P250 PRO to instantly display content from your device onto the projected screen.
 - b. You can connect any USB SSD storage drive / stick to MP250 / MP250 PRO to access and play content directly from it.
 - c. You can also enable Bluetooth Audio mode, to use MP250 / MP250 PRO as a Bluetooth speaker for music sessions. To bring back the projected screen, press the 'back' button on the remote.
5. MP250 / MP250 PRO features auto-focus functionality to ensure a sharp and clear picture, no matter where it is placed. However, if you would like MP250 / MP250 PRO to re-adjust focus, you may press the 'Auto Focus' button for the device to re-attempt picture focus.
6. MP250/ MP250 PRO features an air mouse that mimics the cursor of a mouse. You may use this as another way to navigate the menus of MP250 /MP250 PRO. Alternatively, if you prefer using a physical mouse, you can plug any USB mouse into the USB port.
7. For further details regarding the usage of MP250 / MP250 PRO, please read the 'User Guide' located inside the device.

We would like to thank you again, and sincerely hope you will enjoy using HP MP250/MP250 PRO.

Changes or modifications not expressly approved by the party responsible for compliance could void the user's authority to operate the equipment.

NOTE: THE MANUFACTURER IS NOT RESPONSIBLE FOR ANY RADIO OR TV INTERFERENCE CAUSED BY UNAUTHORIZED MODIFICATIONS TO THIS EQUIPMENT. SUCH MODIFICATIONS COULD VOID THE USER'S AUTHORITY TO OPERATE THE EQUIPMENT. NOTE: This equipment was tested and found to comply with the limits for a Class B digital device, pursuant to Part 15 of the FCC Rules. These limits are designed to provide reasonable protection against harmful interference in a residential installation. This equipment generates, uses, and can radiate radiofrequency energy. If not installed and used in accordance with the instructions, may cause harmful interference to radio communications. However, there is no guarantee that interference will not occur in a particular installation. If this equipment does cause harmful interference to radio or television reception, which can be determined by turning the equipment off and on, the user is encouraged to try to correct the interference by one or more of the following measures:

- Reorient or relocate the receiving antenna.
- Increase the separation between the equipment and receiver.
- Connect the equipment into an outlet on a circuit different from that to which the receiver is connected.
- Consult the dealer or an experienced radio/television technician for help.

This device has been tested and found to comply with the FCC radiation exposure limit set forth for an uncontrolled environment and meet the FCC radio frequency (RF) exposure guidelines. This device complies with Part 15 of the FCC Rules. Operation is subject to the following two conditions: (1) this device may not cause harmful interference, and (2) this device must accept any interference received, including interference that may cause undesired operation.

This equipment complies with FCC RF radiation exposure limits set forth for an uncontrolled environment. This device and its antenna must not be co-located or operating in conjunction with any other antenna or transmitter. To comply with FCC RF exposure compliance requirements, this grant is applicable to only Mobile Configurations. The antennas used for this transmitter must be installed to provide a separation distance of at least 20 cm from all persons and must not be co-located or operating in conjunction with any other antenna or transmitter.

Technical Support:

For more detailed usage instructions, please download the MP250/MP250 PRO user manual at
<https://www.hp-projector.com/support>

GT Technology (Chongqing) Limited The manufacturer under the license of HP Inc.

Email: support@hp-projector.com Web: www.hp-projector.com

Documents / Resources

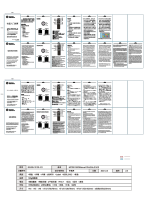
	<p>hp MP250 Mobile Projector [pdf] User Guide MP250, 2AZ3IMP250, MP250 Mobile Projector, MP250, Mobile Projector</p>
---	--

Manuals+