



# HP Wireless Premium and Collaboration USB Keyboard User Guide

[Home](#) » [HP](#) » HP Wireless Premium and Collaboration USB Keyboard User Guide 

## Contents

- [1 HP Wireless Premium and Collaboration USB Keyboard](#)
- [2 Getting Started
  - \[2.1 HP Wireless Collaboration Keyboard\]\(#\)
  - \[2.2 3 HP Wireless Collaboration Keyboard\]\(#\)](#)
- [3 HP USB Collaboration Keyboard](#)
- [4 HP Wireless Premium Keyboard
  - \[4.1 7 HP Wireless Premium Keyboard\]\(#\)](#)
- [5 HP USB Premium Keyboard](#)
- [6 Troubleshooting](#)
- [7 FAQ's](#)
- [8 Related Posts](#)



**HP Wireless Premium and Collaboration USB Keyboard**



## Getting Started

### HP Wireless Collaboration Keyboard



### 2 HP Wireless Collaboration Keyboard

Skype for Business® or Lync® subscription is required. If you do not have Skype for Business or Lync installed and running on your computer, these keys open your Outlook® contacts or calendar.

### 3 HP Wireless Collaboration Keyboard

#### Connect button

Your keyboard and Link-5 transceiver are pre-paired. To use the keyboard, simply connect the Link-5 transceiver to your computer. If you have an older Link-5 transceiver, you must pair any devices paired to that transceiver to your new transceiver.

#### What is Link-5?

HP Link-5 technology makes it easy to link up to five compatible HP wireless devices to the same USB transceiver. Using Link-5 with additional devices To pair a device to the Link-5 transceiver, move it to within one foot (30 cm) of the Link-5 transceiver, press the button on the device, and then press a key or Click a button on the device.

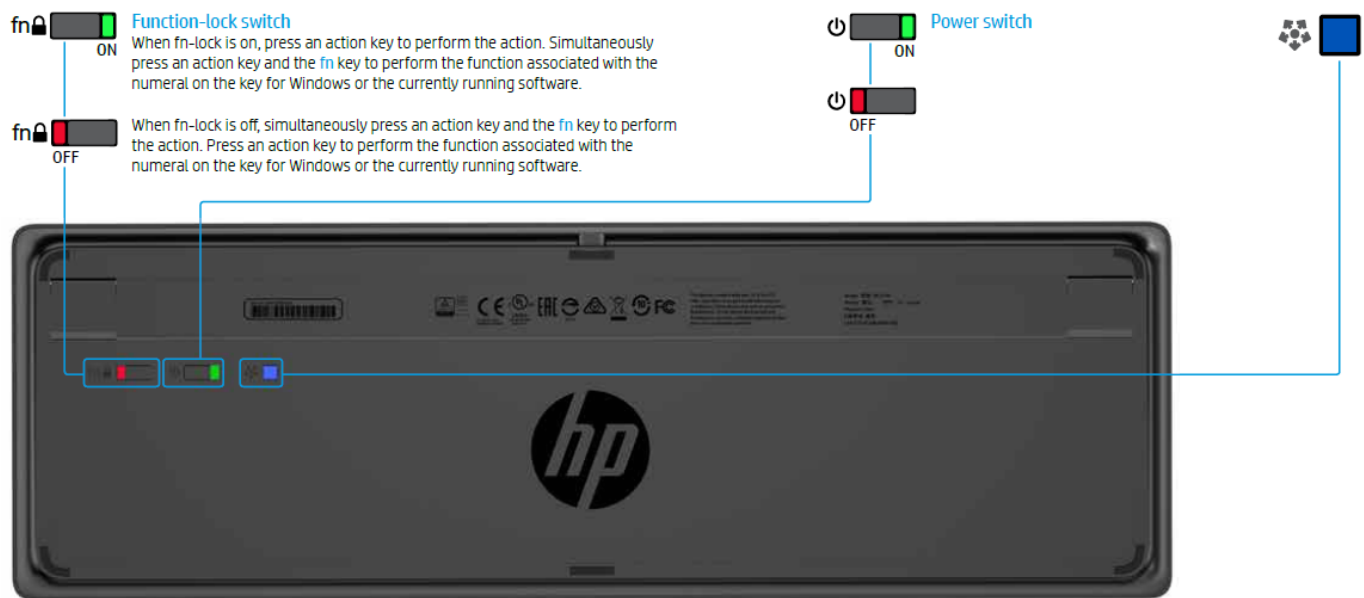

## HP USB Collaboration Keyboard

### 4 HP USB Collaboration Keyboard

\*Skype for Business or Lync subscription required. If you do not have Skype for Business or Lync installed and running on your computer, these keys open your Outlook contacts or calendar.



### 5 HP USB Collaboration Keyboard



#### Function-lock switch

When fn-lock is on, press an action key to perform the action. Simultaneously press an action key and the **fn** key to perform the function associated with the numeral on the key for Windows or the currently running software.



When fn-lock is off, simultaneously press an action key and the **fn** key to perform the action. Press an action key to perform the function associated with the numeral on the key for Windows or the currently running software.



## HP Wireless Premium Keyboard

### 6 HP Wireless Premium Keyboard



#### Mute microphone

Mutes the system microphone.  
• Light on: The system microphone is muted.



#### Mute audio

Mutes or restores speaker sound.  
• Light on: Speakers are muted.



#### Volume down



#### Volume up



#### Battery and pairing light status

- Solid white (5 s): Charge completed
- Slowly blinking white: Charging
- Slowly blinking amber: Low battery
- Off: Charged
- Blinking white (10 s): Pairing mode
- Quickly blinking white (2 s): Pairing completed

### 7 HP Wireless Premium Keyboard

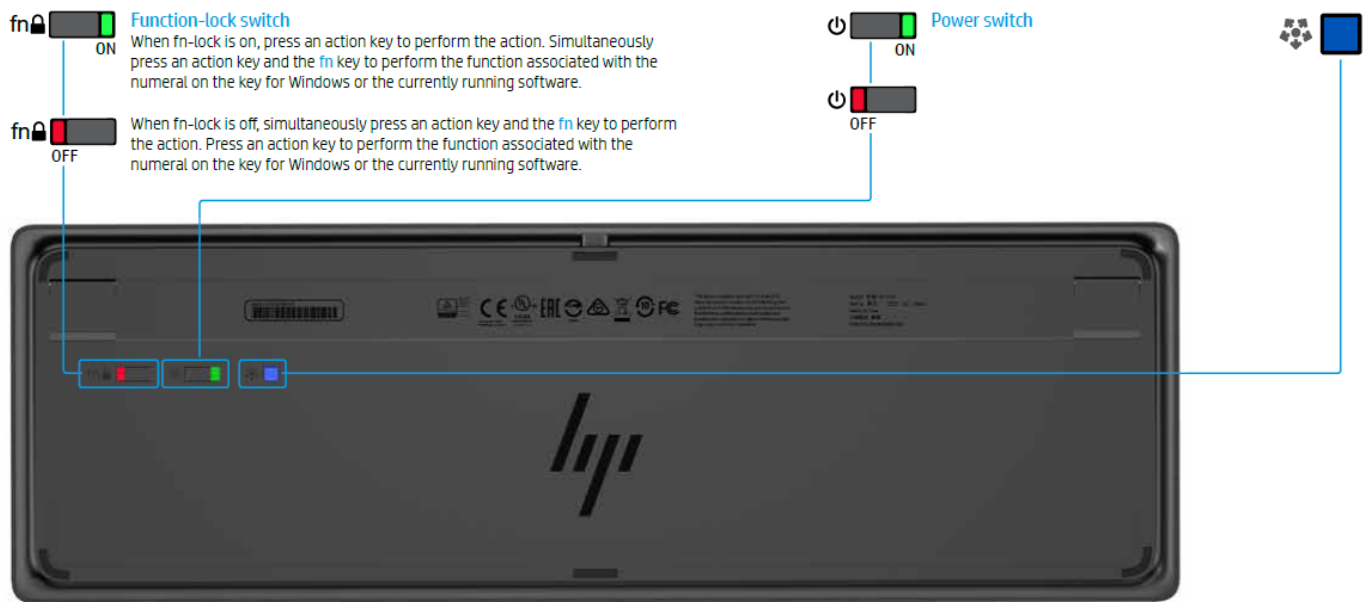

## Connect button

Your keyboard and Link-5 transceiver are pre-paired. To use the keyboard, simply connect the Link-5 transceiver to your computer. If you have an older Link-5 transceiver, you must pair any devices paired to that transceiver to your new transceiver.

## What is Link-5?

HP Link-5 technology makes it easy to link up to five compatible HP wireless devices to the same USB transceiver. Using Link-5 with additional devices To pair a device to the Link-5 transceiver, move it to within one foot (30 cm) of the Link-5 transceiver, press the button on the device, and then press a key or click a button on the device.

## HP USB Premium Keyboard

### 8 HP USB Premium Keyboard

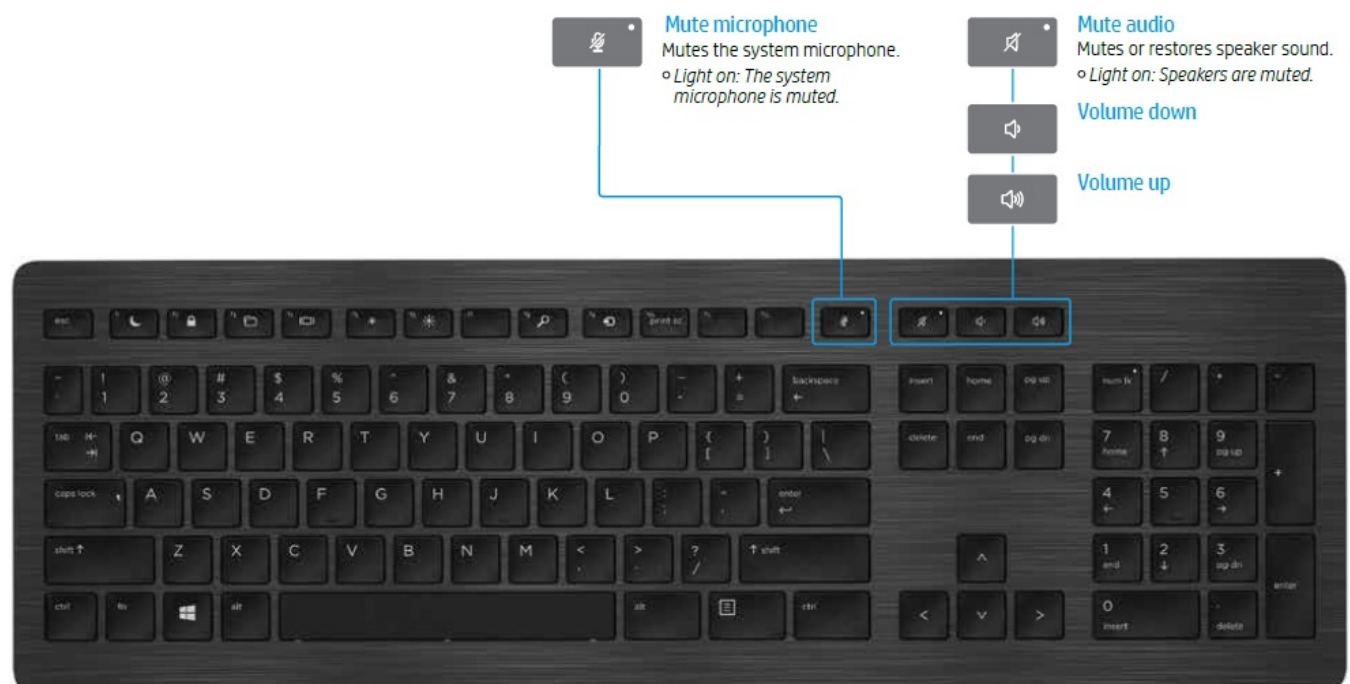

## 9 HP USB Premium Keyboard

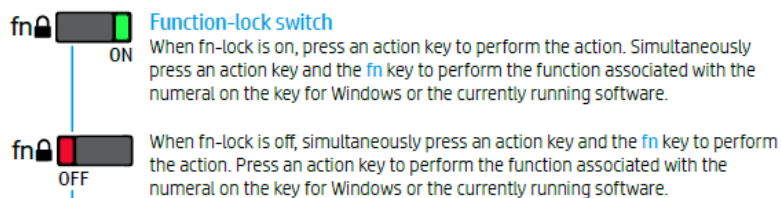

## Troubleshooting

### Problem

1. An action key or collaboration key is not working.
2. The f5 and f6 action keys do not adjust your monitor brightness setting.
3. Cannot share the screen in a 1-on-1 chat window.
4. The share screen light does not turn on.
5. The answer call or end call lights do not turn on.
6. The wireless keyboard does not pair with my USB transceiver.

### Possible cause

1. The keyboard software is not installed.
  - Neither Skype for Business nor Lync is installed on the computer.
  - An unsupported Skype for Business or Lync version is installed.
  - Your computer is running an unsupported operating system.
  - The function-lock switch is in the off position.
  - The keyboard was connected after a call was made.
  - Your audio settings are not configured properly.
  - You tried to share your screen or initiate a video call, but the recipient is on a device that does not support video.
2. Your device is not supported.
3. This action is not supported.
4. The recipient has not accepted your share screen request.
5. The recipient has not answered the call.



6. You are trying to pair the keyboard to an unsupported USB transceiver.

- The connection was lost.

## **Solution**

1. Go to [www.hp.com/support](http://www.hp.com/support) to download and install the latest software. Select Get software and drivers, enter the model number (on the bottom of the keyboard), and then select Find my product. Select your operating system, and then download the keyboard software.

- Install Skype for Business or Lync, configure your profile, and then download the keyboard software. If you download the keyboard software and then configure your profile, you must restart the computer before using the keyboard.
  - Download and install the latest version of Skype for Business – or – Download and install Lync 2013 version 15.0.46xx or higher. Not all keyboard functions can be used with Skype for Business Basic or Lync 2013 Basic.
  - Only Windows 10, Windows 8.1, and Windows 7 are supported.
  - An action key performs the function indicated by the icon on the key. When fn-lock is off, simultaneously press an action key and the fn key to perform the action.
  - Before making a call, connect the keyboard to your computer.
  - Confirm that the Skype for Business or Lync Audio Device settings and the System Playback Devices settings are the same. In the System Playback Devices settings, select Skype for Business or Lync Audio Device as the Default Communication Device.
  - Screen sharing and video calls are not supported on calls to a landline or phone. To use these functions, make a call to a device with Skype for Business or Lync installed.
2. The f5 and f6 action keys are supported only on select HP laptops and All-in-One computers.
3. Make an audio or video call and share your screen in that window. In Skype for Business or Lync, you can have a 1-on-1 chat in the same window as your audio or video call.
4. The share screen light turns on after the recipient accepts your share screen request.
5. The lights turn on after the recipient answers your call.
6. Only pair the keyboard to the included Link-5 transceiver. Older versions of the Link-5 transceiver are not supported.
- Repair the keyboard to the included Link-5 transceiver: Move the keyboard to within one foot (30 cm) of the Link-5 transceiver, and then press the button on the keyboard. When the light blinks to indicate that the keyboard is in pairing mode, press a key on the keyboard. The light blinks more quickly for 2 seconds when the pairing is complete.

© Copyright 2017 HP Development Company, L.P. Lync, and Skype are either registered trademarks or trademarks of Microsoft Corporation in the United States and/or other countries. The information contained herein is subject to change without notice. The only warranties for HP products and services are set forth in the express warranty statements accompanying such products and services. Nothing herein should be construed as constituting an additional warranty. HP shall not be liable for technical or editorial errors or omissions contained herein.

- **First Edition:** April 2017
- **Document Part Number:** 925614-001

## **FAQ's**

### **What's the process for a wireless USB keyboard?**

The wireless keyboard's radio transmitter is located inside of it. The radio receiver is plugged into a USB or keyboard port. The keyboard and mouse are recognized by the computer as though they were connected by a cable as soon as the receiver and transmitter are plugged in.

### **What is an HP laptop with a collaboration keyboard?**

In order to provide rapid access to support information and solutions, HP installs software on your Microsoft Windows device that enables it to recognize and collect data about your HP and Compaq products.

### **Why did my HP wireless keyboard suddenly stop functioning?**

Check the Bluetooth keyboards' power and connection status. Make sure the keyboard's On/Off switch is in the On position if it has one.

### **Wireless keyboards: are they hackable?**

Even while wireless keyboards encrypt the data they communicate back to the devices they are associated with, the encryption is occasionally not reliable. The attacker may inject packets into the unencrypted transmission as a result of this lack of protection.

### **Are batteries required for wireless keyboards?**

Wireless keyboards require a separate power supply.

### **Can a wireless keyboard be connected without a USB?**

No USB port is necessary when using Bluetooth to connect straight to your computer.

### **What should you do if your HP wireless keyboard won't work?**

Make sure the keyboard's On/Off switch is in the On position if it has one. If the keyboard won't switch on, charge the battery by plugging the charging cord into an electrical outlet, such as a USB port on a computer or an external USB power supply. Install fresh batteries if the keyboard is powered by changeable ones.

### **What advantages can wireless keyboards offer?**

Users may use a wireless keyboard wherever they choose to sit thanks to its portability and mobility. The keyboard and its adapter communicate with each other using infrared or radio waves.

### **Collaboration keys controller: what is it?**

Utilizing collaboration keyboard keys with some Hewlett Packard machines requires the use of the Collaboration Keys application. Once the application is installed, you can map the action to the correct keyboard keys.

### **What do the HP keyboard's function keys do?**

A printed icon that denotes a supplementary action, such as muting sound or altering display brightness, is frequently seen on the keyboard's function keys (f1 through f12).

### **On the wireless keyboard from HP, where is the connect button?**

The Connect button is red and may be found on the back corner of the keyboard, underneath the plastic tab. Verify that the keyboard's batteries are in good condition and are properly inserted into the gadgets.

### **Where is the HP wireless keyboard on/off switch?**



The wireless keyboard and mouse have a switch on the bottom. The power switch on some keyboard models is possible. Change the setting to ON.

### **How can I deactivate my wireless HP keyboard?**

The On/Off switch for the keyboard is at the bottom back.

### **Do USB keyboards outperform wireless ones?**

Which wireless keyboards should you purchase? Best response: If you don't want to bother with input lag, the possibility of interference, or battery life, wired keyboards are preferable.

### **Are all Bluetooth wireless keyboards the same?**

There are two primary types of wireless keyboard connections: those that rely on radio frequency (RF) and those that use Bluetooth to transmit data between the device and the keyboard.

**Download this PDF Link:** [HP Wireless Premium and Collaboration USB Keyboard](#)