

[Skip to content](#)

Manuals+

User Manuals Simplified.

HP 300 Wireless Mouse and Keyboard

Quick Start Guide



[Home](#) » [HP](#) » HP 300 Wireless Mouse and Keyboard Quick Start Guide

Contents [hide](#)

[1 HP 300 Wireless Mouse and Keyboard](#)

[2 Introduction](#)

[3 Description](#)

[4 What's in the box](#)

[5 How to Use](#)

[6 Features](#)

[7 FAQ's](#)

[8 Related Posts](#)



HP 300 Wireless Mouse and Keyboard



Introduction

We are a technology business founded on the idea that organizations should strive to achieve more than just financial success. They ought to contribute to improving the planet. Our initiatives in the areas of human rights and digital equity demonstrate that we are making every effort to achieve this goal. With more than 80 years of experience, we are confident in our ability to imagine a world where innovation leads to truly remarkable contributions to humanity. And our technology, which includes a range of personal systems, printers, and 3D printing solutions, was developed to spur this significant advancement. We are aware that original thoughts can strike anyone, anywhere, at any moment. To change the world, just one person is necessary.

Description

Use HP Accessory Center to set the mouse's DPI or program the keyboard's keys. Open the Microsoft Store, App Store, or Chrome Web Store on your computer if the app does not download instantly. Once you've found HP Accessory Center, download the app.

- **Comfort meets toughness**
With this comfortable, durable mouse, you can complete any work.
- **Get away from the wires**
Enjoy a wireless connection at 2.4GHz.
- **Speed and Accuracy**
With a DPI of up to 1600, your mouse movements will be more fluid.

What's in the box



1. Keyboard
2. Mouse
3. AAA batteries (keyboard) 2x
4. AA battery (mouse) 1x

How to Use

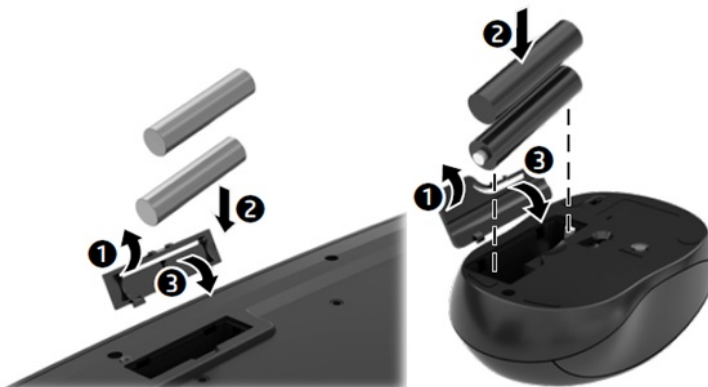

- **Updating the keyboard and mouse's batteries**

- Place the batteries after removing the cover from the rear of the keyboard and mouse.

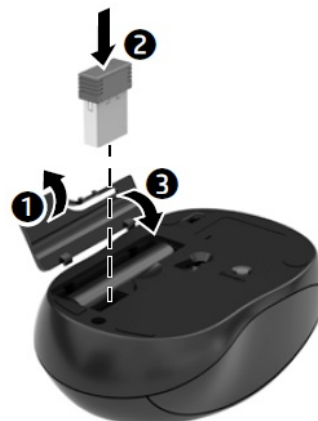

- After placing the batteries in the keyboard and mouse, insert the dongle.

- **Activate the mouse**



- On the mouse's backside is the on/off button.

- **Connect and Play**

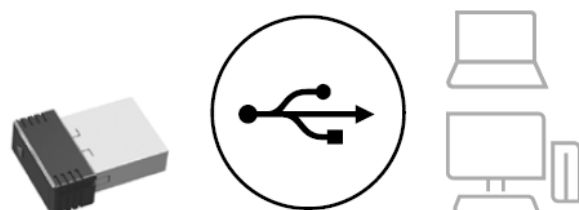

- Connect the dongle to the USB port on your computer or laptop.

Features

1. **Wireless, fashionable, and warm**

You can type more quietly and comfortably thanks to the chiclet keyboard design.

2. **Comfortable and tough**

You can complete any task with this dependable, cozy mouse.

3. **Respect the cables' privacy**

You can go about lag-free with a 2.4GHz wireless connection.

4. **You have access to productivity**

To increase output, use a keyboard that enables you to quickly press each of the 12 function keys with a single click.

Note

Products with electrical plugs are designed with American consumers in mind. Because outlets and voltage differ from one country to the next, you might need an adaptor or converter to use this device when you are traveling. Please verify compatibility before making a purchase.

FAQ's

It does not specify what the shortcut buttons on the keyboard are.

Press one and you'll find out!

Is this Windows 10 compatible?

Yep! It works wonderfully and is as simple to use as a horseback fall.

How many buttons does the mouse have? Does the center button of the mouse work?

The mouse features three buttons: a Left button, a Right button, and an auto-scrolling scroll wheel in the center.

If the device has Bluetooth as stated in the description, can I use the Bluetooth on my laptop or do I need the dongle?

I connected using Bluetooth on my computer. Try it; you'll like it, is all I can advise.

Does a wireless keyboard require Wi-Fi?

WiFi is not used by a wireless mouse and keyboard. Bluetooth is employed. There is a USB receiver included with the keyboard and mouse.

Does a wireless keyboard require Wi-Fi?

Wi-Fi is not used by a wireless mouse and keyboard. Bluetooth is employed. There is a USB receiver included with the keyboard and mouse.

Is it possible to hack a wireless keyboard and mouse?

Even while wireless keyboards encrypt the data they communicate back to the devices they are associated with, the encryption is occasionally not reliable. The attacker may inject packets into the unencrypted transmission as a result of this lack of protection.

Does this keyboard highlight the caps lock key?

Yes, however, it's not on the Caps Lock button; instead, it's above the minus key on the right side of the keyboard.

Is the height of this keyboard adjustable?

Yes, the legs on the back of this keyboard may be adjusted in height.

Can a mouse and keyboard be shared across two computers?

In my opinion, no. A dongle connected to the computer's USB port allows the keyboard and mouse to communicate with it. The dongle would have to be transferred between the PCs.

Is it Xbox-compatible?

Yes, it does.

Can I connect my existing HP mouse to the new dongle or would my existing HP mouse and dongle work with this?

Solely makes use of the keyboard and mouse that came with the dongle

Can a wireless HP mouse be connected without a receiver?

A wireless mouse is linked to a suitable wireless receiver (the matching dongle). Without the dongle, it won't connect unless it connects over Bluetooth and your laptop supports Bluetooth.

Download this PDF Link: [HP 300 Wireless Mouse and Keyboard Quick Start Guide](#)

[Manuals+](#)

- [home](#)
- [privacy](#)