



GE 93130501 Toggle or Paddle Smart Switch Instruction Manual

[Home](#) » [GE](#) » GE 93130501 Toggle or Paddle Smart Switch Instruction Manual 

Contents

- [1 GE 93130501 Toggle or Paddle Smart Switch](#)
- [2 Installation Guide](#)
- [3 Compatibility Requirements](#)
- [4 BEFORE YOU BEGIN](#)
- [5 PACKAGE CONTENTS](#)
- [6 TOOLS REQUIRED](#)
- [7 Congratulations!](#)
- [8 Enable Your Voice Assistant](#)
- [9 Additional Information and Warnings](#)
- [10 Documents / Resources](#)
- [11 Related Posts](#)



GE 93130501 Toggle or Paddle Smart Switch



Installation Guide

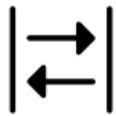

**Install
your Smart
Switch**



**Download
the CYNc App**



**Add
your Smart Switch to
the CYNc App**

Compatibility Requirements

- Rating 120 V AC 60 Hz
- Neutral wire is required (wire is usually white or grey)
- Ground wire is required (wire is usually green, green with a yellow stripe, or copper) Wi-Fi 802.11 b/g/n @ 2.-4 GHz is required
- Works with halogen, Incandescent and LED bulbs, Including CYNc Smart Bulbs.
- LED up to 1.25 amps
- Incandescent/halogen up to 5 amps

IMPORTANT NOTE ON 3-WAY WIRING:

Some lights have one wall switch, while others are controlled by two or more wall switches (such as stair lights, which have a switch at both the top and bottom of the stairs). If your lights have more than one switch (called a 3-way), we've created instructions for how to install and enable the capability.

Visit cyncsupport.gelighting.com

for 3-way Installation Instructions and how-to-videos.

Note: Complete set up in the CYNc App to enable 3-way/multi-way functionality

FOR SET UP HELP, VISIT [CYNCSUPPORT.GELIGHTING.COM](https://cyncsupport.gelighting.com) OR CALL 1-844-302-2943.

BEFORE YOU BEGIN

Read these instructions completely and carefully.

WARNING: RISK OF ELECTRIC SHOCK

This product installation requires handling 120 volt wiring. Follow each step carefully.

If any concerns handling wiring, hire a qualified electrician. Ensure all work meets local and federal regulations.

PACKAGE CONTENTS

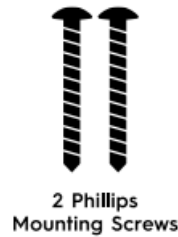

TOOLS REQUIRED



• STEP 1 TURN OFF THE POWER

Turn off the power for the switch location at the circuit breaker box.

Test existing switch by toggling switch on/off, ensuring lights do not turn on.

Now, follow these setup steps for a single gang switch.

• STEP 2 REMOVE YOUR OLD SWITCH

- Remove the existing wall plate and switch from the wall.
- Use voltage tester on the black wires to confirm power to the switch is off (recommended).
- Before disconnecting the wires from the wall label each wire.

A Neutral and ground wires are required. If you don't have either wire, the smart switch is not compatible.

- Disconnect wires and remove existing switch.

• STEP 3 CONNECT THE WIRES

- Connect the neutral (white) wire on the switch to the neutral wire from the wall.
- Connect the line (black) wire on the switch to the line wire from the wall.
- Connect the load (red) wire on the switch with the load wire from the wall
- Connect the ground (green) wire on the switch with the ground wire from the wall.
- Cap the 3-way/multi-way traveler wire (if applicable).

For 3-way switch setup, visit cyncsupport.gelighting.com

A Attention: Incorrectly connecting the Neutral or Ground wire from the wall to the Line or Load wire on the switch will damage the product

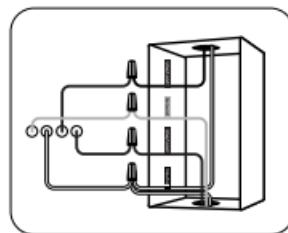
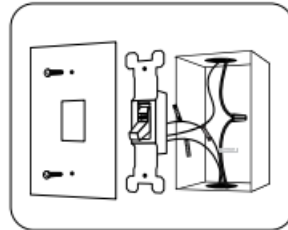
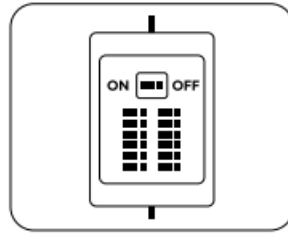

- **STEP 4 FIT WIRES INTO WALL BOX**

Neatly push the wires back into the box, rotating the switch so it's oriented according to the image.

- **STEP 5 SECURE THE SWITCH**

Using a phillips screwdriver and the screws provided, secure the switch to the wall until level and flush.

Screw on the wall plate (not included).

The paddle switch fits standard paddle-style wall plates.

The toggle switch fits standard toggle-style wall plates.

- **STEP 6 TURN THE POWER BACK ON**

- After the switch is secured and faceplate mounted, turn the power back on at the circuit breaker box.
- At the switch, the light ring indicator will flash blue indicating the device is wired correctly and is in setup mode.

Light ring will flash blue until the switch is added to the Cync App.

Light ring will flash red when Wi-Fi is disconnected.

Light ring will not illuminate if wired incorrectly.

- **IF LIGHTS DON'T TURN ON:**

- Check that power to the switch is on at the breaker.
- Turn power off at the breaker, return to the switch to confirm the wires are securely and properly wired according to the installation guide.
- Go to cyncsupport.gelighting.com for more troubleshooting

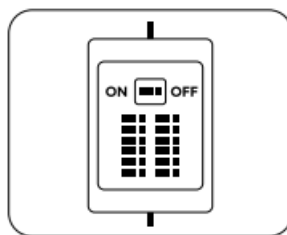
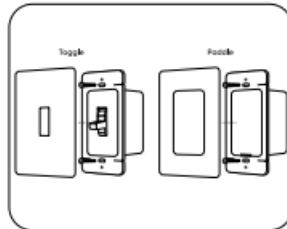
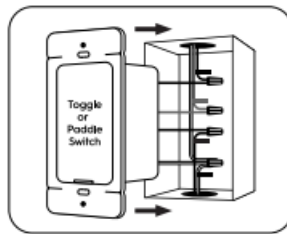

Congratulations!

You've completed the Smart Switch installation.
Next ...

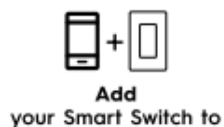

Enable Your Voice Assistant

Easily conned your Smart Switch to your Amazon Alexa- or Hey Google-enabled device In the Cync App

AMAZON ALEXA

TRY THIS ...

Alexa, turn off the llvIng room.
Alexa, turn on the bedroom.

HEY GOOGLE

TRY THIS. ..

Hey Google, turn on the lights.
Hey Google, good morning.
Hey Google, I'm leaving.

For set up help, visit cyncsupport.gellghting.com or call 1-Blili-302-2943

Additional Information and Warnings

FCC Compliance Statement Compliance Notice,

This equipment has been tested and found to comply with the limits for a Class B digital device, pursuant to part 15 of the FCC Rules. These limits are designed to provide reasonable protection against harmful interference in a residential installation. This equipment generates, uses and can radiate radio frequency energy and, if not installed and used in accordance with the instructions, may cause harmful interference to radio communications. However, there is no guarantee that interference will not occur in a particular installation. If this equipment does cause harmful interference to radio or television reception, which can be determined by turning the equipment off and on, the user is encouraged to try to correct the interference by one or more of the following measures,

- Reorient or relocate the receiving antenna.
- Increase the separation between the equipment and receiver.
- Connect the equipment into an outlet on a circuit different from that to which the receiver is connected.
- Consult the dealer or an experienced radio/TV technician for help.

This device complies with part 15 of FCC rules. Operation is subject to the following two conditions,

1. This device may not cause harmful interference.
2. This device must accept any interference received, including interference that may cause undesired operation.

Changes or modifications that are not expressly approved by the manufacturer could void the user's authority to operate the equipment.

RF Exposure Information

This equipment complies with FCC radiation exposure limits set forth for an uncontrolled environment. In order to avoid the possibility of exceeding the FCC radio frequency exposure limits, human proximity to the antenna shall not be less than 8 inches during normal operation.

RF Exposure Statement

This equipment complies with IC RSS-102 radiation exposure limits set forth for an uncontrolled environment. This transmitter must be installed to provide a separation distance of at least 8 inches from all persons and must not be collocated or operating in conjunction with any other antenna or transmitter.

For supply connections, use copper wire only rated at 75C.

A CAUTION – High Voltage – Disconnect power supply before servicing Operation temperature: 0-100°C

For Control of Electronic Ballast, CFLs, LED, and LED Lamps.

Type 1 Enclosure

IP20

Pollution Degree 2

Impulse Voltage: 2500V

Type 1.B action

Indoor use only.

FOR SET UP HELP, VISIT [CYNCSUPPORT.GELIGHTING.COM](https://cyncsupport.gelighting.com) OR CALL 1-844-302-2943.

GE Lighting, a Savant company • 1-844-302-2943 • gelighting.com/cync

GE AND C BY GE ARE TRADEMARKS OF GENERAL ELECTRIC COMPANY, USED UNDER TRADEMARK LICENSE ©2022 GE LIGHTING, A SAVANT COMPANY INFORMATION PROVIDED IS SUBJECT TO CHANGE WITHOUT NOTICE. ALL VALUES ARE DESIGN OR TYPICAL VALUES WHEN MEASURED UNDER

Documents / Resources

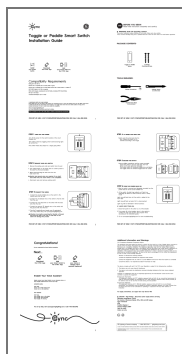

[GE 93130501 Toggle or Paddle Smart Switch](#) [pdf] Instruction Manual

93130501 Toggle or paddle Smart Switch, 93130501, Toggle or paddle Smart Switch, paddle Smart Switch, Smart Switch