



FS NLR-S018 Next Level Racing Instruction Manual

[Home](#) » [FS](#) » FS NLR-S018 Next Level Racing Instruction Manual 

Contents

- [1 FS NLR-S018 Next Level Racing](#)
- [2 PRE-FLIGHT CHECKS](#)
- [3 IN THE BOX](#)
- [4 ADJUSTMENT POINTS](#)
- [5 ASSISTANCE](#)
- [6 Documents / Resources](#)
 - [6.1 References](#)
- [7 Related Posts](#)



FS NLR-S018 Next Level Racing



PRE-FLIGHT CHECKS

WARNING

- Please do not use power tools for assembly as over tightening can damage your frame.
- Lay out and build the cockpit on a level surface.
- Do not force parts together.
- Avoid cross threading bolts.
- If in doubt consult the installation video.

If you require any support with your product please contact our friendly team at: support@nextlevelracing.com

IN THE BOX

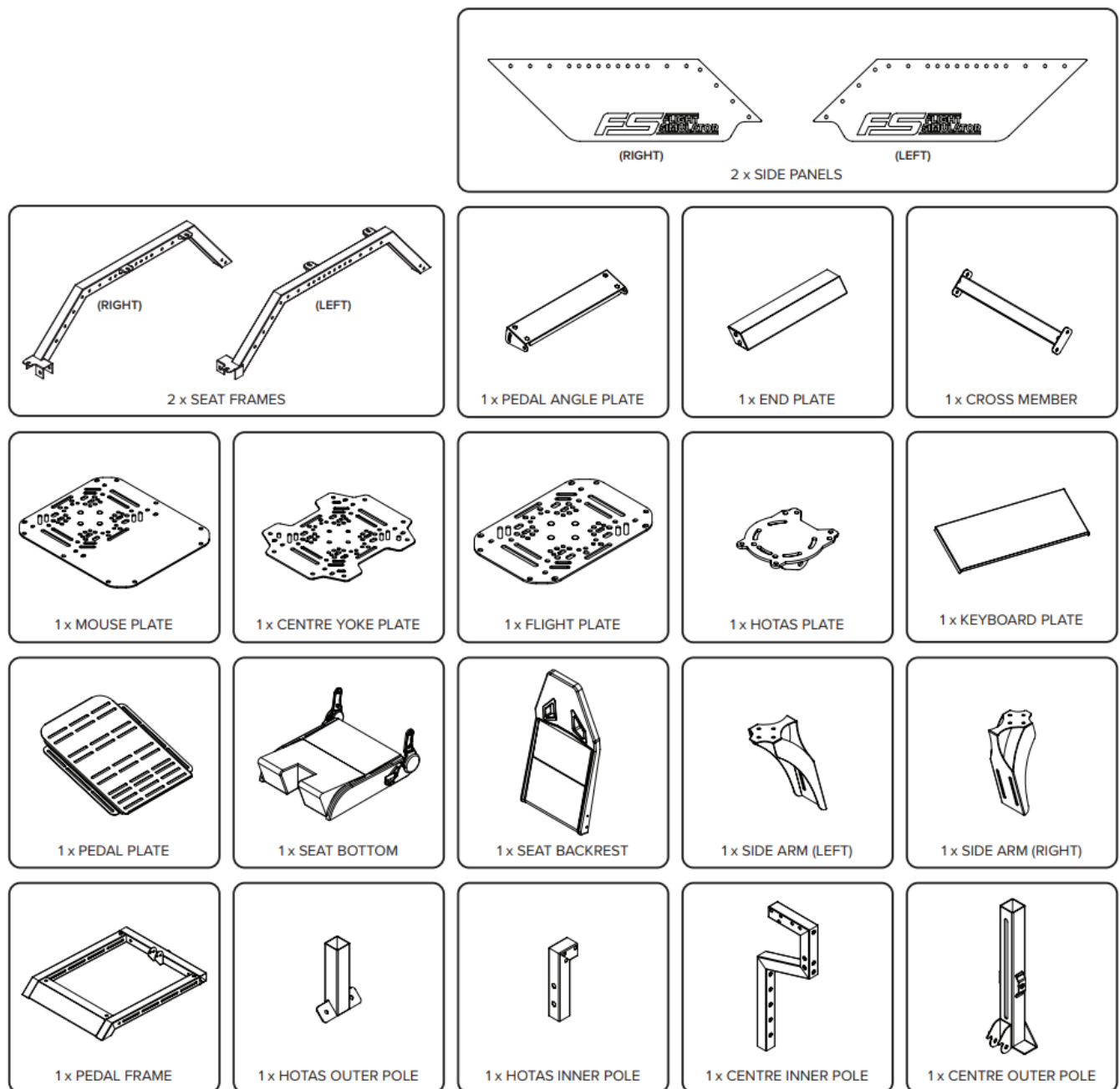

NOTE: Some Items Come with Rust Resistant Coating

NOTE: Some Items Come with Rust Resistant Coating

 <p>14 x M4 16mm BOLTS 26 x M6 16mm BOLTS 14 x M8 16mm BOLTS</p>	 <p>40 x M8 55mm BOLTS</p>	 <p>8 x M5 60mm BOLTS</p>	 <p>14 x M4 FLANGE NUTS 8 x M5 FLANGE NUTS 34 x M6 FLANGE NUTS 40 x M8 FLANGE NUTS</p>	 <p>14 x M4 WASHERS 8 x M5 WASHERS 26 x M6 WASHERS 55 x M8 WASHERS</p>
 <p>4 x 20mm KNOBS</p>	 <p>1 x M8 70mm BOLT</p>	 <p>6 x SQUARE WASHERS</p>	 <p>10x M6 20mm THREADED STUDS</p>	 <p>1 x 13mm WRENCH (M8)</p>
 <p>4 x ALLEN KEYS</p>	 <p>1 x M4/M6 WRENCH 1 x M5/M6 WRENCH</p>	 <p>6 x ADJUSTABLE FEET</p>	 <p>1 x BUTTKICKER POLE</p>	 <p>1 x SEATBELT</p>
 <p>1 x STRAIGHT SIDE ARM</p>	 <p>1 x TURTLE BEACH ADAPTOR</p>	 <p>6 x VELCRO CABLE TIES</p>	 <p>1 x LUMBAR CUSHION</p>	 <p>2 x TPR ADAPTORS</p>
 <p>2 x FELT PADS (30mm x 120mm)</p>	 <p>1 x SUPPORT BRACKET</p>	 <p>1 x SUPPORT BRACKET MOUNT</p>	 <p>1 x 40mm BARREL SPACER</p>	 <p>1 x CLAMP PLATE</p>
 <p>1 x KEYBOARD ARM</p>	 <p>10 x M8 16mm WASHERS</p>	 <p>1 x KEYBOARD MAT</p>	 <p>1 x MOUSE MAT</p>	

ADJUSTMENT POINTS



The Flight Simulator is a fully adjustable cockpit making it perfect for flight enthusiasts of all sizes. Utilize the various adjustment points to achieve the most comfortable position.

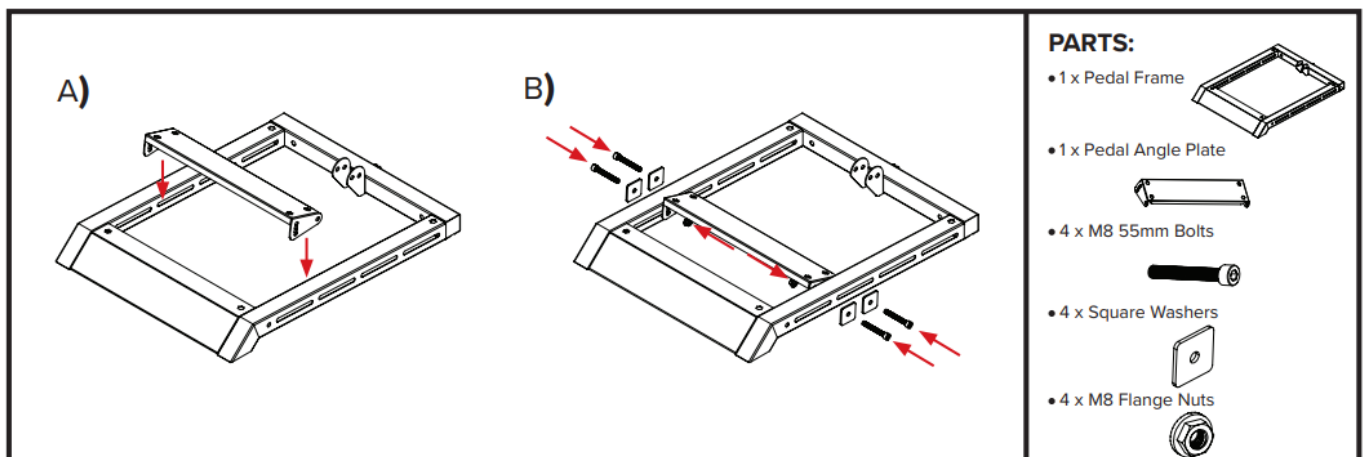

1. **A)** Align the mounting holes on the Pedal Angle Plate with the slots on the Pedal Frame.
B) Bolt through and secure with 4 x M8 Bolts, Square Washers and Flange Nuts.

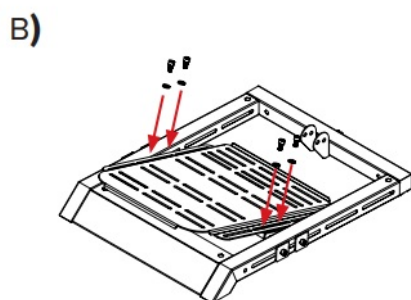
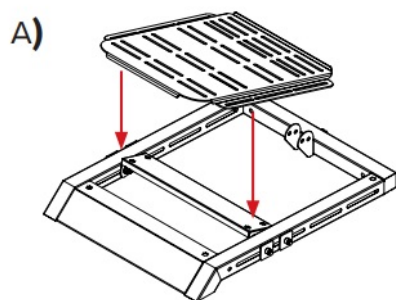

PARTS:

• 1 x Pedal Plate



• 4 x M8 16mm Bolts



• 4 x M8 Washers



2. **A)** Align the mounting slots on the Pedal Plate with the threaded inserts on the Pedal Angle Plate.

B) Bolt through and secure with 4 x M8 Bolts and Washers.

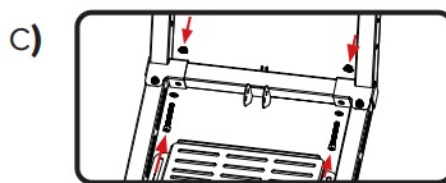
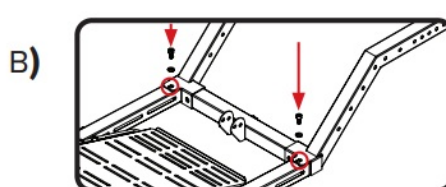
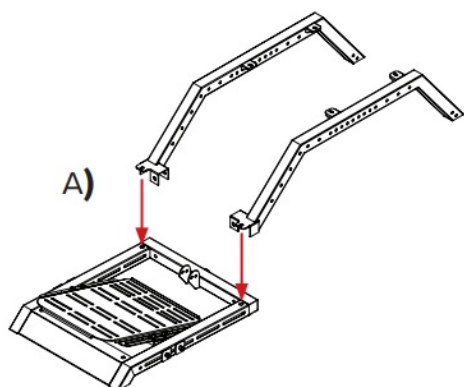

PARTS:

• 2 x Seat Frames



• 2 x M8 55mm Bolts



• 2 x M8 16mm Bolts



• 4 x M8 Washers



• 2 x M8 Flange Nuts



3. **A)** Align the mounting holes on the Seat Frames with the mounting holes and threaded inserts on the Pedal Frame.

B) On the top of the frame, bolt through and secure the Seat Frames with 2 x M8 16mm Bolts and Washers.

C) Bolt through the centre of the frame and secure with 2 x M8 55mm Bolts, Washers and Flange Nuts

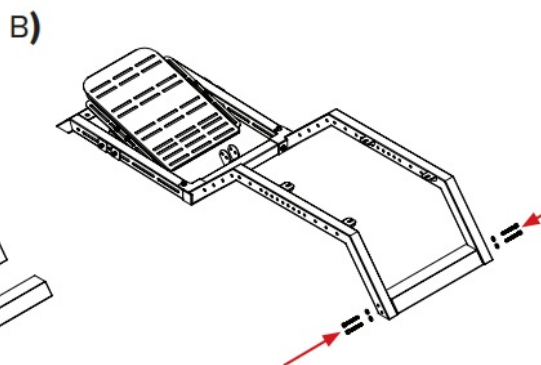
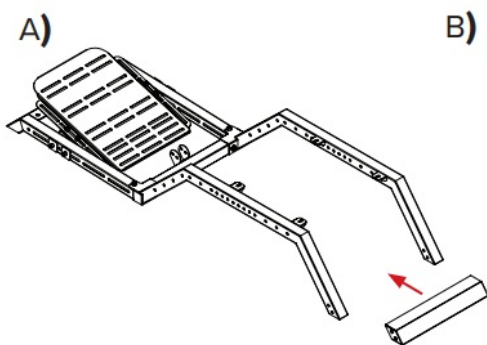

PARTS:

• 1 x End Plate

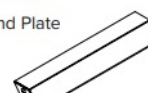

• 4 x M8 55mm Bolts



• 4 x M8 Washers



4. Align the threaded inserts on the End Plate with the mounting holes on the Left and Right Seat Frames. Bolt through and secure with 4 x M8 Bolts and Washers.

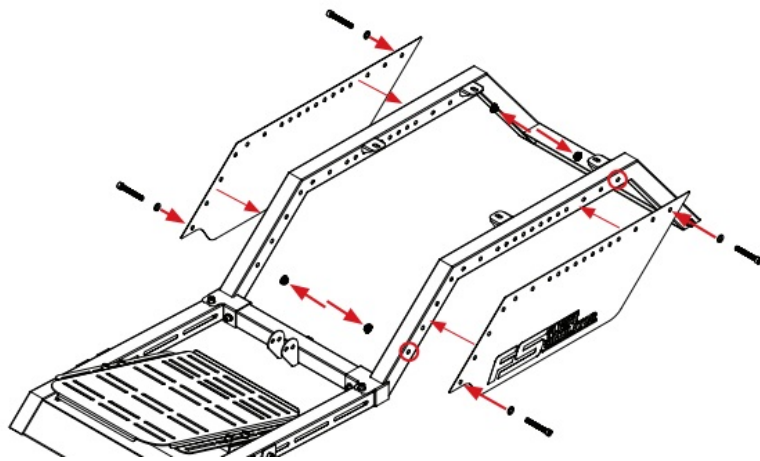

PARTS:

- 2 x Side Panels



- 4 x M8 55mm Bolts



- 4 x M8 Washers



- 4 x M8 Flange Nuts



5. Align the mounting holes on the Side Panels with the through holes on the Seat Frames. Bolt through and secure with 4 x M8 Bolts, Washers and Flange Nuts.

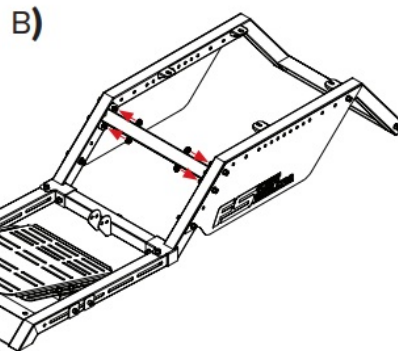
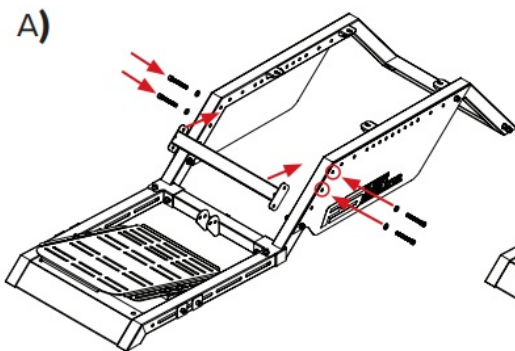

PARTS:

- 1 x Cross Member



- 4 x M8 55mm Bolts



- 4 x M8 Washers



- 4 x M8 Flange Nuts



6. **A)** Align the mounting holes on the Cross Member with the through holes on the Left and Right Seat Frames and Side Panels.

- B)** Bolt through and secure with 4 x M8 Bolts, Washers and Flange Nuts.

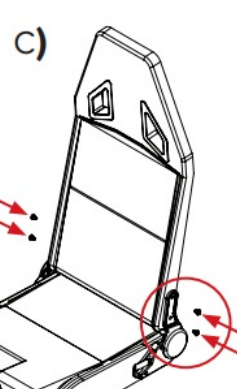
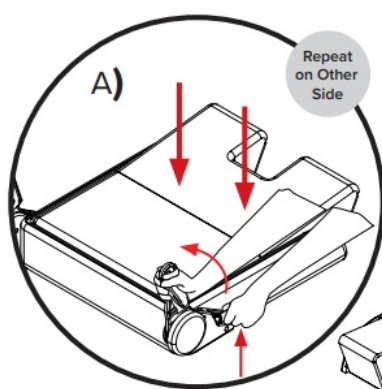

PARTS:

- 1 x Seat Backrest



- 1 x Seat Bottom



7. **A)** Apply pressure to the seat base with body-weight. Pull up the recliner handle with one hand and adjust so that the recliner is perpendicular with the Seat Bottom. Repeat on other side (It is recommended to use a cloth/cardboard in palm to prevent injury to hands).

- B)** Uninstall 4 x Dome Head Bolts which are pre-installed on the Seat Backrest and align the threaded inserts on the Seat Backrest with the mounting holes on the Seat Bottom.

- C)** Bolt through and secure with 4 x M8 Dome Head Bolts which were previously uninstalled. Remove the warning labels on the recliners

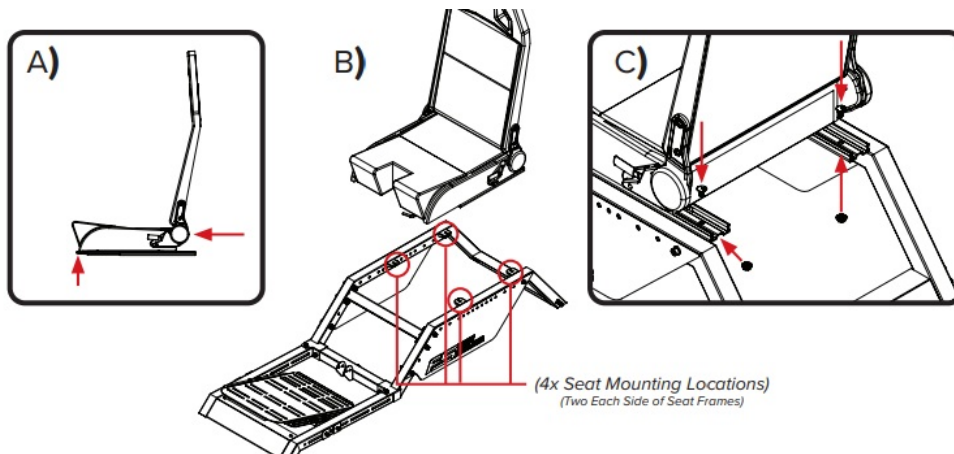

PARTS:

- 2 x M8 16mm Square Neck Bolts



- 2 x M8 Flange Nuts



8. **A)** Pull the Seat Slider handle up and adjust the Seat to the forward-most position.

B) Align the mounting holes on the Seat Sliders with the seat mounting locations (Refer to image) on the Left and Right Seat Frames.

C) At the rear, bolt through and secure with 2 x M8 Square Neck Bolts and Flange Nuts

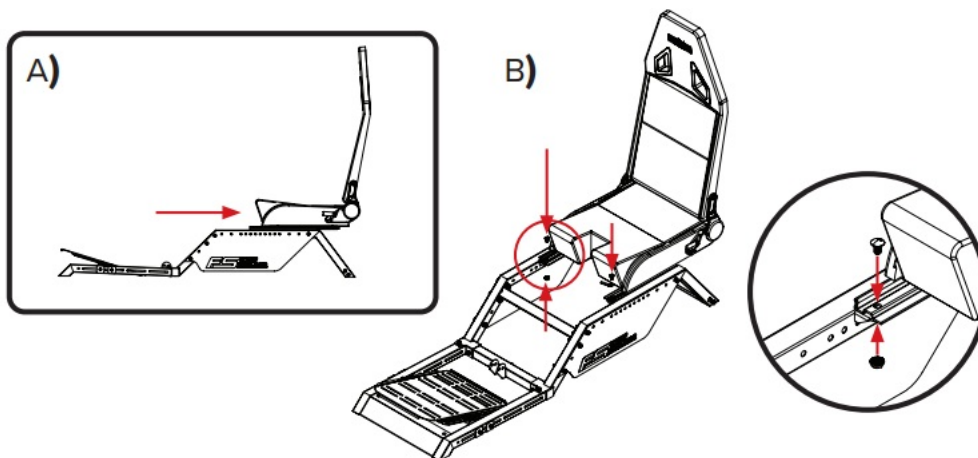

PARTS:

- 2 x M8 16mm Square Neck Bolts



- 2 x M8 Flange Nuts



9. **A)** Pull the Seat Slider handle and adjust the Seat to the rear-most position.

B) At the front, bolt through and secure with 2 x M8 Square Neck Bolts and Flange Nuts

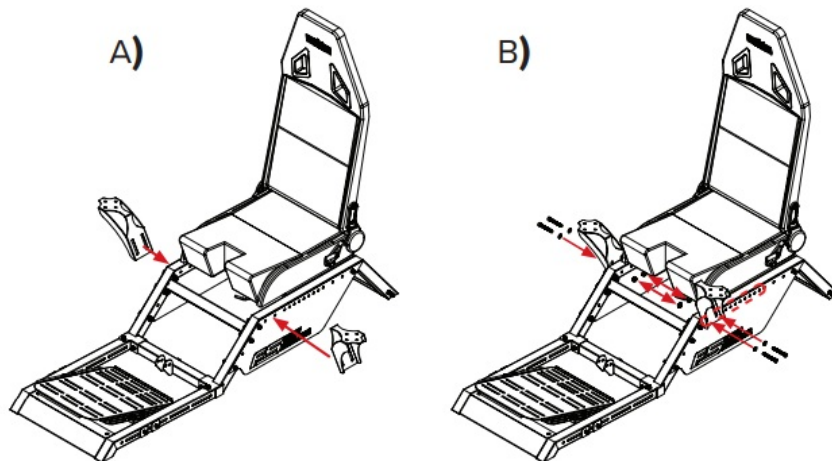

PARTS:

- 2 x Side Arms

L)

R)



- 4 x M8 55mm Bolts



- 4 x M8 Washers



- 4 x M8 Flange Nuts



10. **A)** Align the mounting slots on the Left and Right Side Arms with the through holes on the Left and Right Seat Frames and Side Panels.

B) Bolt through and secure with 4 x M8 Bolts, Washers and Flange Nuts.

SIDE ARM ADJUSTMENT

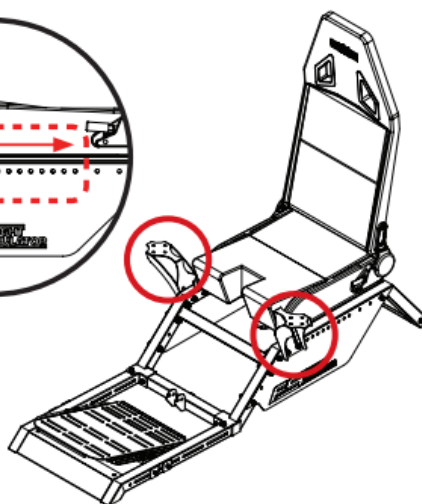
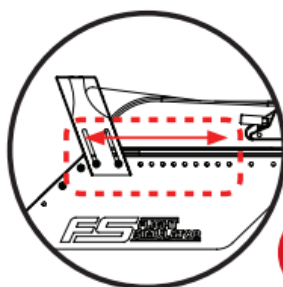
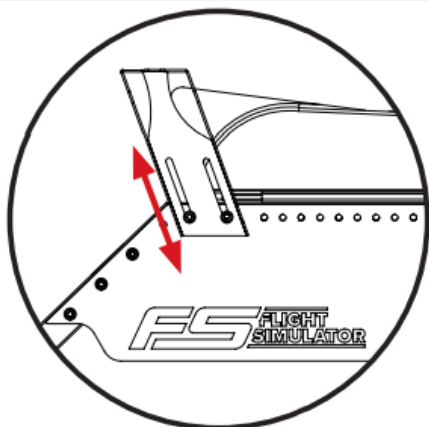

PARTS:

- NIL

11. Loosen the Bolts to adjust the Side Arms to the desired height and angle. Tighten the Bolts to lock in place. Utilize the extra through holes on the Seat Frames for back and forward adjustment.

NOTE: The plates are interchangeable and can be mounted to accommodate for left or right-handed users.

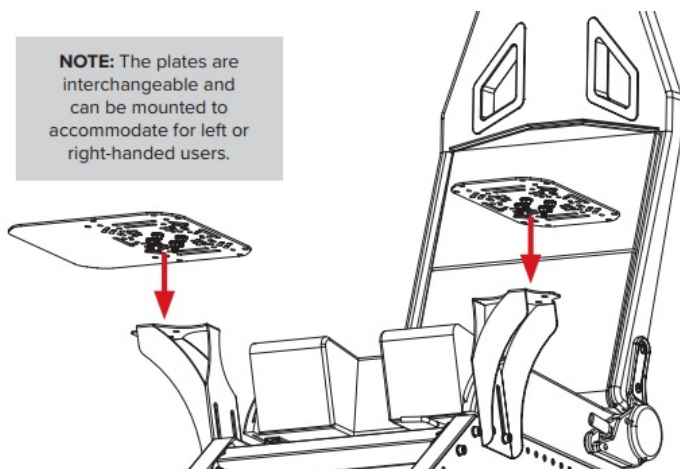

PARTS:

- 1 x Mouse Plate



- 1 x Flight Plate

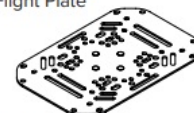

- 8 x M8 Flange Nuts



12. Align the Threaded Studs on the Mouse Plate and Flight Plate with the mounting holes on the Left and Right Side Arms. Secure with 8 x M8 Flange Nuts.

OPTIONAL HOTAS INSTALL

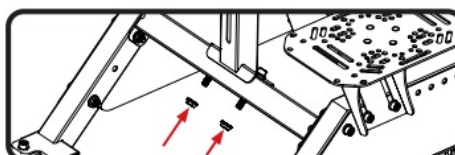
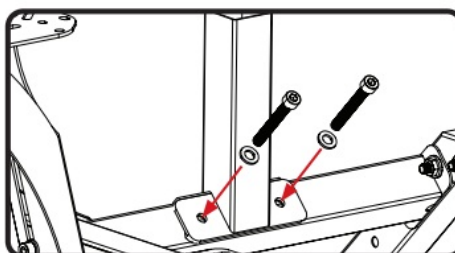
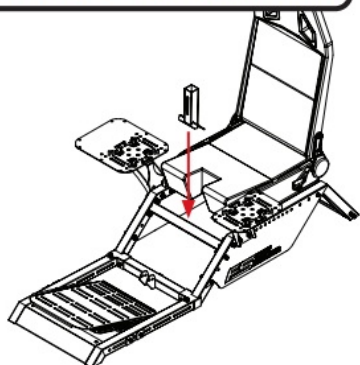

PARTS:

- 1 x HOTAS Outer Pole



- 2 x M8 55mm Bolts



- 2 x M8 Washers



- 2 x M8 Flange Nuts



13. Align the mounting holes on the HOTAS Outer Pole with the through holes on the Cross Member. Bolt through and secure with 2 x M8 Bolts, Washers and Flange Nuts.

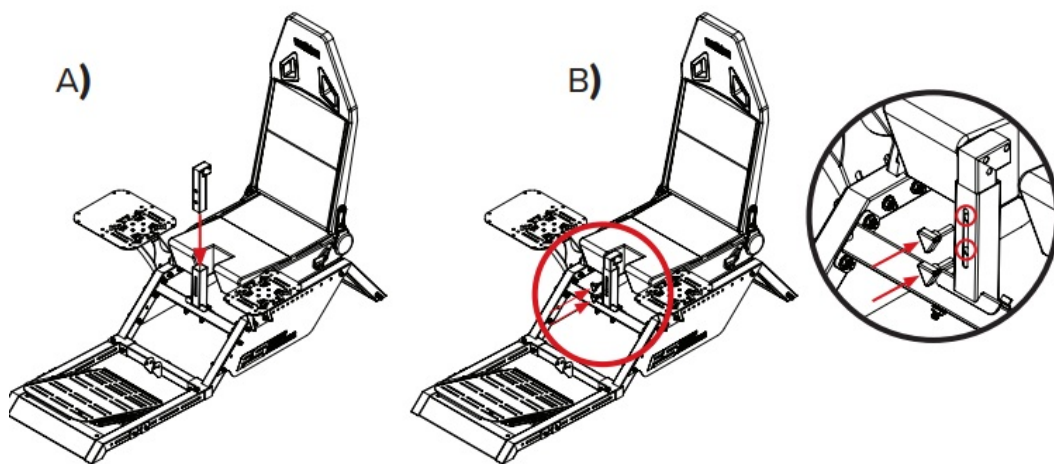

PARTS:

- 1 x HOTAS Inner Pole



- 2 x 20mm Knobs



14. Align the threaded inserts on the HOTAS Inner Pole with the slot on the HOTAS Outer pole. Bolt through and secure with 2 x Knobs.

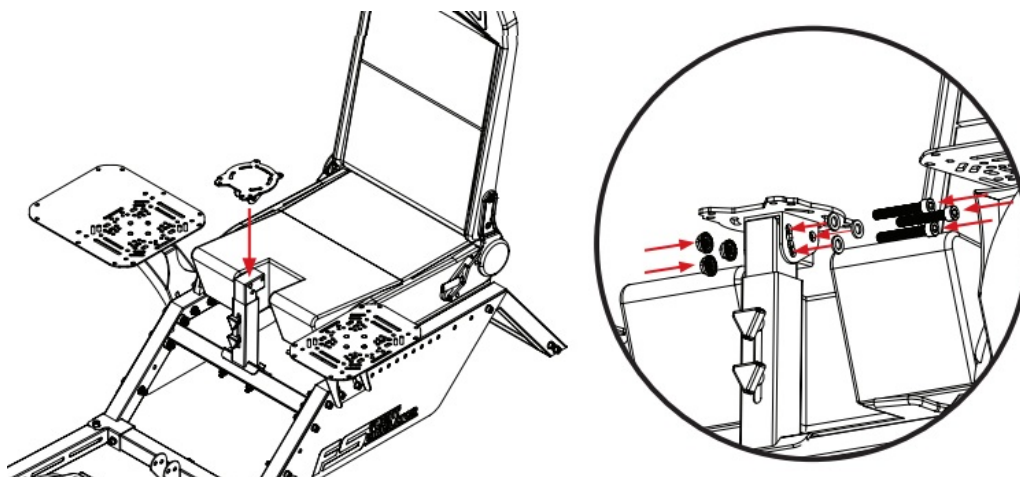

PARTS:

- 1 x HOTAS Plate



- 3 x M8 55mm Bolts



- 3 x M8 16mm Washers



- 3 x M8 Flange Nuts



15. Align the mounting holes on the HOTAS Plate with the through holes on the HOTAS Inner Pole. Bolt through and secure with 3 x M8 Bolts, Washers and Flange Nuts.

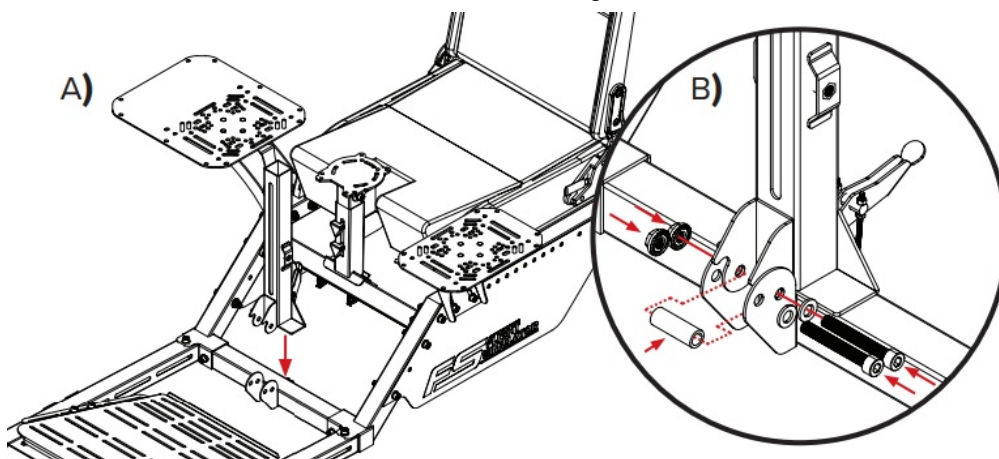

PARTS:

- 1 x Centre Outer Pole



- 2 x M8 55mm Bolts



- 2 x M8 Washers



- 2 x M8 Flange Nuts



- 1 x Barrel Spacer



16. **A)** Align the mounting holes on the Centre Outer Pole with the holes on the Pedal Frame.
B) Align the Barrel Spacer with the holes on the Centre Outer Pole. Bolt through and secure with 2 x M8 Bolts, Washers and Flange Nuts.

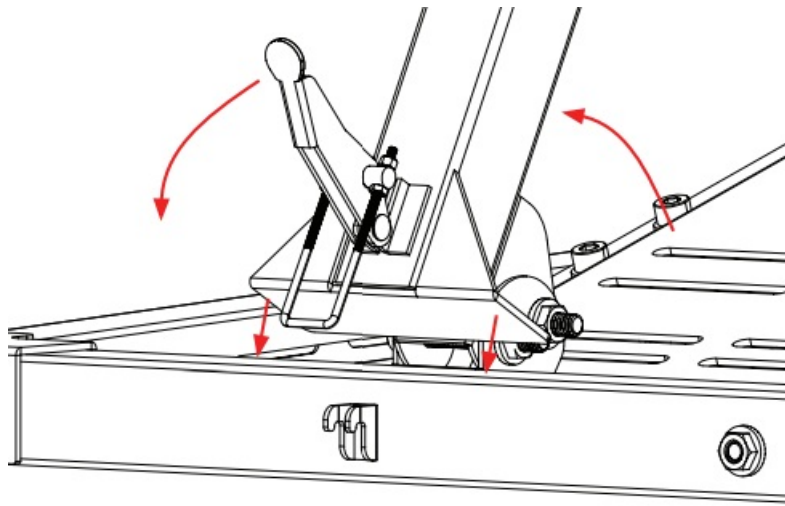

17. **a.** Gently place the Center Pole on top of the Pedal Frame and make sure the latch is down.

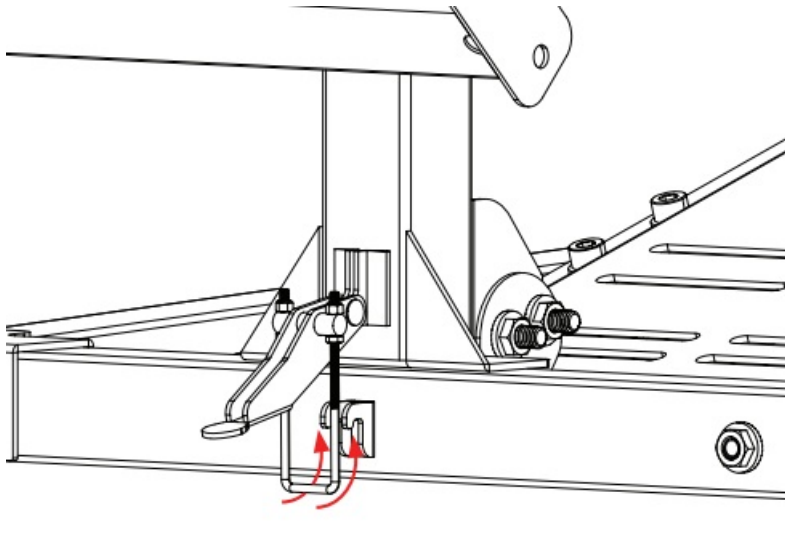

1. **b.** Hook the U-Bolt into the locking tab on the Pedal Frame.

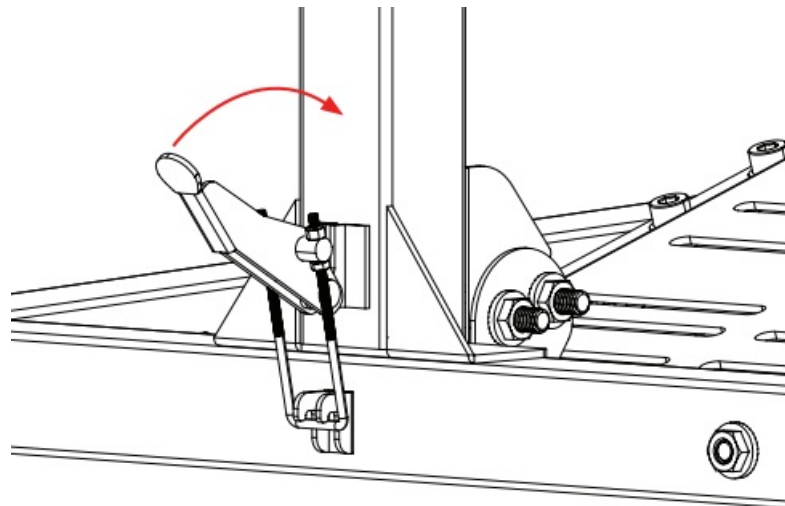

2. **c.** Make sure the U bolt is sitting properly in the locking tab and pull the latch until its tight.

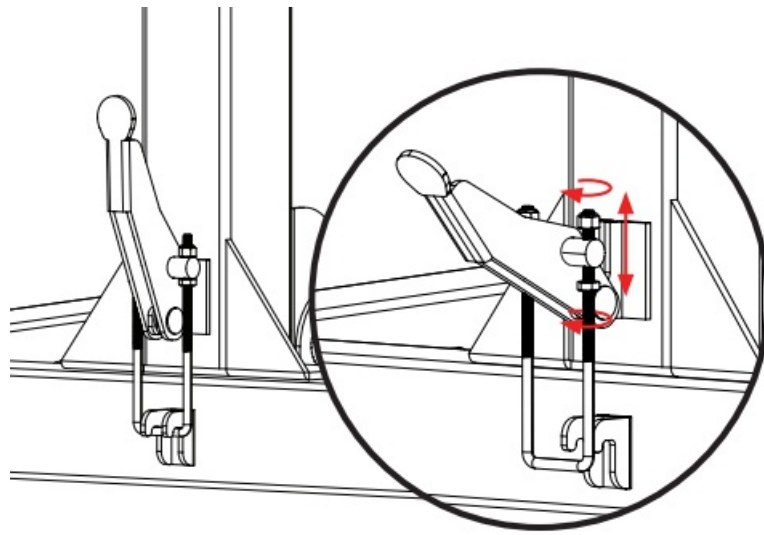

3. **d.** For a tighter lock, undo the latch, adjust the nuts at the top of the latch and close it back again

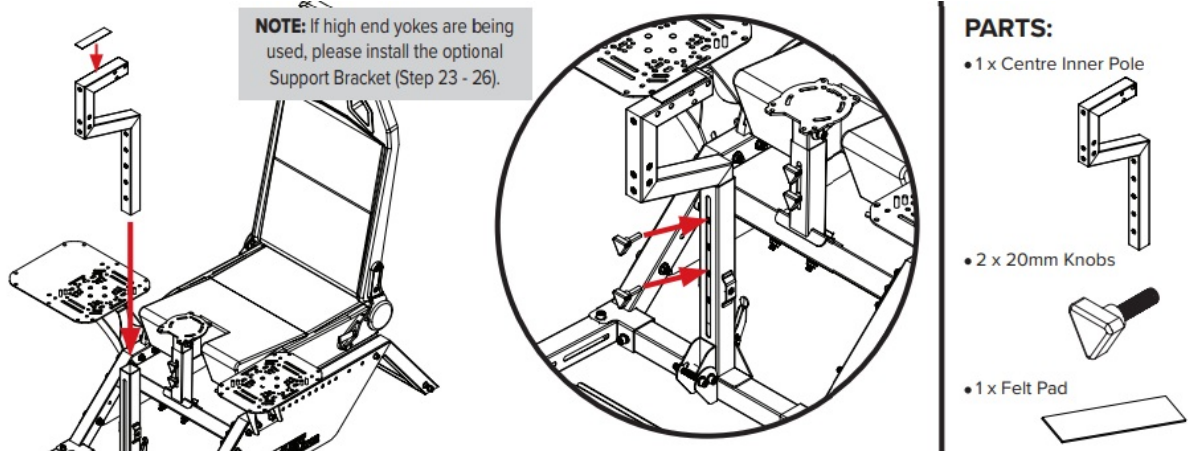

18. Install 1 x Felt Pad onto the top of the Centre Inner Pole. Align the threaded inserts on the Centre Inner Pole with the slots on the Centre Outer Pole. Bolt through and secure with 2 x Knobs.

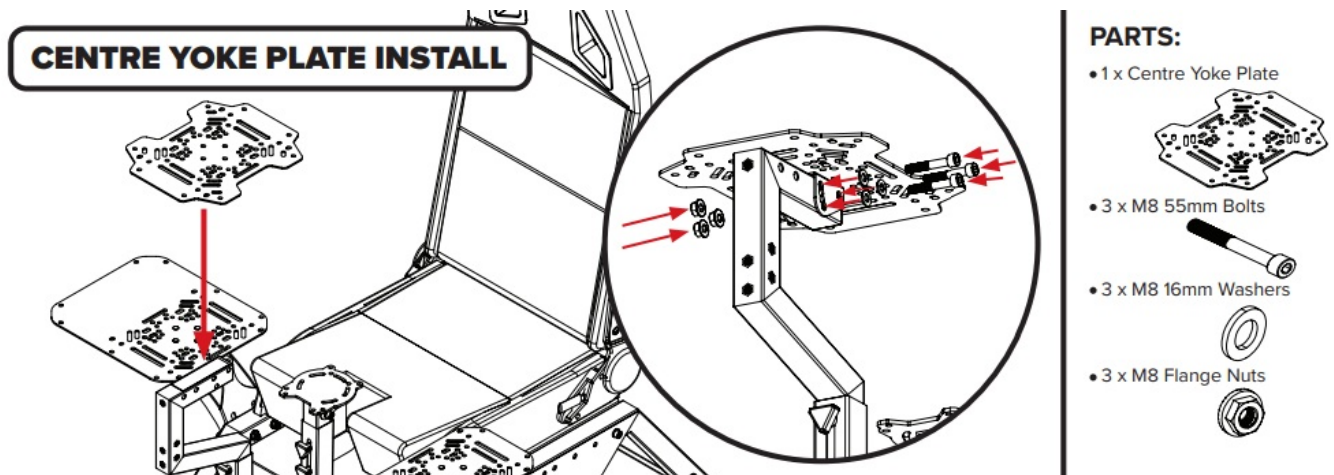

19. Align the mounting holes on the Centre Yoke Plate with the through holes on the Centre Inner Pole. Bolt through and secure with 3 x M8 55mm Bolts, Washers and Flange Nuts

OPTIONAL TURTLE BEACH ADAPTOR INSTALL

(Continue from Step 19a)

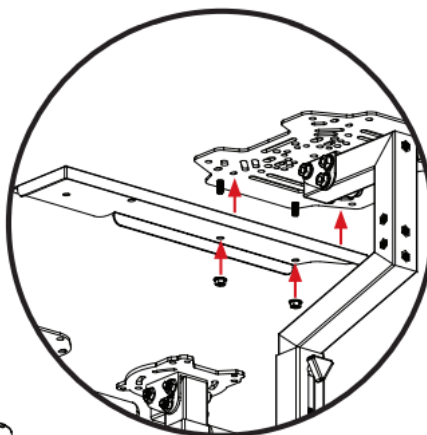
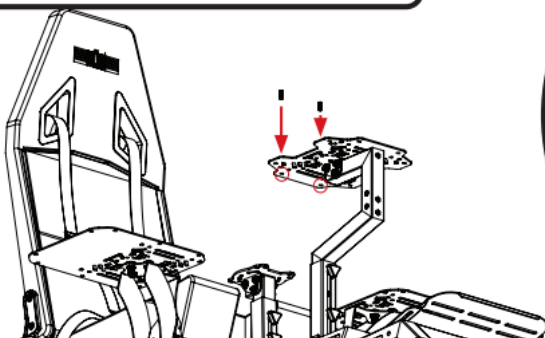

PARTS:

- 1 x Turtle Beach Adaptor Plate



- 2 x M6 20mm Press Fit Studs



- 2 x M6 Flange Nuts



- A)** Insert the 2 x M6 Studs into the rear-most holes on the Centre Yoke Plate.

B) Align the mounting holes on the Turtle Beach Adaptor Plate with the threaded studs, secure with 2 x M6 Flange Nuts.

BOEING YOKE/CLAMP PLATE INSTALL

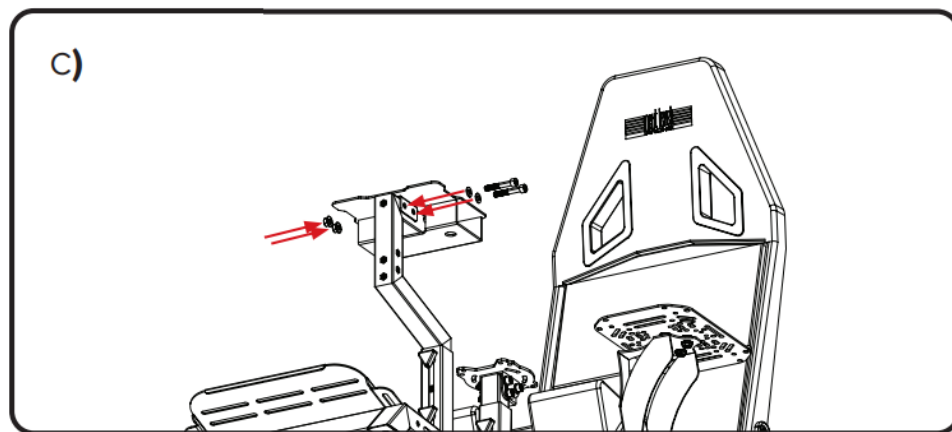
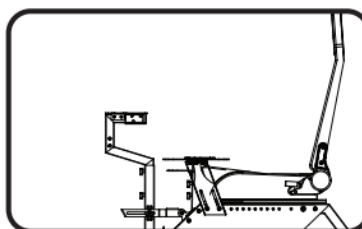
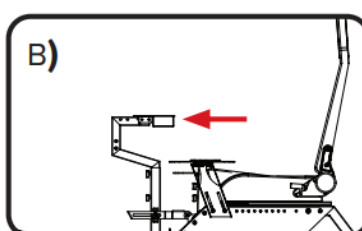
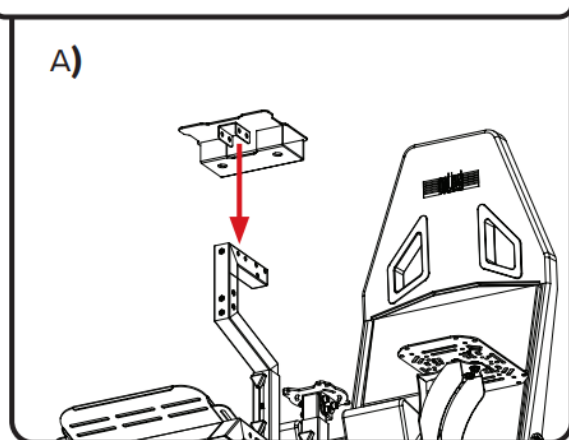

PARTS:

- 1 x Clamp Plate



- 2 x M8 55mm Bolts



- 2 x M8 Washers



- 2 x M8 Flange Nuts



- A)** Place the Clamp Plate on top of the Centre Inner Pole.

B) Slide the Clamp Plate forward and align the mounting holes on the Centre Inner Pole and Clamp Plate.

C) Bolt through and secure with 2 x M8 Bolts, Washers and Flange Nuts.

CENTRE KEYBOARD PLATE INSTALL

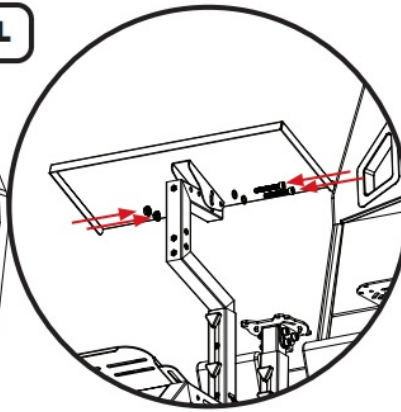
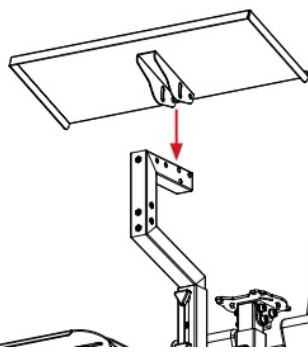

PARTS:

- 1 x Keyboard Plate



- 2 x M8 55mm Bolts



- 2 x M8 Washers



- 2 x M8 Flange Nuts



3. Align the mounting holes and slots on the Keyboard Plate with the through holes on the Centre Inner 19b Pole. Bolt through and secure with 2 x M8 Bolts, Washers and Flange Nuts.

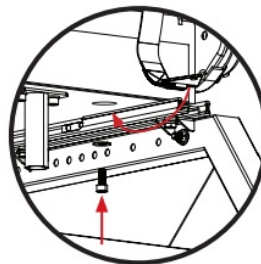
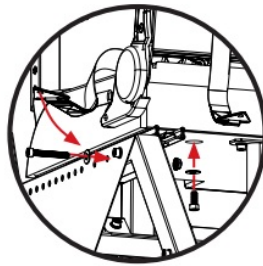
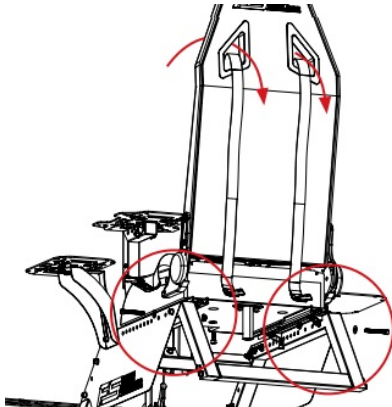

PARTS:

- 1 x Seatbelt



- 2 x M8 20mm Bolts



- 2 x M8 55mm Bolts



- 4 x M8 Washers



- 2 x M8 Flange Nuts



20. Thread the Seatbelt through the eyelets in the Seat Backrest. Align the mounting holes on each Seatbelt mounting plate with the through holes on the Seat Frames and the threaded inserts on the underside of the Seat Bottom. Bolt through and secure with 4 x M8 Bolts, Washers and 2 x M8 Flange Nuts.

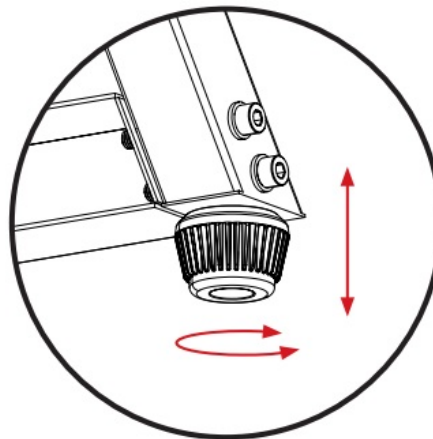
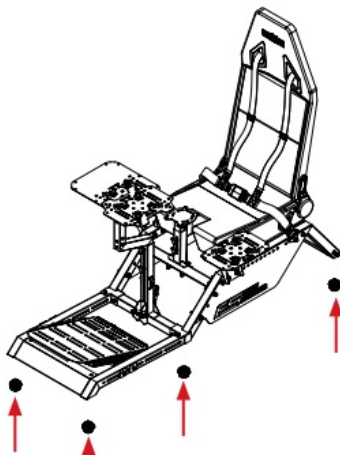

PARTS:

- 6 x Adjustable Feet



21. Align the Adjustable Feet with the threaded inserts on the bottom of the Pedal Frame and Seat Frames. Lock into place by twisting the Adjustable feet into the threaded inserts. To raise an Adjustable Foot, twist anti-clockwise.

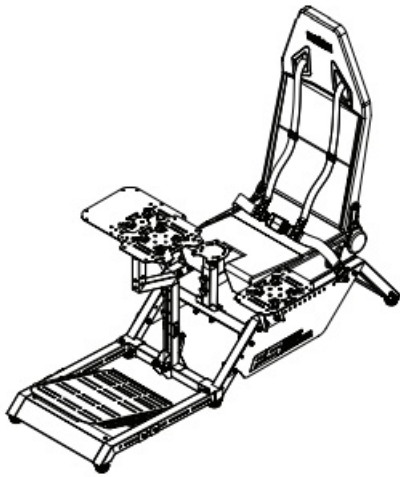

PARTS:

- NIL

22. Your Flight Simulator cockpit is complete.

OPTIONAL SUPPORT BRACKET INSTALL

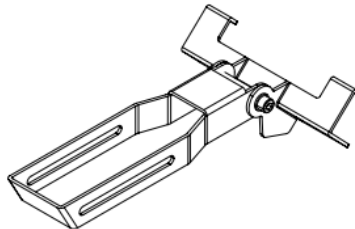
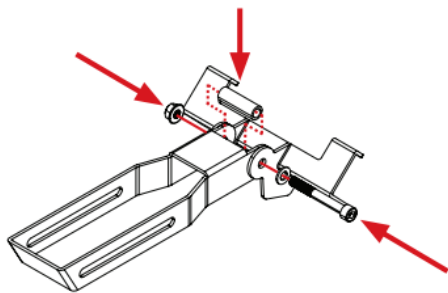

PARTS:

- 1 x Support Bracket
- 1 x Support Bracket Mount
- 1 x M8 70mm Bolt
- 1 x Barrel Spacer
- 1 x M8 Washer
- 1 x M8 Flange Nut

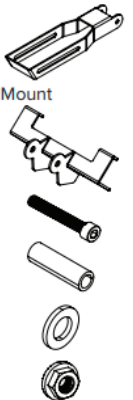

23. Align the pivot point on the Support Bracket with the mounting holes on the Support Bracket Mount. Bolt through and secure with 1 x M8 Bolt, Washer, Barrel Spacer and Flange Nut.

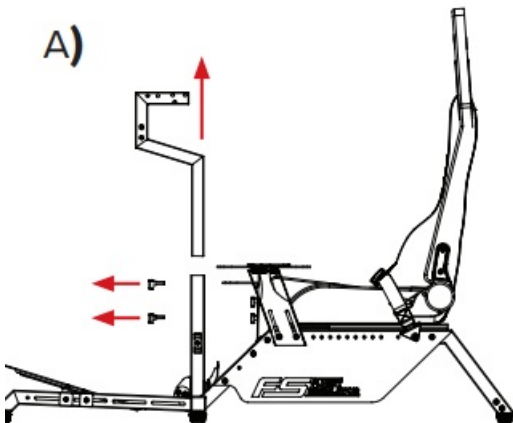

B)

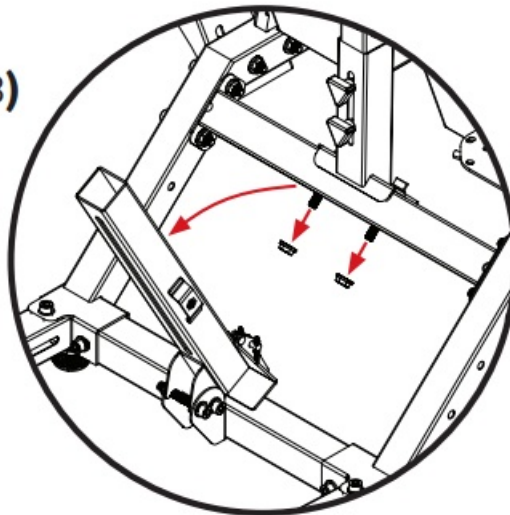

PARTS:

- NIL

24. **A)** Uninstall the Knobs securing the Centre Inner Pole to the Centre Outer Pole and remove the Centre Outer Pole.

B) Uninstall the 2 x M8 Flange Nuts securing the HOTAS Outer Pole to the Cross Member

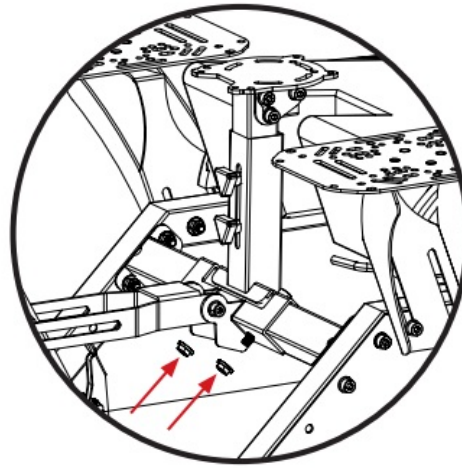
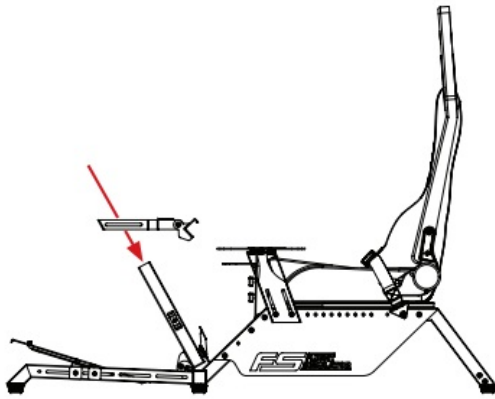

PARTS:

- 2 x M8 Flange Nuts



25. Align the mounting holes on the Support Bracket with the through holes on the Cross Member. Secure with 2 x M8 Flange Nuts previously uninstalled in Step 24.

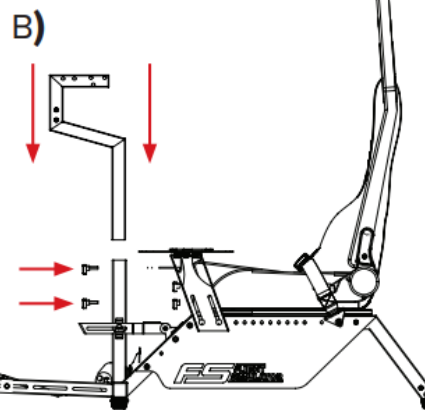
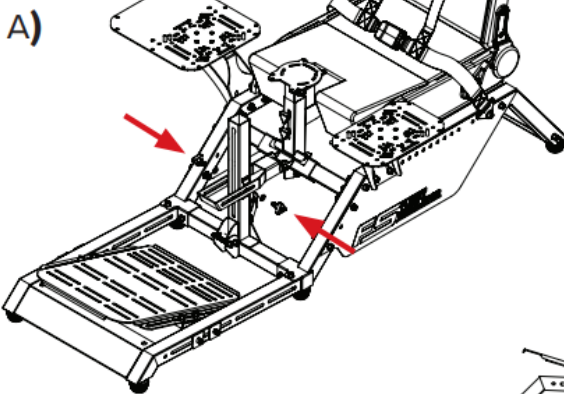

PARTS:

- 1 x Centre Inner Pole

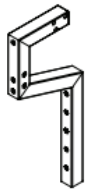

- 4 x 12mm Knobs



26. **A)** Align the threaded inserts on the Centre Outer Pole with the slots on the Support Bracket. Bolt through with 2 x Knobs.

B) Fit the Centre Inner Pole into the Centre Outer Pole. Align the threaded inserts on the Centre Inner Pole with the slot in the Centre Outer Pole. Bolt through and secure with 2 x Knobs previously uninstalled in Step 24.

OPTIONAL KEYBOARD PLATE SIDE MOUNT

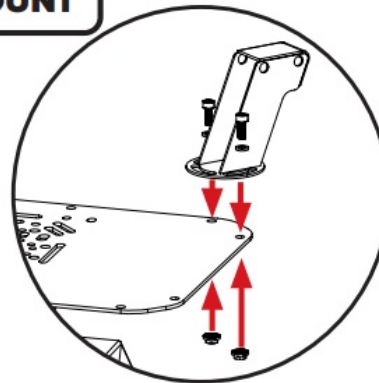
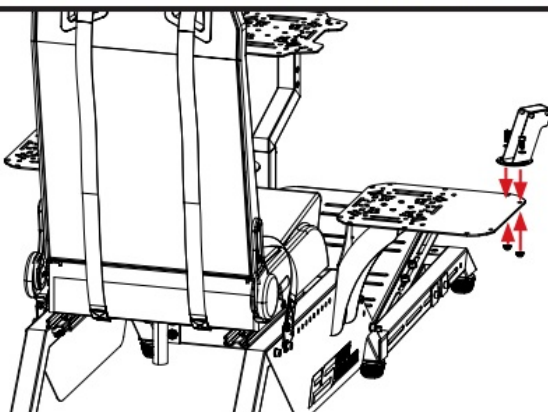

PARTS:

- 1 x Keyboard Arm



- 2 x M6 16mm Bolts



- 2 x M6 Washers



- 2 x M6 Flange Nuts



27. Align the mounting slots on the Keyboard Arm with the holes on the Mouse Plate. Bolt through and secure with 2 x M6 Bolts, Washers and Flange Nuts.

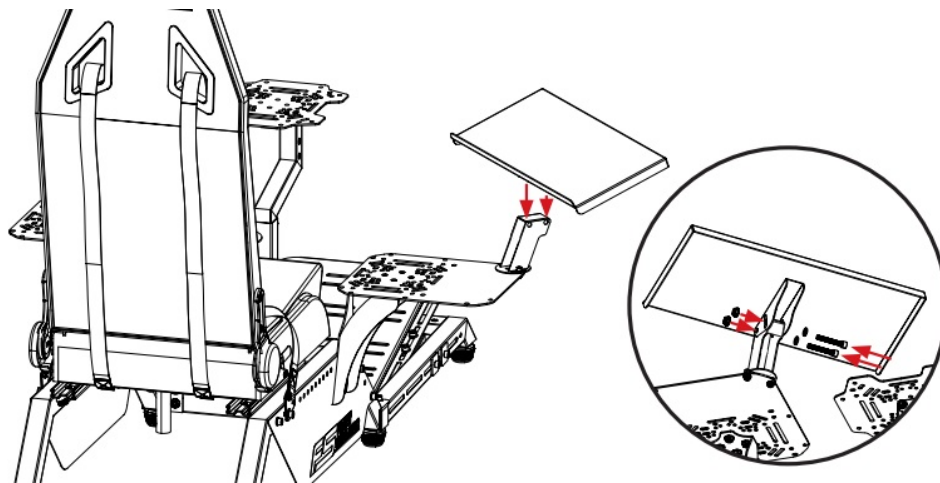

PARTS:

- 1 x Keyboard Plate
- 2 x M8 55mm Bolts
- 2 x M8 Washers
- 2 x M8 Flange Nuts

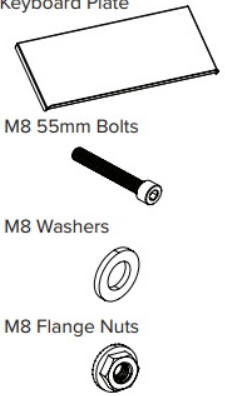

28. Align the mounting holes on the Keyboard Plate with the through holes on the Keyboard Arm. Bolt through and secure with 2 x M8 Bolts, Washers and Flange Nuts.

OPTIONAL STRAIGHT SIDE ARM

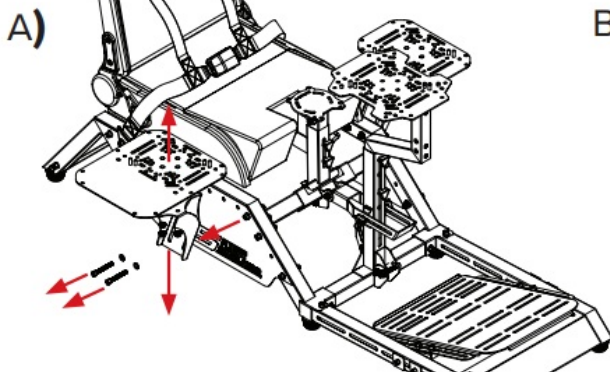

B)

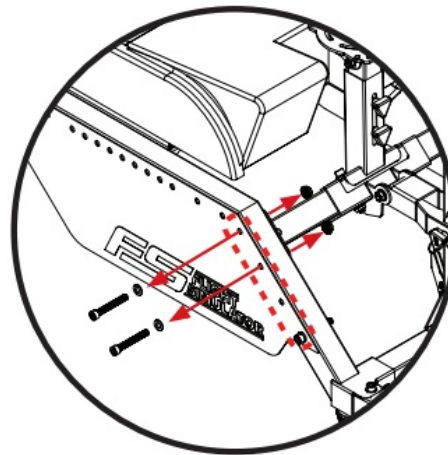

PARTS:

- NIL

29. **A)** Uninstall 2 x M8 Bolts, Washers and Flange Nuts securing the Side Arm. Detach the Flight Plate from the Side Arm.

B) Uninstall 2 x M8 Bolts, Washers and Flange Nuts securing one side of the Cross Member to the Seat Frame

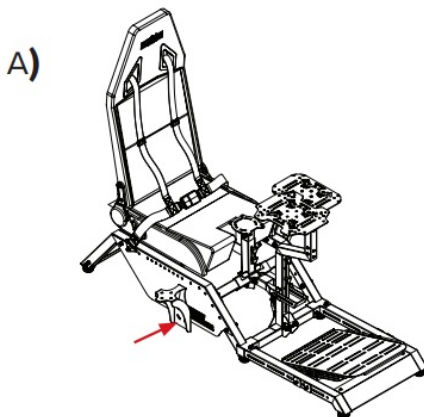

B)

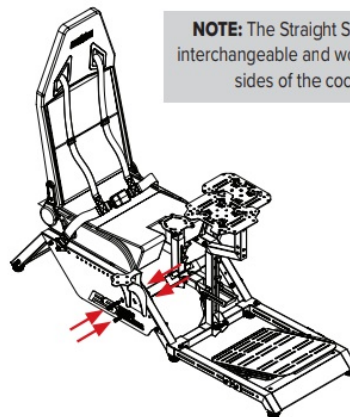

NOTE: The Straight Side Arm is interchangeable and works on both sides of the cockpit.

PARTS:

- 1 x Straight Side Arm
- 2 x M8 55mm Bolts
- 2 x M8 Washers
- 2 x M8 Flange Nuts

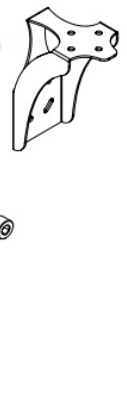

30. **A)** Align the Straight Side Arm with the through holes in the Seat Frame and Cross Member.

B) Bolt through and secure with 2 x M8 Bolts, Washers and Flange Nuts uninstalled in Step 29.

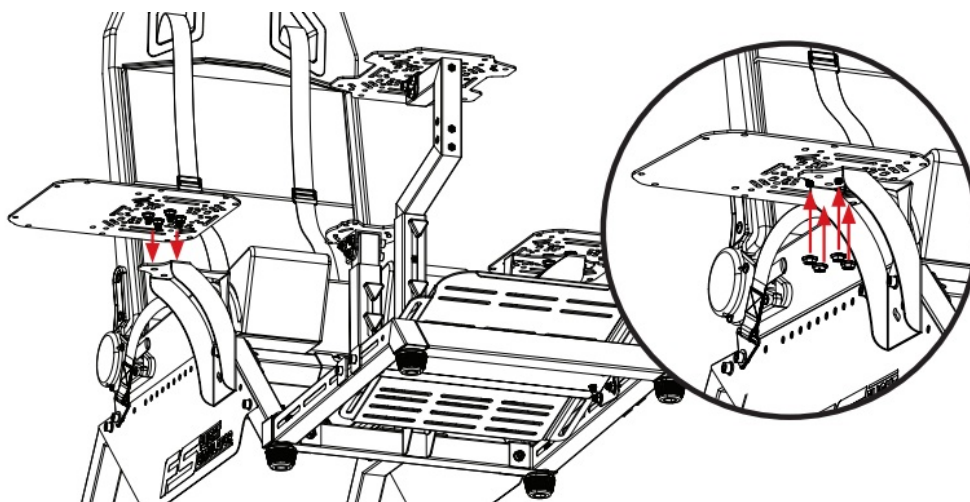

PARTS:

- 4 x M8 Flange Nuts



- 1 x Mouse Plate



31. Align the Mouse Plate Threaded Studs with the mounting holes on the Straight Side Arm. Secure with 4 x M8 Flange Nuts.

PEDAL PLATE ANGLE ADJUSTMENT

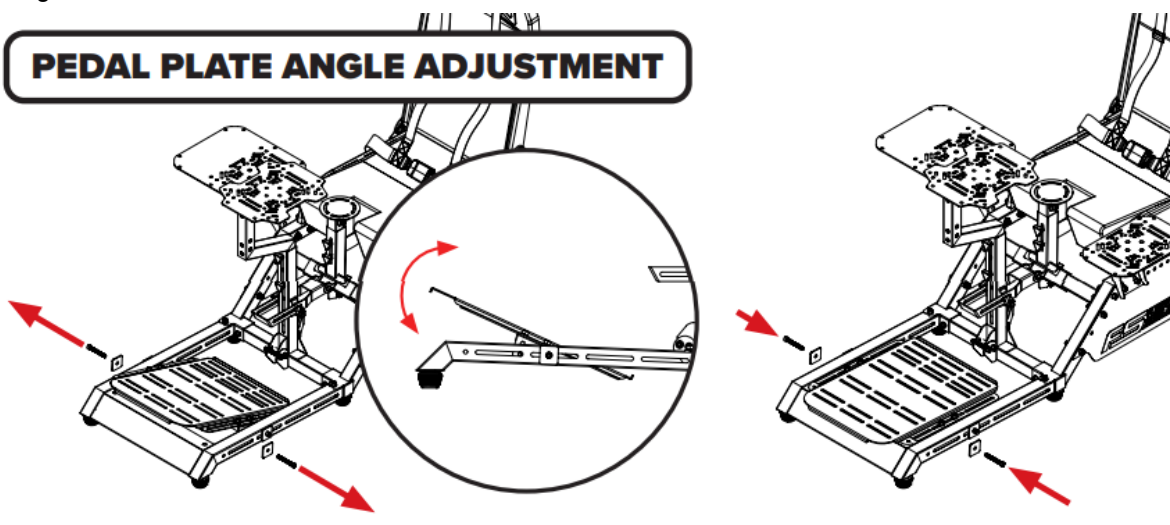

PARTS:

- NIL

32. Uninstall the front Bolts, Square Washers and Flange Nuts securing the Pedal Angle Plate to the Pedal Frame and loosen the rear Bolts. Adjust to the desired angle. Bolt through and secure with the Bolts, Square Washers and Flange Nuts previously uninstalled.

HOTAS POLE HEIGHT ADJUSTMENT

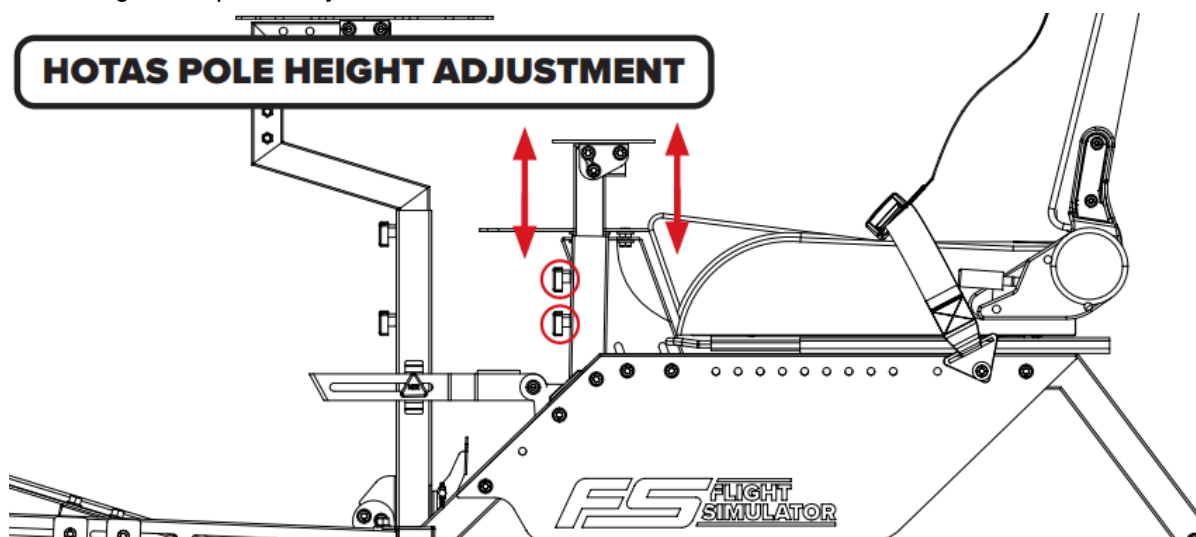

PARTS:

- NIL

33. Loosen the Knobs securing the HOTAS Inner Pole to the HOTAS Outer Pole. Adjust to desired height and tighten Knobs to lock in place.

HOTAS POLE ANGLE ADJUSTMENT

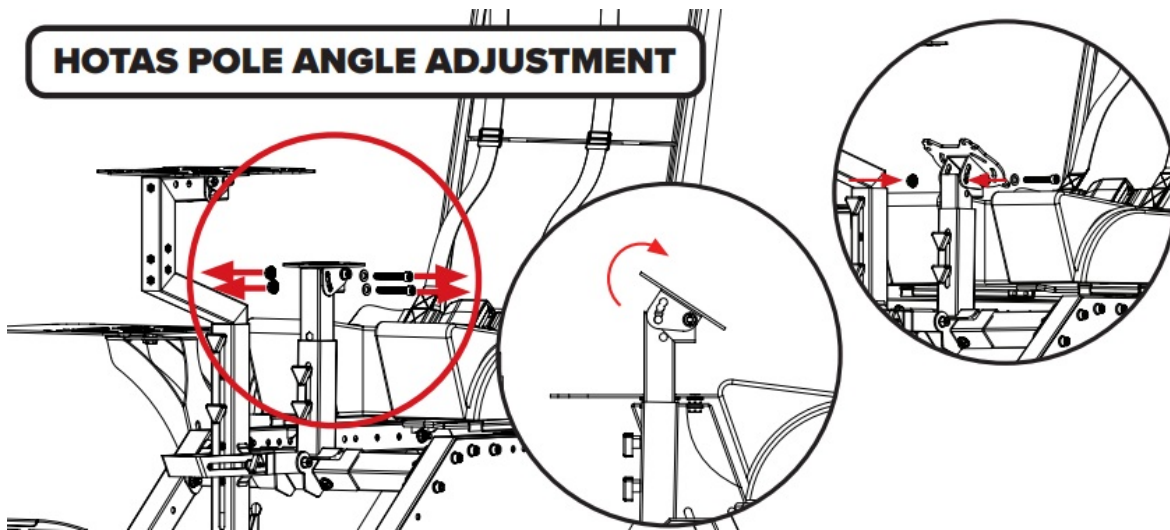

PARTS:

• NIL

34. Uninstall the front Bolts, Washers and Flange Nuts securing the HOTAS Plate to the HOTAS Inner Pole. Angle to the desired position. Bolt through and secure with 1 x Bolt, Washer and Flange Nut previously uninstalled.

CENTRE POLE HEIGHT ADJUSTMENT

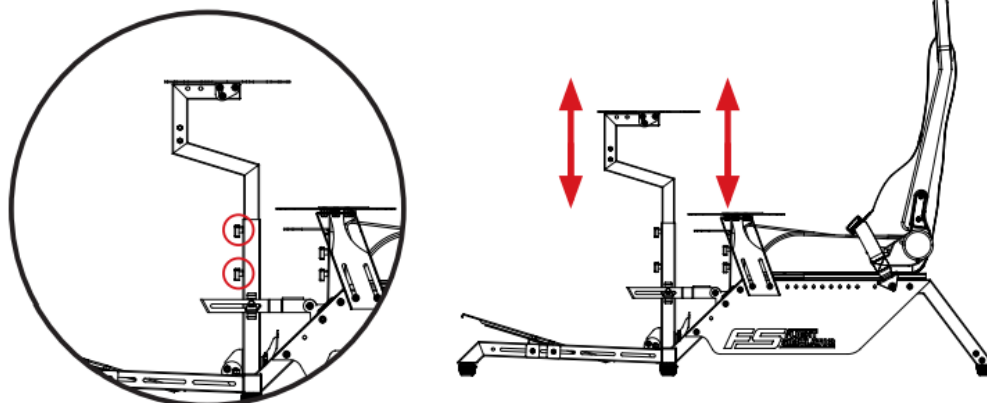

PARTS:

• NIL

35. Loosen the Knobs securing the Inner Centre Pole to the Outer Centre Pole. Adjust the Inner Centre Pole to the desired height and tighten the Knobs to secure in place. Utilize the multiple threaded inserts for a perfect fit.

CENTRE PLATE ANGLE ADJUSTMENT

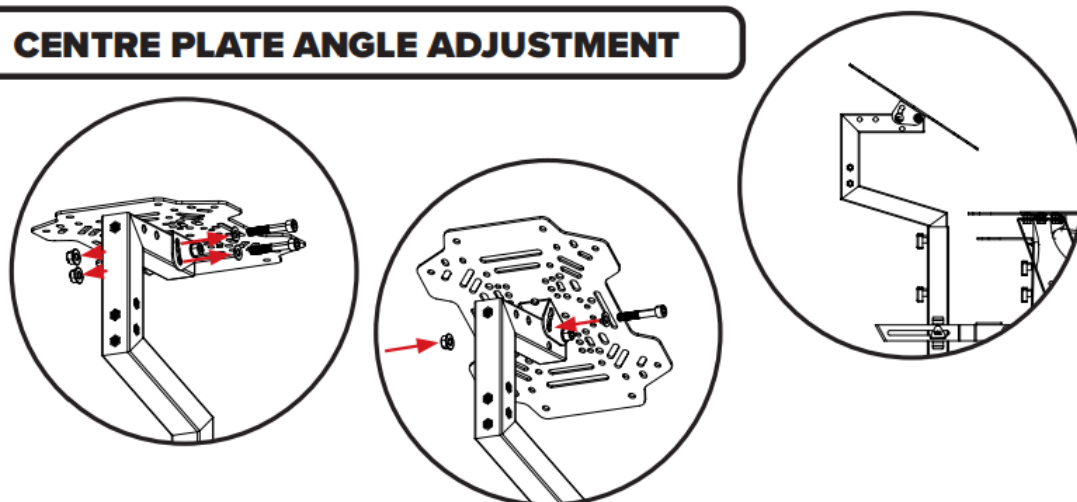

PARTS:

• NIL

36. Uninstall the front Bolts, Washers and Flange Nuts securing the Centre Plate to the Inner Centre Pole. Angle to the desired position. Bolt through and secure with 1 x Bolt, Washer and Flange Nut previously uninstalled.

TPR RUDDER INSTALLATION

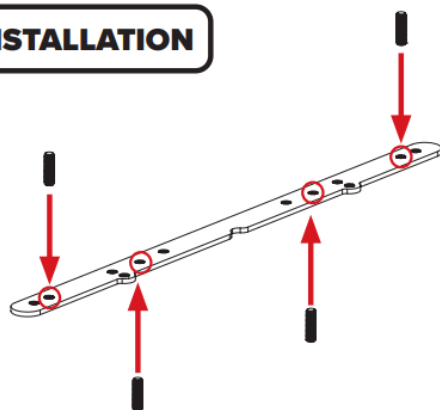

PARTS:

- 1 x TPR Adaptor

- 4 x M6 20mm Threaded Studs



37. Install 4 x M6 Threaded Studs into the TPR Adaptor.

(A)

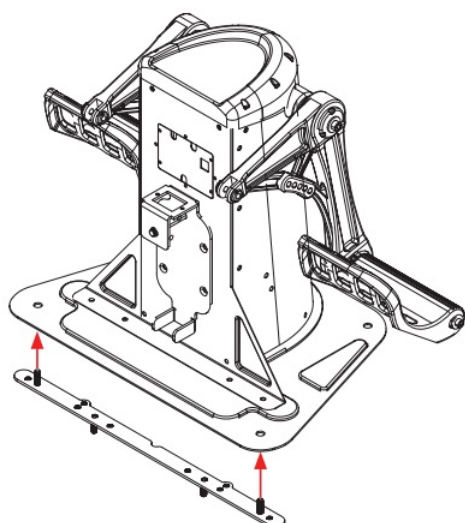

(B)

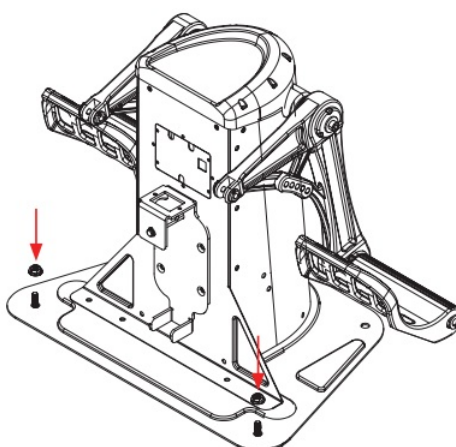

PARTS:

- 2x M6 Flange Nuts



- TPR Rudder *(not included)*

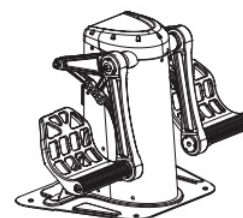

38. Align the mounting holes on the front of the TPR Rudder with the Threaded Studs on the TPR Adaptor. Secure with 2 x M6 Flange Nuts. The TPR Rudders are ready to install onto the cockpit.

BUTTKICKER POLE INSTALL

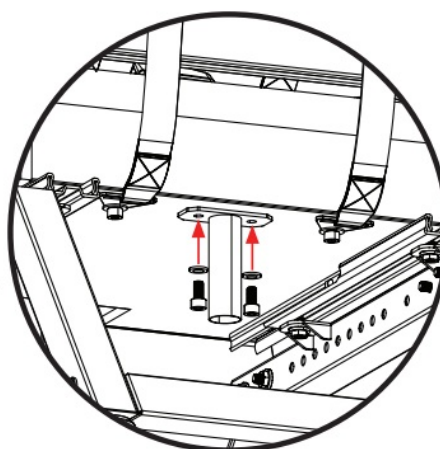
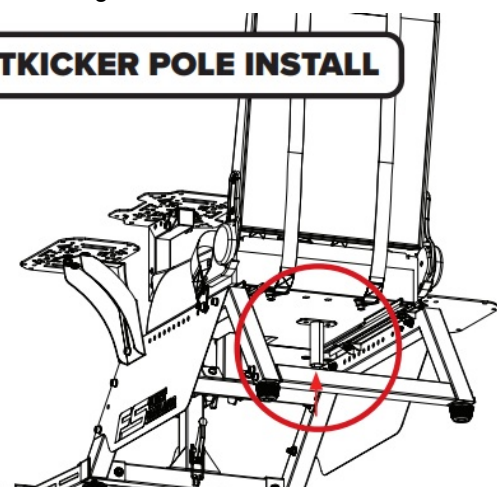

PARTS:

- 1 x ButtKicker Pole

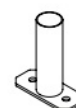

- 2 x M8 16mm Bolts



- 2 x M8 Washers



39. Align the mounting holes on the ButtKicker Pole with the threaded inserts under the Seat Bottom. Bolt through and secure with 2 x M8 Bolts and Washers.

MOUSE MAT INSTALL

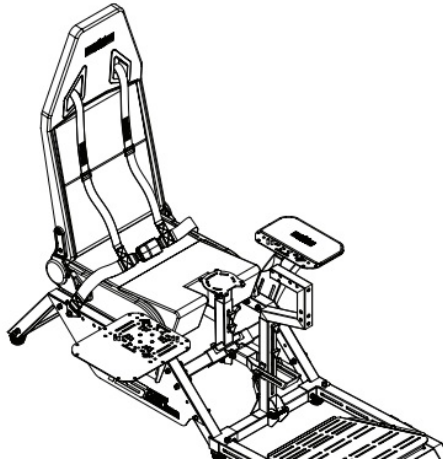
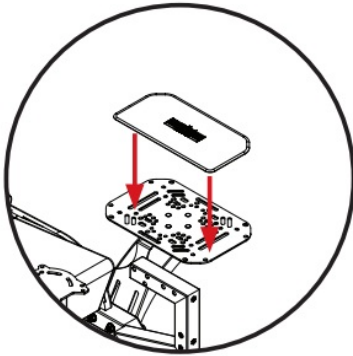

PARTS:

- 1 x Mouse Mat



40. A Mouse mat may be installed on top of the Flight or Mouse Plate. A mouse may now be used

KEYBOARD MAT INSTALL

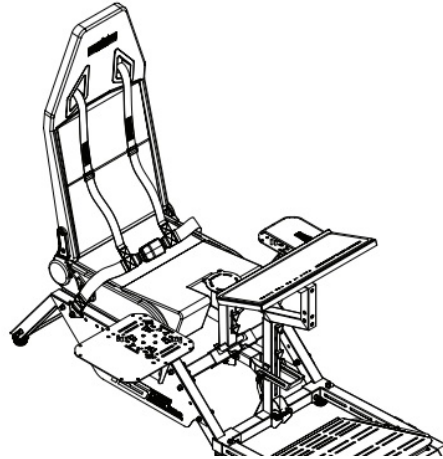
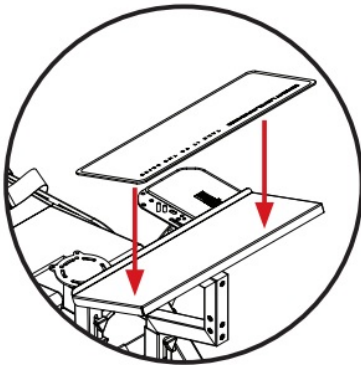

PARTS:

- 1 x Keyboard Mat



41. Place the Keyboard Mat on top of the Keyboard Plate. A keyboard may now be used.

WARNING

- Please do not use power tools for assembly as over-tightening can damage your frame.
- Lay out and build the cockpit on a level surface.
- Do not force parts together.
- Avoid cross-threading bolts.
- If in doubt, consult the installation video.

ASSISTANCE



bit.ly/nlrbuild

If you require further support with your product please contact our friendly team at:
support@nextlevelracing.com

We know you're eager to start flying! Take your time with the instructions and follow this guide to assemble your product. You'll be setting yourself up for success by following the instruction booklet to fully optimize your product.

Documents / Resources

	<p>FS NLR-S018 Next Level Racing [pdf] Instruction Manual</p> <p>NLR-S018 Next Level Racing, NLR-S018, Next Level Racing, Racing Setup</p>
---	--

References

- [📺 Video Instructions, Tips & Reviews | Next Level Racing](#)