

## FS FitShow App User Guide

[Home](#) » [FS](#) » FS FitShow App User Guide 

### Contents

- [1 FS FitShow App](#)
- [2 FitShow Download](#)
- [3 Application Operation](#)
- [4 The Third-Party Application](#)
- [5 Documents / Resources](#)
- [6 Related Posts](#)



### FS FitShow App

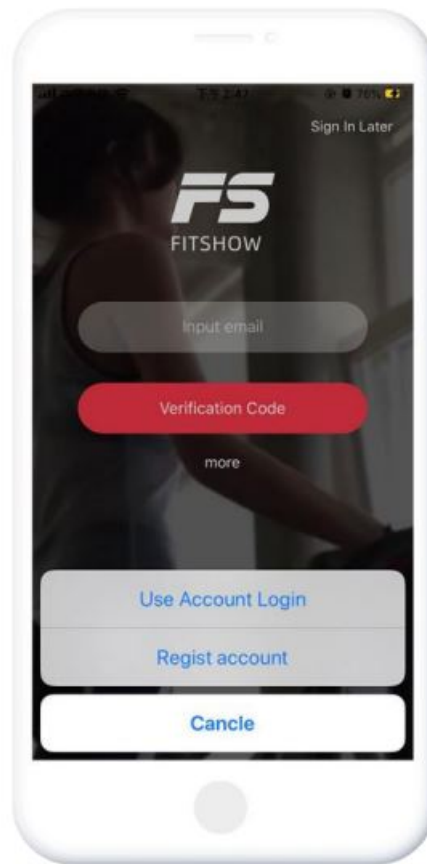

## FitShow Download



Scan QR code to download the APP directly, or download and install over the application stores by search 'FitShow'

## Application Operation

### User register/signup and login

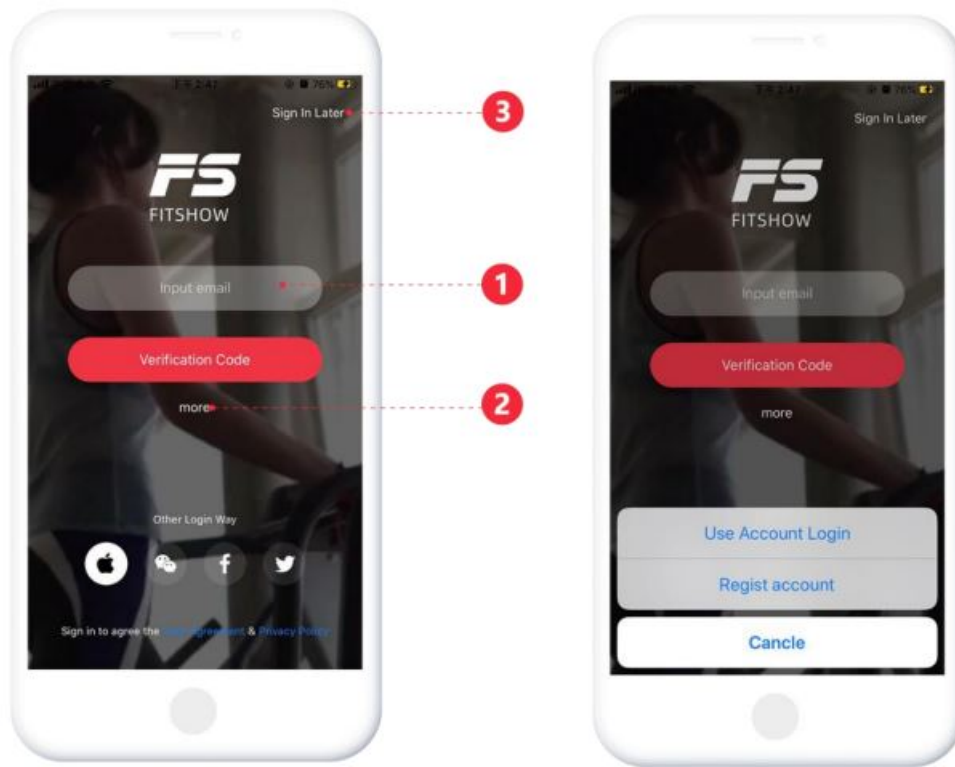

1. Generate a verification code to log in directly
2. Tap 'More' -> Password Login to input the existing account and password
3. Log in as a guest

## Device Connection

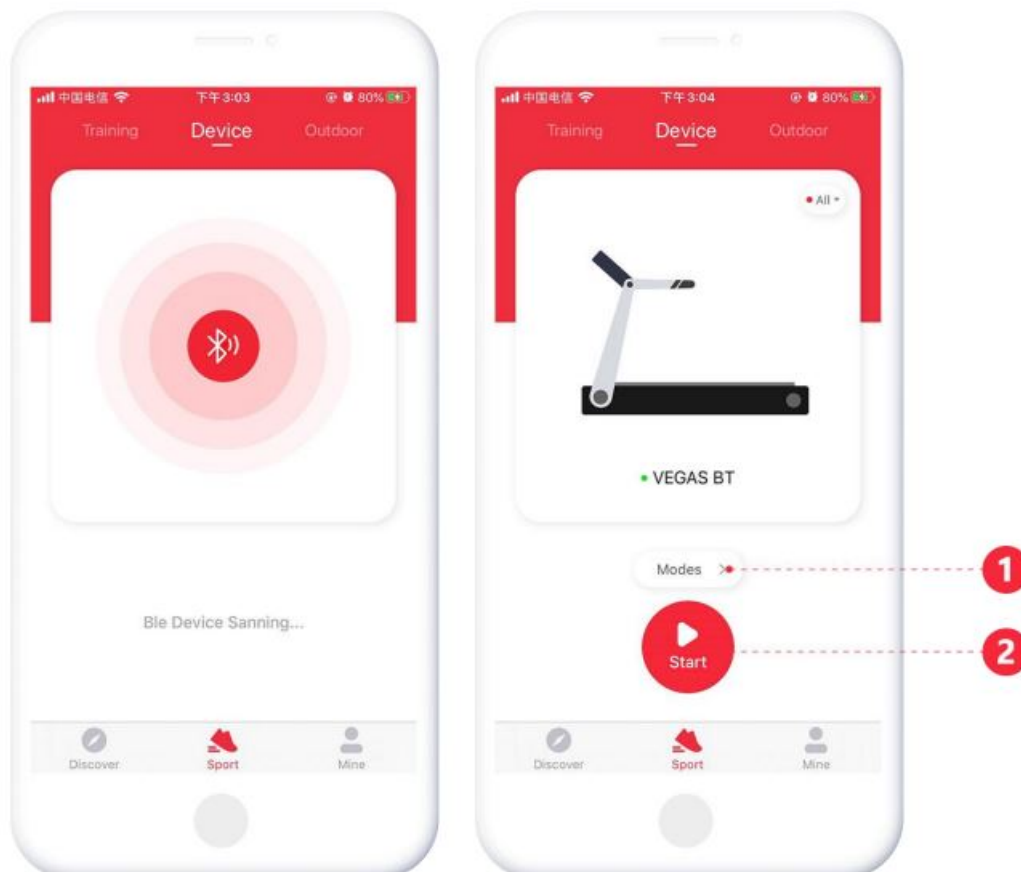

Before connecting the device, please make sure the system Bluetooth and GPS(Android8.0 and above required) are ON status. Then go to [Sports – Devices] page, get the devices nearby via Bluetooth search.

## Note:

1. Please do not bind devices by the phone Bluetooth list which will disable the APP.
2. If the device is powered by battery, please run the device one or two to activate the device then connect APP

## Model Selection

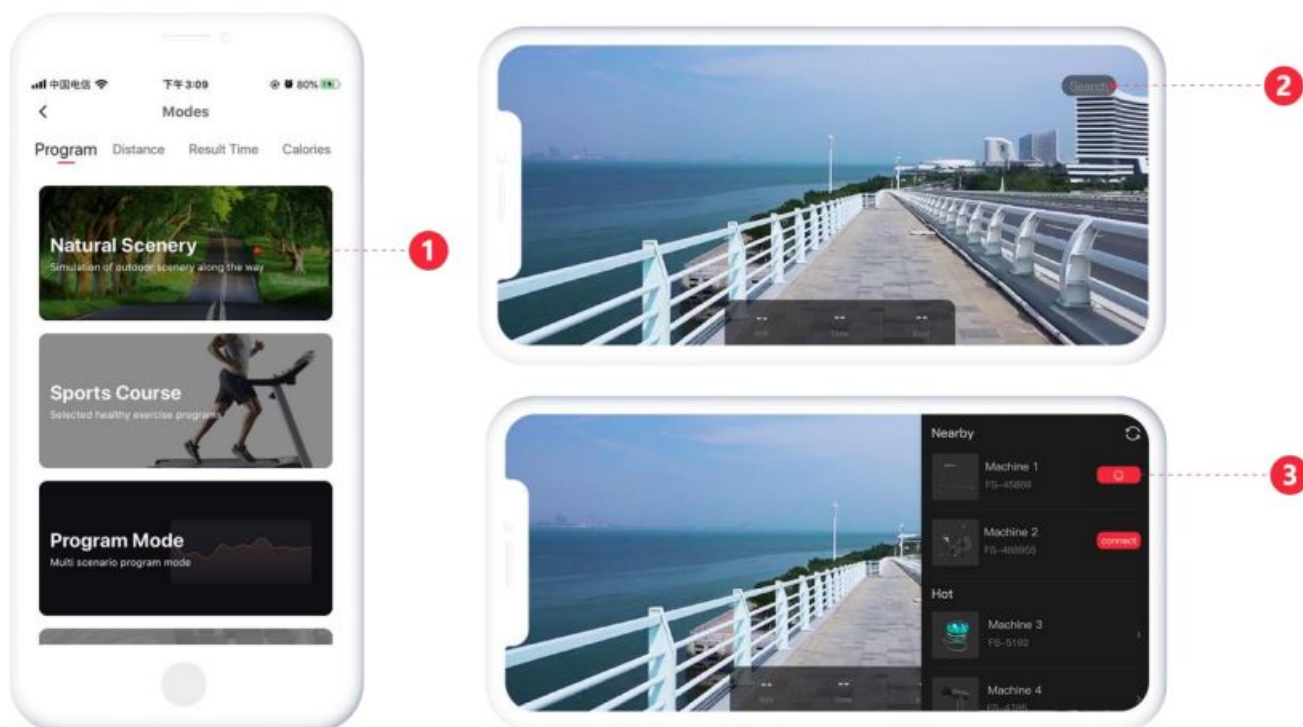

Tap a mode 1 to enter the corresponding sports model. And connect the desired device by the nearby devices list 2 .

## Sports Control

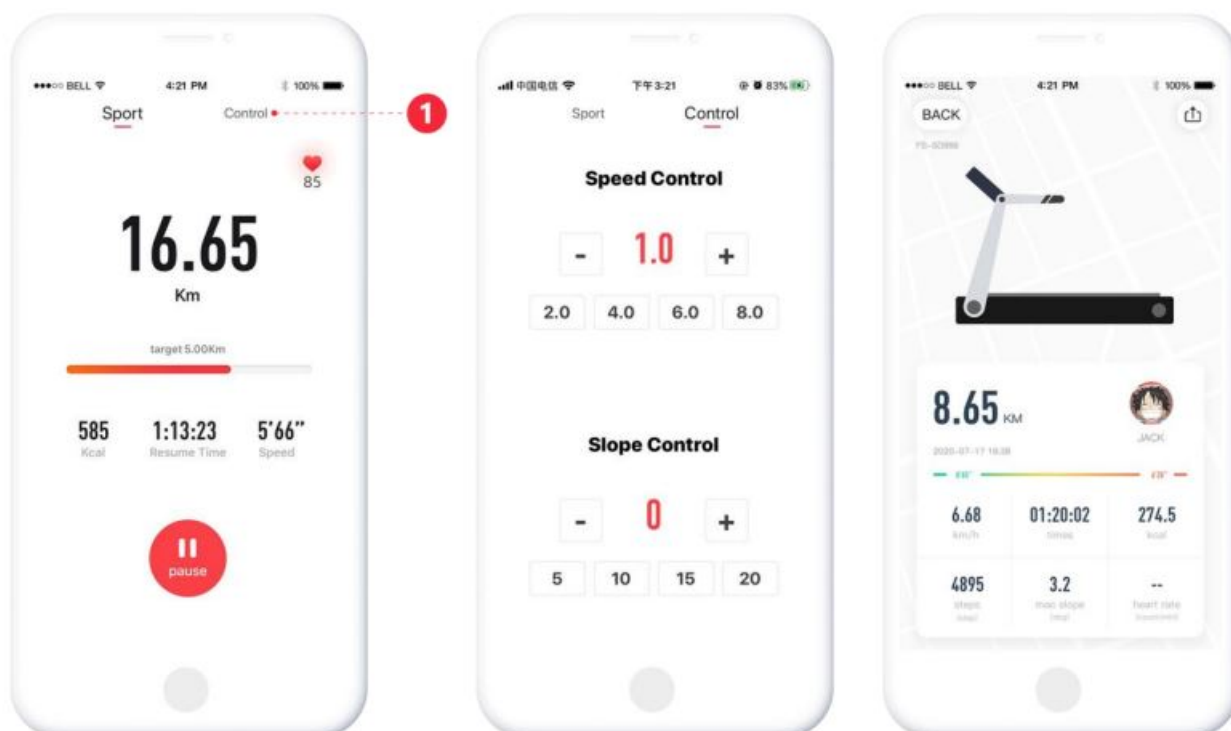

Start the treadmill to enter the sports car table, and control the sports by the 1 control options. The motion data is generated synchronously after the sports.

## Sports Training

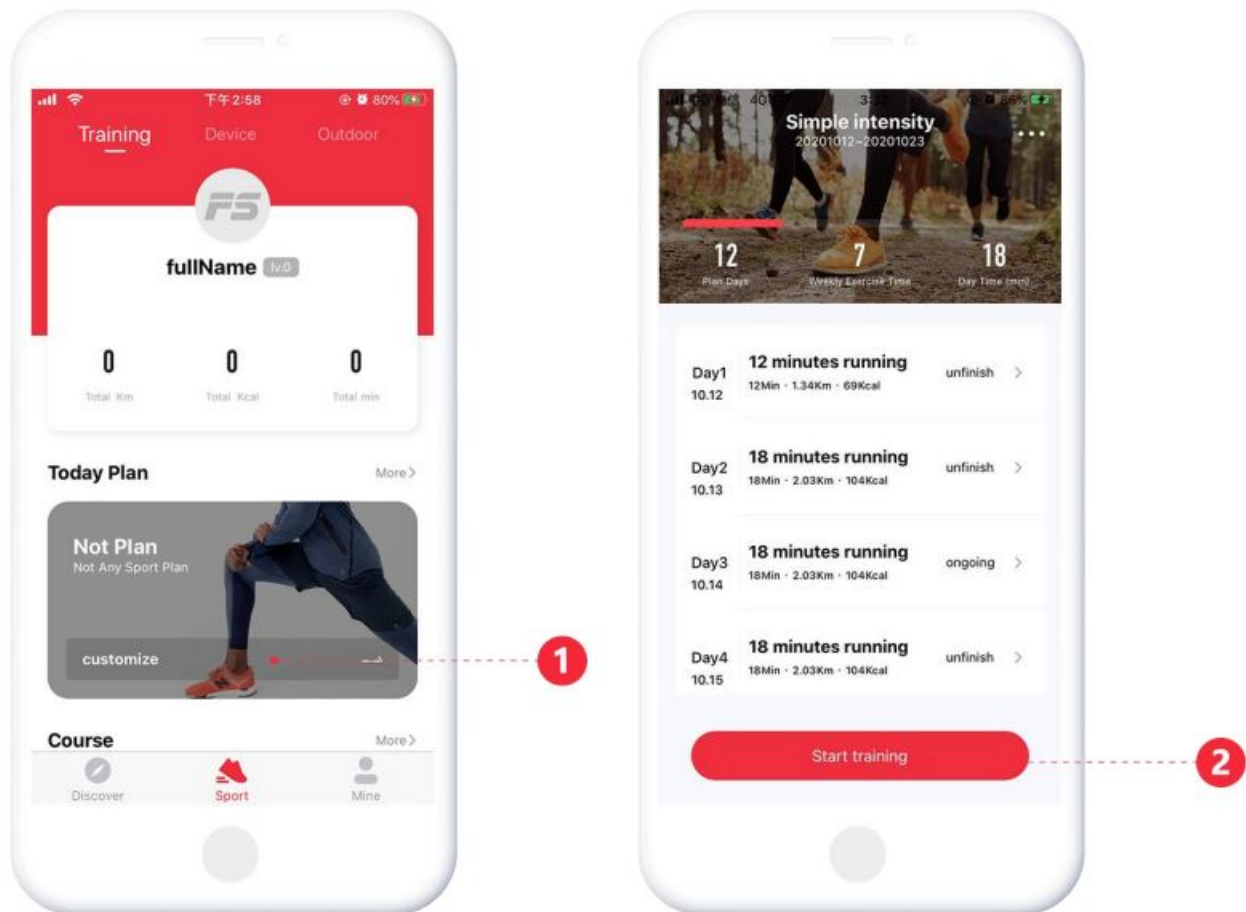

Enter [SPorts – Training] page, make a daily sport plan by the 1 . Once the plan is created, tap 2 to start the plan.

## Outdoor Sports

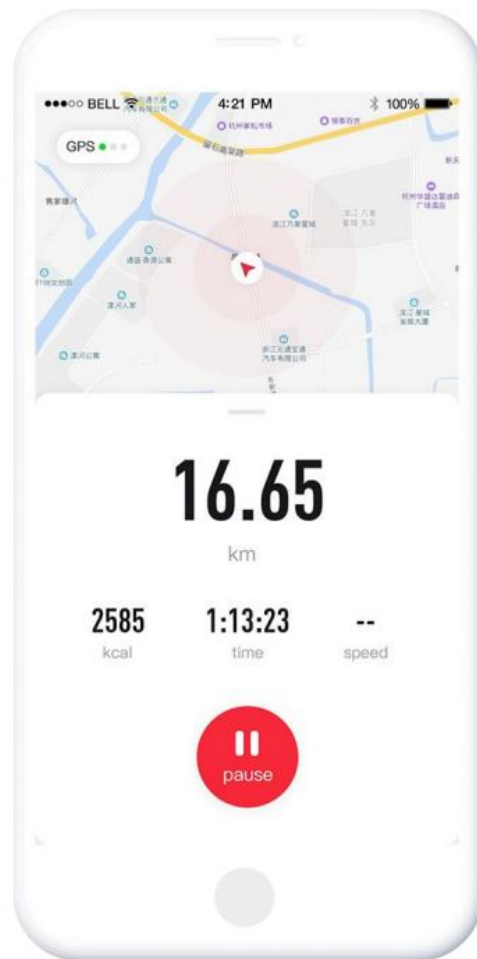
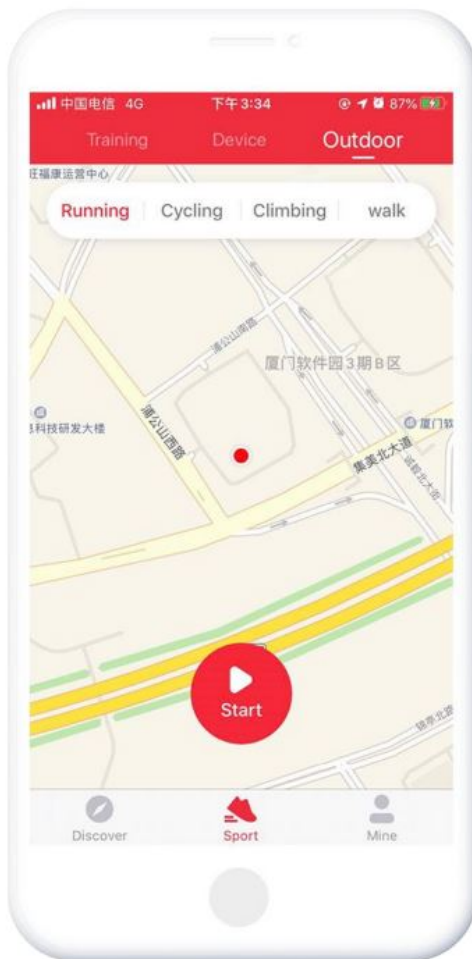

Enter [Sports – OutDoor] page to start a related outdoor sports model.

## Discover

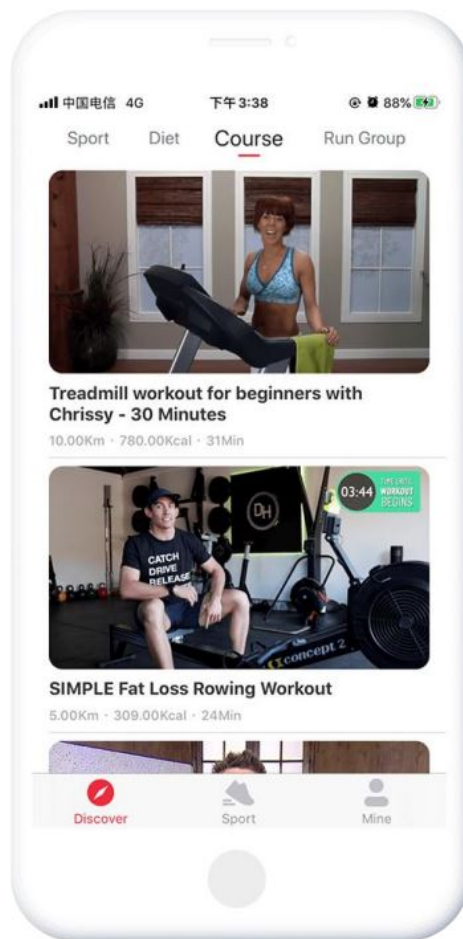
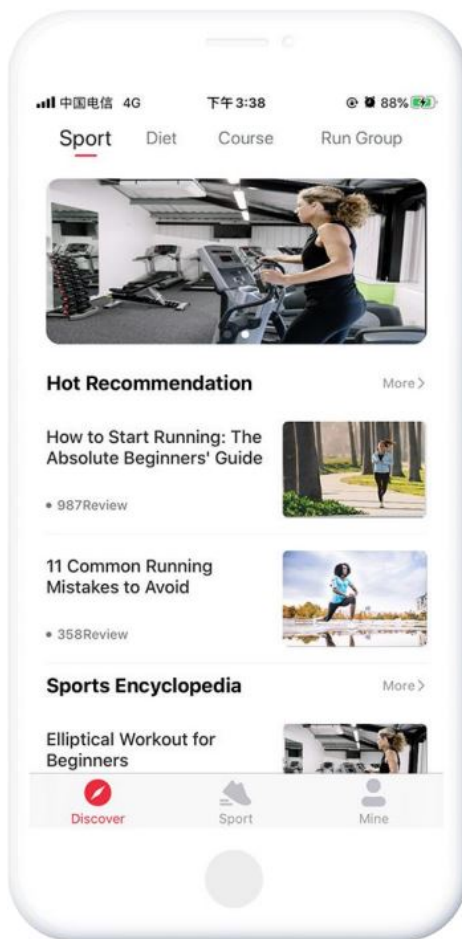

Enter [Discover] page to find more sports, diet, course, and other wonderful content recommendations.

My

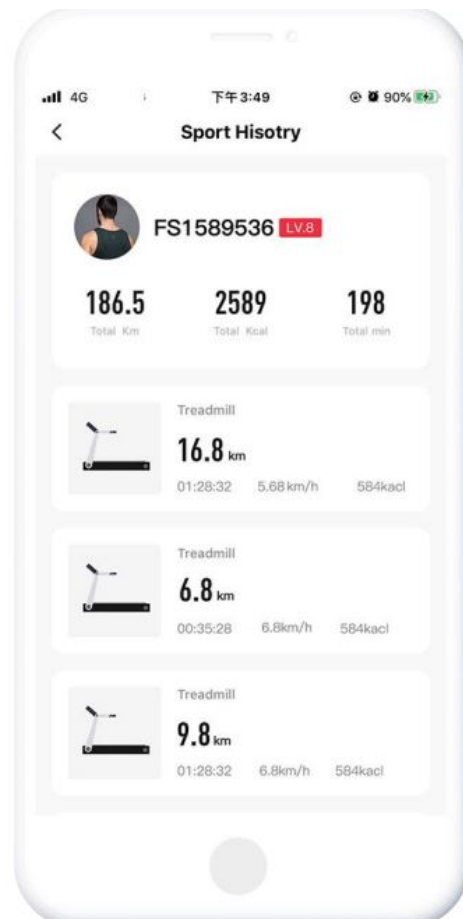
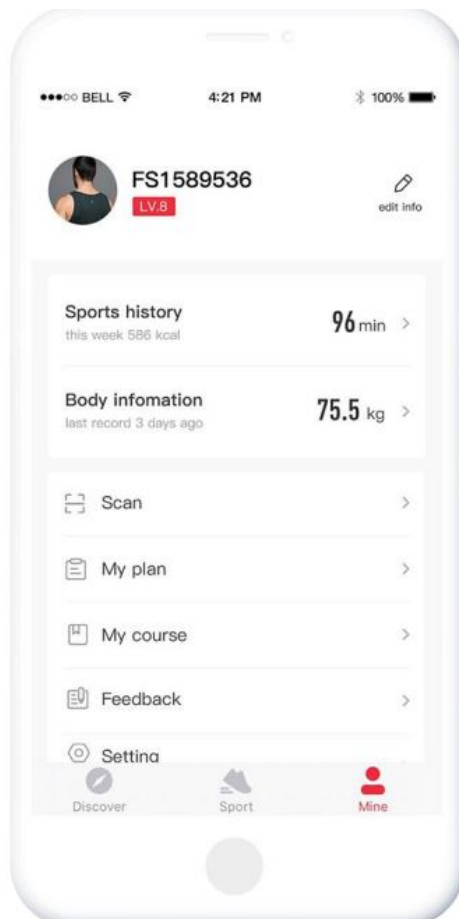



Enter [My] page to view the sports data record, edit profile, change system setting, and so on.

## The Third-Party Application

### Kinomap

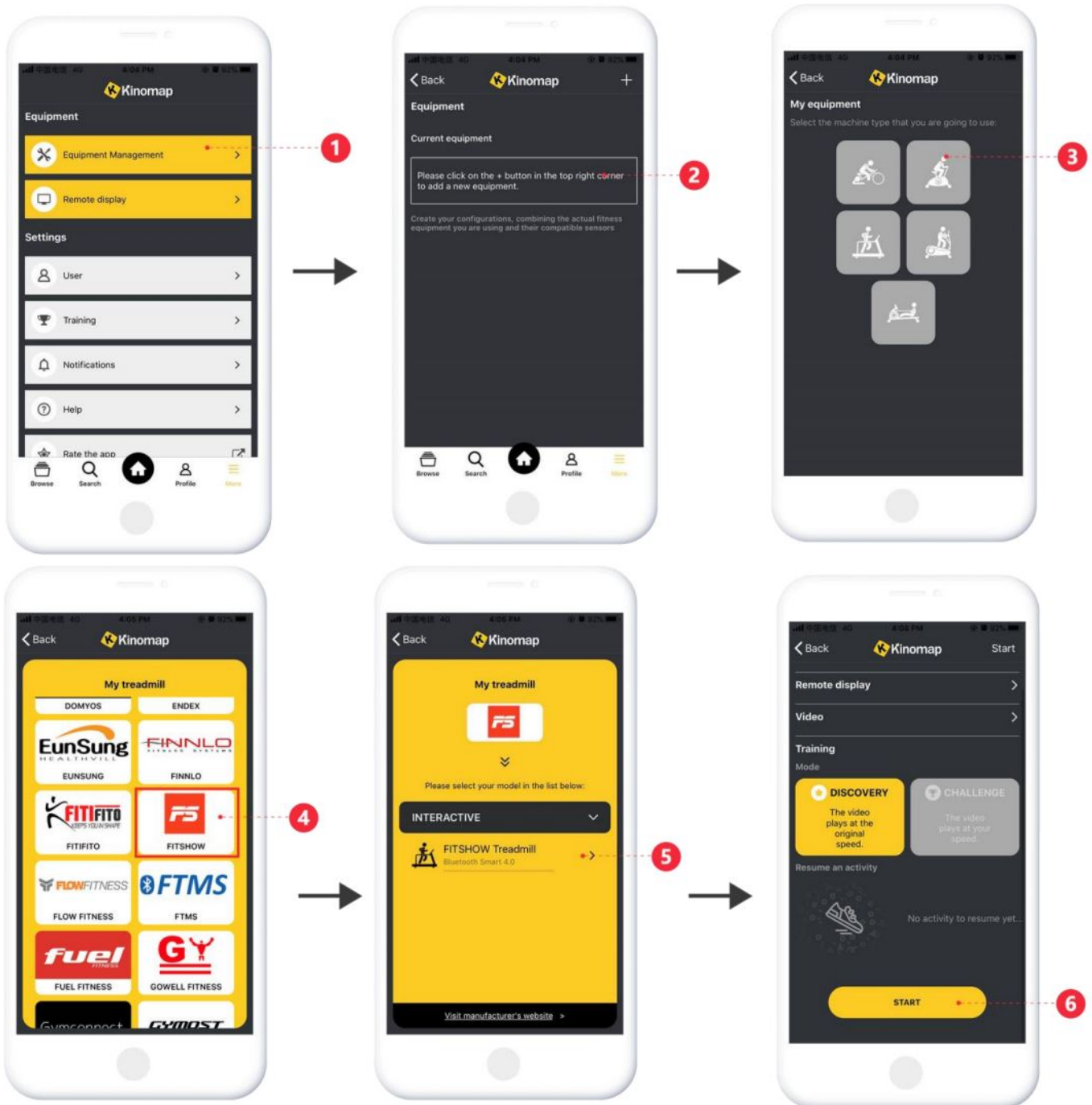

Search, download, and install Kinomap over the App Store.

1. Enter Kinomap to select [More] page;
2. Select to add more fitness equipment;
3. Select the desired device type;
4. Tap FiteShow entrance;
5. Tap the matching devices like 'Fs-XXXX' to bind Find related videos to start sports.
6. Find related videos to start sports



ZWIFT

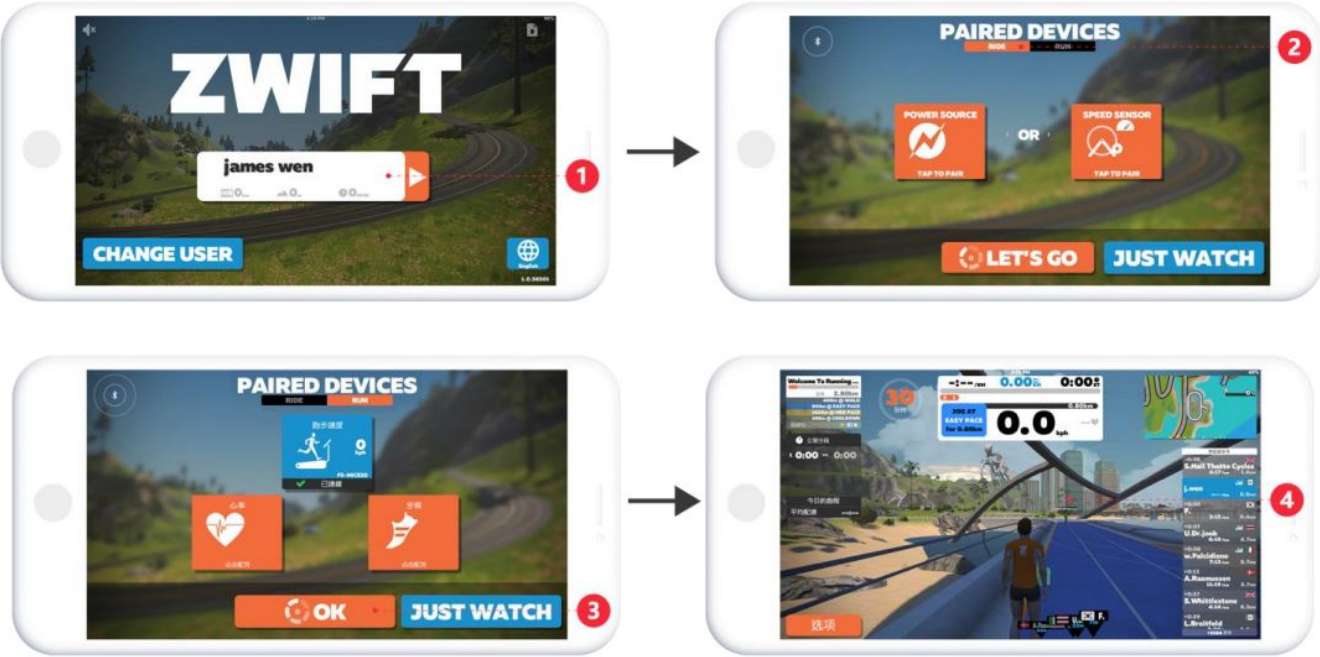

Search, download, and install ZWIFT over the App Store.

1. Enter ZWIFT to register an account;
2. Login account to select the paired riding or running equipment;
3. Pair device successfully, tap OK to start sport;
4. For riding equipment, start riding directly. For running equipment, need to press the start button to start running.

Documents / Resources

Fitshow User Manual	<a href="#">FS FitShow App</a> [pdf] User Guide FitShow App
---------------------	--