

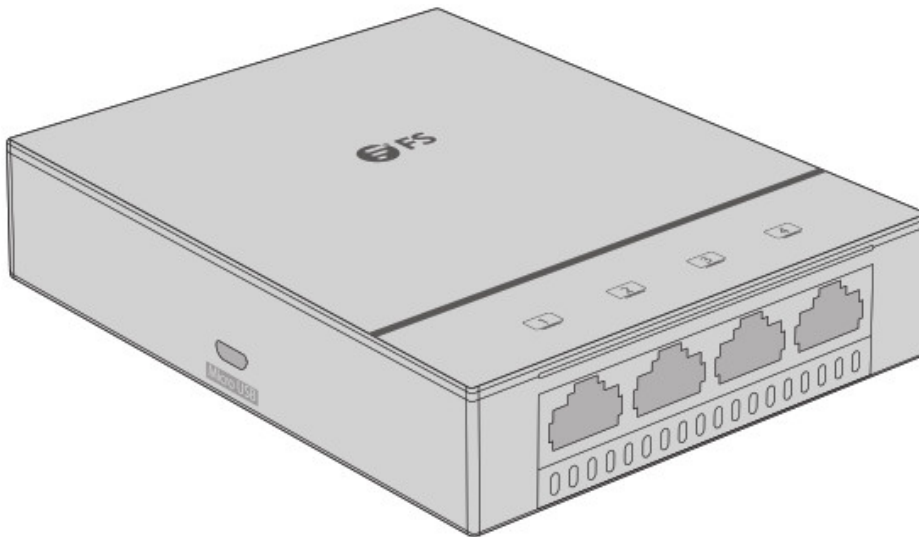

FS AP-W6D1775C Enterprise Wi-Fi 6 Wall Plate Access Point User Guide

[Home](#) » [FS](#) » FS AP-W6D1775C Enterprise Wi-Fi 6 Wall Plate Access Point User Guide 



AP-W6D1775C **V1.0**
ENTERPRISE WI-FI 6 WALL PLATE ACCESS POINT
Quick Start Guide

Contents

- [1 Introduction](#)
- [2 Accessories](#)
- [3 Optional \(Not Included\)](#)
- [4 Hardware Overview](#)
- [5 Button](#)
- [6 Installation Requirements](#)
- [7 Mounting the Access Point](#)
- [8 Configuring the Access Point](#)
- [9 Troubleshooting](#)
- [10 Support and Other Resources](#)
- [11 Product Warranty](#)
- [12 Documents / Resources](#)
- [13 Related Posts](#)

Introduction

Thank you for choosing the enterprise Wi-Fi 6 access point. This guide is designed to familiarize you with the layout of the access point and describes how to deploy the access point in your network.



AP-W6D1775C

Accessories



Screw x2

Optional (Not Included)



Screwdriver x1 Flathead Screwdriver x1

Hardware Overview

Ports

10/100/1000Base-T LAN

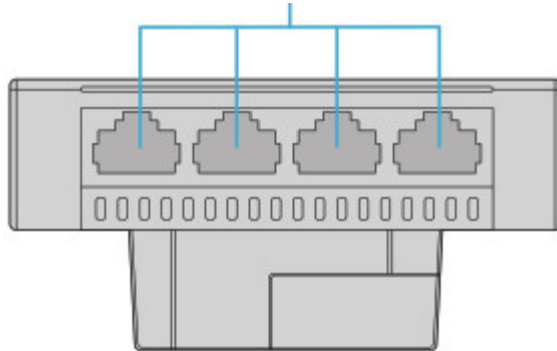

WAN/PoE

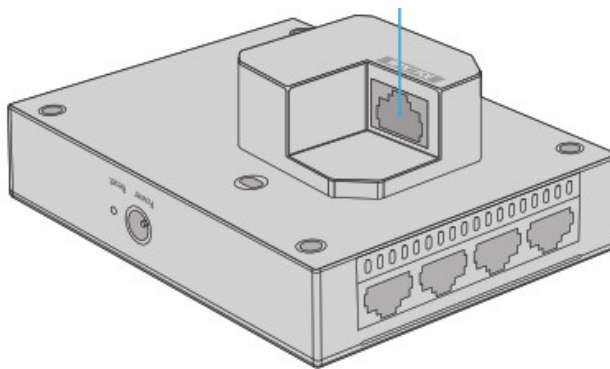

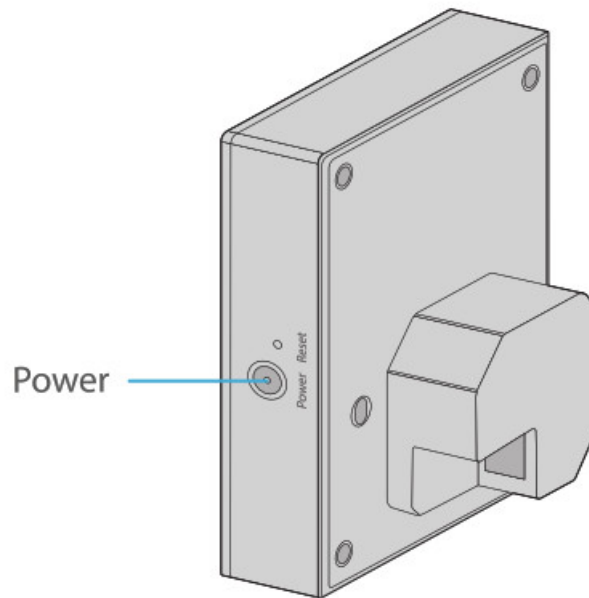
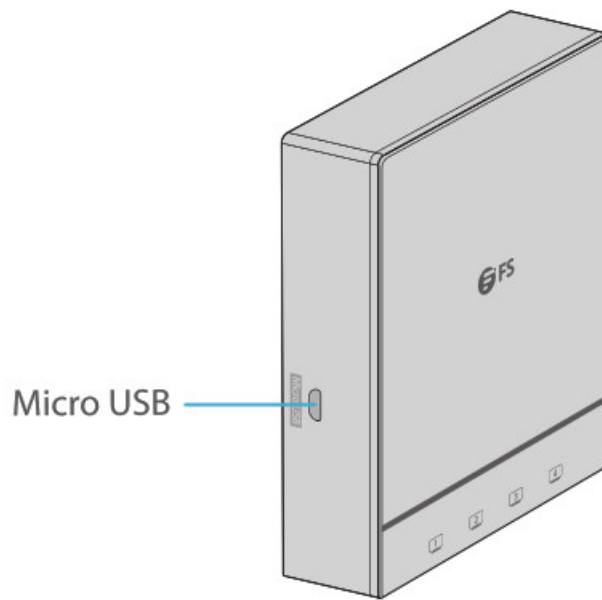

Ports	Description
LAN	10/100/1000Base-T LAN port
WAN/PoE	10/100/1000Base-T Ethernet WAN port, PoE and PoE+ capable
Micro USB	Micro USB management port (Console)
Power	Port for local power supply

Button

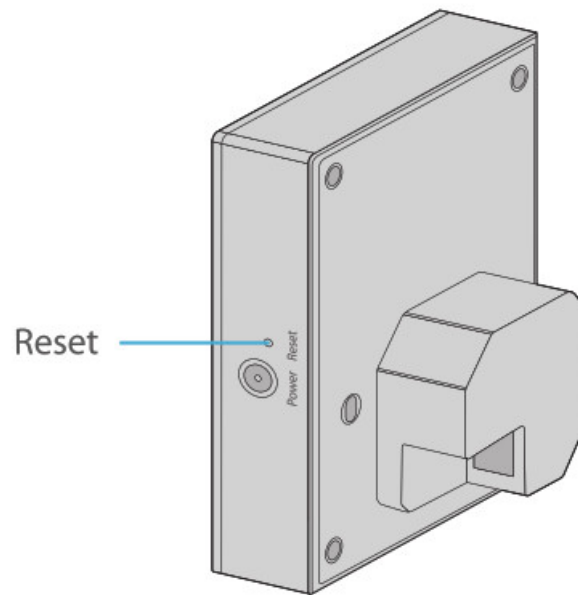

Button	Description
Reset	Restart: Press the Reset button for less than two seconds.
	Restore to Factory Default Settings: Press and hold the Reset button for more than three seconds.

LEDs

LED

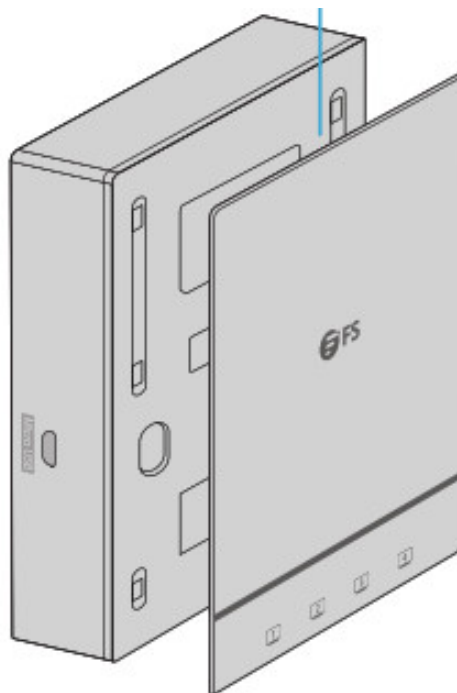

FAT AP:

Status	Frequency	Description
Off	N/A	The AP is powered off, or the AP is in Silent mode, which can be disabled via software.
Fast Blinking Green Before Solid Green	2.5Hz (fast blinking green)	Initialization is in progress. The AP is operational.
Fast Blinking Red	2.5Hz	Firmware upgrade in progress. Do not power off the AP.
Blinking Red	1Hz	AP is operational and Ethernet link is down.
Blinking Green	1Hz	AP is operational.

Status	Frequency	Description
Off	N/A	The AP is powered Off, or the AP is in Silent mode, which can be disabled via software.
Fast Blinking Green Before Solid Green	2.5Hz (fast blinking green)	Initialization is in progress. The AP is operational.
Fast Blinking Red	2.5Hz	Firmware upgrade in progress. Do not power off the AP.
Blinking Red	1Hz	AP is operational and Ethernet link is down.
Blinking Green	1Hz	AP is operational and Ethernet link is up. CAPWAP error.
Slow Blinking Green	0.4Hz	AP is operational and CAPWAP connection is established. At least one client is associated.

Installation Requirements

- Install the AP indoors.
- Do not power the AP during installation.
- Install the AP in a well-ventilated location.
- Place the AP in a dry area and avoid liquid intrusion.
- Keep the AP clean and dust-free.
- Keep away from high voltage cables.
- Do not subject the device to high temperatures.
- Do not expose the device in a thunderstorm or strong electric field.

Mounting the Access Point

Wall Plate Mounting

1. Use a flathead screwdriver to remove the cover plate as constructed in the following figure.

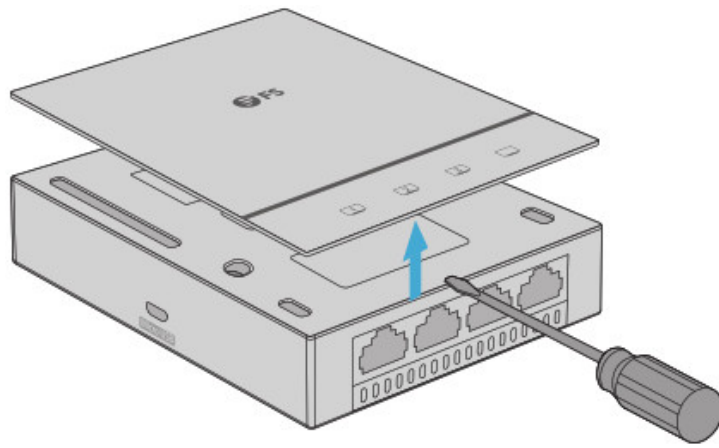

2. Connect the uplink cable to the WAN/PoE port

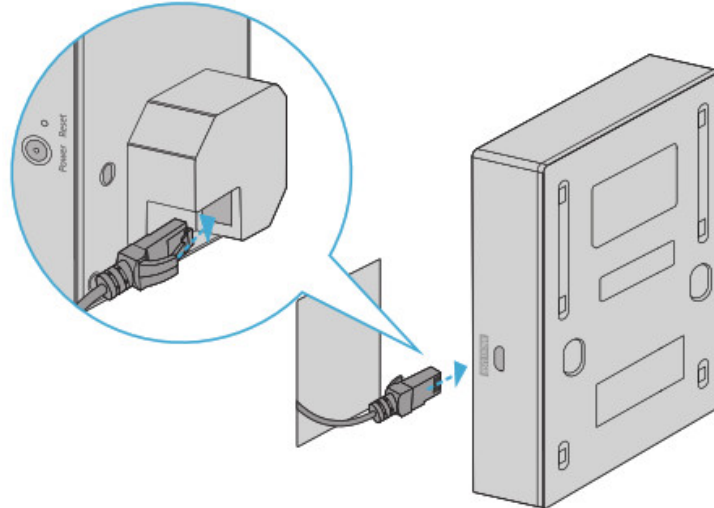

3. Align screw holes on both sides of the device over those on the faceplate. And then tighten screws with a screwdriver.

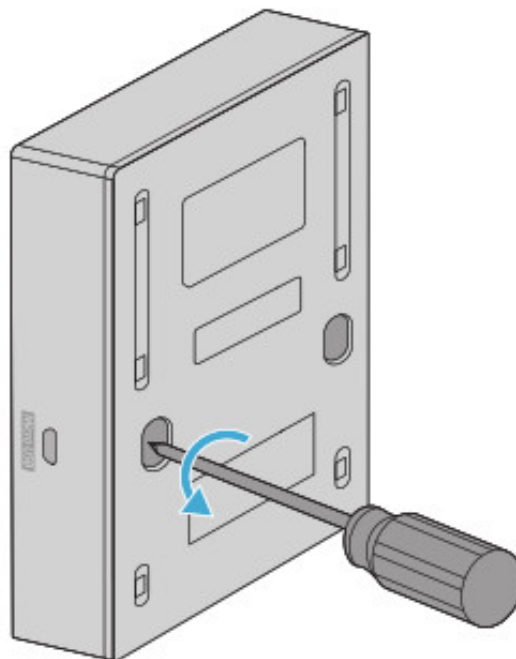

4. Install the cover plate in the way as shown in the following figure.

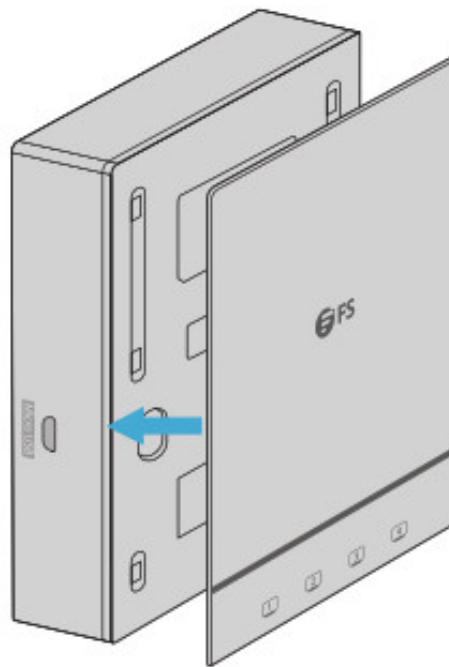

5. Complete the installation.



**Connecting the PoE Power Supply
PoE Switch**

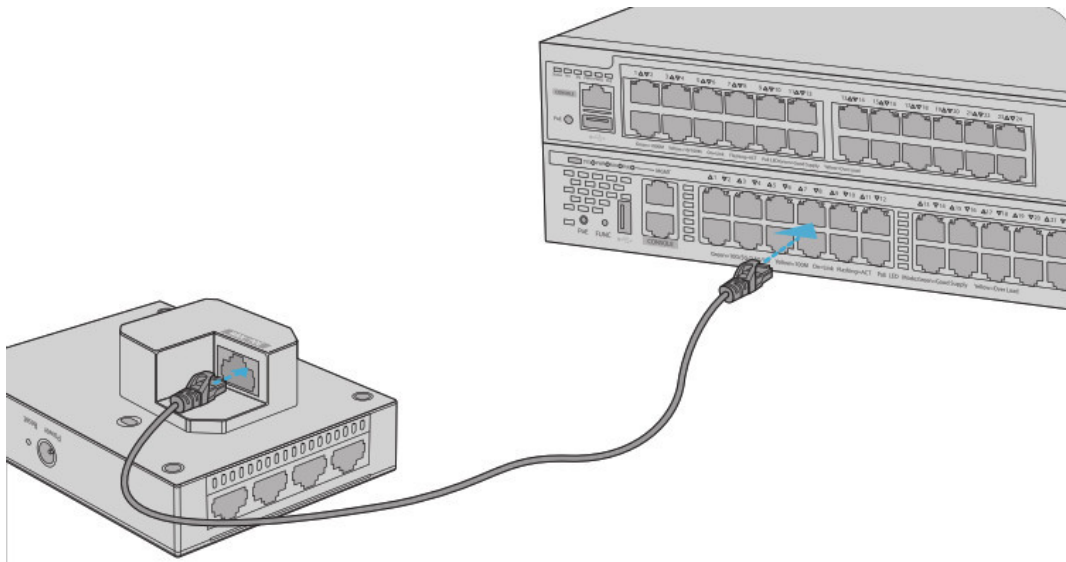

Use an Ethernet cable to connect the WAN/PoE port on the AP to the PoE port on a PoE switch.

PoE Injector

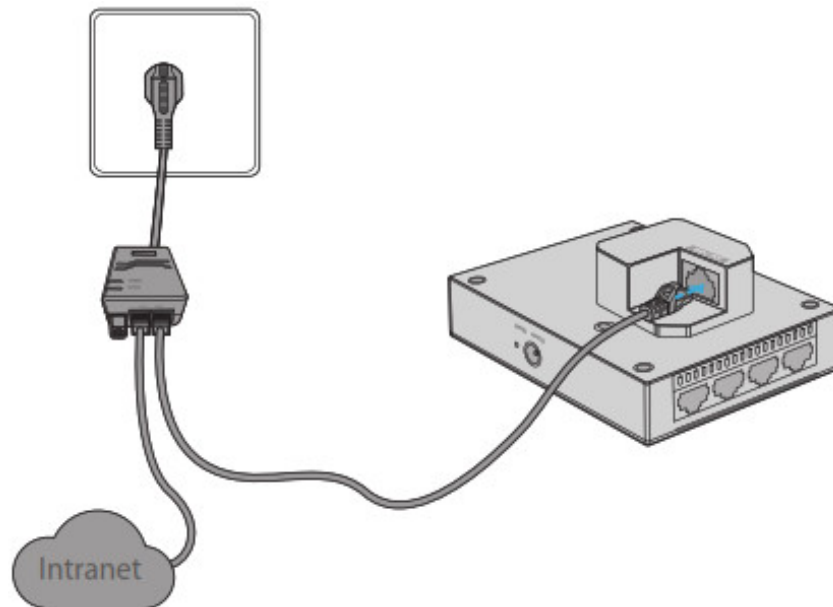

Use the power cord, power injector and Ethernet cable to connect the WAN/PoE port of the AP to the local power source.

Configuring the Access Point

Configuring the AP Using the Web-based Interface

Step 1: Connect the computer to the WAN/PoE port of the AP using the network cable.

Step 2: Set the IP address of the computer to 192.168.1.x. ("x" is any number from 2 to 254.)

Internet Protocol Version 4 (TCP/IPv4) Properties

General

You can get IP settings assigned automatically if your network supports this capability. Otherwise, you need to ask your network administrator for the appropriate IP settings.

☐ Obtain an IP address automatically

☒ Use the following IP address:

IP address: 192 . 168 . 1 . 2

Subnet mask: 255 . 255 . 255 . 0

Default gateway: . . .

☐ Obtain DNS server address automatically

☒ Use the following DNS server addresses:

Preferred DNS server: . . .

Alternate DNS server: . . .

☐ Validate settings upon exit

Advanced...

OK Cancel

Step 3: Open a browser, type <http://192.168.1.1>, and enter the default username and password, **admin/admin**.

Access Point

admin

Login

Step 4: Click Login to display the web-based configuration page.

Step 5: Click the **System Mode Switch** to switch the FIT/FAP working mode.

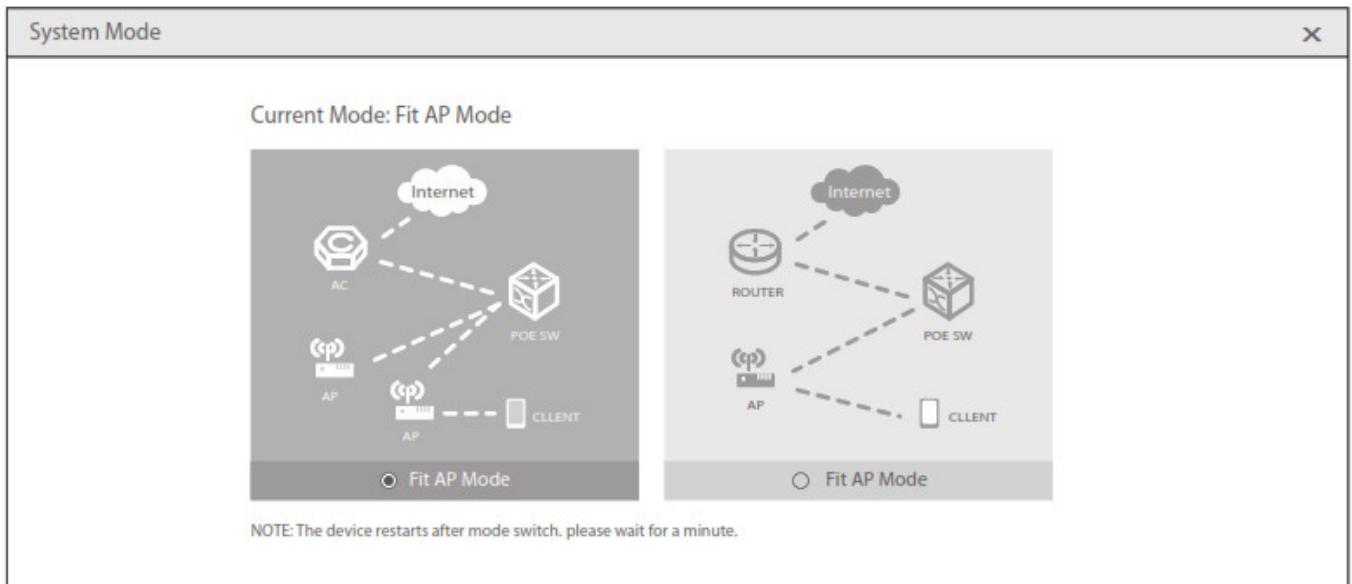

NOTE: The access points work in Fit AP Mode by default.

Configuring the AP Using the Console Port (FAT AP Mode)

Step 1: Connect a computer to the AP's Micro USB port using the console cable.

Step 2: Start the terminal simulation software such as HyperTerminal on the computer.

Step 3: Set the parameters of the HyperTerminal: 9600 bits per second, 8 data bits, no parity, 1 stop bit and no flow control.

Quick Connect

Protocol: Serial

The port may be manually entered or selected from the list.

Port: COM3

Baud rate: 9600

Data bits: 8

Parity: None

Stop bits: 1

Name of pipe:

Flow Control

☐ DTR/DSR

☐ RTS/CTS

☐ XON/XOFF

☐ Show quick connect on startup

☐ Save session

☐ Open in a tab

Connect Cancel

Step 4: After setting the parameters, click Connect to enter. And then enter the default password, admin.



NOTE: For more details, please refer to the Configuration Guide on the website.

Troubleshooting

LED does not light up after the AP is powered on

Verify that the power source is IEEE 802.11af/at compliant. And then verify that the cable is connected properly.

Orange LED blinks after the Ethernet cable is connected

Verify that the device at the other end of the Ethernet cable is working properly. And then verify that the Ethernet cable is capable of providing the required data rate and is properly connected.

Wireless client cannot find the AP

1. Follow the above-mentioned two steps.
2. Verify that the AP is configured correctly.
3. Adjust the transmit power.
4. Move the client device to adjust the distance between the client and the AP.

Support and Other Resources

- Download <https://www.fs.com/download.html>
- Help Center https://www.fs.com/service/help_center.html
- Contact Us https://www.fs.com/contact_us.html

Product Warranty

FS ensures our customers that any damage or faulty items due to our workmanship, we will offer a free return within 30 Days from the day you receive your goods. This excludes any custom made items or tailored solutions.



Warranty: The Wi-Fi 6 wireless access point enjoys 3 years limited warranty against defects in materials or workmanship. For more details about warranty, please check at

<https://www.fs.com/policies/warranty.html>



Return: If you want to return item(s), information on how to return can be found at

https://www.fs.com/policies/day_return_policy.html

Q.C. PASSED

Copyright © 2021 FS.COM All Rights Reserved.

Documents / Resources

 <p>AP-W6D1775C ENTERPRISE WI-FI 6 WALL PLATE ACCESS POINT Quick Start Guide</p>	<p>FS AP-W6D1775C Enterprise Wi-Fi 6 Wall Plate Access Point [pdf] User Guide AP-W6D1775C, Enterprise Wi-Fi 6 Wall Plate Access Point</p>
---	--

