



## FD I268 Wireless Mouse User Manual

[Home](#) » [FD](#) » FD I268 Wireless Mouse User Manual 

### Contents

- [1 FD I268 Wireless Mouse](#)
- [2 Overview](#)
- [3 Instructions](#)
- [4 Data parameter](#)
- [5 System requirement:](#)
- [6 Package included](#)
- [7 Documents / Resources](#)
- [8 Related Posts](#)



### FD I268 Wireless Mouse



### Overview

1. Left button
2. Scroll wheel & Middle
3. USB receiver
4. Right button

## Instructions

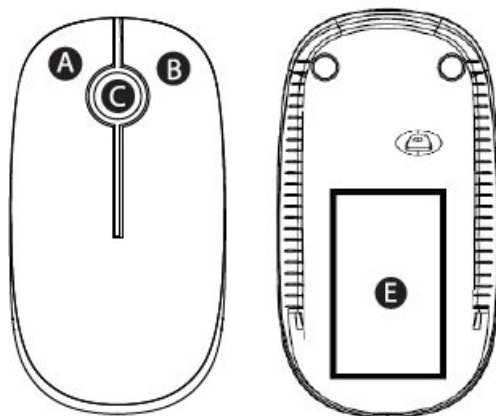

1. Open the back cover and install the battery
2. Take out the receiver

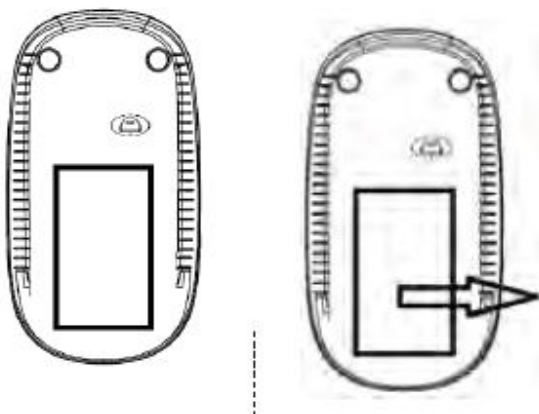

3. Inset the usb receiver into the usb port of PC

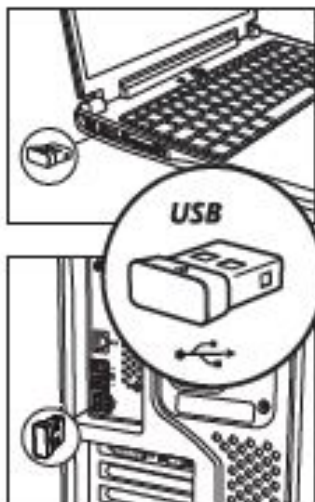

## Data parameter

- Data transmission: 1 Mbps
- Frequency:
- Channel: 16
- Engine: Optical
- Distance: 20m
- Voltage:
- Current: 11mA
- Mouse Key life: Above 3 millions
- Mouse Size: 110x60x31mm
- Mouse Weight: 62g

#### **Tracking performance:**

Mouse Resolution: 1600DPI Polling rate: 250Hz

#### **System requirement:**

- Windows: 2000/ ME/
- XP(x64)/ Vista/ 7/8/10
- Workable USB port

#### **Package included**

- 1 x Wireless mouse
- 1 x USB receiver (in battery storage)
- 1 x User guide

**Warning:** Changes or modifications to this unit not expressly approved by the party responsible for compliance could void the user's authority to operate the equipment.

**NOTE:** This device complies with part 15 of the FCC Rules. Operation is subject to the following two conditions: (1) This device may not cause harmful interference, and (2) this device must accept any interference received, including interference that may cause undesired operation.

**FCC Statement:** This equipment has been tested and found to comply with the limits for a Class B digital device, pursuant to part 15 of the FCC Rules. These limits are designed to provide reasonable protection against harmful interference in a residential installation. This equipment generates, uses and can radiate radio frequency energy and, if not installed and used in accordance with the instructions, may cause harmful interference to radio communications. However, there is no guarantee that interference will not occur in a particular installation. If this equipment does cause harmful interference to radio or television reception, which can be determined by turning the equipment off and on, the user is encouraged to try to correct the interference by one or more of the following measures:

- Reorient or relocate the receiving antenna.
- Increase the separation between the equipment and receiver.
- Connect the equipment into an outlet on a circuit different from that to which the receiver is connected.
- Consult the dealer or an experienced radio/TV technician for help.

**RF exposure compliance statement:**

This device has been evaluated to meet the general RF exposure requirement

**Documents / Resources**

	<a href="#">FD I268 Wireless Mouse</a> [pdf] User Manual I268, 2ANBU-I268, 2ANBUI268, I268 Wireless Mouse, Wireless Mouse
---	--

[Manuals+](#)