



DWE-DT1 Wireless Trigger Mesh Batter Head User Guide

[Home](#) » [DW](#) » DWE-DT1 Wireless Trigger Mesh Batter Head User Guide 



Quick Start Guide
© 2023 Drum Workshop, Inc.

Before using this unit, carefully read “USING THE DWe SYSTEM SAFELY” and “IMPORTANT NOTES”. After reading, keep the document(s) where it will be available for immediate reference.



Contents

- [1 USING THE DWe SYSTEM SAFELY](#)
- [2 Thank you for joining the DWe family](#)
- [3 Included components](#)
- [4 IMPORTANT NOTES](#)
- [5 To get started, first download and install the DW Soundworks™ software](#)
- [6 Cymbal and drum setup](#)
- [7 DrumLink™ hub setup](#)
- [8 RTap setup](#)
- [9 Documents / Resources](#)
 - [9.1 References](#)







USING THE DWe SYSTEM SAFELY

INSTRUCTIONS FOR THE PREVENTION OF FIRE, ELECTRIC SHOCK, OR INJURY TO PERSONS

About  WARNING and  CAUTION Notices

 WARNING	Used for instructions intended to alert the user to the risk of death or severe injury should the unit be used improperly.
 CAUTION	Used for instructions intended to alert the user to the risk of injury or material damage should the unit be used improperly. * Material damage refers to damage or other adverse effects caused with respect to the home and all its furnishings, as well to domestic animals or pets.

About the Symbols

	The  symbol alerts the user to important instructions or warnings. The specific meaning of the symbol is determined by the design contained within the triangle. In the case of the symbol at left, it is used for general cautions, warnings, or alerts to danger.
	The  symbol alerts the user to items that must never be carried out (are forbidden). The specific thing that must not be done is indicated by the design contained within the circle. In the case of the symbol at left, it means that the unit must never be disassembled.
	The  symbol alerts the user to things that must be carried out. The specific thing that must be done is indicated by the design contained within the circle. In the case of the symbol at left, it means that the power-cord plug must be unplugged from the outlet.

ALWAYS OBSERVE THE FOLLOWING

WARNING

Do not disassemble or modify by yourself



Do not carry out anything unless you are instructed to do so in the owner's manual. Otherwise, you risk causing malfunction.

Do not repair or replace parts by yourself



Be sure to contact your dealer, a DW/Roland service center, or an official DWe/Roland dealer. For a list of DW/Roland service centers and official DWe/Roland dealers, refer to the DW/Roland website.
USA: DW/DWe dealers Other regions: Roland service centers/ Roland dealers

Do not use or store in the following types of locations

- Subject to temperature extremes (e.g., direct sunlight in an enclosed vehicle, near a heating duct, on top of heat-generating equipment); or are



- Damp (e.g., baths, washrooms, on wet floors); or are
- Exposed to steam or smoke; or are
- Subject to salt exposure; or are
- Exposed to rain; or are

- Dusty or sandy; or are
- Subject to high levels of vibration and shakiness; or are
- Placed in a poorly ventilated location.

Use only the stand that is recommended

 This unit should be used only with a stand that is recommended by DW.

Do not place in a location that is unstable

 When using the unit with a stand recommended by DW, the stand must be carefully placed so it is level and sure to remain stable. If not using a stand, you still need to make sure that any location you choose for placing the unit provides a level surface that will properly support the unit, and keep it from wobbling.

Precautions regarding placement of this unit on a stand

 Be sure to follow the instructions in the Owner's Manual carefully when placing this unit on a stand. If it is not set up properly, you risk creating an unstable situation which could lead to the unit falling or the stand toppling, and may result in injury.

Avoid extended use at high volume

 Use of the unit at high volume for extended periods of time may cause hearing loss. If you ever experience any hearing loss or ringing in the ears, you should immediately stop using the unit and consult a specialized physician.

Do not allow foreign objects or liquids to enter unit; never place containers with liquid on unit



Do not place containers containing liquid (e.g., flower vases) on this product. Never allow foreign objects (e.g., flammable objects, coins, wires) or liquids (e.g., water or juice) to enter this product. Doing so may cause short circuits, faulty operation, or other malfunctions.

Unplug the unit if an abnormality or malfunction occurs

 In the following cases, immediately unplug the unit from computer and contact your dealer, a DW/Roland service center, or an official DWe/Roland dealer for service.

- If smoke or unusual odor occurs; or
- Objects have fallen into, or liquid has been spilled onto the unit; or
- The unit has been exposed to rain (or otherwise has become wet); or
- The unit does not appear to operate normally or exhibits a marked change in performance.

For a list of DW/Roland service centers and official DWe/Roland dealers, refer to the DW/Roland website.
USA: DW/DWe dealers Other regions: Roland service centers/ Roland dealers

Be cautious to protect children from injury



Always make sure that an adult is on hand to provide supervision and guidance when using the unit in places where children are present, or when a child will be using the unit.

Do not drop or subject to strong impact



Otherwise, you risk causing damage or malfunction.

Handle batteries carefully

If used improperly, you risk the dangers of fluid leakage, overheating, combustion, explosion, etc. Carefully observe the following:



- Do not heat, disassemble, or toss them into a fire or water.
- Do not expose them to sunlight, flame, or any other source of extreme heat.
- Do not attempt to charge a dry cell battery.



CAUTION

Use only the specified stand(s)



This unit is designed to be used in combination with specific stands (DW series) manufactured by DW. If used in combination with other stands, you risk sustaining injuries as the result of this product dropping down or toppling over due to a lack of stability.

Evaluate safety issues before using stands



Even if you observe the cautions given in the owner's manual, certain types of handling may allow this product to fall from the stand, or cause the stand to overturn. Please be mindful of any safety issues before using this product.

Avoid climbing on top of the unit, or placing heavy objects on it



Otherwise, you risk injury as the result of the unit toppling over or dropping down.

Disconnect all cords/cables before moving the unit



Damage or malfunction may result if you fail to disconnect all cables before moving the unit.

Handle batteries carefully

If used improperly, batteries may explode or leak and cause damage or injury. In the interest of safety, please read and observe the following precautions.



- Carefully follow the installation instructions for batteries, and make sure you observe the correct polarity.
- Avoid using new batteries together with used ones. In addition, avoid mixing different types of batteries.
- Remove the batteries whenever the unit is to remain unused for an extended period of time.
- Never keep batteries together with metallic objects such as ballpoint pens, necklaces, hairpins, etc.
- Used batteries must be disposed of in compliance with whatever regulations for their safe disposal that may be observed in the region in which you live.

Take care so as not to get fingers pinched



When handling the following moving parts, take care so as not to get fingers, toes, etc., pinched. Whenever a child uses the unit, an adult should be on hand to provide supervision and guidance.

- Stands
- Pedals
- Knobs

Keep small items out of the reach of children



To prevent accidental ingestion of the parts listed below, always keep them out of the reach of small children.

- Included Parts
- Drum key
- Removable Parts
- Screws
- Washers
- Nuts
- Felt washers
- Springs
- Knobs

Handle leaking batteries carefully



- Do not touch the liquid with your bare hands.
- If any of the leaking fluid gets into your eyes, the loss of vision may result. Do not rub your eyes; use clean water to flush them thoroughly. Then, promptly see a doctor.
- Burning of the skin or dermatitis may result if fluid has gotten onto your skin or clothing. Use clean water to flush affected areas thoroughly; then, promptly see a doctor.
- Using a soft cloth, carefully wipe any remaining fluid from the inside of the battery compartment. Then, install new batteries.

Thank you for joining the DWe family

Thank you for purchasing this DWe product. Throughout our history, our passion has been designing and making products that help drummers expand their art form and maximize their creativity. Solving problems for drummers means they can focus on the music and the performance because that's what matters most.

Thank you for putting your trust in DW, we don't take it lightly. We will continue to innovate so you can explore more sounds and take your playing to the next level!

Included components

* These will vary by the shell or cymbal pack configuration or if you purchased an individual drum or cymbal.

DWe Components & Configurations										
	4 PC Shell Pack	5 PC Shell Pack	Cym bal Pack 1	Cym bal Pack 2	Indi vidu al T om	Indi vidu al Fl oor Tom	Indi vidu al B ass Dru m	Indi vidu al S nare Dru m	Indi vidu al C ymb al	Indiv idual Hi H at
7×8 e33 Tom, DWE-DT1 Wireless Trigger, Mesh Batter Head					●					
8×10 e33 Tom, DWE-DT1 Wireless Trigger, Mesh Batter Head	●	●			●					
9×12 e33 Tom, DWE-DT1 Wireless Trigger, Mesh Batter Head		●			●					
12×14 e33 Tom, DWE-DT1 Wireless Trigger, Mesh Batter Head	●					●				
14×16 e33 Tom, DWE-DT1 Wireless Trigger, Mesh Batter Head		●				●				
5×14 e33 Snare drum, DWE-DT1 Wireless Trigger, Mesh Heads	●							●		
6.5×14 e33 Snare drum, DWE-DT1 Wireless Trigger, Mesh Heads		●						●		
14×20 e33 Bass Drum, DWE-DT1 Wireless Trigger, Mesh Batter Head	●						●			
16×22 e33 Bass Drum, DWE-DT1 Wireless Trigger, Mesh Batter Head		●					●			
Floor Tom Legs w/Memory Locks	●	●				●				

[illegible]

DWe Polymer Cymbal Felt			●						●	
DWe Polymer Cymbal Wing Nuts x2			●							
DWe Polymer Cymbal Felts x2			●							
DWe Polymer Cymbal Wing Nuts x3				●						
DWe Polymer Cymbal Felts x3				●						
DWe Hi Hat Clutch			●	●						●
DWe Hi Hat Cup			●	●						●
DWe Upper Hi Hat Stand Tube (Fits DW9000, DW5000 stands)			●	●						●
Quick Start Guide (This document)	●	●	●	●	●	●	●	●	●	●
DW Soundworks™ Product Key Card	●	●	●	●	●	●	●	●	●	●

IMPORTANT NOTES

Power Supply: Use of Batteries

- Batteries should always be installed or replaced before connecting any other devices. This way, you can prevent malfunction and damage.
- The life of the supplied batteries may be limited, since its primary purpose was to enable testing.
- If operating this unit on batteries, please use alkaline (type AA) batteries.
- When battery power gets too low, you risk fluid leakage. Replace the battery as soon as possible.

Placement

- Using the unit near power amplifiers (or other equipment containing large power transformers) may induce hum.
To alleviate the problem, change the orientation of this unit; or move it farther away from the source of interference.
- This unit may interfere with radio and television reception. Do not use this unit in the vicinity of such receivers.
- Noise may be produced if wireless communications devices, such as cell phones, are operated in the vicinity of this unit. Such noise could occur when receiving or initiating a call, or while conversing. Should you experience such problems, you should relocate such wireless devices so they are at a greater distance from this unit, or switch them off.
- Do not allow lighting devices that normally are used while their light source is very close to the unit (such as a

piano light), or powerful spotlights to shine upon the same area of the unit for extended periods of time. Excessive heat can deform or discolor the unit.

- When moved from one location to another where the temperature and/or humidity is very different, water droplets (condensation) may form inside the unit.

Damage or malfunction may result if you attempt to use the unit in this condition.

Therefore, before using the unit, you must allow it to stand for several hours, until the condensation has completely evaporated.

- Do not paste stickers, decals, or the like to this instrument. Peeling such matter off the instrument may damage the exterior finish.
- Depending on the material and temperature of the surface on which you place the unit, its rubber feet may discolor or mar the surface.
- Do not place containers or anything else containing liquid on top of this unit. Also, whenever any liquid has been spilled on the surface of this unit, be sure to promptly wipe it away using a soft, dry cloth.
- When connecting to the USB, OUTPUT (LEFT, RIGHT), MIX INPUT, and HEADPHONE OUT jacks, use a cable shorter than 10 ft/3 m.
- To prevent malfunction and equipment failure, always turn down the volume.

Maintenance

- Never use benzine, thinners, alcohol or solvents of any kind, to avoid the possibility of discoloration and/or deformation.

Repairs and Data

- Before sending the unit away for repairs, be sure to make a backup of the data stored within it; or you may prefer to write down the needed information.

Although we will do our utmost to preserve the data stored in your unit when we carry out repairs, in some cases, such as when the memory section is physically damaged, restoration of the stored content may be impossible.

DW assumes no liability concerning the restoration of any stored content that has been lost.

Additional Precautions

- Any data stored within the unit can be lost as the result of equipment failure, incorrect operation, etc. To protect yourself against the irretrievable loss of data, be sure to make a backup of the data stored within it; or you may prefer to write down the needed information.
- DW assumes no liability concerning the restoration of any stored content that has been lost.
- Use a reasonable amount of care when using the unit's buttons, sliders, or other controls; and when using its jacks and connectors. Rough handling can lead to malfunctions.
- When disconnecting all cables, grasp the connector itself—never pull on the cable. This way you will avoid causing shorts, or damage to the cable's internal elements.
- To avoid disturbing others nearby, try to keep the unit's volume at reasonable levels.
- This instrument is designed to minimize the extraneous sounds produced when it's played. However, since sound vibrations can be transmitted through floors and walls to a greater degree than expected, take care not to

allow these sounds to become a nuisance others nearby.

- When disposing of the packing carton or cushioning material in which this unit was packed, you must observe the waste disposal regulations that apply to your locality.
- Do not use connection cables that contain a built-in resistor.

Caution Regarding Radio Frequency Emissions

- The following actions may subject you to penalty of law.
- Disassembling or modifying this device.
- Removing the certification label affixed to the back of this device.
- Using this device in a country other than where it was purchased

Intellectual Property Right

- Drum Workshop, DWe, Soundworks, and DrumLink are either registered trademarks or trademarks of Drum Workshop, Inc. in the United States and/ or other countries.
- Company names and product names appearing in this document are registered trademarks or trademarks of their respective owners.

To get started, first download and install the DW Soundworks™ software

Visit <www.dwdrums.com/DWe/start> and click on the link to download the Roland Cloud Manager to activate, download and install the DW Soundworks™ software application and the DW Soundworks™ core sound library pack to your Mac or PC computer.

Once you have installed Roland Cloud Manager, locate the start card included in your box.

Enter the Product Activation Key in the designated field to validate your purchase and begin the download process.

The DW Soundworks™ application also includes the DWe Control app to connect (pair) your drums and cymbals. The DWe Control app allows you to adjust the triggering parameters as needed. See the DW Soundworks™ user guide for details.

You can download the DW Soundworks™ owner's manual at <www.dwdrums.com/DWe/support>

While your downloads are in process, please view the tutorial videos posted on <www.DWDrums.com/DWe/start> to familiarize yourself with the setup process and other related functions of the DWe Control and DW Soundworks™ applications.

Cymbal and drum setup

Time to set up your DWe e33 drums and cymbals!

* Your DWe drums are configured to arrive in electronic mode from the factory.

Drum setup

Precautions regarding placement of this unit on a stand

- Be sure to follow the instructions in the DWe Quick Guide carefully when placing this unit on a stand.
- If it is not set up properly, you risk creating an unstable situation which could lead to the unit falling or the stand toppling, and may result in injury.
- The tips of the cymbal mount and tom holder are sharp. Handle them with care.
- When setting up or storing the stand, be careful not to pinch the fingers you use to handle the stand.
- When setting up, ensure that the tripod of the stand is sufficiently open. If the tripod is insufficiently open, the

appropriate degree of stability might not be obtained.

You can mount DWe Drums on traditional tom and cymbal stands. Just make sure the tom L-arms are 12.7 mm in diameter, as smaller 10.5 mm arms do not work on the STM tom mounts.



The floor toms use the included floor tom legs with memory locks, so you can be sure the drum is set up the same way every time.



For the bass drum, simply loosen the bass drum spur to rotate the spur into position and extend the legs so the front of the bass drum is slightly elevated. This will ensure the bass drum beater on the bass drum pedal strikes the drumhead at 90° for extended drumhead life.

- * The tip of the spike is sharp; handle it with care.
- * Using the spike leg tips on wood flooring may damage the floor; the rubber leg tips should be used on wood flooring.
- * Take care not to pinch your fingers.



The snare drum can be mounted on a standard snare stand.





* You may want to tighten drumheads slightly as they may have loosened in transit or over time. Reliable triggering with the mesh drumheads is best achieved with medium-high tensions. Make sure to apply tension evenly around your drum. Start with 1/8th of a turn on the tension rods.



Drum playing areas: Zones

The drums are divided into multiple “zones”. Zones are the different striking areas to trigger different sounds.



Snare drum: Center, edge, rimshot, rim, and cross-stick zone

Center zone	Hit only the head of the snare drum. This is your primary snare sound.	
Edge zone	On the snare drum, the tone will change naturally as you move the strike location out from the center of the head toward the edge of the drum.	
Rimshot zone	Strike the head and the rim of the snare drum simultaneously to get the rimshot sound, it sounds different than the center.	
Rim zone	Strike the upper part of the snare rim without striking the head simultaneously. This will produce the rim sound.	
Cross-stick zone	The Cross-Stick zone is activated by hand pressure. To trigger a cross-stick sound simply rest your hand near the center while playing a cross-stick.	

* The DW Digi-MAG throw-off functions as a switch to allow a secondary set of sounds such as snare wires off. Try this as you play through the various Soundworks presets.



Rack tom and floor tom: Center, rimshot, and rim zone

<p>Center zone</p>	<p>Hit only the head of the tom drum. This is your primary tom sound.</p>	
<p>Rimshot zone</p>	<p>Strike the head and the rim of the tom simultaneously to get the rimshot sound, it sounds different than the center zone.</p>	
<p>Rim zone</p>	<p>Strike the upper part of the tom rim without striking the head simultaneously. This will produce the rim sound.</p>	

Bass drum: Center zone

Hit only the head of the bass drum. This is your primary bass drum sound.

* Both single and double bass drum pedals will work.

Cymbal setup

To use the DWE cymbals you can use any standard cymbal stand with 8 mm threaded cymbal tilter, but you will need to use the included polymer felts instead of standard cymbal felts. These specially designed felts allow the

cymbals to move in a more natural way.

First place the polymer felt on your cymbal sleeve. Then place the cymbal on the felt. Finally, use the plastic wingnut/felt to adjust how much sway you want the cymbal to have.



* The plastic wingnut has an 8 mm thread.

* You will need to substitute the upper hi-hat tube of your hi-hat stand. The included DWe hi-hat tube will fit DW9000 and DW5000 hi-hat stands or stands with a 1" tube diameter. Remove your upper hi-hat stand tube and then use the provided upper hi-hat tube, you will notice the threaded top to properly mount the electronic hi-hat's lower assembly.

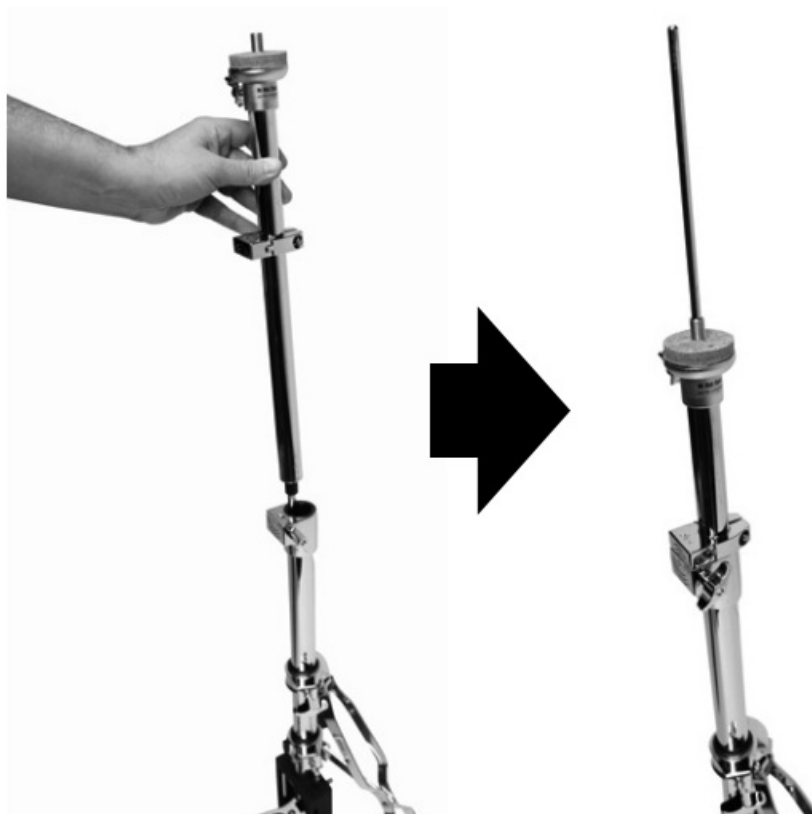

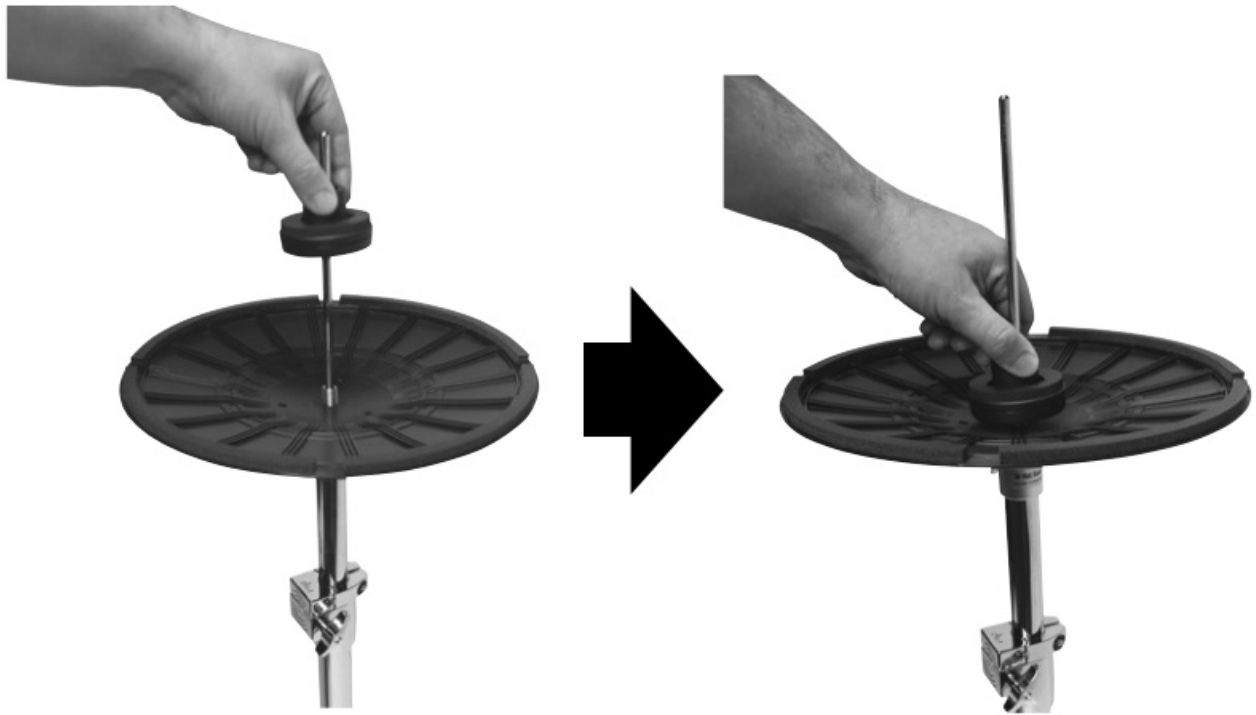

Next, place the lower hi-hat cymbal (black plastic) on the hi-hat felt, and screw on the provided hi-hat activator cup to the threaded upper tube to secure the lower hi-hat cymbal.

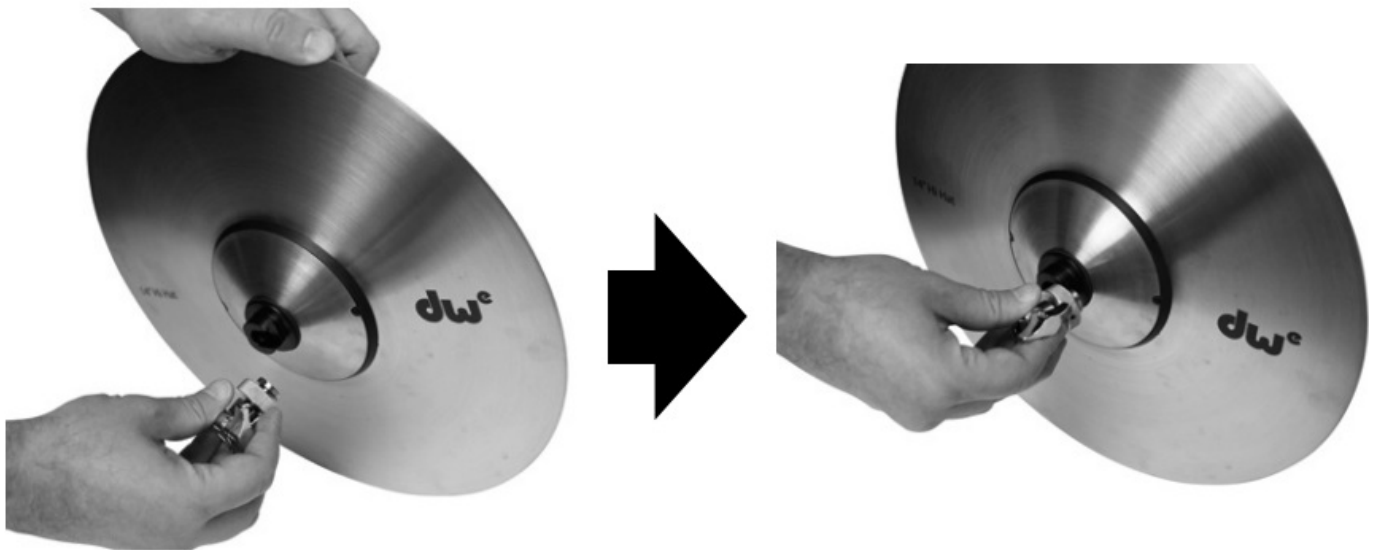

Finally, slide the included DWe hi-hat clutch into the top hihat cymbal then slide the hihat through the hi-hat rod and adjust the height to taste.

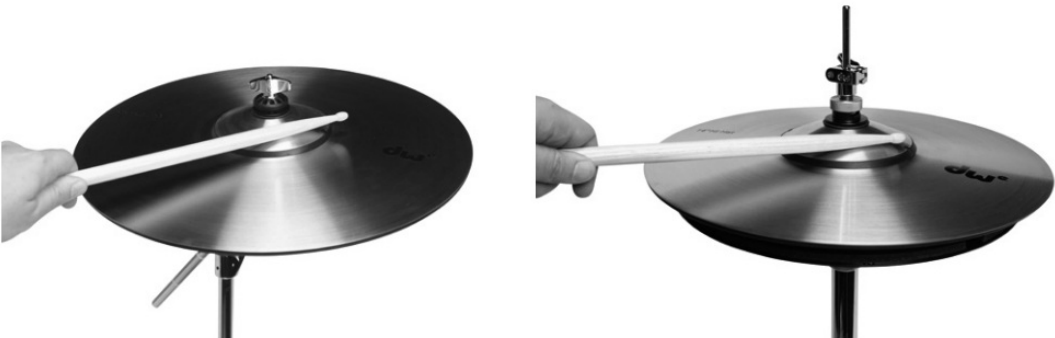

Cymbal playing areas: Zones, Cymbals: Edge, bow, bell zone

Edge zone	<p>The edge zone is activated when striking the edge of the cymbals.</p> 
Bow zone	<p>The bow zone is activated when striking the bow of the cymbal.</p> 
Bell zone	<p>This zone is activated when striking the bell of the cymbal. For light-to- medium bell sound, play the bell with the tips of the drumsticks. For a more aggressive bell sound, play the bell with the shank (or shoulder) of the stick.</p> 

A cymbal can be choked by using your hand to grasp the cymbal edge immediately after striking the cymbal to stop the cymbal sound. The cymbal choke area is near the outer area of the cymbal, 1 to 2 inches from the edge.



The hi-hat also has “foot chick” pedal close and “foot/heel splash” zones, the “foot chick” pedal closed zone

produces the sound of both the top and bottom hi-hat cymbal coming together when pressing fully down on the hi-hat pedal.



The foot/heel splash is accomplished by quickly pressing down the hi-hat pedal and then quickly opening the hi-hat immediately after the pedal is pressed closed.



DrumLink™ hub setup

Connect the DrumLink™ wireless USB hub to your Mac or PC computer with the provided USB Type-C® cable.

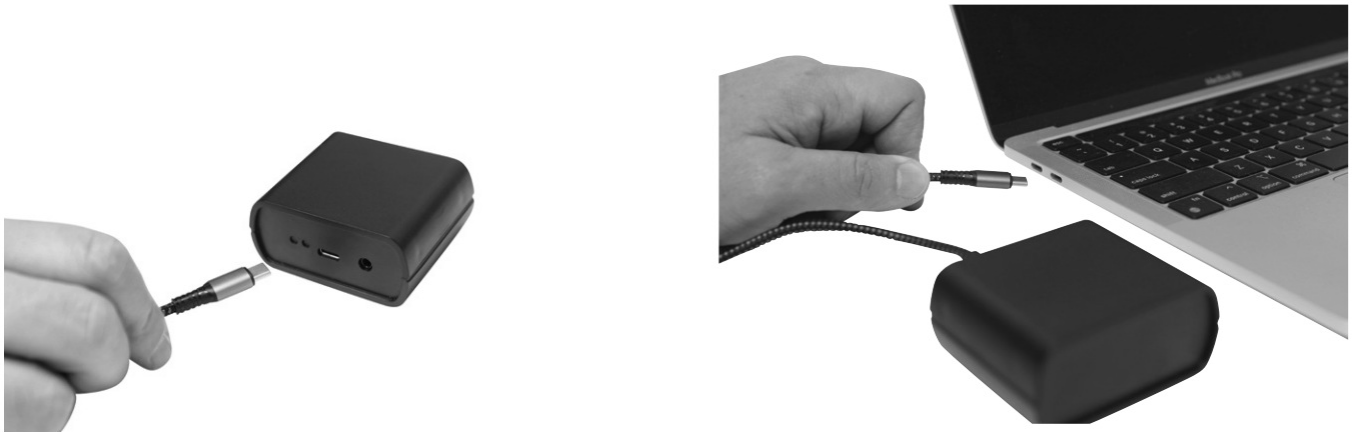

You can use a USB Type-C® to USB A adapter if your computer does not have a USB Type-C® port.

* A direct connection from the DrumLink™ hub to the computer is preferred.

* Do not use a USB cable that is designed only for charging a device. Charge-only cables cannot transmit data.

* Once the drums & cymbals are connected to the DrumLink™ hub a blue LED on the internal trigger will blink every few seconds during operation, this is normal.

RTap setup

Connect the RTap (Real-Time Audio Interface) to your Mac or PC computer with the provided USB Type-C® cable.

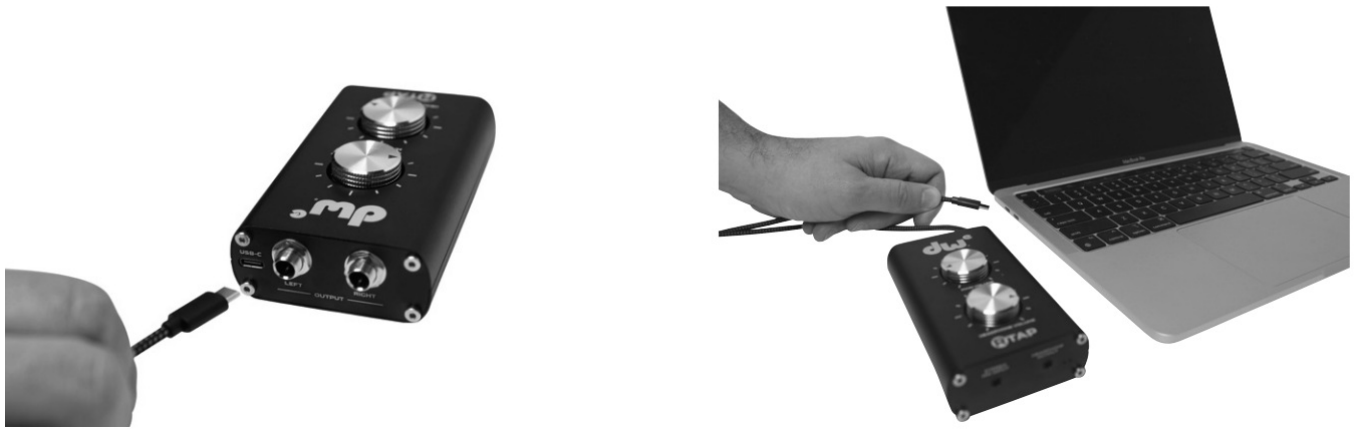

You can use a USB Type-C® to USB A adapter if your computer does not have a USB Type-C® port.

* You can use a USB extender hub and powered USB Type-C® hubs with the RTap.

You can connect headphones and/or speakers for audio monitoring through the RTap's headphone out or main L/R Out.

Using a laptop table such as the DW3800LS Laptop Table is recommended for keeping your laptop, RTap, and DrumLink™ USB hub stable and secure.

After your drums, cymbals, DrumLink™ and RTap are setup launch DW Soundworks™ to begin the pairing process in the DWe Control trigger settings app.

For detailed “how-to” instructions on any of the DWe operations and/or warranty questions, please visit

<www.dwdrums.com/DWe/support>

<www.dwdrums.com/warranty>

If you have any further questions, contact your local authorized DWe Dealer.

Drum Workshop Inc.
3450 Lunar Court
Oxnard, CA 93030 US
P: 1-800-45-DRUMS (800-453-7867)
DWe P/N: 09DEDCUSG000001
Rev A

Documents / Resources

	<p>dw DWE-DT1 Wireless Trigger Mesh Batter Head [pdf] User Guide DWE-DT1 Wireless Trigger Mesh Batter Head, DWE-DT1, Wireless Trigger Mesh Batter Head, Trigger Mesh Batter Head, Mesh Batter Head, Batter Head</p>
--	---

References

- [dw DWe Quick Start Guide | Drum Workshop Inc.](#)
- [dw DWe | Drum Workshop Inc.](#)
- [dw DWe Quick Start Guide | Drum Workshop Inc.](#)
- [dw DWe Support & Downloads | Drum Workshop Inc.](#)
- [dw Warranty | Drum Workshop Inc.](#)

- [User Manual](#)

[Manuals+](#), [Privacy Policy](#)

This website is an independent publication and is neither affiliated with nor endorsed by any of the trademark owners. The "Bluetooth®" word mark and logos are registered trademarks owned by Bluetooth SIG, Inc. The "Wi-Fi®" word mark and logos are registered trademarks owned by the Wi-Fi Alliance. Any use of these marks on this website does not imply any affiliation with or endorsement.