

AI M1 Smart Mouse



# AI M1 Smart Mouse User Manual

[Home](#) » [Ai](#) » AI M1 Smart Mouse User Manual 

## Contents

- [1 AI M1 Smart Mouse](#)
- [2 Product Information](#)
- [3 Product Usage Instructions](#)
- [4 Basic smart functions](#)
- [5 FCC Statement](#)
- [6 Frequently Asked Questions](#)
- [7 Documents / Resources](#)
  - [7.1 References](#)
- [8 Related Posts](#)



**AI M1 Smart Mouse**



## Product Information

### Specifications

- Connection Modes: USB (2.4G) and Bluetooth (BT3.0 or BT5.0)
- Charging Port: TypeC
- Charging Time: 1.5 hours for full charge
- Compatibility: Windows, Mac OS, Android systems
- Product Name: AI Smart Mouse
- Connection: USB (2.4G)+BT 5.0
- DPI sensitivity: 800~3200 Dpi
- Pickup distance: 1 meter
- Wireless recognition distance: 10 meters
- Number of function buttons: 6 pcs
- Charging port: Type-C interface/5V-1A
- Charging time: About 1.5 hours
- Support system: Windows 7/8/10/11
  - Android 9.0+
  - Mac os10.13+

## Product Usage Instructions

### Getting Started

1. Check the accessory list: AI smart mouse (including 2.4G receiver), TypeC charging cable, user manual.
2. Turn on the mouse power by turning on the power switch at the bottom of the mouse.

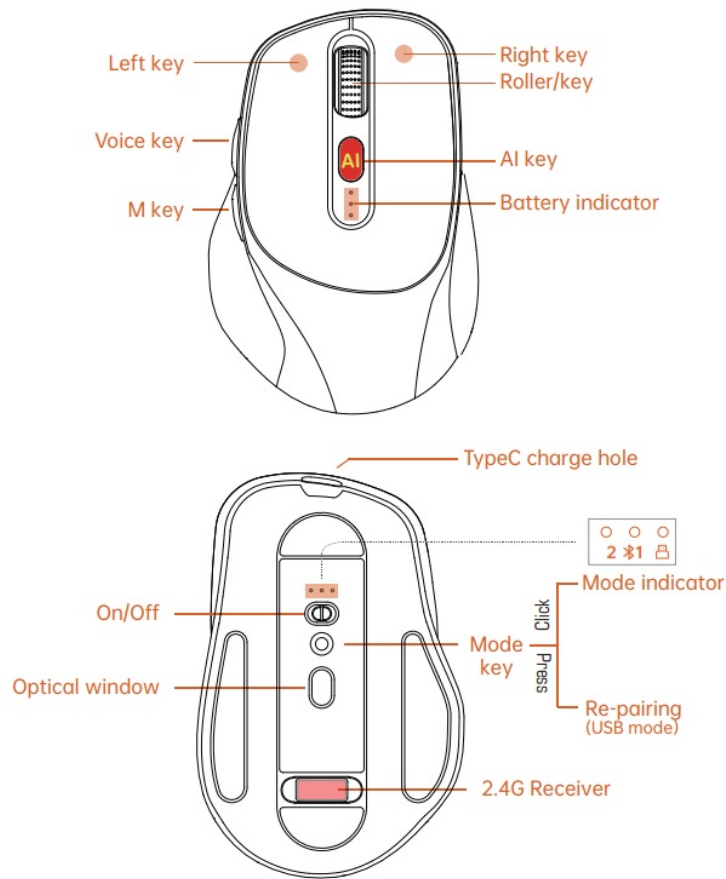

This product supports two connection modes: USB (2.4G) and Bluetooth (BT3.0 or BT5.0) for wireless connection to computers. After turning on the mouse power, pressing the mode switch button can switch the connection mode.

### Connection Modes

This product supports two connection modes: USB (2.4G) and Bluetooth (BT3.0 or BT5.0) for wireless connection to computers. Pressing the mode switch button allows you to switch between modes.



### USB Mode (2.4G)

Insert the 2.4G receiver into the computer's USB port to establish a connection.

1. Pull out the USB (2.4G) receiver from the bottom of the mouse and insert it into the computer USB port.
2. Turn on the mouse switch (the photoelectric window will flash. If the light is not turned on, it may be because the mouse battery is too low to turn on. Please charge it first).
3. Press the [Mode Switch] button until the 2.4G mode indicator light  lights up (usually default to USB mode at the factory).
4. Swipe the mouse, and if the cursor moves, it indicates a successful connection. At this point, this product can be used as a regular wireless mouse.
5. If the above automatic pairing is not successful, you can place the mouse close to the USB receiver, hold down the left and right keys, wait for the scroll wheel light to flash and turn off Or press and hold the “Mode Switch” button, and wait for the indicator light to flash and turn off , and then try again to see if the connection is successful.
6. To use the intelligent and AI functions of this mouse, you need to download and install the “AI Office” software.

### Bluetooth mode (BT3.0 or BT5.0)

This mouse supports connecting two computers simultaneously through Bluetooth, distinguished by Bluetooth 1 and Bluetooth 2. It can be switched and used by pressing the mode switch button.

1. Turn on the mouse switch (the photoelectric window will flash. If the light is not turned on, it may be because the mouse battery is too low to turn on. Please charge it first).
2. Press the [Mode Switch] button to switch to Bluetooth mode 1  and search for iMouse through computer Bluetooth to pair.
3. Swipe the mouse and the cursor moves to indicate a successful connection. At this point, this product can be used as a regular wireless mouse.
4. If you need to connect to a second computer, follow the same steps. Press the [Mode Switch] button to switch to Bluetooth mode 2  and the computer will search for iMouse Bluetooth to pair.
5. To control the first computer with this mouse, press the [Mode Switch] button to switch to Bluetooth mode 1. If you need to control the second computer, switch to Bluetooth mode 2.
6. To use the intelligent and AI functions of this mouse, please

### Bluetooth Mode (BT3.0 or BT5.0)

This mouse supports connecting two computers simultaneously through Bluetooth. Press the mode switch button to toggle between Bluetooth connections.

### Charging

1. When obtaining this mouse for the first time, please fully charge it before using it.
2. Mouse charging: Insert the TypeC charging head into the mouse charging port, and then connect the USB plug of the charging cable to the computer USB interface or a 5V-1.0A power adapter.
3. When the mouse battery is close to zero, it is expected to take 1.5 hours to fully charge.

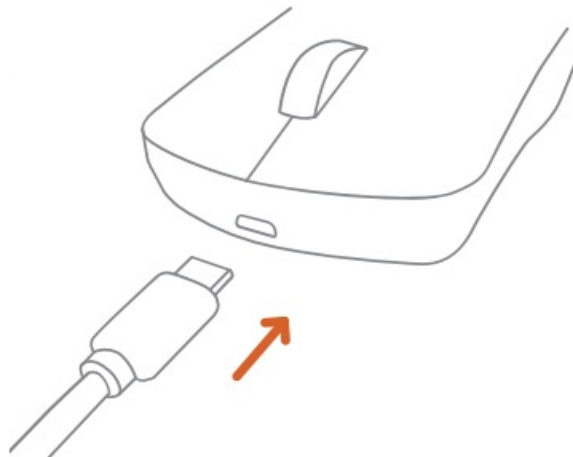

### Install AI Office Software

To utilize intelligent functions and AI features, download and install the AI Office software:

- **Windows System:** Visit [gpt-mouse.com](https://gpt-mouse.com) or press and hold the mouse scroll button to initiate software download.
- **Mac OS System:** Access the App Store or [gpt-mouse.com](https://gpt-mouse.com) for software download.
- **Android System:** Scan the provided QR code for download.

The intelligent functions (voice transcription, intelligent translation, custom shortcut keys, etc.) and AI functions of this product need to be used in conjunction with the “AI Office” software. Please download and install the AI Office software.

### Windows system

Log in to the website app. [gpt-mouse.com](https://gpt-mouse.com) to download the installation software for the corresponding computer system. Alternatively, press and hold the mouse scroll button for 5 seconds until an auto run window appears in the lower left corner of the computer screen and the software download webpage automatically opens (some computers do not support this feature).

### Mac OS system

Open the App Store of the system, search for “AI Office” to download and install, or log in to app. [gpt mouse.com](https://gpt-mouse.com) to download the corresponding software version of the computer system.

### Android system

Scan the QR code on the right to complete the download and installation.



### AI Smart Functions

If the “AI Office” software has been installed. Click the [AI key] to open the AI Office software, where you can use the voice transcription (converting voice into text), various intelligent translations, and custom shortcut keys with the M key of this mouse. And can use AI functions (Starfire AI, AI drawing, AI manuscript, etc.)

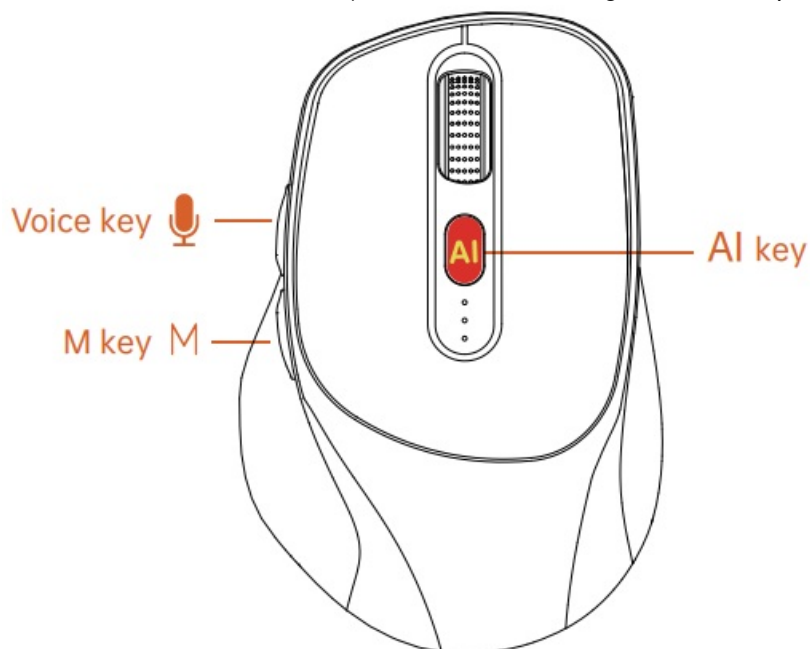



### Basic smart functions

#### Voice Typing

Use the M key for voice typing where recognized text is displayed in real-time during speech. To convert voice to text, move the mouse cursor over any text input box to use this function.

## It supports two methods:

- **Method 1:** Hold down the [  ] voice button and speak to the mouse. After speaking, release your hand and the mouse can transcribe your words (voice) into text.
- **Method 2:** Move the mouse cursor to any text input box, press the [  ] voice key once, speak to the mouse, and then press the [  ] voice key again to end the conversation. The system will automatically complete the voice transcription (this mode is also suitable for meeting voice recording).

**Reminder:** During your speech, the text box displays the preliminarily recognized text. If there is a significant difference from your original words, it is a normal phenomenon. After speaking, the system will make intelligent corrections based on the original meaning of your entire sentence or paragraph. Please try to avoid speaking a single character or word as much as possible, otherwise it is normal to recognize a character that is not what you actually want to say due to polyphonic characters. When using voice transcription function, try to keep the environment quiet and keep the mouse and mouth within 65cm.

## Dictionary Translation

In the AIOOffice software “My Device – Text Translation”, open [Word Translation]. When you use the mouse to select the text you want to translate, you can view the translation content in the translation pop-up window.

**Reminder:** Please set your native language (dialect) or commonly used language in the “My Device – Text Translation” section of the AIOOffice software, as well as the foreign language you need to translate frequently.

## OCR translation

After pressing the shortcut key [Ctrl+Q] on the keyboard, when the computer screen dims, use the mouse to swipe the text that needs to be translated to view the translation content in the translation pop-up window. (reminder: same as “Dictionary translation”)

## DPI setting

You can choose the appropriate DPI value (mouse sensitivity, larger values are more sensitive) in the AIOOffice software “My Devices” according to your usage habits or work needs.

## M-key custom functions

The M key can be customized as a variety of shortcut intelligent function keys. Please operate it in the “My Device – M Key Settings” section of the AI Office software. Optional functions include: Enter return to desktop, window switching, voice search, voice translation, screenshot translation, etc.

## Voice Search

When the [M] key is set to the [Voice Search] key, holding down the [M] key allows you to directly say to the mouse to open a website, software/application, or file.

**Reminder:** Before using this feature, you need to check the commonly used software or application in the “My Devices – Voice Search” section of the AIOOffice software. If individual software or applications cannot recognize it accurately, please find the path to their executable file (usually with the suffix “. exe”) and design a search command word \* \* \* (i.e. you call it “open \* \* \*” with the same name). Open a file or file, similar to.

## Voice translation

When the [M] key is set to the [Word Translation] key, hold down the [M] key, and the mouse can directly transcribe your spoken language into a foreign language. You can use this function to quickly communicate with your foreign friends or customers in a foreign language. (Reminder: Same as “voice transcription”)

## ChatGPT

At any time, click the [AI] button to open ChatGPT (or open AI Office and click to open ChatGPT). In the ChatGPT dialogue window, you can ask ChatGPT any questions or help you write copy (speech, congratulatory message, advertising slogan, work summary, etc.), help you write professional documents (contracts, patent disclosure documents, papers, manuals, etc.), and help you create PPTs, mind maps, etc.

**Reminder:** In the AI dialog box, you can type directly, or use the voice transcription function (voice key) of this mouse, or hold down the AI key to speak, to transcribe the voice into text and send it to the AI at the same time. When asking questions or asking for AI to help you write, try to convey necessary information to AI like telling your employees or secretary about this job, avoiding ambiguity in your words, so that AI can answer more in line with your requirements.

To use ChatGPT for the first time, you need to follow the prompts to register an account. The default binding for AI mice is ChatGPT3.5 free version. If you need to use ChatGPT4.0 or higher, according to local policies, corresponding service fees may be required. Please determine according to your own needs.

### **You can ask ChatGPT Example:**

- “May I ask who are the four ancient civilizations of the world?”
- “Can you tell me about some major cities in China?”
- “Tell me about a famous historical figure from China ”

### **Call ChatGPT write for you Example:**

- “I am Musk, and I will be giving a speech at New York University next week. The topic of my speech is “my dream”. Please help me write a speech. The core information is artificial intelligence, with an inspiring tone and rich information.”
- “Please extend this speech to a longer length, introducing more about the applications of artificial intelligence in people’s daily lives and work, suitable for a 10 minute speech time.”
- “I have an idea to design a cleaner that can be pasted on the wall and rubbed on the back. Please help me write a patent disclosure letter.”
- “I would like to sell AI smart mouse in France. Could you please help me analyze the sales prospects of this product in France?”
- “Please help me write a purchase letter for an AI smart mouse.”
- “Help me create a PowerPoint presentation for an AI smart mouse (focusing on its unique features such as AI intelligent Q&A, intelligent writing, voice transcription, and intelligent translation) and market prospects.”
- “Please help me write a wonderful introduction to AI smart mice, within 100 words, and I want to promote it on my social media.”

### **Smart AI+**

If there is a “+” on the top right of your AI Office work interface, it means that your AI Office can freely load more web-based AI applications such as AI painting, AI image editing, AI video, AI music, AI-PPT, etc.) or commonly used URLs, and can be sorted and deleted.

**Reminder:** AI Office provides the “+” loading function, but cannot guarantee that all web-based AI applications or commonly used URLs can be properly adapted. Please choose to load based on your actual situation. Other AI applications you load may involve related charges from the developer or service provider, so please choose carefully.

### **FCC Statement**

Changes or modifications not expressly approved by the party responsible for compliance could void the user's authority to operate the equipment. This equipment has been tested and found to comply with the limits for a Class B digital device, pursuant to Part 15 of the FCC Rules. These limits are designed to provide reasonable protection against harmful interference in a residential installation. This equipment generates uses and can radiate radio frequency energy and, if not installed and used in accordance with the instructions, may cause harmful interference to radio communications. However, there is no guarantee that interference will not occur in a particular installation.

If this equipment does cause harmful interference to radio or television reception, which can be determined by turning the equipment off and on, the user is encouraged to try to correct the interference by one or more of the following measures:

- Reorient or relocate the receiving antenna.
- Increase the separation between the equipment and receiver. -- Connect the equipment into an outlet on a circuit different from that to which the receiver is connected.
- Consult the dealer or an experienced radio/TV technician for help.

### **FCC Radiation Exposure Statement**

The device has been evaluated to meet general RF exposure requirement. The device can be used in portable exposure condition without restriction. This device complies with Part 15 of the FCC Rules.

### **Operation is subject to the following two conditions:**

1. This device may not cause harmful interference.
2. This device must accept any interference received, including interference that may cause undesired operation.

**Reminder:** Due to continuous optimization and updates of the product and software, the illustrations in this manual are for reference only. Please refer to the actual product for accuracy.

**Warn:** If the battery is used improperly, it may lead to leakage and explosion, etc. Into personal injury or fire. Do not expose it to humid and high temperature environments, and avoid contact with conductive materials Or liquid.

**Look out:** It is recommended to use a charger marked "Output 5V-1A" for charging, when charging. Keep this product away from heat sources such as heating equipment. Please... Do not disassemble, repair or modify the product yourself. Keep away from the eyes of children or animals when using the product indicator light.

### **Frequently Asked Questions**



Breakdown	Possible cause	Solution
USB no response	Poor USB contact	Receiver is plugged into another USB port
Unable to Bluetooth	Bluetooth version is low	Connect using receiver mode
	Win7 does not support Bluetooth connectivity	
Cursor cannot move	Not boot	Turn on the power
	Low battery	Use after charging
	Failed to connect to the computer	Follow the Bluetooth mode USB receiver pairing method to reconnect the computer
Speech dysfunction	Software download error	Download the correct driver and try again
	The driver is not started	Start the driver and try again
	The computer is not connected to the Internet or the network quality is poor	Check that the network is normal
Poor speech recognition	Ambient noise	Use in a relatively quiet environment
	Speak too little/loudly	Speak at a normal volume
	Speak too fast unclear	Speak at a normal pace
	Away from the mouse	Try again within 65cm of the mouse
Voice typing is not possible in some software	Restricted by permissions	Exit the AI Office driver and restart with administrator rights
	360 and other antivirus software restrictions	Exit 360 Security Guard and antivirus software, and add AI Office software to the whitelist of antivirus software
MAC indicates malicious programs	The driver software is not available in the Mac APP Store	In MAC, go to System Preferences > Security & Privacy > General > Still Open

• **Q: How do I switch between Bluetooth connections on the mouse?**

**A:** To switch between Bluetooth connections, press the mode switch button on the mouse until you reach the desired Bluetooth connection (Bluetooth 1 or Bluetooth 2).

• **Q: Can I use the mouse while it is charging?**

**A:** Yes, you can continue using the mouse while it is charging via the TypeC charging cable connected to a power source.

• **Q: How can I access the intelligent functions of the mouse?**

**A:** To access intelligent functions like voice transcription and intelligent translation, install the AI Office software and use the AI key on the mouse to open the software.

## Documents / Resources

	<p><a href="#">AI M1 Smart Mouse</a> [pdf] User Manual M1, M1 Smart Mouse, Smart Mouse, Mouse</p>
---	---

## References

- [MOUSE.com](#)
- [User Manual](#)

## **Manuals+. Privacy Policy**

This website is an independent publication and is neither affiliated with nor endorsed by any of the trademark owners. The "Bluetooth®" word mark and logos are registered trademarks owned by Bluetooth SIG, Inc. The "Wi-Fi®" word mark and logos are registered trademarks owned by the Wi-Fi Alliance. Any use of these marks on this website does not imply any affiliation with or endorsement.