



## 8BitDo N64 Mod Kit for Controller Joystick Instructions

[Home](#) » [8Bitdo](#) » 8BitDo N64 Mod Kit for Controller Joystick Instructions 

### Contents

- [1 8BitDo N64 Mod Kit for Controller Joystick](#)
- [2 WHAT IN BOX](#)
- [3 INSTALLATION](#)
- [4 Instruction manual](#)
- [5 Switch](#)
- [6 Wired Connection](#)
- [7 Android / Windows](#)
- [8 Documents / Resources](#)

# 8BitDo®

**8BitDo N64 Mod Kit for Controller Joystick**



Please handle it with care. We are not responsible for any damage caused in use.

## WHAT IN BOX



## INSTALLATION

①

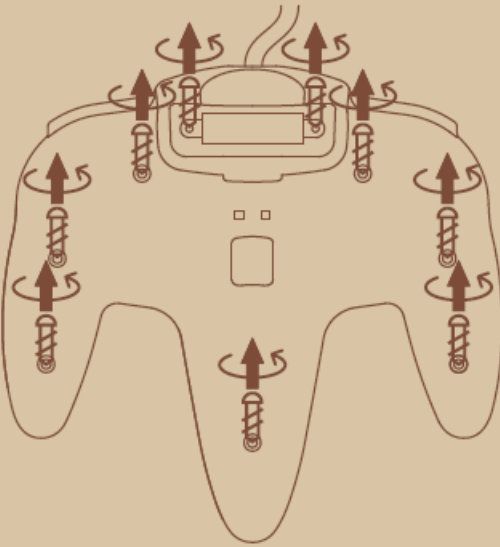

②

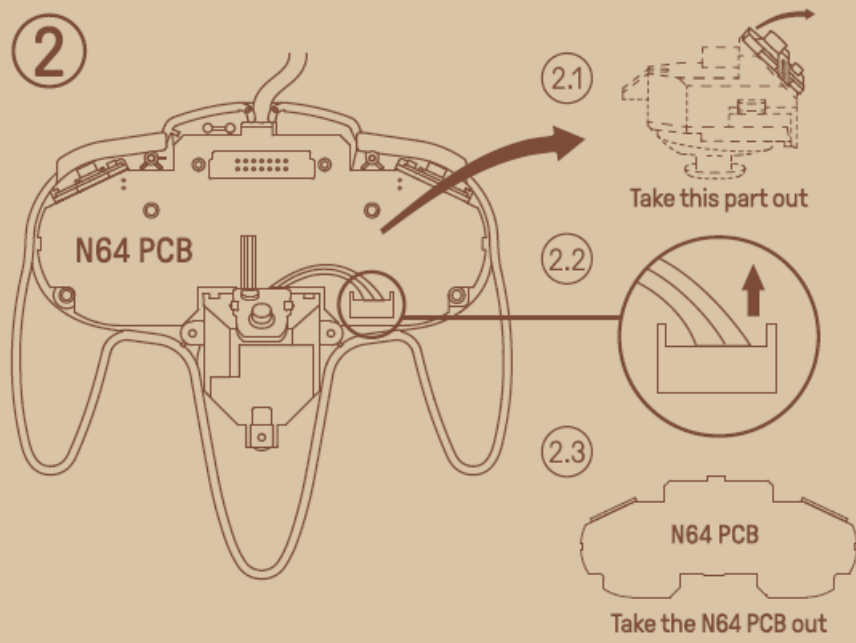

3

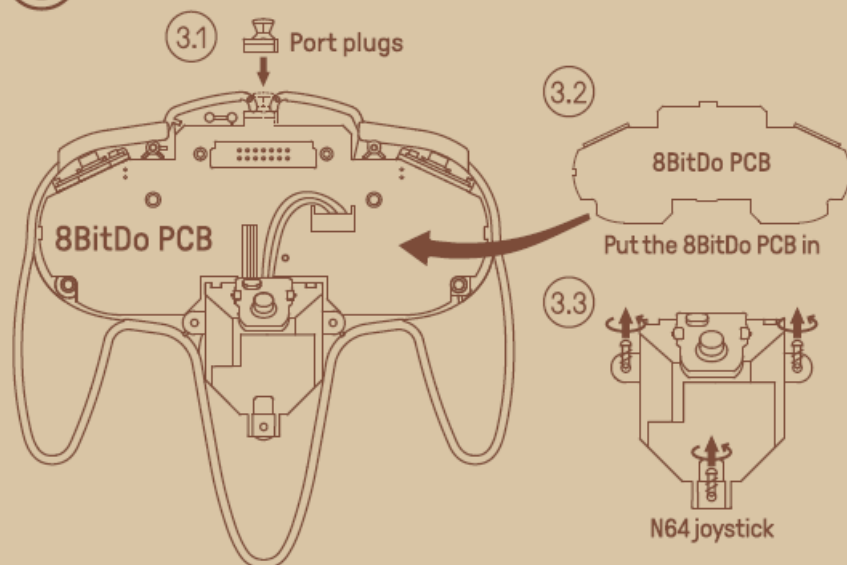

4

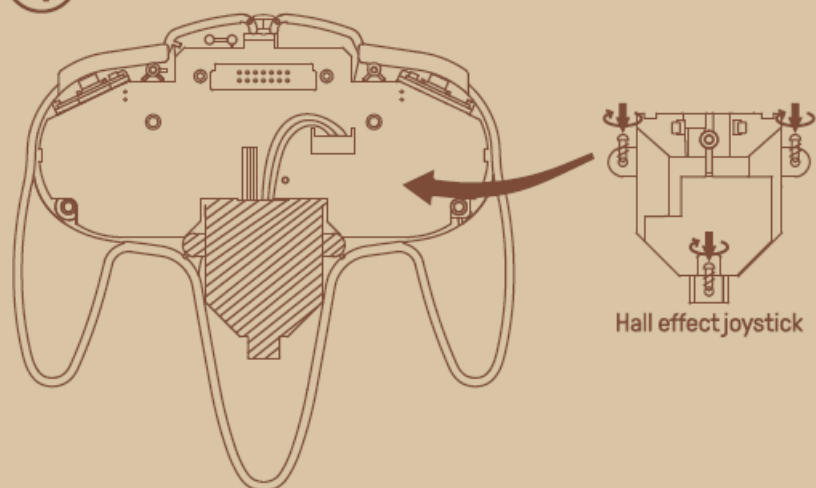

5

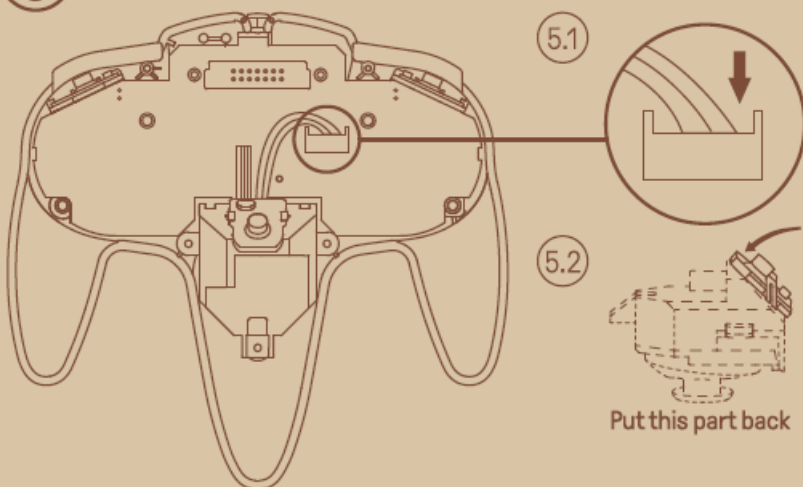

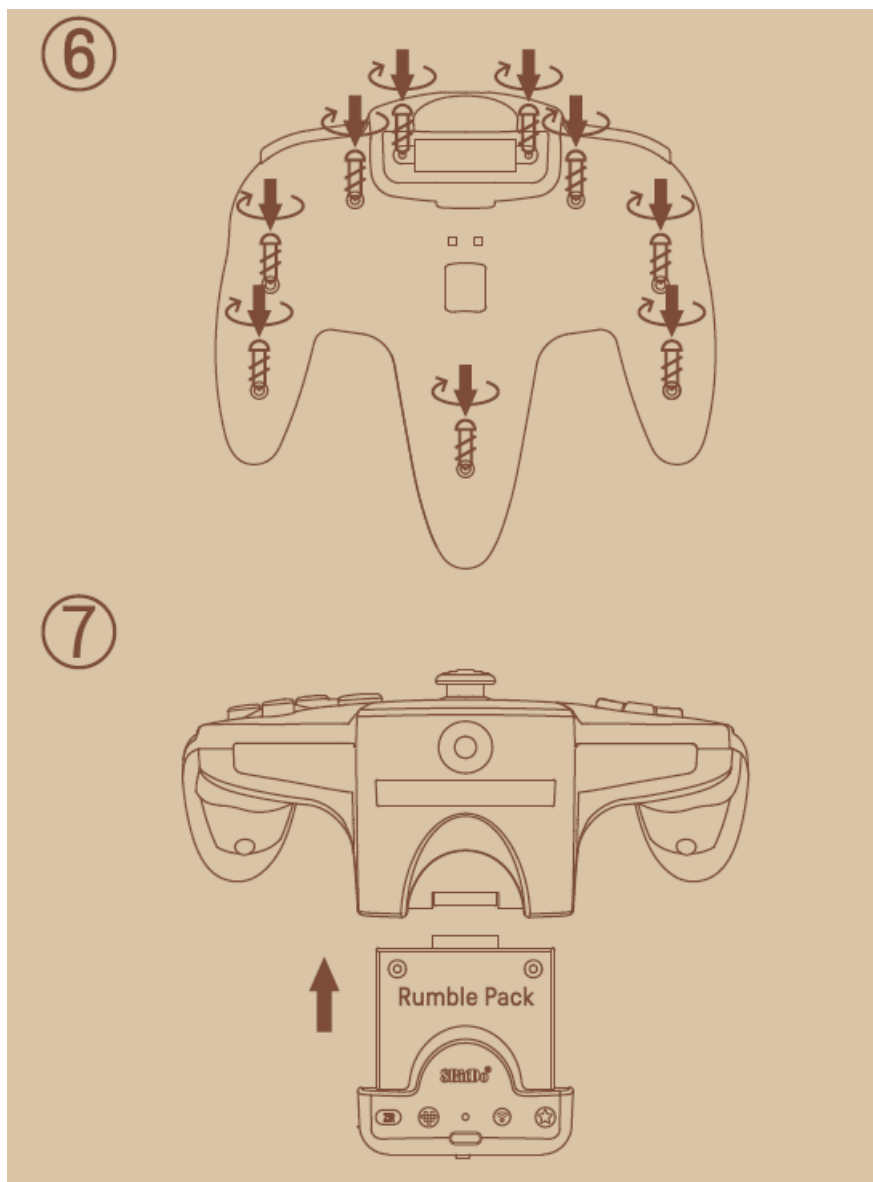

## Instruction manual

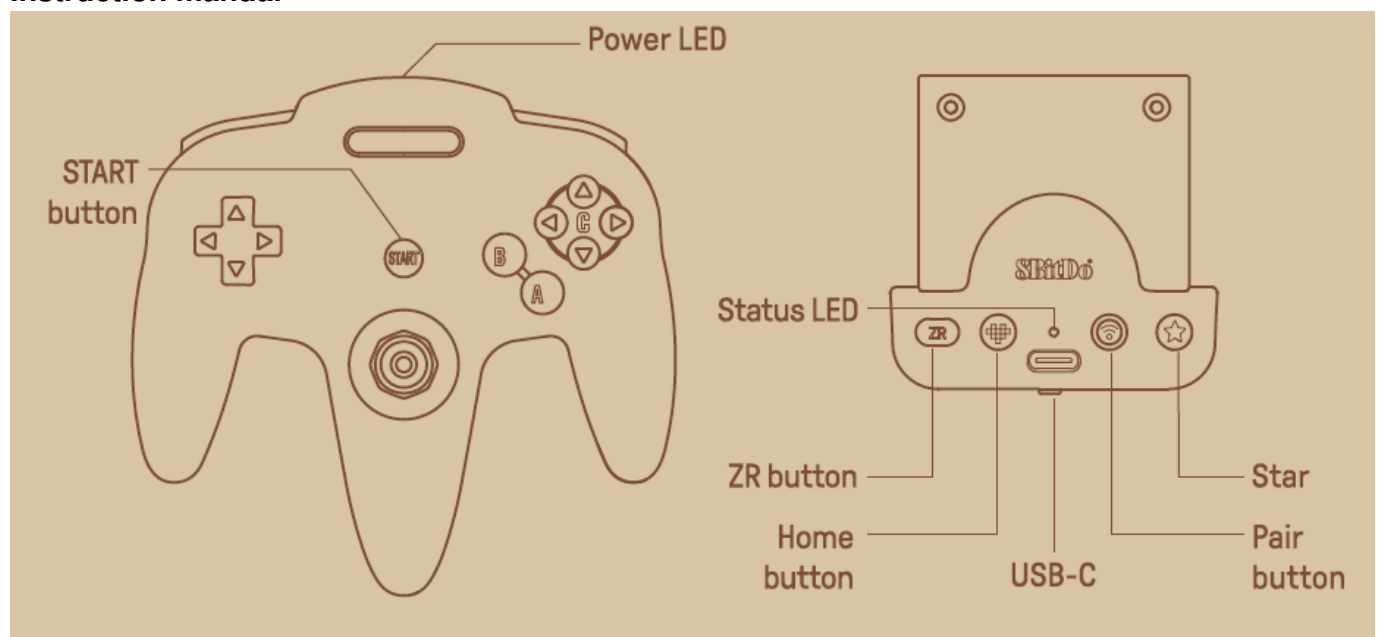

- Press Start button to turn on the controller.
- Hold start button for 3 seconds to turn off the controller.
- Hold Start button for 8 seconds to force the controller to shut down.

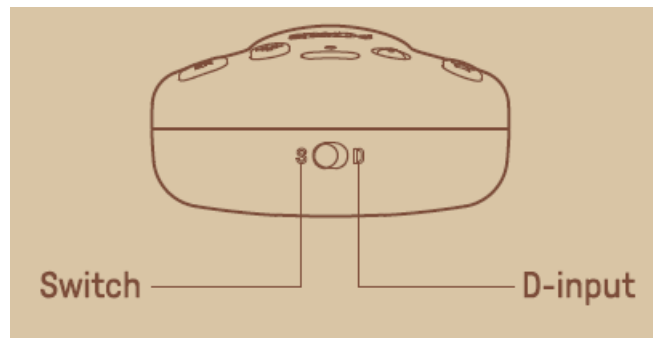

## Switch

Please ensure your Switch system is the latest version. Bluetooth

1. Turn the mode switch to [SJ.
2. Press Start to turn on the controller.
3. Hold pair button for 3 seconds to enter its pairing mode, LED starts to blink rapidly. (This is required for the very first time only]
4. Go to your Switch Home page to click on [Controllers], then click on [Change grip/order] and wait for the connection.
5. LED becomes solid when the connection is successful.

## Wired Connection

Go to System Setting > Controllers and Sensors> turn on Pro Controller Wired Communication

1. Turn the mode switch to [SJ.
2. Connect the controller to your Switch dock via USB cable.
3. Wait till the controller is successfully recognized by your Switch to play

## Android / Windows

### Bluetooth

1. Turn the mode switch to [DJ.
2. Press Start to turn on the controller.
3. Hold pair button for 3 seconds to enter its pairing mode, LED starts to blink rapidly. (This is required for the very first time only)
4. Go to your Android/Windows device's Bluetooth setting and pair with [SBitDo N64 Modkit].
5. LED becomes solid when the connection is successful.

### Wired Connection

1. Turn the mode switch to [DJ.
2. Connect the controller to your Android/Windows device via USB cable, then wait till the controller is successfully recognized by your Android/Windows device to play.

## Turbo

- D-Pad, joysticks, Star button are not supported.
- Star button equals to screenshot when connected to Switch.
- Hold the button you would like to set turbo functionality to, then press the star button to activate/deactivate its turbo functionality.

## Battery

About 8 hours of playtime with a 500mAh built-in battery pack, rechargeable with 1 to 2 hours charging time.

### LED indicator status:

- **Charging** LED stays solid
- **Fully charged** LED light out
- **Low battery** LED blinks

It will automatically shut down if it is not connected within 1 minute or if there is no operation within 15 minutes after startup.

It will not automatically shut down when it is on wired connection

## Support

Please visit [support8bitdo.com](https://support8bitdo.com) for further information & additional support.

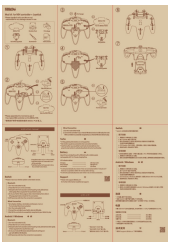

## Documents / Resources

	<p><a href="#">8BitDo N64 Mod Kit for Controller Joystick</a> [pdf] Instructions N64 Mod Kit for Controller Joystick, N64, Mod Kit for Controller Joystick, Controller Joystick, Joystick</p>
---	---