



# 8BitDo N30 Mod Kit for NES/NES Classic Controller Instructions

[Home](#) » [8Bitdo](#) » 8BitDo N30 Mod Kit for NES/NES Classic Controller Instructions 

## Contents

- [1 8BitDo N30 Mod Kit for NES/NES Classic](#)
- [2 InstructionS](#)
- [3 Bluetooth connection](#)
- [4 8Bitdo Retro Receivers and use Adapter](#)
- [5 Button Mapping](#)
- [6 Battery](#)
- [7 Support](#)
- [8 Documents / Resources](#)
- [9 Related Posts](#)



**8BitDo N30 Mod Kit for NES/NES Classic**



## Instructions

\* Please handle it with care. We are not responsible for any damage caused in use.

We are not responsible for any damage caused in use.

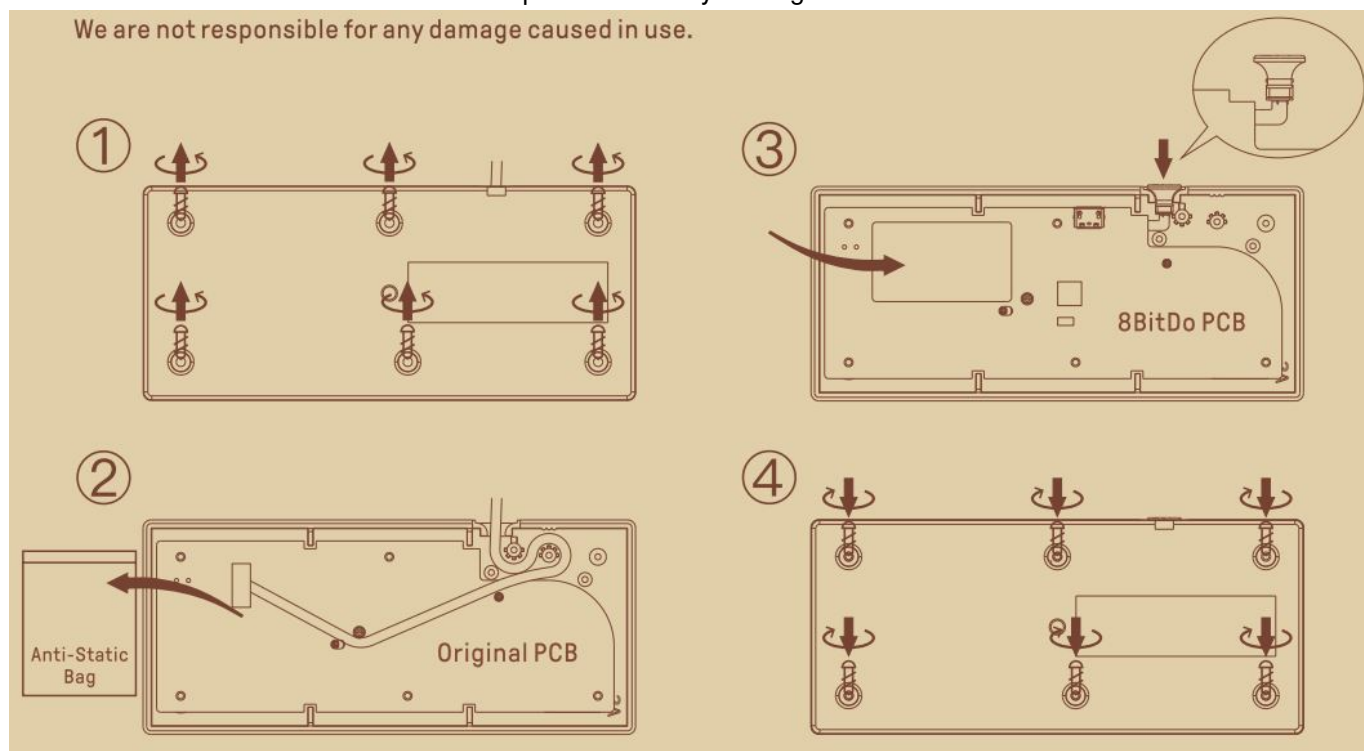

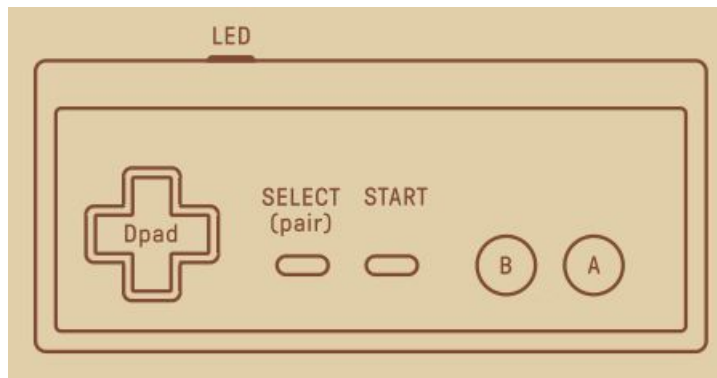

Press START to turn on the controller

Press and hold START for 3 seconds to turn off the controller Press and hold START for 8 seconds to force turn off the controller

## Bluetooth connection

### switch

1. Press START +LEFT to turn on the controller, LEO will blink 4 times per cycle.
2. Press and hold SELECT for 3 seconds to enter pairing mode. LEO will rapidly blink.
3. Goto your Switch Home Page to click on Controllers, then click on Change Grip/Order and waitfor controllerto sync up. LEO will become solid when connection is successful.
4. Controller will auto reconnect to your Switch with the press of START once it has been paired.

'When connected to your Switch, OOWN+SELECT = Switch HOME button.

### Andriod

1. Press START +8 to turn on the controller, LEO will blink once per cycle.
2. Press and hold SELECT for 3 seconds to enter pairing mode. LED will rapidly blink.
3. Go to your Android device's Bluetooth setting, pair with [88itdo N30 Modkit). LEO will become solid when connection is successful.
4. Controller will auto reconnectto your Android device with the press of START once it has been paired.

## WINDOWS

1. Press START +UP to turn on the controller, LEO will blink twice per cycle.
2. Press and hold SELECT for 3 seconds to enter pairing mode. LED will rapidly blink.
3. Go to your windows device's Bluetooth setting, pair with [8Bitdo N30 Mod kit]. LEO will become solid when the connection is successful.
4. Controller will auto reconnect to yourWindows device with the press of START once it has been paired

### macOS

1. Press and hold START +A to turn on the controller, LEO will blink3times per cycle.
2. Press and hold SELECTfor 3 seconds to enter pairing mode. LEO will rapidly blink.
3. Go to your macOS device's Bluetooth setting, pair with [Wireless Controller]. LEO will become solid when the

connection is successful.

4. Controller will auto-reconnect to your macOS device with the press of START once it has been paired.

## 8Bitdo Retro Receivers and use Adapter

1. Press START + B to turn on the controller, LEO will blink once per cycle.
2. Press both the PAIR buttons on the receiver/Adapter and SELECT on the controller to sync them.
3. Both LEDs on the receiver/Adapter and controller will become solid when the connection is successful.

## Button Mapping

Press and hold HOTKEY for 3 seconds to map OPAD and other buttons, LED will blink once in red when successful:

1. SELECT+UP: OPAD → DPA0
2. SELECT+ LEFT: DPAD → LEFT JOYSTICK
3. SELECT+RIGHT: DPAD → RIGHT JOYSTICK
4. SELECT+DOWN: Swap A → B and X → Y

Works only before connecting anything.

## Battery

- Status-LEO Indicator
- Low battery mode – Red LED blinks
- Battery charging -Red LEO stays solid
- Battery fully charged -LEO turns off

built-in 230mAh Li-ion with 10 hours of play time. "Rechargeable via USB cable with 30 minute charging time."

## Support

Please visit <http://support.8bitdo.com.tor> for further information and additional support.

## Documents / Resources

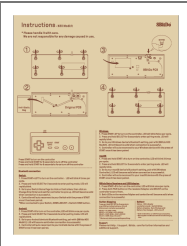
	<p><b>8Bitdo N30 Mod Kit for NES/NES Classic Controller</b> [pdf] Instructions N30, Mod Kit for NES NES Classic Controller, N30 Mod Kit for NES NES Classic Controller</p>
---	--