

## 8BitDo M30 Mod Kit for MD Controller Instruction Manual

[Home](#) » [8Bitdo](#) » 8BitDo M30 Mod Kit for MD Controller Instruction Manual 

### Contents

- [1 8BitDo M30 Mod Kit for MD Controller](#)
- [2 InstructionS-M30Modkit](#)
- [3 Bluetooth connection](#)
- [4 Android](#)
- [5 WINDOWS](#)
- [6 8Bitdo Retro Receivers and use Adapter](#)
- [7 Battery](#)
- [8 Support](#)
- [9 Documents / Resources](#)
- [10 Related Posts](#)



### 8BitDo M30 Mod Kit for MD Controller

8BitDo M30 Mod Kit for MD Controller

### InstructionS-M30Modkit

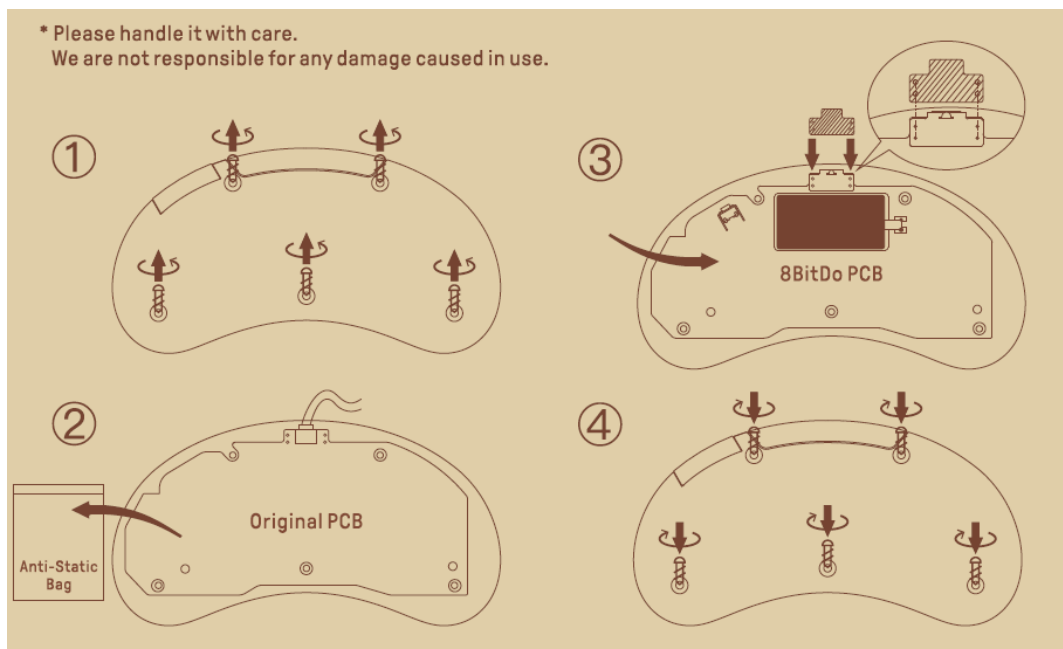

- Please handle it with care.
- We are not responsible for any damage caused in use.

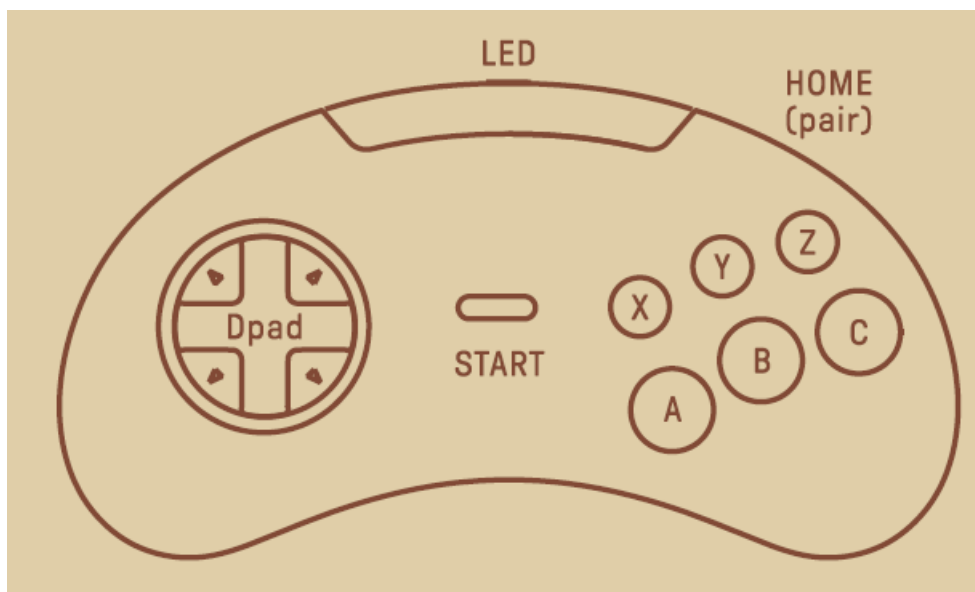

Press start to turn on the controller

Press and hold START for 3 seconds to turn off the controller Press and hold START for 8 seconds to force turn off the controller

## Bluetooth connection

### Switch

1. Press START + Y to turn on the controller, LED will blink 4 times per cycle.
2. Press and hold MODE for 3 seconds to enter pairing mode. LED will rapidly blink.
3. Go to your Switch Home Page to click on Controllers, then click on Change Grip/Order and wait for the controller to sync up. LED will become solid when the connection is successful.
4. The controller will auto-reconnect to your Switch with the press of START once it has been paired.

When connected to your Switch, DOWN+HOME = Switch HOME button.

## **Android**

1. Press START +B to turn on the controller, the LED will blink once per cycle.
2. Press and hold MODE for 3 seconds to enter pairing mode. LED will rapidly blink.
3. Go to your Android device's Bluetooth setting, and pair with [8Bitdo M30 Mod kit]. LED will become solid when the connection is
4. The controller will auto-reconnect to your Android device with the press of START once it has been paired.

## **WINDOWS**

1. Press START +X to turn on the controller, LED will blink twice per cycle.
2. Press and hold MODE for 3 seconds to enter pairing mode. LED will rapidly blink.
3. Go to your windows device's Bluetooth setting, and pair with [8Bitdo M30 Modkit]. LED will become solid when connection is successful.
4. The controller will auto-reconnect your Windows device with the press of START once it has been paired

## **macOS**

1. Press and hold START +A to turn on the controller, LEO will blink 3 times per cycle.
2. Press and hold MOOE for 3 seconds to enter pairing mode. LEO will rapidly blink.
3. Go to your macOS device's Bluetooth setting, pair with [Wireless Controller]. LEO will become solid when connection is successful.
4. The controller will auto-reconnect to your Windows device with the press of START once it has been paired.

## **8Bitdo Retro Receivers and use Adapter**

1. Press START +B to turn on the controller, the LED will blink once per cycle.
2. Press both the PAIR button on the receiver/Adapter and MOOE on the controller to sync them.
3. Both LEDs on the receiver/Adapter and controller will become solid when connection is successful.

## **Button Mapping**

Press and hold HOTKEY for 3 seconds to map\ OPAD and other buttons, the LED will blink once in! red when successful:

- HOME+ UP: DPAD™ DPAO
- HOME+ LEFT: OPPO • LEFT JOYSTICK
- HOME+RIGHT: DPAO• RIGHTJOYSTICK
- HOME+ DOWN: Swap A-B and-Y

## **Battery**

- Status-LEO Indicator
- Low battery mode- Red LED blinks

- Battery charging – Rad LEO stays solid
- Battery fully charged -LEO turns off

## Support

Please visit <http://support.bbitdo.com> /for further information and additional support.

## Documents / Resources

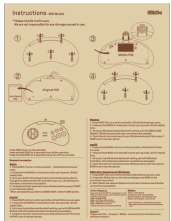

[8BitDo M30 Mod Kit for MD Controller](#) [pdf] Instruction Manual  
M30, Mod Kit for MD Controller, M30 Mod Kit for MD Controller

[Manuals+.](#)