



8Bitdo 6922621504290 Retro Mechanical Keyboard Instruction Manual

[Home](#) » [8Bitdo](#) » 8Bitdo 6922621504290 Retro Mechanical Keyboard Instruction Manual 

Contents

- [1 8Bitdo 6922621504290 Retro Mechanical Keyboard](#)
- [2 Retro Mechanical Keyboard](#)
- [3 2.4G Connection](#)
- [4 Wired Connection](#)
- [5 Bluetooth Connection](#)
- [6 Battery](#)
- [7 Fast Key Mapping](#)
- [8 FAQs](#)
- [9 Video-8BitDo Retro Mechanical Keyboard](#)
- [10 Reference Link](#)
- [11 References](#)

8Bitdo

8Bitdo 6922621504290 Retro Mechanical Keyboard



Retro Mechanical Keyboard

- Interfaces for 8BitD0 Super Buttons only

- Requires Bluetooth Low Energy or USB port

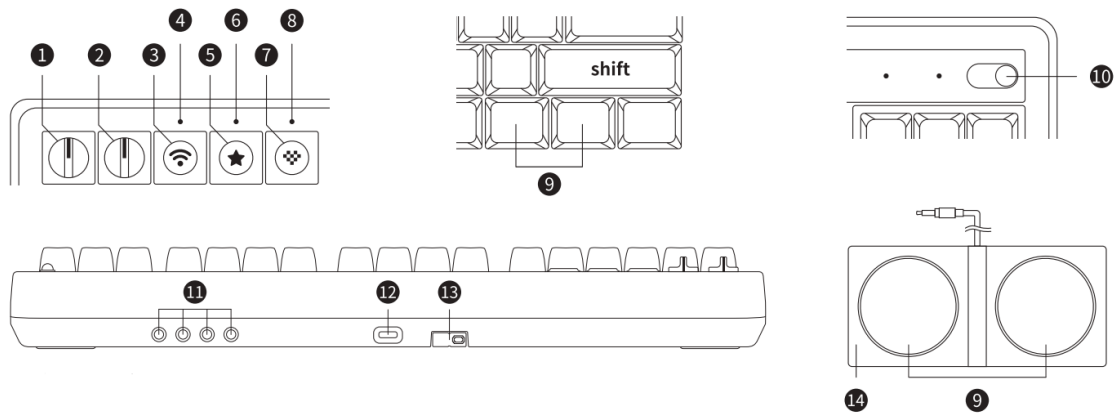

1. Mode switch
2. pair button
3. Fast key mapping button
4. Profile button
5. Programmable key
6. Interfaces for 8BitDo Super Buttons
7. 2.4G Receiver/Receiver compartment
8. Volume knob
9. Connection indicator
10. Keymapping indicator
11. Profile indicator
12. Power status indicator
13. Charging port USB Type C)
14. 8BitDo Dual Super Buttons

2.4G Connection

1. Turn the mode switch to 2.4.



2. Connect the 2.4G receiver to the USB port of your device.



3. The connection indicator will remain solid for 8 seconds and then go Off to indicate a successful connection.

Follow the steps below to re-pair the keyboard and receiver:

1. Turn the mode switch to 2.4

2. Hold the pair button for 3 seconds to enter its pairing mode, the connection indicator starts to blink rapidly, connect the 2.4G receiver to the USB port of your device
3. Wait for the keyboard to automatically pair with the receiver, the connection indicator will remain solid for 8 seconds and then go off to indicate a successful connection

Wired Connection

1. Turn the mode switch to OFF



2. Connect the keyboard to the USB port of your device and wait until the keyboard is successfully recognized by your device before using it.

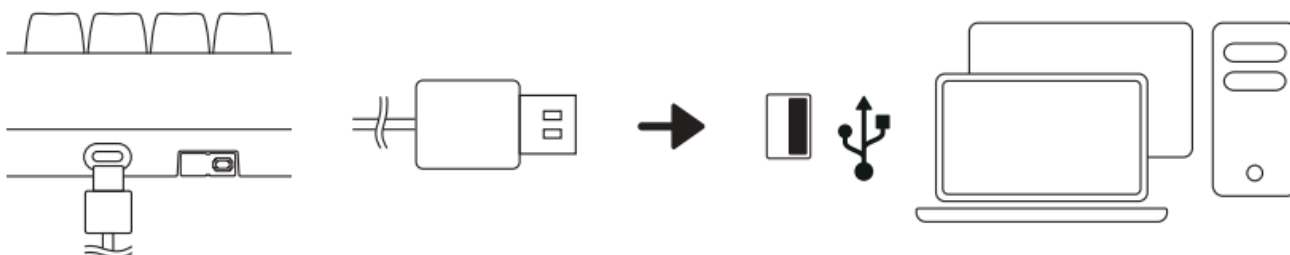

Bluetooth Connection

1. Turn the mode switch to BT 8BitDo Retro Keyboard for 3 seconds



2. Press and hold the pair button for 3 seconds to enter its pairing mode, and the connection indicator starts to blink rapidly. (this is required for the very first time only).



3. Go to your device's Bluetooth list and pair with [8BitDo Retro Keyboard], the connection indicator will remain solid for 8 seconds and then go Off to indicate a successful connection.



Battery

Status

- Low battery
- Battery charging

- Fully charged

LED indicator

- Red LED blinks
- Red LED breathing
- Red LED stays solid

200 hours Of usage time with a 2000mAh built-in battery, rechargeable with 4 hours of charging time.

Fast Key Mapping

1. Press the fast key mapping button to enter the fast key mapping mode, the key mapping indicator will blink slowly.
2. Hold one or more keys that you want to assign to a programmable key.
3. Press the programmable key to finish the mapping, the key mapping indicator will turn off.
 - you can assign up to 6 keys to a programmable key at the same time.
 - Hold the fast key mapping button for 5 seconds to clear all the fast key mappings.
 - The key mapping indicator will blink continuously when the mapped programmable key is pressed.
 - The fast key mapping mode will automatically exit after 8 seconds of no activity.

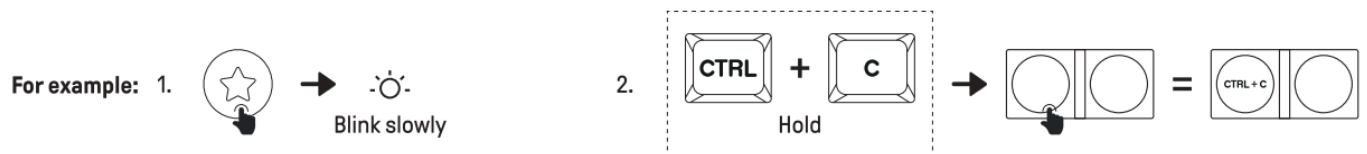

Ultimate Software

Please visit app.8bitd0.com to get the 8BitD0 Ultimate Software, which allows you to customize key mapping, macro, and more.

Support

Please visit support.8bitd0.com for further information & additional support.

FAQs

What is the build material of the keyboard and keycaps?

The construction materials influence the keyboard's durability and feel. Common materials include plastic, metal, and PBT keycaps.

Are there additional media control keys or programmable keys on the keyboard?

Check for extra features like media control keys or programmable keys that can enhance functionality.

Does it have customizable RGB lighting or backlighting?

Some mechanical keyboards offer customizable lighting options. Confirm if the 8Bitdo Retro Keyboard has any backlighting features.

What is the keyboard's compatibility with different operating systems?

Verify whether the keyboard is compatible with various operating systems, such as Windows, macOS, or Linux.

Is the keyboard wireless or wired?

The 8Bitdo Retro Mechanical Keyboard may be available in both wireless and wired configurations, providing flexibility in connectivity.

Does the keyboard feature a retro design, and what era does it draw inspiration from?

How many keys are on the keyboard, and is it a full-sized layout?

The keyboard likely has a standard number of keys, but it's essential to confirm if it follows a full-sized layout.

What type of switches does the 8Bitdo 6922621504290 Retro Mechanical Keyboard use?

The keyboard may use mechanical switches, and the specific type (Cherry MX, Gateron, etc.) can impact the typing experience.

Are replacement keycaps or switches readily available for the 8Bitdo Retro Mechanical Keyboard?

Knowing the availability of replacement parts can be useful for long-term use and maintenance.

What wireless connectivity does the keyboard support (Bluetooth, 2.4GHz)?

If it's a wireless keyboard, determine the type of wireless connectivity it supports, such as Bluetooth or 2.4GHz.

Is the keyboard designed for a specific purpose, such as gaming or typing?

Some mechanical keyboards are optimized for gaming, while others focus on typing comfort. Understand the intended use.

Does the keyboard have anti-ghosting or N-key rollover for improved gaming performance?

Gaming-oriented features like anti-ghosting and N-key rollover can enhance the keyboard's performance during gaming sessions.

Video-8BitDo Retro Mechanical Keyboard



[Download This Manual PDF](#)
[8Bitdo 6922621504290Retro Mechanical Keyboard Instruction Manual](#)
[Mechanical-KeyBoard-Instruction-Manual.mp4](#)

Reference Link

[8Bitdo 6922621504290Retro Mechanical Keyboard Instruction Manual-Devie. report](#)

References

- [User Manual](#)