



# 8BitDo 85HA Retro Mechanical Keyboard Instruction Manual

[Home](#) » [8Bitdo](#) » 8BitDo 85HA Retro Mechanical Keyboard Instruction Manual 

### Contents

- [1 8BitDo 85HA Retro Mechanical Keyboard](#)
- [2 OVERVIEW](#)
- [3 2.4G Connection](#)
- [4 Battery](#)
- [5 Fast Key Mapping](#)
- [6 Documents / Resources](#)



## 8BitDo 85HA Retro Mechanical Keyboard



### OVERVIEW

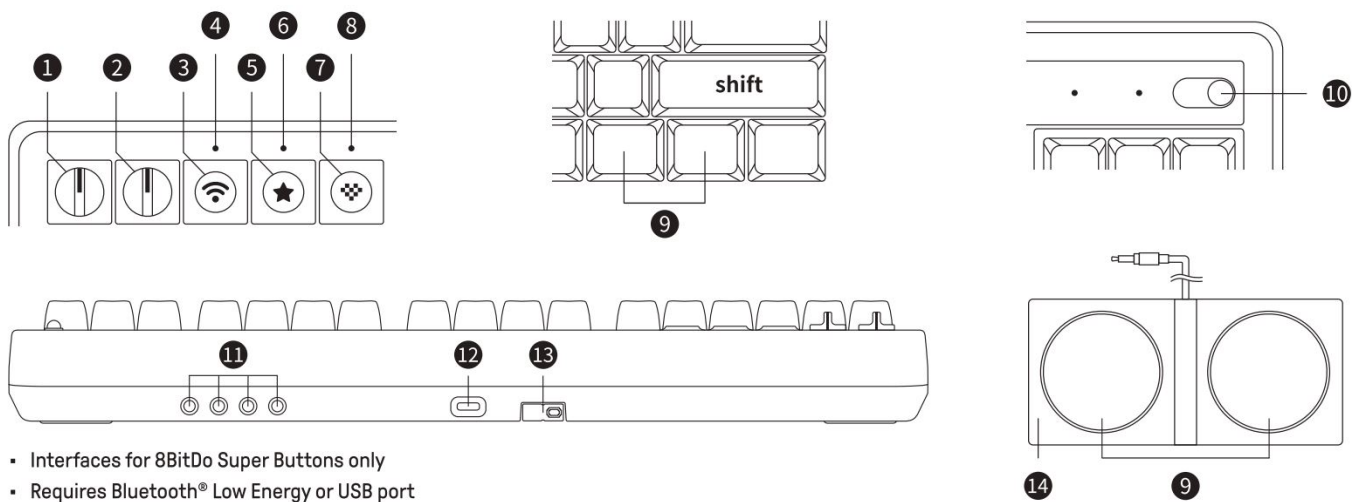

1. Mode switch
2. Volume knob
3. Pair button
4. Connection indicator
5. Fast key mapping button
6. Keymapping indicator
7. Profile button
8. Profile indicator
9. Programmable key
10. Power status indicator
11. Interfaces for 8B itDo Super Buttons
12. Charging port(USBTypo CI
13. 2.46 Receiver/Receiver compartment
14. BBitDo Dual Super Buttons

## 2.4G Connection

1. Turn the mode switch to 2.4



2. Connect the 2.46 receiver to the USB port of your device.
3. The connection indicator will remain solid for 8 seconds and then go off to indicate a successful connection.

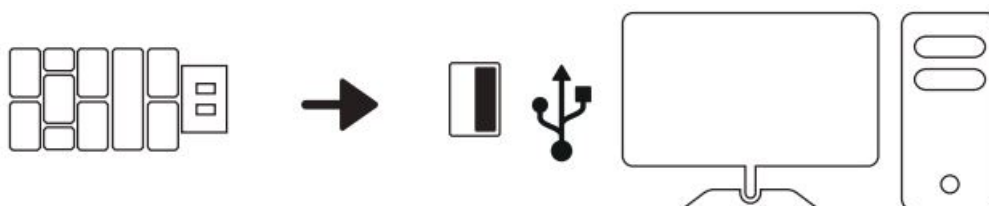

Follow the steps below to repair the keyboard and receiver:

1. Turn the mode switch to 2.4
2. Hold the pair button for 3 seconds to enter its pairing mode, the connection indicator starts to blink rapidly, connect the 2.4G receiver to the USB port of your device
3. Wait for the keyboard to automatically pair with the receiver, the connection indicator will remain solid for 8 seconds and then go off to indicate a successful connection

## Wired Connection

1. Turn the mode switch to OFF.

OFF



2. Connect the keyboard to the USB port of your device and wait until the keyboard is successfully recognized by your device before using it.

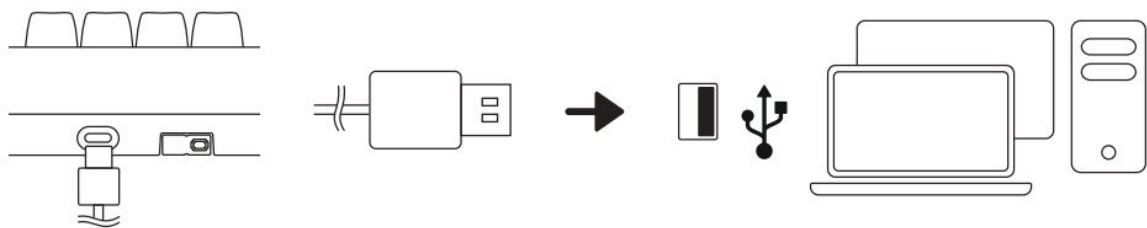

## Bluetooth Connection

1. Turn the mode switch to BT.



2. Press and hold the pair button for 3 seconds to enter its pairing mode, the connection indicator starts to blink rapidly.(this is required for the very first time only).



3 seconds

3. Go to your device's Bluetooth list and pair with [8BitDo Retro Keyboard], the connection indicator will remain solid for 8 seconds and then go off to indicate a successful connection.



8BitDo Retro Keyboard

## Battery

- **Low battery:** Red LED blinks
- **Battery charging:** Red LED breathing
- **Fully charged:** Red LED stays solid

200 hours of usage time with a 2000mAh built-in battery, rechargeable with 4 hours charging time

## Fast Key Mapping

1. Press the fast key mapping button to enter the fast key mapping mode, the key mapping indicator will blink slowly.

2. Hold one or more keys that you want to assign to a programmable key.
3. Press the programmable key to finish the mapping, the key mapping indicator will turn off.
- You can assign up to 6 keys to a programmable key at the same time.

Hold the fast key mapping button for 5 seconds to clear all the fast key mappings.

The key mapping indicator will blink continuously when the mapped programmable key is pressed.

The fast key mapping mode will automatically exit after 8 seconds of no activity.

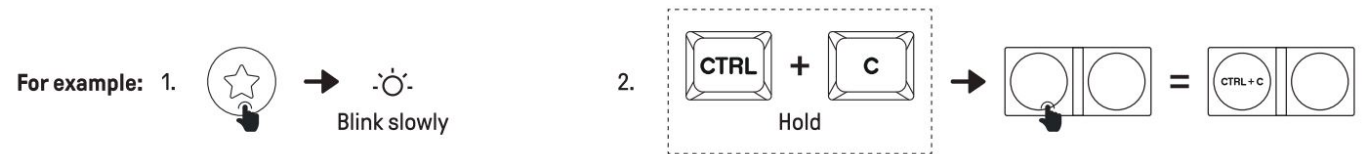

Ultimate Software

Please visit [app.8bitdo.com](https://app.8bitdo.com) to get the 8BitDo Ultimate Software, which allows you to customize key mapping, macro and more.

Support

Please visit [support.8bitdo.com](https://support.8bitdo.com) for further information & additional support.

Documents / Resources

	<a href="#">8BitDo 85HA Retro Mechanical Keyboard</a> [pdf] Instruction Manual 85HA Retro Mechanical Keyboard, 85HA, Retro Mechanical Keyboard, Mechanical Keyboard, Keyboard
---	--