



## 6 SIGMA 6S-80 Assembly Documentation Instructions

[Home](#) » [6 SIGMA](#) » 6 SIGMA 6S-80 Assembly Documentation Instructions 

### Contents

- [1 6 SIGMA 6S-80 Assembly Documentation](#)
- [2 Assembly Documentation](#)
- [3 PARTS](#)
- [4 Safety First](#)
- [5 T-Nut Installation](#)
- [6 Documents / Resources](#)
  - [6.1 References](#)
- [7 Related Posts](#)



### 6 SIGMA 6S-80 Assembly Documentation



### Product Specifications

- Model: 6S-80
- Dimensions: Various sizes ranging from 40mm to 1200mm in length
- Material: Aluminum extrusions
- Includes: Various brackets, angles, nuts, screws, and T-nuts

## **Product Usage Instructions:**

### **Assembly**

1. Ensure you have all the necessary parts as listed in the manual.
2. Follow the step-by-step assembly instructions provided in the manual.
3. Pay attention to safety guidelines such as wearing goggles when handling sharp edges.
4. Protect the product from scratches by using a towel or blanket when assembling on hard surfaces.

### **Step-by-Step Assembly**

1. **Step 1:** Install 4-40×40 angle with M8 T-Nuts and screws.
2. **Step 2:** Attach 6-80×80 bracket and 3-40x80x500 angle as instructed.
3. **Step 3:** Use 2-40x80x1200 extrusions with 6-foot pad and M8 T-Nuts.
4. **Step 4:** Follow the instructions for the specific component provided (320 [122] in this case).
5. **Step 5:** Install 2-40x80x400 extrusions according to the manual.
6. **Step 6:** Secure parts using M8 nuts, T-Nuts, and screws as specified.
7. **Step 7-12:** Follow the remaining steps in the assembly process.

### **Frequently Asked Questions (FAQ):**

#### **Q: What should I do if I encounter difficulties during assembly?**

A: If you face any challenges during assembly, refer to the detailed instructions provided in the manual or contact our customer support for assistance.

### **Assembly Documentation**

(Shown with optional 6 SIGMA label plate.)

(Shown with optional shifter mount and mouse pad kit.)

Need help? Email: [info@6sigmasimracing.com](mailto:info@6sigmasimracing.com) Toll-free: 1-[888-608-6161](tel:888-608-6161)

### **PARTS**

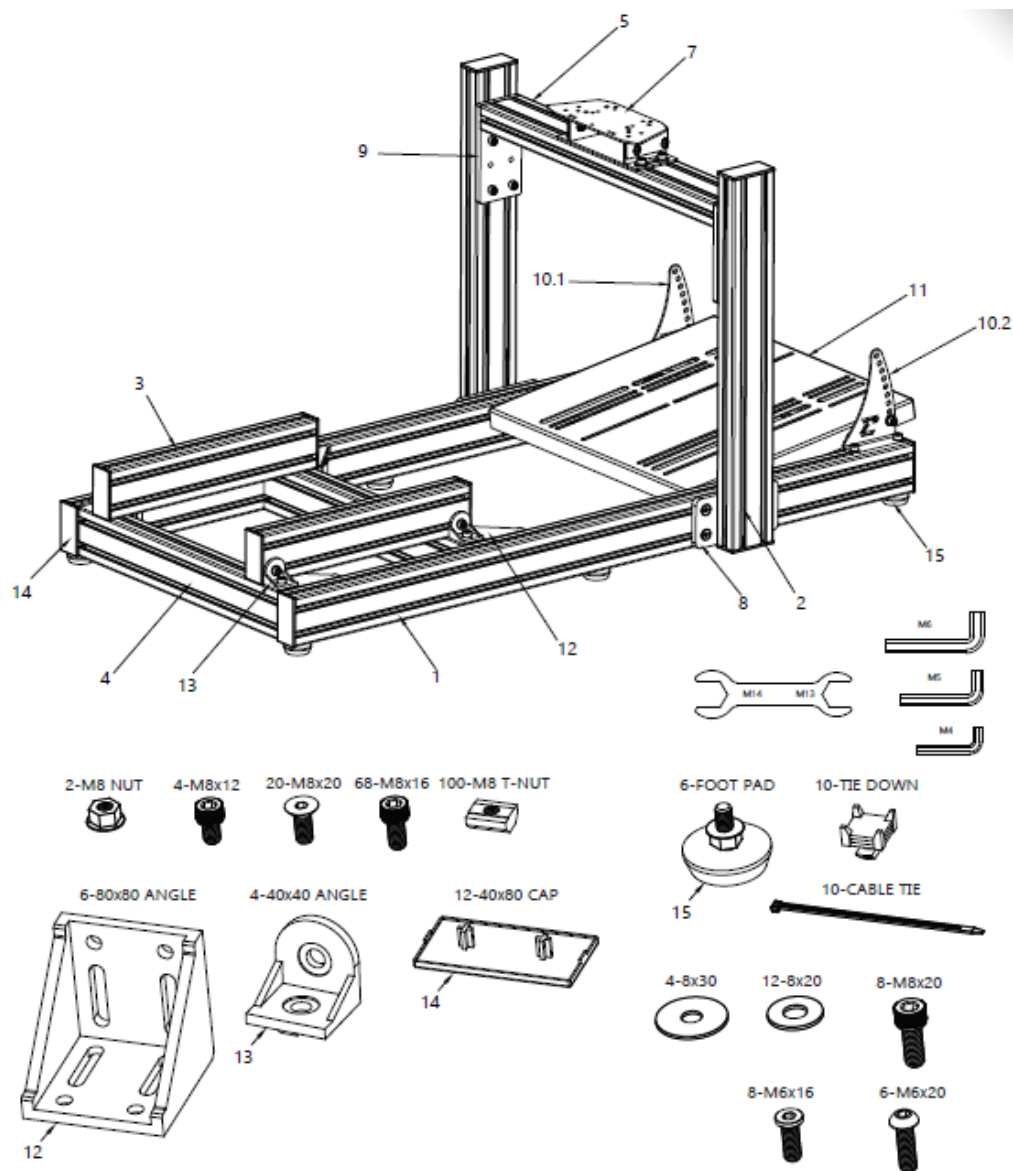

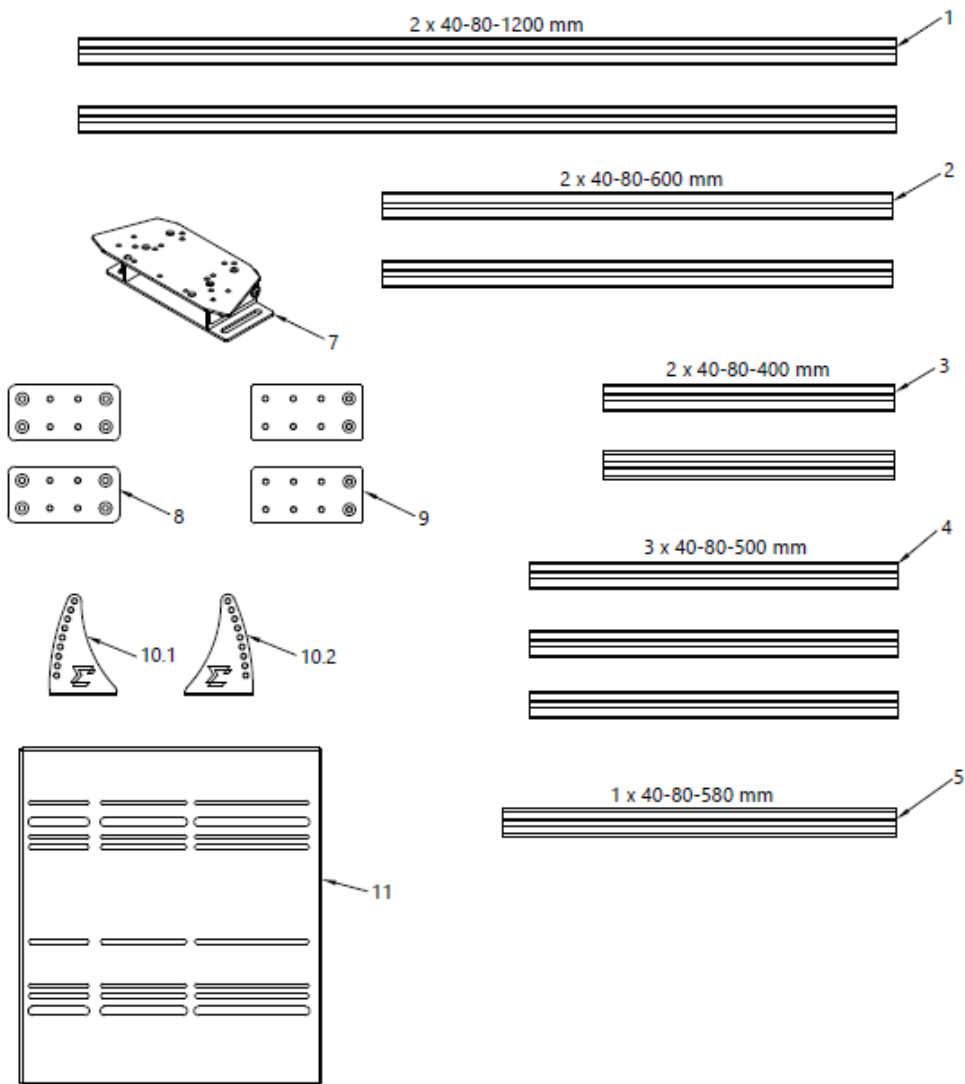

## NOTES

### Safety First

Be mindful of any sharp edges. Use safety goggles whenever removing tabs from angle brackets.



### Protect From Scratches

Hard surfaces can damage the surfaces of the aluminum extrusions.  
Use a towel or blanket when assembling on hard surfaces to protect the finishes.

### How to measure screws

Flat head screws are measured based on their overall length.  
Socket head cap screws are measured based on the length under the head of the screw.

## Metric Conversions

- 25.4 mm = 1"
- 16 mm = 5/8"
- 20 mm = 25/32"
- 320 mm = 12 9/16"
- 400 mm = 15 3/4"
- 500 mm = 19 11/16"
- 580 mm = 22 13/16"
- 700 mm = 27 9/16"
- 1200 mm = 47 1/4"

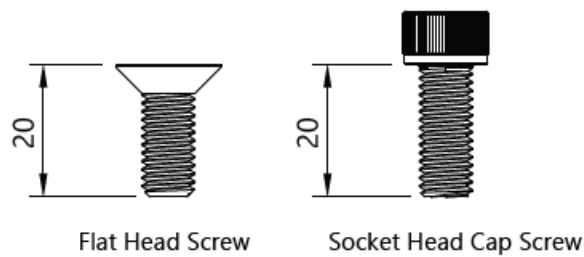

## T-Nut Installation

Be mindful of the order of installation and plan out the insertion of T-nuts.

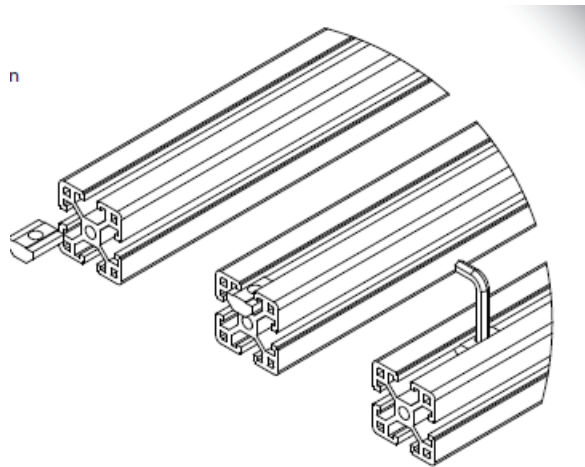

## Alignment Tab Removal

Tabs on brackets may need to be removed if they interfere with the installation of an extrusion as shown to the right.

2 – tabs need to be removed from 4 brackets

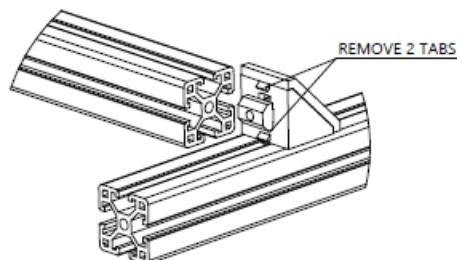

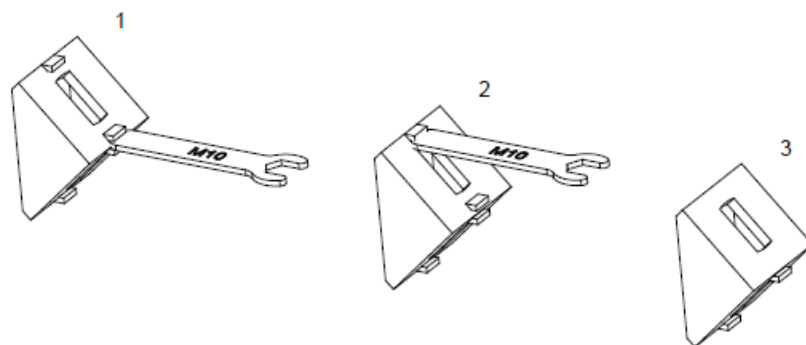

# STEP 1

4-40x40 ANGLE

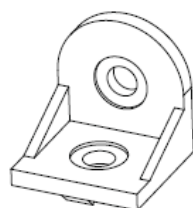

56-M8 T-NUT



56-M8x16



6-80x80 ANGLE

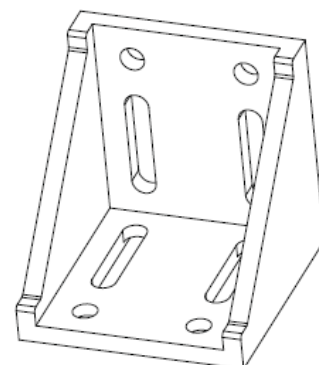

4-40x40 ANGLE

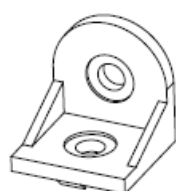

56-M8 T-NUT



56-M8x16



6-80x80 ANGLE

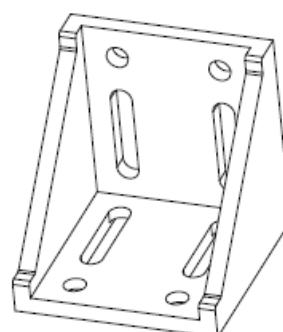

---

x 4

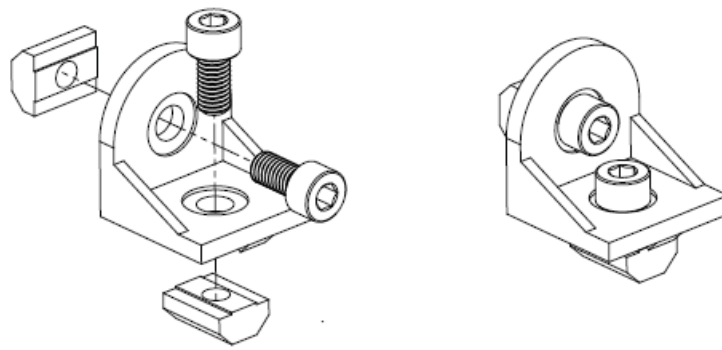

---

x 6

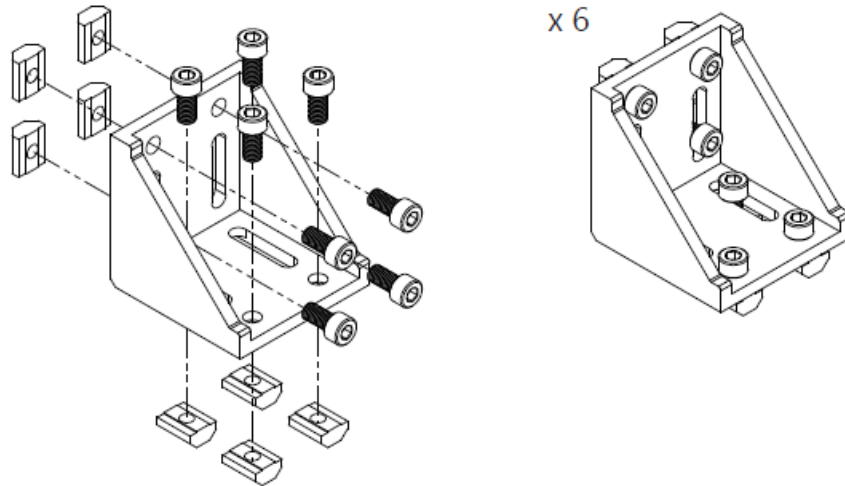

## STEP 2

6-80x80 BRACKET

3-40x80x500

4-40x40 ANGLE

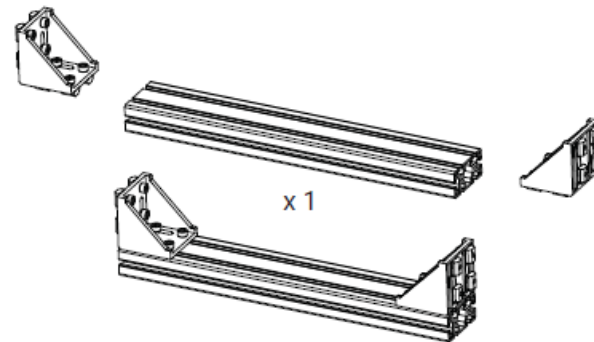
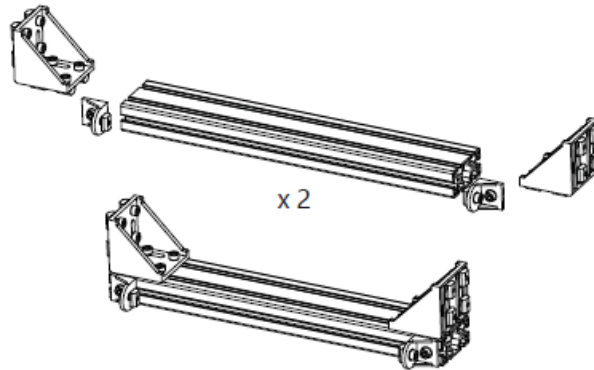
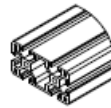
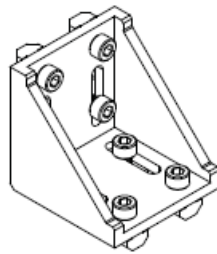

## STEP 3

2-40x80x1200

6-FOOT PAD

6-M8 T-NUT

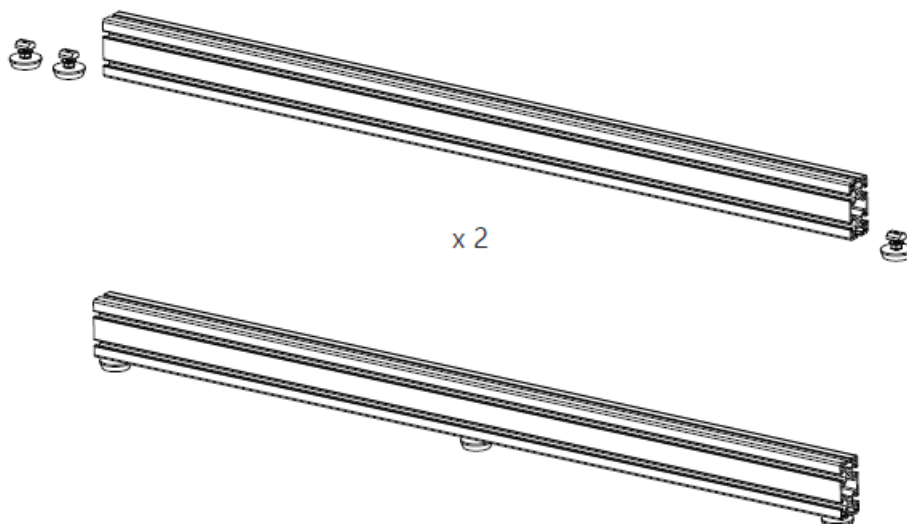
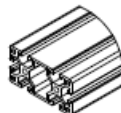
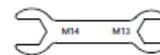



## STEP 4

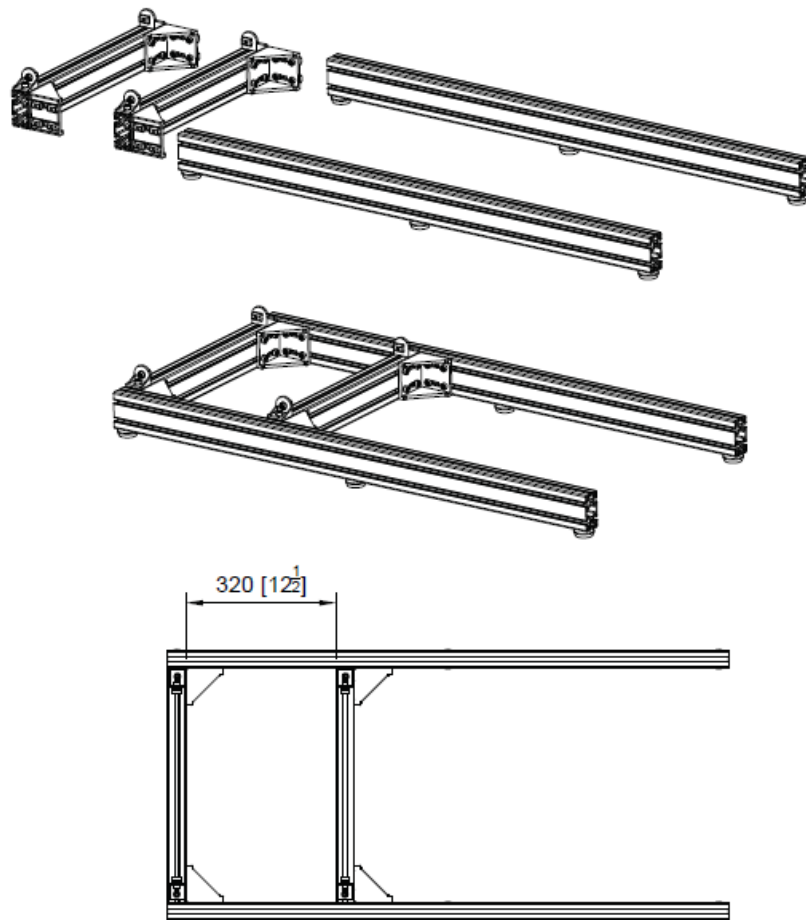

## STEP 5

2-40x80x400

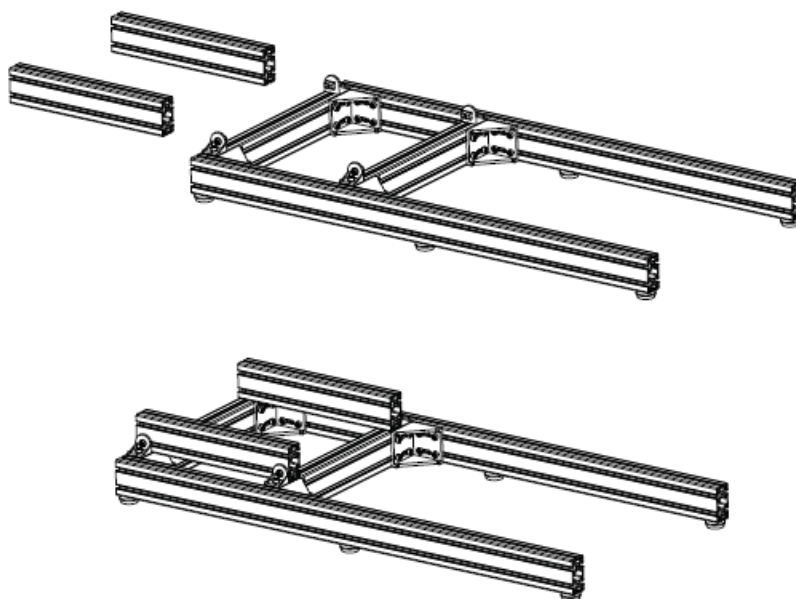
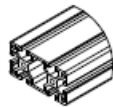

## STEP 6

2-M8 NUT



8-M8 T-NUT



8-M8x16



4-8x20

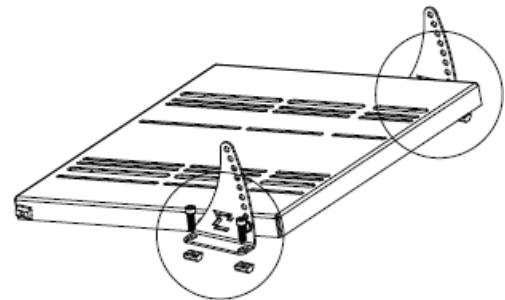
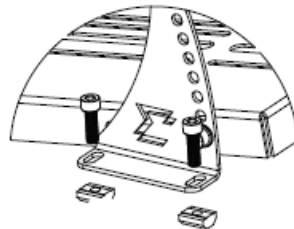
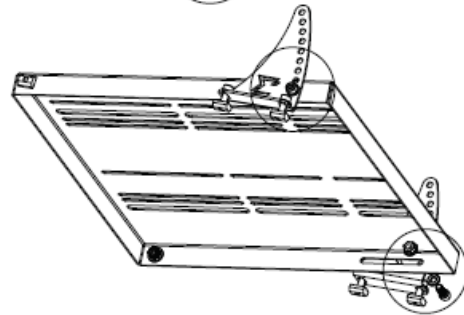
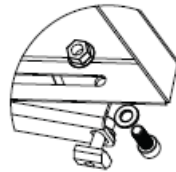
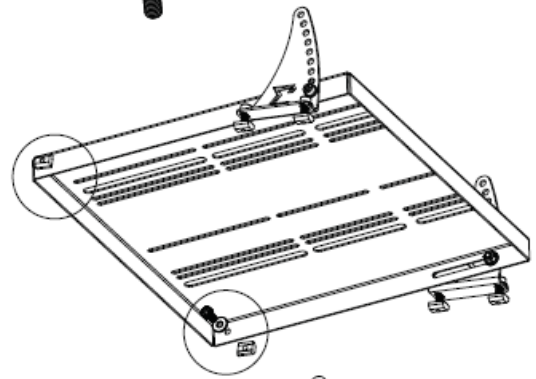
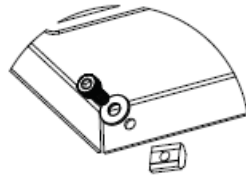

## STEP 7

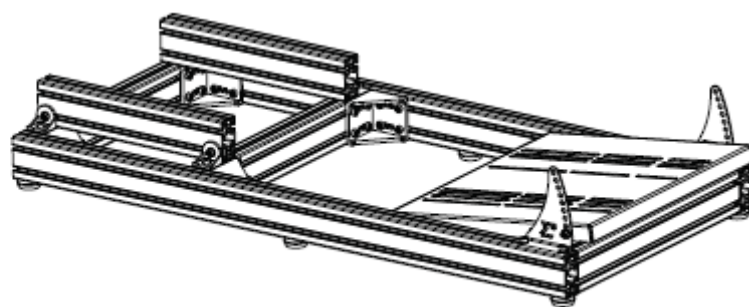
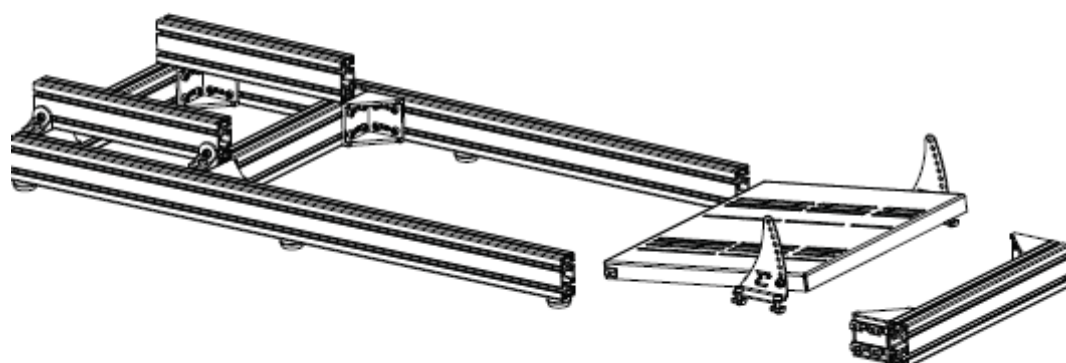

# STEP 8

2-40x80x600



16-M8 T-NUT



16-M8x20



2-MOUNTING PLATE

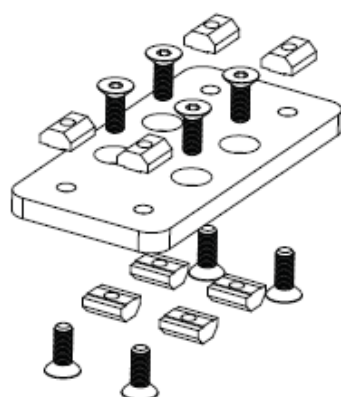
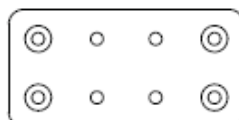

x 2

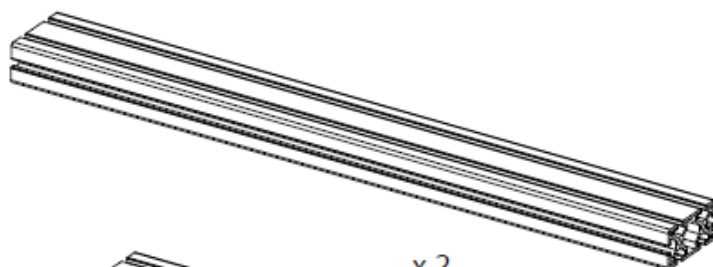
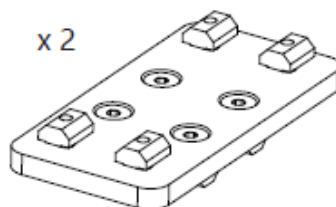

x 2

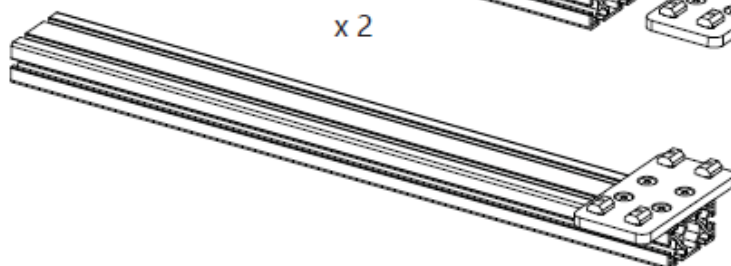

## STEP 9

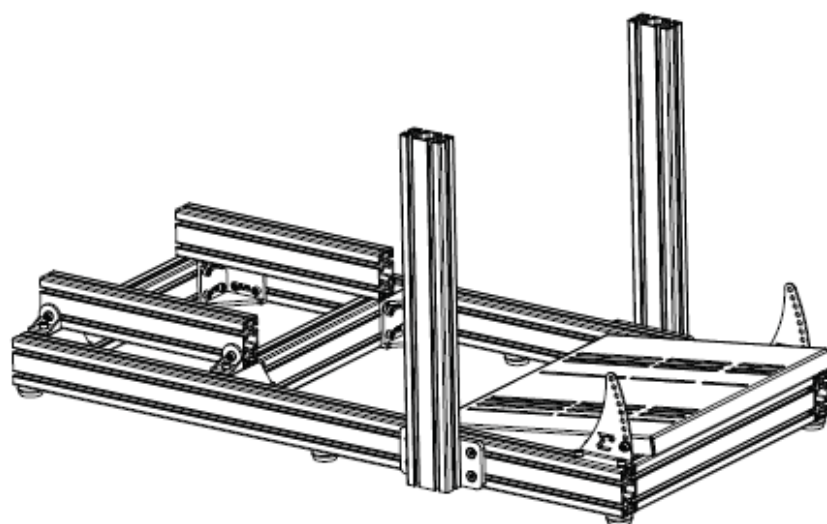
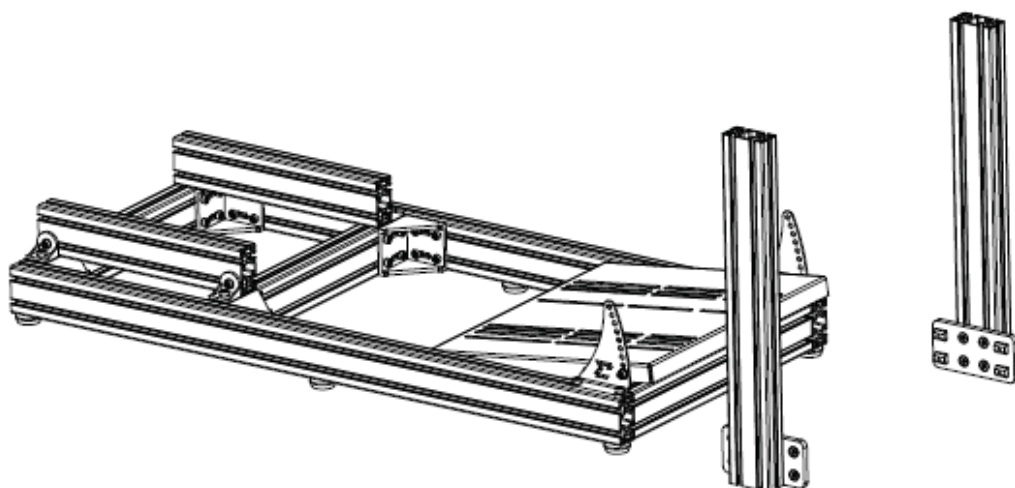

# STEP 10

1-40x80x580

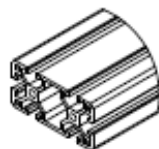

12-M8 T-NUT



4-M8x20



12-8x20



4-M8x12



8-M8x20

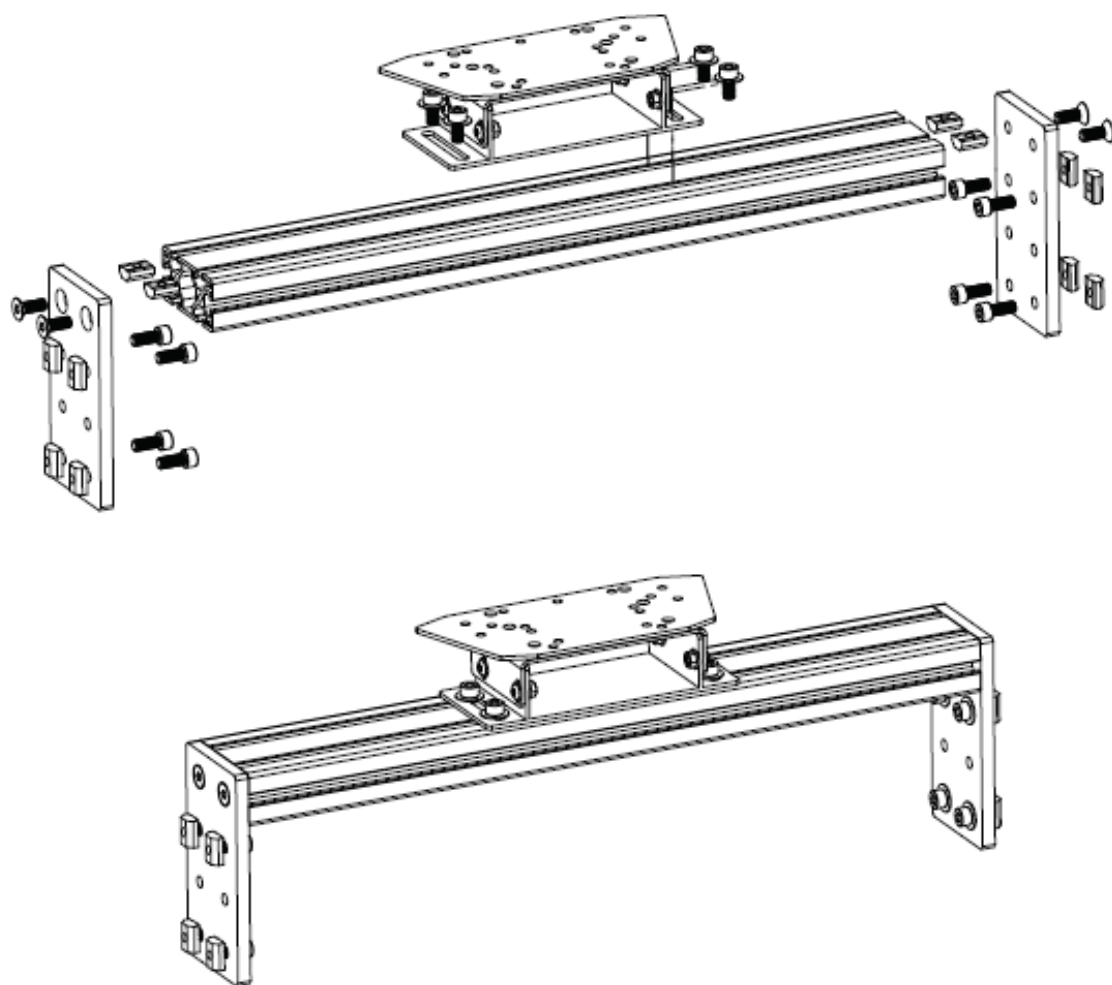

## STEP 11

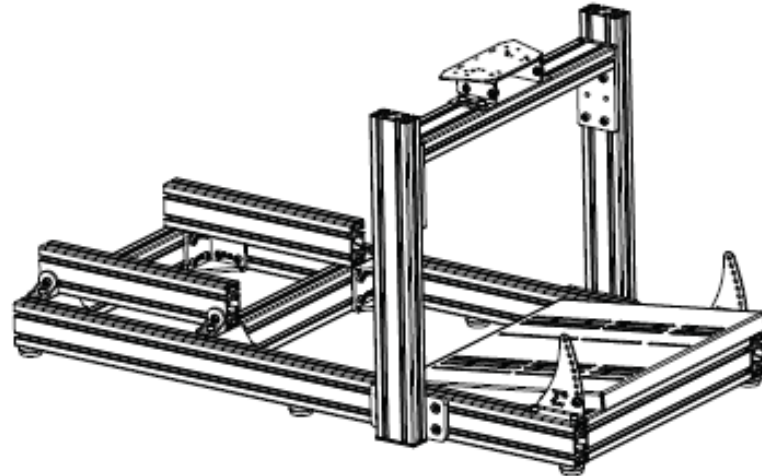
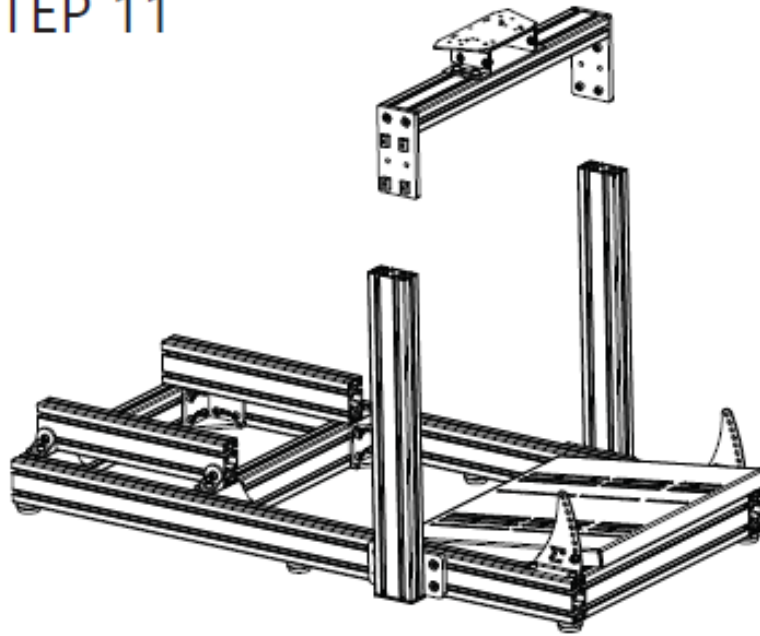

## STEP 12

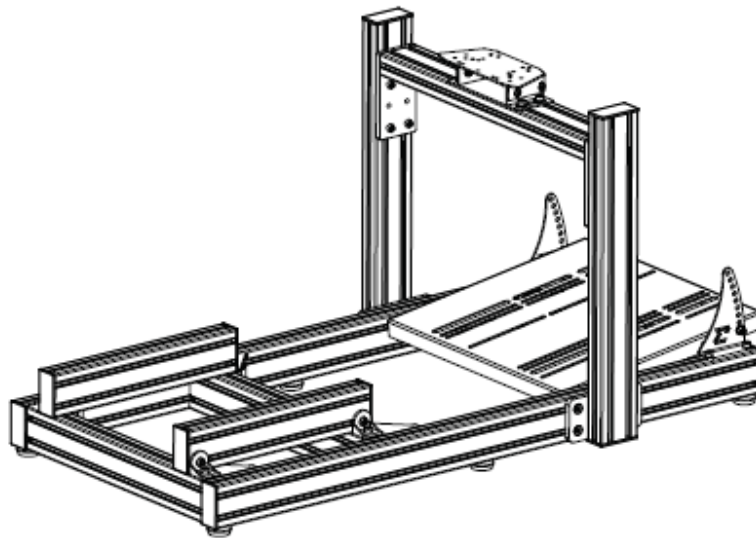

**SHIFTER MOUNT AND MOUSE PAD KIT (OPTIONAL)**



1-40x40x320



1-40x80x580

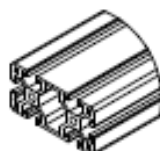

9-M8 T-NUT



6-M6 NUT



3-M8x20



6-M6x20



2-M8x16



x 2



1-MOUNTING PLATE

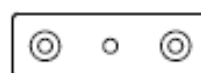

MOUSE PAD



SHIFTER MOUNT BRACKET

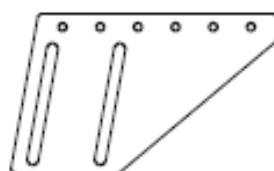

SHIFTER MOUNT

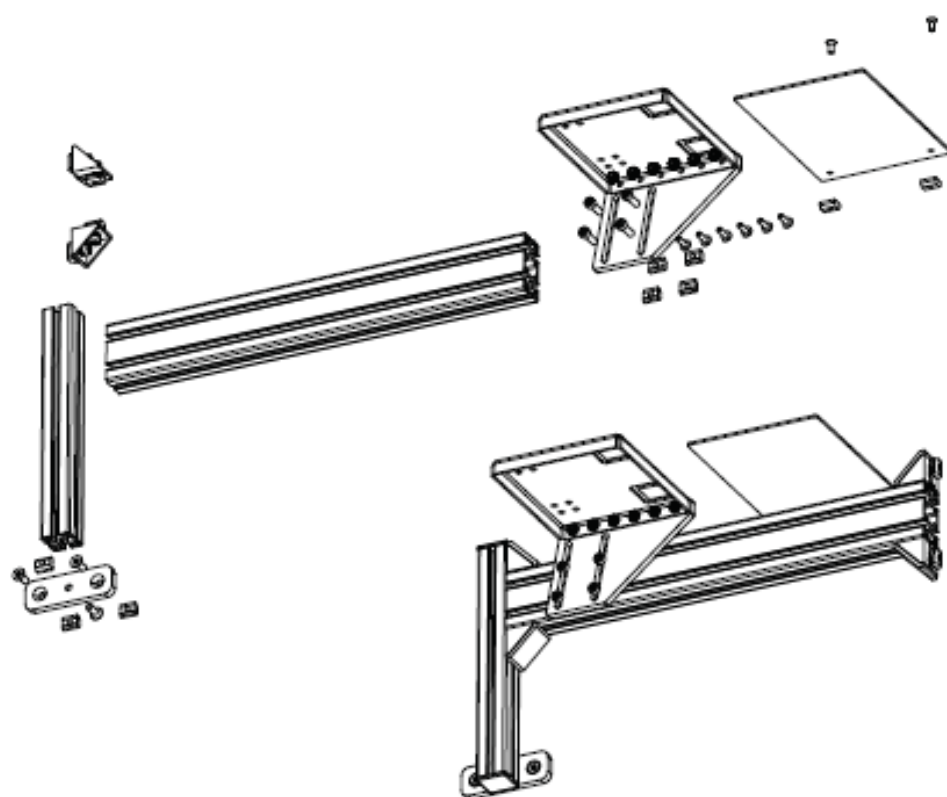
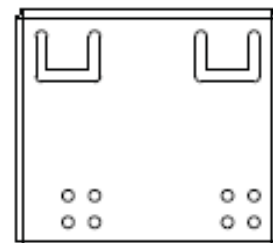

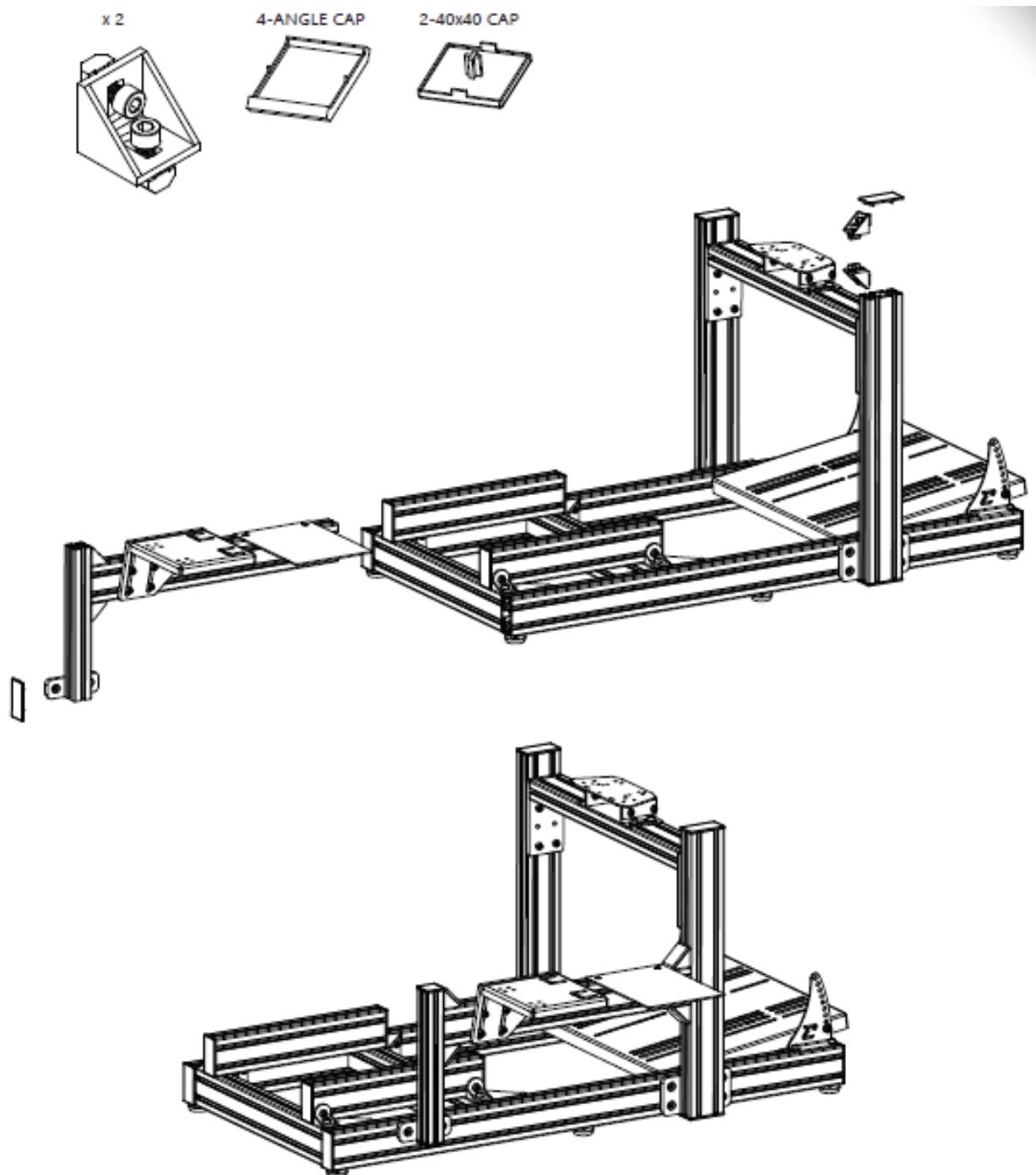

Need help? Email: [info@6sigmasimracing.com](mailto:info@6sigmasimracing.com) Toll-free: 1-[888-608-6161](tel:888-608-6161)

## Documents / Resources



[6 SIGMA 6S-80 Assembly Documentation](#) [pdf] Instructions  
6S-80 Assembly Documentation, 6S-80, Assembly Documentation, Documentation

## References

- [User Manual](#)

## **Manuals+. Privacy Policy**

This website is an independent publication and is neither affiliated with nor endorsed by any of the trademark owners. The "Bluetooth®" word mark and logos are registered trademarks owned by Bluetooth SIG, Inc. The "Wi-Fi®" word mark and logos are registered trademarks owned by the Wi-Fi Alliance. Any use of these marks on this website does not imply any affiliation with or endorsement.