



3nStar SC405 Handheld Barcode Scanner 2D With Base User Manual

[Home](#) » [3nStar](#) » 3nStar SC405 Handheld Barcode Scanner 2D With Base User Manual 



SC405
Handheld Barcode Scanner
2D with Base



User Manual



Contents

- [1 Scanner Overview](#)
- [2 Cable plug&Unplug](#)
- [3 Connection Guide](#)
- [4 Scanning Angle](#)
- [5 Methods](#)
- [6 Troubleshooting Q & A:](#)
- [7 Decode Setting](#)
- [8 Documents / Resources](#)
- [8.1 References](#)

Scanner Overview

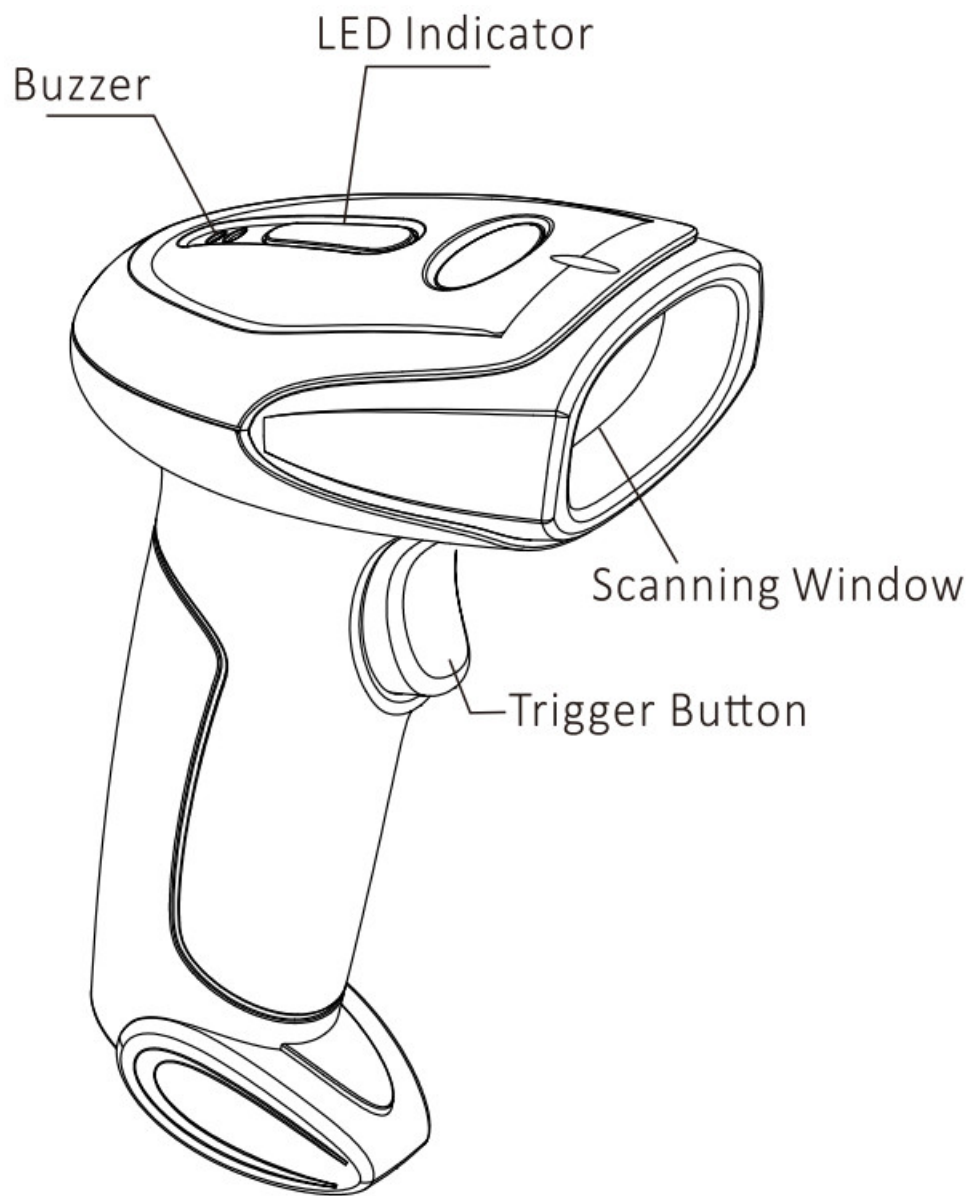

Barcode scanner

Note: Product appearance depends on goods

Cable plug&Unplug

(Pluggable scanner applies)

1. Plug as picture above

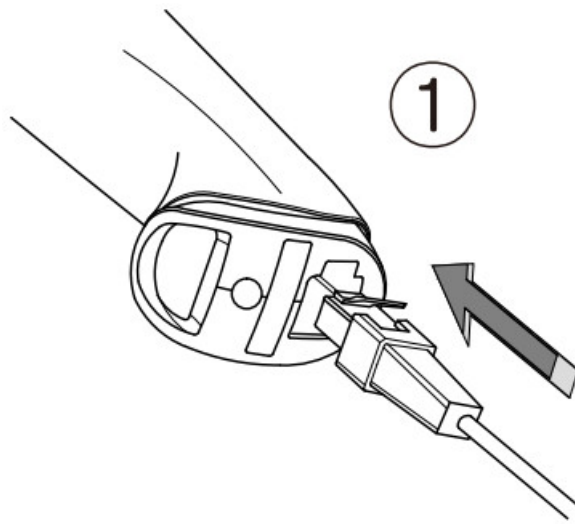

2. Press the buckle click, then pull out the cable

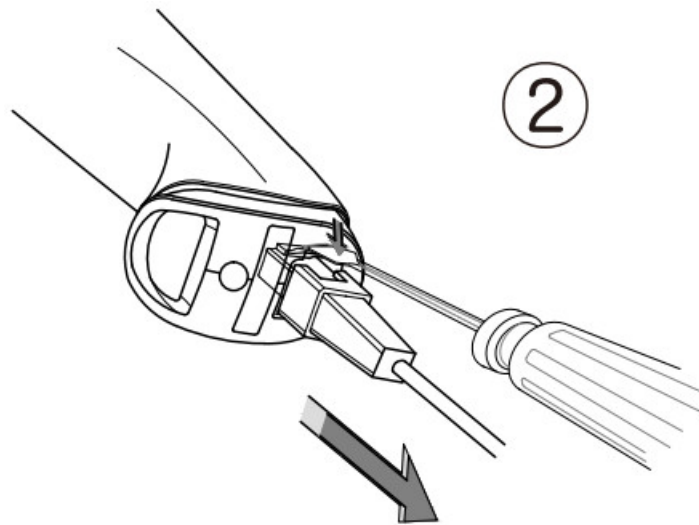

Connection Guide

1. USB cable

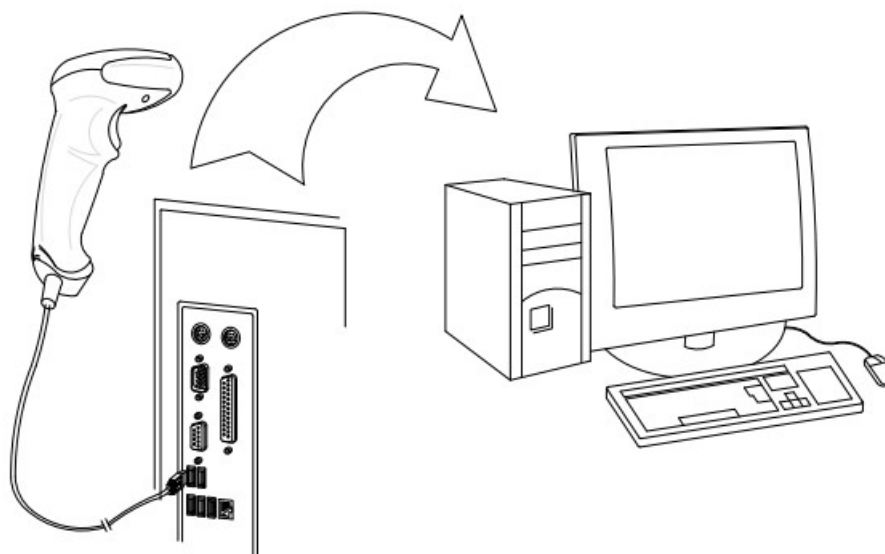

2. RS232 cable

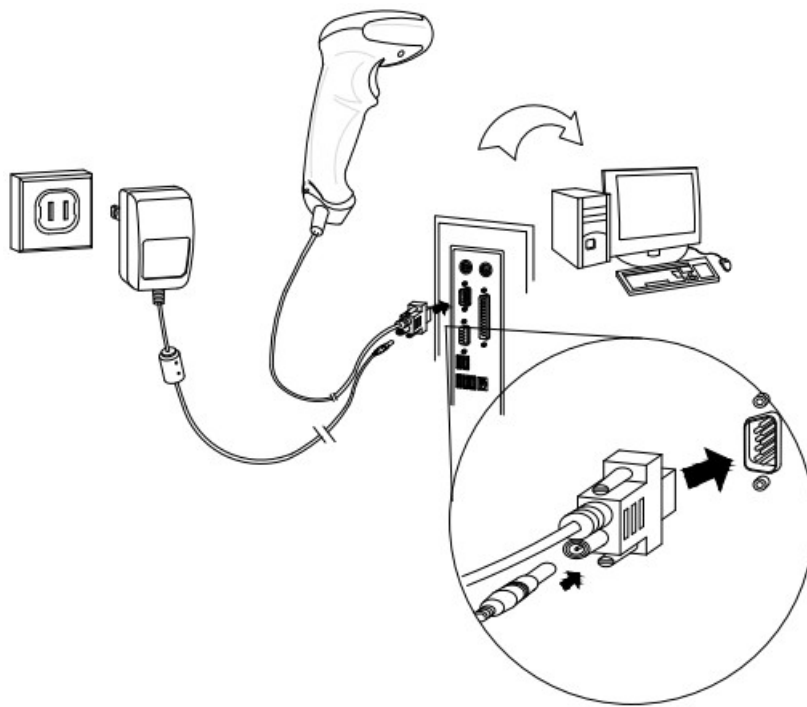

Lights Indicator

LED Indicator	Explanation
Blue light blinking	Decoding Successfully
Blue light On	Standby status

Buzzer

Beep Indication	Explanation
One Beep	Decoding Successfully
Two Beep	Successfully parameter setting

Scanning Angle

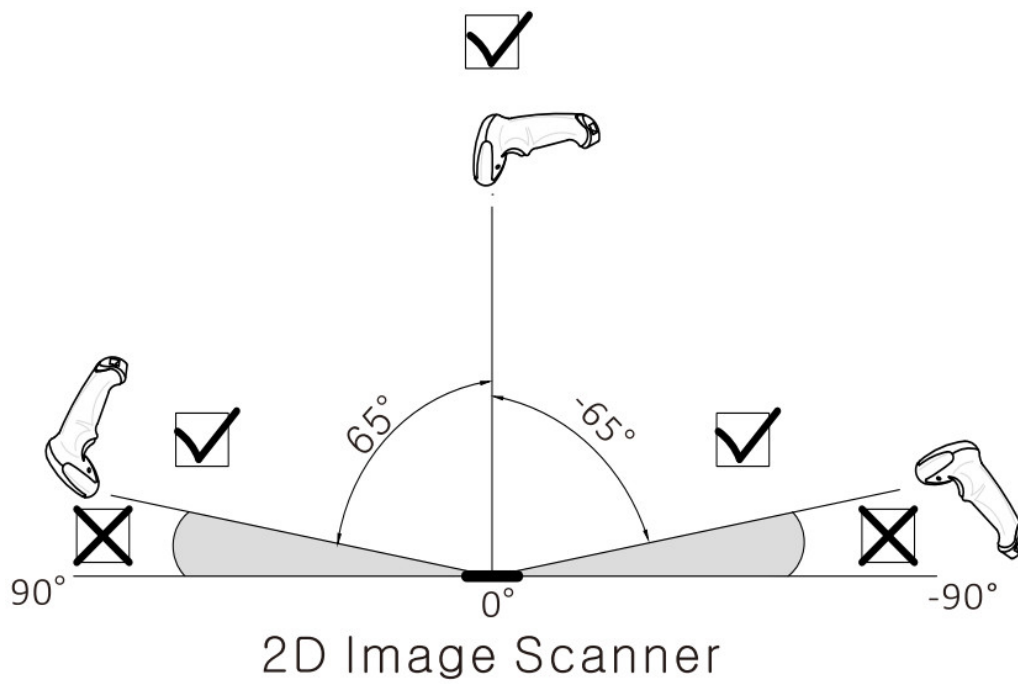

Methods

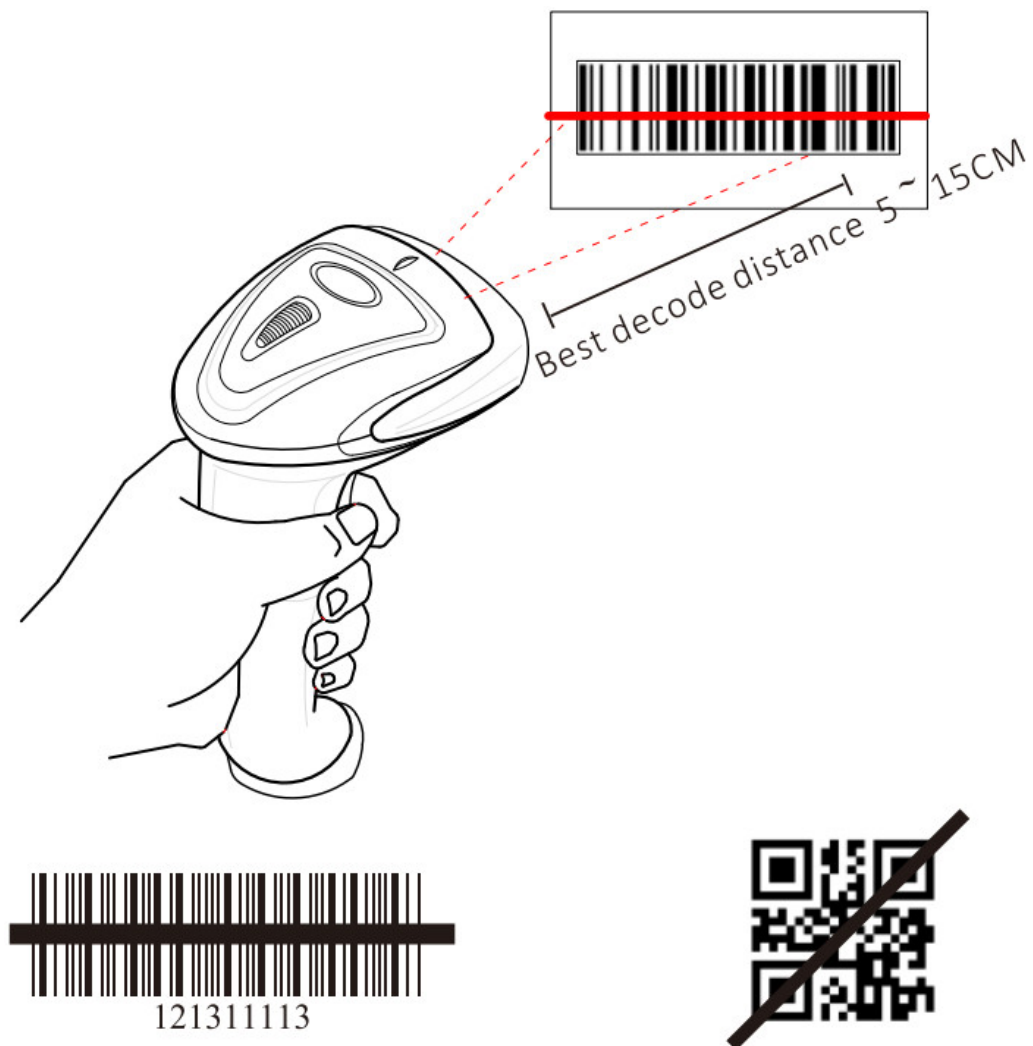

The aiming beam should be centered over the bar code, but it can be positioned in any direction for a good read.

? Troubleshooting Q & A:

USB bar code scanner without data upload and after scanning.

Unplug and plug the scanner into another USB port or reset the interface mode to “USB HID Keyboard”.

No LED light out after connection via Rs232.

Refer to Data cable connection guide and check the power supply

No data upload and alarm buzzer after scanning via Rs232.

Terminal should have software to transfer data when using RS232,not cursor position.

Decode Setting

Configuration method: Scan the function bar code directly.

① Defaults Parameter

1. Restore default parameter will not change interface Mode. Refer to interface mode selection for setting interface.
2. With “®” in bold means default parameter.



② Firmware Version

Scan the following bar code to display the firmware version number.



③ Interface Mode

According to your requirements to select the correct interface mode as blow.



091809.
USB HID Keyboard



091804.
Serial Output

④ Auto Trigger

When the scanner detects an object in its field of view, it will be trigger and attempt to decode without press the button



090901.
Enable auto trigger



091A00.
*Disable auto trigger

⑤ Suffix Values

Suffix can be appended to scan data for use in data editing.



080404;080507.
None



090200.
*0x0D (CR)



090202.
0x0A (LF)



090300.
0x0D 0x0A (CR LF)



090201.
TAB

© **Keyboard Language**

The selecting of key board layout supports many country.



060E000.
*US

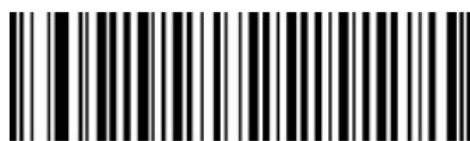

060E004.
German



060E001.
French Belgian



060E0015.
Czech



060E005.
Italian



060E003.
French



060E0027.
Turkish



060E0016.
Brazil



060E0010.
Spanish



0203051.
Transmit ST/SP



0203050.
*Not Transmit ST/SP



0203020.
*Disable Full ASCII Code39



0203021.
Enable Full ASCII Code39



0401020.
High level Illumination



0401022.
Mid level Illumination

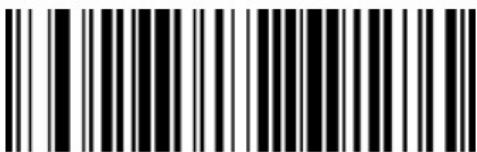

0401023.
Low level Illumination

© **Symbologies**

Read this function bar code to enable decode all bar code types.

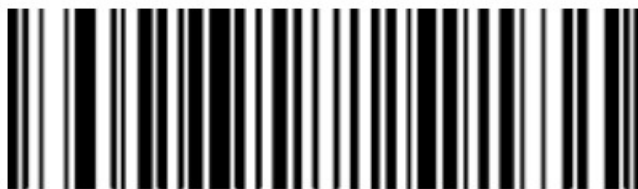

0201001.
Enable all symbologies



www.3nstar.com



[3nStar SC405 Handheld Barcode Scanner 2D With Base](#) [pdf] User Manual
SC405 Handheld Barcode Scanner 2D With Base, SC405, Handheld Barcode Scanner 2D With Base, Barcode Scanner 2D With Base, Scanner 2D With Base, With Base

References

- ^{MH} [Search - Manual-Hub.com](#)

Manuals+.