



1Mii B0301 2 in 1 Wireless Transmitter and Receiver User Manual

[Home](#) » [1Mii](#) » 1Mii B0301 2 in 1 Wireless Transmitter and Receiver User Manual 

Contents

- [1 1Mii B0301 2 in 1 Wireless Transmitter and Receiver](#)
- [2 In the box](#)
- [3 Product Overview](#)
- [4 TX mode](#)
- [5 RX mode](#)
- [6 OPERATION](#)
- [7 FCC](#)
- [8 Warranty](#)
- [9 Documents / Resources](#)



1Mii B0301 2 in 1 Wireless Transmitter and Receiver



In the box

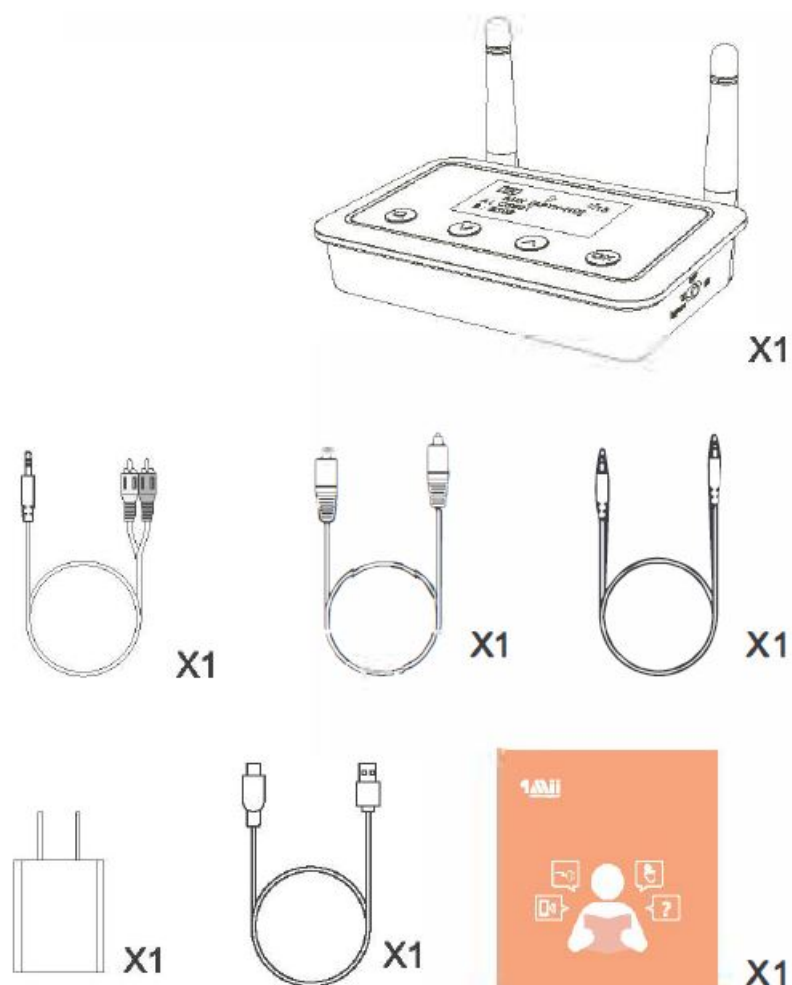

Product Overview

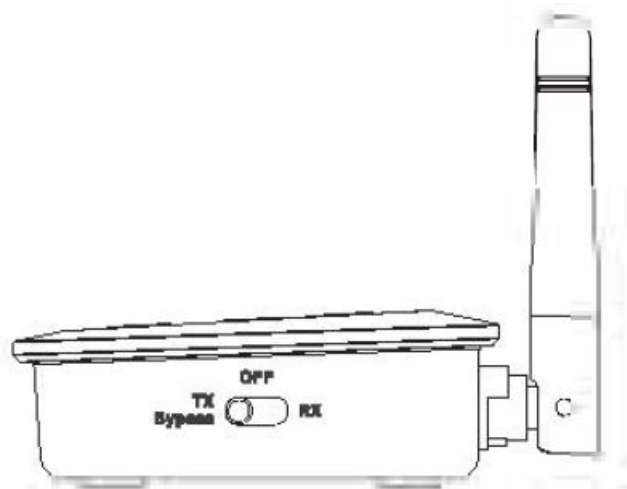
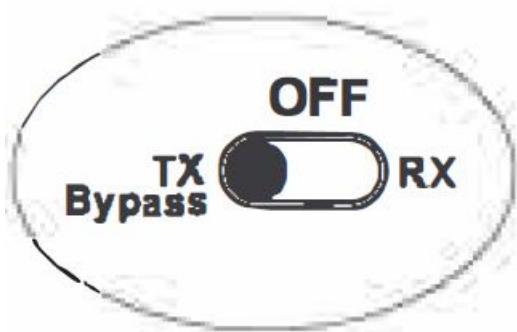

Switch to Trcnsmmitter+Bypass mode/ Power off/ Receiver Mode

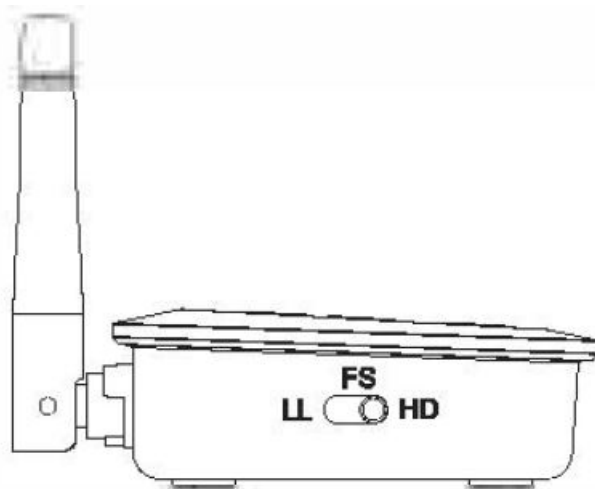
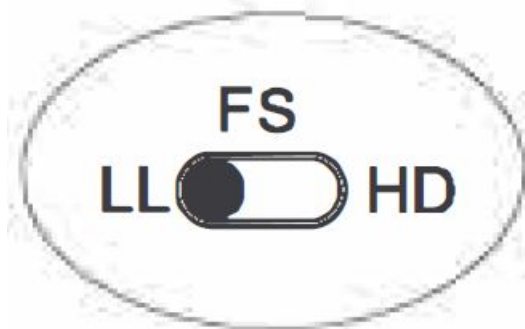

Select Codec: Format (ll/FS/HD) by the Switch

Transmitter /
Receivler Mode

Input Format

Connected
Device A/B

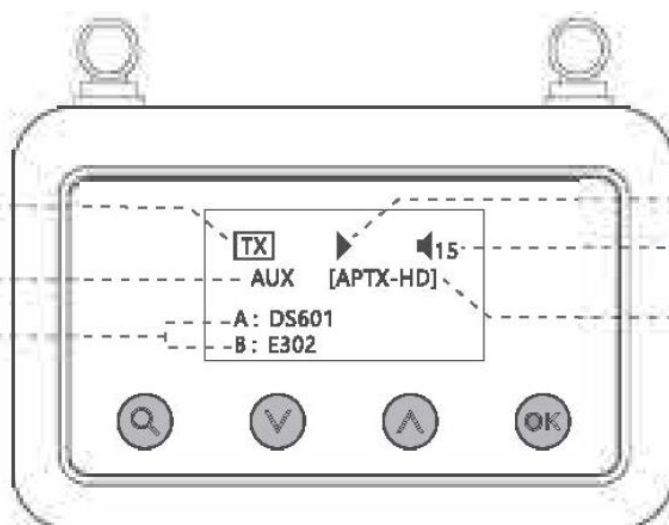

Play / Pause
Volume Level

Bluetooth Codec

1. Search and Pair
2. Confirm OK
3. Select Device
4. Volume Up/Down

5. Reset/Clear History

TX mode

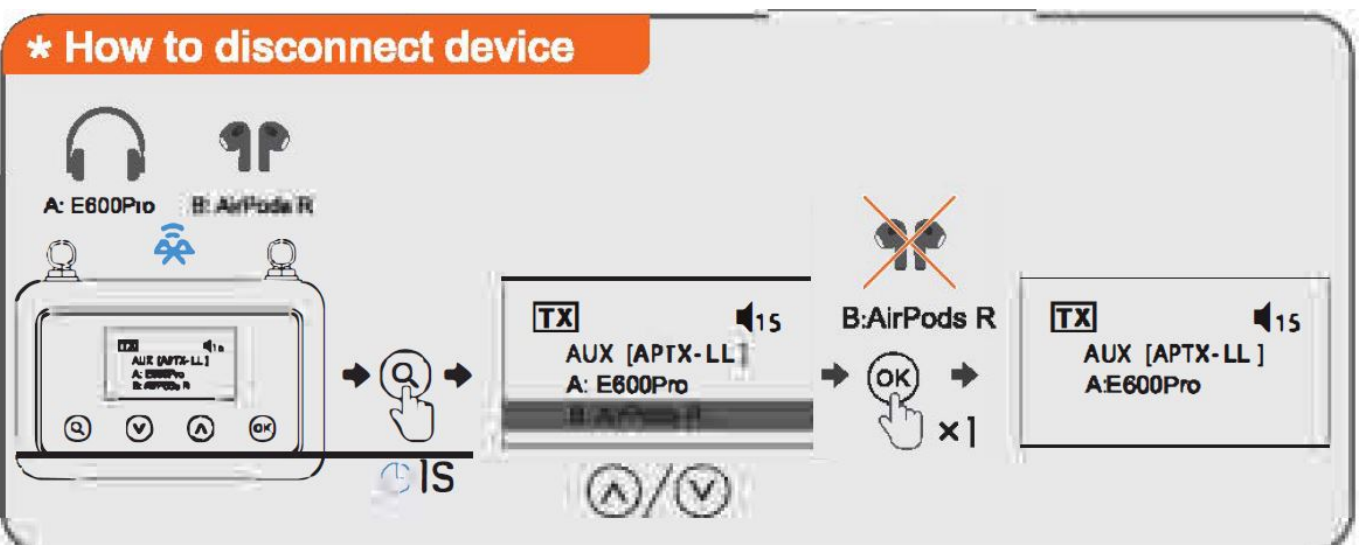
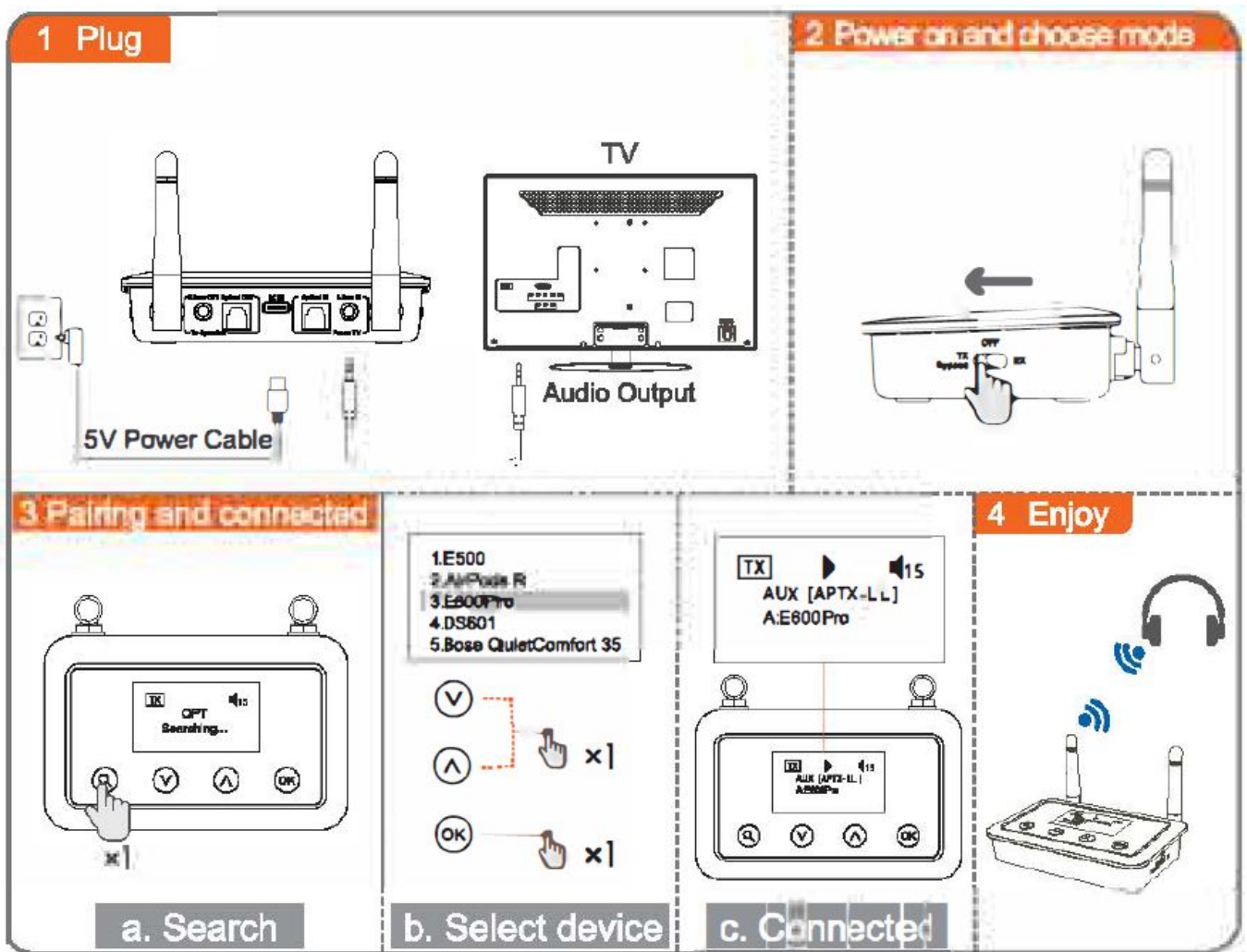

TX MODE

Slide the mode switch to IX Bypass· side Enter your headphone /speaker into PAIRING mode
Please refer to your headphone/speaker user manual for details.
Search and Conned your device to the Transmitter

- Press to search for your device on the transmitter. The bottom of the screen should now display “searching”.

- Use @ /0 to select your device. and then press,i) to connect The bottom of the screen should now display ·connecting·
- Once connected. will appear next to your device on the LCD screen

Add another headphone to lha transmitter

The transmitter can work with two headphones simultaneously; simply repeat the instructions above to pair & connect the 2nd headphone.

For next use

1. Turn on your headphones. give it 3-5 seconds. they should automatically reconnect
2. If ttiey dont, Press @ once to manually reconnect.
3. Enjoy your music

RX mode

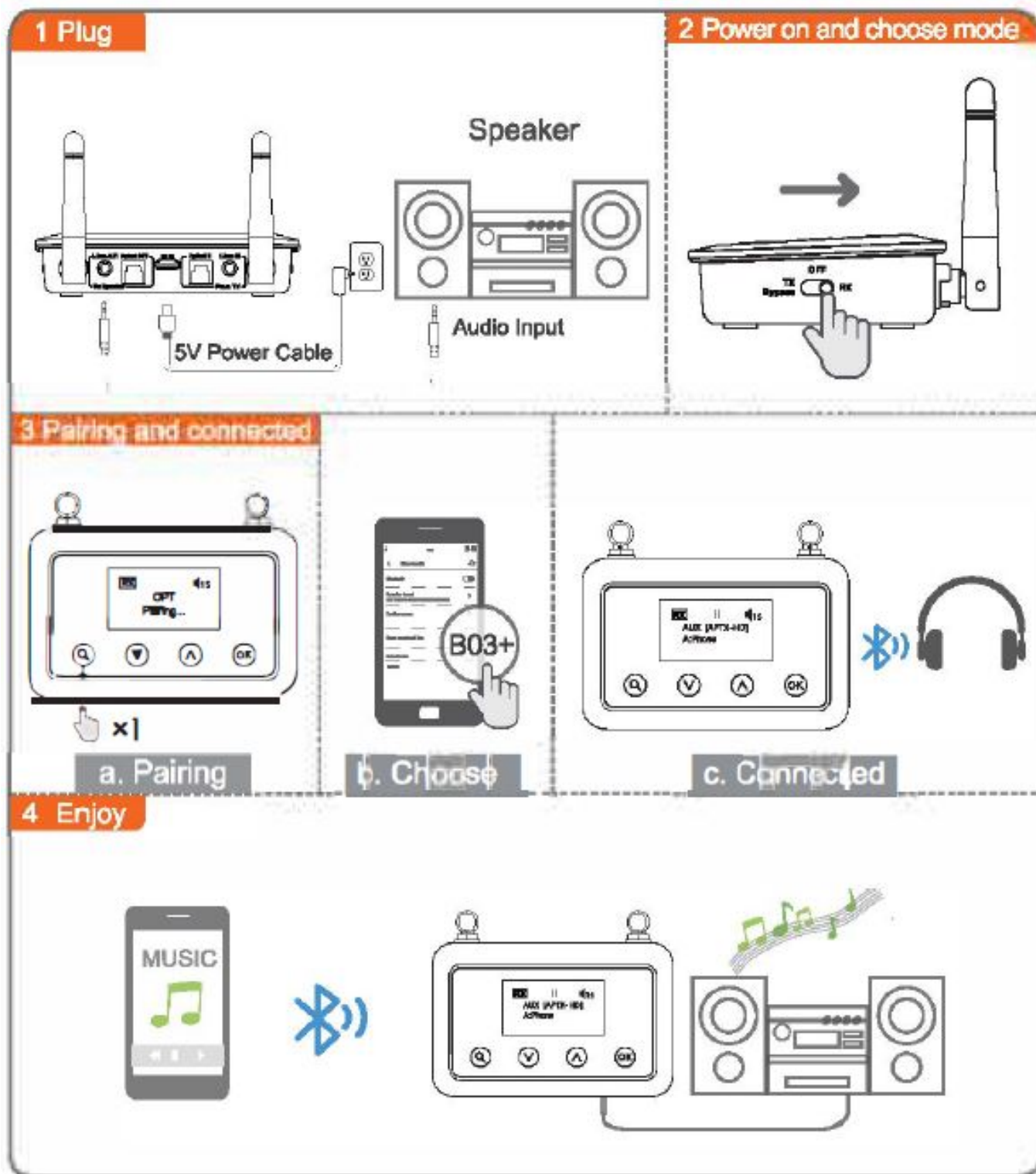



RX MODE

1. Connect your speaker to "to speaker" port of B03+ with the audio cable provided (3.5mm / RCA / Optical Cable)
2. Slide the mode switch to "RX" side.
3. Pairing: Pair B03+ with your Bluetooth-enabled phone/PC/tablet
 - Pairing mode of B03+ (get "Pairing" on the screen)
 - First time use: B03+ auto enter pairing mode (with clear memory)
 - Afterward: short press @ button to enter pairing mode.
 - Turn on Bluetooth of your Phone or other device and select B03+ in the Bluetooth list

- Wait far the connected (For quick pairing, better keep both devices within 1 meter when pairing)

4. Enjoy your music.

OPERATION

Button	EN: Operation	ZH: 操作
	Receiver mode	接收模式
	Power OFF	关机
	Transmitter mode	发射模式
	Low latency mode	低延迟模式
 	Pair the TWS	配对TWS耳机
	High definition mode	高清模式
 x1	Pair	配对
 1s	Exit pairing / Return	退出配对/返回
  x1	Flip down	下翻
 x1	Volume down	音量减
  1s	Previous song	上一曲
  x1	On the turn	上翻
 x1	Volume up	音量加
  1s	Next song	下一曲
  x1	Play / Pause	播放/暂停
  x1	Confirm OK	确认

If your TV has Digital Optical Out

Please use the Optical cable to connect your TV to the OPT INPUT port on the transmitter



- Go to your TV's SOUND settings, make sure that the AUDIO OUTPUT has been set to "External Speaker" or "Optical Out". Some TVs automatically complete this step for you, some don't.

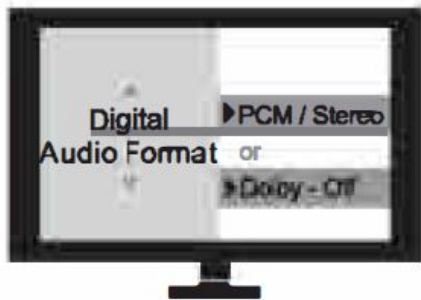

- Since Bluetooth cannot handle Dolby/DTS, you need to go to TV's SOUND settings, make sure that the DIGITAL AUDIO FORMAT has been set to PCM (or STEREO) If you see DOLBY in the menu, turn it OFF.

Ensure the MIC/ AUX/OPT audio input switch on transmitter has been switched to "OPT position". Now you can stream audio from your TV.

If your TV has an AUX/3.5mm Out .

Please use the AUX cable to connect your TV to the AUX INPUT port on the transmitter.

Ensure that the MIC/AUX/OPT audio input switch on transmitter has been switched to AUX position.

Now you can stream audio from your TV.

If you still can't hear anything through the headphones, please set the Sound Out/Speaker setting on your TV to "Wired headphones" or "Headset".

The Bluetooth® word mark and logos are owned by the Bluetooth SIG, Inc. and any use of such marks by 1Mii Ltd. is under license. Other trademarks and trade names are those of their respective owners.

FCC

This device complies with part 15 of the FCC rules. Operation is subject to the following two conditions: (1) This device may not cause harmful interference, and (2) This device must accept any interference. Changes or modifications not expressly approved by 1Mii Ltd. will void the user's authority to operate the equipment. This equipment has been tested and found to comply with the limits for a Class B digital device, pursuant to part 15 of the FCC Rules. These limits are designed to provide reasonable protection against harmful interference in a residential installation. This equipment generates, uses and can radiate radio frequency energy and, if not installed and used in accordance with the instructions, may cause harmful interference to radio communications. However, there is no guarantee that interference will not occur in a particular installation. If this equipment does cause harmful interference to radio or television reception, which can be determined by turning the equipment off and on, the user is encouraged to try to correct the interference by one or more of the following measures:

- Reorient or relocate the receiving antenna
- Increase the separation between equipment and receiver
- Connect the equipment to an electrical outlet on a different circuit to that which the receiver is connected
- Consult the manufacturer or an experienced radio/TV technician for help.

This product, like other radio devices, emits radio frequency electromagnetic energy and operates within the guidelines found in radio frequency safety standards and recommendations. These standards and recommendations reflect the consensus of the scientific community and result from deliberations of panels and

committees of scientists who continually review and interpret the extensive research literature.

Warranty

Warranty service is limited to normal use. Any man-made damages such as from connecting to an unsuitable power source, using an unsuitable device, or not following the instructions, as well as damages that did not occur during shipping, repairs and adjustments not approved by the company. Damages from misuse, inattention or improper installation may cause the warranty to be ineffective immediately. This warranty does not include shipping fee.

support@1mii.com

web: www.1mii.com

Documents / Resources

	1Mii B0301 2 in 1 Wireless Transmitter and Receiver [pdf] User Manual B0301, 2 in 1 Wireless Transmitter and Receiver
---	--

[Manuals+.](#)