



# 10X XS-SSB01 Wifi Smart Device User Manual

[Home](#) » [10X](#) » 10X XS-SSB01 Wifi Smart Device User Manual 

## Contents

- 1 10X XS-SSB01 Wifi Smart Device User Manual
- 2 Works with Smart Life APP
- 3 Add Devices in Easy Mode(Recommend)
- 4 Add Devices in AP Mode
- 5 Notices
- 6 Works with Google Home Preparation
- 7 Set up with Google Home APP
- 8 Link Smart Life account in Home Control
- 9 Works with Amazon Alexa Preparation
- 10 Tap .
- 11 Set up Echo with Amazon Alexa APP
- 12 Enable our skill in Alexa APP
- 13 Control your smart device through Echo
- 14 Q&A
- 15 How can I share my device with others?
- 16 Read More About This Manual & Download PDF:
- 17 Documents / Resources

## 10X XS-SSB01 Wifi Smart Device User Manual



### Works with Smart Life APP

#### Download & Registration

- Scan the QR code to download “Smart Life” APP. You can also search “Smart Life” in either APP store or Google Play to install the APP.
- Open the “Smart Life” APP, tap “Register” to register a “Smart Life” account with your phone number or Email. Then sign in the APP.

### Add Devices in Easy Mode(Recommend)

- Make sure your smart device is energized and your mobile phone is connected to your Wi-Fi network. Long press the power button for more than 5 seconds until the indicator light begin to flash quickly(2 times per second about), this means the device is already for configuration. (Attention: For the light bulb and bulb adaptor to turn on/off the power for 3 times continuously to get into Easy Mode.)
- Open your “Smart Life” APP and tap “+” on the top right of the APP. Select Device Type, tap it and “Confirm indicator light rapidly blink”. These will automatically fetch the password of the Wi-Fi network that your mobile phone connects to. Then tap “Confirm” to connect to the device. If When appears “Successfully added 1 device”, it means the connection is complete and your device will be listed in your APP list.



### Add Devices in AP Mode

If failed in Easy Mode, users could also add devices in AP Mode.

- Long press the power button for more than 5 seconds until the indicator light begin to flash quickly, then long press the power button for another 5 seconds until the indicator light begin to flash slowly, this means the device is already for configuration in the AP Mode. (Attention: For the light bulb and bulb adaptor to turn on/off the power for 6 times continuously to get into AP Mode.) Tap “+” on the top right of the APP. Select Device
- Type and tap it. Then select “AP Mode” on the top right of the APP. Tap “Confirm indicator light slowly blink” and “Confirm”. Then tap “Connect now” to go to the WLAN Settings interface in your mobile phone and select the Wi-Fi network named “Smartlife XXXX” to connect it.
- When appears “Successfully added 1 device”, it means the connection is complete and your device will be listed in your APP list.

Now you can control your smart device via your mobile phone APP anytime and anywhere(Make sure your mobile phone and smart device are all connected to the network).

You can share your devices with your friend or family after you add your devices successfully. More functions you will enjoy refer to the picture.

## Notices

1. Please check if there is damage caused by transportation, if yes, please contact supplier for replacement.
2. Please follow the specification instruction and notice to keep products in a good and safe use condition.
3. Put the device in proper condition and out of reach of the children .
4. .Plug in fully to the socket while using.
5. The total power of being electric connected appliances could not be bigger than the maximum power of the socket.
6. Do not disassemble or install the device other wise there may cause security risks.

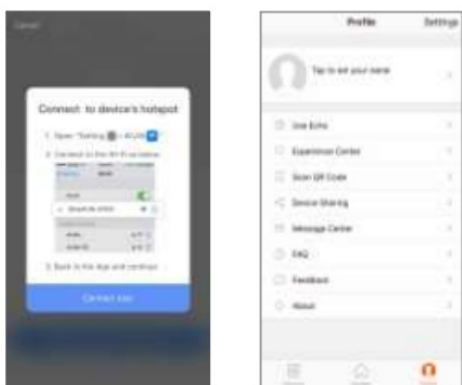

## Works with Google Home Preparation

- A Google Home device, or an Android phone with Google Assistant.
- Latest Google Home APP (Android only) and a Google account.
- The device display language must be set to English us.
- Smart Life APP and a related account. Smart device. Sign in with Smart Life account, add the device, then change the name to a easily recognized word or phrase, like “bedroom light”.

## Set up with Google Home APP

- Open the Google Home APP and sign in a Google account. Then connect the Google Home APP with your Google Home device according to the Instruction of Google Home. fl Choose the Wi-Fi network you want to connect to your Google Home. Then connect it to your Google Home according to the Instruction. Make sure your Google Home APP and Google Home are in the same Wi-Fi network.

## Link Smart Life account in Home Control

Attention: Due to the Google Home APP's known bug , you could use only one Google Home account to control "Home Control Action". If you sign in Google Home APP with several Google accounts, only the first Google account you signed in can be used for "Home Control".

- Tap "Home Control" in the hamburger menu on the Google HomeAPP's Home Page, then tap "+".
- Find "Smart Life" in the list. In the new window, select your Smart Life account region, type your Smart Life account and password, then tap "Link Now". After you assign rooms for devices, your devices will be listed in the Home Control page.

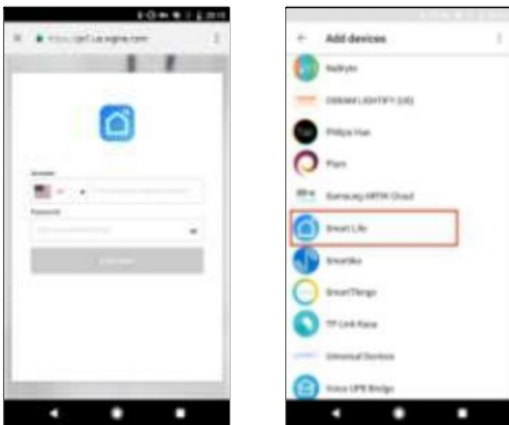

Control your smart devices  
through Google Home

Now you can control your smart device through Google Home. Take bedroom light as the example, the supported voice commands are as below:  
OK Google, turn on/off bedroom light.  
OK Google, set bedroom light to 50 percent.  
OK Google, brighten/dim bedroom light.  
OK Google, set bedroom light to red.

## Works with Amazon Alexa Preparation

- Amazon Alexa APP and account
- Smart Life APP and account .. An Echo device, including Echo, Echo Dot and Echo

Tap .

- Smart device. Sign in with Smart Life account, add the device, then change the name to a easily recognized

word or phrase, like “bedroom light”.

## **Set up Echo with Amazon Alexa APP**

Sign in with Amazon account. Tap the Homepage on the top left, tap “Settings” and “Set up a new device”. Then follow the instructions. Select a Echo device, long press the dot button on the top of your Echo device until the orange light shows up and tap “Continue”. Then select your Wi-Fi network and connect it to your device according to the instructions. This may take several minutes.

## **Enable our skill in Alexa APP**

- Tap the Homepage, select “Skills”, then search “Smart Life”. Select “Smart Life” and tap “Enable Skill” to enable the Smart Life Skill.
- You will be redirected to the account link page. Type your Smart Life account and password, do not forget to select the country/region where your account belongs to. Then tap “Link Now” to link your Smart Life account. When “Alexa has been successfully linked with Smart Life” shows up, you can leave this page. (Note: If a Smart Life account has been linked before, you can use it directly, you can also tap “Disable Skills” to remove it. )

## **Control your smart device through Echo**

Echo need to discover your smart device before the control .

- You can say “Alexa, discover device” to Echo, or you can also tap “Discover Device” on APP to discover the smart devices. Discovered devices will be shown in the list. (Note: Every time you change the name of devices on Smart Life APP, Echo must re-discover devices before the control.) Now you can control your smart devices through Echo. You can use following commands to control your devices(e.g.,bedroom light):  
Alexa, turn on/off bedroom light.  
Alexa, set bedroom light to 50 percent.  
Alexa, brighten/dim bedroom light.  
Alexa, set bedroom light to red .

You can also set up groups in Alexa APP. Tap “Create group”, give your group a name like “my smart lights”, select devices to add them in this group, then tap “Save”. Now you can control your devices by group. If you say “Alexa turn on my smart lights”, all the lights will be turned on.

## **Q&A**

Why failed in adding device?

1. Make sure the device is powered on and close to your mobile phone when adding device.
2. Make sure your mobile phone is connected to the Wi-Fi network and your Wi-Fi router is working properly.
3. Make sure the device is ready for configuration. Please refer to the Product Instruction “Add Devices in Easy

Mode” or “Add Devices in AP Mode” for details.

4. Make sure the connected devices have not reached the maximum number of Wi-Fi router. If not, please disconnect the network of some devices.
5. Make sure password of the Wi-Fi network is correct when adding new device.
6. Make sure you have selected 2.4GHz Wi-Fi network if you have a dual-band Wi-Fi router.
7. Make sure you have not used any Chinese Characters to name your Wi-Fi network. Can I control device with 2G/3G/4G network?

When adding device for the first time, it requires that your mobile phone and device are connected to the same Wi-Fi network. After adding device successfully, you can remote control your device with 2G/3G/4G network.

## How can I share my device with others?

1. Open you Smart Life APP, select your device and tap the button in the top right corner. Tap “Device Sharing” and “Add”, then select the country/region where the account belongs to and input the account (a phone number or an E-mail address) you want to share with. (Please make sure the phone number or E-mail is registered.)
2. .Open you Smart Life APP, tap “Profile• on the lower right corner of the APP. Select “Device Sharing” and add device you want to share with others, then select the country/region where the account belongs to and input the account (a phone number or an E-mail address) you want to share with. (Please make sure the phone number or E-mail is registered.)

How can I manage the device shared by others?

Open you Smart Life APP, tap “Profile• on the lower right corner of the APP. Tap “Device Sharing” ,you will find devices shared by others.

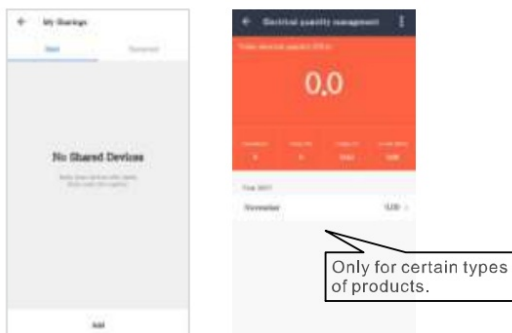

The function of electricity meter : Users can view the current, power, voltage and electrical quantity(KW, h) in real time on APP interface.(Refer to the picture above.)

## Read More About This Manual & Download PDF:

### Documents / Resources

	<a href="#">10X XS-SSB01 Wifi Smart Device</a> [pdf] User Manual XS-SSB01 Wifi Smart Device, XS-SSB01, Wifi Smart Device, Smart Device, Device
---	---

